

1

VICINITY LOCATION MAP
N.T.S.

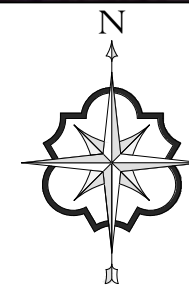

2

AERIAL VIEW LOOKING NORTHEAST
N.T.S.



3

AERIAL VIEW LOOKING SOUTHWEST
N.T.S.

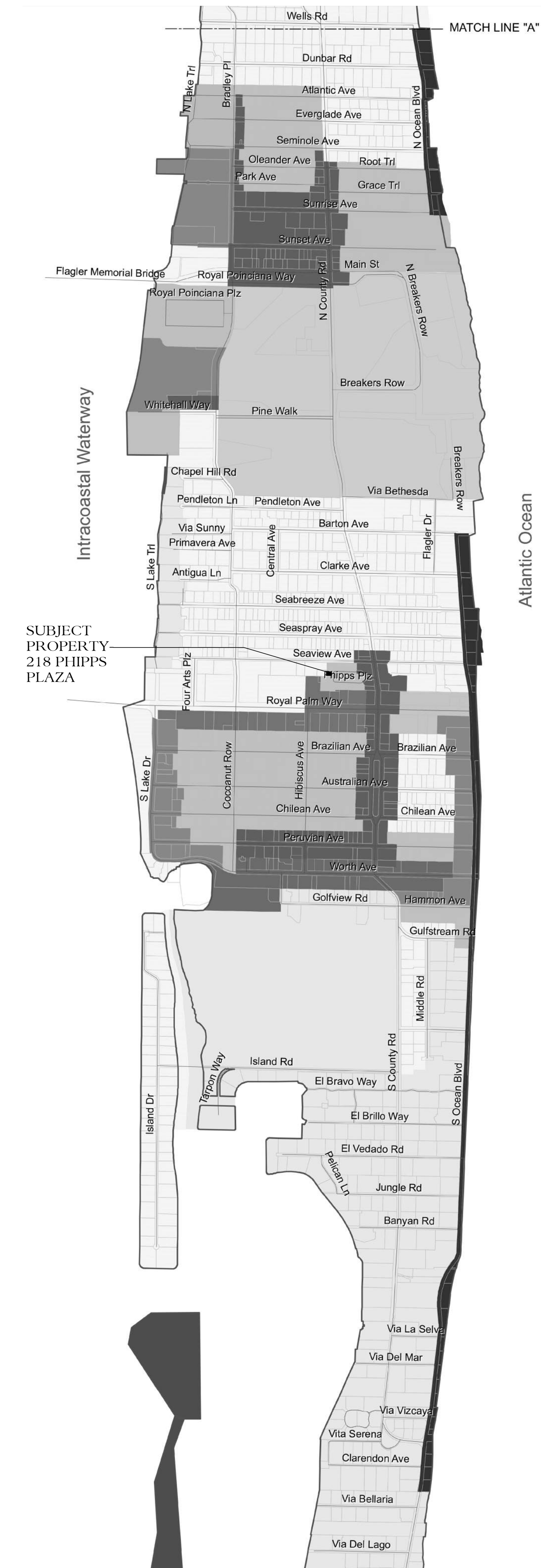

4

TOWN OF PALM BEACH MAP
N.T.S.

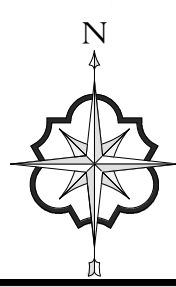

PATRICK RYAN O'CONNELL
ARCHITECT

PATRICK RYAN O'CONNELL
ARCHITECT, L.L.C.
400 ROYAL PALM WAY, SUITE 206
PALM BEACH, FL 33480
FL LIC # A26003685
WWW.PROARCHITECT.COM
tel (561) 331-2048

PROPOSED RENOVATIONS TO:
PHIPPS PLAZA
218 PHIPPS PLAZA
PALM BEACH, FL 33480

Project #: 22-004
Drawn by: PRO, AR, NS
Date(s):
21 FEB. 2023 - PERMIT SET 1
15 JULY. 2023 - STAFF APPROVAL
16 OCT. 2023 - STAFF APPROVAL
ACCESSORY STRUCTURE
NOV. 2023 - STAFF APPROVAL
HARDSCAPE/LANDSCAPE
DEC. 2023 - PERMIT REVISION
SEPT 23. 2024 - 2ND SUBMITTAL BRICK
INLAY

COA #: 24-0023

SEAL
PATRICK RYAN O'CONNELL
PROFESSIONAL CERTIFICATION:
I certify that these documents were prepared
or approved by me, and that I am a duly
licensed architect under the laws of the State
of Florida, license #A26003685,
exp. date 28 February 2025.

2

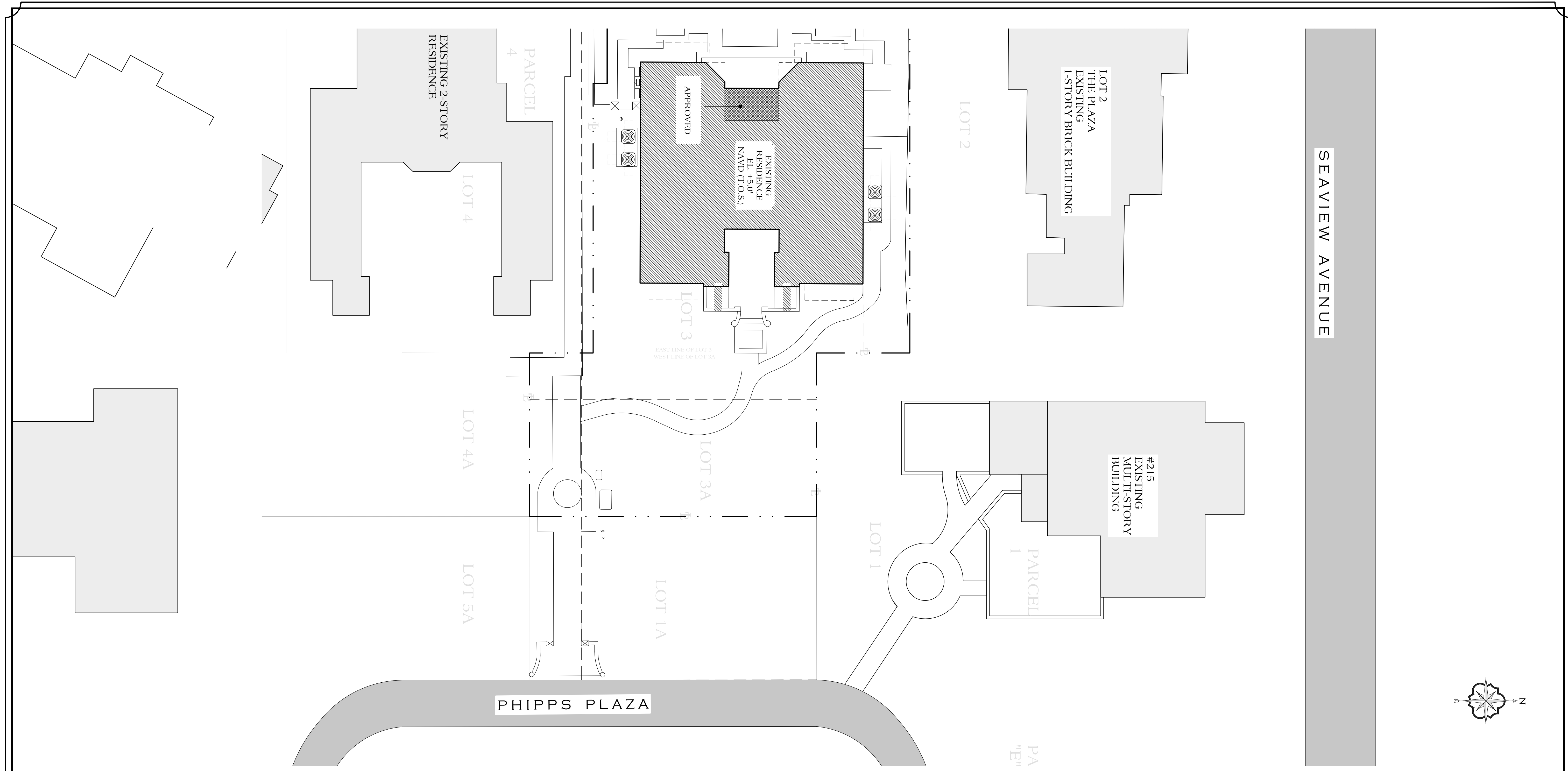

1 LOCATION PLAN
N.T.S.

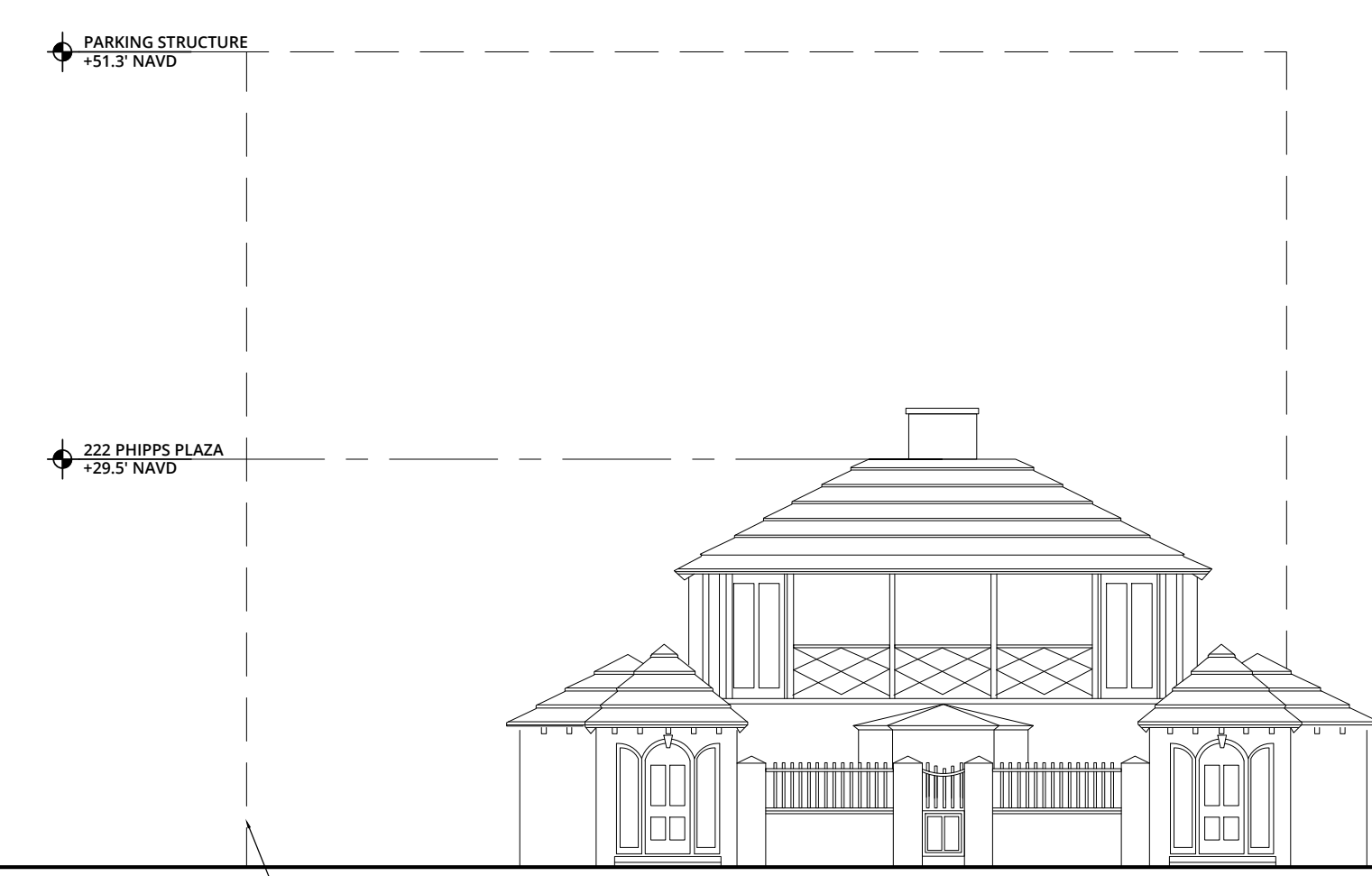

222 PHIPPS PLAZA EAST ELEVATION
6 STORY PARKING GARAGE BEYOND



218 PHIPPS PLAZA EAST ELEVATION
EXISTING ACTIVITY CENTER BEYOND

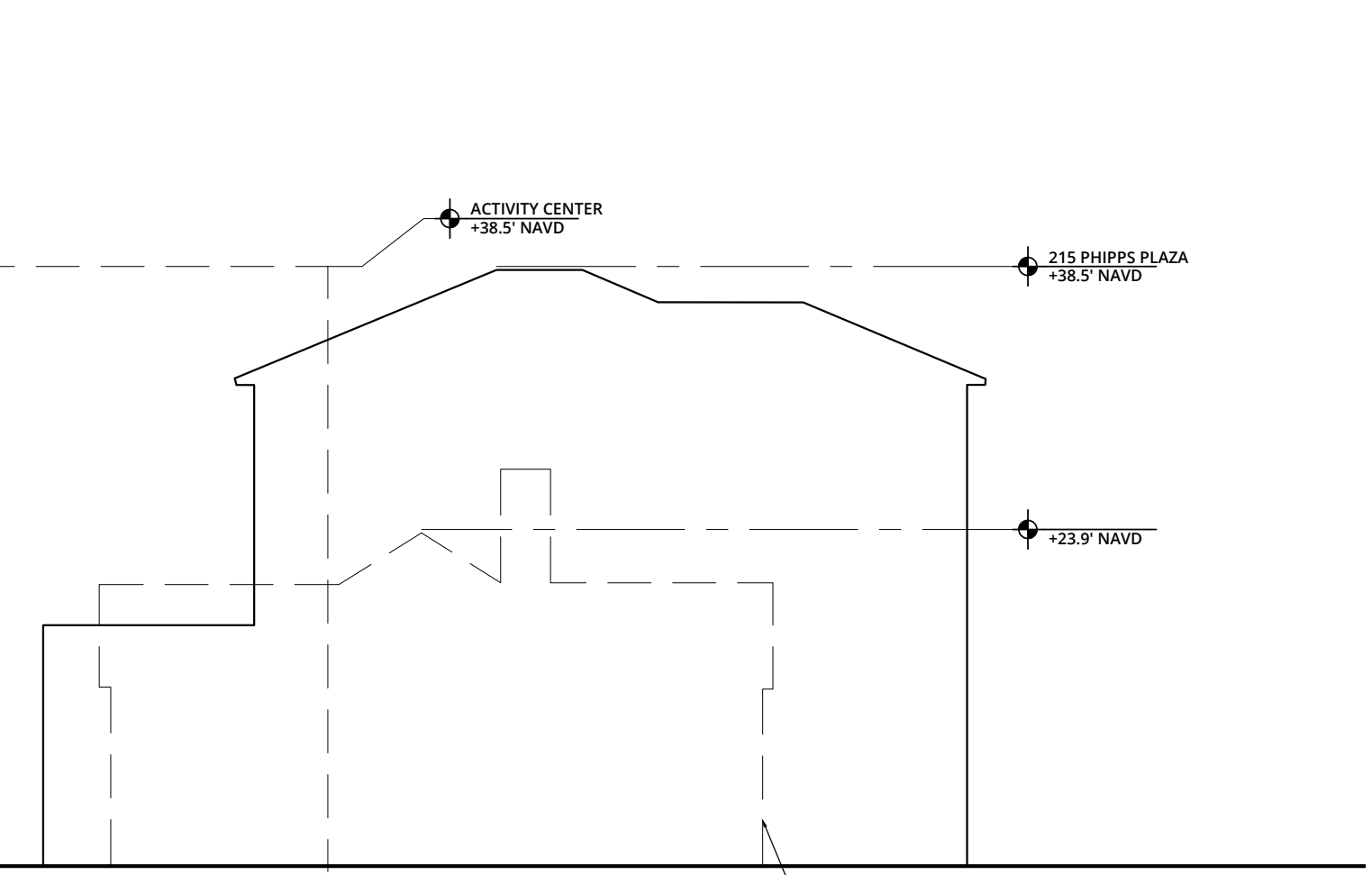

215 PHIPPS PLAZA ELEVATION
LOT 2 THE PLAZA BEYOND

2 STREETSCAPE ELEVATION
N.T.S.



PATRICK RYAN O'CONNELL ARCHITECT

PATRICK RYAN O'CONNELL ARCHITECT, L.L.C.
400 ROYAL PALM WAY, SUITE 206
PALM BEACH FL 33480
FL LIC #: A26003685
tel (561) 331-2048 WWW.PROARCHITECT.COM

PROPOSED RENOVATIONS TO:
PHIPPS PLAZA
218 PHIPPS PLAZA
PALM BEACH, FL 33480

Project #: 22-004
Drawn by: PRO, AR, NS
Date(s):
21 FEB. 2023 - PERMIT SET 1
15 JULY 2023 - STAFF APPROVAL
16 OCT. 2023 - STAFF APPROVAL
ACCESSORY STRUCTURE
NOV. 2023 - STAFF APPROVAL
HARDSCAPE/LANDSCAPE
DEC. 2023 - PERMIT REVISION
SEPT 23, 2024 - 2ND SUBMITTAL BRICK
INLAY

COA #: 24-0023

SEAL
PATRICK RYAN O'CONNELL
PROFESSIONAL CERTIFICATION:
I certify that these documents were prepared
or approved by me, and that I am a duly
licensed architect under the laws of the State
of Florida, license #A26003685,
exp. date 28 February 2025.

4
COPYRIGHT © 2024

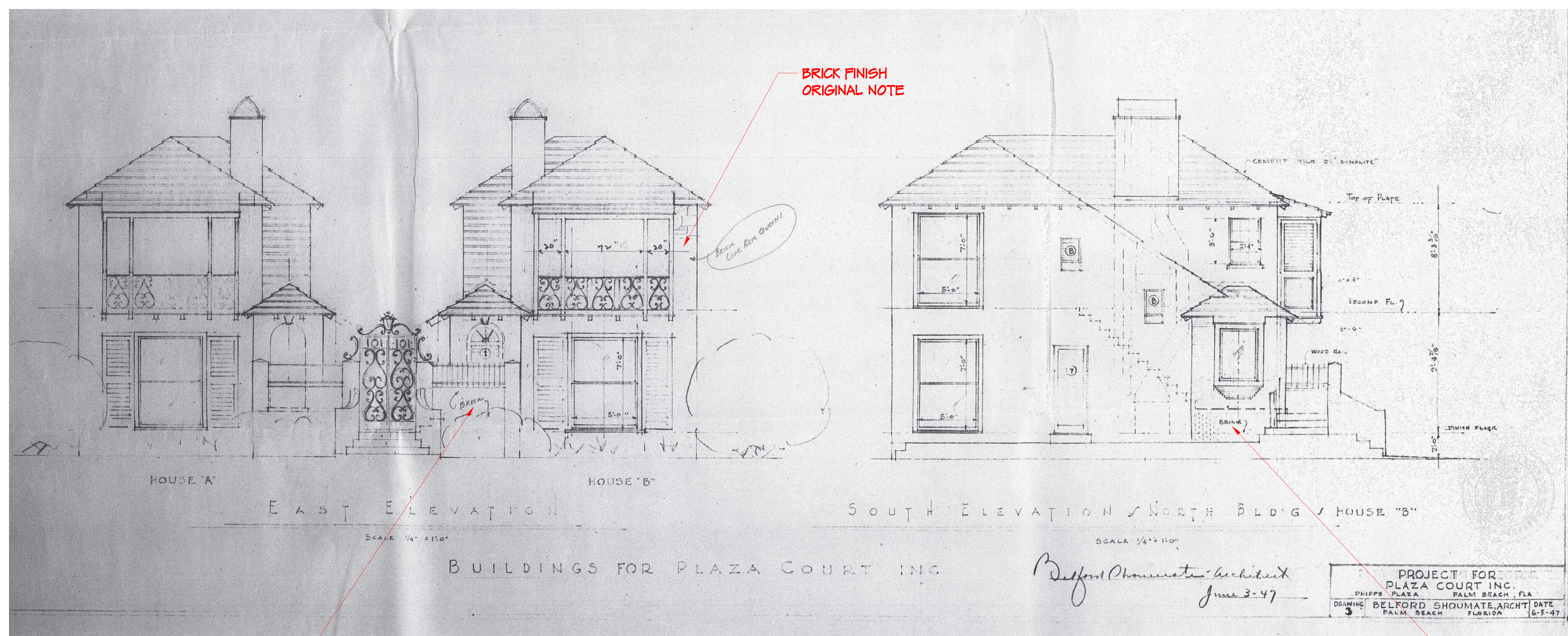

BRICK FINISH ORIGINAL NOTE

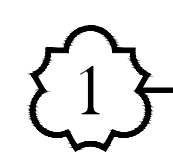

BELFORD SHOUMATE ORIGINAL EAST FRONT FACADE AND INTERIOR FACADE
N.T.S.

BRICK FINISH ORIGINAL NOTE

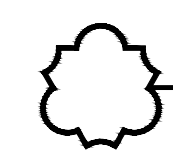

HISTORICAL DOCUMENTS
N.T.S.



1

EXISTING 1996 WEST ELEVATION AND PLANS
N.T.S.



2

PROPOSED 1996 WEST ELEVATION AND PLANS
N.T.S.

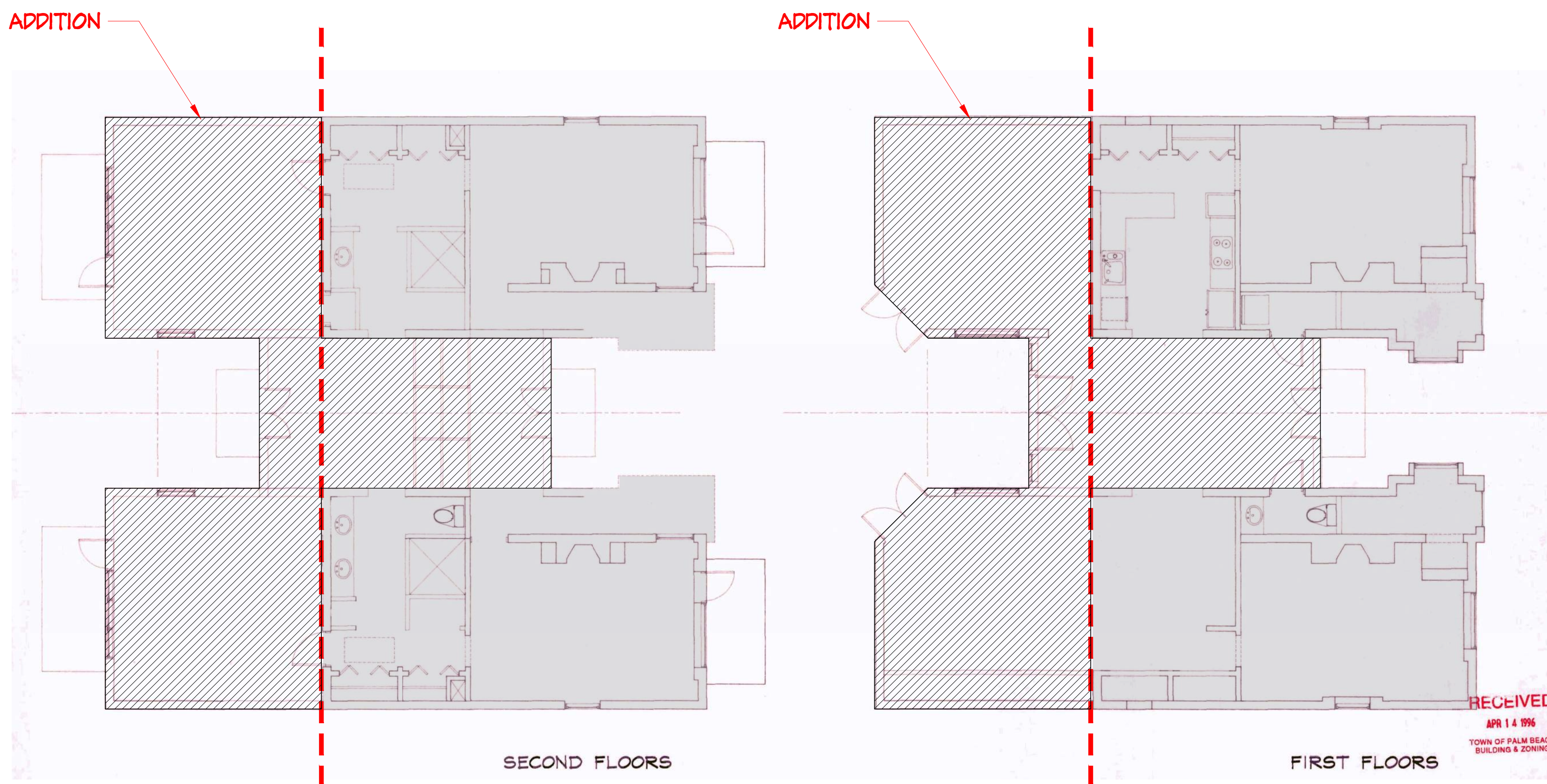

5

1996 ALTERATIONS
N.T.S.



1 EAST FACADE



2 INTERNAL ENTRY FACADE



3 INTERNAL ENTRY FACADE



4 EAST FACADE

PICTURES OF EXISTING CONDITIONS BRICK INLAY AT FRONT AND INTERNAL FACADES
N.T.S.

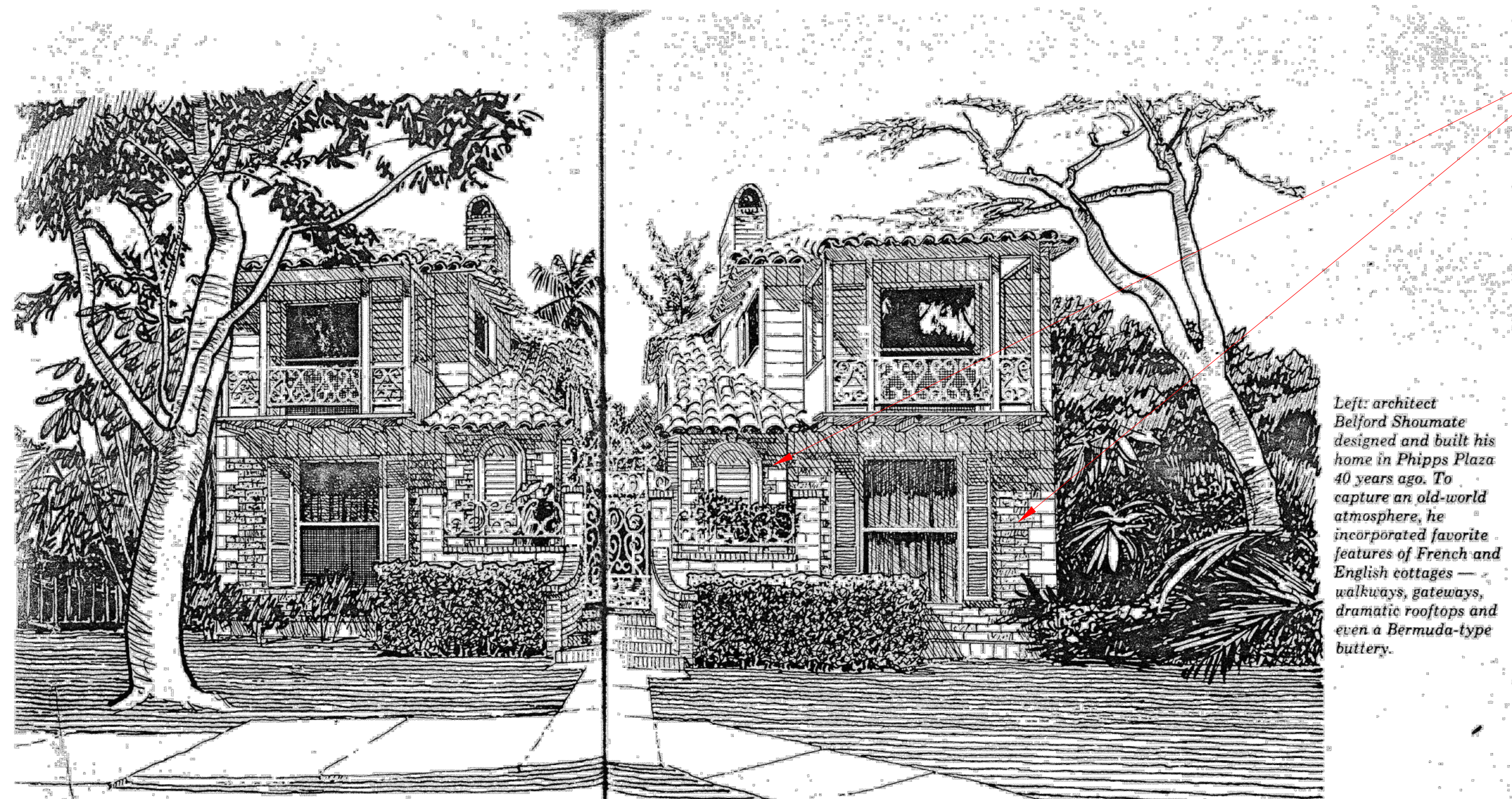

Left: architect Belford Shoumate designed and built his home in Phipps Plaza 40 years ago. To capture an old-world atmosphere, he incorporated favorite features of French and English cottages — walkways, gateways, dramatic rooftops and even a Bermuda-type buttery.

PHOTOS BY STEPHEN LEEK AND KIM SARGENT ILLUSTRATIONS BY STAN SHARP

most beautiful mans and stately rable area. is its architect- Wveth, Joseph

resident ever since. She has combed the area, finding for Palm Beach Life the "best of the best." She discovered the most attractive windows, doorways, archways, gateways, rooftops and various bits of ornamentation. Although some of the most fabulous mansions were built in Washington — the only national non-profit organization chartered by Congress to encourage public participation in the preservation of architecturally and historically significant

BRICK INLAY ON BELFORD SHOUMATE'S HOME

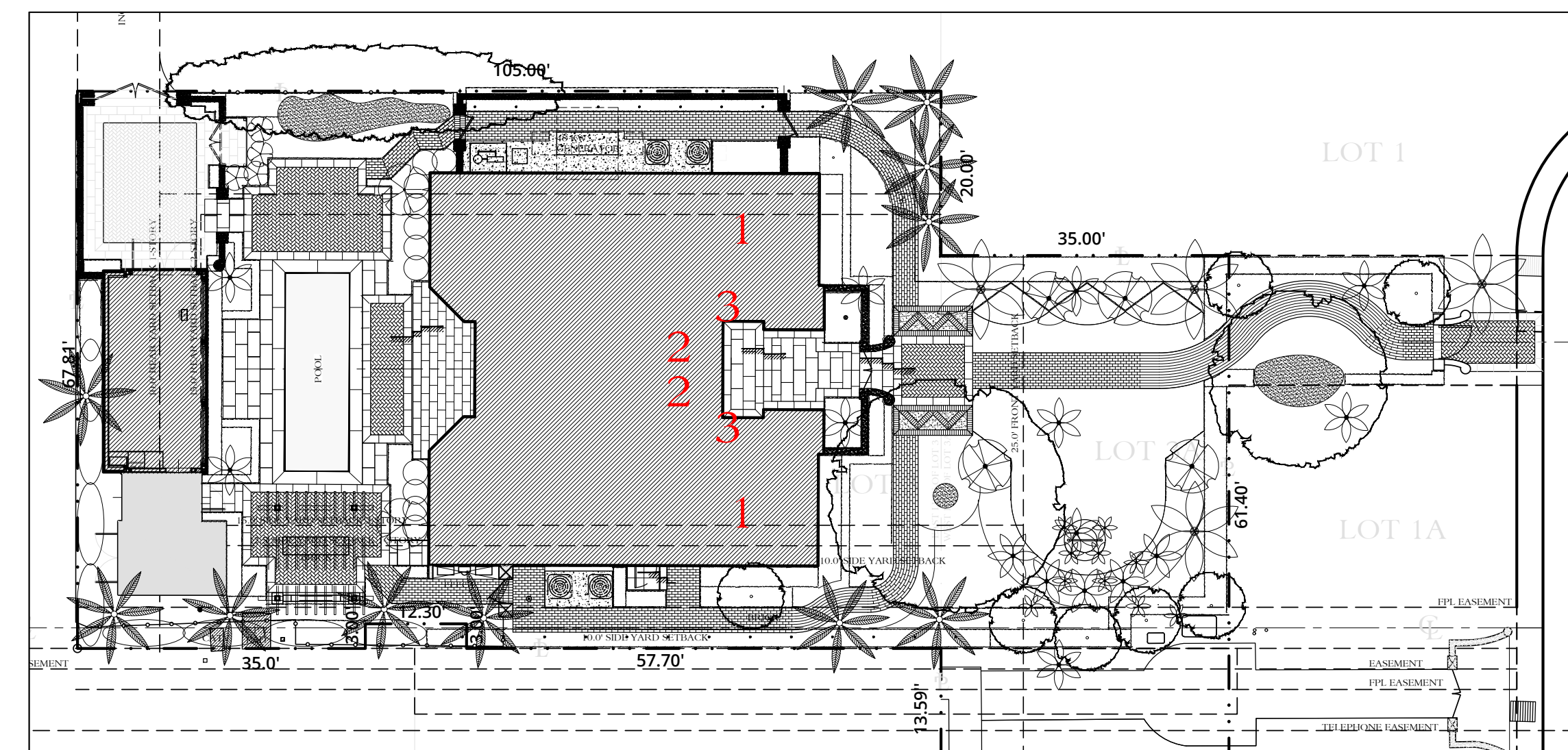

LOCATION PLAN
N.T.S.

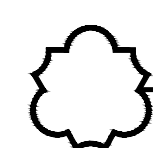

EXISTING REAR ELEVATION
N.T.S.



PATRICK RYAN
O'CONNELL
ARCHITECT

PATRICK RYAN O'CONNELL
ARCHITECT, LLC.
400 ROYAL PALM WAY, SUITE 206
PALM BEACH FL 33480
FL LIC #: AA26003685
tel (561)-331-2048 WWW.PROARCHITECT.COM

PROPOSED RENOVATIONS TO:

PHIPPS PLAZA
218 PHIPPS PLAZA
PALM BEACH, FL 33480

Project #: 22-004
Drawn by: PRO, AR, NS
Date(s):
21 FEB. 2023 - PERMIT SET 1
15 JULY 2023 - STAFF APPROVAL
16 OCT. 2023 - STAFF APPROVAL
ACCESSORY STRUCTURE
NOV. 2023 - STAFF APPROVAL
HARDSCAPE/LANDSCAPE
DEC. 2023 - PERMIT REVISION
SEPT 23, 2024 - 2ND SUBMITTAL BRICK
INLAY

COA #: 24-0023

SEAL

PATRICK RYAN O'CONNELL
PROFESSIONAL CERTIFICATION
"I certify that these documents were prepared
or approved by me, and that I am a duly
licensed architect under the laws of the State
of Florida, license #A039461,
exp. date 28 February 2025."

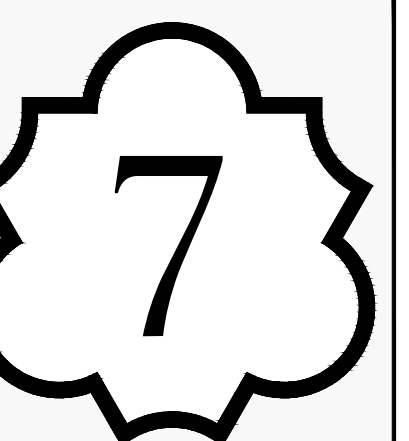



1 PREVIOUSLY LPC APPROVED WEST ELEVATION
1/4" = 1'-0"



2 PROPOSED WEST ELEVATION
1/4" = 1'-0"

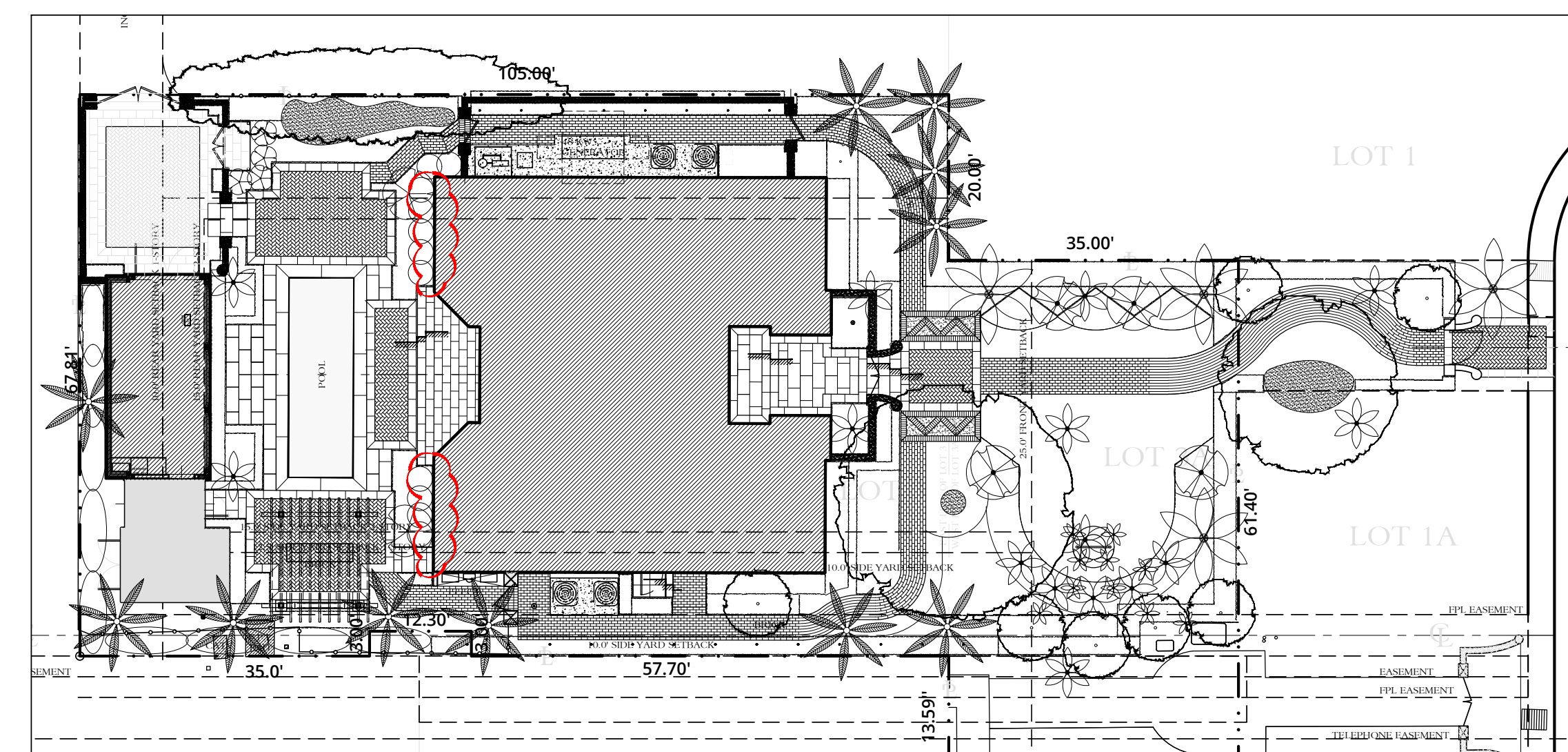

LOCATION PLAN
N.T.S.



PATRICK RYAN
O'CONNELL
ARCHITECT

PATRICK RYAN O'CONNELL
ARCHITECT, LLC.

400 ROYAL PALM WAY, SUITE 206
PALM BEACH FL 33480
FL LIC #: AA26003685
tel (561)-331-2048 WWW.PROARCHITECT.COM

PROPOSED RENOVATIONS TO:

PHIPPS PLAZA
218 PHIPPS PLAZA
PALM BEACH, FL 33480

Project #: 22-004
Drawn by: PRO, AR, NS
Date(s):
21 FEB. 2023 - PERMIT SET 1
15 JULY, 2023 - STAFF APPROVAL
16 OCT. 2023 - STAFF APPROVAL
ACCESSORY STRUCTURE
NOV. 2023 - STAFF APPROVAL
HARDSCAPE/LANDSCAPE
DEC. 2023 - PERMIT REVISION
SEPT 23, 2024 - 2ND SUBMITTAL BRICK
INLAY

COA #: 24-0023

SEAL

PATRICK RYAN O'CONNELL
PROFESSIONAL CERTIFICATION:
"I certify that these documents were prepared
or approved by me, and that I am a duly
licensed architect under the laws of the State
of Florida, license #AR98461,
exp. date 28 February 2025."

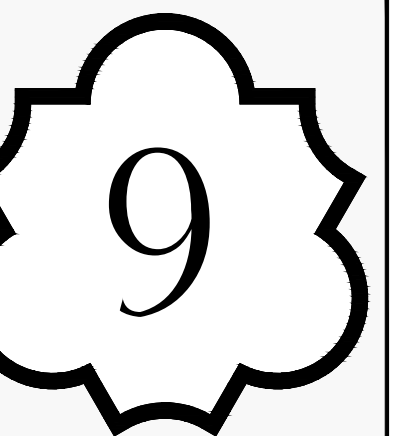

COPYRIGHT © 2024



PROPOSED COLORED WEST ELEVATION WITH BRICK INLAY
N.T.S.