

APPROVED SITE PLAN: FEBRUARY 2023

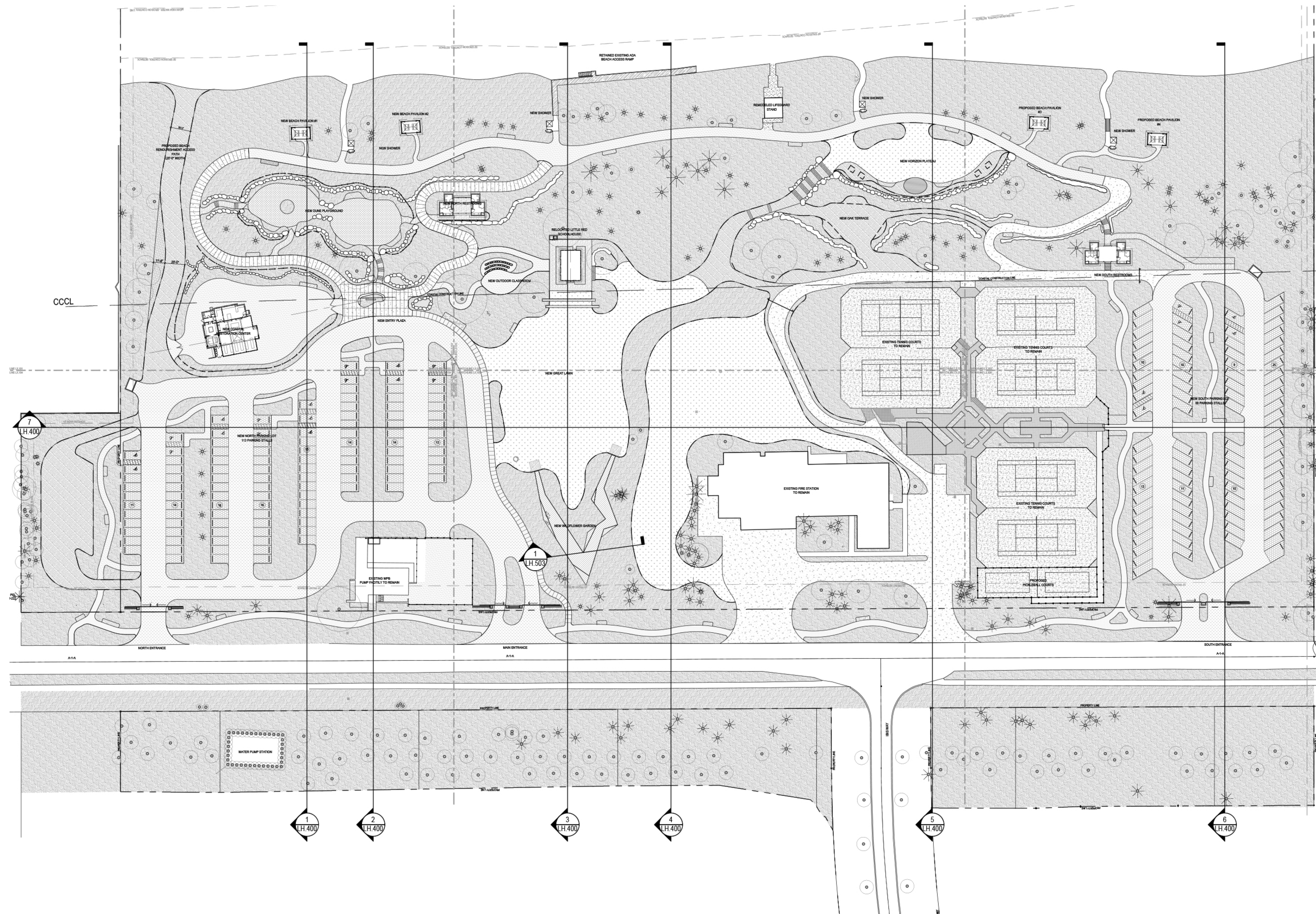

PROGRAM ELEMENTS REMOVED FROM APPROVED SITE PLAN

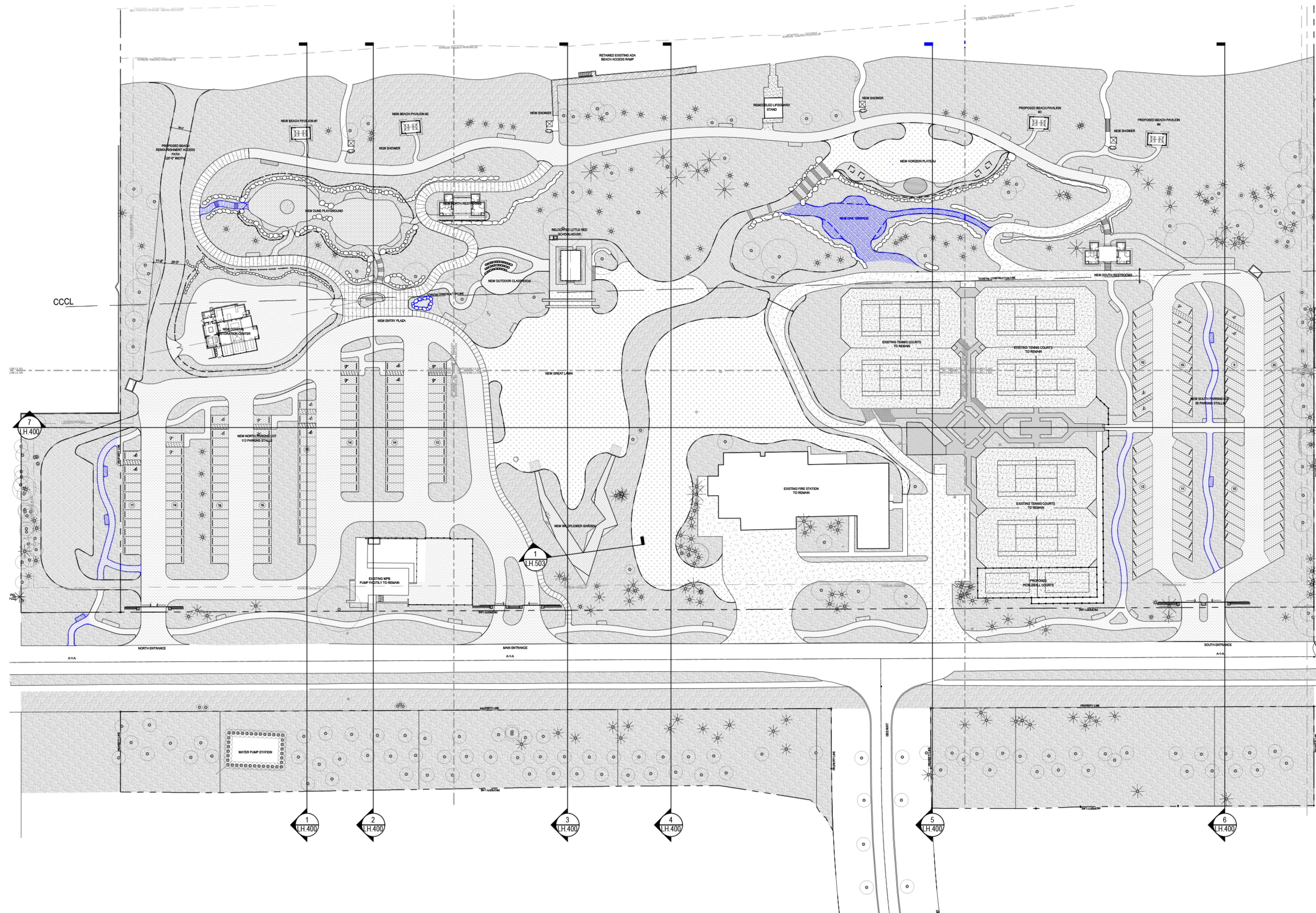

- North entry to playground removed
- Water feature basin removed (one of two)
- Interior walkways removed to accommodate stormwater treatment.
- Oak Terrace removed
- Sidewalk connection across A1A removed (to be completed under separate FDOT project)

90% SITE PLAN: DECEMBER 2023

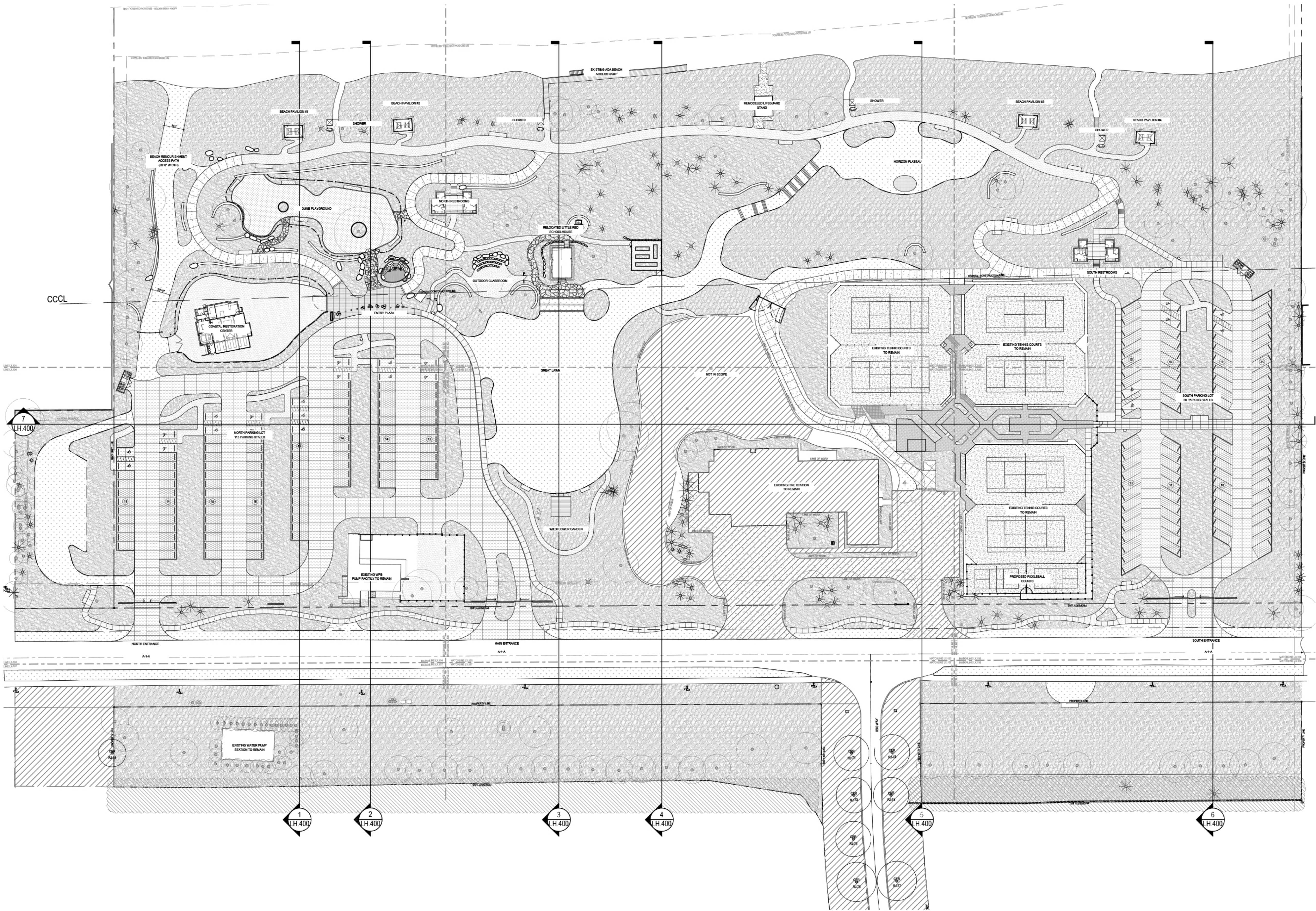

MODIFIED PROGRAM ELEMENTS FROM APPROVED SITE PLAN

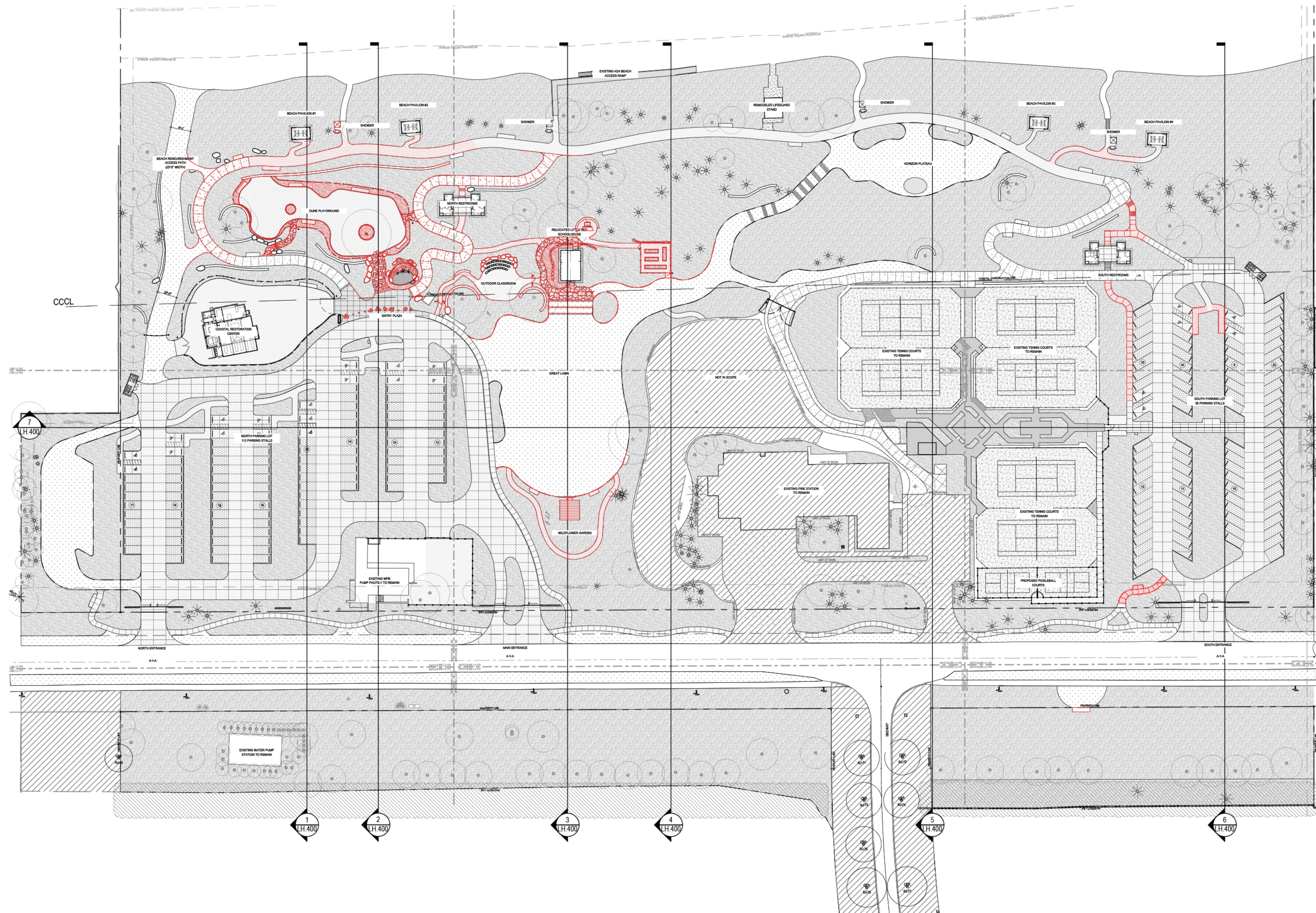

- Playground extents massaged
- Outdoor educational garden added
- 'Out-house' A/C structure relocated due to grading modifications.
- Bollards and seating boulders added to entry plaza
- Wildflower garden pathway and overlook added.
- Pathways modified to accommodate ADA accessibility including: dune crest approach, outdoor classroom approach, access to beach pavilions, outdoor classroom and LRS access, south restroom building access, ADA parking access.
- Pathways modified to accommodate stormwater treatment: South parking walkway from tennis center to south restroom building and south parking to R/W sidewalk.