

RECEIVED
By Antonette Fabrizi at 3:49 pm, Mar 14, 2023



Scope of Work

- * Demolition of Existing Front Path
- * New Hardscape for Front Path & Pool Deck
- * Minor Landscape Improvements

Private Residence
250 Pendleton Lane

F L O R I D A

Application #:
ARC-23-046

Date of Presentation:
04.26.2023

Sheet Index

Cover Sheet
Survey

- L1.0 - Existing Vegetation Inventory & Action Plan
 - L1.1 - Existing Site Photos
- L2.0 - Demolition and Vegetation Action Plan
- L3.0 - Construction Staging Plan
- L4.0 - Truck Logistics Plan
- L5.0 - Site Plan
 - L5.1 - Site Calculation/Lot Coverage Graphics
- L6.0 - Landscape Plan
 - L6.1 - Landscape Schedule
 - L6.2 - Planting Details & Specifications

Design Team/Consultants

Landscape Architects
ENVIRONMENT DESIGN GROUP
139 NORTH COUNTY ROAD SUITE 20B
PALM BEACH, FL 33480
561.832.4600
WWW.ENVIRONMENTDESIGNGROUP.COM

Private Residence
250 Pendleton
Palm Beach

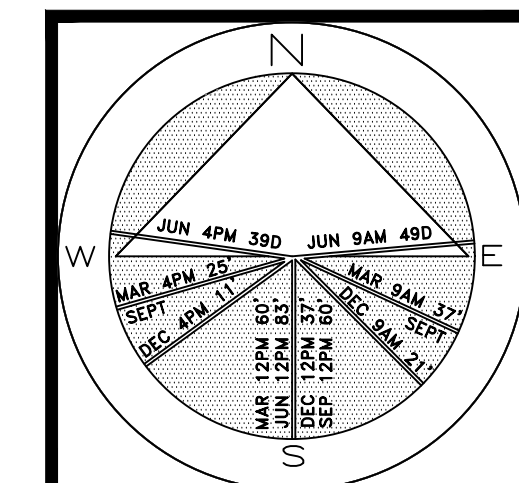

JOB NUMBER: # xxxxx.00 LA
DRAWN BY: Lauren Freeman
DATE: 02.09.2023
02.27.2023
03.14.2023

SHEET L1.0

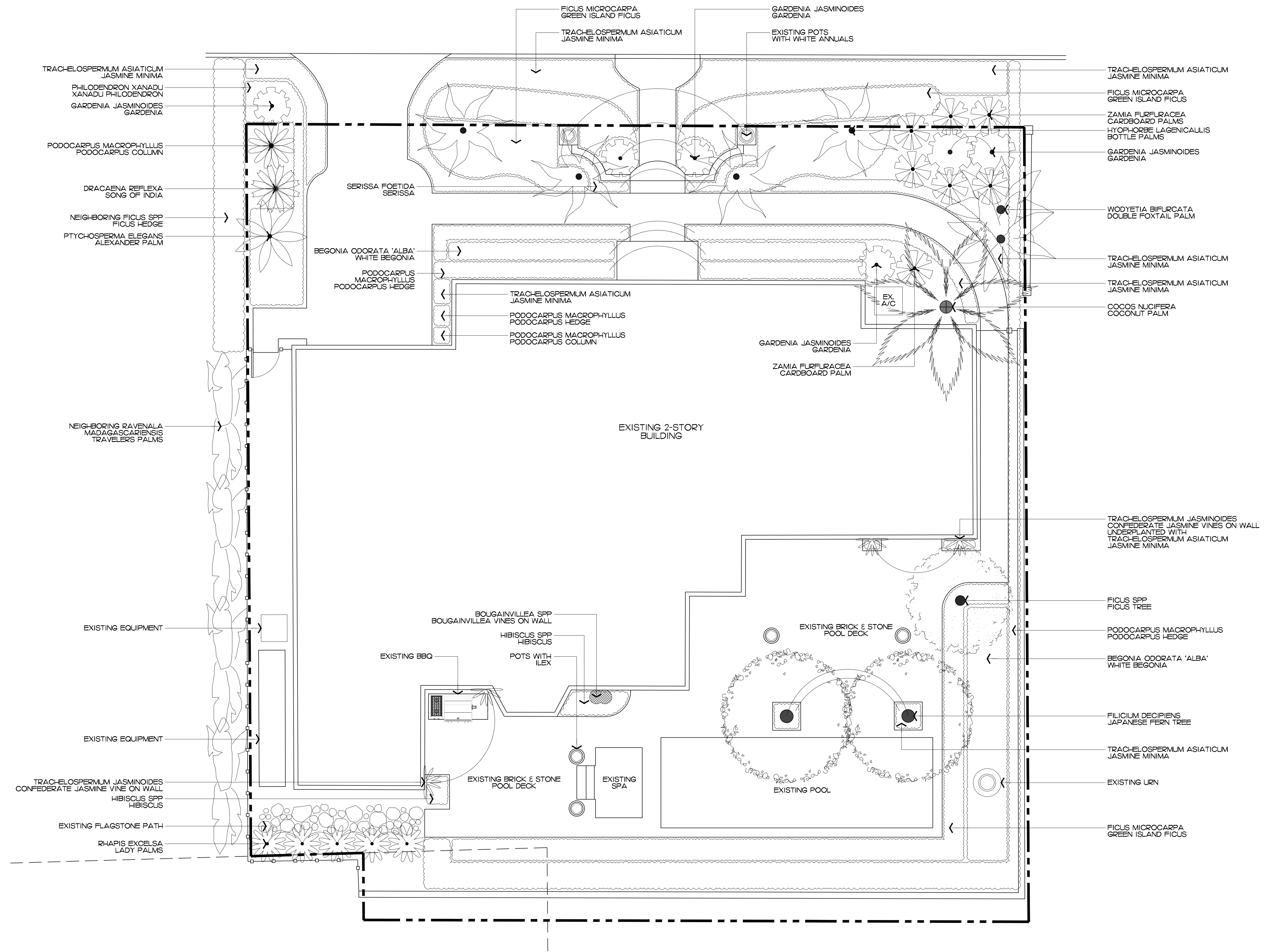

2023
COPYRIGHT: The following drawings are instruments of service to the Landscape Architect. They are not products of design. All ideas, designs, arrangements and plans indicated or represented by this/these drawings are owned by and the property of the designer, and were created, evolved and developed for use on and in connection with this project. None of such ideas, designs, arrangements or plans shall be used by or disclosed to any person, firm or corporation without the written permission of the Landscape Architect.

2023
DISCLAIMER: Construction, as the term is generally understood, and that ENVIRONMENT DESIGN GROUP does not provide landscape architectural services during construction, including on-site monitoring, site visits, shop drawing review, design clarification, etc., the client agrees to indemnify and hold harmless ENVIRONMENT DESIGN GROUP from any liability arising from, acts or omissions in the performance of said services during construction by the client, and his/her agents, employees, or subcontractors.

48 HOURS BEFORE DIGGING
CALL TOLL FREE
1-800-432-4770
SUNSHINE STATE ONE CALL
OF FLORIDA, INC.

ARC-23-046
Existing Vegetation Inventory & Action Plan
SCALE IN FEET: 3/16"=1'-0"



Existing View to Front



Existing View to Front



Existing View West Path



Existing View to Pool Garden

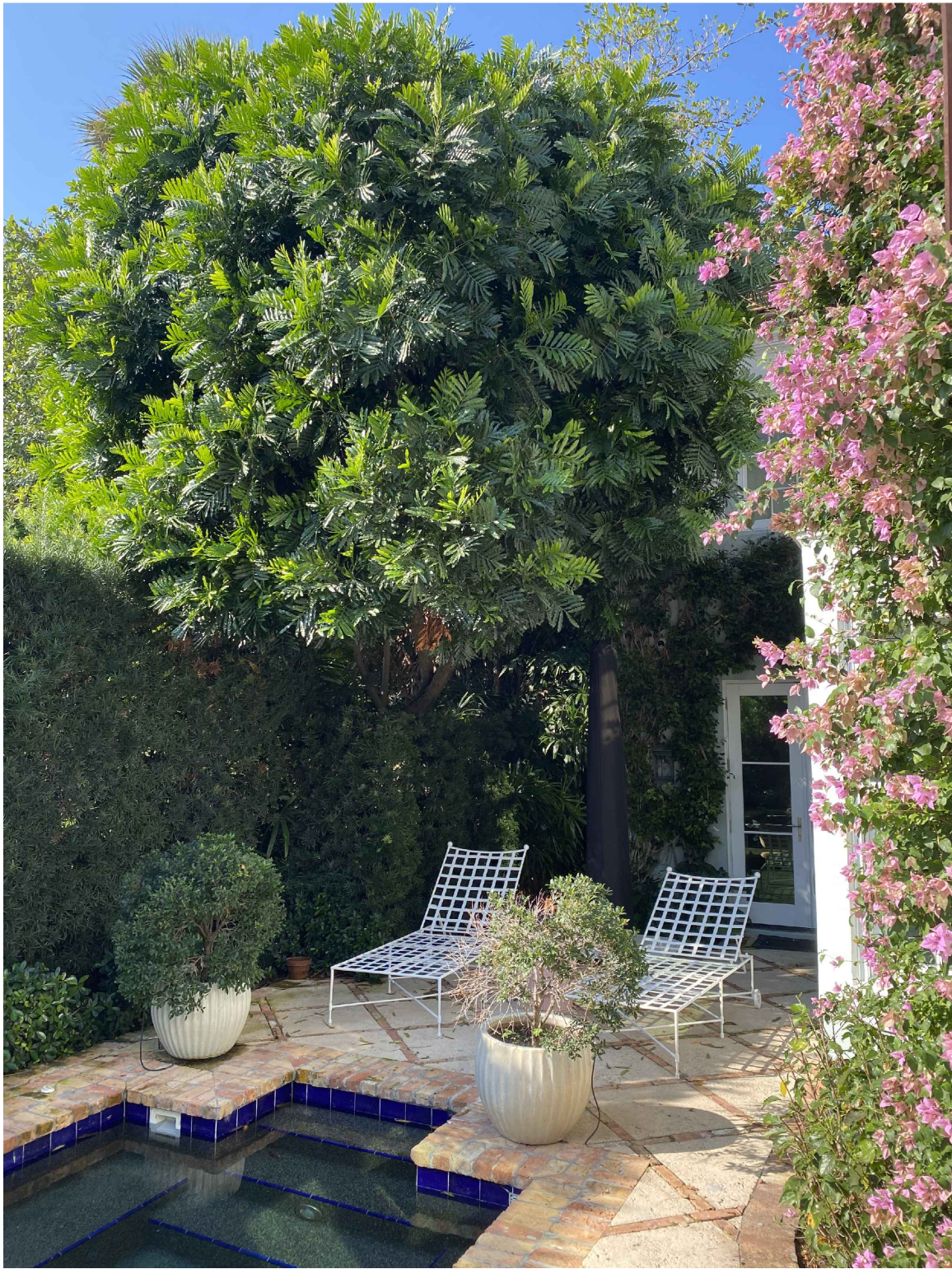

Existing View to Pool Garden



Existing View North Path



Existing View West Equipment Yard

ENVIRONMENT
DESIGN
GROUP

139 North County Road 5420-8 Palm Beach, FL 33480

Phone: 561.832.4600 Mobile: 561.313.4424

Landscape Architecture

Land Planning

Landscape Management

Dustin M. Mizell, M.L.A. P.L.A. #6666784

Dustin@environmentdesigngroup.com

Private Residence
250 Pendleton
Palm Beach

E
N
V
I
R
O
N
M
E
N
T
D
E
S
I
G
N
G
R
O
U
P

COPYRIGHT: 2023

The following drawings are instruments of service to the Landscape Architect. They are not products of design. All ideas, designs, arrangements and plans indicated or represented by this/these drawings are owned by and the property of the designer, and were created, evolved and developed for use on and in connection with this project. None of such ideas, designs, arrangements or plans shall be used by or disclosed to any person, firm or corporation without the written permission of the Landscape Architect.

DISCLAIMER: 2023

Construction, as the term is generally understood, and that ENVIRONMENT DESIGN GROUP does not provide landscape architectural services during construction, including on-site monitoring, site visits, shop drawing review, design clarification, etc., the client agrees to indemnify and hold harmless ENVIRONMENT DESIGN GROUP from any liability arising from, acts or omissions in the performance of said services during construction by the client, and his/her agents, employees, or subcontractors.

48 HOURS BEFORE DIGGING

CALL TOLL FREE

1-800-432-4770

SUNSHINE STATE ONE CALL

OF FLORIDA, INC.

ARC-23-046

Existing Site Photos

SHEET L1.1

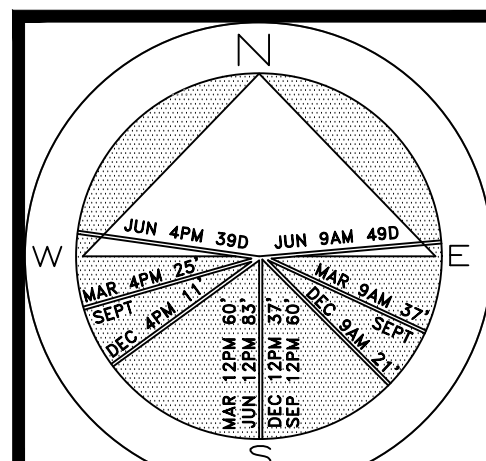

SHEET L2.0

Private Residence
250 Pendleton Ave
Palm Beach

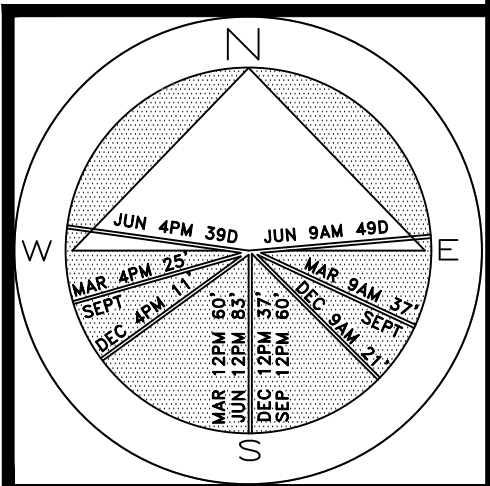

JOB NUMBER: # 22013.00 LA
DRAWN BY: Alex Bugrii
DATE: 02.09.2023
02.27.2023

SHEET L3.0

64 sq. ft.

AREA IN SQ. FT.

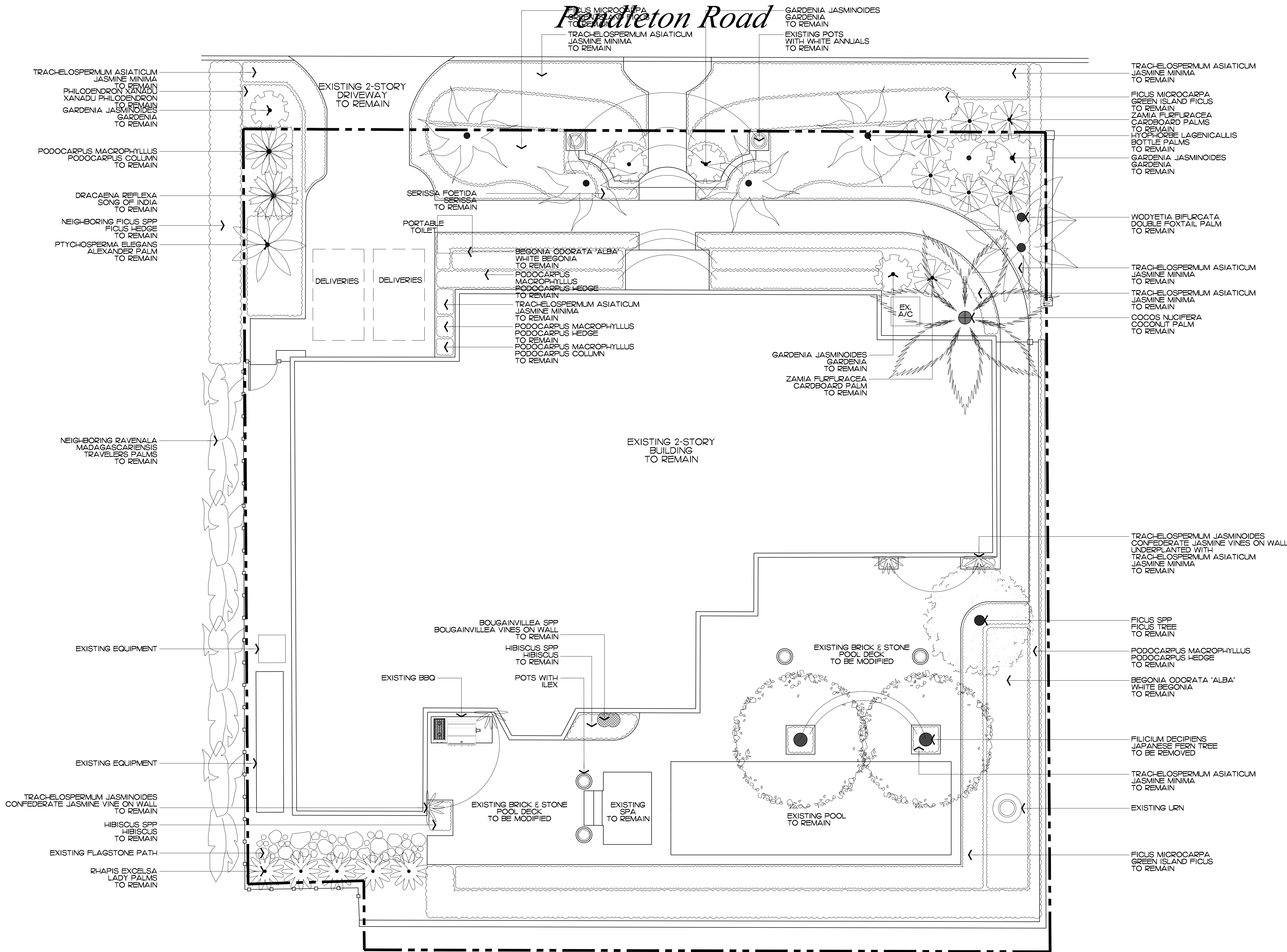

COPYRIGHT: 2023
The following drawings are instruments of service to the Landscape Architect. They are not products of design. All ideas, designs, arrangements and plans indicated or represented by this/these drawings are owned by and the property of the designer, and were created, evolved and developed for use on and in connection with this project. None of such ideas, designs, arrangements or plans shall be used by or disclosed to any person, firm or corporation without the written permission of the Landscape Architect.

DISCLAIMER: 2023
Construction, as the term is generally understood, and that ENVIRONMENTAL DESIGN GROUP does not provide landscape architectural services during construction, including on-site monitoring, site visits, shop drawing review, design clarification, etc., the client agrees to indemnify and hold harmless ENVIRONMENTAL DESIGN GROUP from any liability arising from, acts or omissions in the performance of said services during construction by the client, and his/her agents, employees, or subcontractors.

48 HOURS BEFORE DIGGING
CALL TOLL FREE
1-800-432-4770
SUNSHINE STATE ONE CALL
OF FLORIDA, INC.

ARC-23-046
Construction Staging Plan
SCALE IN FEET 0' 8' 16' 24'

Private Residence
250 Pendleton Ave
Palm Beach

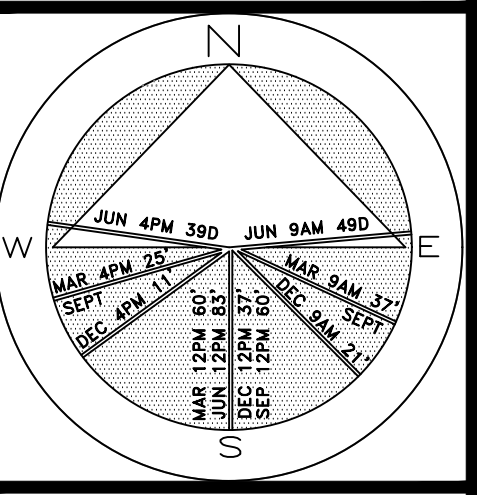

JOB NUMBER: # xxxxx-00 LA
DRAWN BY: Lauren Freeman
DATE: 02.09.2023
02.27.2023

SHEET L4.0

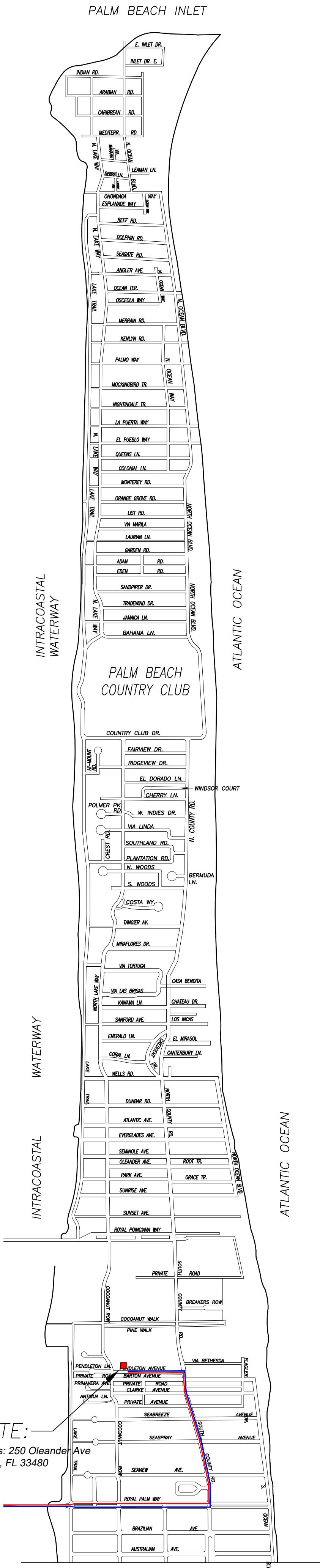

CONCEPTUAL CONSTRUCTION SCHEDULE	
• APRIL 26TH 2023 – ARCOM MEETING	
• JUL–AUG 2023 – SUBMIT FOR PERMIT	
• 1 MONTH –SEPT 2023	– MOBILIZATION & DEMOLITION
• 1–2 MONTHS	– SITE/BUILDING PREPARATION
• 4 MONTHS	– FRONT FACADE IMPROVEMENTS
• 1–2 MONTHS	– FINISHES
• 2 MONTHS	– LANDSCAPE & HARDSCAPE INSTALLATION
• 1–2 MONTHS	– FINAL INSPECTIONS
• +/-10 MONTHS	– PROPOSED TOTAL CONSTRUCTION FOLLOWING BUILDING PERMIT

1 PROPOSED TRUCK INGRESS / EGRESS ROUTES MAP

LARGEST TRUCK ->
10-15 DUMP TRUCKS FOR DEBRIS REMOVAL
TRAILER FOR EXCAVATOR / DEMOLITION
LANDSCAPE TRUCKS ->
SOD
IRRIGATION

NOTE: SEE SEPARATE "CONSTRUCTION STAGING PLAN" SHEET FOR INFORMATION ON LOCATIONS FOR PARKING, MATERIAL STORAGE, DELIVERIES, DUMPSTER, PORTABLE TOILETS, TIRE CLEANING AREA, SILT FENCE, ETC.

- PROPOSED INGRESS TRUCK ROUTE
- PROPOSED EGRESS TRUCK ROUTE

COPYRIGHT: 2023
The following drawings are instruments of service to the Landscape Architect. They are not products of design. All ideas, designs, arrangements and plans indicated or represented by this/these drawings are owned by and the property of the designer, and were created, evolved and developed for use on and in connection with this project. None of such ideas, designs, arrangements or plans shall be used by or disclosed to any person, firm or corporation without the written permission of the Landscape Architect.

DISCLAIMER: 2023
Construction, as the term is generally understood, and that ENVIRONMENT DESIGN GROUP does not provide landscape architectural services during construction, including on-site monitoring, site visits, shop drawing review, design clarification, etc., the client agrees to indemnify and hold harmless ENVIRONMENT DESIGN GROUP from any liability arising from, acts or omissions in the performance of said services during construction by the client, and his/her agents, employees, or subcontractors.

48 HOURS BEFORE DIGGING
CALL TOLL FREE
1-800-432-4770
SUNSHINE STATE ONE CALL
OF FLORIDA, INC.

ARC-23-046
Truck Logistics Plan
SCALE: NOT TO SCALE

Pendleton Road

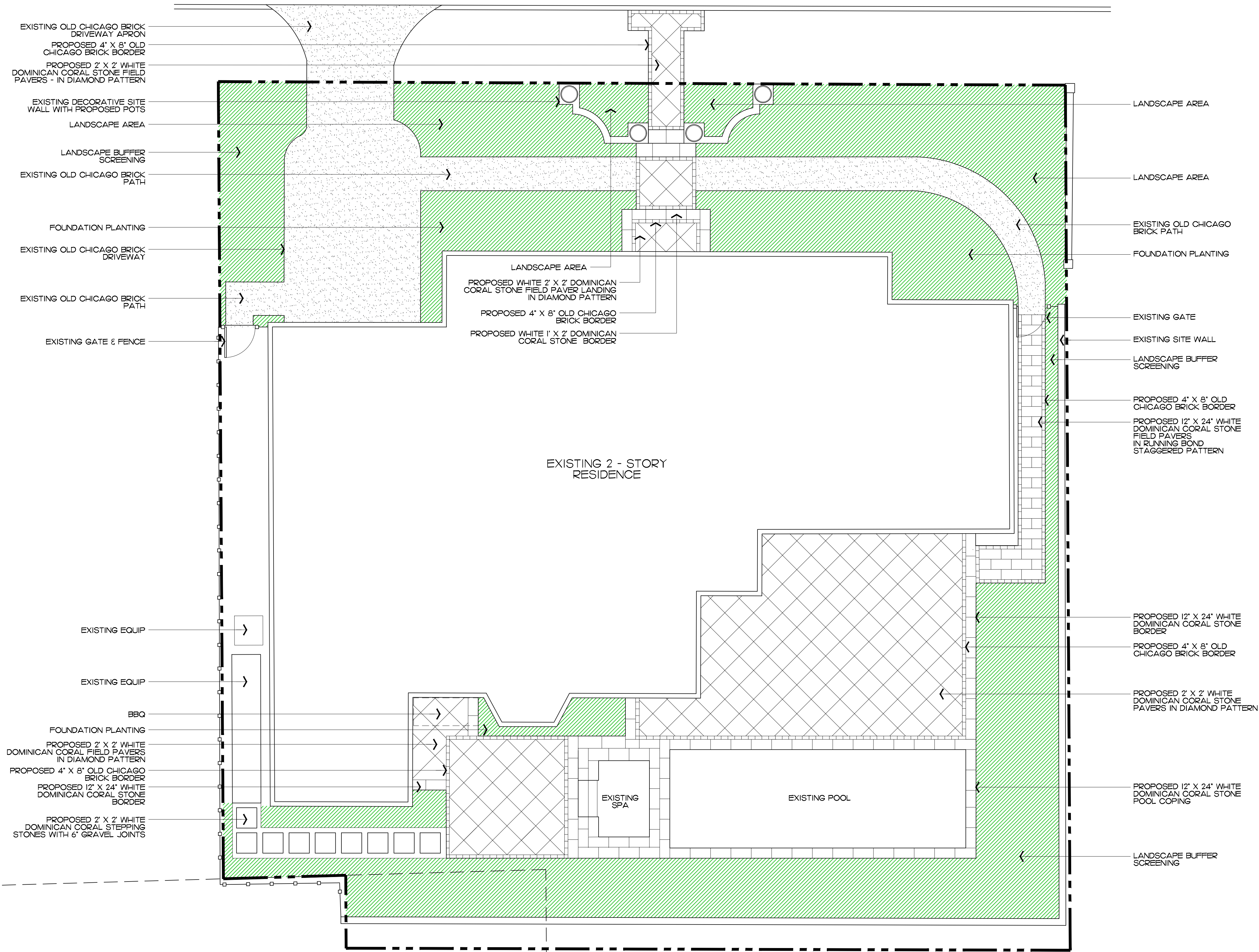

Proposed Site Data

DESCRIPTION	REQUIRED	EXISTING	PROPOSED
LOT ZONE		R-B - LOW DENSITY RESIDENTIAL	R-B - LOW DENSITY RESIDENTIAL
LOT AREA	10,000 S.F. MINIMUM	6,984 S.F.	6,984 S.F.
OPEN / PERMEABLE SPACE	MINIMUM 45%	3,142.8 S.F.	2,154 S.F.
FRONT YARD LANDSCAPE	MINIMUM 40% OF FRONT YARD	836.8 S.F.	988 S.F.
PERIMETER LANDSCAPE WITHIN 10' OF PROPERTY LINE	MINIMUM 50% OF REQ'D OPEN SPACE	1,571.4 S.F.	1,889 S.F.

ARC-23-046
Site Plan
SCALE IN FEET 0' 8' 16' 24'

ENVIRONMENT
DESIGN
GROUP

139 North County Road 5920-8 Palm Beach, FL 33480
Phone: 561.832.4600 Mobile: 561.313.4424

Landscape Architecture
Land Planning
Landscape Management

Dustin M. Mizell, M.L.A. P.L.A. #6666784
Dustin@environmentdesigngroup.com

Private Residence
250 Pendleton
Palm Beach

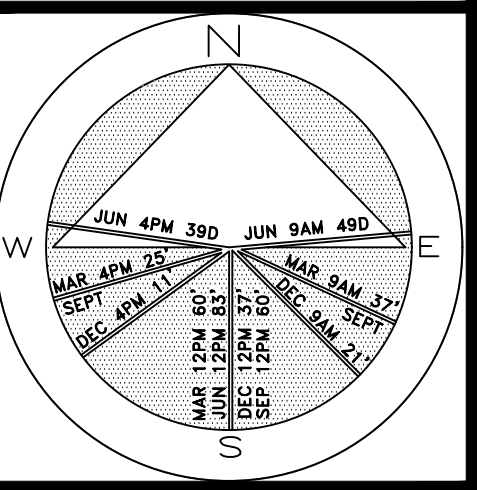

JOB NUMBER: # xxxxx-00 LA
DRAWN BY: Lauren Freeman
DATE: 01.23.2023
02.09.2023
02.27.2023

SHEET L5.0

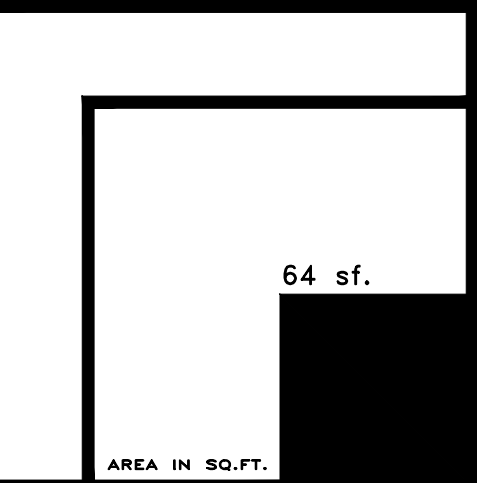

2023

COPYRIGHT:
The following drawings are instruments of service to the Landscape Architect. They are not products of design. All ideas, designs, arrangements and plans indicated or represented by this/these drawings are owned by and the property of the designer, and were created, evolved and developed for use on and in connection with this project. None of such ideas, designs, arrangements or plans shall be used by or disclosed to any person, firm or corporation without the written permission of the Landscape Architect.

2023

DISCLAIMER:
Construction, as the term is generally understood, and that ENVIRONMENT DESIGN GROUP does not provide landscape architectural services during construction, including on-site monitoring, site visits, shop drawing review, design clarification, etc., the client agrees to indemnify and hold harmless ENVIRONMENT DESIGN GROUP from any liability arising from, acts or omissions in the performance of said services during construction by the client, and his/her agents, employees, or subcontractors.

48 HOURS BEFORE DIGGING
CALL TOLL FREE
1-800-432-4770
SUNSHINE STATE ONE CALL
OF FLORIDA, INC.

Private Residence
250 Pendleton
Palm Beach

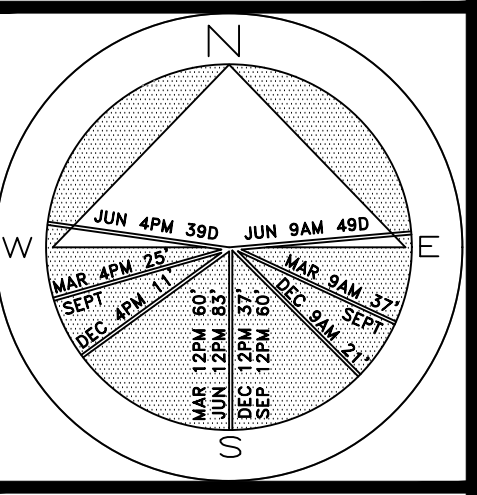

JOB NUMBER: # 22254.00 LA
DRAWN BY: Lauren Freeman
James Aparicio
DATE: 01.23.2023
02.09.2023
02.27.2023

SHEET L5.1

64 sf.
AREA IN SQ.FT.

Pendleton Road

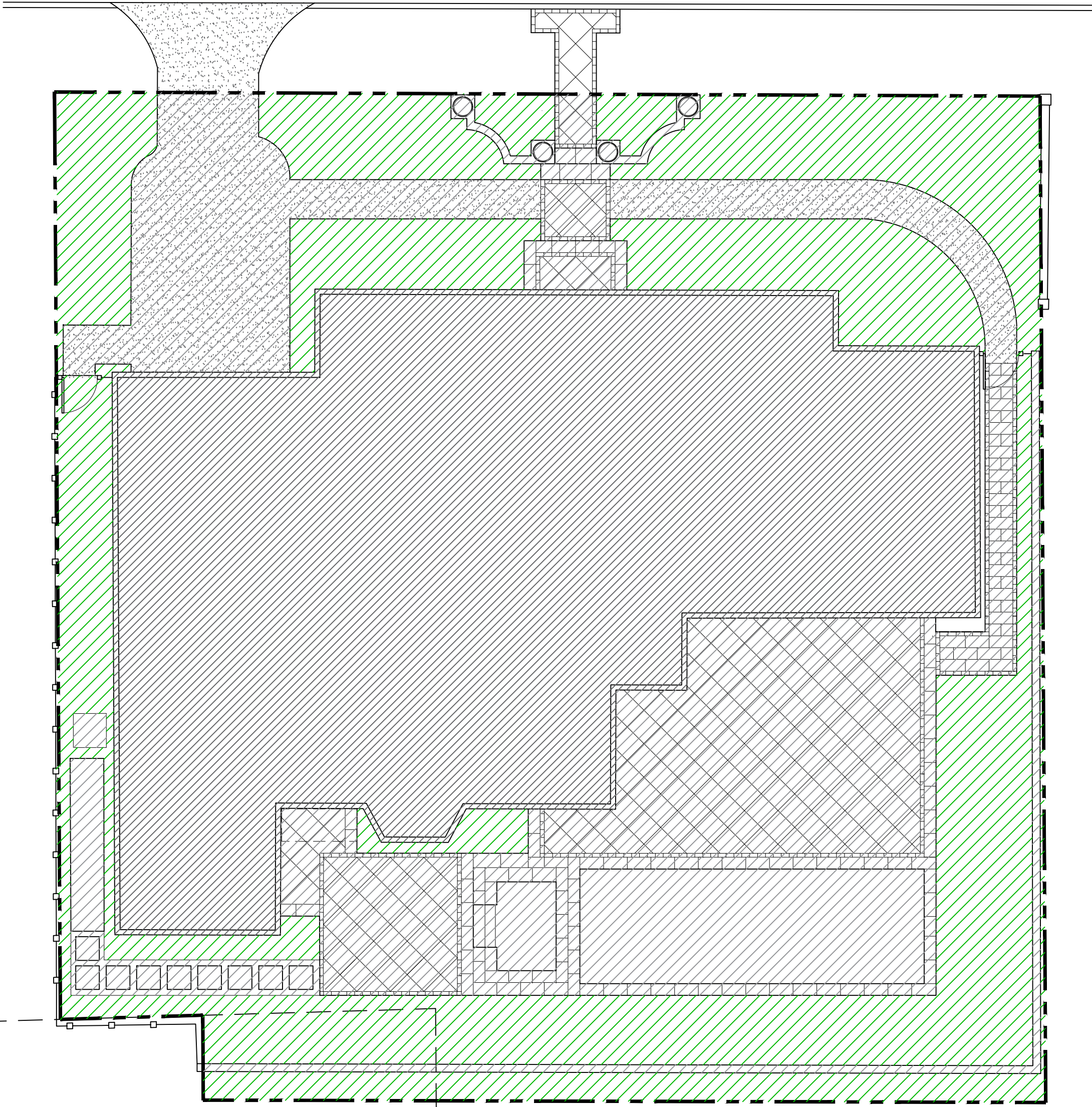

Proposed Lot Coverage Graphic

Legend

- IMPERVIOUS AREA (HOUSE/STRUCTURE)
- IMPERVIOUS AREA (HARDSCAPE)
- PERVIOUS AREA / OPEN SPACE
- PERVIOUS AREA / WATER FEATURE

Proposed Site Data

DESCRIPTION	REQUIRED	EXISTING	PROPOSED
LOT ZONE		R-B - LOW DENSITY RESIDENTIAL	R-B - LOW DENSITY RESIDENTIAL
LOT AREA	10,000 S.F. MINIMUM	6,984 S.F.	6,984 S.F.
OPEN / PERMEABLE SPACE	MINIMUM 45%	3,142.8 S.F.	2,050 S.F.
FRONT YARD LANDSCAPE	MINIMUM 40% OF FRONT YARD	836.8 S.F.	988 S.F.
PERIMETER LANDSCAPE WITHIN 10' OF PROPERTY LINE	MINIMUM 50% OF REQ'D OPEN SPACE	1,571.4 S.F.	1,889 S.F.

Existing Lot Coverage Graphic

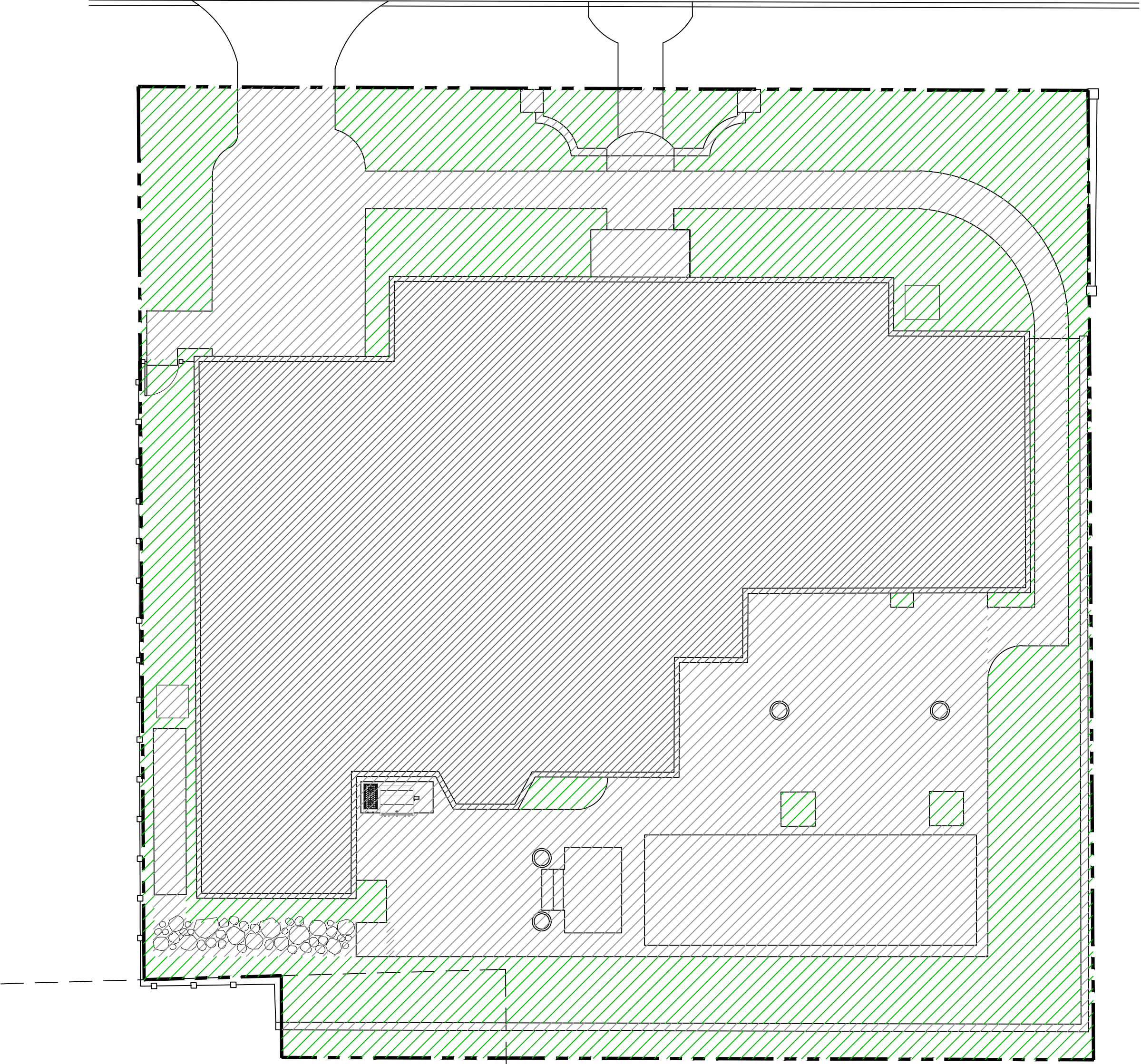

48 HOURS BEFORE DIGGING
CALL TOLL FREE
1-800-432-4770
SUNSHINE STATE ONE CALL
OF FLORIDA, INC.

SHEET L6.0

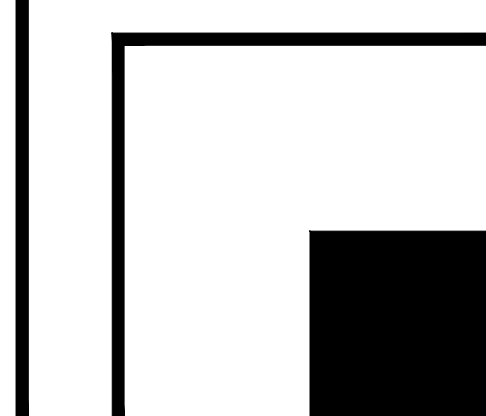

Trees

SYMBOL	PLANT NAME	QTY.	DESCRIPTION	NATIVE
	CONOCARPUS ERECTUS GREEN BUTTONWOOD TREES	11	PLEACHED, 14'-16' HT.	YES
TOTAL: NATIVE SPECIES:		11 11 (100%)		

Palms

SYMBOL	PLANT NAME	QTY.	DESCRIPTION	NATIVE
	THRINAX RADIATA FLORIDA THATCH PALM	4	12' C.T.	YES
TOTAL: NATIVE SPECIES:		4 4 (100%)		

Private Residence
250 Pendleton
Palm Beach

A

D

I

R

O

L

F

JOB NUMBER: # xxxxx-00 LA
DRAWN BY: Lauren Freeman
DATE: 02.09.2023
02.27.2023

SHEET L6.1

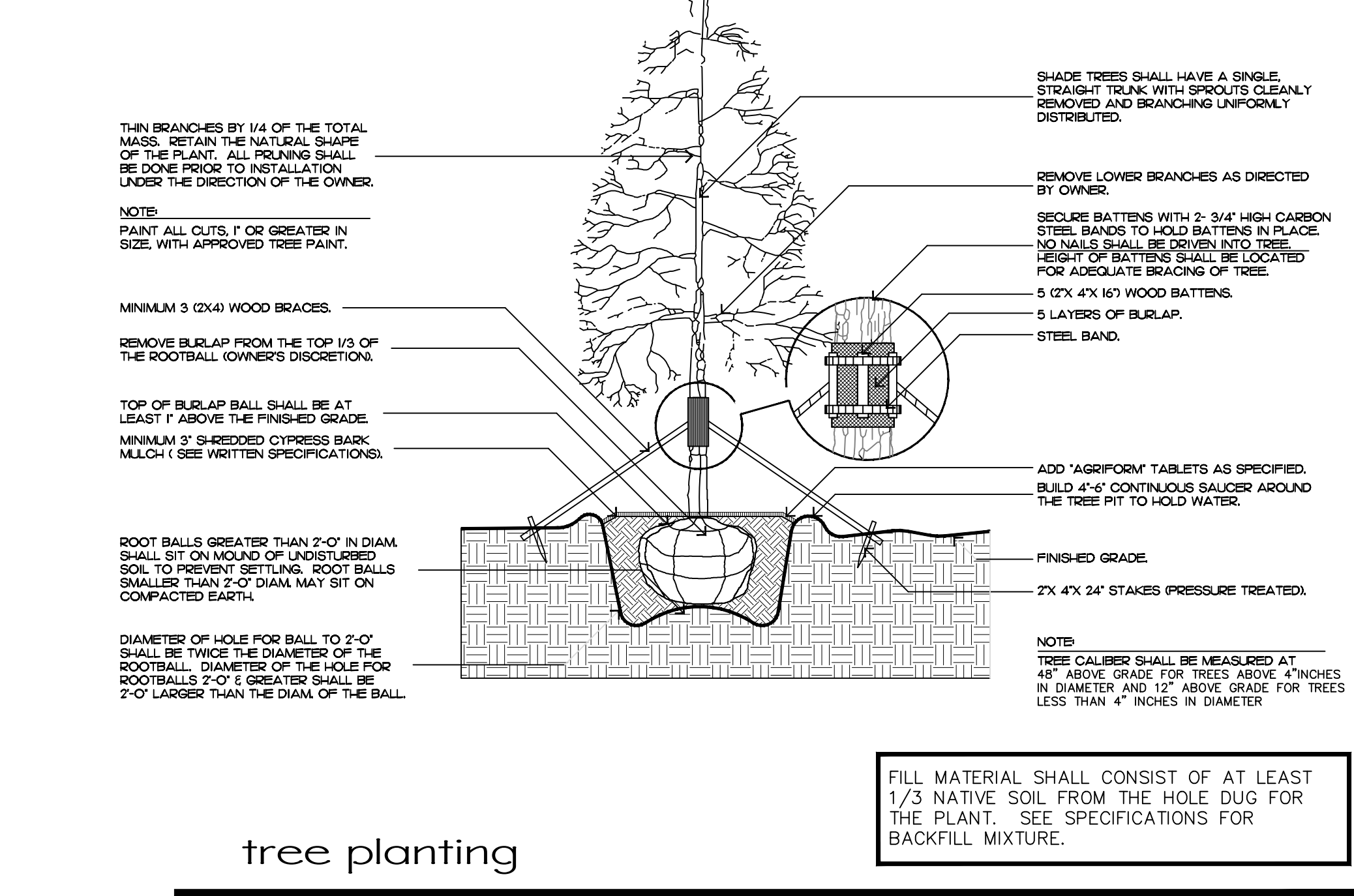

tree planting

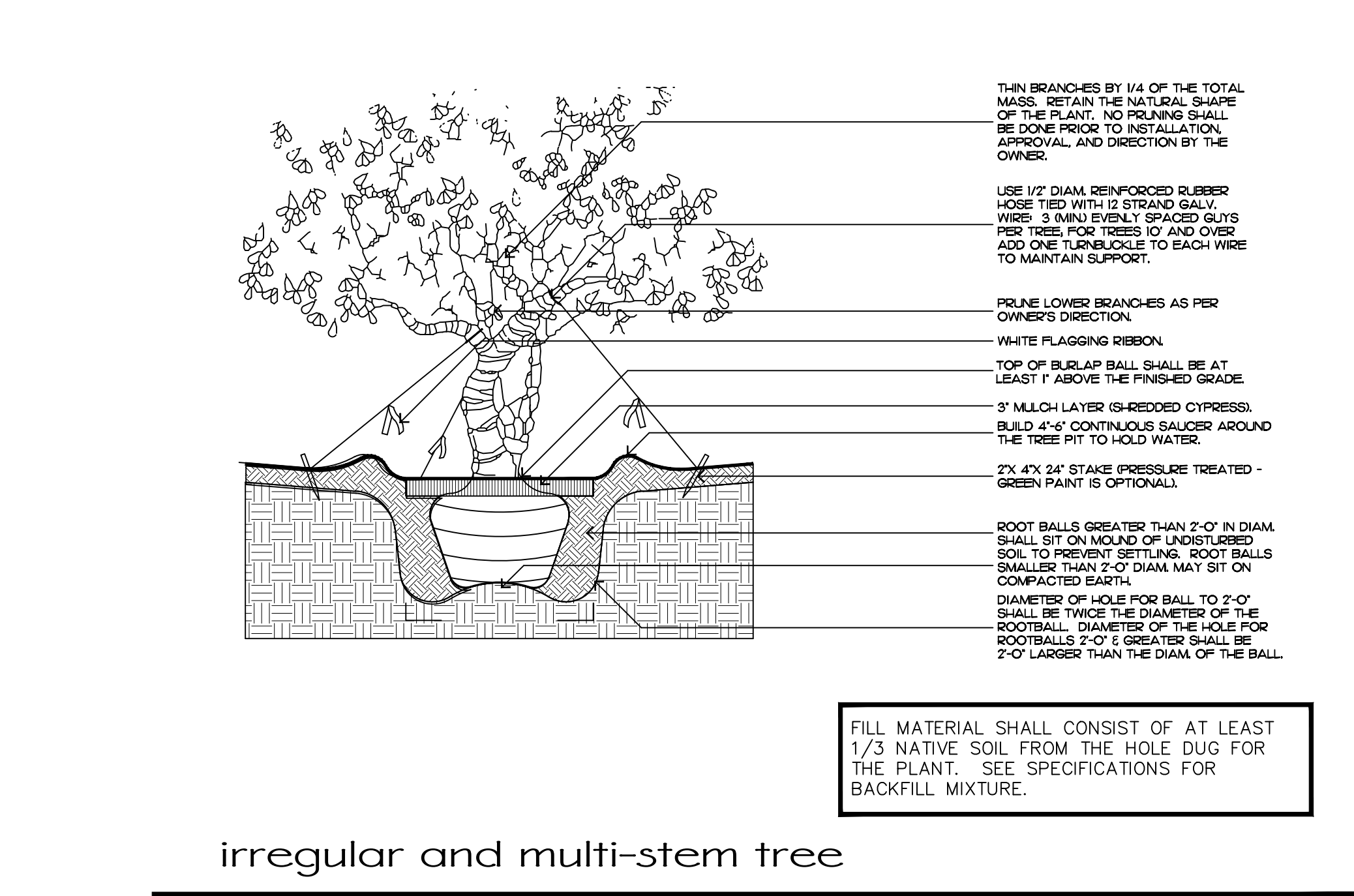

irregular and multi-stem tree

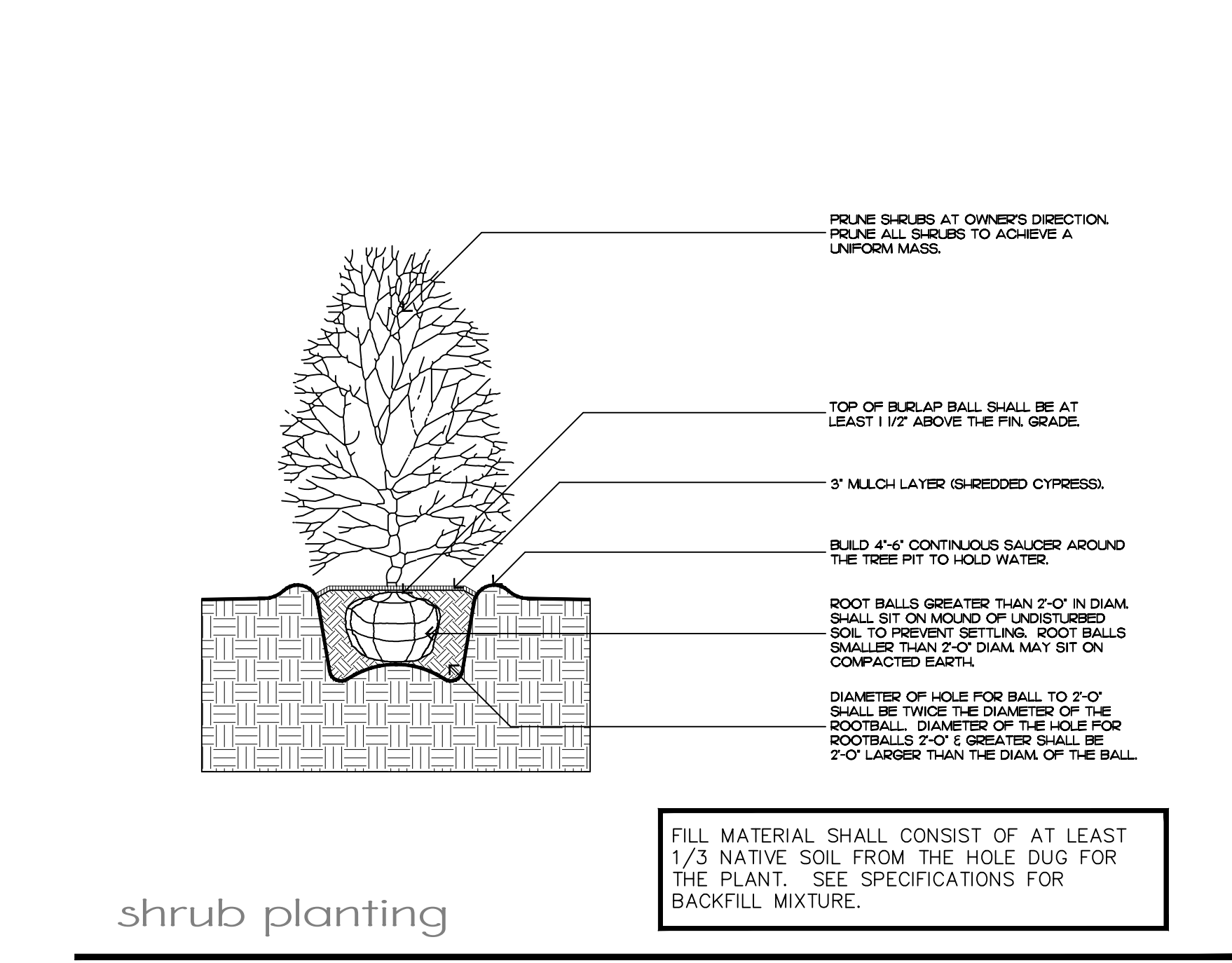

shrub planting

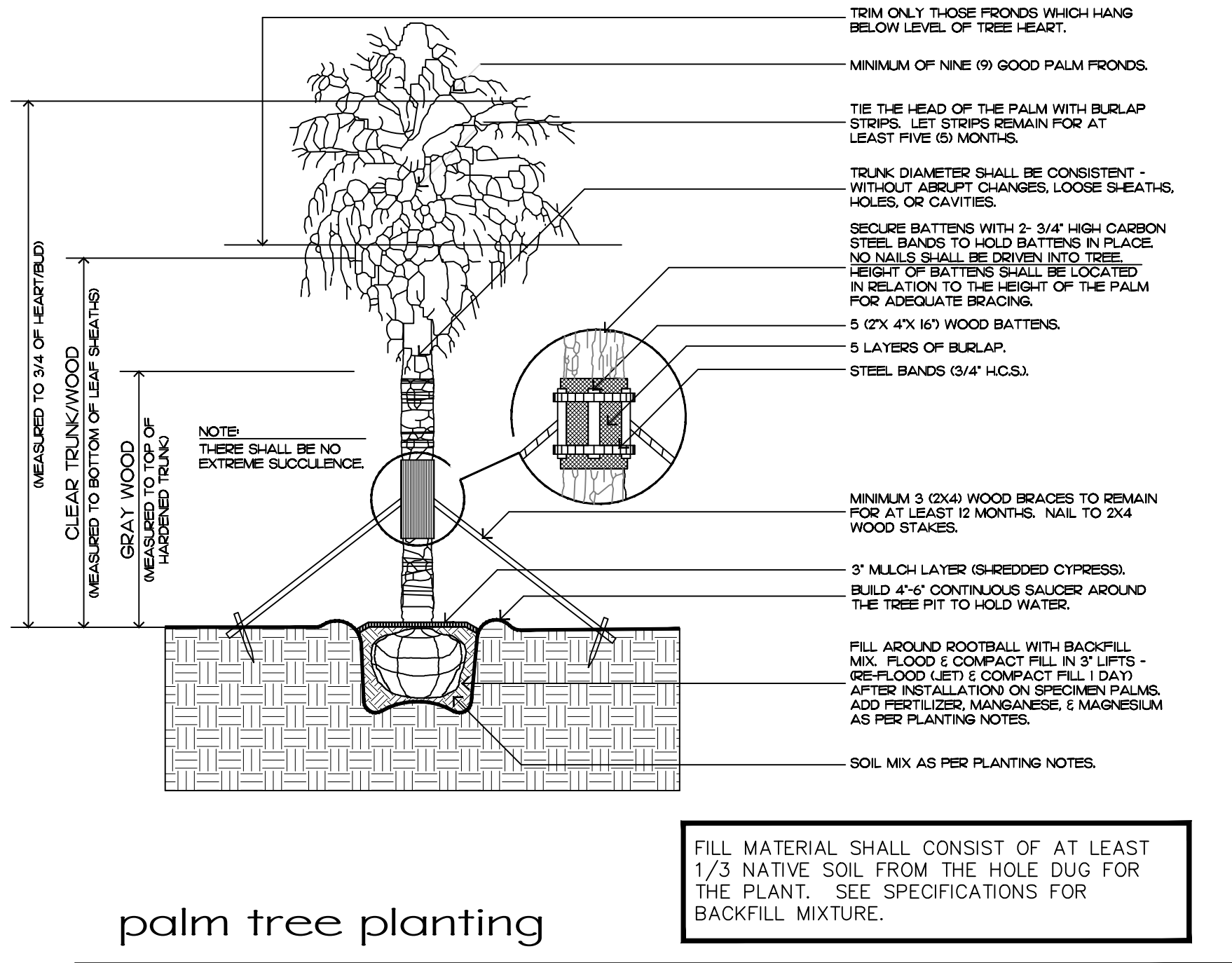

palm tree planting

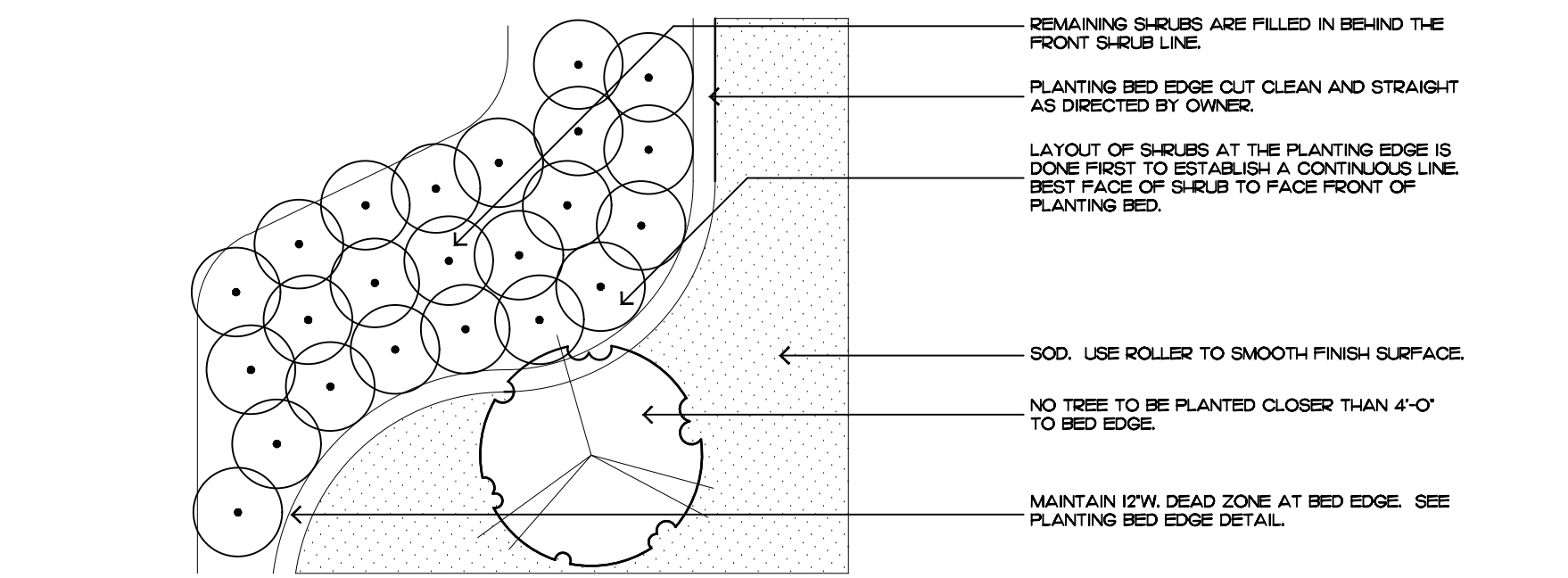

shrub & ground cover layout

Planting Notes

COMMERCIAL FERTILIZER:

FERTILIZER SHALL BE COMPLETELY ORGANIC, IT SHALL BE UNIFORM IN COMPOSITION, DRY AND FREE FLOWING. THIS FERTILIZER SHALL BE DELIVERED TO THE SITE IN THE ORIGINAL UNOPENED BAGS, EACH BEARING THE MANUFACTURER'S STATEMENT OF ANALYSIS, AND SHALL MEET THE FOLLOWING REQUIREMENTS:

- SIX PERCENT (6%) NITROGEN
- SIX PERCENT (6%) PHOSPHOROUS
- SIX PERCENT (6%) POTASSIUM

FERTILIZER SHALL BE APPLIED TO ALL SHRUBS (1/3 LB. PER 3 GAL. POT, 1/4 LB. PER 1 GAL. POT) AND GROUNDCOVER. THE SAME FERTILIZER MIXTURE SHALL BE USED ON SOD AT A RATE OF 15 LBS. PER 1000 SQUARE FEET. A FOURTEEN PERCENT (14%) NITROGEN, FOURTEEN PERCENT (14%) PHOSPHOROUS AND FOURTEEN PERCENT (14%) POTASSIUM IS REQUIRED ON ALL TREES AND SHRUBS OVER 5'-0" IN HEIGHT (1/2 LB. PER 5'-0" OF SPREAD). AGRIFORM TABLETS WITH TWENTY PERCENT (20%) NITROGEN, TEN PERCENT (10%) PHOSPHOROUS, FIVE PERCENT (5%) POTASSIUM IN 21 GRAM SIZES SHALL BE APPLIED ALONG WITH THE FERTILIZER PROCESS (1 WITH 1 GAL. PLANTS, 2 WITH 3 GAL. PLANTS AND 2 TABLETS PER 1" OF TREE TRUNK CALIPER). BACK FILL HALFWAY UP THE ROOT BALL. PLACE ABOUT ONE INCH (1") FROM ROOT TIPS. MAGNESIUM SULFATE SHALL BE APPLIED TO ALL PALMS AT INSTALLATION AT A RATE OF 1/2 LB. PER INCH OF TRUNK CALIPER. MANGANESE SHALL BE APPLIED AT THE SAME RATE.

MULCH:

MULCH MATERIAL SHALL BE SHREDDED CYPRESS MULCH OR APPROVED EQUAL, MOISTENED AT THE TIME OF APPLICATION TO PREVENT WIND DISPLACEMENT. MULCH SHALL BE APPLIED TO A MINIMUM 3" DEPTH IN PLANTING BEDS.

SOD:

THE SOD SHALL BE FREE FROM WEEDS, FUNGUS, INSECTS AND DISEASES OF ANY KIND, CLEAN, STRONGLY ROOTED, UNIFORMLY SIZED STRIPS, MACHINE STRIPPED NOT MORE THAN TWENTY-FOUR (24) HOURS PRIOR TO LAYING.

SUBSTITUTIONS:

NO SUBSTITUTION OF PLANT MATERIAL TYPES OR SIZES WILL BE ALLOWED WITHOUT WRITTEN AUTHORIZATION FROM THE OWNER. CONTAINER GROWN MATERIAL WILL NOT BE ACCEPTED AS SUBSTITUTE FOR B&B MATERIAL UNLESS PREVIOUSLY APPROVED. INTENDED SUBSTITUTIONS SHALL BE SPELLED OUT IN BID.

MEASUREMENTS:

SHADE TREES: HEIGHT SHALL BE MEASURED FROM GROUND TO THE AVERAGE BRANCH HEIGHT OF CANOPY. SPREAD SHALL BE MEASURED TO THE END OF THE BRANCHING EQUALLY AROUND THE CROWN FROM THE CENTER OF THE TRUNK. MEASUREMENTS ARE NOT TO INCLUDE ANY TERMINAL GROWTH. SINGLE TRUNK TREES SHALL BE FREE OF "V" CROTCHES THAT COULD BE POINTS OF WEAK LIMB STRUCTURE OR DISEASE INFESTATION.

SHRUBS: HEIGHT SHALL BE MEASURED FROM THE GROUND TO THE AVERAGE POINT WHERE MATURE PLANT GROWTH STOPS. SPREAD SHALL BE MEASURED TO THE END OF BRANCHING EQUALLY AROUND THE SHRUB MASS. MEASUREMENT AREA NOT TO INCLUDE ANY TERMINAL GROWTH.

PALMS: CLEAR TRUNK (C.T.) SHALL BE MEASURED FROM THE GROUND AT TIME OF INSTALLATION TO THE POINT WHERE THE MATURE AGED TRUNK JOINS THE IMMATURE OR GREEN PORTION OF THE TRUNK OR HEAD.

OVERALL HEIGHT (O.A.) SHALL BE MEASURED FROM THE GROUND AT THE TIME OF INSTALLATION TO THE AVERAGE FROND HEIGHT.

PALMS WITH MARRED OR BURNED TRUNKS WILL NOT BE ACCEPTED.

PLANTING SOIL AND BACKFILL:

PLANTING SOIL FOR USE IN PREPARING BACKFILL FOR PLANT PITS SHALL BE A FERTILE, FRIABLE AND NATURAL TOPSOIL, WITHOUT MIXTURE OF SUBSOIL MATERIALS, AND SHALL BE FREE FROM HEAVY CLAY, STONES, LIMES, LUMPS, SHELLS, PLANTS, ROOTS OR OTHER FOREIGN MATERIALS, WEEDS, OR NOXIOUS GRASSES (SUCH AS BERBERIS OR NUT GRASS). IT SHALL NOT CONTAIN TOXIC SUBSTANCES WHICH MAY BE HARMFUL TO THE PLANT GROWTH.

BACKFILL FOR SOD AREAS SHALL BE SUBJECT TO LESSER STANDARDS AT THE DISCRETION AND DECISION OF THE OWNER.

EXISTING TOPSOIL SHALL BE USED IN ALL PLANT MATERIAL PITS EXCEPT SABAL PALMS WHERE THE SOIL SHALL CONSIST OF CLEAN SAND.

PLANTING SOIL FOR USE IN BEDS FOR ANNUALS AND/OR PERENNIALS SHALL CONTAIN ONE-THIRD (1/3) POTTING SOIL OR A BLENDED TOPSOIL, TILL INTO TOP 10" - 12" OF SOIL WITH A TIME-RELEASE FERTILIZER.

PLANT MATERIALS:

PALMS, TREES, SHRUBS, GROUNDCOVERS AND VINES

PLANT SPECIES AND SIZE SHALL CONFORM TO THOSE INDICATED ON THE DRAWINGS. NOMENCLATURE SHALL CONFORM TO 'STANDARDIZED PLANT NAMES', 1942 EDITION. ALL NURSERY STOCK SHALL BE IN ACCORDANCE WITH 'GRADES AND STANDARDS FOR NURSERY PLANTS PARTS I & II', LATEST EDITION PUBLISHED BY THE FLORIDA DEPARTMENT OF AGRICULTURE AND CONSUMER SERVICES. UNLESS SPECIFIED OTHERWISE, ALL PLANTS SHALL BE FLORIDA GRADE NUMBER 1 OR BETTER AS DETERMINED BY THE FLORIDA DIVISION OF PLANT INDUSTRY. SPECIMEN WEANS AN EXCEPTIONALLY HEAVY, SYMMETRICAL, TIGHTLY KNIT PLANT, SO TRAINED OR FAVORED IN ITS DEVELOPMENT THAT FIRST APPEARANCE IS UNQUESTIONABLE AND OUTSTANDINGLY SUPERIOR IN FORM, NUMBER OF BRANCHES, COMPACTNESS AND SYMMETRY. ALL PLANTS SHALL BE FRESHLY DUG, SOUND, HEALTHY, VIGOROUS, WELL BRANCHED AND FREE OF DISEASE AND INSECT EGGS AND LARVAE AND SHALL HAVE ADEQUATE ROOT SYSTEM. TREES FOR PLANTING ROWS SHALL BE UNIFORM IN SIZE AND SHAPE. ALL MATERIALS SHALL BE SUBJECT TO APPROVAL BY THE OWNER. WHERE REQUIREMENTS ARE OMITTED FROM THE PLANT LIST, THE PLANTS FURNISHED SHALL BE NORMAL FOR THE VARIETY AND FLORIDA NUMBER 1. PLANTS SHALL BE PRUNED PRIOR TO DELIVERY ONLY UPON THE APPROVAL OF THE OWNER.

CONTAINER GROWN STOCK:

ALL CONTAINER GROWN MATERIAL SHALL BE HEALTHY, VIGOROUS, WELL-ROOTED PLANTS AND ESTABLISHED IN THE CONTAINER IN WHICH THEY ARE SOLD. THE PLANTS SHALL HAVE TOPS OF GOOD QUALITY AND BE IN A HEALTHY GROWING CONDITION.

- AN ESTABLISHED CONTAINER GROWN PLANT SHALL BE TRANSPLANTED INTO A CONTAINER AND GROWN IN THAT CONTAINER SUFFICIENTLY LONG ENOUGH FOR THE NEW FIBROUS ROOTS TO HAVE DEVELOPED SO THAT THE ROOT MASS WILL RETAIN ITS SHAPE AND HOLD TOGETHER WHEN REMOVED FROM THE CONTAINER.
-

WARRANTY:

WARRANTY PLANTS, SHRUBS AND GROUNDCOVERS FOR A PERIOD OF NINETY (90) DAYS; TREES & PALMS FOR ONE YEAR (1) AGAINST UNHEALTHY CONDITION, EXCEPT AS MAY RESULT FROM NEGLECT BY OWNER, DAMAGE BY OTHERS, AND UNUSUAL PHENOMENA BEYOND INSTALLER'S CONTROL. REPLACE AT TIME REQUESTED BY THE OWNER OR LANDSCAPE ARCHITECT.

MAINTENANCE:

MAINTAIN LANDSCAPE WORK UNTIL THE LETTER OF SUBSTANTIAL COMPLETION BY THE GENERAL CONTRACTOR. INCLUDE WATERING, WEEDING, CULTIVATING, RESTORATION OF GRADE, MOWING AND TRIMMING GRASS, PRUNING TREES AND SHRUBS, PROTECTION FROM INSECTS AND DISEASES, FERTILIZATION AND SIMILAR OPERATIONS AS NEEDED TO ENSURE NORMAL GOOD HEALTH FOR LIVE PLANT MATERIAL.