

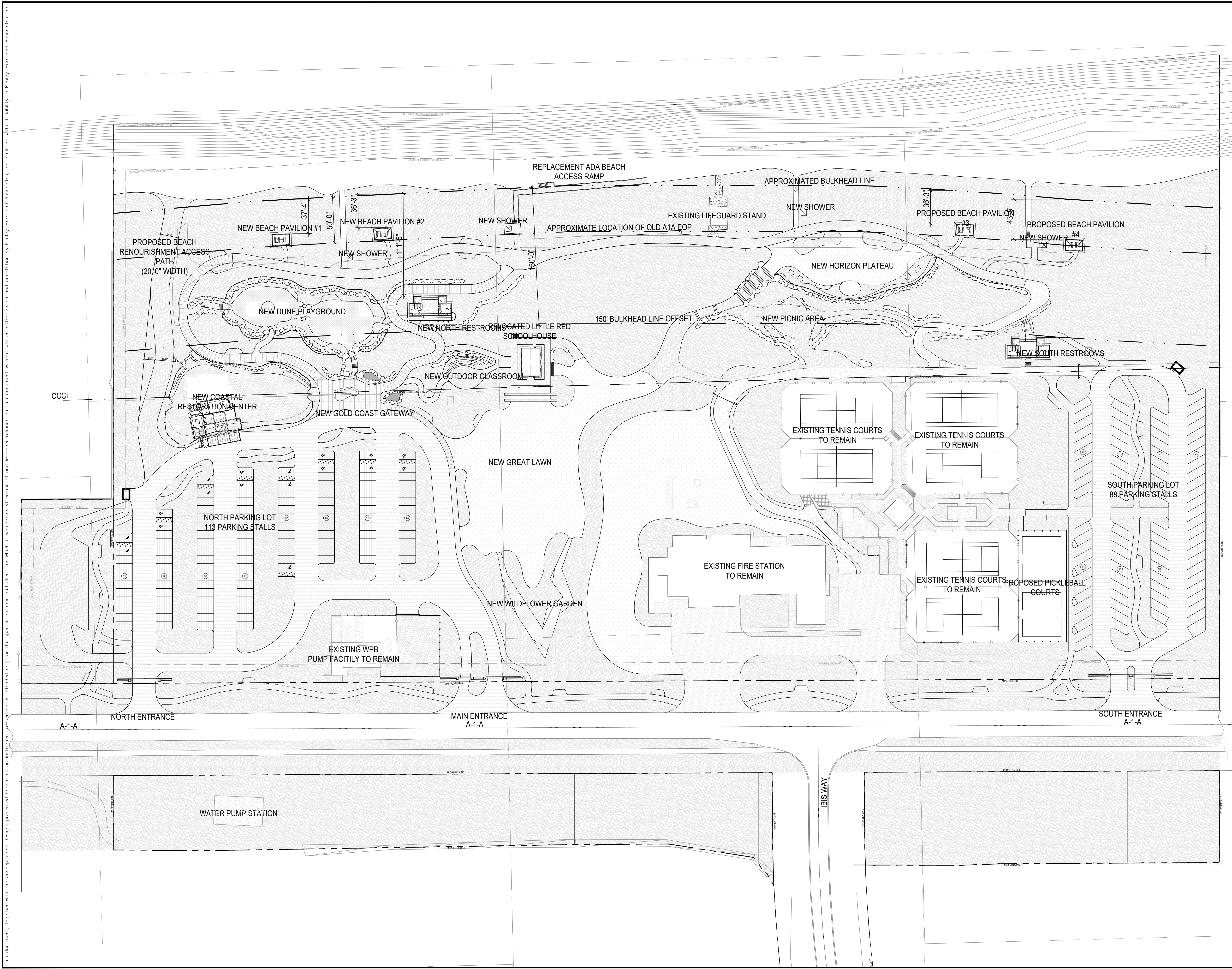



This document, together with the concepts and designs presented herein, as an instrument of service, is intended only for the specific purpose and client for which it was prepared. Reuse of and improper reliance on this document without written authorization and adaptation by Kimley-Horn and Associates, Inc. shall be without liability to Kimley-Horn and Associates, Inc.



**LEGEND**

	PROPERTY LINE
	SETBACK
	COASTAL CONSTRUCTION CONTROL LINE

0 25 50 100  
SCALE: 1:50



<b>CIVIL ENGINEER</b> <h1 style="margin: 0;">Kimley»Horn</h1>		
1920 KEWIKVA WAY, SUITE 200, WEST PALM BEACH, FL 33411 PHONE: 561-845-0665 FAX: 561-863-8175 WWW.KIMLEY-HORN.COM REGISTRY NO. 35106		
<b>ARCHITECT</b> 		
<b>FAIRFAX &amp; SAMMONS</b> FAIRFAX, SAMMONS & PARTNERS, LLC 214 BRAZILIAN AVENUE PALM BEACH, FL 33480 PHONE: (561) 805-8591		
<b>LANDSCAPE ARCHITECT</b> <h2 style="margin: 0;">jungles</h2> RAYMOND JUNGLES, INC. 2964 AVIATION AVENUE MIAMI, FL 33133 PHONE: (305) 858-6777		
COA: 22-037 ZON: 22-107		
No.	REVISIONS	DATE
PROJECT No.		
DATE		
9/26/2022		
SCALE		
AS SHOWN		
DESIGNED BY		
DRAWN BY		
CHECKED BY		
SITE PLAN		
<h2 style="margin: 0;">PHIPPS OCEAN PARK</h2> <p style="margin: 0;">PREPARED FOR</p> <h2 style="margin: 0;">TOWN OF PALM BEACH</h2>		
SHEET NUMBER <h1 style="margin: 0;">GI.000</h1>		