

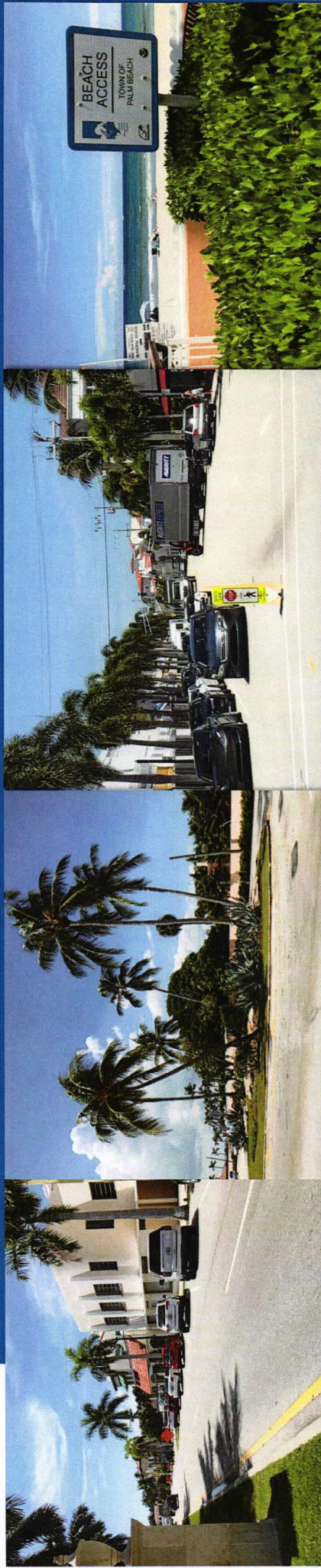

# WELCOME

**The State Road (S.R.) A1A Resurfacing Design  
Presentation will begin at 5:30 p.m.**



February 7, 2023

Page 1





**PUBLIC MEETING**

# **State Road (S.R.) A1A Resurfacing Design**

**From North of Emerald Beach Way to South of S.R. 704/Royal Palm Way  
Palm Beach County - Project Identification Number: 446175-1-52-01**

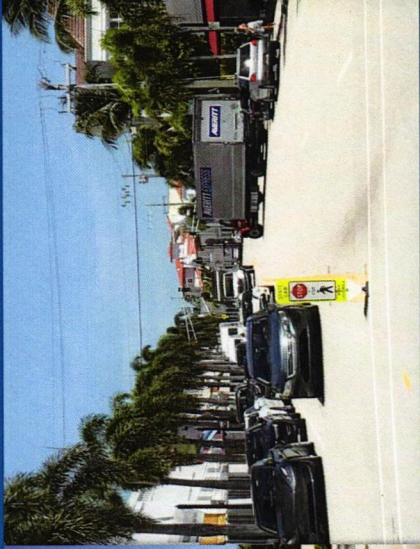
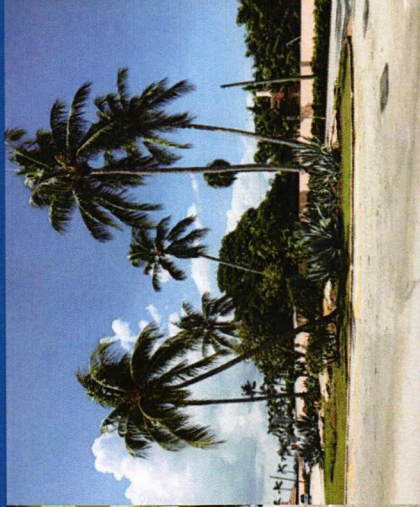
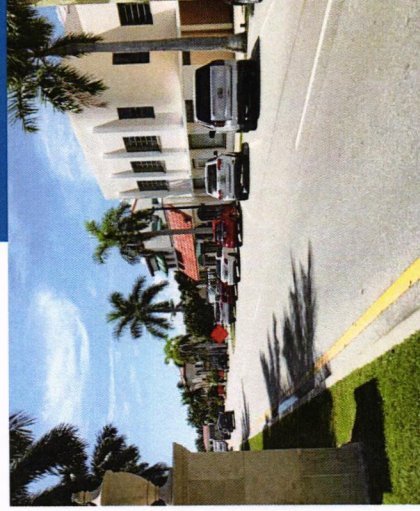

**February 7, 2023**

**Page 2**





## MEET THE TEAM

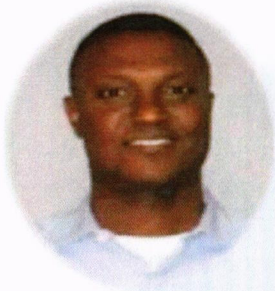

**Kenzot Jasmin, P.E.**  
FDOT Project Manager  
FDOT District Four  
Consultant Management Office



**Md Rahman, P.E.**  
Consultant Project Manager  
CORE Engineering Group, LLC



**Navon Wallace, P.E.**  
Consultant Project Manager  
AECOM  
FDOT District Four  
Consultant Management Office



**Eileen LaSeur**  
Public Information Officer  
CORE Engineering Group, LLC



- 1. Technical Information**
- 2. Non-Discrimination Policy and Rules of Engagement**
- 3. Project Location and Overview**
- 4. Proposed Improvements**
- 5. Temporary Traffic Control Plan**
- 6. Project Schedule and Costs**
- 7. Closing and Contact Information**
- 8. Questions and Answers**





This public meeting is being conducted in a hybrid format:

- In-Person
- Virtual
- Dial-in

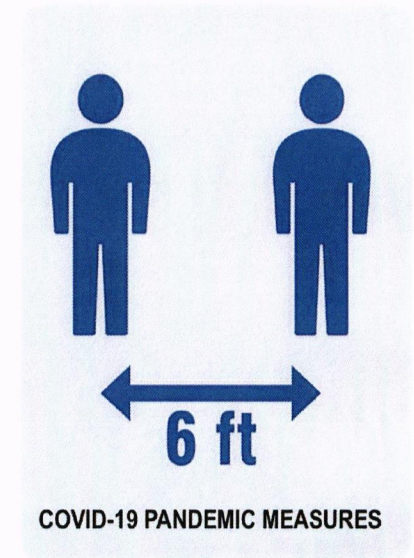
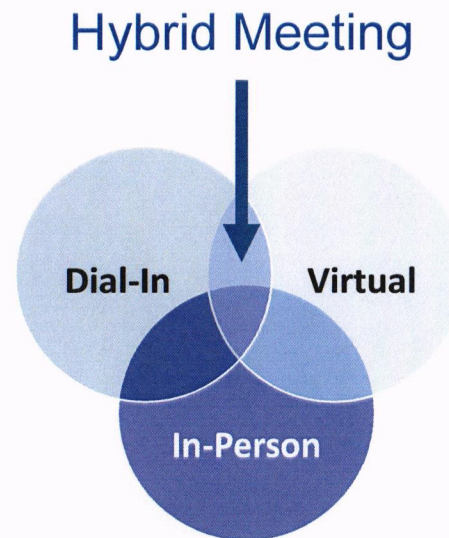

**Dial-in** attendees are “listen only”.

A copy of the presentation is available at:

[https://www.d4fdot.com/pbfdot/state\\_road\\_a1a\\_from\\_north\\_of\\_emerald\\_beach\\_way\\_to\\_south\\_of\\_sr\\_704\\_royal\\_palm\\_way.asp](https://www.d4fdot.com/pbfdot/state_road_a1a_from_north_of_emerald_beach_way_to_south_of_sr_704_royal_palm_way.asp)





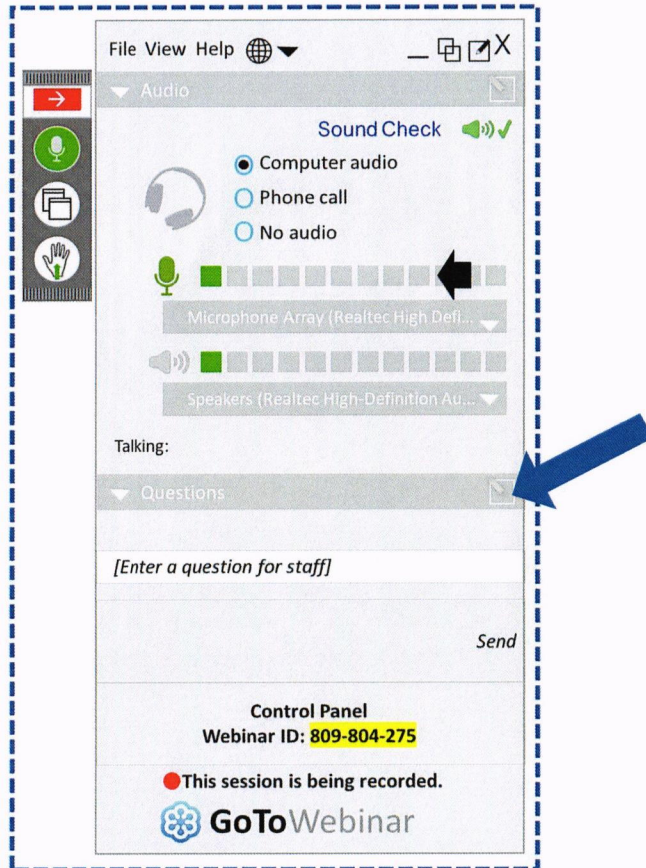

## Mobile

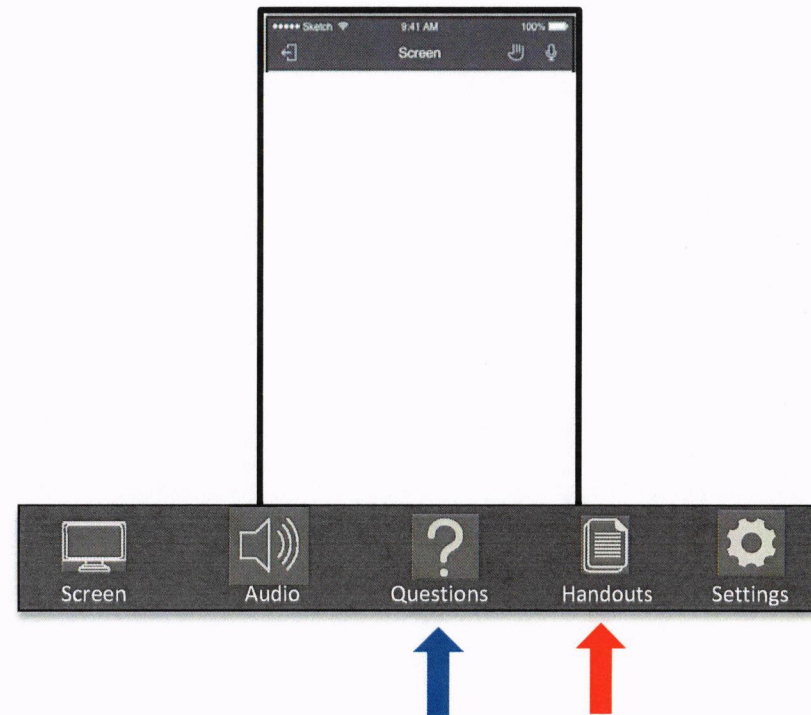





## PUBLIC MEETING – PUBLIC NOTICE

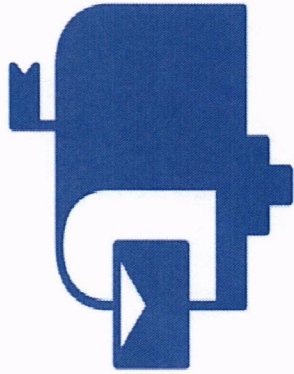

Property Owner/Tenant Letters



Email to Project Contact List

Florida Department of State

FLORIDA ADMINISTRATIVE CODE &  
FLORIDA ADMINISTRATIVE REGISTER

Florida Administrative Register

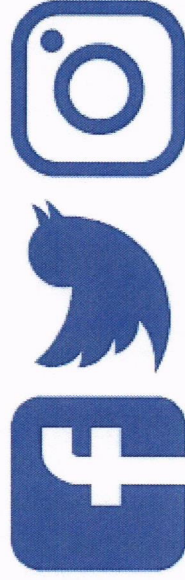

Social Media



# **Non-Discrimination Policy and Rules of Engagement**





## NON-DISCRIMINATION POLICY

The Florida Department of Transportation complies with various non-discrimination laws and regulations, including:

### Title VI of the Civil Rights Act of 1964

This meeting is being held without regard to race, color, national origin age, sex, religion, disability, or family status.

For questions or concerns, you may contact either:

#### District Four

Florida Department of Transportation

*District 4 Title VI Coordinator*

**Sharon SinghHagyan**



3400 West Commercial Boulevard

Fort Lauderdale, Florida 33309



(944) 777-4190



[Sharon.SinghHagyan@dot.state.fl.us](mailto:Sharon.SinghHagyan@dot.state.fl.us)

#### Tallahassee Office

Equal Opportunity Office Civil Rights Manager

Florida Department of Transportation

**Stefan Kulakowski**



605 Suwannee Street, MS 65

Tallahassee, Florida 32399-0450



(850) 414-4753



[Stefan.Kulakowski@dot.state.fl.us](mailto:Stefan.Kulakowski@dot.state.fl.us)



## RULES OF ENGAGEMENT



- This Virtual Public Meeting is being recorded
- If you experience technical difficulties, please contact **GoToWebinar Support at +1(833) 851-8340**
- All attendees will remain muted throughout the meeting
- Attendees are welcome to submit questions/comments using the GoToWebinar Question Panel
- A member of the team will respond during the question-and-answer portion of the meeting



# **Project Location and Scope of Services**





## PROJECT LOCATION

- Project is in the Town of Palm Beach in Palm Beach County
- Project limits are from North of Emerald Beach Way to South of S.R. 704/Royal Palm Way

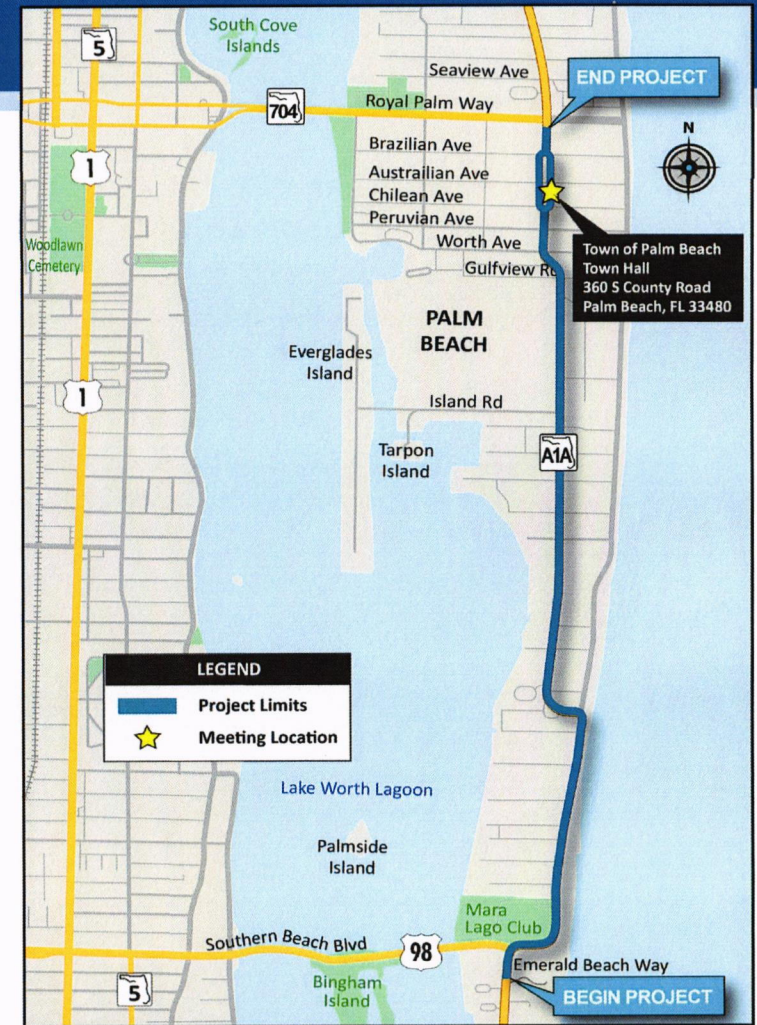
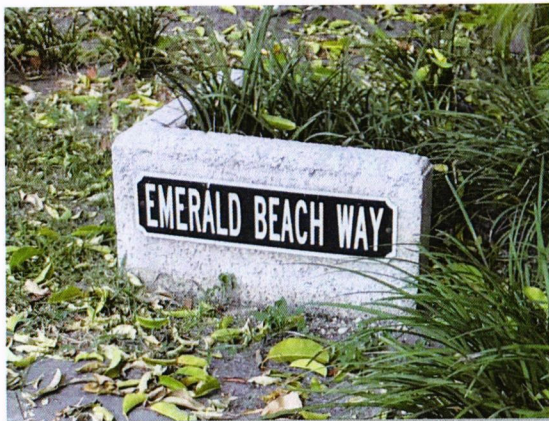



## PROJECT SCOPE OF SERVICES

- Repaving the existing roadway
- Upgrading Americans with Disabilities Act (ADA) issues
- Improving drainage to avoid ponding
- Sidewalk improvements and shared lane pavement markings
- Preserving and protecting existing vegetation
- Upgrading lighting
- Replacing signal heads and emergency signals







# DESIGN PLANS



## EXISTING CONDITIONS

Existing Typical Section 1 from North of Emerald Beach Way to Hammon Avenue:

- Two-lane, two-way urban collector with 11-foot travel lanes
- Shoulder varying from 2 feet to 5.5 feet
- A minimum 4.5-foot concrete sidewalk runs along the northbound lane starting north of Ocean Boulevard

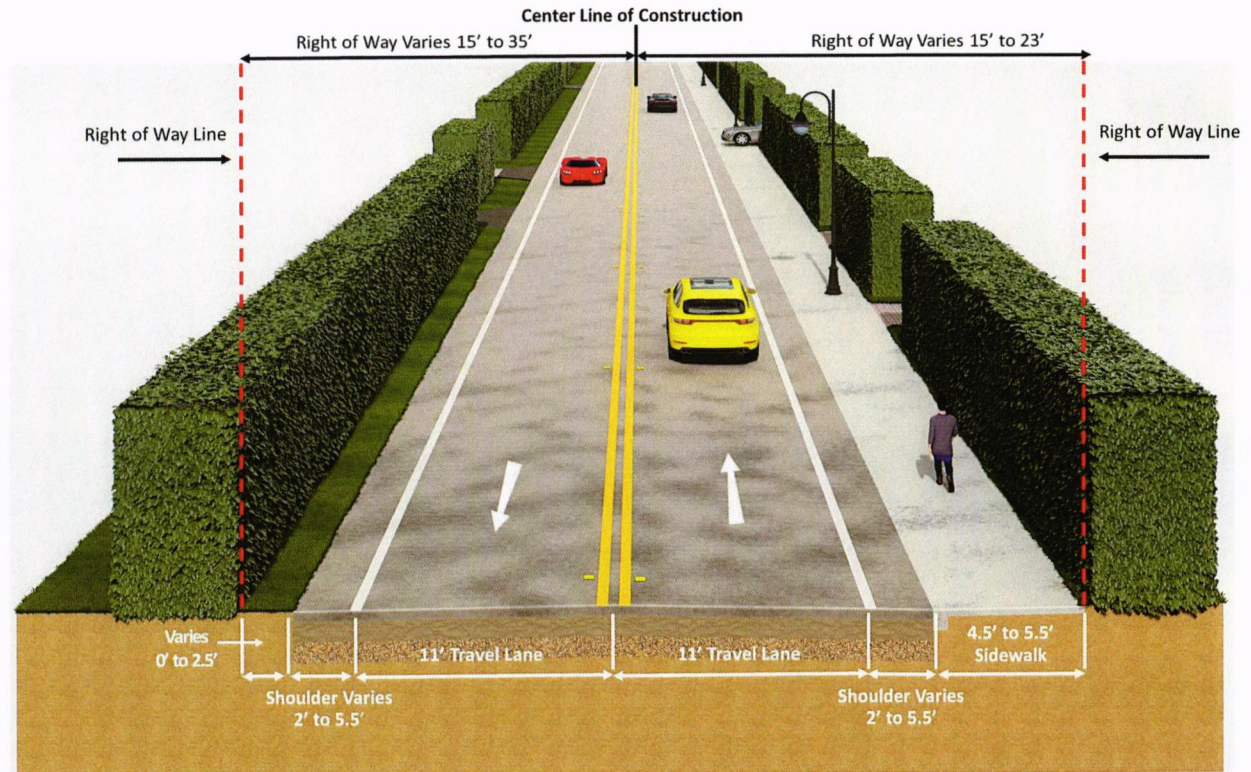



## Existing Typical Section 2 from Hammon Avenue to Chilean Avenue:

- Four-lane undivided section with 10.5-foot travel lanes
- 8-foot parallel parking along the northbound lanes
- Type D Curb on the outside with varying width sidewalk on both sides

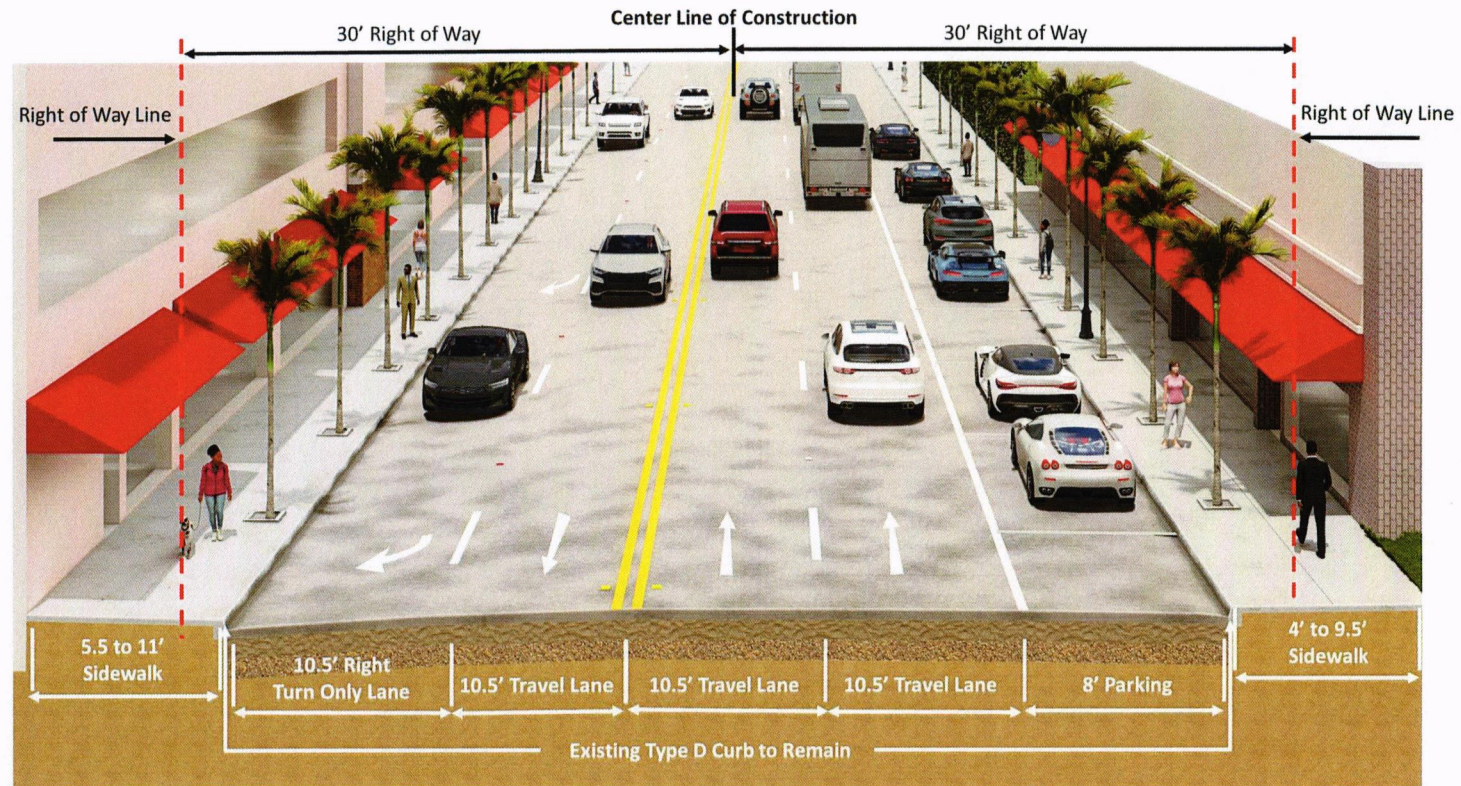



## EXISTING CONDITIONS

### Existing Typical Section 3 from Chilean Avenue to Brazilian Avenue:

- Two-way pair, each pair consisting of a two-lane section with 11 to 12-foot travel lanes
- 8-foot on-street parking
- Type F Curb with varying width sidewalk on both sides

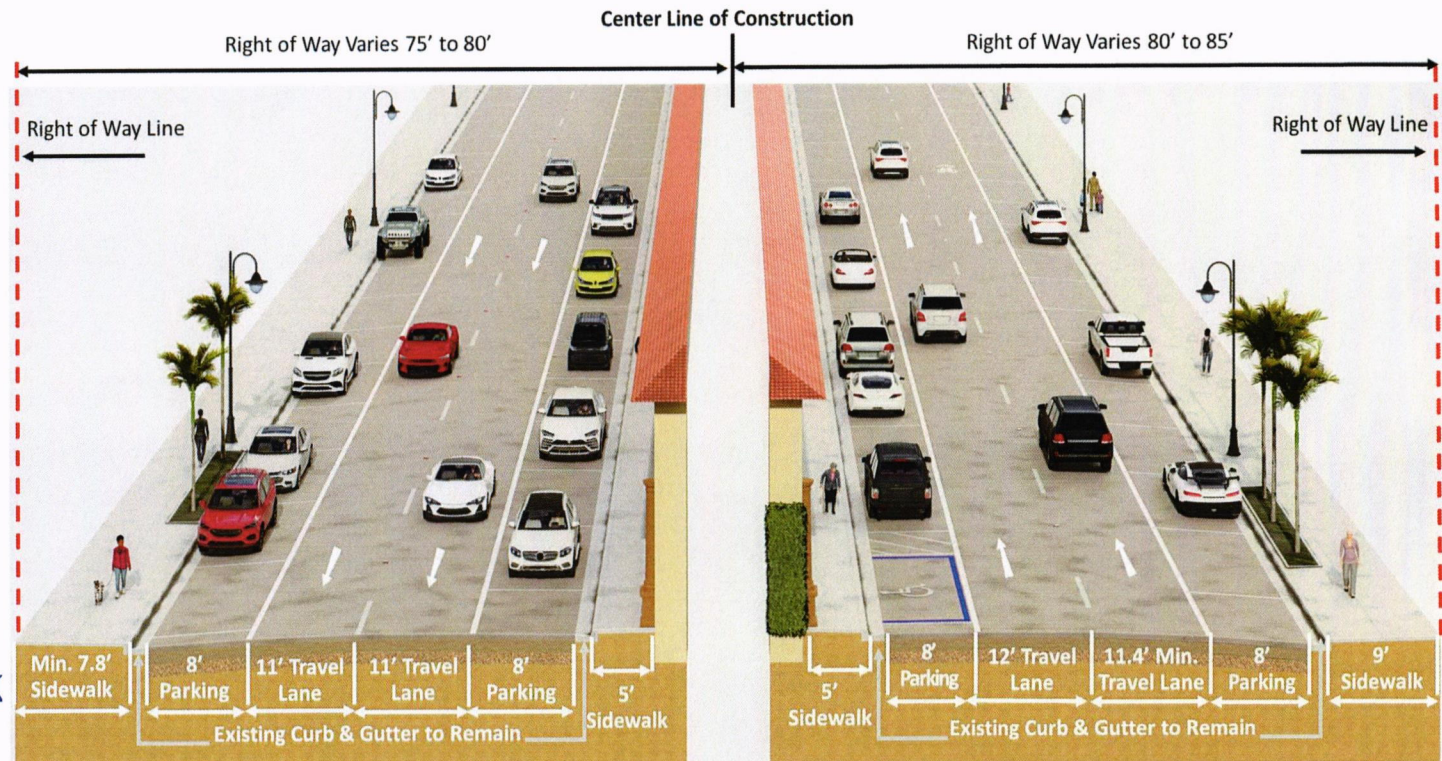



## EXISTING CONDITIONS

Existing Typical Section 4 from Brazilian Avenue to South of Royal Palm Way:

- Three-lane undivided section with two 12-foot travel lanes
- 8-foot on-street parking
- Type F Curb and 9.5-foot sidewalk on both sides

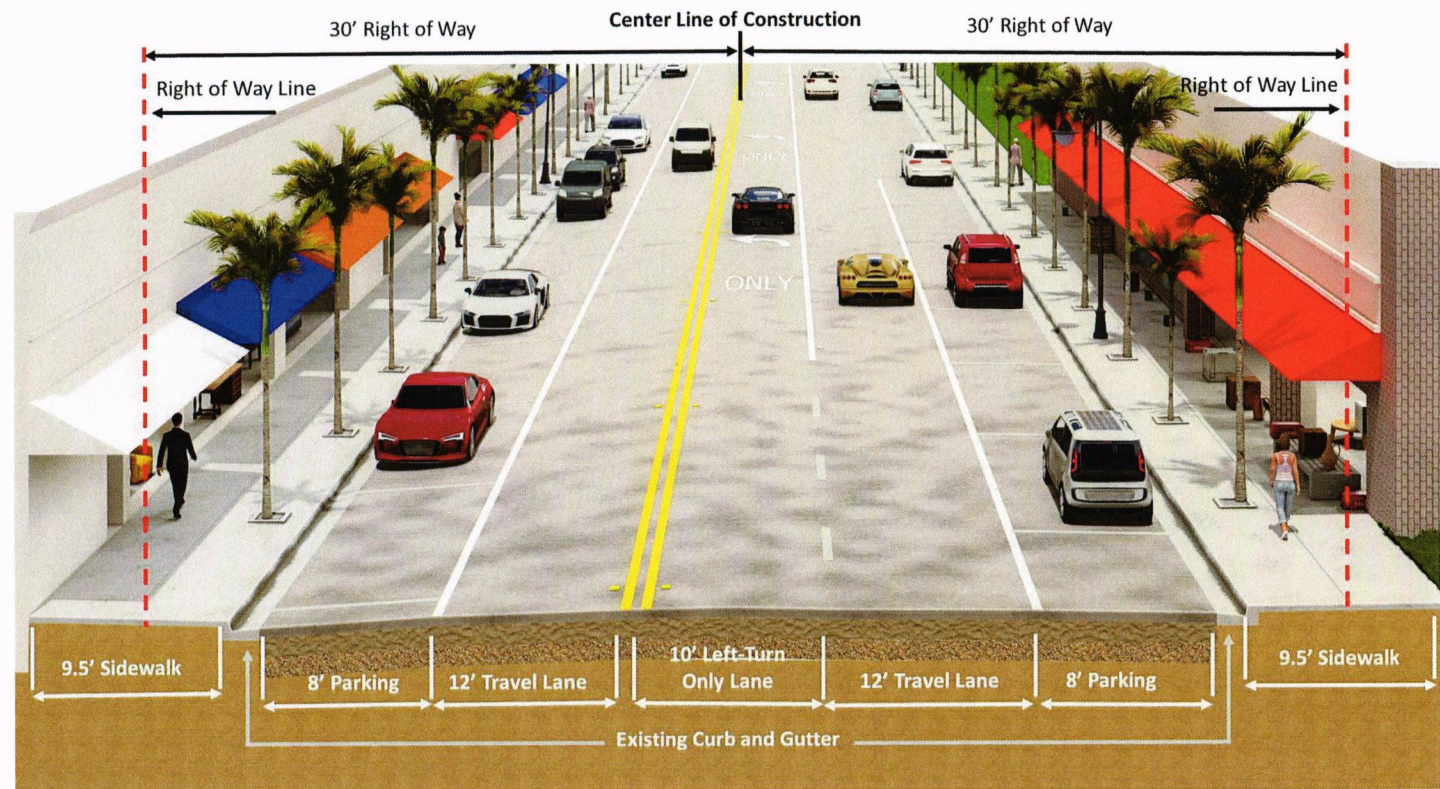



## PROPOSED DESIGN PLANS

### Proposed Typical Section 1 from North of Emerald Beach Way to Hammon Avenue:

- Two-lane, two-way urban collector with 12-foot travel lanes
- Shoulder varying from 1 to 4.5 feet in both directions
- 4.5 to 5.5-foot concrete sidewalk along the northbound lane starting north of Ocean Boulevard

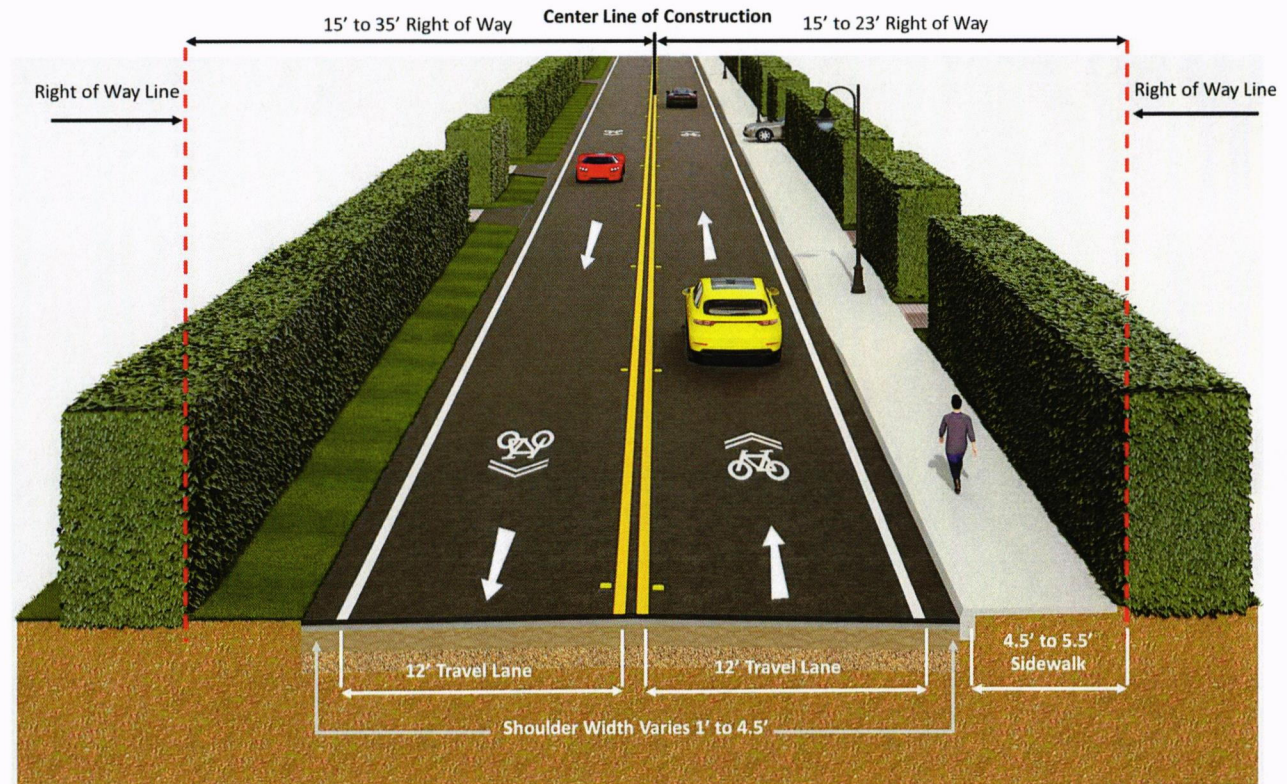



## PROPOSED DESIGN PLANS

### Proposed Typical Section 2 from Hammon Avenue to Chilean Avenue:

- Four-lane undivided section with 10-foot travel lanes
- 8-foot on-street parking with buffer along northbound lanes
- Type D Curb on the outside, and 4 to 11-foot sidewalk on both sides of the roadway

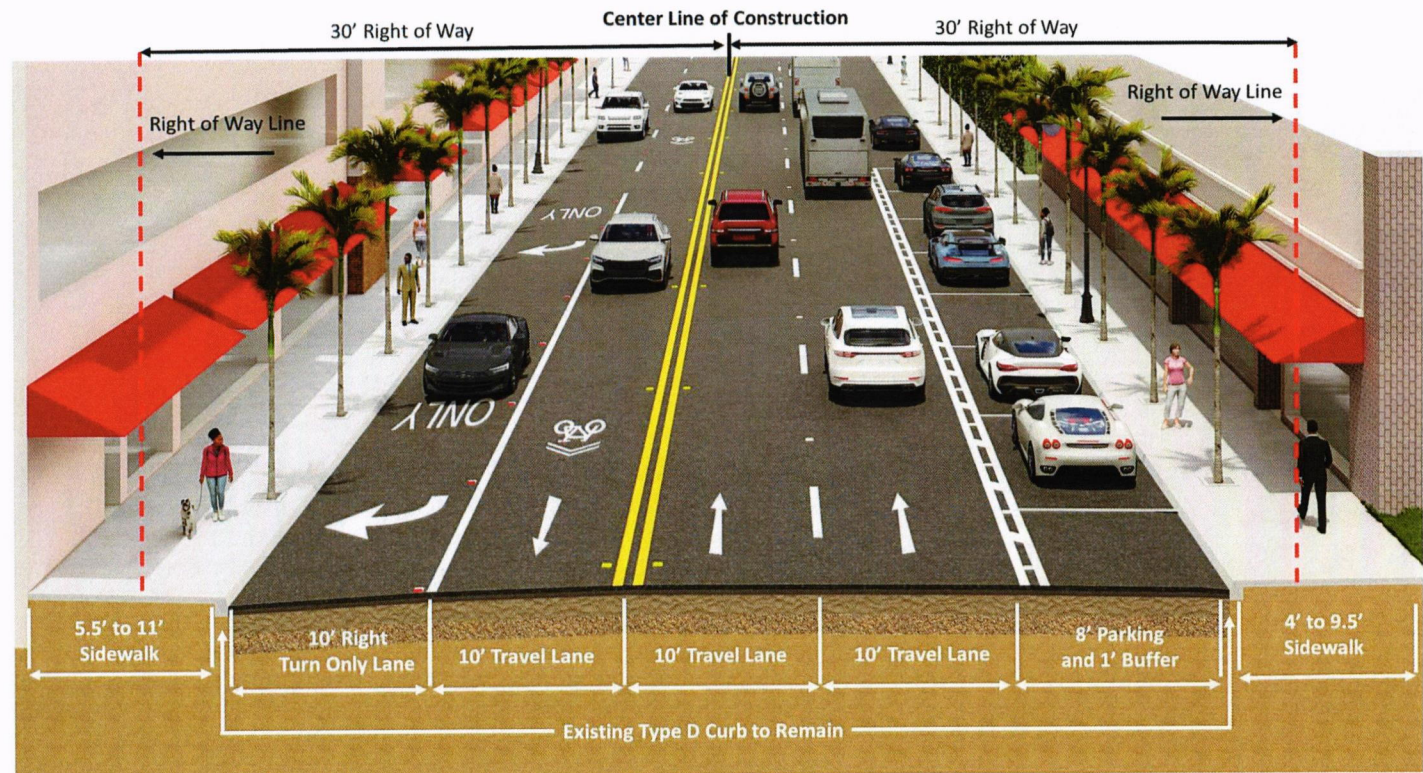



# PROPOSED DESIGN PLANS

## Proposed Typical Section 3 from Chilean Avenue to Brazilian Avenue:

- Two-way pair, each pair consisting of a 2-lane section with 10 to 11-foot travel lanes
- 8-foot on-street parking with a buffer
- Type F Curb and varying width sidewalk on both sides

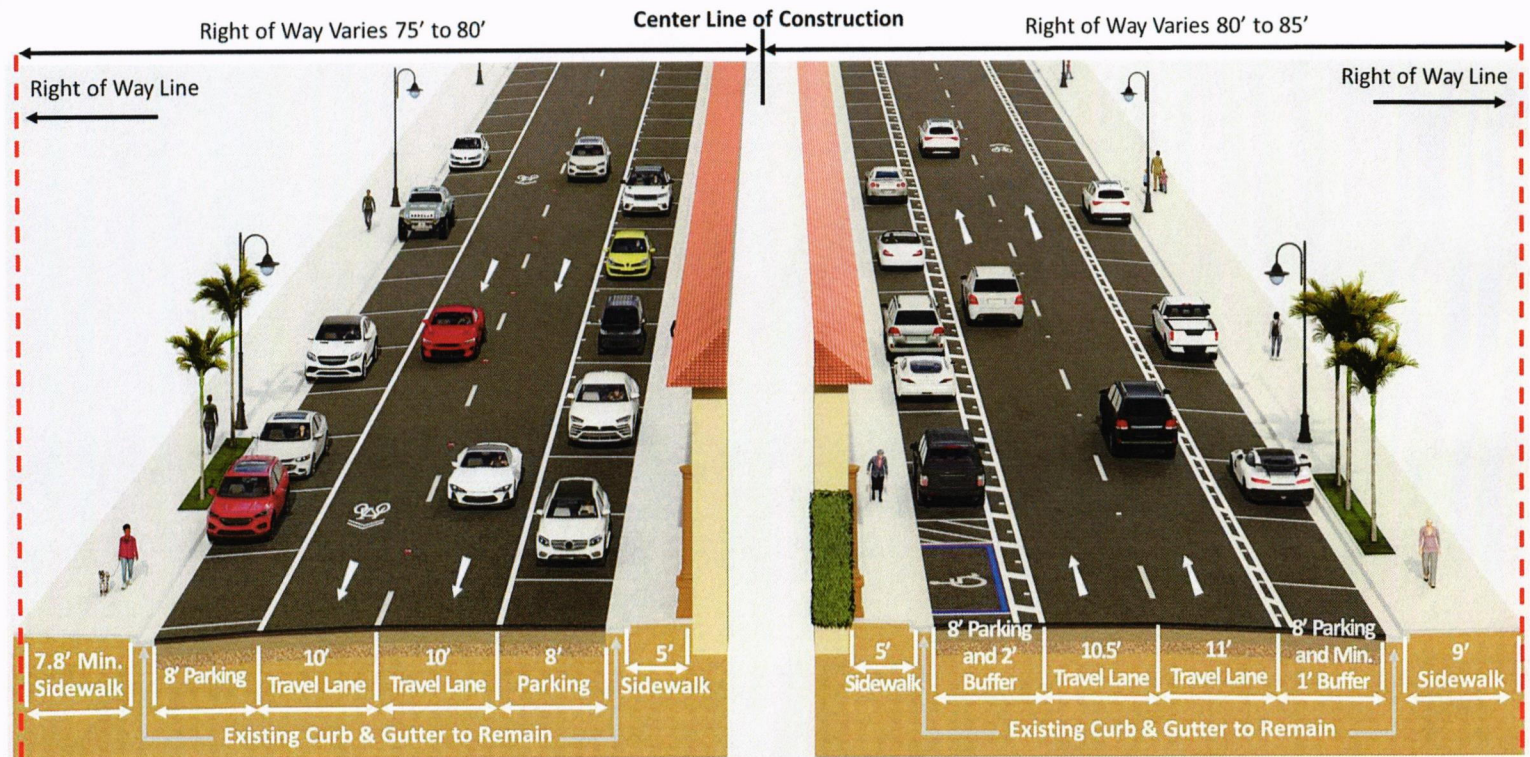



## PROPOSED DESIGN PLANS

### Proposed Typical Section 4 from Brazilian Avenue to South of SR 704/Royal Palm Way:

- Three-lane undivided section with two 10-foot travel lanes
- 8-foot on-street parking with buffer
- Type F Curb and 9.5-foot sidewalk on both sides

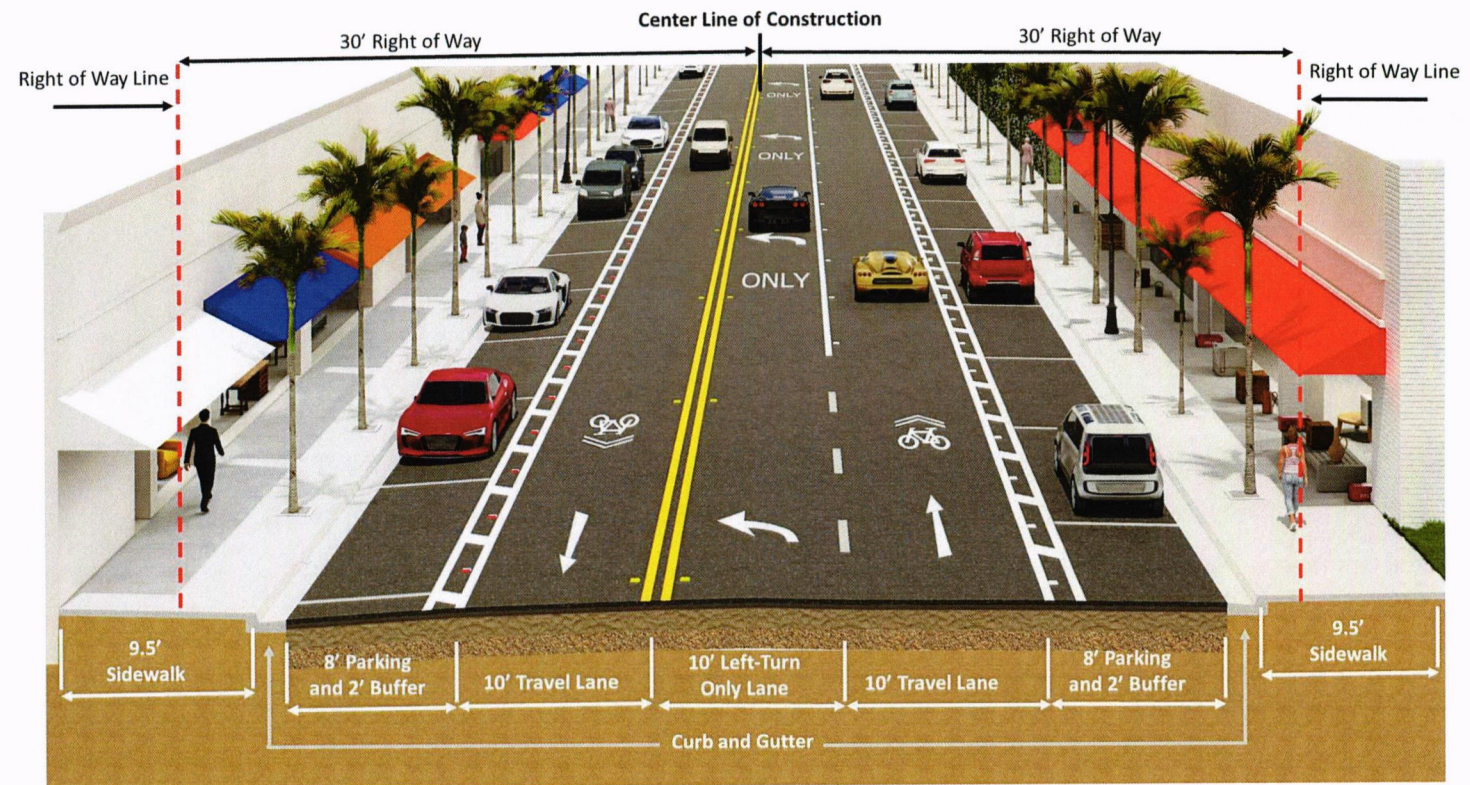



# MAINTENANCE OF TRAFFIC



- During construction, single lane closures will be used to construct the proposed improvements
- Vehicle detours or full road/ intersection closures for drainage and signal improvements
- Temporary impacts to pedestrian traffic will be addressed by temporary pedestrian detours/diversions, as needed





# PROJECT SCHEDULE AND COST



## PROJECT SCHEDULE AND COST



- Estimated construction start date: April 2024
- Anticipated completion date: December 2025



- Estimated construction cost: \$3.5 Million



# QUESTIONS AND COMMENTS





## ADDITIONAL COMMENTS AND QUESTIONS

In-person

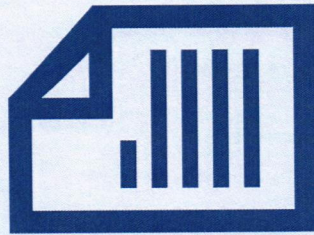

Virtually

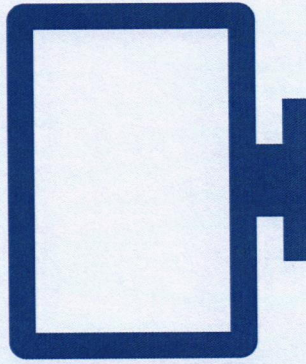

Mail



By phone







## ADDITIONAL COMMENTS AND QUESTIONS

- In-person  
Submit Comment Form
- Virtually  
GoToWebinar: Type your comment in the Questions box
- Contact the FDOT Project Manager directly

To download presentation slides, use the link below:  
[https://www.d4fdot.com/pbfdot/state\\_road\\_a1a\\_from\\_north\\_of\\_emerald\\_beach\\_way\\_to\\_south\\_of\\_sr\\_704\\_royal\\_palm\\_way.asp](https://www.d4fdot.com/pbfdot/state_road_a1a_from_north_of_emerald_beach_way_to_south_of_sr_704_royal_palm_way.asp).

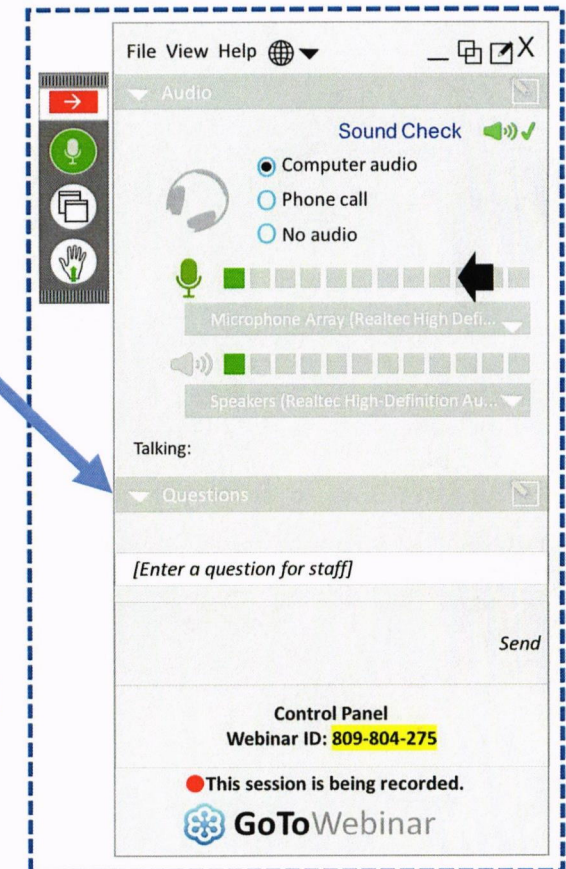





## FDOT PM CONTACT INFORMATION

If you have additional comments or questions, please contact Kenzot Jasmin, P.E., FDOT Project Manager at:

[Kenzot.Jasmin@dot.state.fl.us](mailto:Kenzot.Jasmin@dot.state.fl.us)



Florida Department of Transportation, District Four  
3400 W Commercial Boulevard, Ft. Lauderdale, Florida 33309



(954) 777-4462  
Toll Free: +1(866) 336-8435 ext. 4462







## ADDITIONAL COMMENTS AND QUESTIONS

Please submit your comments by February 21, 2023



If your question was  
not responded to  
during the meeting,  
a response will be  
provided later by mail  
or email

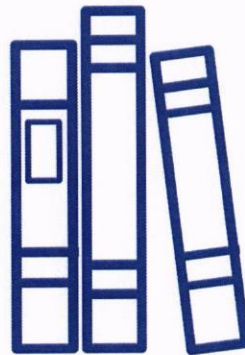

All comments and  
questions are part of  
the **Public Record**



All registrants will  
receive a link to the  
**meeting recording  
and presentation  
slides**



**Thank You for Participating  
in This Public Meeting**



