

This document, together with the concepts and designs presented herein, as an instrument of service, is intended only for the specific purpose and client for which it was prepared. Reuse of and improper reliance on this document without written authorization and adaptation by Kimley-Horn and Associates, Inc. shall be without liability to Kimley-Horn and Associates, Inc.

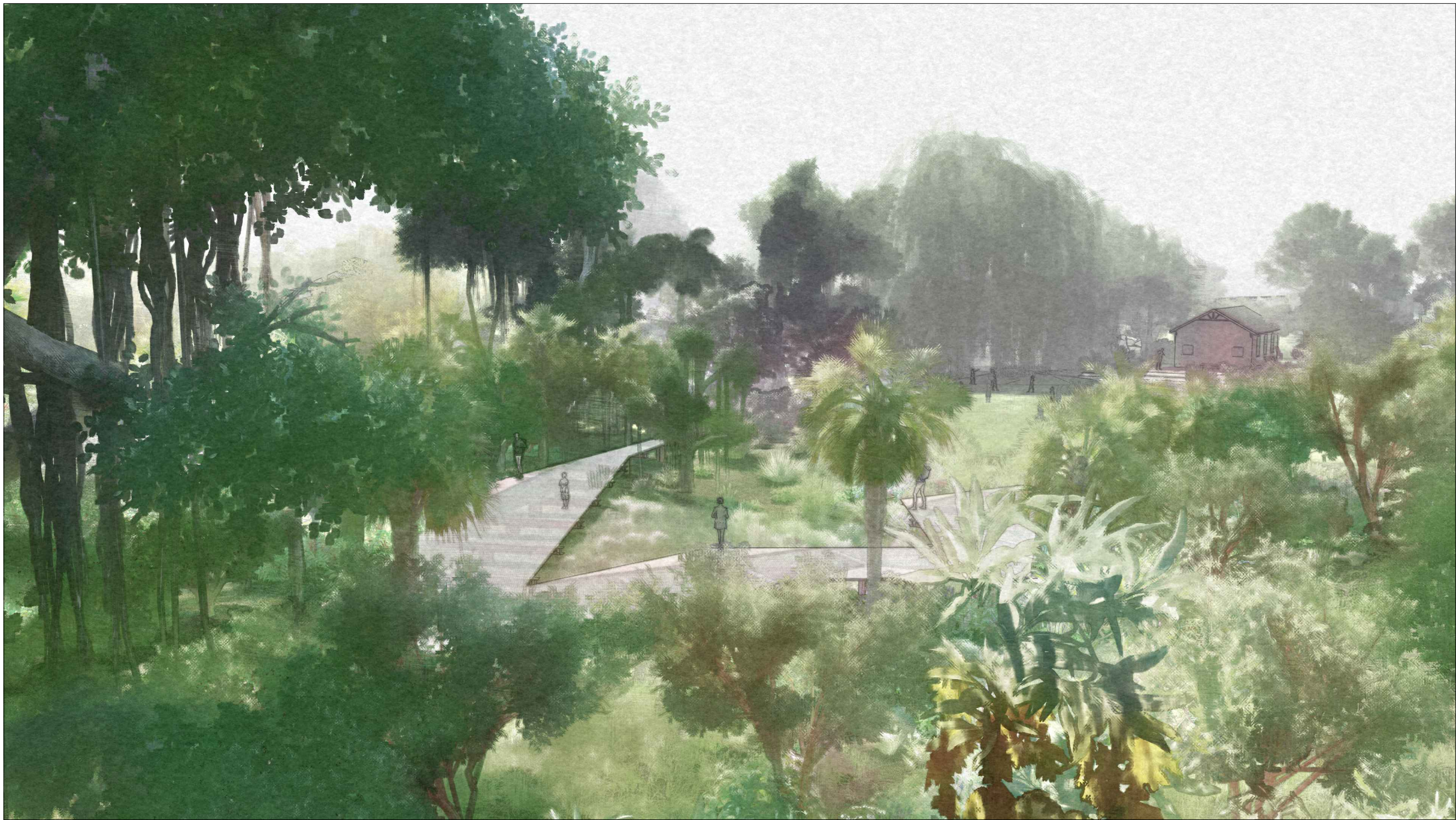

17 WILDFLOWER GARDEN



19 WILDFLOWER GARDEN



18 WILDFLOWER GARDEN



20 THE GREAT LAWN

CIVIL ENGINEER

Kimley»Horn

1920 WEKIVA WAY, SUITE 200,
WEST PALM BEACH, FL 33411
PHONE: 561-845-0665
FAX: 561-863-8175
WWW.KIMLEY-HORN.COM
REGISTRY NO. 35106

ARCHITECT



FAIRFAX & SAMMONS

FAIRFAX, SAMMONS & PARTNERS, LLC
214 BRAZILIAN AVENUE
PALM BEACH, FL 33480
PHONE: (561) 805-8591

LANDSCAPE ARCHITECT

jungles

RAYMOND JUNGLES, INC.

2964 AVIATION AVENUE
MIAMI, FL 33133
PHONE: (305) 858-6777

COA: 22-037
ZON: 22-107

No.	REVISIONS	DATE
-----	-----------	------



PROJECT No.

DATE 10/28/2022

SCALE AS SHOWN

DESIGNED BY

DRAWN BY

CHECKED BY

RENDERINGS



**PHIPPS OCEAN
PARK**
PREPARED FOR
TOWN OF PALM
BEACH

SHEET NUMBER

GI.054



21 PICNIC AREA



22 PICNIC AREA



23 COASTAL RESTORATION CENTER



24 PARKING LOTS

CIVIL ENGINEER

Kimley»Horn

1920 WEKIVA WAY, SUITE 200,
WEST PALM BEACH, FL 33411
PHONE: 561-845-0665
FAX: 561-863-8175
WWW.KIMLEY-HORN.COM
REGISTRY NO. 35106

ARCHITECT



FAIRFAX & SAMMONS

FAIRFAX, SAMMONS & PARTNERS, LLC
214 BRAZILIAN AVENUE
PALM BEACH, FL 33480
PHONE: (561) 805-8591

LANDSCAPE ARCHITECT

jungles

RAYMOND JUNGLES, INC.
2964 AVIATION AVENUE
MIAMI, FL 33133
PHONE: (305) 858-6777

COA: 22-037
ZON: 22-107

No.	REVISIONS	DATE



PROJECT No.

DATE 10/28/2022

SCALE AS SHOWN

DESIGNED BY

DRAWN BY

CHECKED BY

RENDERINGS



**PHIPPS OCEAN
PARK**
PREPARED FOR
TOWN OF PALM
BEACH

SHEET NUMBER

GI.055

This document, together with the concepts and designs presented herein, is intended only for the specific purpose and client for which it was prepared. Reuse of and improper reliance on this document without written authorization and adaptation by Kimley-Horn and Associates, Inc. shall be without liability to Kimley-Horn and Associates, Inc.

This document, together with the concepts and designs presented herein, as an instrument of service, is intended only for the specific purpose and client for which it was prepared. Reuse of and improper reliance on this document without written authorization and adaptation by Kimley-Horn and Associates, Inc. shall be without liability to Kimley-Horn and Associates, Inc.



25 HORIZON PLATEAU



26 HORIZON PLATEAU

CIVIL ENGINEER

Kimley»Horn

1920 WEKIVA WAY, SUITE 200,
WEST PALM BEACH, FL 33411
PHONE: 561-845-0665
FAX: 561-863-8175
WWW.KIMLEY-HORN.COM
REGISTRY NO. 35106

ARCHITECT



FAIRFAX & SAMMONS

FAIRFAX, SAMMONS & PARTNERS, LLC
214 BRAZILIAN AVENUE
PALM BEACH, FL 33480
PHONE: (561) 805-8591

LANDSCAPE ARCHITECT

jungles

RAYMOND JUNGLES, INC.
2964 AVIATION AVENUE
MIAMI, FL 33133
PHONE: (305) 858-6777

COA: 22-037
ZON: 22-107

No.	REVISIONS	DATE

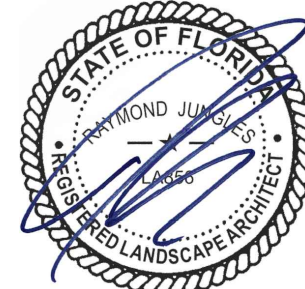

PROJECT No.

DATE 10/28/2022

SCALE AS SHOWN

DESIGNED BY

DRAWN BY

CHECKED BY

RENDERINGS



PHIPPS OCEAN
PARK
PREPARED FOR
TOWN OF PALM
BEACH

SHEET NUMBER
GI.056

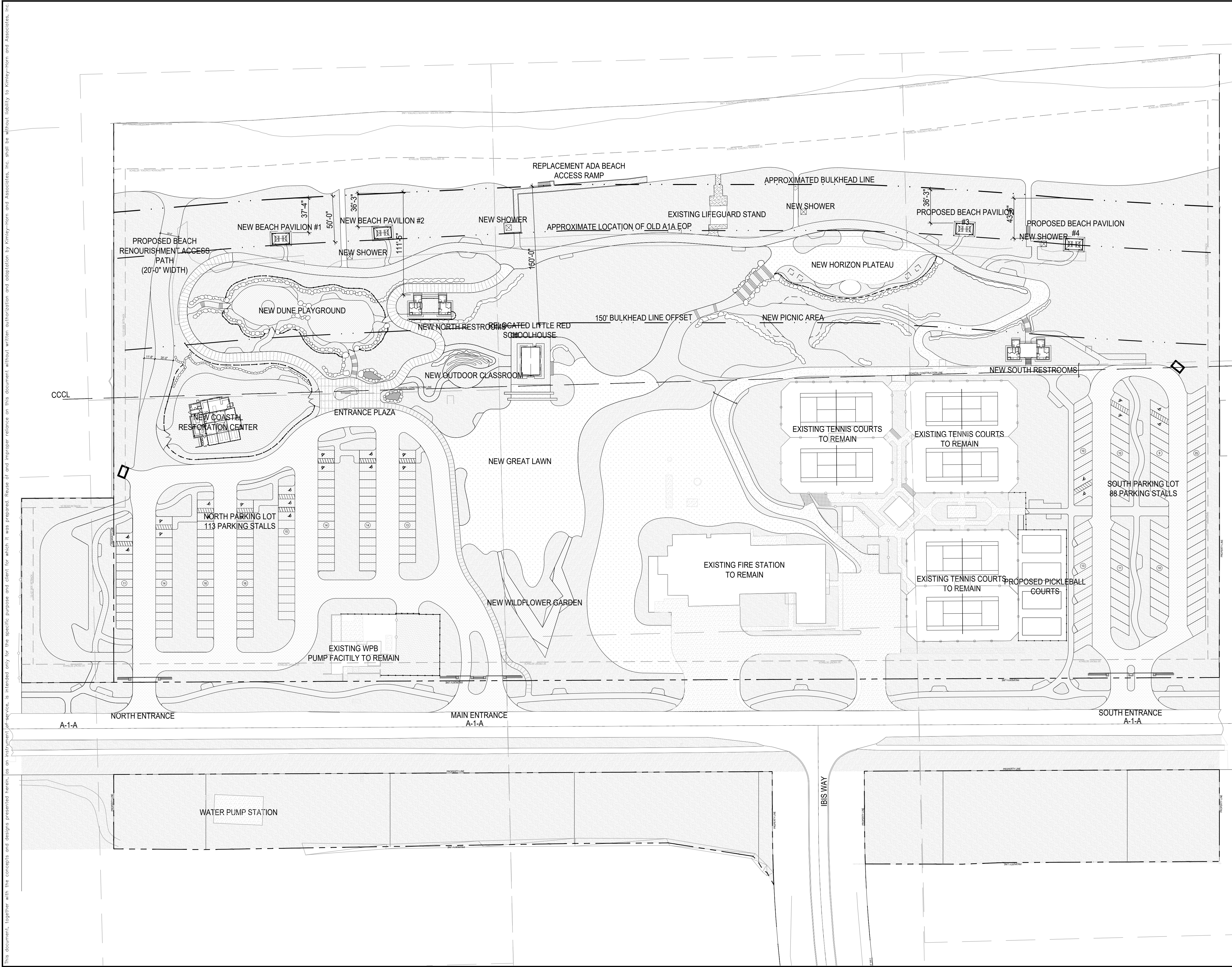

LEGEND
PROPERTY LINE
SETBACK
COASTAL CONSTRUCTION CONTROL LINE

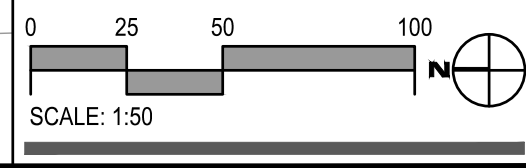

CIVIL ENGINEER

Kimley»Horn

1920 WEKIVA WAY, SUITE 200,
WEST PALM BEACH, FL 33411
PHONE: 561-845-0665
FAX: 561-863-8175
WWW.KIMLEY-HORN.COM
REGISTRY NO. 35106

ARCHITECT

FAIRFAX & SAMMONS
NEW YORK - PALM BEACH

FAIRFAX, SAMMONS & PARTNERS, LLC
214 BRAZILIAN AVENUE
PALM BEACH, FL 33480
PHONE: (561) 805-8591

LANDSCAPE ARCHITECT

jungles

RAYMOND JUNGLES, INC.
2964 AVIATION AVENUE
MIAMI, FL 33133
PHONE: (305) 858-6777

COA: 22-037
ZON: 22-107

No.	REVISIONS	DATE

PROJECT No.

DATE 10/28/2022

SCALE AS SHOWN

DESIGNED BY

DRAWN BY

CHECKED BY

SITE PLAN

SEAL OF THE TOWN OF PALM BEACH, FLORIDA
INCORPORATED APRIL 17, 1911

PHIPPS OCEAN PARK
PREPARED FOR
TOWN OF PALM BEACH

SHEET NUMBER
GI.000