

This document, together with the concepts and designs presented herein, as an instrument of service, is intended only for the specific purpose and client for which it was prepared. Reuse of and improper reliance on this document without written authorization and adaptation by Kimley-Horn and Associates, Inc. shall be without liability to Kimley-Horn and Associates, Inc.

jungles						
Phipps Ocean Park - Master Plan - Tree Disposition List 9/23/2022						
Iden.	Symbol	Scientific Name	Common Name	Disposition	DBH	SPREAD
RJ-33	CER	Conocarpus erectus	Green Buttonwood	Remain	18"	
RJ-34	CER	Conocarpus erectus	Green Buttonwood	Remain	14"	
RJ-35	CER	Conocarpus erectus	Green Buttonwood	Remain	12"	
RJ-36	PDA	Phoenix dactylifera 'Medjool'	Medjool Date Palm	Remain	15"	
RJ-37	CER	Conocarpus erectus	Green Buttonwood	Remain	12"	
RJ-38	CER	Conocarpus erectus	Green Buttonwood	Remain	10"	
RJ-39	CER	Conocarpus erectus	Green Buttonwood	Remain	12"	
RJ-40	CER	Conocarpus erectus	Green Buttonwood	Remain	12"	
RJ-41	CER	Conocarpus erectus	Green Buttonwood	Remain	6"	
RJ-42	CER	Conocarpus erectus	Green Buttonwood	Remain	12"	
RJ-43	PDA	Phoenix dactylifera 'Medjool'	Medjool Date Palm	Remain	12"	
RJ-44	PDA	Phoenix dactylifera 'Medjool'	Medjool Date Palm	Remain	12"	
RJ-45	CER	Conocarpus erectus	Green Buttonwood	Remain	12"	
RJ-46	CER	Conocarpus erectus	Green Buttonwood	Remain	14"	
RJ-47	CER	Conocarpus erectus	Green Buttonwood	Remain	12"	
RJ-48	CER	Conocarpus erectus	Green Buttonwood	Remain	12"	
RJ-49	CER	Conocarpus erectus	Green Buttonwood	Remain	12"	
RJ-50	PDA	Phoenix dactylifera 'Medjool'	Medjool Date Palm	Remain	20"	
RJ-51	PDA	Phoenix dactylifera 'Medjool'	Medjool Date Palm	Remain	14"	
RJ-52	PDA	Phoenix dactylifera 'Medjool'	Medjool Date Palm	Remain	14"	
RJ-53	CER	Conocarpus erectus	Green Buttonwood	Remain	14"	
RJ-54	CER	Conocarpus erectus	Green Buttonwood	Remain	12"	
RJ-55	CER	Conocarpus erectus	Green Buttonwood	Remain	10"	
RJ-56	CER	Conocarpus erectus	Green Buttonwood	Remain	10"	
RJ-57	CER	Conocarpus erectus	Green Buttonwood	Remain	15"	
RJ-58	CER	Conocarpus erectus	Green Buttonwood	Remain	12"	
RJ-59	CER	Conocarpus erectus	Green Buttonwood	Remain	14"	
RJ-60	CER	Conocarpus erectus	Green Buttonwood	Remain	12"	
RJ-61	PDA	Phoenix dactylifera 'Medjool'	Medjool Date Palm	Remain	24"	
RJ-62	PDA	Phoenix dactylifera 'Medjool'	Medjool Date Palm	Remain	12"	
RJ-63	PDA	Phoenix dactylifera 'Medjool'	Medjool Date Palm	Remain	12"	
RJ-64	PDA	Phoenix dactylifera 'Medjool'	Medjool Date Palm	Remain	12"	
RJ-65	PDA	Phoenix dactylifera 'Medjool'	Medjool Date Palm	Remain	15"	
RJ-66	CER	Conocarpus erectus	Green Buttonwood	Remain	12"	
RJ-67	PDA	Phoenix dactylifera 'Medjool'	Medjool Date Palm	Remain	15"	
RJ-68	PDA	Phoenix dactylifera 'Medjool'	Medjool Date Palm	Remain	18"	
RJ-69	PDA	Phoenix dactylifera 'Medjool'	Medjool Date Palm	Remain	15"	
RJ-70	CER	Conocarpus erectus	Green Buttonwood	Remain	12"	
RJ-71	CER	Conocarpus erectus	Green Buttonwood	Remain	20"	
RJ-72	CER	Conocarpus erectus	Green Buttonwood	Remain	24"	
RJ-73	CER	Conocarpus erectus	Green Buttonwood	Remain	30"	
RJ-74	CER	Conocarpus erectus	Green Buttonwood	Remain	12"	
RJ-75	CER	Conocarpus erectus	Green Buttonwood	Remain	48"	
RJ-76	CER	Conocarpus erectus	Green Buttonwood	Remain	36"	
RJ-77	CER	Conocarpus erectus	Green Buttonwood	Remain	15"	
RJ-78	CER	Conocarpus erectus	Green Buttonwood	Remain	36"	
RJ-79	CER	Conocarpus erectus	Green Buttonwood	Remain	30"	
RJ-80	CER	Conocarpus erectus	Green Buttonwood	Remain	14"	
RJ-81	PDA	Phoenix dactylifera 'Medjool'	Medjool Date Palm	Remain	15"	
RJ-82	CER	Conocarpus erectus	Green Buttonwood	Remain	12"	
RJ-83	CER	Conocarpus erectus	Green Buttonwood	Remain	12"	
RJ-84	CER	Conocarpus erectus	Green Buttonwood	Remain	14"	
RJ-85	CER	Conocarpus erectus	Green Buttonwood	Remain	14"	
RJ-86	CER	Conocarpus erectus	Green Buttonwood	Remain	12"	
RJ-87	PDA	Phoenix dactylifera 'Medjool'	Medjool Date Palm	Remain	14"	
RJ-88	PDA	Phoenix dactylifera 'Medjool'	Medjool Date Palm	Remain	14"	
RJ-89	PDA	Phoenix dactylifera 'Medjool'	Medjool Date Palm	Remain	12"	
RJ-90	CER	Conocarpus erectus	Green Buttonwood	Remain	15"	
RJ-91	CER	Conocarpus erectus	Green Buttonwood	Remain	8"	
RJ-92	PDA	Phoenix dactylifera 'Medjool'	Medjool Date Palm	Remain	24"	
RJ-93	PDA	Phoenix dactylifera 'Medjool'	Medjool Date Palm	Remain	12"	
RJ-94	PDA	Phoenix dactylifera 'Medjool'	Medjool Date Palm	Remain	30"	
RJ-95	CER	Conocarpus erectus	Green Buttonwood	Remain	12"	
RJ-96	CER	Conocarpus erectus	Green Buttonwood	Remain	14"	
RJ-97	CER	Conocarpus erectus	Green Buttonwood	Remain	12"	
RJ-98	CER	Conocarpus erectus	Green Buttonwood	Remain	15"	
RJ-99	CER	Conocarpus erectus	Green Buttonwood	Remain	14"	
RJ-100	PDA	Phoenix dactylifera 'Medjool'	Medjool Date Palm	Remain	24"	
RJ-101	PDA	Phoenix dactylifera 'Medjool'	Medjool Date Palm	Remain	15"	
RJ-102	PDA	Phoenix dactylifera 'Medjool'	Medjool Date Palm	Remain	12"	
RJ-103	PDA	Phoenix dactylifera 'Medjool'	Medjool Date Palm	Remain	18"	
RJ-104	PDA	Phoenix dactylifera 'Medjool'	Medjool Date Palm	Remain	15"	
RJ-105	CER	Conocarpus erectus	Green Buttonwood	Remain	12"	
RJ-106	CER	Conocarpus erectus	Green Buttonwood	Remain	14"	
RJ-107	CER	Conocarpus erectus	Green Buttonwood	Remain	15"	
RJ-108	SPA	Sabal palmetto	Sabal Palm	Remain	14"	
RJ-109	CER	Conocarpus erectus	Green Buttonwood	Remain	15"	
RJ-110	CER	Conocarpus erectus	Green Buttonwood	Remain	18"	
RJ-111	CER	Conocarpus erectus	Green Buttonwood	Remain	14"	
RJ-112	CER	Conocarpus erectus	Green Buttonwood	Remain	15"	
RJ-113	CER	Conocarpus erectus	Green Buttonwood	Remain	25"	
RJ-114	CER	Conocarpus erectus	Green Buttonwood	Remain	12"	
RJ-115	CER	Conocarpus erectus	Green Buttonwood	Remain	12"	
RJ-116	CER	Conocarpus erectus	Green Buttonwood	Remain	12"	
RJ-117	SPA	Sabal palmetto	Sabal Palm	Remain	12"	
RJ-118	CER	Conocarpus erectus	Green Buttonwood	Remain	14"	
RJ-119	CER	Conocarpus erectus	Green Buttonwood	Remain	14"	
RJ-120	CSP	Casuarina spp.	Australian Pine	Remove	6"	
RJ-121	CSP	Casuarina spp.	Australian Pine	Remove	8"	
RJ-122	CSP	Casuarina spp.	Australian Pine	Remove	6"	
RJ-123	CSP	Casuarina spp.	Australian Pine	Remove	6"	
RJ-124	CSP	Casuarina spp.	Australian Pine	Remove	6"	
RJ-125	CSP	Casuarina spp.	Australian Pine	Remove	8"	
RJ-126	CSP	Casuarina spp.	Australian Pine	Remove	6"	
RJ-127	CSP	Casuarina spp.	Australian Pine	Remove	8"	
RJ-128	CSP	Casuarina spp.	Australian Pine	Remove	8"	
RJ-129	SPA	Sabal palmetto	Sabal Palm	Relocate	16"	
RJ-130	SPA	Sabal palmetto	Sabal Palm	Relocate	16"	
RJ-131	SPA	Sabal palmetto	Sabal Palm	Remain	10"	
RJ-132	SPA	Sabal palmetto	Sabal Palm	Remain	12"	

jungles						
Phipps Ocean Park - Master Plan - Tree Disposition List 9/23/2022						
Iden.	Symbol	Scientific Name	Common Name	Disposition	DBH	SPREAD
RJ-133	SPA	Sabal palmetto	Sabal Palm	Remain	18"	
RJ-134	SPA	Sabal palmetto	Sabal Palm	Remain	10"	
RJ-135	SPA	Sabal palmetto	Sabal Palm	Remove	10"	
RJ-136	SPA	Sabal palmetto	Sabal Palm	Remain	12"	
RJ-137	SPA	Sabal palmetto	Sabal Palm	Remain	10"	
RJ-138	SPA	Sabal palmetto	Sabal Palm	Remain	12"	
RJ-139	SPA	Sabal palmetto	Sabal Palm	Remain	12"	
RJ-140	SPA	Sabal palmetto	Sabal Palm	Remove	12"	
RJ-141	SPA	Sabal palmetto	Sabal Palm	Relocate	18"	
RJ-142	SPA	Sabal palmetto	Sabal Palm	Remove	10"	
RJ-143	CUV	Coccoloba uvifera	Seagrape	Relocate	10"	
RJ-144	SPA	Sabal palmetto	Sabal Palm	Relocate	10"	
RJ-145	SPA	Sabal palmetto	Sabal Palm	Relocate	8"	
RJ-146	SPA	Sabal palmetto	Sabal Palm	Remain	6"	
RJ-147	SPA	Sabal palmetto	Sabal Palm	Remain	10"	
RJ-148	SPA	Sabal palmetto	Sabal Palm	Remain	10"	
RJ-149	SPA	Sabal palmetto	Sabal Palm	Remain	14"	
RJ-150	SPA	Sabal palmetto	Sabal Palm	Remain	14"	
RJ-151	SPA	Sabal palmetto	Sabal Palm	Remain	14"	
RJ-152	SPA	Sabal palmetto	Sabal Palm	Relocate	16"	
RJ-153	CSP	Casuarina spp.	Australian Pine	Remove	6"	
RJ-154	CER	Conocarpus erectus	Green Buttonwood	Remain	36"	
RJ-155	CER	Conocarpus erectus	Green Buttonwood	Remain	36"	
RJ-156	CSP	Casuarina spp.	Australian Pine	Remove	6"	
RJ-157	CER	Conocarpus erectus	Green Buttonwood	Remain	14"	
RJ-158	CSP	Casuarina spp.	Australian Pine	Remove	6"	
RJ-159	CSP	Casuarina spp.	Australian Pine	Remove	6"	
RJ-160	CSP	Casuarina spp.	Australian Pine	Remove	6"	
RJ-161	CSP	Casuarina spp.	Australian Pine	Remove	6"	
RJ-162	CSP	Casuarina spp.	Australian Pine	Remove	6"	
RJ-163	CSP	Casuarina spp.	Australian Pine	Remove	6"	
RJ-164	CSP	Casuarina spp.	Australian Pine	Remove	6"	
RJ-165	CSP	Casuarina spp.	Australian Pine	Remove	6"	
RJ-166	CSP	Casuarina spp.	Australian Pine	Remove	6"	
RJ-167	CER	Conocarpus erectus	Green Buttonwood	Remain	12"	
RJ-168	CSP	Casuarina spp.	Australian Pine	Remove	6"	
RJ-169	CER	Conocarpus erectus	Green Buttonwood	Remain	18"	
RJ-170	CSP	Casuarina spp.	Australian Pine	Remove	6"	
RJ-171	CSP	Casuarina spp.	Australian Pine	Remove	6"	
RJ-172	CSP	Casuarina spp.	Australian Pine	Remove	6"	
RJ-173	CSP	Casuarina spp.	Australian Pine	Remove	6"	
RJ-174	CSP	Casuarina spp.	Australian Pine	Remove	6"	
RJ-175	CSP	Casuarina spp.	Australian Pine	Remove	4"	
RJ-176	CSP	Casuarina spp.	Australian Pine	Remove	6"	
RJ-177	CER	Conocarpus erectus	Green Buttonwood	Remain	14"	
RJ-178	CSP	Casuarina spp.	Australian Pine	Remove	6"	
RJ-179	CSP	Casuarina spp.	Australian Pine	Remove	6"	
RJ-180	CSP	Casuarina spp.	Australian Pine	Remove	6"	
RJ-181	CSP	Casuarina spp.	Australian Pine	Remove	6"	
RJ-182	CSP	Casuarina spp.	Australian Pine	Remove	6"	
RJ-183	CSP	Casuarina spp.	Australian Pine	Remove	4"	
RJ-184	CSP	Casuarina spp.	Australian Pine	Remove	6"	
RJ-185	CSP	Casuarina spp.	Australian Pine	Remove	6"	
RJ-186	CUV	Coccoloba uvifera	Seagrape	Relocate	12"	
RJ-187	AME	Adonidia merrillii	Christmas / Manila Palm	Remove	3-6"	
RJ-188	AME	Adonidia merrillii	Christmas / Manila Palm	Remove	3-6"	
RJ-189	AME	Adonidia merrillii	Christmas / Manila Palm	Remove	2-6"	
RJ-190	AME	Adonidia merrillii	Christmas / Manila Palm	Remove	2-6"	
RJ-191	AME	Adonidia merrillii	Christmas / Manila Palm	Remove	2-6"	
RJ-192	AME	Adonidia merrillii	Christmas / Manila Palm	Remove	2-6"	
RJ-193	CER	Conocarpus erectus	Green Buttonwood	Remain	36"	
RJ-194	CER	Conocarpus erectus	Green Buttonwood	Remain	36"	
RJ-195	FSP	Ficus aurea	Strangler Fig	Remain	120"	
RJ-196	CUV	Coccoloba uvifera	Seagrape	Remain	12"	
RJ-197	CUV	Coccoloba uvifera	Seagrape	Remain	36"	
RJ-198	CUV	Coccoloba uvifera	Seagrape	Remain	6"	
RJ-199	CUV	Coccoloba uvifera	Seagrape	Remain	6"	
RJ-200	CUV	Coccoloba uvifera	Seagrape	Remain	6"	
RJ-201	CUV	Coccoloba uvifera	Seagrape	Remain	4"	
RJ-202	CUV	Coccoloba uvifera	Seagrape	Remain	6"	
RJ-203	CUV	Coccoloba uvifera	Seagrape	Remain	6"	
RJ-204	SPA	Sabal palmetto	Sabal Palm	Remain	12"	
RJ-205	CUV	Coccoloba uvifera	Seagrape	Remain	6"	
RJ-206	CUV	Coccoloba uvifera	Seagrape	Remain	10"	
RJ-207	CUV	Coccoloba uvifera	Seagrape	Remain	12"	
RJ-208	CUV	Coccoloba uvifera	Seagrape	Remain	8"	
RJ-209	SPA	Sabal palmetto	Sabal Palm	Remain	8"	
RJ-210	SPA	Sabal palmetto	Sabal Palm	Remain	12"	
RJ-211	CUV	Coccoloba uvifera	Seagrape	Remain	30"	
RJ-212	CUV	Coccoloba uvifera	Seagrape	Remain	10"	
RJ-213	CUV	Coccoloba uvifera	Seagrape	Remain	30"	
RJ-214	CUV	Coccoloba uvifera	Seagrape	Remain	14"	
RJ-215	CUV	Coccoloba uvifera	Seagrape	Remain	10"	
RJ-216	SPA	Sabal palmetto	Sabal Palm	Remain	10"	
RJ-217	CUV	Coccoloba uvifera	Seagrape	Remain	6"	
RJ-218	CUV	Coccoloba uvifera	Seagrape	Remain	30"	
RJ-219	SPA	Sabal palmetto	Sabal Palm	Remain	12"	
RJ-220	SPA	Sabal palmetto	Sabal Palm	Remain	12"	
RJ-221	CUV	Coccoloba uvifera	Seagrape	Remain	48"	
RJ-222	PEL	Ptychosperma elegans	Solitaire Palm	Remove	4"	
RJ-223	BSI	Bursera simaruba	Gumbo Limbo	Remain	18"	
RJ-224	CBR	Calophyllum brasiliense	Brazil Beauty Leaf	Relocate	12"	
RJ-225	CER	Conocarpus erectus	Silver Buttonwood	Remain	6"	
RJ-226	CER	Conocarpus erectus	Silver Buttonwood	Remain	6"	
RJ-227	CER	Conocarpus erectus	Silver Buttonwood	Remain	12"	
RJ-228	CER	Conocarpus erectus	Silver Buttonwood	Remain	12"	
RJ-229	CER	Conocarpus erectus	Silver Buttonwood	Remain	12"	
RJ-230	CER	Conocarpus erectus	Silver Buttonwood	Remain	12"	
RJ-231	CER	Conocarpus erectus	Silver Buttonwood	Remain	12"	
RJ-232	CER	Conocarpus erectus	Silver Buttonwood	Remain	12"	

jungles						
Phinos Ocean Park - Master Plan - Tree Disposition List						
9/23/2022						
Iden.	Symbol	Scientific Name	Common Name	Disposition	DBH	SPREAD
RJ-233	CER	Conocarpus erectus	Silver Buttonwood	Remain	12"	
RJ-234	CER	Conocarpus erectus	Silver Buttonwood	Remain	12"	
RJ-235	CER	Conocarpus erectus	Silver Buttonwood	Remain	12"	
RJ-236	CER	Conocarpus erectus	Silver Buttonwood	Remain	12"	
RJ-237	CER	Conocarpus erectus	Silver Buttonwood	Remain	12"	
RJ-238	CER	Conocarpus erectus	Silver Buttonwood	Remain	12"	
RJ-239	CER	Conocarpus erectus	Silver Buttonwood	Remain	12"	
RJ-240	CER	Conocarpus erectus	Silver Buttonwood	Remain	12"	
RJ-241	CER	Conocarpus erectus	Silver Buttonwood	Remain	12"	
RJ-242	CER	Conocarpus erectus	Silver Buttonwood	Remain	12"	
RJ-243	CER	Conocarpus erectus	Silver Buttonwood	Remain	12"	
RJ-244	CER	Conocarpus erectus	Silver Buttonwood	Remain	12"	
RJ-245	CER	Conocarpus erectus	Silver Buttonwood	Remain	12"	
RJ-246	CER	Conocarpus erectus	Silver Buttonwood	Remain	12"	
RJ-247	CER	Conocarpus erectus	Silver Buttonwood	Remain	12"	
RJ-248	CER	Conocarpus erectus	Silver Buttonwood	Remain	12"	
RJ-249	CER	Conocarpus erectus	Silver Buttonwood	Remain	12"	
RJ-250	CER	Conocarpus erectus	Silver Buttonwood	Remain	12"	
RJ-251	CER	Conocarpus erectus	Silver Buttonwood	Remain	12"	
RJ-252	CER	Conocarpus erectus	Silver Buttonwood	Remain	12"	
RJ-253	CER	Conocarpus erectus	Silver Buttonwood	Remain	12"	
RJ-254	CER	Conocarpus erectus	Silver Buttonwood	Remain	12"	
RJ-255	CER	Conocarpus erectus	Silver Buttonwood	Remain	12"	
RJ-256	CER	Conocarpus erectus	Silver Buttonwood	Remain	12"	
RJ-257	CER	Conocarpus erectus	Silver Buttonwood	Remain	12"	
RJ-258	CER	Conocarpus erectus	Silver Buttonwood	Remain	12"	
RJ-259	CER	Conocarpus erectus	Silver Buttonwood	Remain	12"	
RJ-260	CER	Conocarpus erectus	Silver Buttonwood	Remain	12"	
RJ-261	CER	Conocarpus erectus	Silver Buttonwood	Remain	12"	
RJ-262	CER	Conocarpus erectus	Silver Buttonwood	Remain	12"	
RJ-263	CER	Conocarpus erectus	Silver Buttonwood	Remain	12"	
RJ-264	CER	Conocarpus erectus	Silver Buttonwood	Remain	12"	
RJ-265	CER	Conocarpus erectus	Silver Buttonwood	Remain	6"	
RJ-266	CER	Conocarpus erectus	Silver Buttonwood	Remain	6"	
RJ-267	CER	Conocarpus erectus	Silver Buttonwood	Remain	6"	
1005	SPA	Sabal palmetto	Sabal Palm	Remain	12"	
1006	CUV	Coccoloba uvifera	Seagrape	Relocate	14"	
1007	CUV	Coccoloba uvifera	Seagrape	Remain	16"	
1008	SPA	Sabal palmetto	Sabal Palm	Remove	12"	
1009	SPA	Sabal palmetto	Sabal Palm	Remain	12"	
1010	CUV	Coccoloba uvifera	Seagrape	Remain	18"	
1011	CUV	Coccoloba uvifera	Seagrape	Remain	18"	
1012	CUV	Coccoloba uvifera	Seagrape	Remain	14"	
1013	CUV	Coccoloba uvifera	Seagrape	Remain	12"	
1014	CUV	Coccoloba uvifera	Seagrape	Remain	20"	
1015	SPA	Sabal palmetto	Sabal Palm	Remain	12"	
1016	SPA	Sabal palmetto	Sabal Palm	Remain	14"	
1017	CUV	Coccoloba uvifera	Seagrape	Remain	14"	
1018	CUV	Coccoloba uvifera	Seagrape	Remain	8"	
1019	SPA	Sabal palmetto	Sabal Palm	Remain	13"	
1020	SPA	Sabal palmetto	Sabal Palm	Remain	13"	
1021	CUV	Coccoloba uvifera	Seagrape	Remain	18"	
1022	CUV	Coccoloba uvifera	Seagrape	Remain	16"	
1023	CUV	Coccoloba uvifera	Seagrape	Remain	28"	
1024	SPA	Sabal palmetto	Sabal Palm	Remain	14"	
Total Remain 484						
Total Relocate 292						
Total Remove 79						

This document, together with the concepts and designs presented herein, as an instrument of service, is intended only for the specific purpose and client for which it was prepared. Reuse of and improper reliance on this document without written authorization and adaptation by Kimley-Horn and Associates, Inc. shall be without liability to Kimley-Horn and Associates, Inc.

TREE / PALM PROTECTION NOTES

1. CONTRACTOR QUALIFICATIONS

- 1.1. CONTRACTOR MUST BE A LICENSED LANDSCAPE CONTRACTOR.
- 1.2. CONTRACTOR MUST HAVE A MINIMUM OF 10 YEARS OF PROVEN EXPERIENCE RELOCATING LARGE SPECIMEN TREES AND PALMS IN SOUTH FLORIDA.
- 1.3. CONTRACTOR MUST HAVE PROVEN EXPERIENCE RELOCATING TREES AND PALMS OF THE SAME SPECIES AND SIZE AS THOSE TO BE RELOCATED FOR THE CURRENT PROJECT.
- 1.4. CONTRACTOR MUST HAVE A CERTIFIED ARBORIST ON STAFF.

2. CONTRACTOR REQUIREMENTS

- 2.1. CONTRACTOR MUST VISIT THE JOBSITE AND INSPECT ALL TREES AND PALMS TO BE RELOCATED AS WELL AS EXISTING SITE CONDITIONS AND RESTRICTIONS PRIOR TO PREPARING BID.
- 2.2. CONTRACTOR MUST VERIFY AND ENSURE THAT ALL TREES AND PALMS IDENTIFIED ON THE PLANS AND THOSE TAGGED ON THE JOBSITE CORRESPOND AS TO NUMBER AND DESCRIPTION. ANY DISCREPANCIES MUST BE BROUGHT TO THE ATTENTION OF THE LANDSCAPE ARCHITECT IMMEDIATELY, PRIOR TO PREPARING BID.
- 2.3. CONTRACTOR MUST CONDUCT ALL WORK ASSOCIATED WITH RELOCATION AND MAINTENANCE OF TREES AND PALMS TO BE RELOCATED. NO WORK IS TO BE SUBCONTRACTED WITHOUT PRIOR WRITTEN CONSENT OF THE OWNER AND/OR LANDSCAPE ARCHITECT.
- 2.4. CONTRACTOR MUST DESIGNATE A COMPETENT, ENGLISH-SPEAKING SUPERVISOR OR FOREMAN TO OVERSEE AND DIRECT ALL RELOCATION AND MAINTENANCE ACTIVITIES AS OUTLINED IN THESE SPECIFICATIONS.
- 2.5. CONTRACTOR MUST SCHEDULE ROOT PRUNING TO PROVIDE THE MAXIMUM POSSIBLE TIME FOR NEW ROOT GROWTH. EVEN TREES AND PALMS THAT TYPICALLY DO NOT REQUIRE LONG (OR ANY) ROOT PRUNING WILL BENEFIT FROM MORE ROOT PRUNING TIME; THEREFORE, ALL TREES AND PALMS TO BE RELOCATED MUST BE ROOT PRUNED. CONTRACTOR MUST PROVIDE A ROOT PRUNE SCHEDULE FOR EACH TREE OR PALM TO BE RELOCATED AS AN ATTACHMENT TO THE BID.
- 2.6. CONTRACTOR MUST CALL SUNSHINE 811 TO HAVE ALL UNDERGROUND UTILITIES LOCATED UNDER OR IN THE VICINITY OF THE CURRENT OR FUTURE LOCATIONS OF ALL TREES AND PALMS TO BE RELOCATED PRIOR TO WORK COMMENCING.
- 2.7. CONTRACTOR MUST VERIFY WITH THE GENERAL CONTRACTOR THE ABSENCE OF ANY UNDERGROUND CONSTRUCTION OR OBSTRUCTIONS (E.G., BULKHEADS, SEPTIC SYSTEMS, ETC.) IN THE CURRENT AND FUTURE LOCATIONS OF ALL TREES AND PALMS TO BE RELOCATED.
- 2.8. CONTRACTOR MUST ALERT THE LANDSCAPE ARCHITECT OF ANY TREES OR PALMS THAT WILL NOT SUCCESSFULLY RELOCATE DUE TO POOR HEALTH PRIOR TO BEGINNING ROOT PRUNING.
- 2.9. CONTRACTOR MUST FLAG ALL PROPOSED TRANSPLANT LOCATIONS FOR THE LANDSCAPE ARCHITECT'S APPROVAL A MINIMUM OF 15 DAYS PRIOR TO RELOCATION.
- 2.10. CONTRACTOR MUST ENSURE THAT ALL TREES AND PALMS TO BE RELOCATED ARE INSTALLED AT THE CORRECT GRADE OR ELEVATION, ACCORDING TO THE GRADING PLAN.
- 2.11. CONTRACTOR MUST ENSURE THAT ALL ROOT FLARES ARE EXPOSED AFTER RELOCATION.
- 2.12. CONTRACTOR MUST REMOVE ALL RESIDUAL ROOTS, STUMPS, AND PORTIONS THEREOF AND BACKFILL PITS FROM WHICH RELOCATED TREES AND PALMS WERE REMOVED WITH CLEAN FILL FLUSH WITH THE SURROUNDING GRADE.
- 2.13. CONTRACTOR MUST REPAIR ANY DAMAGE TO OTHER PLANTS, LAWN, HARDSCAPES, OR NEW CONSTRUCTION WITHIN THE RELOCATION AREA AT CONTRACTOR'S EXPENSE. HARDSCAPES INCLUDE BUT ARE NOT LIMITED TO CURBS, WALKS, ROADS, FENCES, SITE FURNISHINGS, ETC.
- 2.14. CONTRACTOR MUST PHOTOGRAPHICALLY DOCUMENT NEW ROOT GROWTH FOLLOWING EACH ROOT PRUNE AND SUBMIT THIS DOCUMENTATION TO THE LANDSCAPE ARCHITECT. THE PURPOSE OF THIS REQUIREMENT IS TO ENSURE THAT SUFFICIENT ROOT GROWTH HAS OCCURRED PRIOR TO THE SECOND AND SUBSEQUENT ROOT PRUNES AND FOLLOWING THE FINAL ROOT PRUNE PRIOR TO RELOCATION.
- 2.15. CONTRACTOR MUST INSTALL AND MAINTAIN PROTECTION FENCING AROUND EACH TREE AND PALM TO BE RELOCATED BOTH DURING ROOT PRUNING AND AFTER RELOCATION. PROTECTION FENCING MUST CONSIST OF GALVANIZED WELDED WIRE FABRIC OR PLASTIC MESH ATTACHED TO 4" X 4" POSTS INSERTED AROUND THE PERIMETER OF THE DRIPLINE OF THE TREE OR PALM. PROTECTION FENCING MUST BE PLUMB, TAUT, AND STURDY AT ALL TIMES AND MUST REMAIN IN PLACE THROUGHOUT THE ROOT PRUNING AND WARRANTY PERIODS, OR AS DIRECTED BY THE LANDSCAPE ARCHITECT.
- 2.16. CONTRACTOR MUST OBTAIN ALL NECESSARY OR REQUIRED PERMITS FOR THE RELOCATION AND TRANSPORTATION OF THE TREES AND PALMS TO BE RELOCATED.
- 2.17. CONTRACTOR MUST REPLACE ANY TREES OR PALMS SCARRED OR DAMAGED DURING RELOCATION, AT THE CONTRACTOR'S EXPENSE, WITH THE SAME OR SIMILAR SPECIES, SIZE, AND QUALITY. REPLACEMENT TREES OR PALMS MUST BE APPROVED BY THE LANDSCAPE ARCHITECT PRIOR TO PROCUREMENT, PREPARATION, AND/OR INSTALLATION. REPLACEMENT TREES AND PALMS MUST BE INSTALLED WITHIN 60 DAYS OF NOTICE.
- 2.18. CONTRACTOR MUST GUARANTEE ALL RELOCATED TREES AND PALMS FOR ONE YEAR FROM THE DATE OF RELOCATION TO THE FINAL LOCATION. GUARANTEE MUST INCLUDE TREE HEALTH AND SETTLING.
- 2.19. CONTRACTOR MUST PROVIDE ALL MATERIAL NECESSARY TO PERFORM THE WORK COVERED HEREIN, INCLUDING BUT NOT LIMITED TO: BACKFILL MATERIAL, PROTECTION FENCING, FLAGGING, ADDITIVES AND SUPPLEMENTS, TEMPORARY IRRIGATION, BURLAP, WIRE, SHRINK WRAP, AND ALL NECESSARY TOOLS AND EQUIPMENT.

3. ROOT PRUNING SPECIFICATIONS

3.1. GENERAL

- 3.1.1. ALL TREES AND PALMS TO BE RELOCATED MUST BE WATERED DAILY FOR AT LEAST 2-3 DAYS PRIOR TO ANY ROOTS BEING CUT TO ENSURE THAT THEY ARE FULLY HYDRATED. EACH WATERING MUST THOROUGHLY SATURATE THE ROOTBALL TO ITS FULL DEPTH.
- 3.1.2. EACH TREE AND PALM MUST THEN BE WATERED EVERY OTHER DAY, NOT RELYING ON RAIN, DURING THE ENTIRE ROOT PRUNING PROCESS EITHER BY A TEMPORARY IRRIGATION SYSTEM OR BY HAND. EACH WATERING MUST THOROUGHLY SATURATE THE ROOTBALL TO ITS FULL DEPTH.
- 3.1.3. TREE AND PALM RELOCATION ACTIVITIES MUST BE SCHEDULED SO THAT REMOVAL AND REPLANTING TAKE PLACE IN THE SAME 24-HOUR PERIOD. NO TREES OR PALMS MAY BE "STOCKPILED" ONSITE OR OFFSITE FOR ANY PERIOD OF TIME WITHOUT PRIOR WRITTEN APPROVAL OF THE LANDSCAPE ARCHITECT. WHEN ALLOWED, APPROVAL FOR THE METHOD OF "STOCKPIILING" MUST BE OBTAINED FROM THE LANDSCAPE ARCHITECT.
- 3.1.4. ALL DIGGING IN THE ROOT ZONE DURING THE ROOT PRUNE PROCESS MUST BE DONE BY HAND; NO MACHINERY WILL BE ALLOWED. PRUNING OF ROOTS MUST BE DONE BY HAND WITH CLEAN, SHARP TOOLS. DO NOT PAINT CUT ROOTS WITH TREE PAINT OR ANY KIND OF SEALANT.
- 3.1.5. MYCORRHIZA (ROOTS® TRANSPLANT OR EQUIVALENT) MUST BE INCORPORATED INTO THE BACKFILL SOIL PRIOR TO BACKFILLING AS PER MANUFACTURER'S RECOMMENDATIONS.
- 3.1.6. AFTER EACH ROOT PRUNE, EACH SECTION OF ROOTBALL THAT IS PRUNED MUST BE WRAPPED WITH BLACK PLASTIC AND THE TRENCH BACKFILLED WITH ORIGINAL EXCAVATED SOIL. A TREE RING WITH A MINIMUM HEIGHT OF 6" MUST BE CONSTRUCTED 6-12" OUTSIDE THE OUTERMOST EDGE OF THE ROOTBALL AND AROUND THE ENTIRE PERIMETER OF THE ROOTBALL TO DIRECT IRRIGATION WATER AND ANY ADDED SUPPLEMENTS DOWN INTO THE ROOTBALL DURING ROOT REGENERATION.
- 3.1.7. ONCE THE TREE RING IS CONSTRUCTED AFTER EACH ROOT PRUNE, A HIGH-PHOSPHORUS ROOT STIMULANT MUST BE LIBERALLY APPLIED TO THE SURFACE OF THE ROOTBALL AND THOROUGHLY WATERED IN TO ENCOURAGE NEW ROOT GROWTH.

3.2. TREES

- 3.2.1. PRIOR TO ANY ROOTS BEING CUT, ALL MAJOR ROOTS MUST BE IDENTIFIED TO DETERMINE THE ROOTBALL DIAMETER BASED ON THE RELATIVE LOCATION AND SIZE OF THE ROOTS.
- 3.2.2. MANY TREE RELOCATION SPECIFICATIONS USE "GENERAL RULES" TO CALCULATE MINIMUM ROOTBALL DIAMETER, SUCH AS MULTIPLYING THE DIAMETER AT BREAST HEIGHT (DBH) OF THE TREE BY A FACTOR OF 10 OR ALLOWING A MINIMUM OF 9'-12" OF ROOTBALL FOR EVERY 1" OF TREE CALIPER. OTHERS LIST UNREALISTIC MINIMUM SIZES FOR THE ROOTBALLS OR VARIOUS TREE CALIPERS OR HEIGHTS. IN MANY CASES, SUCH APPROACHES RESULT IN ROOTBALLS THAT ARE EITHER TOO LARGE OR TOO SMALL FOR A GIVEN TREE. THE FOLLOWING TABLE LISTS MINIMUM ROOTBALL DIAMETERS BASED ON REAL-WORLD EXPERIENCE OF TREE RELOCATION SPECIALISTS IN SOUTH FLORIDA:

CALIPER (inches)	MIN. ROOTBALL DIA. (feet)	CALIPER (inches)	MIN. ROOTBALL DIA. (feet)
1 - 4	3	12 - 14	8
4 - 5	4	15 - 17	10
6 - 7	5	18 - 24	12 - 15
8 - 9	6	25 - 30	15 - 25
10 - 11	7	30 +	as needed

- 3.2.3. WHENEVER POSSIBLE, ROOTBALLS MUST BE CIRCULAR IN SHAPE WITH AN EQUAL DISTANCE FROM THE TRUNK TO THE EDGE OF THE ROOTBALL ALL AROUND.
- 3.2.4. MINIMUM ROOTBALL DEPTH MUST BE 24"-36" FOR ALL TREES TO BE RELOCATED, WITH THE ACTUAL DEPTH TO BE DETERMINED ONLY AFTER A THOROUGH EXAMINATION OF ALL ROOTS DURING THE INITIAL ROOT INSPECTION AND BASED ON THE ABSENCE OF MAJOR ROOTS AT THE BOTTOM OF THE ROOTBALL. ROOTBALLS DEEPER THAN 36" MAY BE REQUIRED FOR LARGE SPECIMEN TREES, DEPENDING ON THE RELATIVE LOCATIONS AND DEPTHS OF THE MAJOR ROOTS AS OBSERVED DURING THE INITIAL ROOT INSPECTION.

- 3.2.5. AS A GENERAL RULE, MINIMUM ROOT PRUNE TIME FOR TREES WITH A DBH OF LESS THAN 10" IS 12 WEEKS. THE FIRST ROOT PRUNE MUST BE ON TWO OPPOSING SIDES OF THE ROOTBALL, WITH THE SECOND ROOT PRUNE ON ONE OF THE OTHER TWO SIDES DONE A MINIMUM OF 6 WEEKS LATER, AND A THIRD ROOT PRUNE ON THE LAST SIDE DONE A MINIMUM OF 3 WEEKS AFTER THAT. THE SECOND AND THIRD ROOT PRUNES MAY ONLY BE DONE WHEN HEALTHY NEW ROOT GROWTH FROM EARLIER ROOT PRUNES IS EVIDENT (SEE SECTION 2.14 ABOVE FOR SPECIFICATIONS ON PHOTOGRAPHICALLY DOCUMENTING NEW ROOT GROWTH DURING THE ROOT PRUNE PROCESS). MORE TIME MAY BE NEEDED DURING THE COOLER MONTHS OF THE YEAR.

- 3.2.6. AS A GENERAL RULE, MINIMUM ROOT PRUNE TIME FOR TREES WITH A DBH OF 10" OR GREATER IS 24 WEEKS. THE FIRST ROOT PRUNE MUST BE ON TWO OPPOSING SIDES OF THE ROOTBALL, WITH THE SECOND ROOT PRUNE ON ONE OF THE OTHER TWO SIDES DONE A MINIMUM OF 12 WEEKS LATER, AND A THIRD ROOT PRUNE ON THE LAST SIDE DONE A MINIMUM OF 6 WEEKS AFTER THAT. THE SECOND AND THIRD ROOT PRUNES MAY ONLY BE DONE WHEN HEALTHY NEW ROOT GROWTH FROM EARLIER ROOT PRUNES IS EVIDENT (SEE SECTION 2.14 ABOVE FOR SPECIFICATIONS ON PHOTOGRAPHICALLY DOCUMENTING NEW ROOT GROWTH DURING THE ROOT PRUNE PROCESS). MORE TIME MAY BE NEEDED DURING THE COOLER MONTHS OF THE YEAR.

- 3.2.7. CERTAIN HARDWOOD TREES AND GYMNOSPERMS REQUIRE LONGER ROOT PRUNING TIMES. THESE INCLUDE, BUT ARE NOT LIMITED TO, THE FOLLOWING:
 - AVOCADO (PERSEA AMERICANA)
 - BLACK OLIVE (BUCIDA BUCERAS)
 - BRIDALVEIL (CAESALPINIA GRANADILLO)
 - CASSIAS (ALL SPECIES OF CASSIA)
 - LIGNUM VITAE (GUAIAECUM SANCTUM & G. OFFICINALE)
 - PODOCARPUS (PODOCARPUS SP.)
 - LIVE OAK (QUERCUS VIRGINIANA)
 - MAHOGANY (SWietenia MAHAGONI)
 - MANGO (MANGIFERA INDICA)
 - PIGEON PLUM (COCOOLoba DIVERSIFOLIA)
 - SWEET ACACIA (ACACIA FARNESIANA)
 - VERAWOOD (BULNESIA ARBorea)
 - WILD TAMARIND (LYSILOMA LATISLIQUUM & L. SABICU)

FOR THESE TREES, THE MINIMUM ROOT PRUNE TIMES DISCUSSED IN SECTIONS 3.2.5 AND 3.2.6 ABOVE MAY BE INSUFFICIENT. ONLY WHEN SUFFICIENT NEW ROOT GROWTH HAS TAKEN PLACE FOLLOWING AN EARLIER ROOT PRUNE CAN THE NEXT ROOT PRUNE BE DONE, AND ONLY WHEN SUFFICIENT NEW ROOT GROWTH HAS TAKEN PLACE FOLLOWING THE FINAL ROOT PRUNE MAY THE TREE BE RELOCATED (SEE SECTION 2.14 ABOVE FOR SPECIFICATIONS ON PHOTOGRAPHICALLY DOCUMENTING NEW ROOT GROWTH DURING THE ROOT PRUNE PROCESS).

3.3. PALMS

- 3.3.1. THE FOLLOWING TABLE LISTS MINIMUM ROOTBALL DIAMETERS FOR VARIOUS SPECIES OF PALMS BASED ON REAL-WORLD EXPERIENCE OF RELOCATION SPECIALISTS IN SOUTH FLORIDA:

PALM SPECIES	ROOTBALL SPECIFICATIONS
SABAL / CABBAGE PALM	36" diameter
QUEEN & FOX TAIL PALMS	12" from trunk in all directions
ROYAL & COCONUT PALMS	18 - 24" from trunk in all directions
CANARY DATE PALM	24" from trunk in all directions
SLOW-GROWING PALMS	24" from trunk in all directions

- 3.3.2. PALM ROOTBALLS MUST BE A MINIMUM OF 24" DEEP. WHENEVER POSSIBLE, ROOTBALLS MUST BE CIRCULAR IN SHAPE WITH AN EQUAL DISTANCE FROM THE TRUNK TO THE EDGE OF THE ROOTBALL ALL AROUND.

- 3.3.3. AS A GENERAL RULE, MINIMUM ROOT PRUNE TIME FOR PALMS IS 6-8 WEEKS. THE FIRST ROOT PRUNE MUST BE ON TWO OPPOSING SIDES OF THE ROOTBALL, WITH THE SECOND ROOT PRUNE ON ONE OF THE OTHER TWO SIDES DONE A MINIMUM OF 3-4 WEEKS LATER, AND A THIRD ROOT PRUNE ON THE LAST SIDE DONE A MINIMUM OF 4-6 WEEKS AFTER THAT. THE SECOND AND THIRD ROOT PRUNES MAY ONLY BE DONE WHEN HEALTHY NEW ROOT GROWTH FROM EARLIER ROOT PRUNES IS EVIDENT (SEE SECTION 2.14 ABOVE FOR SPECIFICATIONS ON PHOTOGRAPHICALLY DOCUMENTING NEW ROOT GROWTH DURING THE ROOT PRUNE PROCESS). MORE TIME MAY BE NEEDED DURING THE COOLER MONTHS OF THE YEAR.

- 3.4.4. CERTAIN PALMS, IN PARTICULAR THOSE THAT ARE SLOW GROWING, REQUIRE LONGER ROOT PRUNING TIME. THESE INCLUDE, BUT ARE NOT LIMITED TO, THE FOLLOWING:
 - ALL SPECIES OF ARCHONTOPHENIX
 - ALL SPECIES OF CORYPHA
 - AMERICAN OIL PALMS (ALL SPECIES OF ATTALEA)
 - BISMARCK PALM (BISMARCKIA NOBILIS)
 - CUBAN A CARIBBEAN COPERNICIA
 - CUBAN BELLY PALM (GASTROCOCCOS CRISPA)
 - GINGERBREAD/DOLM PALMS (ALL SPECIES OF HYPHAENE)
 - PALMYRA PALMS (ALL SPECIES OF BORASSUS)
 - SATAKE PALM (SATAKENTIA LUKIUEINSIS)
 - SAW PALMETTO (SERENOA REPENS)
 - SILVER PALM (COCOTHRINAX ARGENTATA)
 - ZOMBIE PALM (ZOMBIA ANTILLARUM)

FOR THESE PALMS, THE MINIMUM ROOT PRUNING TIME IS 4-6 MONTHS OR GREATER. ONLY WHEN SUFFICIENT NEW ROOT GROWTH HAS TAKEN PLACE FOLLOWING AN EARLIER ROOT PRUNE CAN THE NEXT ROOT PRUNE BE DONE, AND ONLY WHEN SUFFICIENT NEW ROOT GROWTH HAS TAKEN PLACE FOLLOWING THE FINAL ROOT PRUNE MAY THE TREE BE RELOCATED (SEE SECTION 2.14 ABOVE FOR SPECIFICATIONS ON PHOTOGRAPHICALLY DOCUMENTING NEW ROOT GROWTH DURING THE ROOT PRUNE PROCESS).

4. CANOPY PRUNING SPECIFICATIONS

4.1. TREES

- 4.1.1. PRIOR TO RELOCATION, THE CANOPY OF EACH TREE TO BE RELOCATED MUST BE SELECTIVELY PRUNED TO REMOVE CROSSING, DEAD, DISEASED, BROKEN, AND LOW-HANGING BRANCHES THAT MAY INTERFERE WITH CONSTRUCTION ACTIVITIES, OR THAT MAY INTERFERE OR RESTRICT STRAPPING OR LIFTING THE TREE DURING RELOCATION.
- 4.1.2. FOR TREES BEING RELOCATED ONSITE, THE CANOPY MAY BE SELECTIVELY THINNED AND REDUCED BY NO MORE THAN 1/3 OF THE OVERALL CANOPY MASS, AT THE DIRECTION OF THE LANDSCAPE ARCHITECT; HOWEVER, THE BASIC SHAPE, FORM, AND CHARACTER OF THE TREE MUST BE PRESERVED.
- 4.1.3. FOR TREES BEING RELOCATED OFFSITE, THE CANOPY MUST BE PRUNED, AT THE DIRECTION OF THE LANDSCAPE ARCHITECT, TO FIT ON THE TRAILER FOR TRANSPORT. EVERY EFFORT MUST BE MADE TO RETAIN AS MANY LARGE BRANCHES AS POSSIBLE AND TO PRESERVE AS MUCH OF THE SHAPE, FORM, AND CHARACTER OF THE TREE AS POSSIBLE TO THE WIDEST LOAD WIDTH ALLOWABLE BY THE FLORIDA DEPARTMENT OF TRANSPORTATION. CONTRACTOR MUST OBTAIN ALL NECESSARY PERMITS AND ESCORTS TO TRANSPORT WIDE LOADS, PER FLORIDA LAW.
- 4.1.4. ALL CANOPY PRUNING MUST BE CONDUCTED FOLLOWING ANSI A-300 TREE PRUNING STANDARDS AND BEST MANAGEMENT PRACTICES.
- 4.1.5. ALL DEBRIS GENERATED DURING CANOPY PRUNING MUST BE REMOVED OFFSITE AND DISPOSED.

4.2. PALMS

- 4.2.1. IT IS WELL KNOWN THAT SOME PALMS SURVIVE RELOCATION BETTER WHEN ALL OF THE LEAVES ARE REMOVED (E.G., CABBAGE PALM, SABAL PALMETTO), AND THAT OTHER PALMS BENEFIT FROM HAVING THEIR LEAVES CUT IN HALF DURING RELOCATION (E.G., COCONUT PALM, COCOS NIJUPERA). BOTH OF THESE HORTICULTURAL PRACTICES, WHILE TRUE, ARE ONLY APPLICABLE WHEN PALMS ARE NOT ROOT PRUNED. LEAVES DO NOT NEED TO BE CUT IN HALF OR REMOVED FROM PALMS THAT ARE ADEQUATELY ROOT PRUNED. ON OCCASION WHEN SUFFICIENT ROOT PRUNING TIME IS NOT AVAILABLE, PALMS TO BE RELOCATED MAY HAVE THEIR LEAVES CUT IN HALF OR REMOVED ENTIRELY AT THE DIRECTION OF THE LANDSCAPE ARCHITECT.
- 4.2.2. PALM LEAVES MUST BE TIED UP WITH 2-PLY BIODEGRADABLE TWINE PRIOR TO RELOCATION TO PREVENT MECHANICAL DAMAGE DURING THE RELOCATION PROCESS.
- 4.2.3. PALM TRUNKS SHALL ONLY BE "CLEANED UP" ACCORDING TO THE LANDSCAPE ARCHITECT'S SPECIFICATIONS SPECIFIC TO EACH PALM.

5. RELOCATION SPECIFICATIONS

5.1. GENERAL

- 5.1.1. LANDSCAPE CONTRACTOR TO FLAG ALL PROPOSED PLANT LOCATIONS FOR LANDSCAPE ARCHITECT'S APPROVAL PRIOR TO INSTALLATION. NOTIFY LANDSCAPE ARCHITECT A MINIMUM OF 15 DAYS PRIOR TO REVIEW.
- 5.1.2. ALL TREES AND PALMS TO BE RELOCATED MUST BE WATERED DAILY FOR AT LEAST 5 DAYS PRIOR TO ANY RELOCATION TO ENSURE THAT THEY ARE FULLY HYDRATED. EACH WATERING MUST THOROUGHLY SATURATE THE ROOTBALL TO ITS FULL DEPTH.
- 5.1.3. ALL ROOTBALLS MUST BE WRAPPED IN BURLAP AND THEN TIGHTLY WIRE-WAPPED (USING REDLINE HORSE WIRE OR EQUIVALENT) TO KEEP THE ENTIRE ROOTBALL INTACT DURING RELOCATION. TREES AND PALMS GROWING IN LIMESTONE MUST BE DUG AND RELOCATED WITH THE ROOTS ATTACHED TO A SECTION OF ROCK AS PART OF THE ROOTBALL, SUCH THAT THE ROOTS REMAIN INTACT. ROOTBALLS COMING FROM SAND OR SANDY SOIL MAY ALSO NEED TO BE BOXED PRIOR TO RELOCATION, AT THE DISCRETION OF THE LANDSCAPE ARCHITECT.
- 5.1.4. TREES AND PALMS BEING RELOCATED OFFSITE MUST HAVE THEIR ENTIRE ROOTBALLS THOROUGHLY AND TIGHTLY WRAPPED WITH PLASTIC SHRINK WRAP ON THE OUTSIDE OF THE WIRE WRAP, AND THE ENTIRE TREE OR PALM (INCLUDING CANOPY, TRUNK, AND ROOTBALL) MUST BE COVERED WITH A BREATHABLE TARP (E.G., SHADE CLOTH) DURING TRANSPORT.
- 5.1.5. NEW PLANTING PITS FOR RELOCATED TREES AND PALMS MUST BE PREPARED PRIOR TO LIFTING THE PALM OR TREE FROM ITS CURRENT LOCATION AND MUST BE AT LEAST 3-4 FEET WIDER THAN THE ROOTBALL AND THE SAME DEPTH AS THE ROOTBALL, SUCH THAT THE FINAL ELEVATION OF THE TOP OF THE ROOTBALL IS AT OR SLIGHTLY ABOVE (NO MORE THAN 2" HIGHER) FINAL GRADE.
- 5.1.6. TREES AND PALMS TO BE RELOCATED MUST BE LIFTED BY THE ROOTBALL ONLY, USING APPROPRIATELY SIZED (LENGTH AND STRENGTH) LIFTING STRAPS OR CHAINS. DURING LIFTING, THE TREE OR PALM MUST BE BALANCED IN A MORE OR LESS UPRIGHT POSITION, WITH THE STRAP ON THE TRUNK USED ONLY FOR BALANCING AND MANEUVERING THE TREE OR PALM INTO POSITION. NO CHAINS MAY BE USED AROUND OR AGAINST THE TRUNK AT ANY TIME. AT NO TIME SHALL 100% OF THE WEIGHT OF THE TREE OR PALM BE ON THE STRAP ATTACHED TO THE TRUNK. TRUNKS MUST BE HEAVILY PADDED WITH 30-60 LAYERS (DEPENDING ON SIZE AND WEIGHT) OF BURLAP BENEATH THE BALANCING STRAP.
- 5.1.7. TREES AND PALMS MUST BE LIFTED WITH A CRANE OR BACKHOE APPROPRIATELY SIZED FOR THE SIZE AND WEIGHT OF THE TREE OR PALM AND LIFTED OR CARRIED DIRECTLY TO THE FINAL INSTALL LOCATION OR TRANSPORT TRAILER.
- 5.1.8. ONCE LIFTING BEGINS, ANY UNCLUT ROOTS UNDER OR AROUND THE ROOTBALL THAT MAY YET REMAIN MUST BE IMMEDIATELY SEVERED WITH HAND PRUNING TOOLS TO MINIMIZE TEARING AND ROOT DAMAGE.
- 5.1.9. AGRIFORM PLANTING TABLETS (OR APPROVED EQUIVALENT) MUST BE EVENLY DISTRIBUTED AROUND THE PERIMETER OF THE PLANTING PIT AT THE RATE OF 2 TABLETS PER 1" TRUNK CALIPER PRIOR TO BACKFILLING.
- 5.1.10. MYCORRHIZA (ROOTS® TRANSPLANT OR EQUIVALENT) MUST BE INCORPORATED INTO THE BACKFILL SOIL PRIOR TO BACKFILLING.
- 5.1.11. RELOCATED TREES AND PALMS MUST BE CENTERED IN THE PLANTING PIT, AND THE PIT BACKFILLED USING A 1:1 MIXTURE OF EXISTING SOIL AND 80:20 (DOT SAND:MUCK) SOIL MIX THOROUGHLY BLENDED TOGETHER. DO NOT USE MUDDY SOIL AS BACKFILL. (SEE 5.2.2 BELOW FOR SPECIAL CONDITIONS REGARDING DATE PALM BACKFILL SPECIFICATIONS.)
- 5.1.12. SMALL TREES AND PALMS MUST BE FIRMLY BRACED USING A MINIMUM OF FOUR 4" X 4" WOODEN BRACES ATTACHED TO 2" X 4" WOODEN BATTENS HELD IN PLACE WITH TWO STEEL BANDS. LARGER TREES MAY REQUIRE 6" X 6" WOODEN POSTS OR EVEN TELEPHONE POLES TO PROVIDE SUFFICIENT BRACING STRENGTH TO PREVENT TOPPLING DURING WIND EVENTS. A SUFFICIENT NUMBER OF BATTENS MUST BE STRATEGICALLY PLACED AROUND THE TRUNK SUCH THAT THE STEEL BANDS NEVER CONTACT THE TRUNK. NO BURLAP IS TO REMAIN UNDER THE WOODEN BATTENS ON TREES DURING BRACING, BUT SEVERAL LAYERS OF BURLAP SHOULD BE LEFT UNDER THE WOODEN BATTENS WHEN BRACING PALMS. NAILS SHALL NEVER BE DRIVEN DIRECTLY INTO THE TRUNK DURING BRACING. BRACING MUST REMAIN IN PLACE FOR A MINIMUM OF ONE YEAR.
- 5.1.13. A TREE RING WITH A MINIMUM HEIGHT OF 6" MUST BE CONSTRUCTED 6-12" OUTSIDE THE OUTERMOST EDGE OF THE ROOTBALL AND AROUND THE ENTIRE PERIMETER OF THE ROOTBALL TO DIRECT IRRIGATION WATER AND ANY SUPPLEMENTS THAT ARE ADDED DOWN INTO THE ROOTBALL DURING ROOT REGENERATION.
- 5.1.14. ONCE THE TREE RING IS CONSTRUCTED, A HIGH-PHOSPHORUS ROOT STIMULANT MUST BE LIBERALLY APPLIED TO THE SURFACE OF THE ROOTBALL AND THOROUGHLY WATERED IN.
- 5.1.15. ROOTBALLS MUST BE THOROUGHLY WATERED IN USING A HOSE AND A JOHNSON BAR INSERTED TO THE VERY BOTTOM OF THE ROOTBALL AND SWINGING BACK AND FORTH TO PREVENT FORMATION OF AIR POCKETS. THE JOHNSON BAR TECHNIQUE MUST BE REPEATED AT LEAST ONCE MORE WITHIN ONE WEEK AFTER RELOCATION, AND AGAIN IF ANY SIGNS OF STRESS BECOME APPARENT.
- 5.1.16. ORGANIC MULCH (MELALEUCA IS PREFERRED) MUST BE APPLIED WITHIN 48 HOURS OF RELOCATION AT A DEPTH OF 3-4" OVER THE ENTIRE TOP OF THE ROOTBALL FROM THE TREE RING TO WITHIN 6" OF THE TRUNK. MULCH MUST NOT BE APPLIED OR ALLOWED TO ACCUMULATE DIRECTLY AGAINST THE TRUNK.
- 5.1.17. PITS FROM WHICH THE RELOCATED TREES AND PALMS WERE REMOVED MUST BE CLEANE OF ALL RESIDUAL ROOTS, STUMPS, AND PORTIONS THEREOF AND BACKFILLED WITH CLEAN FILL FLUSH WITH THE SURROUNDING GRADE.
- 5.1.18. RESTORE THE SURFACE WITH MATERIAL TO MATCH ADJACENT AREAS. MATERIAL TO BE APPROVED BY LANDSCAPE ARCHITECT. CONTRACTOR TO PROVIDE A MINIMUM OF ONE YEAR WARRANTY ON SETTLING AND PLANT MATERIAL FROM TIME OF SUBSTANTIAL COMPLETION.
- 5.2. SPECIAL CONDITIONS
- 5.2.1. MULTI-TRUNK TREES AND PALMS MUST BE RELOCATED AS ONE UNIT WITH A SINGLE ROOTBALL.
- 5.2.2. PLANTING PITS FOR EDIBLE DATE PALMS (PHEONIX DACTYLIFERA) MUST BE BACKFILLED WITH PURE DOT SILICA SAND.

6. MAINTENANCE SPECIFICATIONS

6.1. GENERAL

- 6.1.1. ALL RELOCATED TREES AND PALMS MUST BE MAINTAINED FOR ONE YEAR FROM THE DATE OF RELOCATION TO THEIR FINAL LOCATIONS.
- 6.1.2. CONTRACTOR MUST MAINTAIN ALL RELOCATED TREES AND PALMS FOR ONE FULL YEAR FROM THE DATE OF RELOCATION TO THE FINAL LOCATION.
- 6.1.3. WHENEVER POSSIBLE, EACH TREE AND PALM MUST BE WATERED BY A PERMANENT AUTOMATIC IRRIGATION SYSTEM FOLLOWING RELOCATION. EACH WATERING MUST THOROUGHLY SATURATE THE ROOTBALL TO ITS FULL DEPTH; THIS WILL REQUIRE 25-50 GALLONS OF WATER FOR SMALL TREES AND PALMS, DEPENDING ON ROOTBALL SIZE, WHILE LARGE TREES WILL REQUIRE A MINIMUM OF 10 GALLONS PER FOOT OF ROOTBALL DIAMETER (I.E., A 10" DIAMETER ROOTBALL WILL REQUIRE A MINIMUM OF 100 GALLONS PER WATERING EVENT). WATERING FREQUENCY MUST BE EVERY DAY FOR THE FIRST TWO WEEKS, EVERY OTHER DAY FOR THE NEXT THREE WEEKS, AND EVERY THIRD DAY FOR THE NEXT 6-8 WEEKS.
- 6.1.4. WHEN AN AUTOMATIC IRRIGATION SYSTEM IS NOT POSSIBLE, CONTRACTOR IS RESPONSIBLE FOR HAND WATERING RELOCATED TREES AND PALMS THROUGHOUT THE MAINTENANCE PERIOD AND UNTIL FINAL ACCEPTANCE BY THE LANDSCAPE ARCHITECT AND/OR CLIENT.
- 6.1.5. IMMEDIATELY AFTER RELOCATION TO THE FINAL LOCATION, A HIGH-PHOSPHORUS ROOT STIMULANT MUST BE APPLIED TO THE SURFACE OF THE ROOTBALL AT THE RECOMMENDED LABEL RATE AND WATERED IN WITH A DRENCH CONSISTING OF A SYSTEMIC INSECTICIDE AND A CONTACT ROOT ROT FUNGICIDE, FOLLOWING LABEL INSTRUCTIONS, AS INITIAL PREVENTATIVE MAINTENANCE.
- 6.1.6. EVERY THREE MONTHS THEREAFTER, A HIGH-PHOSPHORUS ROOT STIMULANT MUST BE APPLIED TO THE SURFACE OF THE ROOTBALL AT THE RECOMMENDED LABEL RATE AND WATERED IN WITH A DRENCH CONSISTING OF A SYSTEMIC INSECTICIDE AND A BROAD-SPECTRUM SYSTEMIC FUNGICIDE, FOLLOWING LABEL INSTRUCTIONS, AS CONTINUING PREVENTATIVE MAINTENANCE.
- 6.1.7. IRRIGATION AND BRACING MUST BE CHECKED AND EACH TREE OR PALM THOROUGHLY INSPECTED FOR SIGNS OF STRESS, DISEASE, OR PEST PROBLEMS ON A MONTHLY BASIS.

6.2. SHADE TREES

- 6.2.1. IMMEDIATELY AFTER RELOCATION TO THE FINAL LOCATION AND EVERY THREE MONTHS THEREAFTER, A HIGH-QUALITY, SLOW-RELEASE 15-2-15 GRANULAR FERTILIZER MUST BE APPLIED, AT THE RECOMMENDED LABEL RATE, SPREAD EVENLY ACROSS THE SURFACE OF THE ROOTBALL.
- 6.2.2. FOLIAR FEED FOUR TIMES PER YEAR.

6.3. FLOWERING TREES

- 6.3.1. IMMEDIATELY AFTER RELOCATION TO THE FINAL LOCATION AND EVERY THREE MONTHS THEREAFTER, A HIGH-QUALITY, SLOW-RELEASE 5-10-15 GRANULAR FERTILIZER MUST BE APPLIED, AT THE RECOMMENDED LABEL RATE, SPREAD EVENLY ACROSS THE SURFACE OF THE ROOTBALL.
- 6.3.2. FOLIAR FEED FOUR TIMES PER YEAR.

6.4. PALMS

- 6.4.1. STRING MUST BE REMOVED FROM THE TIED UP LEAVES IMMEDIATELY AFTER RELOCATION TO THE FINAL LOCATION IF THE PALM WAS ROOT PRUNED OR WITHIN 30-45 DAYS AFTER RELOCATION ON THE OCCASION THE LANDSCAPE ARCHITECT APPROVED RELOCATION WITHOUT ROOT PRUNING DUE TO TIME CONSTRAINTS.
- 6.4.2. IMMEDIATELY AFTER RELOCATION TO THE FINAL LOCATION AND EVERY THREE MONTHS THEREAFTER, A HIGH-QUALITY, SLOW-RELEASE 8-4-12 GRANULAR PALM FERTILIZER WITH MINORS MUST BE APPLIED, AT THE RECOMMENDED LABEL RATE, SPREAD EVENLY ACROSS THE SURFACE OF THE ROOTBALL.
- 6.4.3. FOLIAR FEED SIX TIMES PER YEAR.

7. TREE PROTECTION SPECIFICATIONS

- 7.1. TREE PROTECTION FENCES SHALL BE CONSTRUCTED PRIOR TO ANY CONSTRUCTION ACTIVITY INCLUDING GRUBBING FOR ALL TREES / PALMS TO REMAIN OR BE RELOCATED.
- 7.2. FENCES SHOULD BE OF STURDY CONSTRUCTION, PREFERABLY 2"x4" POSTS WITH WIRE MESH. ORANGE PLASTIC MESH FENCES ARE INEFFECTIVE BECAUSE THEY ARE EASILY REMOVED, DROPPED, KNOCKED DOWN, IGNORED, ETC.
- 7.3. FENCES MUST BE MAINTAINED INTACT UNTIL THE PROJECT IS COMPLETED. THEY SHOULD NOT BE REMOVED OR DROPPED FOR ANY REASON WITHOUT AUTHORIZATION FROM THE CITY'S URBAN FORESTER.
- 7.4. NO ACTIVITY OR DISTURBANCE SHOULD OCCUR WITHIN THE FENCED AREAS, INCLUDING VEHICLE USE, STORAGE OF MATERIALS, DUMPING OF LIQUIDS OR MATERIALS, GRADE CHANGES, GRUBBING, MECHANICAL TRENCHING FOR IRRIGATION, ELECTRICAL LIGHTING, ETC.
- 7.5. PLACE WEATHER RESISTANT SIGN EVERY 50' ALONG THE BARRIER WITH 6" MINIMUM TEXT HEIGHT AND PROVIDE TEXT IN ENGLISH AND SPANISH. SIGN SHOULD READ "KEEP OUT TREE PROTECTION AREA".

8. WARRANTY

- 8.1. ALL RELOCATED TREES AND PALMS MUST BE GUARANTEED FOR ONE YEAR FROM THE DATE OF RELOCATION TO THEIR FINAL LOCATIONS.
- 8.2. IF A TREE OR PALM DIES WITHIN THE 1-YEAR WARRANTY PERIOD, IT MUST BE REMOVED AND REPLACED AT CONTRACTOR'S EXPENSE.
- 8.3. IF A TREE OR PALM PERFORMS POORLY WITHIN THE 1-YEAR WARRANTY PERIOD, IT MUST BE REMOVED AND REPLACED AT THE CONTRACTOR'S EXPENSE. THE DECISION TO REPLACE BASED ON POOR HEALTH IS AT THE DISCRETION OF THE LANDSCAPE ARCHITECT.
- 8.4. IF A TREE OR PALM SETTLES TO AN UNHEALTHY DEPTH WITHIN THE 1-YEAR WARRANTY PERIOD, AS DETERMINED BY THE LANDSCAPE ARCHITECT, IT MUST BE RAISED TO THE CORRECT GRADE AT CONTRACTOR'S EXPENSE.

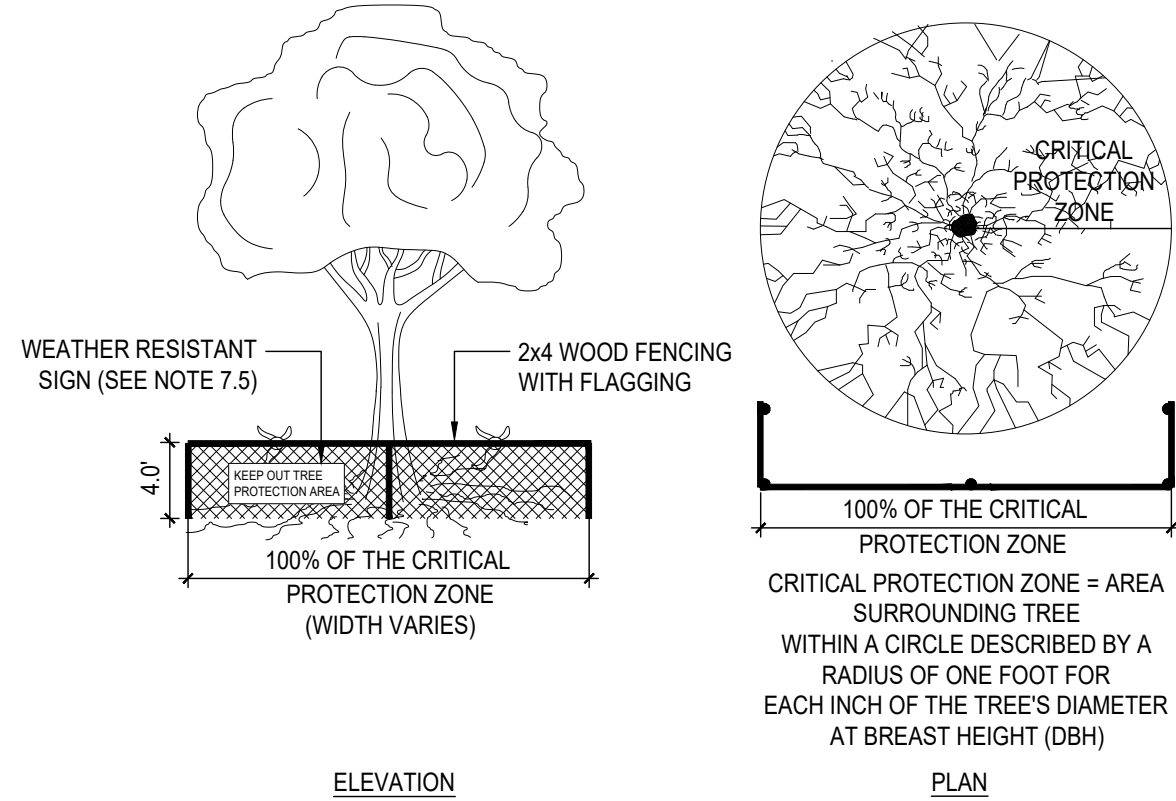

NOTE:
PROVIDE FOR TREE PROTECTION TO BE PERFORMED
ACCORDING TO FDOT STANDARD PLANS INDEX 110-100.

1 TREE BARRICADE DETAIL

SCALE: N/A

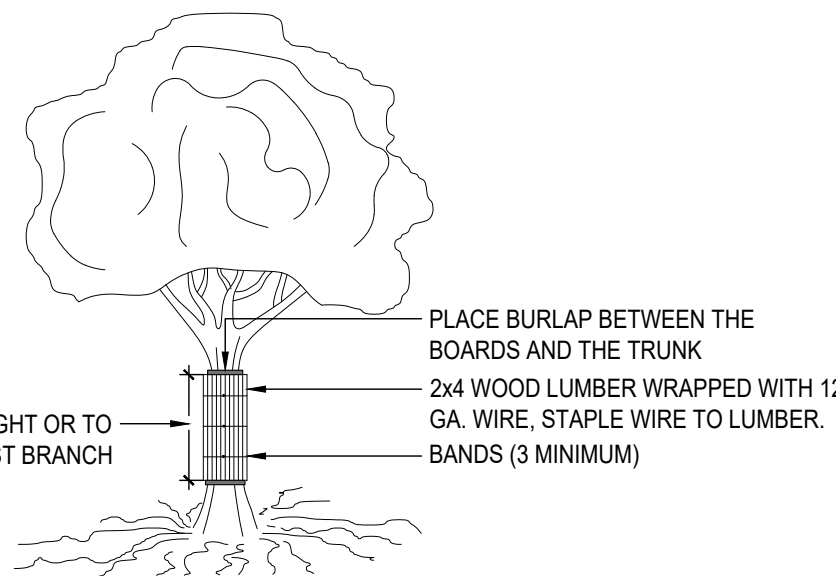

2 TREE TRUNK PROTECTION DETAIL

SCALE: N/A

CIVIL ENGINEER

Kimley»Horn

1920 WEKIVA WAY, SUITE 200,
WEST PALM BEACH, FL 33411
PHONE: 561-845-0665
FAX: 561-863-8175
WWW.KIMLEY-HORN.COM
REGISTRY NO. 35106

ARCHITECT



FAIRFAX & SAMMONS

FAIRFAX, SAMMONS & PARTNERS, LLC
214 BRAZZILIAN AVENUE
PALM BEACH, FL 33480
PHONE: (561) 805-8591

LANDSCAPE ARCHITECT

jungles

RAYMOND JUNGLES, INC.

2964 AVIATION AVENUE
MIAMI, FL 33133
PHONE: (305) 858-6777

COA: 22-037

ZON: 22-107

No.	REVISIONS	DATE

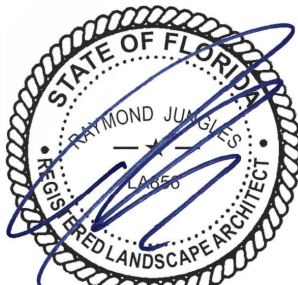

PROJECT No.

DATE
10/28/2022

SCALE
AS SHOWN

DESIGNED BY

DRAWN BY

CHECKED BY

TREE DISPOSITION
NOTES



**PHIPPS OCEAN
PARK**
PREPARED FOR
**TOWN OF PALM
BEACH**

SHEET NUMBER

LR.300

Plotted By:Alexia Krister Sheet Set:PHIPPS OCEAN PARK Layout:CO.02 PHOTOGRAPHS OF EXISTING CONDITIONS October 28, 2022 08:41:30am K:\web_developers\140311003 - phipps ocean park cds\CADD\plansheets\CO.02 PHOTOGRAPHS OF EXISTING CONDITIONS.dwg
This document, together with the concepts and designs presented herein, is intended only for the specific purpose and client for which it was prepared. Reuse of and improper reliance on this document without written authorization and adaptation by Kimley-Horn and Associates, Inc. shall be without liability to Kimley-Horn and Associates, Inc.

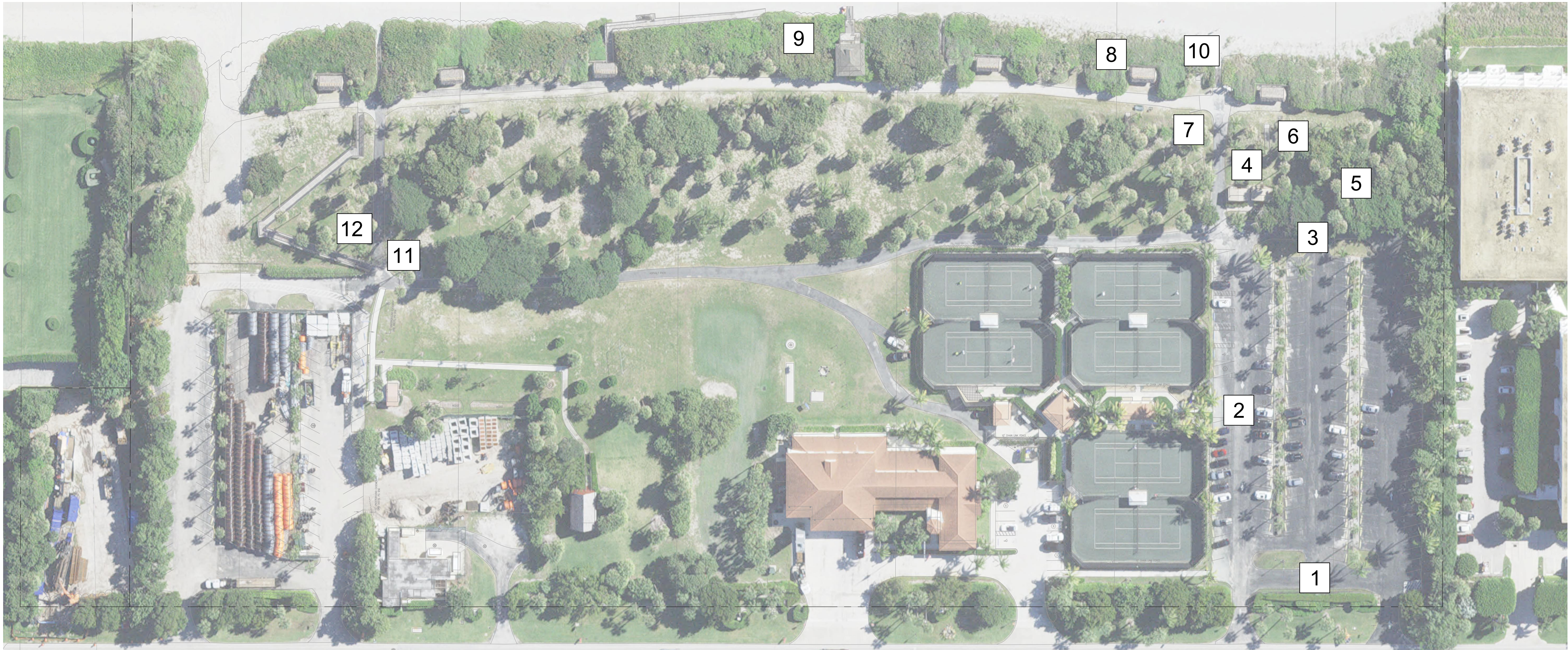

PICTURE 1: EXISTING SOUTH PARKING LOT



PICTURE 2: ENTRANCE TO TENNIS COURTS



PICTURE 3: EXISTING DUMPSTER WITH CONCRETE PAD



PICTURE 4: SOUTH PARKING LOT RESTROOMS



PICTURE 5: PICNIC BENCH



PICTURE 6: STAIRS WITH HANDRAILS

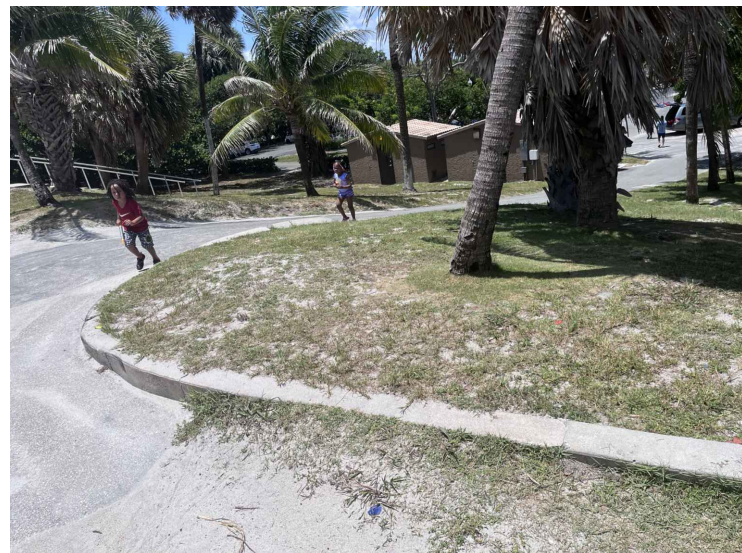

PICTURE 7: EXISTING PATHWAY TO SOUTHERNMOST BEACH ACCESS POINT



PICTURE 8: CHICKEE HUT



PICTURE 9: LIFEGUARD HOUSE



PICTURE 10: SHOWER WITH WOOD WALL

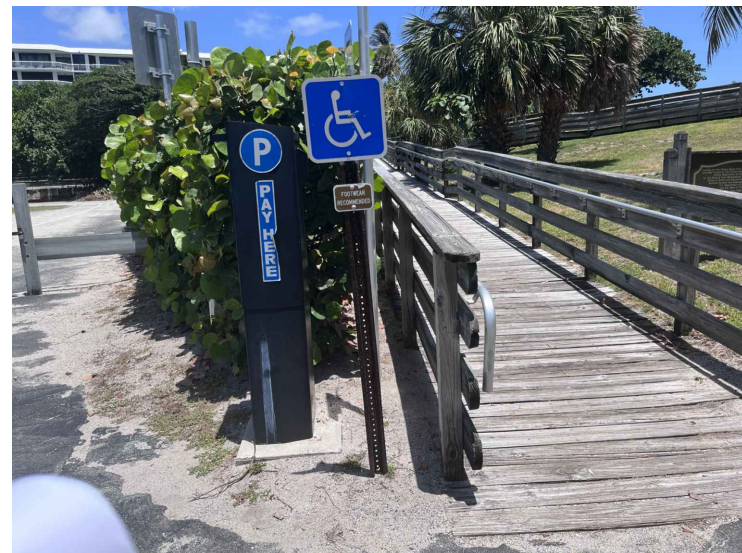

PICTURE 11: PARKING METER AND ADA WALKWAY SIGN AT NORTH PARKING LOT



PICTURE 12: STAGING AREA AT SOUTH PARKING LOT

CIVIL ENGINEER

Kimley»Horn

© 2022 KIMLEY-HORN AND ASSOCIATES, INC.
1920 WEKIVA WAY, SUITE 200,
WEST PALM BEACH, FL 33411
PHONE: 561-845-0665
FAX: 561-863-8175
WWW.KIMLEY-HORN.COM
REGISTRY NO. 35106

ARCHITECT



FAIRFAX & SAMMONS

FAIRFAX, SAMMONS & PARTNERS, LLC
214 BRAZILIAN AVENUE
PALM BEACH, FL 33480
PHONE: (561) 805-8591

LANDSCAPE ARCHITECT

jungles

RAYMOND JUNGLES, INC.
2964 AVIATION AVENUE
MIAMI, FL 33133
PHONE: (305) 858-6777

COA: 22-037
ZON: 22-107

No.	REVISIONS	DATE
-----	-----------	------

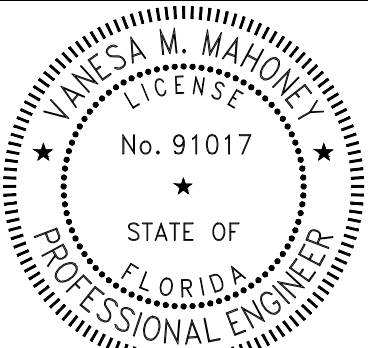

PROJECT No.	140311003
DATE	10/28/2022
SCALE	AS SHOWN
DESIGNED BY	VM
DRAWN BY	MG
CHECKED BY	TR

PHOTOGRAPHS
OF
EXISTING
CONDITIONS



**PHIPPS OCEAN
PARK**
PREPARED FOR
TOWN OF PALM
BEACH

TOWN OF PALM BEACH FL
SHEET NUMBER
C0.02

Plotted By: Alexa - Kristen - Sheet Set: PHIPPS OCEAN PARK - Layout: CO.03 PHOTOGRAPHS OF EXISTING CONDITIONS - October 28, 2022 08:41:35am - I:\web_developers\140311003 - phipps ocean park cbs\CADD\plansheets\CO.03 PHOTOGRAPHS OF EXISTING CONDITIONS.dwg
This document, together with the concepts and designs presented herein, is intended only for the specific purpose and client for which it was prepared. Reuse of and improper reliance on this document without written authorization and adaptation by Kimley-Horn and Associates, Inc. shall be without liability to Kimley-Horn and Associates, Inc.



PICTURE 13: SOUTH PARKING LOT



PICTURE 14: SOUTH PARKING LOT



PICTURE 15: WALKWAY WITH LIGHTPOLES



PICTURE 16: HISTORICAL SIGN



PICTURE 17: FIRE STATION



PICTURE 18: BARBEQUE GRILL



PICTURE 19: WOODEN WALKWAY



PICTURE 20: SHOWER WITH WOOD WALL



PICTURE 21: SHELLROCK PATH



PICTURE 22: SHELLROCK AND ASPHALT PATH

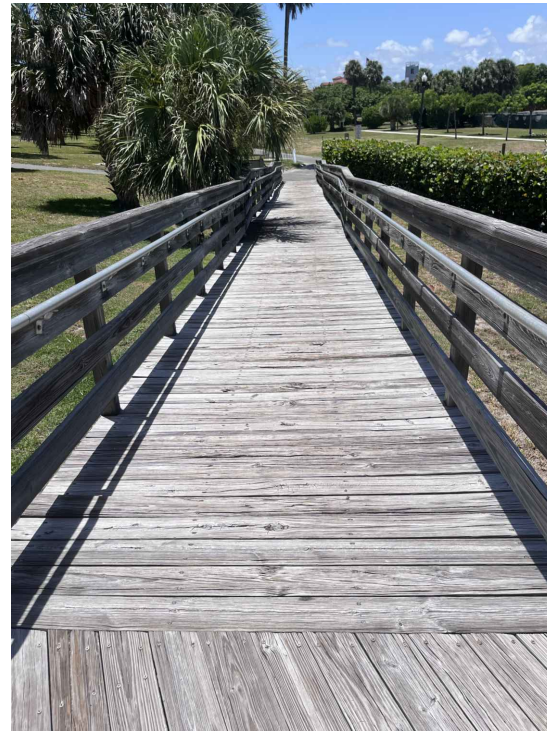

PICTURE 23: WOODEN ADA WALKWAY

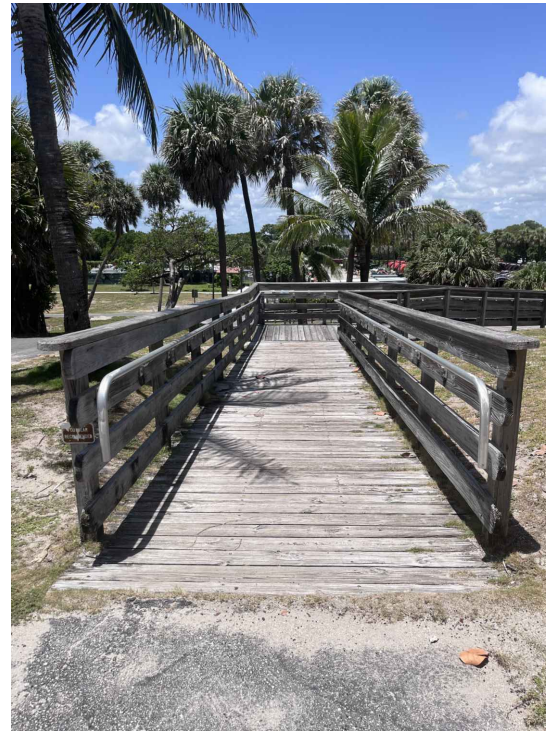

PICTURE 24: WOODEN ADA WALKWAY



PICTURE 25: WOODEN ADA WALKWAY



PICTURE 26: SOUTH PARKING LOT AND STAGING AREA

CIVIL ENGINEER

Kimley»Horn

© 2022 KIMLEY-HORN AND ASSOCIATES, INC.
1920 WEKIVA WAY, SUITE 200,
WEST PALM BEACH, FL 33411
PHONE: 561-845-0665
FAX: 561-863-8175
WWW.KIMLEY-HORN.COM
REGISTRY NO. 35106

ARCHITECT



FAIRFAX & SAMMONS

FAIRFAX, SAMMONS & PARTNERS, LLC
214 BRAZILIAN AVENUE
PALM BEACH, FL 33480
PHONE: (561) 805-8591

LANDSCAPE ARCHITECT

jungles

RAYMOND JUNGLES, INC.
2964 AVIATION AVENUE
MIAMI, FL 33133
PHONE: (305) 858-6777

COA: 22-037
ZON: 22-107

No.	REVISIONS	DATE

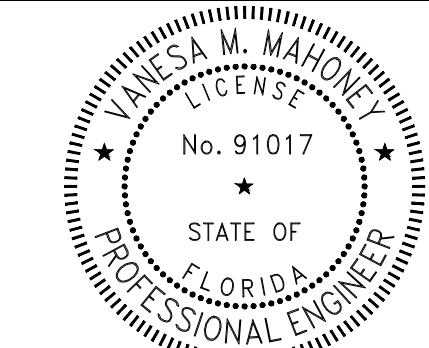

PROJECT No. 140311003

DATE 10/28/2022

SCALE AS SHOWN

DESIGNED BY VM

DRAWN BY MG

CHECKED BY TR

PHOTOGRAPHS
OF
EXISTING
CONDITIONS



**PHIPPS OCEAN
PARK**
PREPARED FOR
TOWN OF PALM
BEACH

TOWN OF PALM BEACH FL

SHEET NUMBER

C0.03

Plotted By: Alexa, Kristen Sheet Set: PHIPPS OCEAN PARK Layout: C1.00 CONSTRUCTION STAGING AND TRUCK LOGISTICS PLAN October 28, 2022 09:41:55am
K:\web_services\140311003 - phipps ocean park cbs\cadd\plansheets\C1.00 CONSTRUCTION STAGING AND TRUCK LOGISTICS PLAN.dwg
This document, together with the concepts and designs presented herein, is an instrument of service, as an instrument of service, is intended only for the specific purpose and client for which it was prepared. Reuse of and improper reliance on this document without written authorization and adaptation by Kimley-Horn and Associates, Inc. shall be without liability to Kimley-Horn and Associates, Inc.

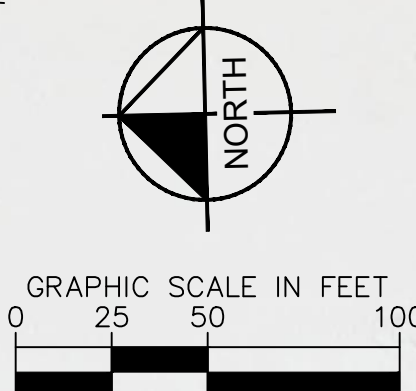
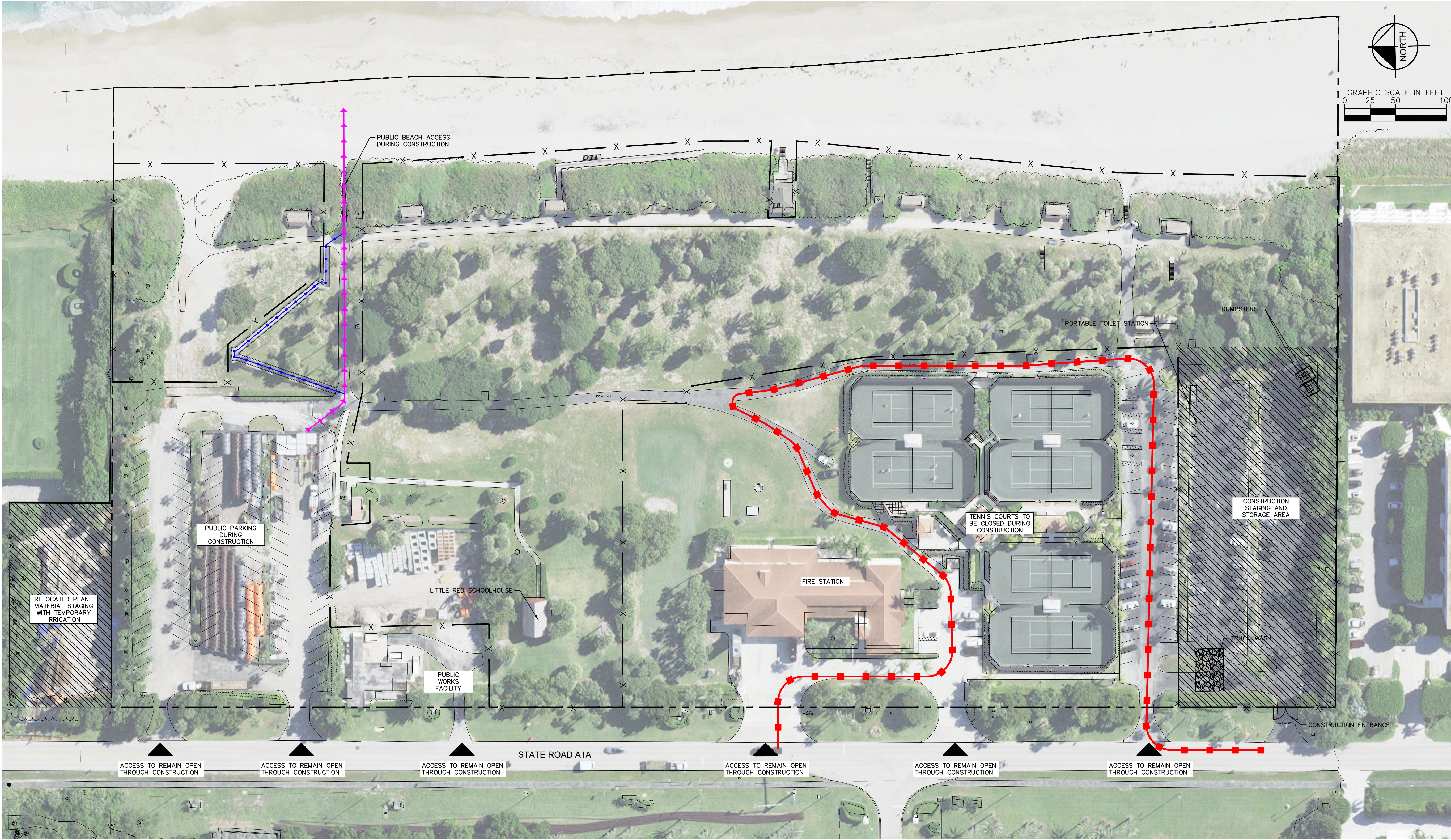

CONSTRUCTION DELIVERY ROUTE MAP
N.T.S.
DIRECTIONS: TRAVEL EAST ONTO PALM BEACH ISLAND VIA LAKE WORTH ROAD, MAKE A LEFT ONTO SOUTH OCEAN BOULEVARD UNTIL ARRIVAL AT PROJECT SITE.

- LEGEND**
- PROPERTY LINE
 - X - CHAINLINK FENCE WITH DUST SCREEN
 - ■ — TRUCK ACCESS DURING CONSTRUCTION
 - ◆ — ADA BEACH ACCESS DURING CONSTRUCTION
 - ◀ — PEDESTRIAN BEACH ACCESS DURING CONSTRUCTION
 - ▨ CONSTRUCTION STAGING AREA

CIVIL ENGINEER

Kimley»Horn

© 2022 KIMLEY-HORN AND ASSOCIATES, INC.
1920 WEKIVA WAY, SUITE 200,
WEST PALM BEACH, FL 33411
PHONE: 561-845-0665
FAX: 561-863-8175
WWW.KIMLEY-HORN.COM
REGISTRY NO. 35106

ARCHITECT



FAIRFAX & SAMMONS

FAIRFAX, SAMMONS & PARTNERS, LLC
214 BRAZILIAN AVENUE
PALM BEACH, FL 33480
PHONE: (561) 805-8591

LANDSCAPE ARCHITECT

jungles

RAYMOND JUNGLES, INC.

2964 AVIATION AVENUE
MIAMI, FL 33133
PHONE: (305) 858-6777

COA: 22-037
ZON: 22-107

No.	REVISIONS	DATE

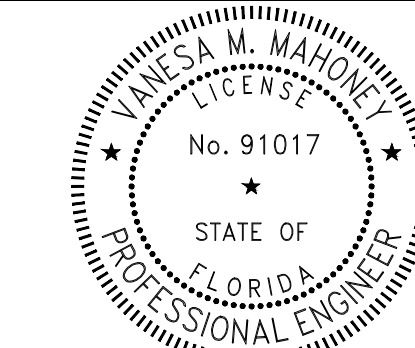

PROJECT No. 140311003

DATE 10/28/2022

SCALE AS SHOWN

DESIGNED BY VM

DRAWN BY MG

CHECKED BY TR

CONSTRUCTION STAGING AND TRUCK LOGISTICS PLAN



PHIPPS OCEAN PARK
PREPARED FOR
TOWN OF PALM BEACH

TOWN OF PALM BEACH FL

SHEET NUMBER

C1.00

Plotted By: Alexa - Kristen
This document, together with the concepts and designs presented herein, is intended only for the specific purpose and client for which it was prepared. Reuse of and improper reliance on this document without written authorization and adaptation by Kimley-Horn and Associates, Inc. shall be without liability to Kimley-Horn and Associates, Inc.

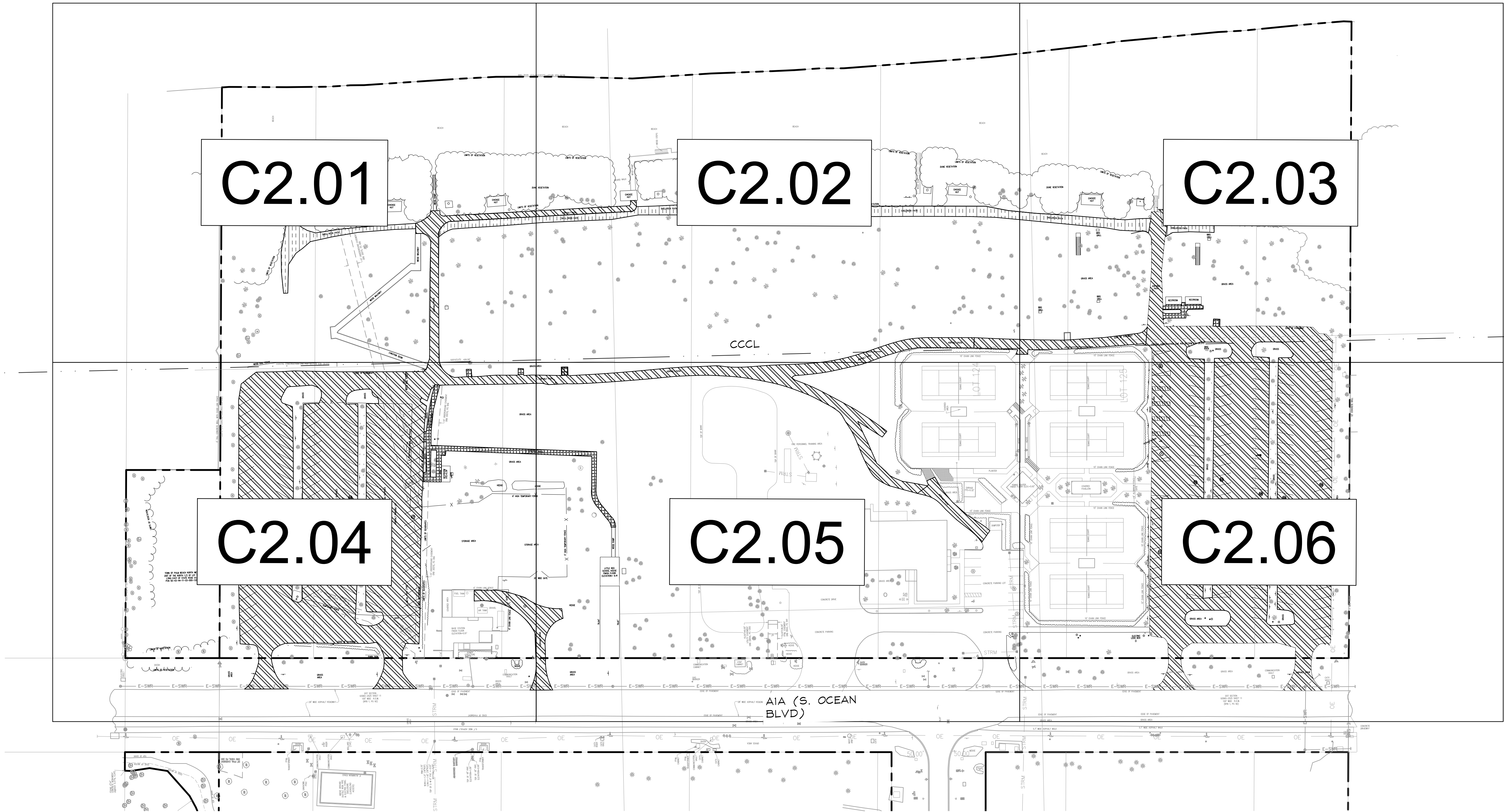

DEMOLITION REPORT

- YEAR OF ORIGINAL CONSTRUCTION: LATE 1950'S / EARLY 1960'S
- ORIGINAL LANDSCAPE ARCHITECT: A.D. TAYLOR
- TIMELINE OF ALTERATIONS:
 - 1948: LAND WAS DONATED BY BESSEMER PROPERTIES, INC. TO PALM BEACH COUNTY
 - 1950: PALM BEACH COUNTY HIRED LANDSCAPE ARCHITECT A.D. TAYLOR TO COMPLETE MASTER PLAN FOR THE PARK
 - 1957: PALM BEACH COUNTY DEEDED THE PROPERTY TO THE TOWN OF PALM BEACH
 - 1990: THE PRESERVATION FOUNDATION ENTERED A 99-YEAR LEASE WITH THE TOWN OF PALM BEACH TO RESTORE THE LITTLE RED SCHOOLHOUSE AND BEGAN OPERATING A LIVING HISTORY PROGRAM FOR SCHOOL CHILDREN
 - 1995: A NEW SOUTH FIRE STATION WAS CONSTRUCTED TO REPLACE THE OLD STATION LOCATED IN THE PARK
- EXISTING CONDITIONS:
 - RECREATIONAL PATHWAYS
 - PAVILIONS
 - BEACH ACCESS PATHS
 - PUBLIC RESTROOMS
 - (6) TENNIS COURTS
 - FIRE STATION
 - PUBLIC WORKS BUILDING
 - LITTLE RED SCHOOLHOUSE
 - (6) THATCHED SHELTERS
 - (2) PUBLIC PARKING LOTS

- LEGEND
- PROPERTY LINE
 - SEWER MAIN TO REMAIN
 - STORM TO REMAIN
 - EXISTING ASPHALT PARKING LOT TO BE REMOVED
 - EXISTING SHELLROCK PATH TO BE REMOVED
 - EXISTING CONCRETE TO BE REMOVED

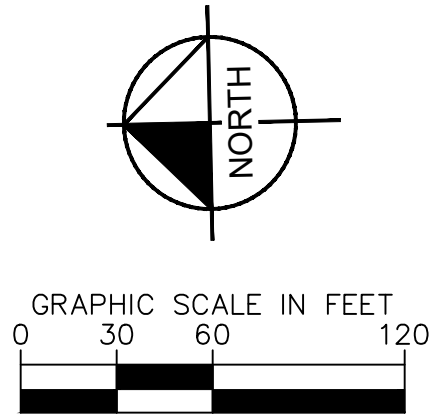

CIVIL ENGINEER
Kimley»Horn
© 2022 KIMLEY-HORN AND ASSOCIATES, INC.
1920 WEKIVA WAY, SUITE 200,
WEST PALM BEACH, FL 33411
PHONE: 561-845-0665
FAX: 561-863-8175
WWW.KIMLEY-HORN.COM
REGISTRY NO. 35106

ARCHITECT
FAIRFAX & SAMMONS
NEW YORK - PALM BEACH
FAIRFAX, SAMMONS & PARTNERS, LLC
214 BRAZILIAN AVENUE
PALM BEACH, FL 33480
PHONE: (561) 805-8591

LANDSCAPE ARCHITECT
jungles
RAYMOND JUNGLES, INC.
2964 AVIATION AVENUE
MIAMI, FL 33133
PHONE: (305) 858-6777

COA: 22-037
ZON: 22-107

No.	REVISIONS	DATE

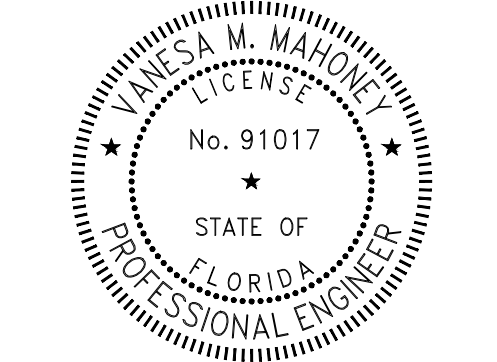





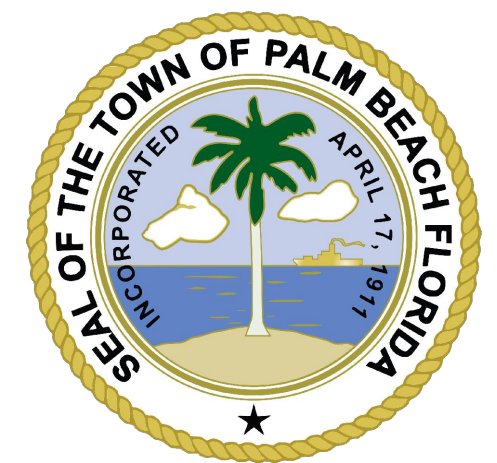

PROJECT No. 140311003
DATE 10/28/2022
SCALE AS SHOWN
DESIGNED BY VM
DRAWN BY MG
CHECKED BY TR

OVERALL
DEMOLITION
PLAN



**PHIPPS OCEAN
PARK**
PREPARED FOR
TOWN OF PALM
BEACH

TOWN OF PALM BEACH FL
SHEET NUMBER
C2.00

LEGEND	
	PROPERTY LINE
 E-5000 E-5000	SEWER MAIN TO REMAIN
	STORM TO REMAIN
	EXISTING ASPHALT PARKING LOT TO BE REMOVED
	EXISTING SHELL/ROCK PATH TO BE REMOVED
	EXISTING CONCRETE TO BE REMOVED

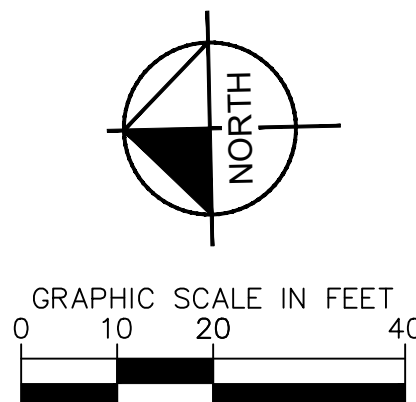
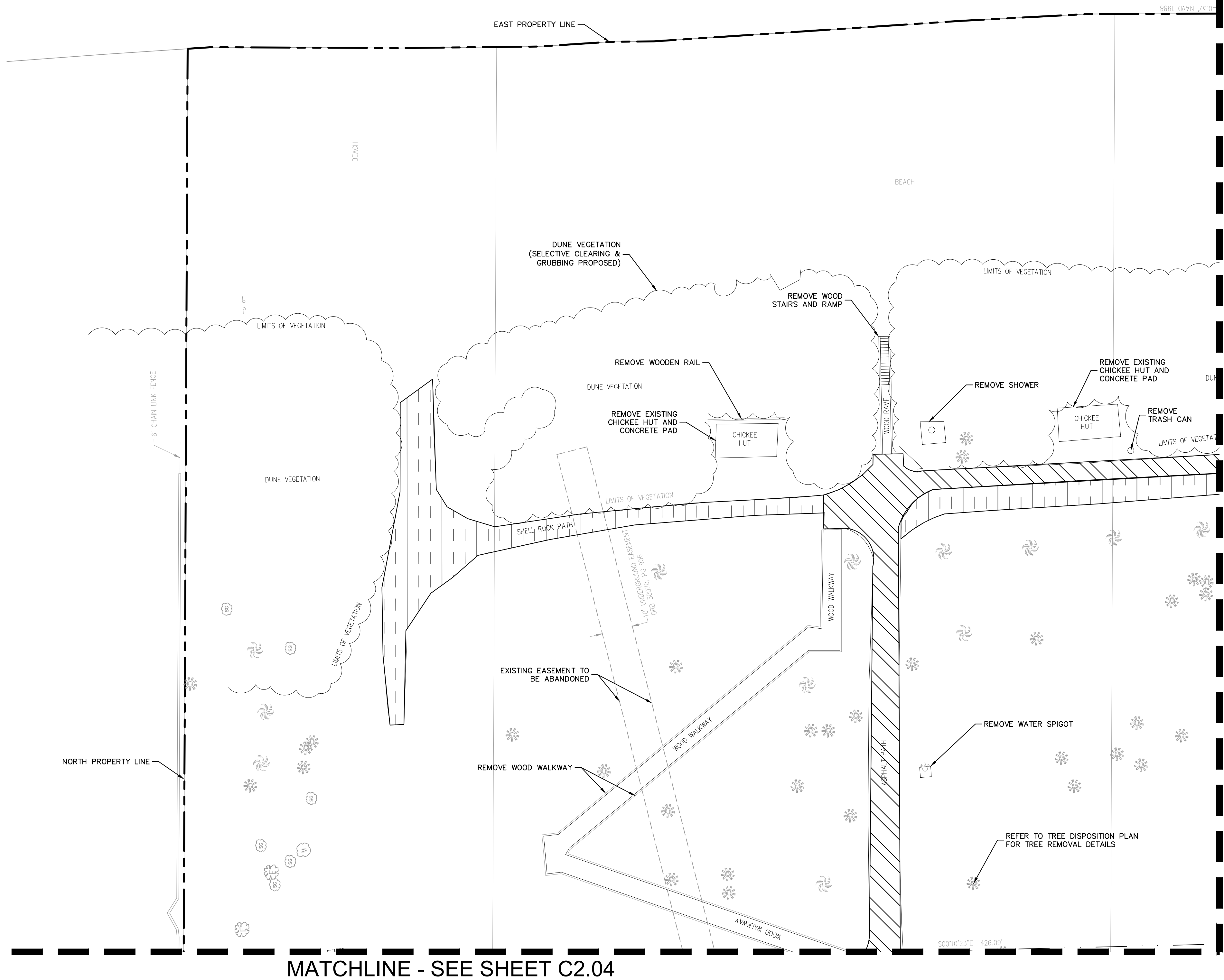
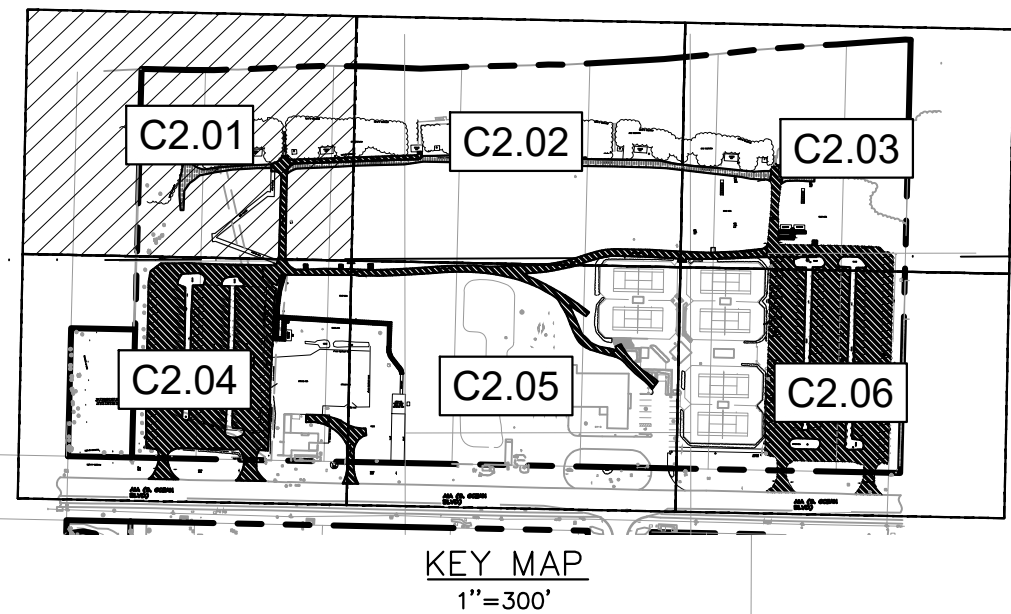

CIVIL ENGINEER

Kimley»Horn

© 2022 KIMLEY-HORN AND ASSOCIATES, INC.
1920 WEKIVA WAY, SUITE 200
WEST PALM BEACH, FL 33411
PHONE: 561-845-0665
FAX: 561-863-8175
WWW.KIMLEY-HORN.COM
REGISTRY NO. 35106

ARCHITECT

**FAIRFAX & SAMMON**

FAIRFAX, SAMMONS & PARTNERS, LLC
214 BRAZILIAN AVENUE
PALM BEACH, FL 33480
PHONE: (561) 805-8591

LANDSCAPE ARCHITECT

jungles

RAYMOND JUNGLES, INC
2964 AVIATION AVENUE
MIAMI, FL 33133
PHONE: (305) 858-6777

COA: 22-037
ZON: 22-107

No.	REVISIONS	DATE
-----	-----------	------

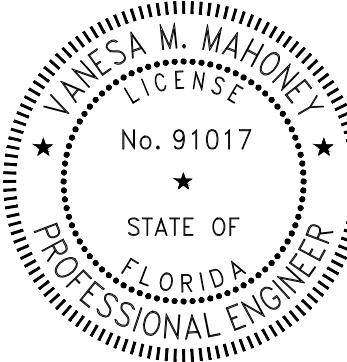

PROJECT No. 140311003

DATE 10/28/202

SCALE	AS SHOWN
-------	----------

DESIGNED BY VM

DRAWN BY MG

CHECKED BY _____ TR _____

DEMOLITION PLAN



PHIPPS OCEAN
PARK
PREPARED FOR
TOWN OF PALM
BEACH

TOWN OF PALM BEACH F

SHEET NUMBER

C2.01

This document, together with the concepts and designs presented herein, as an instrument of service, is intended only for the specific purpose and client for which it was prepared. Reuse of and improper reliance on this document without written authorization and adaptation by Kimley-Horn and Associates, Inc. shall be without liability to Kimley-Horn and Associates, Inc.

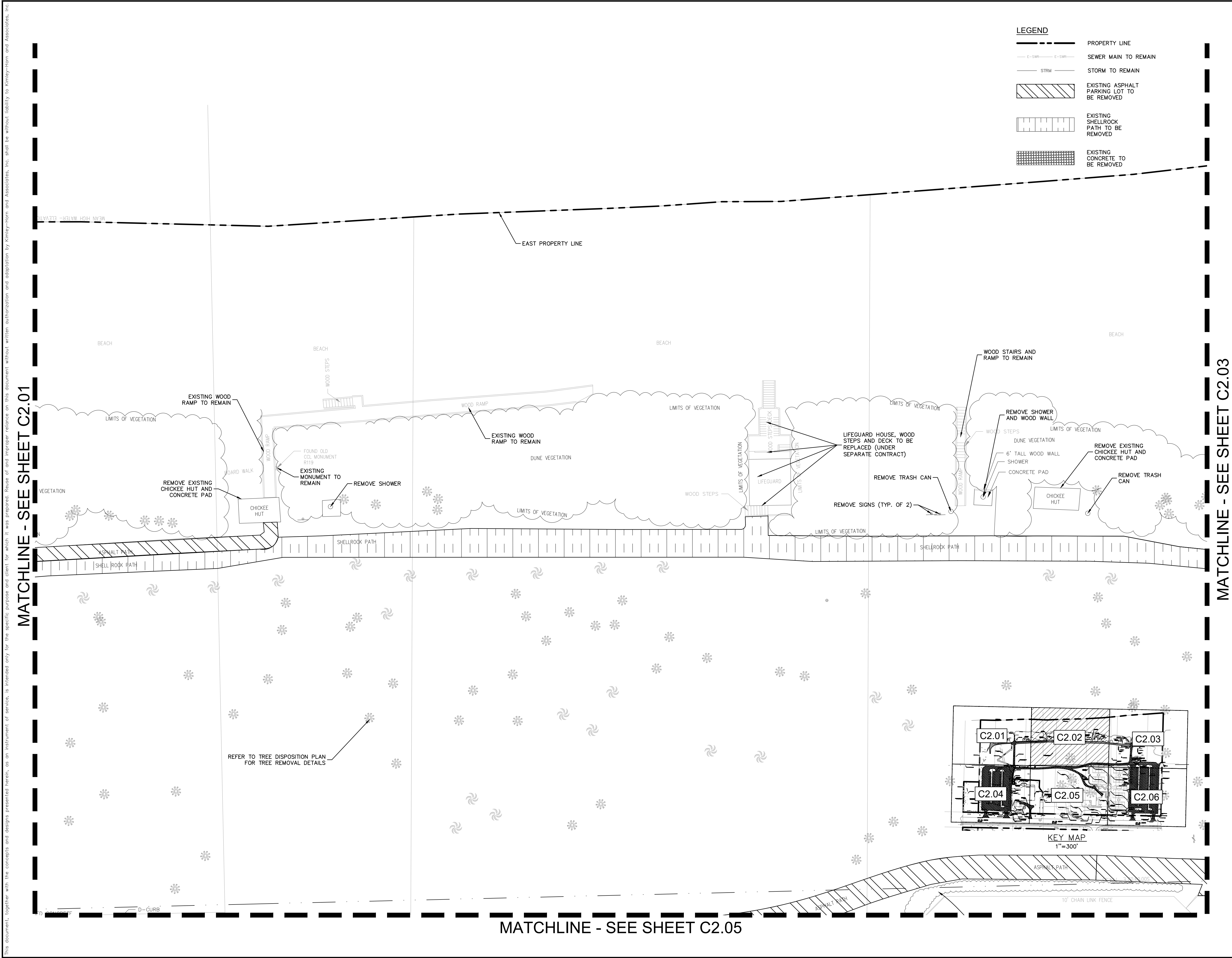

CIVIL ENGINEER

Kimley»Horn

© 2022 KIMLEY-HORN AND ASSOCIATES, INC.
1920 WEKIVA WAY, SUITE 200,
WEST PALM BEACH, FL 33411
PHONE: 561-845-0665
FAX: 561-863-8175
WWW.KIMLEY-HORN.COM
REGISTRY NO. 35106

ARCHITECT

FAIRFAX & SAMMONS
NEW YORK - PALM BEACH

FAIRFAX, SAMMONS & PARTNERS, LLC
214 BRAZILIAN AVENUE
PALM BEACH, FL 33480
PHONE: (561) 805-8591

LANDSCAPE ARCHITECT

jungles

RAYMOND JUNGLES, INC.
2964 AVIATION AVENUE
MIAMI, FL 33133
PHONE: (305) 858-6777

COA: 22-037
ZON: 22-107

No.	REVISIONS	DATE

PROJECT No. 140311003

DATE 10/28/2022

SCALE AS SHOWN

DESIGNED BY VM

DRAWN BY MG

CHECKED BY TR

DEMOLITION PLAN

SEAL OF THE TOWN OF PALM BEACH, FLORIDA
INCORPORATED APRIL 17, 1911

PHIPPS OCEAN PARK
PREPARED FOR
TOWN OF PALM BEACH

TOWN OF PALM BEACH FL

SHEET NUMBER
C2.02

Plotted By: Alexia Kristen
This document, together with the concepts and designs presented herein, is intended only for the specific purpose and client for which it was prepared. Reuse of and improper reliance on this document without written authorization and adaptation by Kimley-Horn and Associates, Inc. shall be without liability to Kimley-Horn and Associates, Inc.

KK:\web_services\140311003 - PHIPPS OCEAN PARK - cds\CAAD\plansheets\C2.01 DEMOLITION PLAN.dwg
10/28/2022 08:42:17am
Layout: C2.03 DEMOLITION PLAN
October 28, 2022
10/28/2022 08:42:17am

MATCHLINE - SEE SHEET C2.02

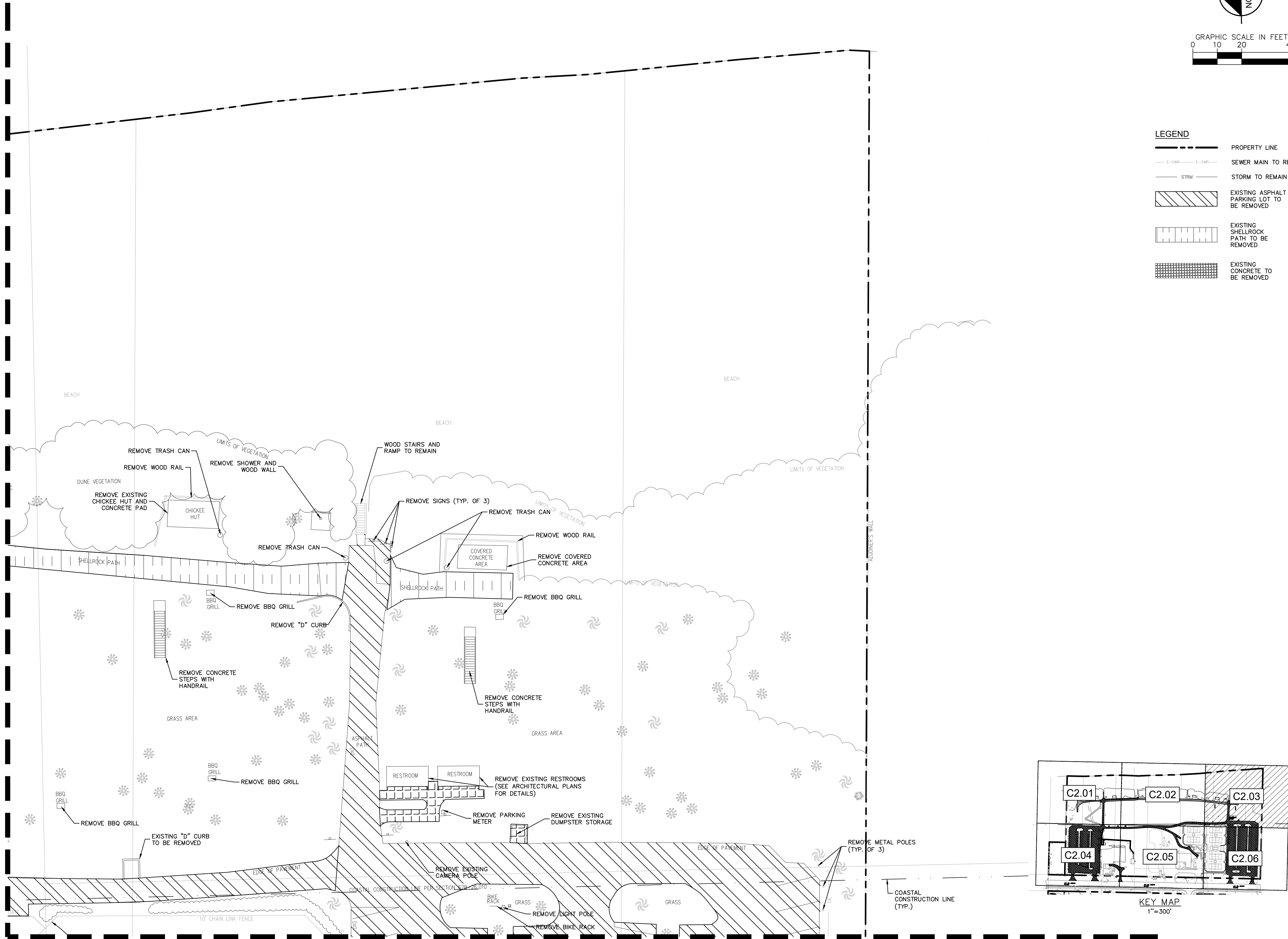

MATCHLINE - SEE SHEET C2.06

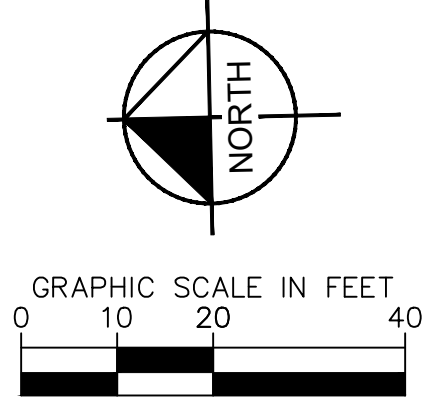

LEGEND

- PROPERTY LINE
- SEWER MAIN TO REMAIN
- STORM TO REMAIN
- EXISTING ASPHALT PARKING LOT TO BE REMOVED
- EXISTING SHELLROCK PATH TO BE REMOVED
- EXISTING CONCRETE TO BE REMOVED

CIVIL ENGINEER
Kimley»Horn
© 2022 KIMLEY-HORN AND ASSOCIATES, INC.
1920 WEKIVA WAY, SUITE 200,
WEST PALM BEACH, FL 33411
PHONE: 561-845-0665
FAX: 561-863-8175
WWW.KIMLEY-HORN.COM
REGISTRY NO. 35106

ARCHITECT
FAIRFAX & SAMMONS
FAIRFAX, SAMMONS & PARTNERS, LLC
214 BRAZILIAN AVENUE
PALM BEACH, FL 33480
PHONE: (561) 805-8591

LANDSCAPE ARCHITECT
jungles
RAYMOND JUNGLES, INC.
2964 AVIATION AVENUE
MIAMI, FL 33133
PHONE: (305) 858-6777

COA: 22-037
ZON: 22-107

No. REVISIONS DATE



PROJECT No. 140311003
DATE 10/28/2022
SCALE AS SHOWN
DESIGNED BY VMM
DRAWN BY MG
CHECKED BY TR

DEMOLITION PLAN



PHIPPS OCEAN PARK
PREPARED FOR
TOWN OF PALM BEACH

TOWN OF PALM BEACH FL
SHEET NUMBER
C2.03

Plotted By: Alexia Kristen
This document, together with the concepts and designs presented herein, as an instrument of service, is intended only for the specific purpose and client for which it was prepared. Reuse of and improper reliance on this document without written authorization and adaptation by Kimley-Horn and Associates, Inc. shall be without liability to Kimley-Horn and Associates, Inc.

Sheet Set: PHIPPS OCEAN PARK
Layout: C2.05 DEMOLITION PLAN
October 28, 2022
08:42:22am
K:\WPB-devservices\140311003 - phipps ocean park.cds\CADD\plansheets\C2.01 DEMOLITION PLAN.dwg

MATCHLINE - SEE SHEET C2.04

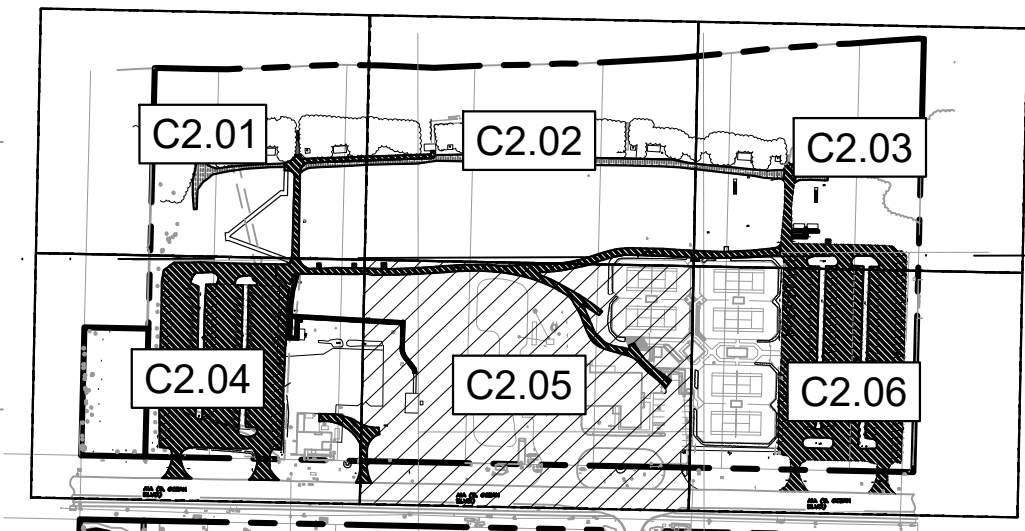

A1A (S. OCEAN BLVD)

MATCHLINE - SEE SHEET C2.02

MATCHLINE - SEE SHEET C2.06

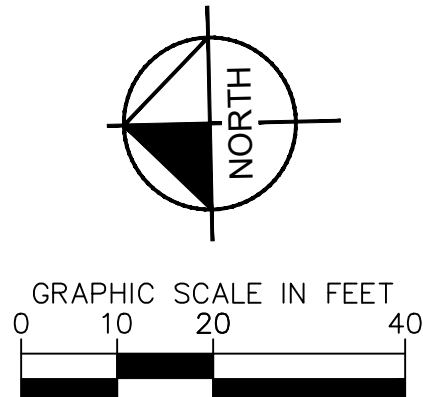

LEGEND

- PROPERTY LINE
- SEWER MAIN TO REMAIN
- STORM TO REMAIN
- EXISTING ASPHALT PARKING LOT TO BE REMOVED
- EXISTING SHELLROCK PATH TO BE REMOVED
- EXISTING CONCRETE TO BE REMOVED

CIVIL ENGINEER

Kimley»Horn

© 2022 KIMLEY-HORN AND ASSOCIATES, INC.
1920 WEKIVA WAY, SUITE 200,
WEST PALM BEACH, FL 33411
PHONE: 561-845-0665
FAX: 561-863-8175
WWW.KIMLEY-HORN.COM
REGISTRY NO. 35106

ARCHITECT



FAIRFAX & SAMMONS

FAIRFAX, SAMMONS & PARTNERS, LLC
214 BRAZILIAN AVENUE
PALM BEACH, FL 33480
PHONE: (561) 805-8591

LANDSCAPE ARCHITECT

jungles

RAYMOND JUNGLES, INC.
2964 AVIATION AVENUE
MIAMI, FL 33133
PHONE: (305) 858-6777

COA: 22-037
ZON: 22-107

No.	REVISIONS	DATE

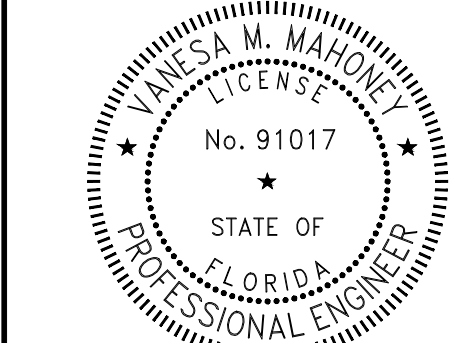

PROJECT No.	140311003
DATE	10/28/2022
SCALE	AS SHOWN
DESIGNED BY	VM
DRAWN BY	MG
CHECKED BY	TR

DEMOLITION PLAN



PHIPPS OCEAN PARK
PREPARED FOR
TOWN OF PALM BEACH

TOWN OF PALM BEACH FL
SHEET NUMBER
C2.05

Plotted By: Alexa Kristen
This document, together with the concepts and designs presented herein, is intended only for the specific purpose and client for which it was prepared. Reuse of and improper reliance on this document without written authorization and adaptation by Kimley-Horn and Associates, Inc. shall be without liability to Kimley-Horn and Associates, Inc.

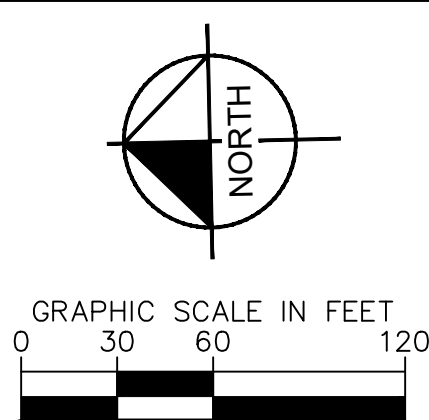
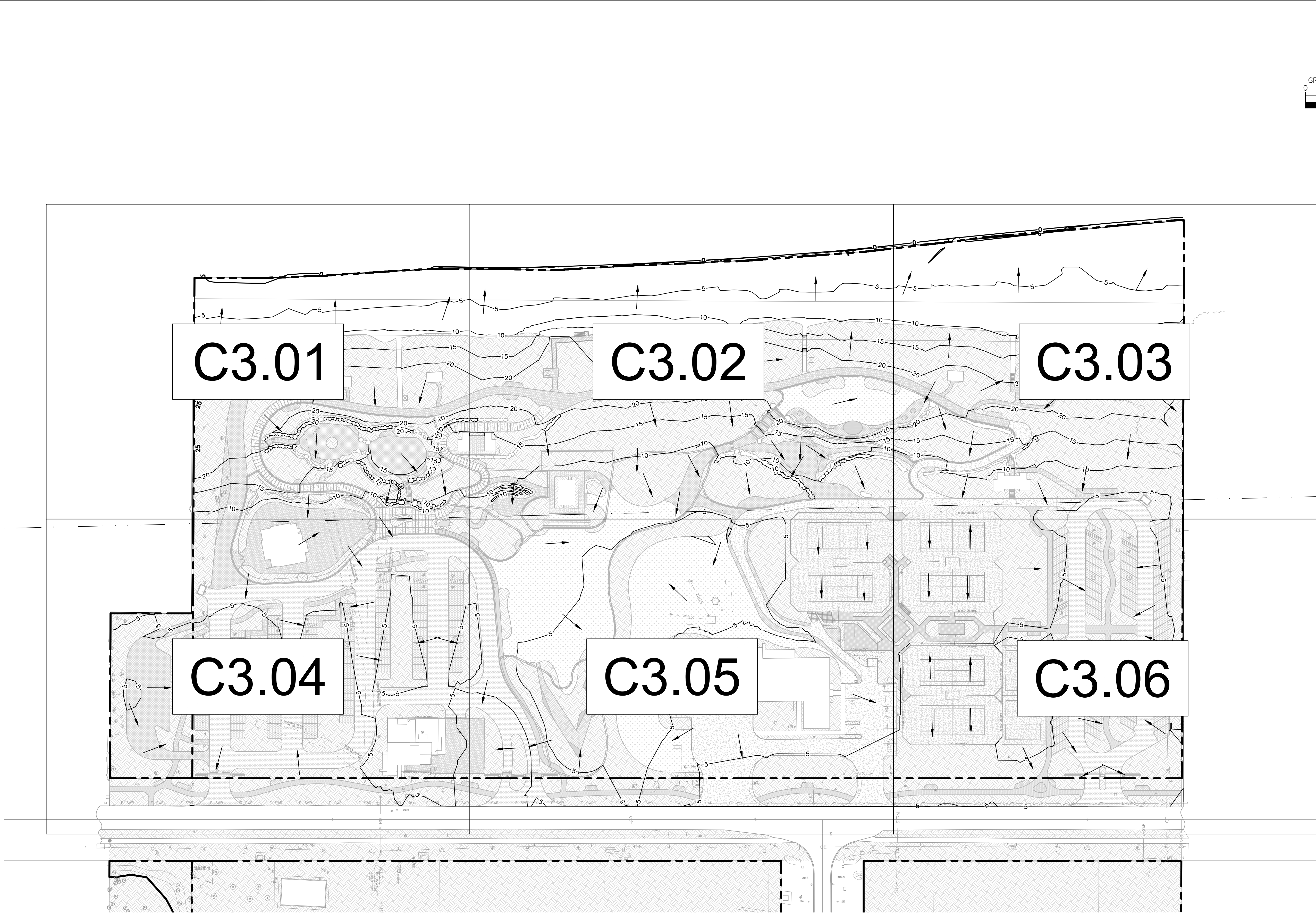

CIVIL ENGINEER
Kimley»Horn
© 2022 KIMLEY-HORN AND ASSOCIATES, INC.
1920 WEKIVA WAY, SUITE 200,
WEST PALM BEACH, FL 33411
PHONE: 561-845-0665
FAX: 561-863-8175
WWW.KIMLEY-HORN.COM
REGISTRY NO. 35106

ARCHITECT
FAIRFAX & SAMMONS
NEW YORK • PALM BEACH
FAIRFAX, SAMMONS & PARTNERS, LLC
214 BRAZILIAN AVENUE
PALM BEACH, FL 33480
PHONE: (561) 805-8591

LANDSCAPE ARCHITECT
jungles
RAYMOND JUNGLES, INC.
2964 AVIATION AVENUE
MIAMI, FL 33133
PHONE: (305) 858-6777

COA: 22-037
ZON: 22-107

No.	REVISIONS	DATE
-----	-----------	------

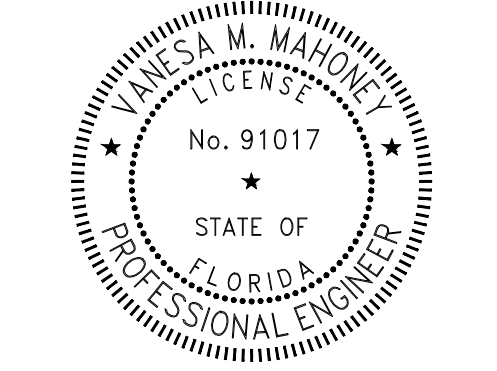

PROJECT No.	140311003
DATE	10/28/2022
SCALE	AS SHOWN
DESIGNED BY	VM
DRAWN BY	MG
CHECKED BY	TR

OVERALL MASS GRADING PLAN

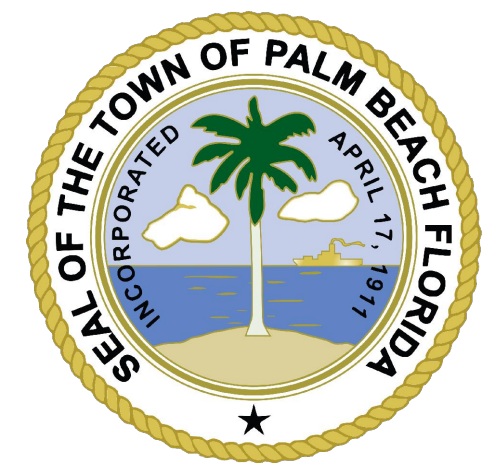

**PHIPPS OCEAN
PARK**
PREPARED FOR
TOWN OF PALM
BEACH

TOWN OF PALM BEACH FL
SHEET NUMBER
C3.00

VERTICAL DATUM
ELEVATIONS SHOWN HEREON ARE BASED ON THE
NORTH AMERICAN VERTICAL DATUM OF 1988.
NAVD '88 ELEV + 1.086' = NGVD '29 ELEVATION

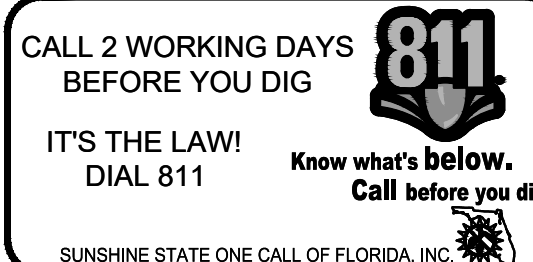

Plotted By: Alexia Kristen
This document, together with the concepts and designs presented herein, is intended only for the specific purpose and client for which it was prepared. Reuse of and improper reliance on this document without written authorization and adaptation by Kimley-Horn and Associates, Inc. shall be without liability to Kimley-Horn and Associates, Inc.

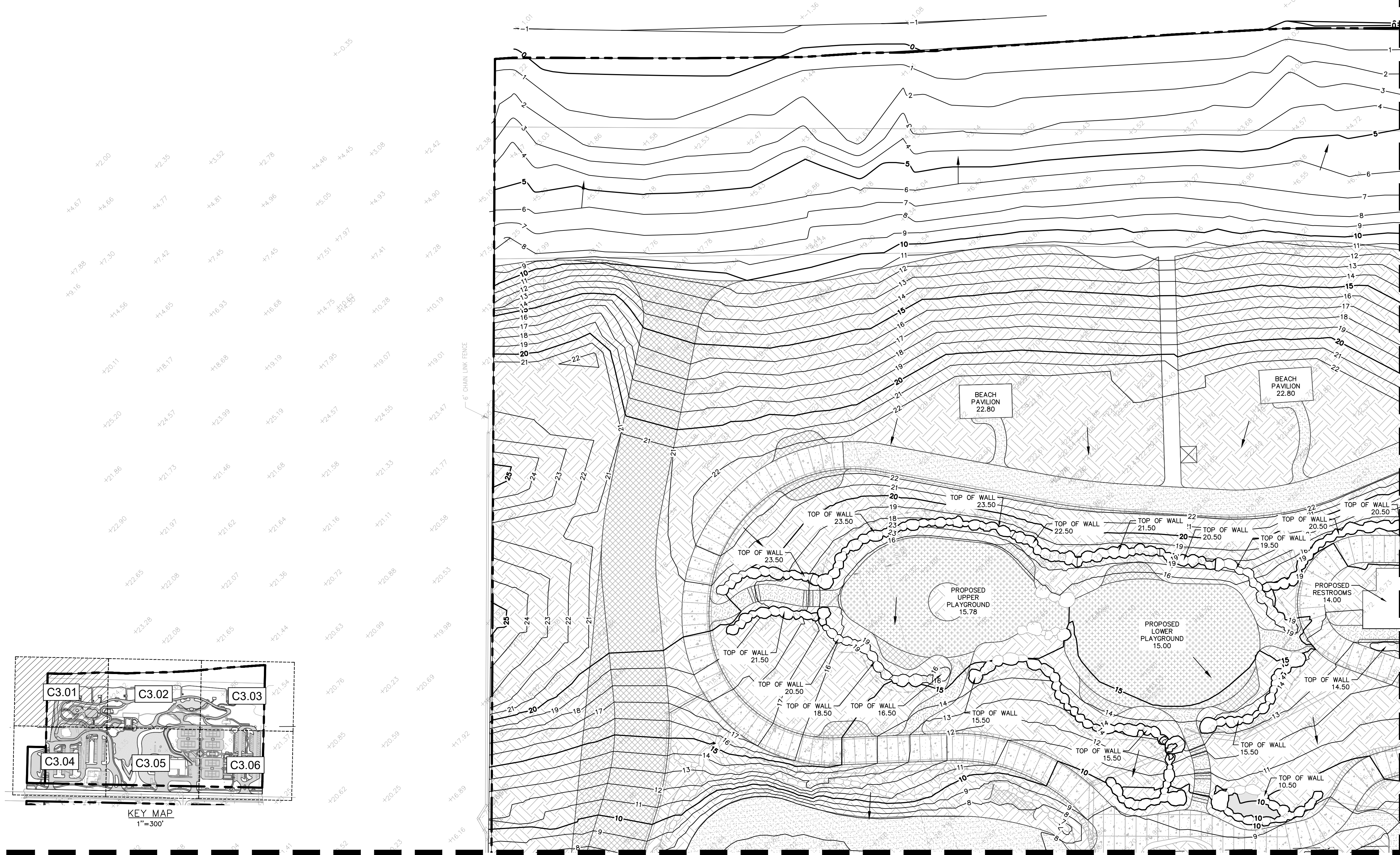
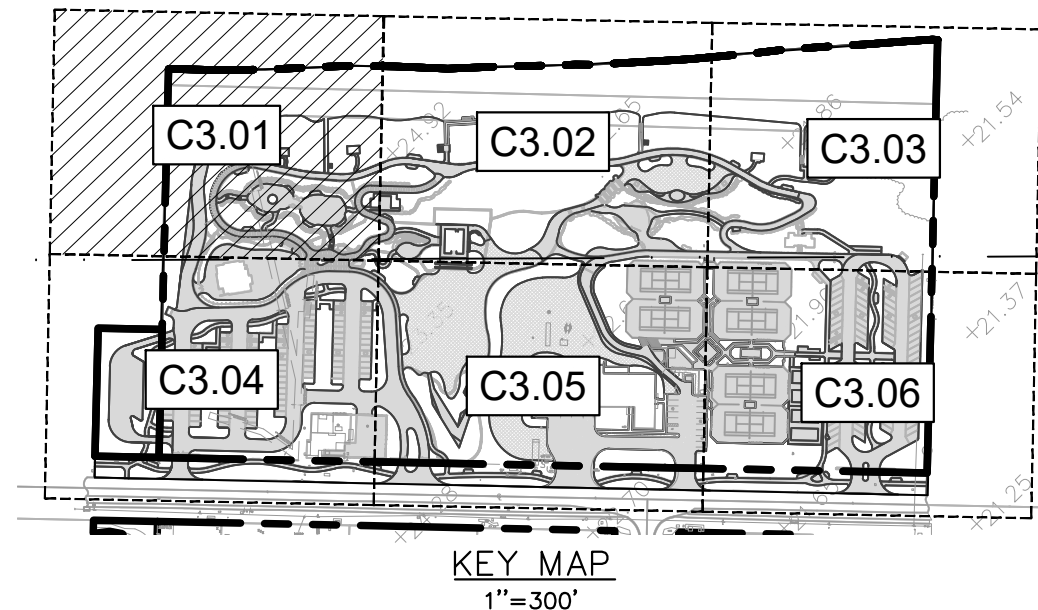

LEGEND

- PROPERTY LINE
- PLANTING AREA
- LAWN
- PERMEABLE PAVING
- VEHICULAR CONCRETE
- GRAVEL PAVING
- ELEVATED WALKWAY
- PEDESTRIAN CONCRETE
- GRASSPAVE
- PLAYGROUND SURFACING

MATCHLINE - SEE SHEET C3.02

MATCHLINE - SEE SHEET C3.04

VERTICAL DATUM
ELEVATIONS SHOWN HEREON ARE BASED ON THE
NORTH AMERICAN VERTICAL DATUM OF 1988.
NAVD '88 ELEV + 1.086' = NGVD '29 ELEVATION

CALL 2 WORKING DAYS
BEFORE YOU DIG

IT'S THE LAW!
DIAL 811

SUNSHINE STATE ONE CALL OF FLORIDA, INC.

CIVIL ENGINEER

Kimley»Horn

© 2022 KIMLEY-HORN AND ASSOCIATES, INC.
1920 WEKIVA WAY, SUITE 200,
WEST PALM BEACH, FL 33411
PHONE: 561-845-0665
FAX: 561-863-8175
WWW.KIMLEY-HORN.COM
REGISTRY NO. 35106

ARCHITECT

FAIRFAX & SAMMONS

FAIRFAX, SAMMONS & PARTNERS, LLC
214 BRAZILIAN AVENUE
PALM BEACH, FL 33480
PHONE: (561) 805-8591

LANDSCAPE ARCHITECT

jungles

RAYMOND JUNGLES, INC.
2964 AVIATION AVENUE
MIAMI, FL 33133
PHONE: (305) 858-6777

COA: 22-037
ZON: 22-107

No.	REVISIONS	DATE

PROJECT No. 140311003
DATE 10/28/2022
SCALE AS SHOWN
DESIGNED BY VM
DRAWN BY MG
CHECKED BY TR

**MASS
GRADING
PLAN**

**PHIPPS OCEAN
PARK**
PREPARED FOR
TOWN OF PALM
BEACH

TOWN OF PALM BEACH FL
SHEET NUMBER
C3.01