

This document, together with the concepts and designs presented herein, as an instrument of service, is intended only for the specific purpose and client for which it was prepared. Reuse of and improper reliance on this document without written authorization and adaptation by Kimley-Horn and Associates, Inc. shall be without liability to Kimley-Horn and Associates, Inc.



9 OUTDOOR CLASSROOM



10 OUTDOOR CLASSROOM



11 PATH TO PICNIC AREA



12 HORIZON PLATEAU

CIVIL ENGINEER

**Kimley»Horn**

1920 WEKIVA WAY, SUITE 200,  
WEST PALM BEACH, FL 33411  
PHONE: 561-845-0665  
FAX: 561-863-8175  
WWW.KIMLEY-HORN.COM  
REGISTRY NO. 35106

ARCHITECT



**FAIRFAX & SAMMONS**

FAIRFAX, SAMMONS & PARTNERS, LLC  
214 BRAZILIAN AVENUE  
PALM BEACH, FL 33480  
PHONE: (561) 805-8591

LANDSCAPE ARCHITECT

**jungles**

**RAYMOND JUNGLES, INC.**

2964 AVIATION AVENUE  
MIAMI, FL 33133  
PHONE: (305) 858-6777

COA: 22-037  
ZON: 22-107

No.	REVISIONS	DATE
-----	-----------	------

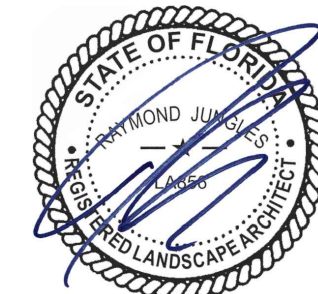

PROJECT No.

DATE 10/28/2022

SCALE AS SHOWN

DESIGNED BY

DRAWN BY

CHECKED BY

RENDERINGS



**PHIPPS OCEAN  
PARK**  
PREPARED FOR  
TOWN OF PALM  
BEACH

SHEET NUMBER

**GI.052**



This document, together with the concepts and designs presented herein, as an instrument of service, is intended only for the specific purpose and client for which it was prepared. Reuse of and improper reliance on this document without written authorization and adaptation by Kimley-Horn and Associates, Inc. shall be without liability to Kimley-Horn and Associates, Inc.



13 HORIZON PLATEAU



14 HORIZON PLATEAU



15 LITTLE RED SCHOOLHOUSE



16 GREAT LAWN

CIVIL ENGINEER

**Kimley»Horn**

1920 WEKIVA WAY, SUITE 200,  
WEST PALM BEACH, FL 33411  
PHONE: 561-845-0665  
FAX: 561-863-8175  
WWW.KIMLEY-HORN.COM  
REGISTRY NO. 35106

ARCHITECT



**FAIRFAX & SAMMONS**

NEW YORK - PALM BEACH  
FAIRFAX, SAMMONS & PARTNERS, LLC  
214 BRAZILIAN AVENUE  
PALM BEACH, FL 33480  
PHONE: (561) 805-8591

LANDSCAPE ARCHITECT

**jungles**

**RAYMOND JUNGLES, INC.**

2964 AVIATION AVENUE  
MIAMI, FL 33133  
PHONE: (305) 858-6777

COA: 22-037  
ZON: 22-107

No.	REVISIONS	DATE
-----	-----------	------



PROJECT No.

DATE 10/28/2022

SCALE AS SHOWN

DESIGNED BY

DRAWN BY

CHECKED BY

RENDERINGS



**PHIPPS OCEAN  
PARK**  
PREPARED FOR  
TOWN OF PALM  
BEACH

SHEET NUMBER  
**GI.053**



This document, together with the concepts and designs presented herein, is intended only for the specific purpose and client for which it was prepared. Reuse of and improper reliance on this document without written authorization and adaptation by Kimley-Horn and Associates, Inc. shall be without liability to Kimley-Horn and Associates, Inc.

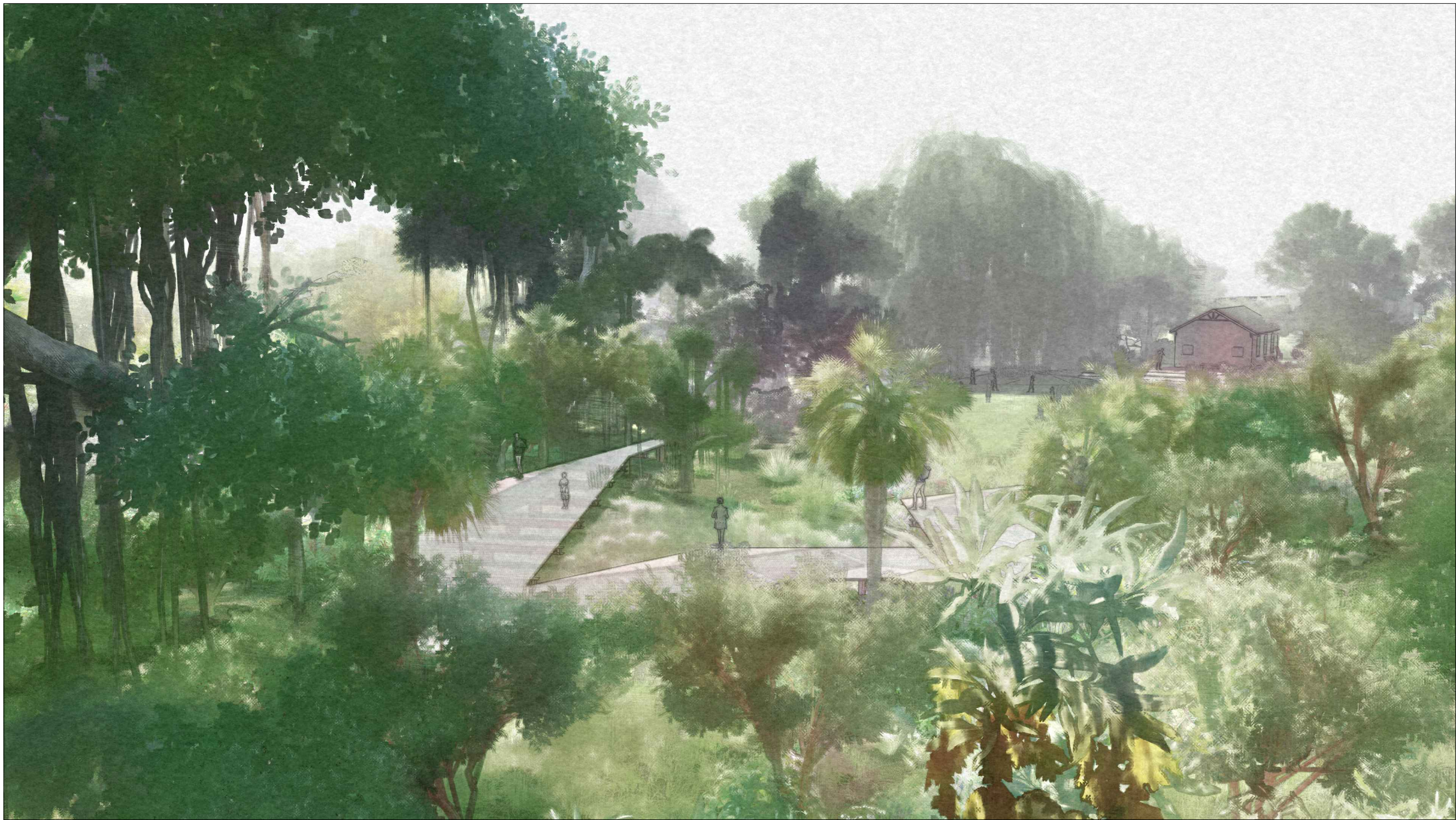

17 WILDFLOWER GARDEN



19 WILDFLOWER GARDEN



18 WILDFLOWER GARDEN



20 THE GREAT LAWN

CIVIL ENGINEER

**Kimley»Horn**

1920 WEKIVA WAY, SUITE 200,  
WEST PALM BEACH, FL 33411  
PHONE: 561-845-0665  
FAX: 561-863-8175  
WWW.KIMLEY-HORN.COM  
REGISTRY NO. 35106

ARCHITECT



**FAIRFAX & SAMMONS**

FAIRFAX, SAMMONS & PARTNERS, LLC  
214 BRAZILIAN AVENUE  
PALM BEACH, FL 33480  
PHONE: (561) 805-8591

LANDSCAPE ARCHITECT

**jungles**

RAYMOND JUNGLES, INC.  
2964 AVIATION AVENUE  
MIAMI, FL 33133  
PHONE: (305) 858-6777

COA: 22-037  
ZON: 22-107

No.	REVISIONS	DATE



PROJECT No.

DATE 10/28/2022

SCALE AS SHOWN

DESIGNED BY

DRAWN BY

CHECKED BY

RENDERINGS



**PHIPPS OCEAN  
PARK**  
PREPARED FOR  
TOWN OF PALM  
BEACH

SHEET NUMBER  
**GI.054**





21) PICNIC AREA



22) PICNIC AREA



23) COASTAL RESTORATION CENTER



24) PARKING LOTS

CIVIL ENGINEER

**Kimley»Horn**

1920 WEKIVA WAY, SUITE 200,  
WEST PALM BEACH, FL 33411  
PHONE: 561-845-0665  
FAX: 561-863-8175  
WWW.KIMLEY-HORN.COM  
REGISTRY NO. 35106

ARCHITECT



**FAIRFAX & SAMMONS**

FAIRFAX, SAMMONS & PARTNERS, LLC  
214 BRAZILIAN AVENUE  
PALM BEACH, FL 33480  
PHONE: (561) 805-8591

LANDSCAPE ARCHITECT

**jungles**

RAYMOND JUNGLES, INC.  
2964 AVIATION AVENUE  
MIAMI, FL 33133  
PHONE: (305) 858-6777

COA: 22-037  
ZON: 22-107

No.	REVISIONS	DATE
-----	-----------	------



PROJECT No.

DATE 10/28/2022

SCALE AS SHOWN

DESIGNED BY

DRAWN BY

CHECKED BY

RENDERINGS



**PHIPPS OCEAN  
PARK**  
PREPARED FOR  
TOWN OF PALM  
BEACH

SHEET NUMBER

**GI.055**

This document, together with the concepts and designs presented herein, is intended only for the specific purpose and client for which it was prepared. Reuse of and improper reliance on this document without written authorization and adaptation by Kimley-Horn and Associates, Inc. shall be without liability to Kimley-Horn and Associates, Inc.



This document, together with the concepts and designs presented herein, as an instrument of service, is intended only for the specific purpose and client for which it was prepared. Reuse of and improper reliance on this document without written authorization and adaptation by Kimley-Horn and Associates, Inc. shall be without liability to Kimley-Horn and Associates, Inc.



25 HORIZON PLATEAU



26 HORIZON PLATEAU

CIVIL ENGINEER

Kimley»Horn

1920 WEKIVA WAY, SUITE 200,  
WEST PALM BEACH, FL 33411  
PHONE: 561-845-0665  
FAX: 561-863-8175  
WWW.KIMLEY-HORN.COM  
REGISTRY NO. 35106

ARCHITECT



FAIRFAX & SAMMONS

FAIRFAX, SAMMONS & PARTNERS, LLC  
214 BRAZILIAN AVENUE  
PALM BEACH, FL 33480  
PHONE: (561) 805-8591

LANDSCAPE ARCHITECT

jungles

RAYMOND JUNGLES, INC.  
2964 AVIATION AVENUE  
MIAMI, FL 33133  
PHONE: (305) 858-6777

COA: 22-037  
ZON: 22-107

No.	REVISIONS	DATE

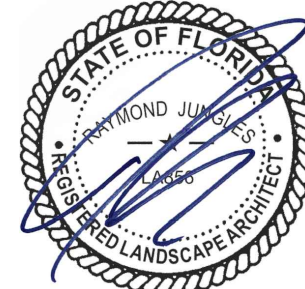

PROJECT No.

DATE 10/28/2022

SCALE AS SHOWN

DESIGNED BY

DRAWN BY

CHECKED BY

RENDERINGS



PHIPPS OCEAN  
PARK  
PREPARED FOR  
TOWN OF PALM  
BEACH

SHEET NUMBER  
GI.056



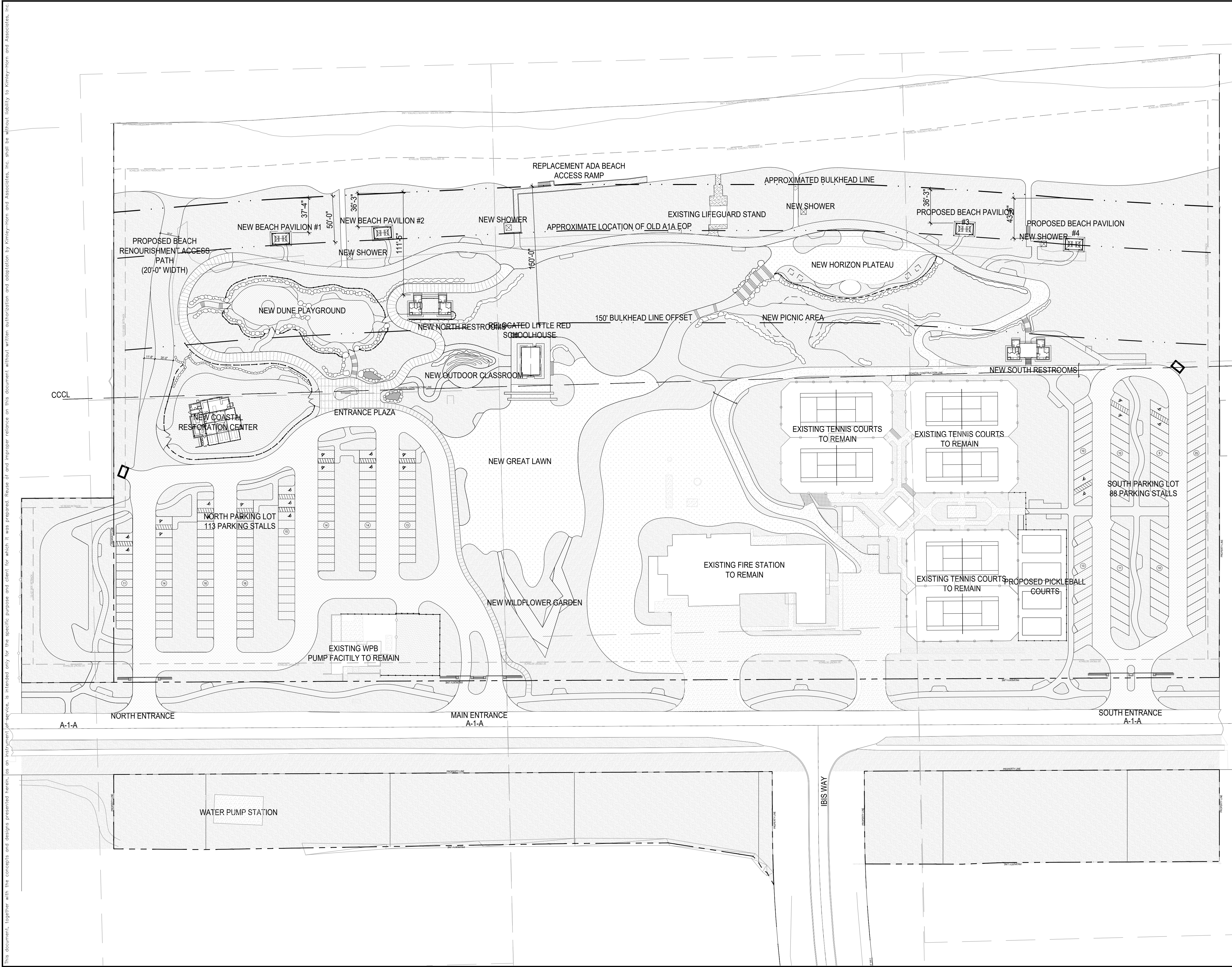

LEGEND
PROPERTY LINE
SETBACK
COASTAL CONSTRUCTION CONTROL LINE

CIVIL ENGINEER  
**Kimley»Horn**  
1920 WEKIVA WAY, SUITE 200,  
WEST PALM BEACH, FL 33411  
PHONE: 561-845-0665  
FAX: 561-863-8175  
WWW.KIMLEY-HORN.COM  
REGISTRY NO. 35106

ARCHITECT  
  
**FAIRFAX & SAMMONS**  
NEW YORK - PALM BEACH  
FAIRFAX, SAMMONS & PARTNERS, LLC  
214 BRAZILIAN AVENUE  
PALM BEACH, FL 33480  
PHONE: (561) 805-8591

LANDSCAPE ARCHITECT  
**jungles**  
RAYMOND JUNGLES, INC.  
2964 AVIATION AVENUE  
MIAMI, FL 33133  
PHONE: (305) 858-6777

COA: 22-037		
ZON: 22-107		
No.	REVISIONS	DATE



PROJECT No.	
DATE	10/28/2022
SCALE	AS SHOWN
DESIGNED BY	
DRAWN BY	
CHECKED BY	

SITE PLAN



**PHIPPS OCEAN PARK**  
PREPARED FOR  
TOWN OF PALM BEACH

SHEET NUMBER  
**GI.000**