

ARCHITECTURE AND DESIGN
PROGETTO DI ARCHITETTURA

THE PARAMOUNT BUILDING
139 NORTH COUNTY ROAD, SUITE 20-C
PALM BEACH, FLORIDA 33480

T: 561 461 0108
F: 561 461 0106

FL LIC. # AA26003943

BARTHOLEMEWPARTNERS.COM

CONSULTANTS

**ENVIRONMENT DESIGN GROUP
LANDSCAPE ARCHITECT**
139 N COUNTY ROAD, SUITE 20-B
PALM BEACH, FL 33480
PHONE: 561-832-4800
E-MAIL: DUSTING@ENVIRONMENTDESIGNGROUP.COM

GRUBER CONSULTING ENGINEERS
CIVIL ENGINEER
2475 MERCER AVE
WEST PALM BEACH, FL 33401
PHONE: 561-312-2041
E-MAIL: CHAD@GRUBERENGINEERS.COM

KOCHMAN & ZISKA PLC
ATTORNEY
222 LAKEVIEW AVENUE, SUITE 1500
WEST PALM BEACH, FL 33401
PHONE: 561-802-8960
E-MAIL: MZISKA@FLORIDAWILLS.COM

**CONKLING AND LEWIS CONSTRUCTION, INC
CONTRACTOR**
1241 OLD OKEECHOBEE BLVD
WEST PALM BEACH, FL 33401
PHONE: 561-833-4441
E-MAIL: KLEWIS@CONKLINGANDLEWIS.COM

KYLE B FANT ARCHITECT # AR99255
INTERIOR DESIGNER # ID6422
AIA # 30425933 NCARB # 87929

Revisions: _____

COPYRIGHT 2021. THESE DRAWINGS ARE THE INSTRUMENT OF SERVICE TO THE ARCHITECT. THEY ARE NOT PRODUCTS OF DESIGN, ALL IDEAS, DESIGNS, ARRANGEMENTS AND PLANS INDICATED OR REPRESENTED BY THIS/ THESE DRAWINGS ARE OWNED BY AND THE PROPERTY OF BAKHTOLLOBIYEV + PARTNERS, AND YEARS CREATED, EVOLVED AND DEVELOPED FOR USE ON AND IN CONNECTION WITH THIS PROJECT. NONE OF SUCH IDEAS, DESIGNS, ARRANGEMENTS OR PLANS SHALL BE USED OR DISCLOSED TO ANY PERSON, FIRM OR CORPORATION WITHOUT THE WRITTEN PERMISSION OF BAKHTOLLOBIYEV + PARTNERS.

CONSTRUCTION ADMINISTRATION, AS THE TERM IS GENERALLY UNDERSTOOD, AND THAT IF BARTHOLEMEW + PARTNERS IS NOT COMPACTED TO PROVIDE ARCHITECTURAL SERVICES DURING CONSTRUCTION, INCLUDING ON-SITE MONITORING, SITE VISITS, SHOP DRAWING REVIEW, DESIGN CLARIFICATION, ETC., THE CLIENT AGREES TO INDEMNIFY AND HOLD HARMLESS BARTHOLEMEW + PARTNERS FROM ANY LIABILITY ARISING FROM ACTS OR OMISSIONS IN THE PERFORMANCE OF SAID SERVICES DURING CONSTRUCTION BY THE CLIENT, AND THEIR AGENTS, EMPLOYEES, OR SUBCONTRACTORS.

Project no: 21.10.161
Date: 06/27/22
Drawn by: VFA
Project Architect: KBF

NEW RESIDENCE FOR THE KASSATLY FAMILY

Project Address:
335 COCOANUT ROW,
PALM BEACH, FL 33480

SHEET NAME

PROPOSED COLOR ELEVATIONS

SHEET NUMBER

A2.0.3

ARCOM SET

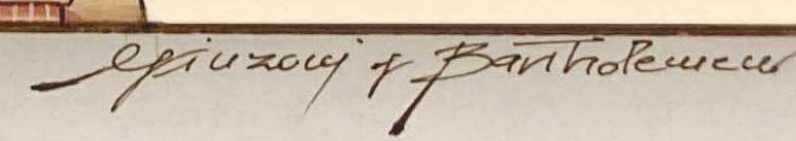

PROPOSED WEST COLOR ELEVATION

SCALE: 1/4" = 1'

ARC-22-161
ZON-22-108

ARCHITECTURE AND DESIGN
PROGETTO DI ARCHITETTURA

CONSULTANTS

**ENVIRONMENT DESIGN GROUP
LANDSCAPE ARCHITECT**
139 N COUNTY ROAD, SUITE 20-B
PALM BEACH, FL 33480
PHONE: 561-832-4600
E-MAIL: DUSTIN@ENVIRONMENTDESIGNGROUP.COM

GRUBER CONSULTING ENGINEERS
CIVIL ENGINEER
 2475 MERCER AVE
 WEST PALM BEACH, FL 33401
 PHONE: 561-312-2041
 E-MAIL: CHAD@GRUBERENGINEERS.COM

KOCHMAN & ZISKA PLC
ATTORNEY
 222 LAKEVIEW AVENUE, SUITE 1500
 WEST PALM BEACH, FL 33401
 PHONE: 561-802-8960
 E-MAIL: MZISKA@FLORIDAWILLS.COM

CONKLING AND LEWIS CONSTRUCTION, INC
CONTRACTOR
 1241 OLD OKEECHOBEE BLVD
 WEST PALM BEACH, FL 33401
 PHONE: 561-833-4441
 E-MAIL: KLEWIS@CONKLINGANDLEWIS.COM

KYLE B FANT ARCHITECT # AR99255
INTERIOR DESIGNER # ID8422
AIA # 30425933 NCARB # 87929

Revisions:

COPYRIGHT 2021. THESE DRAWINGS ARE THE INSTRUMENT OF SERVICE TO THE ARCHITECT. THEY ARE NOT PRODUCTS OF DESIGN. ALL IDEAS, DESIGNS, ARRANGEMENTS AND PLANS INDICATED OR REPRESENTED BY THESE DRAWINGS ARE OWNED BY AND ARE THE PROPERTY OF PANTHEUS+PARTNERS, AND WERE CREATED, EVOLVED AND DEVELOPED FOR USE ON AND IN CONNECTION WITH THIS PROJECT. NONE OF SUCH IDEAS, DESIGNS, ARRANGEMENTS OR PLANS SHALL BE USED BY OR DISCLOSED TO ANY PERSON, FIRM OR CORPORATION WITHOUT THE WRITTEN PERMISSION OF PANTHEUS+PARTNERS.

Project no: 21.10.161
Date: 06/27/22
Drawn by: VFA
Project Architect: KBF

NEW RESIDENCE FOR THE KASSATLY FAMILY

Project Address:
335 COCOANUT ROW,
PALM BEACH, FL 33480

SHEET NAME

PROPOSED COLOR ELEVATIONS

SHEET NUMBER

ARCOM SET

SCALE: 3/8" = 1'

ARC-22-161
ZON-22-108



PROPOSED SOUTH ELEVATION

SCALE: 1/4" = 1'

ARC-22-161
ZON-22-108

PROPOSED ENLARGED SOUTH ELEVATION

SCALE: 3/8" = 1'

ARC-22-161
ZON-22-108



SOUTH ELEVATION DETAIL

SCALE: 3/8" = 1"

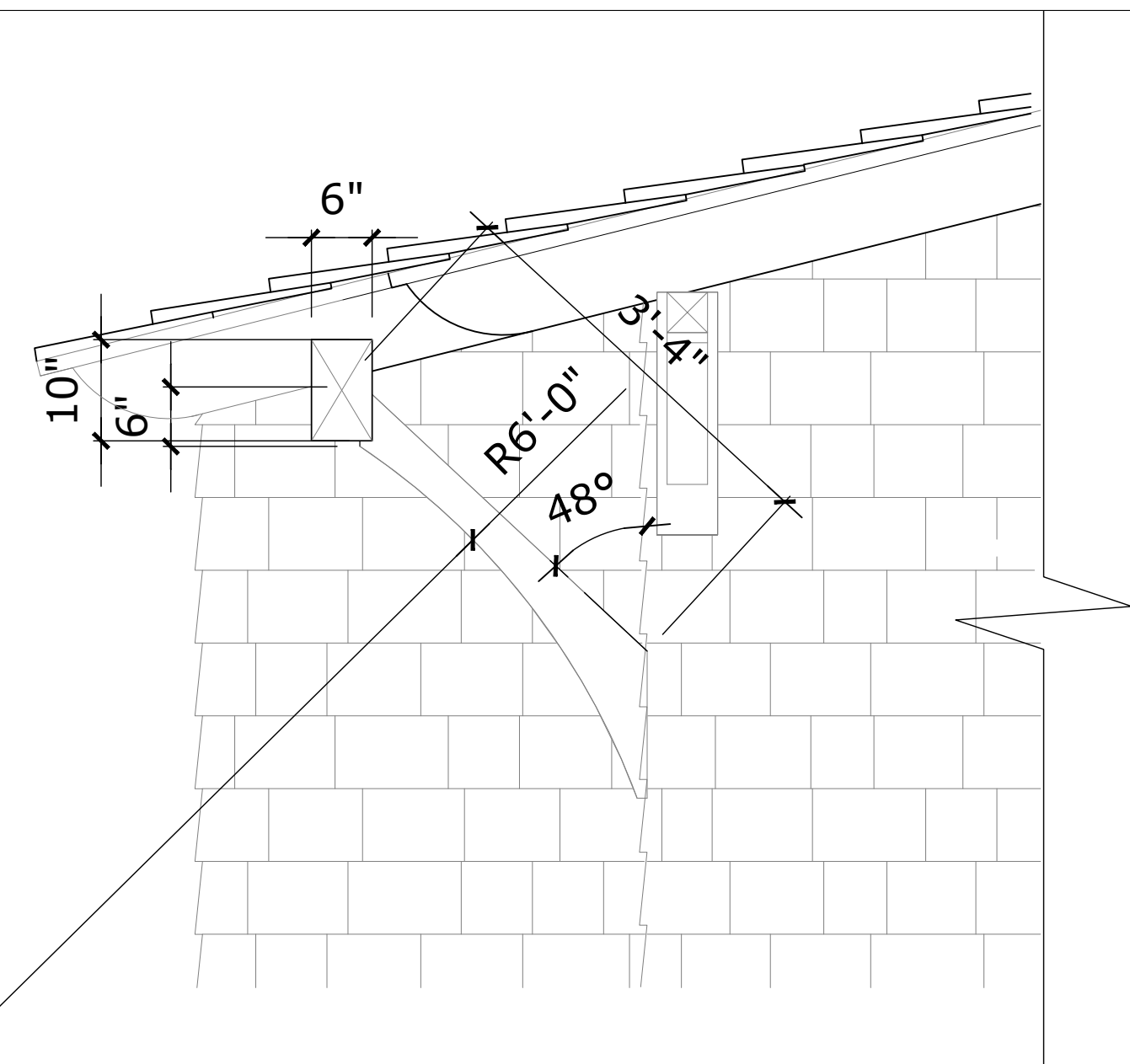

1 BRACKET DETAIL

SCALE: 3/4" = 1"

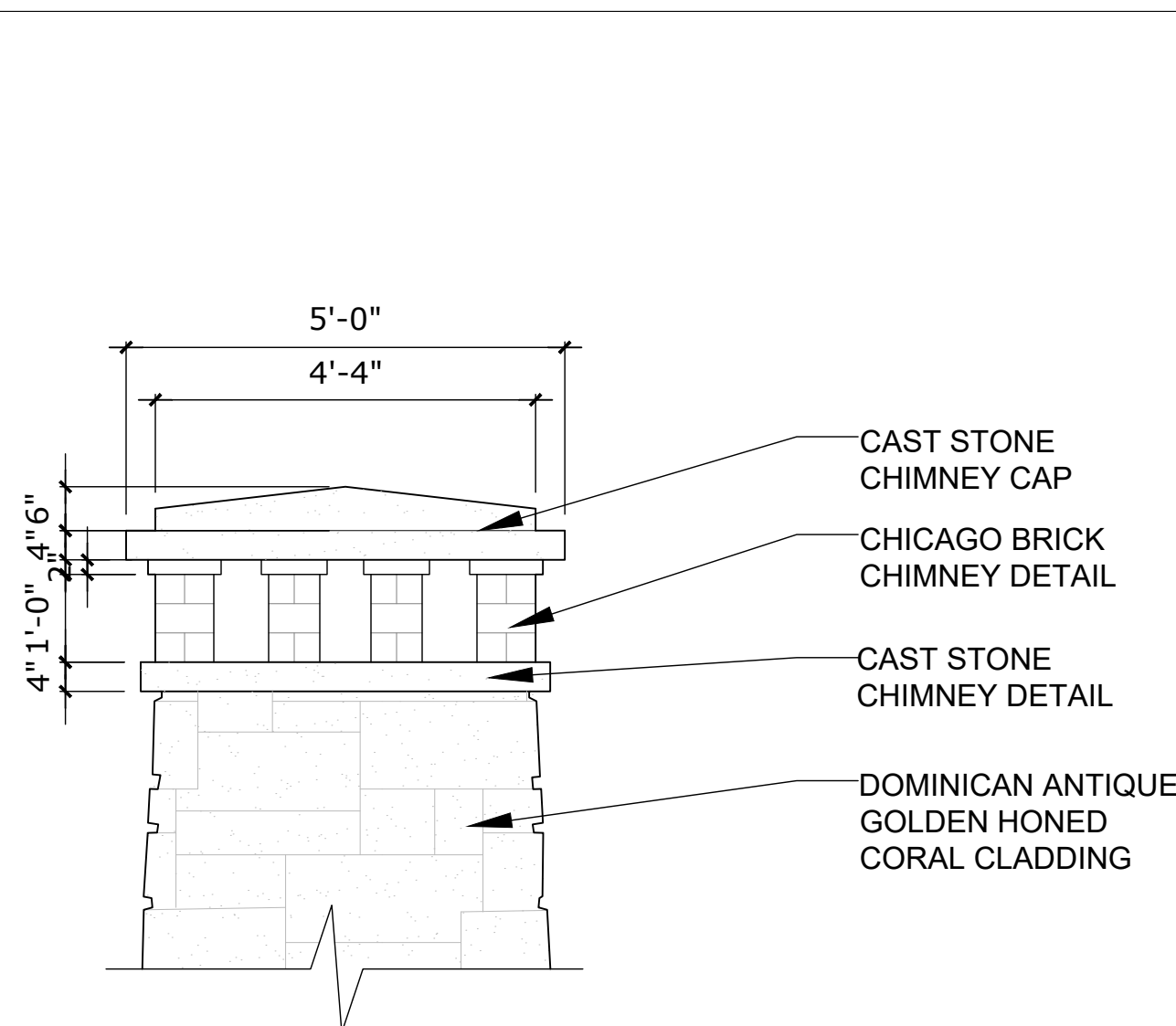

2 CHIMNEY CAP DETAIL

SCALE: 1/2" = 1"

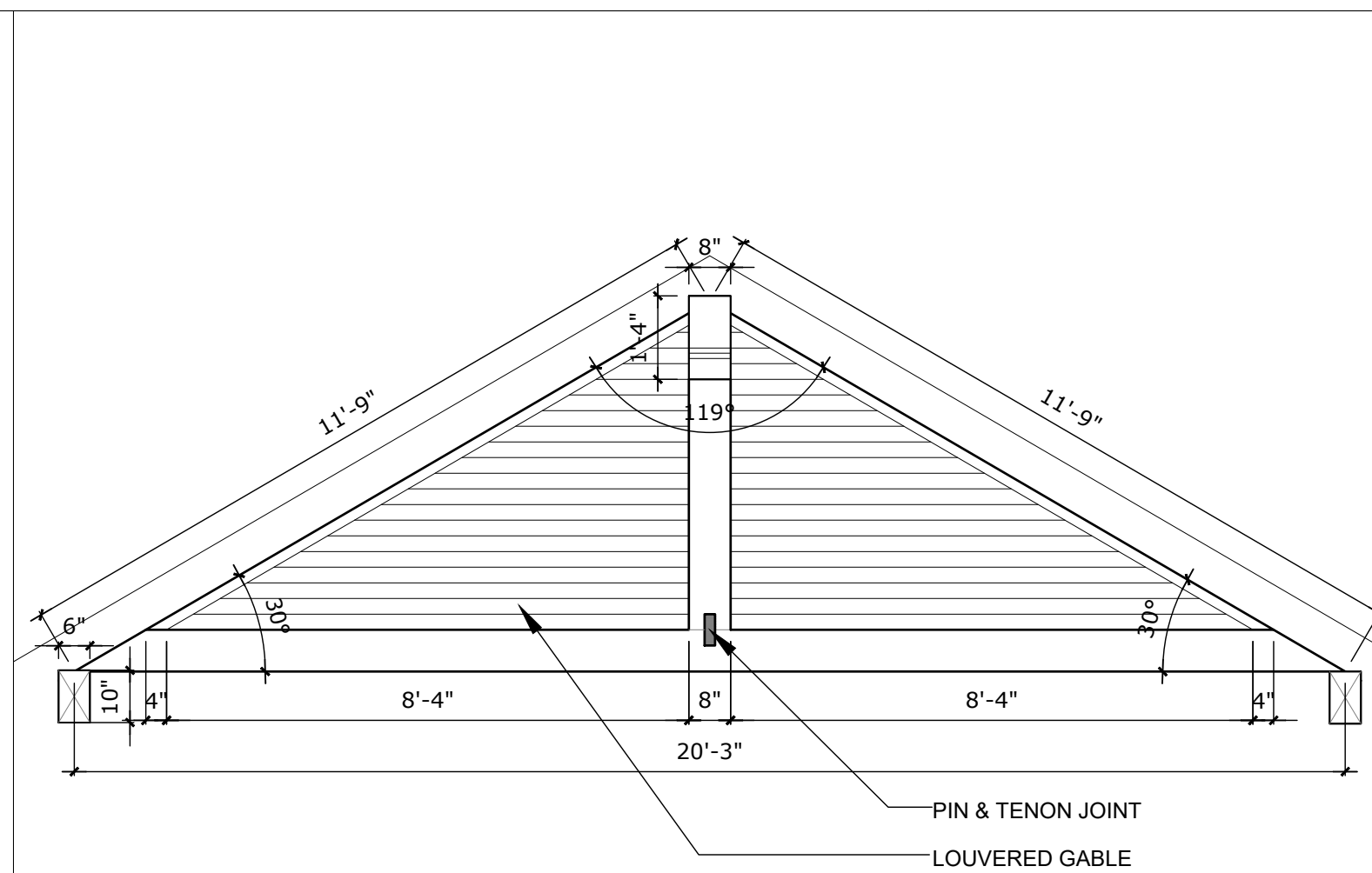

3 SIDE GABLE DETAIL

SCALE: 3/8" = 1"

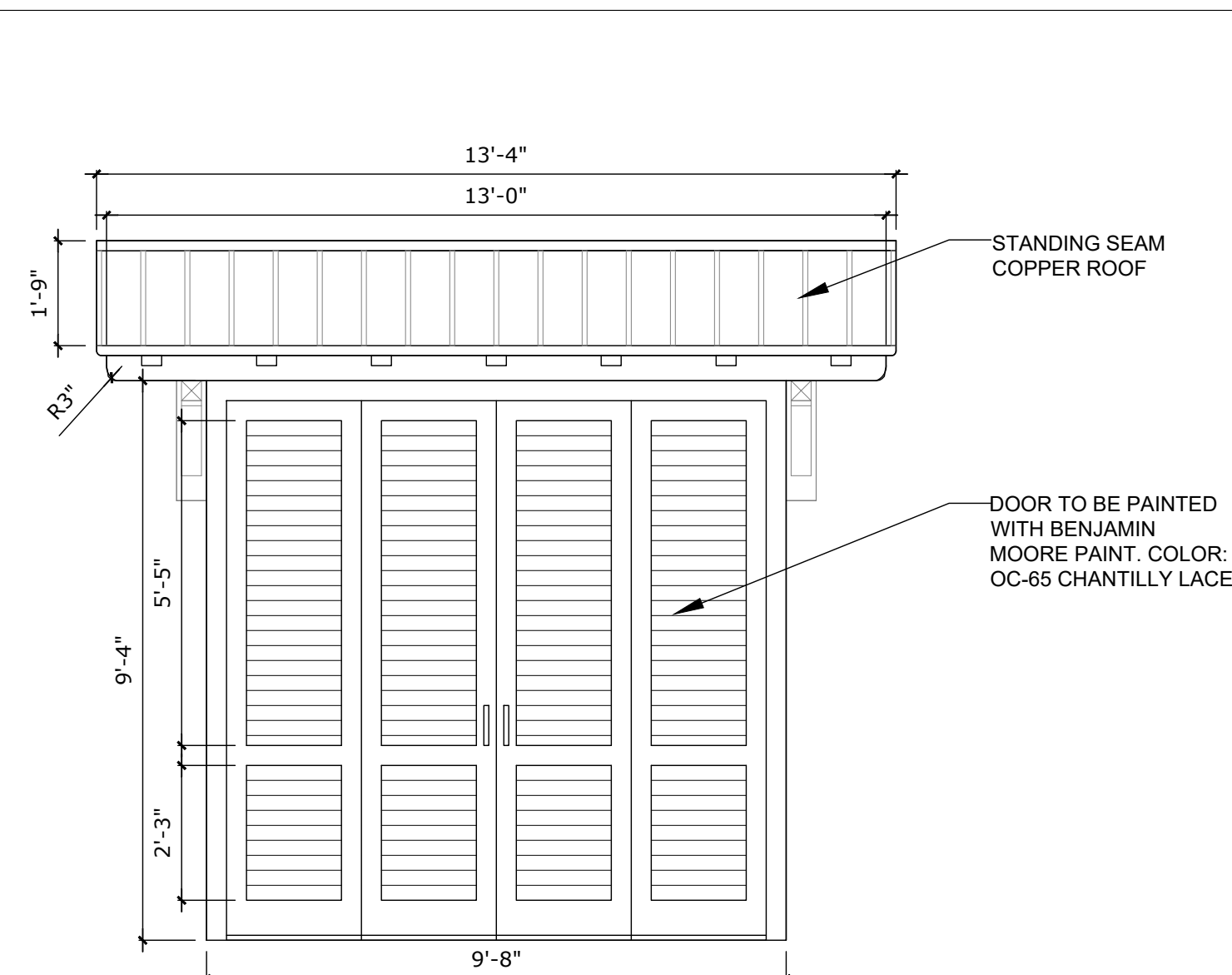

4 BIKE STORAGE DETAIL

SCALE: 3/8" = 1"

ARC-22-161
ZON-22-108

CONTRACTOR: SEE NOTES DRAWINGS ARE THE RESPONSIBILITY OF BARTHOLEMEW + PARTNERS. THE ARCHITECT: KYLE B FANT ARCHITECT. ALL RIGHTS RESERVED. ANY REUSE OR REPRODUCTION OF THESE DRAWINGS WITHOUT THE WRITTEN PERMISSION OF BARTHOLEMEW + PARTNERS IS PROHIBITED. ANY REUSE OR REPRODUCTION OF THESE DRAWINGS WITHOUT THE WRITTEN PERMISSION OF BARTHOLEMEW + PARTNERS IS PROHIBITED. ANY REUSE OR REPRODUCTION OF THESE DRAWINGS WITHOUT THE WRITTEN PERMISSION OF BARTHOLEMEW + PARTNERS IS PROHIBITED.

Project no: 21.10.161
Date: 06/27/22
Drawn by: VFA
Project Architect: KBF

NEW RESIDENCE FOR THE
KASSATLY FAMILY

Project Address:
335 COCOANUT ROW,
PALM BEACH, FL 33480

SHEET NAME

SOUTH ELEVATION
DETAILS

SHEET NUMBER

A2.1.2

ARCOM SET

ARCHITECTURE AND DESIGN
PROGETTO DI ARCHITETTURA

THE PARAMOUNT BUILDING
139 NORTH COUNTY ROAD, SUITE 20-C
PALM BEACH, FLORIDA 33480

T: 561 461 0108
F: 561 461 0106

FL LIC. # AA26003943

BARTHOLEMEWPARTNERS.COM

CONSULTANTS

**ENVIRONMENT DESIGN GROUP
LANDSCAPE ARCHITECT**
139 N COUNTY ROAD, SUITE 20-B
PALM BEACH, FL 33480
PHONE: 561-832-4600
E-MAIL: DUSTIN@ENVIRONMENTDESIGNGROUP.COM

**GRUBER CONSULTING ENGINEERS
CIVIL ENGINEER**
2415 MERCER AVE
WEST PALM BEACH, FL 33401
PHONE: 561-312-2041
E-MAIL: CHAD@GRUBERENGINEERS.COM

KOCHMAN & ZISKA PLC
ATTORNEY
222 LAKEVIEW AVENUE, SUITE 1500
WEST PALM BEACH, FL 33401
PHONE: 561-802-8960
E-MAIL: MZISKA@FLORIDAWILLS.COM

**CONKLING AND LEWIS CONSTRUCTION, INC
CONTRACTOR**
1241 OLD OKEECHOBEE BLVD
WEST PALM BEACH, FL 33401
PHONE: 561-833-4441
E-MAIL: KLEWIS@CONKLINGANDLEWIS.COM

KYLE B FANT ARCHITECT # AR99255
INTERIOR DESIGNER # ID6422
AIA # 30425933 NCARB # 87929

Revisions:

COPYRIGHT 2021: THESE DRAWINGS ARE THE INSTRUMENT OF SERVICES TO THE ARCHITECT. THEY ARE NOT PRODUCTS OF DESIGN, ALL IDEAS, DESIGN, ARRANGEMENTS AND PLANS INDICATED OR REPRESENTED BY THESE DRAWINGS ARE OWNED BY AND THE PROPERTY OF BARTHOLOMEW + PARTNERS, AND WILL BE CREATED, EVOLVED AND DEVELOPED FOR USE ON AND IN CONNECTION WITH THIS PROJECT. NONE OF THESE IDEAS, DESIGN, ARRANGEMENTS OR PLANS SHALL BE USED OR DISCLOSED TO ANY PERSON, FIRM OR CORPORATION WITHOUT THE WRITTEN PERMISSION OF BARTHOLOMEW + PARTNERS.

Project no: 21.10.161
Date: 06/27/22
Drawn by: VFA
Project Architect: KBF

NEW RESIDENCE FOR THE KASSATLY FAMILY

Project Address:
335 COCOANUT ROW,
PALM BEACH, FL 33480

SHEET NAME

PROPOSED COLOR ELEVATIONS

SHEET NUMBER _____

A2.1.3

ARCOM SET



ARC-22-161
ZON-22-108

ARCHITECTURE AND DESIGN
PROGETTO DI ARCHITETTURA

CONSULTANTS

**ENVIRONMENT DESIGN GROUP
LANDSCAPE ARCHITECT**
138 N COUNTY ROAD, SUITE 20-B
PALM BEACH, FL 33480
PHONE: 561-832-4600
E-MAIL: DUSTIN@ENVIRONMENTDESIGNGROUP.COM

**GRUBER CONSULTING ENGINEERS
CIVIL ENGINEER**
241 MERIDIAN AVE
WEST PALM BEACH, FL 33401
PHONE: 561-315-2041
E-MAIL: CHAD@GRUBERENGINEERS.COM

**KOCHMAN & ZISKA PLLC
ATTORNEY**
1202 LAKEVIEW AVENUE, SUITE 1500
WEST PALM BEACH, FL 33411
PHONE: 561-802-8900
E-MAIL: MZSKA@KFORLAWLLCS.COM

**CONKLING AND LEWIS CONSULTING, INC
CONTRACTOR**
1241 OLD OAKENOBLES BLVD
WEST PALM BEACH, FL 33401
PHONE: 561-833-4441
E-MAIL: KLEWIS@CONKLINGANDLEWIS.COM

Revisions:

Project no: 21.10.161
Date: 06/27/22
Drawn by: VFA
Project Architect: KBF

Project Address:
335 COCOANUT ROW,
PALM BEACH, FL 33480

PROPOSED COLOR ELEVATIONS

A2.1.4

ARCOM SET

SCALE: 3/8" = 1'

ARC-22-161
ZON-22-108