

In Witness whereof, the parties hereto have executed with this Amendment effective the ____ day year written and approved.

TOWN OF PALM BEACH

By: _____

Town Manager

Attest: _____ (SEAL)

Clerk

Town Attorney

Date

STATE OF FLORIDA
DEPARTMENT OF TRANSPORTATION

By: _____

Transportation Development Director

Attest: _____ (SEAL)

Executive Secretary

Legal Review

Date

Office of the General Counsel

SECTION No. 93060000
S.R. No.(s): A1A
PERMIT No: 2019-L-496-00007
COUNTY: PALM BEACH

EXHIBIT A

LANDSCAPE IMPROVEMENTS

MAINTENANCE BOUNDARY MAP

- I. LANDSCAPE IMPROVEMENTS MAINTENANCE LIMITS FOR THIS PROJECT:
State Road A1A (South Ocean Boulevard) from (M.P. 24.263) to (M.P. 24.307)
- II. CURRENT TOTAL LANDSCAPE IMPROVEMENTS MAINTENANCE LIMITS FOR
STATE ROAD A1A (SOUTH OCEAN BOULEVARD):
*State Road A1A (South Ocean Boulevard) from (M.P. 23.25) to (M.P. 25.548)
- III. LANDSCAPE IMPROVEMENTS MAINTENANCE BOUNDARY MAP:

Please See Attached

*All limits of the original agreement and amendments shall apply

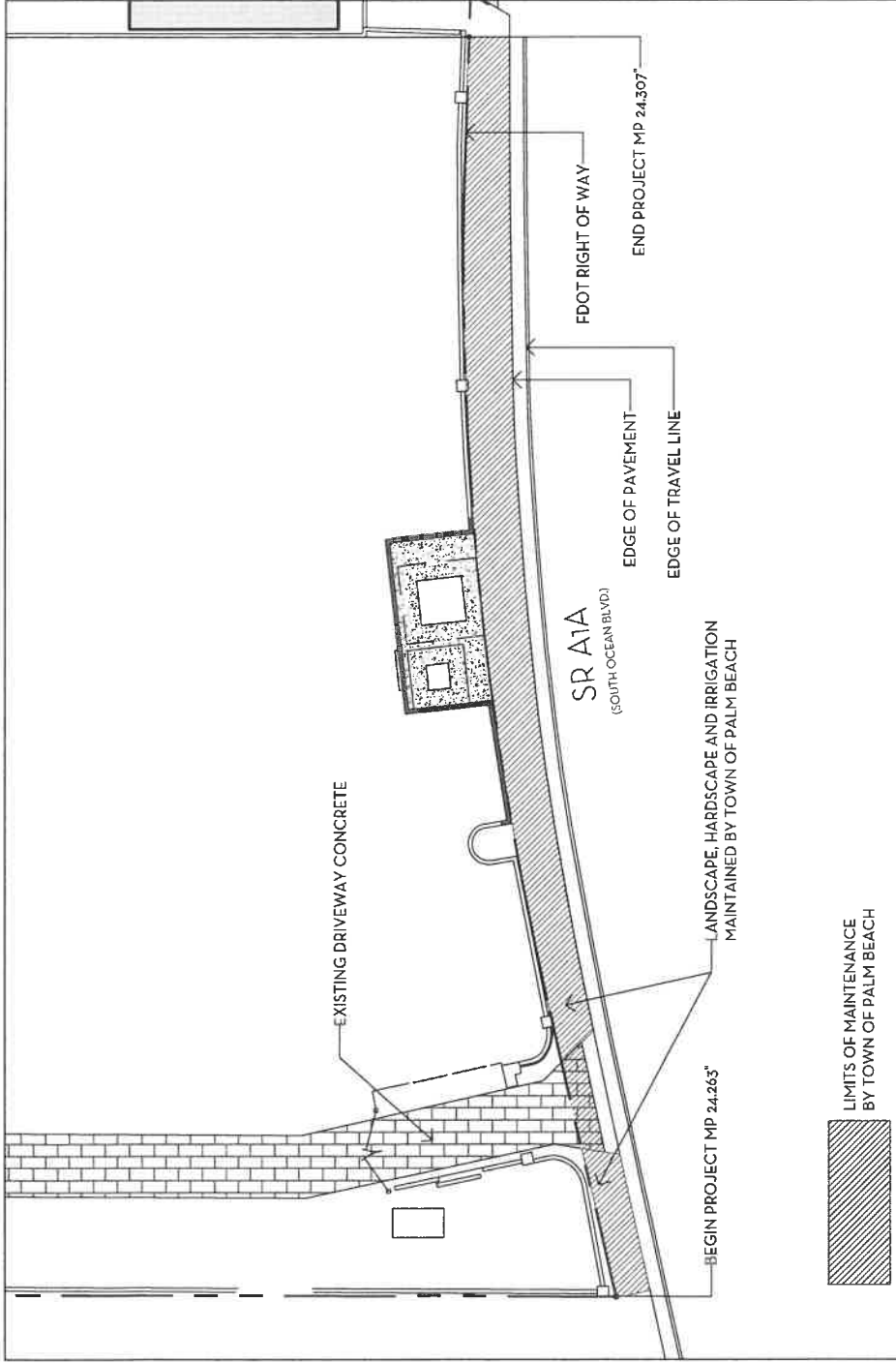
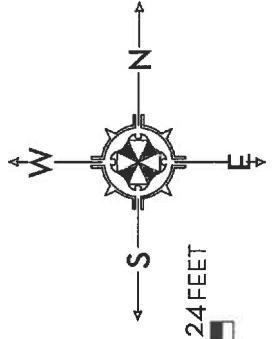

EXHIBIT A
 LANDSCAPE IMPROVEMENTS MAINTENANCE BOUNDARY MAP
 TOWN OF PALM BEACH
 PERMIT No. 2019-L-496-00007
 STATE ROAD A1A
 ROAD ID 93060000
 DATE 01.07.2020



SECTION No.	93060000
S.R. No.(s):	A1A
PERMIT No:	2019-L496-00007
COUNTY:	PALM BEACH

EXHIBIT B
LANDSCAPE IMPROVEMENT PLANS

The AGENCY agrees to install the landscape improvements in accordance with the plans and specifications attached hereto and incorporated herein.

Please see attached plans prepared by:

Damian Gonzalez, P.E.
Dated: December 9, 2019
Mario F. Nievera, LA
Nievera Williams Design
Dated: December 10, 2020

CONSULTING GABLES INC.
 4437 W FLAGLER ST SUITE #9
 CORAL GABLES, FL 33134
 (760)220-0083 F:(666)220-7943
 services@consultingables.com

SHEET DESCRIPTION:
 IRRIGATION PLAN
 HEADS LAYOUT

SEAL: 
 Damian Gonzalez
 2019.12.09
 1449811
 -0500
 Damian Gonzalez PE
 P.E. (001) 724-5889
 P.E. No. B5910

PROJECT: 1350 SOUTH OCEAN LAND TRUST
 PALM BEACH, FL
 1350 SOUTH OCEAN BLVD

DATE: 10/20/2019
 DRAWN BY: Damian Gonzalez PE
 CHECKED BY: SCULS SCALE IS 80%

DATE: 10/20/2019
 DRAWN BY: Damian Gonzalez PE
 CHECKED BY: SCULS SCALE IS 80%

IF IT FEELS LANDSCAPE
 PERMIT NUMBER:
 2019-L-455-0007



POP UP IRRIGATION NOTE:
 1. ALL IRRIGATION HEADS SHALL BE THE LOWEST QUALITY WATER AVAILABLE WHICH ACCORDS WITH AND MEETS THE MINIMUM REQUIREMENTS OF THE WATER SHORTAGE WATER.
 2. POP UP IRRIGATION HEADS SHALL BE INSTALLED IN A MANNER THAT PROVIDES EASY ACCESS TO WATER SERVICE.
 3. ALL IRRIGATION HEADS SHALL BE INSTALLED WITH A MINIMUM OF 18" CLEARANCE FROM THE SURFACE OF THE PAVEMENT.
 4. ALL IRRIGATION HEADS SHALL BE INSTALLED WITH A MINIMUM OF 18" CLEARANCE FROM THE SURFACE OF THE PAVEMENT.

NOTE:
 1. ALL IRRIGATION HEADS SHALL BE INSTALLED WITH A MINIMUM OF 18" CLEARANCE FROM THE SURFACE OF THE PAVEMENT.
 2. ALL IRRIGATION HEADS SHALL BE INSTALLED WITH A MINIMUM OF 18" CLEARANCE FROM THE SURFACE OF THE PAVEMENT.
 3. ALL VALVES AND FURNISHING HAS TO BE INSTALLED WITH A MINIMUM OF 18" CLEARANCE FROM THE SURFACE OF THE PAVEMENT.
 4. ALL IRRIGATION HEADS SHALL BE INSTALLED WITH A MINIMUM OF 18" CLEARANCE FROM THE SURFACE OF THE PAVEMENT.



IRRIGATION PLAN
 SCALE: 1/16" = 1'-0"

VALVE SCHEDULE	ZONE	MANUFACTURER	SIZE	TYPE	DEPTH	WORK	PER	PI	PC	PREC	QTY
1	1	1	1/2"	1/2"	1/2"	1/2"	1/2"	1/2"	1/2"	1/2"	1/2"
2	2	2	1/2"	1/2"	1/2"	1/2"	1/2"	1/2"	1/2"	1/2"	1/2"
3	3	3	1/2"	1/2"	1/2"	1/2"	1/2"	1/2"	1/2"	1/2"	1/2"
4	4	4	1/2"	1/2"	1/2"	1/2"	1/2"	1/2"	1/2"	1/2"	1/2"
5	5	5	1/2"	1/2"	1/2"	1/2"	1/2"	1/2"	1/2"	1/2"	1/2"
6	6	6	1/2"	1/2"	1/2"	1/2"	1/2"	1/2"	1/2"	1/2"	1/2"
7	7	7	1/2"	1/2"	1/2"	1/2"	1/2"	1/2"	1/2"	1/2"	1/2"
8	8	8	1/2"	1/2"	1/2"	1/2"	1/2"	1/2"	1/2"	1/2"	1/2"
9	9	9	1/2"	1/2"	1/2"	1/2"	1/2"	1/2"	1/2"	1/2"	1/2"
10	10	10	1/2"	1/2"	1/2"	1/2"	1/2"	1/2"	1/2"	1/2"	1/2"
11	11	11	1/2"	1/2"	1/2"	1/2"	1/2"	1/2"	1/2"	1/2"	1/2"
12	12	12	1/2"	1/2"	1/2"	1/2"	1/2"	1/2"	1/2"	1/2"	1/2"
13	13	13	1/2"	1/2"	1/2"	1/2"	1/2"	1/2"	1/2"	1/2"	1/2"
14	14	14	1/2"	1/2"	1/2"	1/2"	1/2"	1/2"	1/2"	1/2"	1/2"
15	15	15	1/2"	1/2"	1/2"	1/2"	1/2"	1/2"	1/2"	1/2"	1/2"
16	16	16	1/2"	1/2"	1/2"	1/2"	1/2"	1/2"	1/2"	1/2"	1/2"
17	17	17	1/2"	1/2"	1/2"	1/2"	1/2"	1/2"	1/2"	1/2"	1/2"
18	18	18	1/2"	1/2"	1/2"	1/2"	1/2"	1/2"	1/2"	1/2"	1/2"
19	19	19	1/2"	1/2"	1/2"	1/2"	1/2"	1/2"	1/2"	1/2"	1/2"
20	20	20	1/2"	1/2"	1/2"	1/2"	1/2"	1/2"	1/2"	1/2"	1/2"
21	21	21	1/2"	1/2"	1/2"	1/2"	1/2"	1/2"	1/2"	1/2"	1/2"
22	22	22	1/2"	1/2"	1/2"	1/2"	1/2"	1/2"	1/2"	1/2"	1/2"
23	23	23	1/2"	1/2"	1/2"	1/2"	1/2"	1/2"	1/2"	1/2"	1/2"
24	24	24	1/2"	1/2"	1/2"	1/2"	1/2"	1/2"	1/2"	1/2"	1/2"
25	25	25	1/2"	1/2"	1/2"	1/2"	1/2"	1/2"	1/2"	1/2"	1/2"
26	26	26	1/2"	1/2"	1/2"	1/2"	1/2"	1/2"	1/2"	1/2"	1/2"
27	27	27	1/2"	1/2"	1/2"	1/2"	1/2"	1/2"	1/2"	1/2"	1/2"
28	28	28	1/2"	1/2"	1/2"	1/2"	1/2"	1/2"	1/2"	1/2"	1/2"
29	29	29	1/2"	1/2"	1/2"	1/2"	1/2"	1/2"	1/2"	1/2"	1/2"
30	30	30	1/2"	1/2"	1/2"	1/2"	1/2"	1/2"	1/2"	1/2"	1/2"
31	31	31	1/2"	1/2"	1/2"	1/2"	1/2"	1/2"	1/2"	1/2"	1/2"
32	32	32	1/2"	1/2"	1/2"	1/2"	1/2"	1/2"	1/2"	1/2"	1/2"
33	33	33	1/2"	1/2"	1/2"	1/2"	1/2"	1/2"	1/2"	1/2"	1/2"
34	34	34	1/2"	1/2"	1/2"	1/2"	1/2"	1/2"	1/2"	1/2"	1/2"
35	35	35	1/2"	1/2"	1/2"	1/2"	1/2"	1/2"	1/2"	1/2"	1/2"
36	36	36	1/2"	1/2"	1/2"	1/2"	1/2"	1/2"	1/2"	1/2"	1/2"
37	37	37	1/2"	1/2"	1/2"	1/2"	1/2"	1/2"	1/2"	1/2"	1/2"
38	38	38	1/2"	1/2"	1/2"	1/2"	1/2"	1/2"	1/2"	1/2"	1/2"
39	39	39	1/2"	1/2"	1/2"	1/2"	1/2"	1/2"	1/2"	1/2"	1/2"
40	40	40	1/2"	1/2"	1/2"	1/2"	1/2"	1/2"	1/2"	1/2"	1/2"
41	41	41	1/2"	1/2"	1/2"	1/2"	1/2"	1/2"	1/2"	1/2"	1/2"
42	42	42	1/2"	1/2"	1/2"	1/2"	1/2"	1/2"	1/2"	1/2"	1/2"
43	43	43	1/2"	1/2"	1/2"	1/2"	1/2"	1/2"	1/2"	1/2"	1/2"
44	44	44	1/2"	1/2"	1/2"	1/2"	1/2"	1/2"	1/2"	1/2"	1/2"
45	45	45	1/2"	1/2"	1/2"	1/2"	1/2"	1/2"	1/2"	1/2"	1/2"
46	46	46	1/2"	1/2"	1/2"	1/2"	1/2"	1/2"	1/2"	1/2"	1/2"
47	47	47	1/2"	1/2"	1/2"	1/2"	1/2"	1/2"	1/2"	1/2"	1/2"
48	48	48	1/2"	1/2"	1/2"	1/2"	1/2"	1/2"	1/2"	1/2"	1/2"
49	49	49	1/2"	1/2"	1/2"	1/2"	1/2"	1/2"	1/2"	1/2"	1/2"
50	50	50	1/2"	1/2"	1/2"	1/2"	1/2"	1/2"	1/2"	1/2"	1/2"
51	51	51	1/2"	1/2"	1/2"	1/2"	1/2"	1/2"	1/2"	1/2"	1/2"
52	52	52	1/2"	1/2"	1/2"	1/2"	1/2"	1/2"	1/2"	1/2"	1/2"
53	53	53	1/2"	1/2"	1/2"	1/2"	1/2"	1/2"	1/2"	1/2"	1/2"
54	54	54	1/2"	1/2"	1/2"	1/2"	1/2"	1/2"	1/2"	1/2"	1/2"
55	55	55	1/2"	1/2"	1/2"	1/2"	1/2"	1/2"	1/2"	1/2"	1/2"
56	56	56	1/2"	1/2"	1/2"	1/2"	1/2"	1/2"	1/2"	1/2"	1/2"
57	57	57	1/2"	1/2"	1/2"	1/2"	1/2"	1/2"	1/2"	1/2"	1/2"
58	58	58	1/2"	1/2"	1/2"	1/2"	1/2"	1/2"	1/2"	1/2"	1/2"
59	59	59	1/2"	1/2"	1/2"	1/2"	1/2"	1/2"	1/2"	1/2"	1/2"
60	60	60	1/2"	1/2"	1/2"	1/2"	1/2"	1/2"	1/2"	1/2"	1/2"
61	61	61	1/2"	1/2"	1/2"	1/2"	1/2"	1/2"	1/2"	1/2"	1/2"
62	62	62	1/2"	1/2"	1/2"	1/2"	1/2"	1/2"	1/2"	1/2"	1/2"
63	63	63	1/2"	1/2"	1/2"	1/2"	1/2"	1/2"	1/2"	1/2"	1/2"
64	64	64	1/2"	1/2"	1/2"	1/2"	1/2"	1/2"	1/2"	1/2"	1/2"
65	65	65	1/2"	1/2"	1/2"	1/2"	1/2"	1/2"	1/2"	1/2"	1/2"
66	66	66	1/2"	1/2"	1/2"	1/2"	1/2"	1/2"	1/2"	1/2"	1/2"
67	67	67	1/2"	1/2"	1/2"	1/2"	1/2"	1/2"	1/2"	1/2"	1/2"
68	68	68	1/2"	1/2"	1/2"	1/2"	1/2"	1/2"	1/2"	1/2"	1/2"
69	69	69	1/2"	1/2"	1/2"	1/2"	1/2"	1/2"	1/2"	1/2"	1/2"
70	70	70	1/2"	1/2"	1/2"	1/2"	1/2"	1/2"	1/2"	1/2"	1/2"
71	71	71	1/2"	1/2"	1/2"	1/2"	1/2"	1/2"	1/2"	1/2"	1/2"
72	72	72	1/2"	1/2"	1/2"	1/2"	1/2"	1/2"	1/2"	1/2"	1/2"
73	73	73	1/2"	1/2"	1/2"	1/2"	1/2"	1/2"	1/2"	1/2"	1/2"
74	74	74	1/2"	1/2"	1/2"	1/2"	1/2"	1/2"	1/2"	1/2"	1/2"
75	75	75	1/2"	1/2"	1/2"	1/2"	1/2"	1/2"	1/2"	1/2"	1/2"
76	76	76	1/2"	1/2"	1/2"	1/2"	1/2"	1/2"	1/2"	1/2"	1/2"
77	77	77	1/2"	1/2"	1/2"	1/2"	1/2"	1/2"	1/2"	1/2"	1/2"
78	78	78	1/2"	1/2"	1/2"	1/2"	1/2"	1/2"	1/2"	1/2"	1/2"
79	79	79	1/2"	1/2"	1/2"	1/2"	1/2"	1/2"	1/2"	1/2"	1/2"
80	80	80	1/2"	1/2"	1/2"	1/2"	1/2"	1/2"	1/2"	1/2"	1/2"
81	81	81	1/2"	1/2"	1/2"	1/2"	1/2"	1/2"	1/2"	1/2"	1/2"
82	82	82	1/2"	1/2"	1/2"	1/2"	1/2"	1/2"	1/2"	1/2"	1/2"
83	83	83	1/2"	1/2"	1/2"	1/2"	1/2"	1/2"	1/2"	1/2"	1/2"
84	84	84	1/2"	1/2"	1/2"	1/2"	1/2"	1/2"	1/2"	1/2"	1/2"
85	85	85	1/2"	1/2"	1/2"	1/2"	1/2"	1/2"	1/2"	1/2"	1/2"
86	86	86	1/2"	1/2"	1/2"	1/2"	1/2"	1/2"	1/2"	1/2"	1/2"
87	87	87	1/2"	1/2"	1/2"	1/2"	1/2"	1/2"	1/2"	1/2"	1/2"
88	88	88	1/2"	1/2"	1/2"	1/2"	1/2"	1/2"	1/2"	1/2"	1/2"
89	89	89	1/2"	1/2"	1/2"	1/2"	1/2"	1/2"	1/2"	1/2"	1/2"
90	90	90	1/2"	1/2"	1/2"	1/2"	1/2"	1/2"	1/2"	1/2"	1/2"
91	91	91	1/2"	1/2"	1/2"	1/2"	1/2"	1/2"	1/2"	1/2"	1/2"
92	92	92	1/2"	1/2"	1/2"	1/2"	1/2"	1/2"	1/2"	1/2"	1/2"
93	93	93	1/2"	1/2"	1/2"	1/2"	1/2"	1/2"	1/2"	1/2"	1/2"
94	94	94	1/2"	1/2"	1/2"	1/2"	1/2"	1/2"	1/2"	1/2"	1/2"
95	95	95	1/2"	1/2"	1/2"	1/2"	1/2"	1/2"	1/2"	1/2"	1/2"
96	96	96	1/2"	1/2"	1/2"	1/2"	1/2"	1/2"	1/2"	1/2"	1/2"
97	97	97	1/2"	1/2"	1/2"	1/2"	1/2"	1/2"	1/2"	1/2"	1/2"
98	98	98	1/2"	1/2"	1/2"	1/2"	1/2"	1/2"	1/2"	1/2"	1/2"
99	99	99	1/2"	1/2"	1/2"	1/2"	1/2"	1/2"	1/2"	1/2"	1/2"
100	100	100	1/2"	1/2"	1/2"	1/2"	1/2"	1/2"	1/2"	1/2"	1/2"

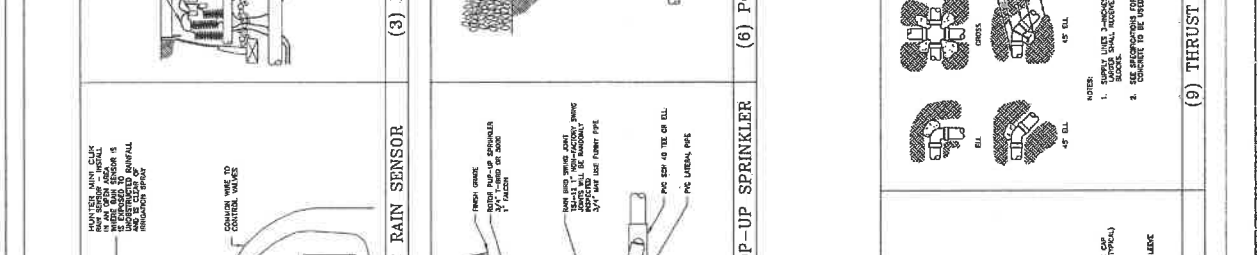
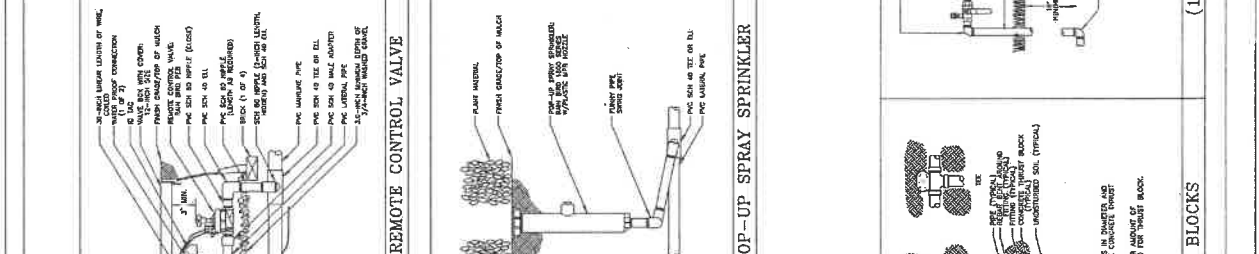
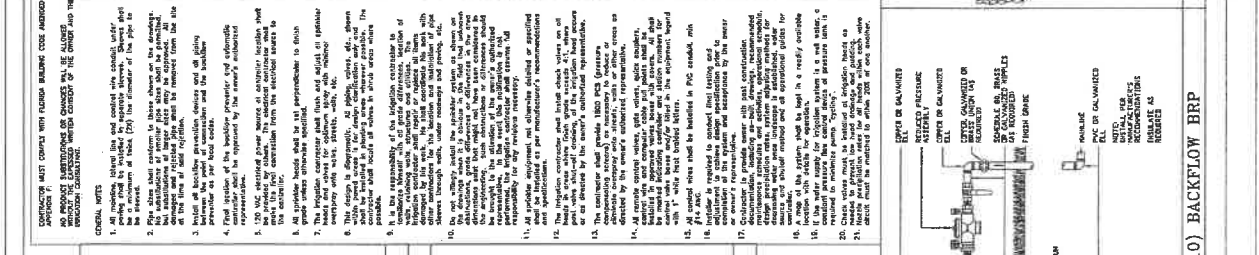
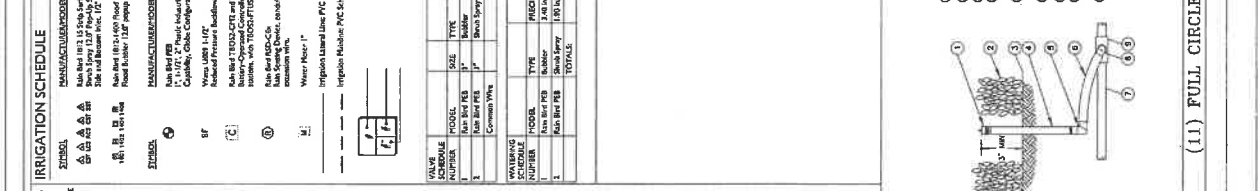

MARIO F. NIEVERA
 State of Florida
 Landscape Architect
 Registration No.
 440494

Mario Nievera
 6666856

Digitally signed by
 Mario Nievera
 Date: 2019.12.10
 09:11:14 -05'00'

SCALE: 1" = 10'

LANDSCAPE PLAN AND PLANT LIST

1350 SOUTH OCEAN BLVD, PALM BEACH, FL
 33409

02 OCTOBER 2019
 20 OCTOBER 2019
 26 MARCH 2020



NIEVERA WILLIAMS
 DESIGN

222 Sunset Avenue
 Palm Beach, Florida 33480
 P: 561-992-8920
 F: 561-992-2113

NIEWERAWILLIAMS.COM

LPI

REVISIONS
 (Refer to GENERAL LANDSCAPE REVISIONS AS PER FOOT COMMENTS)

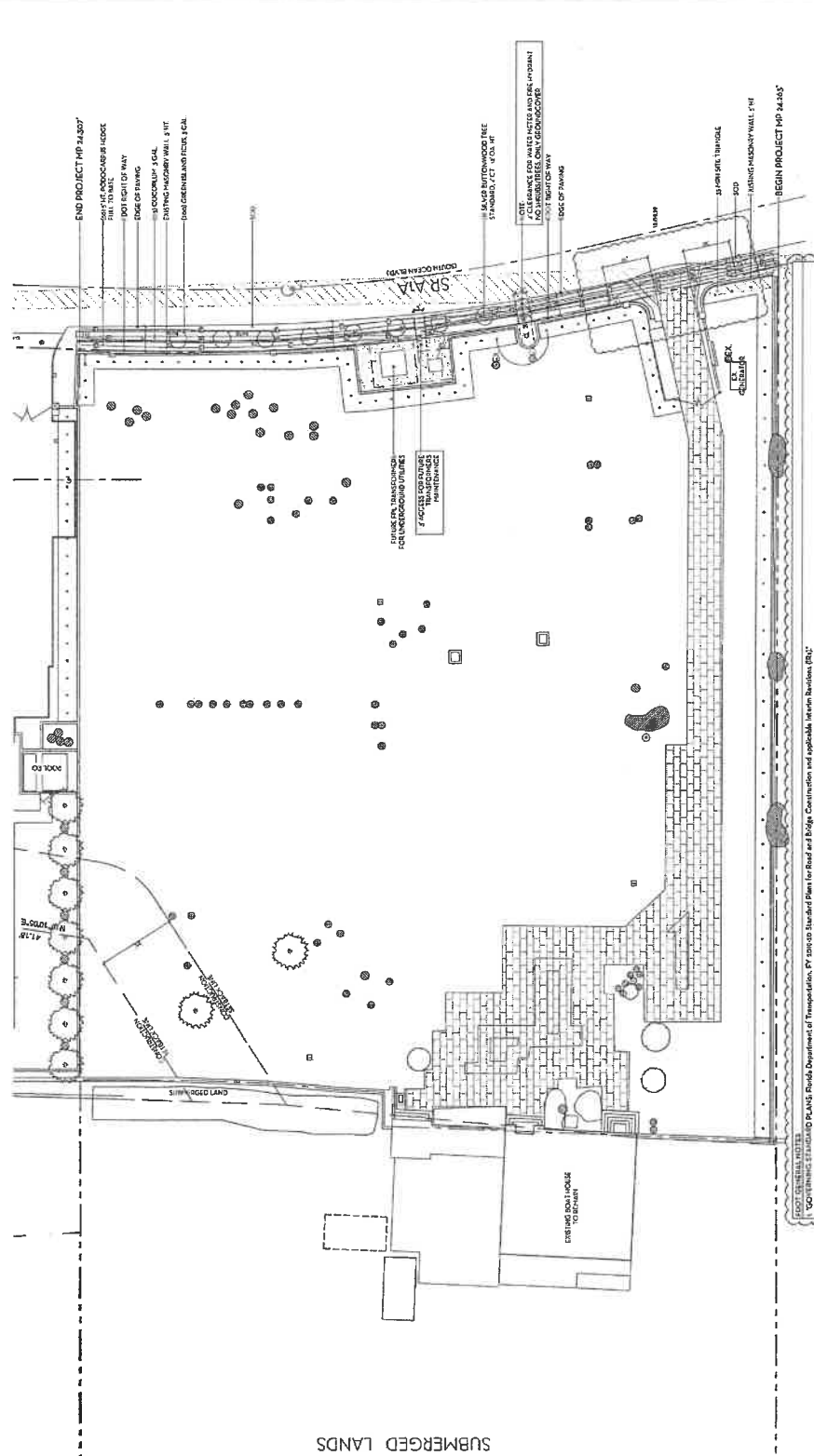

END PROJECT MAP 14.645'

SEE PLAN APPROXIMATE LOCATIONS FOR:
 - FDOT RIGHT OF WAY
 - SUBMERGED LANDS
 - 31' FROM SHORE TURNOUT
 - FLOODING MEDICAL WELL 7\"/>

LEGEND

- BORED TELEPHONE CABLE (AS SHOWN ON THE GROUND SURVEY)
- BORED TELEPHONE CABLE (AS SHOWN ON THE GROUND SURVEY)
- CULVERT
- EXISTING TELEPHONE CABLE
- EXISTING TELEPHONE CABLE
- EXISTING TELEPHONE CABLE

SCALE: 1/8" = 1'-0"

LEGEND

- BORED TELEPHONE CABLE (AS SHOWN ON THE GROUND SURVEY)
- BORED TELEPHONE CABLE (AS SHOWN ON THE GROUND SURVEY)
- CULVERT
- EXISTING TELEPHONE CABLE
- EXISTING TELEPHONE CABLE
- EXISTING TELEPHONE CABLE

SCALE: 1/8" = 1'-0"

PROPOSED PLANT LIST (TO BE PLANTED ON ROAST ROW)

SYMBOL	COMMON NAME	SCIENTIFIC NAME	HEIGHT	SPACING
[Symbol]	ORANGE BLOSSOMED PLANT			
[Symbol]	ORANGE BLOSSOMED PLANT			
[Symbol]	ORANGE BLOSSOMED PLANT			
[Symbol]	ORANGE BLOSSOMED PLANT			

FOOT GENERAL NOTES

1. For the purpose of this landscape plan, all plants shall comply with current FDOT maintenance specifications §50-2.
2. A checklist shall be prepared for the proposed landscape plan, which shall include the following information:
 - a. List of all plants and quantities of each plant.
 - b. List of all trees and quantities of each tree.
 - c. List of all shrubs and quantities of each shrub.
 - d. List of all groundcovers and quantities of each groundcover.
3. Any plants, materials, substances or equipment to be used on the project shall be approved by the Florida Department of Transportation, Bureau of Operations, before being used on the project.

FOOT GENERAL NOTES

1. Contractor shall report any change in FDOT specifications to the Designer immediately.
2. Any plants, materials, substances or equipment to be used on the project shall be approved by the Florida Department of Transportation, Bureau of Operations, before being used on the project.
3. All plants, materials, substances or equipment to be used on the project shall be approved by the Florida Department of Transportation, Bureau of Operations, before being used on the project.

FOOT GENERAL NOTES

1. All plants, materials, substances or equipment to be used on the project shall be approved by the Florida Department of Transportation, Bureau of Operations, before being used on the project.
2. All plants, materials, substances or equipment to be used on the project shall be approved by the Florida Department of Transportation, Bureau of Operations, before being used on the project.
3. All plants, materials, substances or equipment to be used on the project shall be approved by the Florida Department of Transportation, Bureau of Operations, before being used on the project.

FDOT LANDSCAPE PERMIT No.
 2019-L-466-00007



Detail prepared by
 Adam B. Kehr
 Date: 09/10/2019
 1406271000

GRAPHIC SCALE IN FEET
 0 35 70 140