



May 16, 2019

Wayne Bergman, MCP, LEED-AP
Asst. Director
Town of Palm Beach Planning, Zoning, Building
360 S. County Road
Palm Beach, FL 33480

Dear Wayne,

We are requesting a modification to the normal construction hours in Palm Beach to complete an interior refresh project at Palm Beach Bradley Place Chase bank located at 285 Sunrise Avenue.

The requested schedule of construction is as follows:

- Project to begin on Friday, June 7th and continues during nights and weekends until completion June 22nd.
- Monday through Friday, crews will work inside bank from 6:00 PM until midnight each night.
- Saturday, crews will work inside the bank from 9:00 AM until Midnight.
- Sunday, crews will work inside the bank 9:00 AM until 9:00 PM.

Work includes basic electrical outlet relocation, light framing and drywall, new carpet, paint and furniture. These are small, specialized crews that do not create noise loud enough to be heard outdoors in the surrounding area.

The full set of construction drawings have been submitted and approved with permits. Please let me know if I need to contact the police department to make them aware we will have activity inside the bank during this period. We need to begin June 7th in order to complete the project on time so if the above requested schedule is not approved, please respond with a schedule that is approved so we can adjust our crews accordingly. We are not permitted to work during Chase business hours.

I look forward to working with you on this request.

Best Regards,

John L. Stevens

John L. Stevens
Sr. Project Manager, LEED AP
JLL in Partnership with J.P. Morgan Chase
Mobile +1 561 353 7415
John.l.stevens@jpmchase.com
www.jll.com

Palm Beach Bradley Place

285 Sunrise Ave., Palm Beach, FL 33480

DND Number 5407

CHASE  RETAIL DISTRIBUTION NETWORK

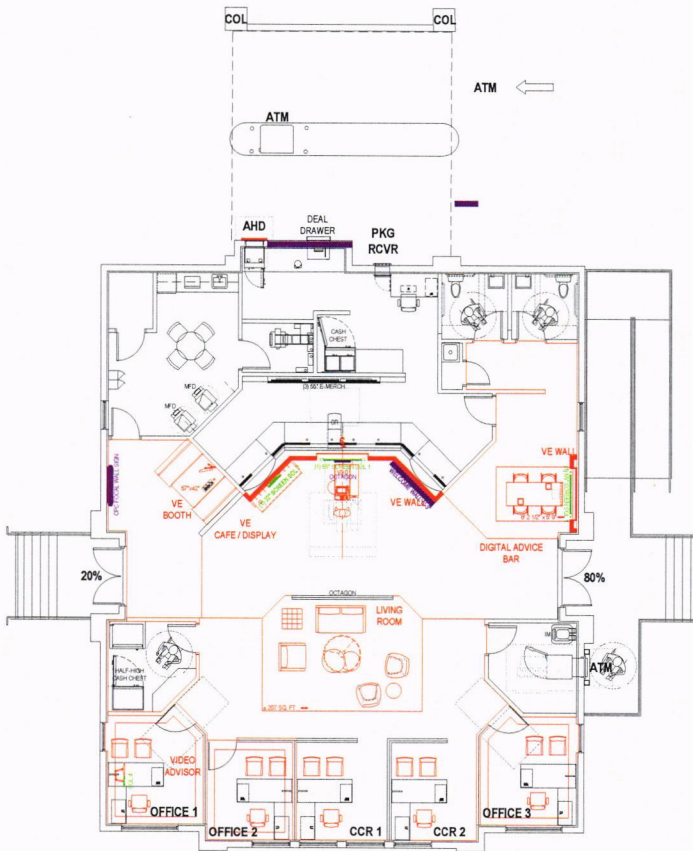

- LEGEND:**
- NEW SIGNAGE / MARKETING
 - NEW PARTITION
 - EXISTING FURNITURE REUSED
 - NET NEW
 - NEW TECHNOLOGY
 - NEW KEVLAR PANELS ON WALL
 - EXISTING SIGNAGE / MARKETING
 - FUTURE
 - NEW BORDER TILE
 - ATM REFRESH
 - NEW MILLWORK
 - # KEYED NOTE

PROPOSED FLOOR PLANS

Confidential. JPMorgan Chase Bank, N.A. Proprietary Information.

DESIGNER: JR/JJ

2018-01-24

PAGE 3.0