

1/24/2025 4:39:51 PM

1 PROPOSED SITE PLAN

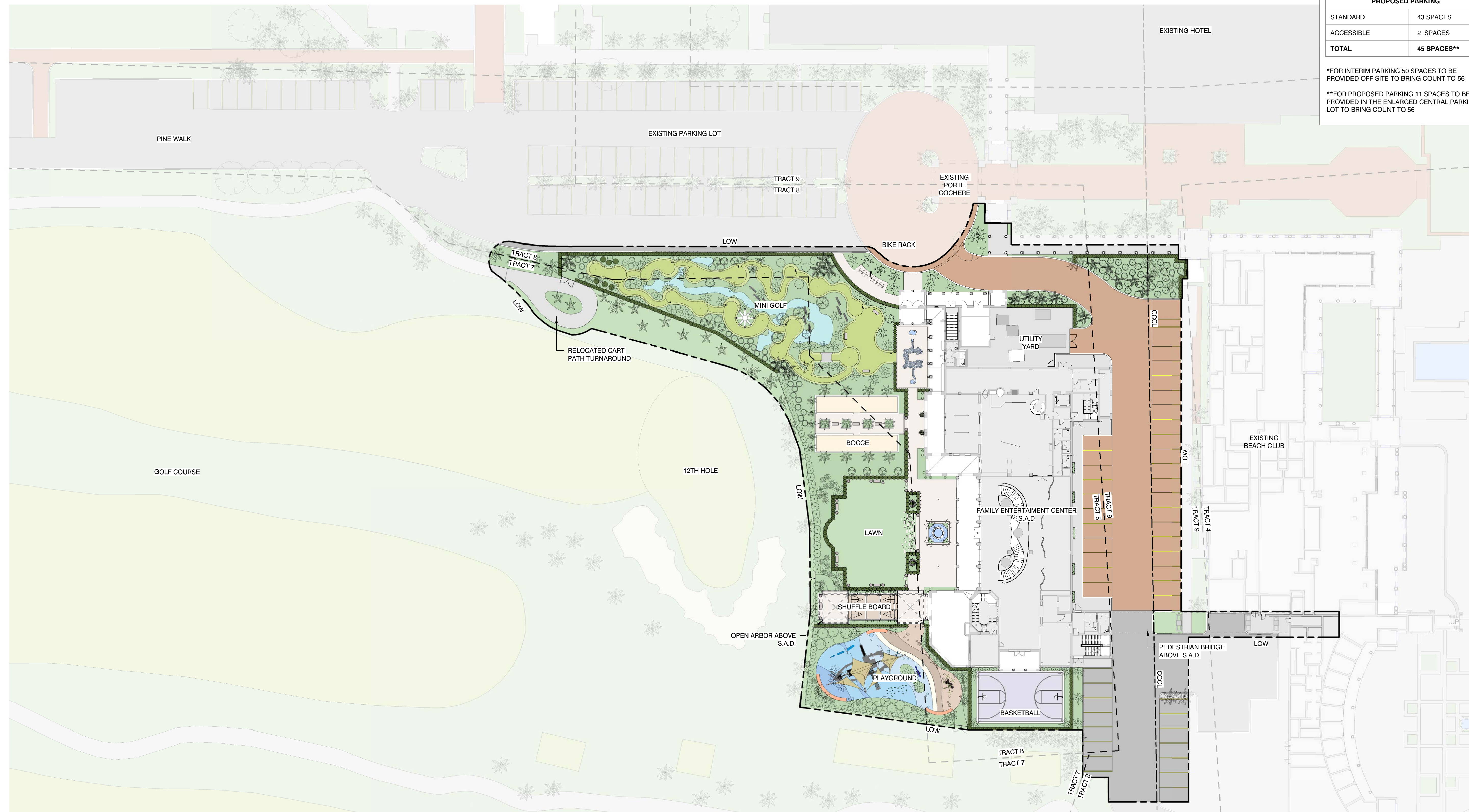

GENERAL LEGEND

--- TRACT LINE
 - - - - - LIMIT OF WORK (LOW)
 - - - - - COSTAL CONSTRUCTION CONTROL LINE (CCCL)

EXISTING PARKING	
STANDARD	52 SPACES
ACCESSIBLE	4 SPACES
TOTAL	56 SPACES
INTERIM (DURING CONSTRUCTION) PARKING	
STANDARD	4 SPACES
ACCESSIBLE	2 SPACES
TOTAL	6 SPACES*
PROPOSED PARKING	
STANDARD	43 SPACES
ACCESSIBLE	2 SPACES
TOTAL	45 SPACES**

*FOR INTERIM PARKING 50 SPACES TO BE PROVIDED OFF SITE TO BRING COUNT TO 56
 **FOR PROPOSED PARKING 11 SPACES TO BE PROVIDED IN THE ENLARGED CENTRAL PARKING LOT TO BRING COUNT TO 56

STATE OF FLORIDA
 ANNE H. HOWERTON
 L.A. 666852
 REGISTERED LANDSCAPE ARCHITECT

HART HOWERTON
 NEW YORK, SAN FRANCISCO
 10 East 40th Street, New York, NY 10016
 Tel.: 212 683 5631 Fax: 212 461 3788
 Email: NY@hartowerton.com

FINAL SUBMITTAL

**THE BREAKERS
 PALM BEACH
 1 S COUNTY RD
 PALM BEACH, FLORIDA 33480**

©2023 Hart Howerton
 The design and concepts shown are the sole property of Hart Howerton and may not be used without the prior written consent of Hart Howerton.

SCALE: As indicated
 NOTE: DO NOT SCALE DRAWINGS. USE DIMENSIONS DIMENSIONS ONLY. FOR CLARIFICATION FROM ARCHITECT FOR MEASUREMENTS THAT ARE NOT INDICATED.

MILESTONES	
DATE	ISSUE
12/12/2024	1ST SUBMIT
01/27/2025	FINAL SUBMIT

REVISIONS		
NO.	DATE	ISSUE

REVISIONS		
NO.	DATE	ISSUE

DRAWING TITLE:
PROPOSED SITE PLAN

PROJECT #:
 22-525
 DRAWN BY:
 MU
 CHECKED BY:
 JN
 DRAWING NO:
FEC L0-00

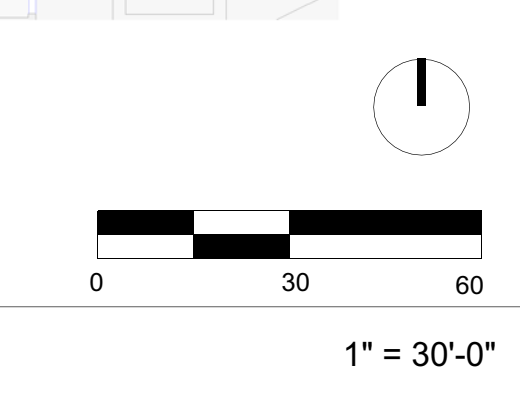

TREE ID	TYPE, TRUNK DIAMETER (IN INCHES)	CANOPY RADIUS (IN FEET)	BOTANICAL NAME	COMMON NAME	NATIVE	REMOVED
1301	PALM 17	13	PHOENIX SYLVESTRIS	SILVER DATE PALM		
1302	MISC 6	7	LIGUSTRUM JAPONICUM	JAPANESE PRIVET		
1310	PALM 4	5	COCOS NUCIFERA	MALAYAN DWARF		X
1311	PALM 10	8	COCOS NUCIFERA	MALAYAN DWARF		X
1312	PALM 11	9	COCOS NUCIFERA	MALAYAN DWARF		
1313	PALM 4	6	COCOS NUCIFERA	MALAYAN DWARF		
1314	PALM 5	5	COCOS NUCIFERA	MALAYAN DWARF		X
1315	PALM 10	9	COCOS NUCIFERA	MALAYAN DWARF		X
1316	PALM 9	9	COCOS NUCIFERA	MALAYAN DWARF		
1317	PALM 6	6	COCOS NUCIFERA	MALAYAN DWARF		
1318	PALM 12	11	COCOS NUCIFERA	MALAYAN DWARF		
1323	PALM 14	7	SABAL PALMETTO	SABAL PALM	NATIVE	
1324	PALM 10	7	SABAL PALMETTO	SABAL PALM	NATIVE	
1343	PALM 10	11	COCOS NUCIFERA	MALAYAN DWARF		
1344	PALM 10	9	COCOS NUCIFERA	MALAYAN DWARF		X
1345	PALM 8	8	COCOS NUCIFERA	MALAYAN DWARF		X
1346	PALM 11	12	COCOS NUCIFERA	MALAYAN DWARF		X
1347	PALM 9	9	COCOS NUCIFERA	MALAYAN DWARF		X
1348	PALM 8	7	SABAL PALMETTO	SABAL PALM	NATIVE	X
1349	PALM 9	11	COCOS NUCIFERA	MALAYAN DWARF		X
1350	PALM 16	13	COCOS NUCIFERA	MALAYAN DWARF		X
1351	PALM 12	8	SABAL PALMETTO	SABAL PALM	NATIVE	X
1352	PALM 12	13	COCOS NUCIFERA	MALAYAN DWARF		X
1353	PALM 9	12	COCOS NUCIFERA	MALAYAN DWARF		X
1354	PALM 8	6	SABAL PALMETTO	SABAL PALM	NATIVE	X
1355	PALM 8	9	COCOS NUCIFERA	MALAYAN DWARF		X
1356	PALM 11	7	COCOS NUCIFERA	MALAYAN DWARF		X
1359	PALM 10	10	COCOS NUCIFERA	MALAYAN DWARF		X
1360	PALM 13	7	SABAL PALMETTO	SABAL PALM	NATIVE	X
1361	PALM 6	7	VEITCHIA MONTGOMERYANA	MONTGOMERY PALM		X
1362	PALM 7	9	COCOS NUCIFERA	MALAYAN DWARF		X
1363	MISC 20	11	COCCOLOBA UVIFERA	SEA GRAPE	NATIVE	X
1364	PALM 4	8	VEITCHIA MONTGOMERYANA	MONTGOMERY PALM		X
1365	PALM 4	7	VEITCHIA MONTGOMERYANA	MONTGOMERY PALM		X
1366	PALM 5	7	VEITCHIA MONTGOMERYANA	MONTGOMERY PALM		X
1367	PALM 4	7	VEITCHIA MONTGOMERYANA	MONTGOMERY PALM		X
1368	PALM 4	9	VEITCHIA MONTGOMERYANA	MONTGOMERY PALM		X
1369	PALM 11	12	COCOS NUCIFERA	MALAYAN DWARF		X
1370	PALM 11	7	SABAL PALMETTO	SABAL PALM	NATIVE	X
1371	OAK 8	10	LIGUSTRUM JAPONICUM	JAPANESE PRIVET		X
1372	OAK 12	24	COCCOLOBA UVIFERA	SEA GRAPE	NATIVE	X
1373	PALM 11	7	SABAL PALMETTO	SABAL PALM	NATIVE	X
1374	PALM 9	10	COCOS NUCIFERA	MALAYAN DWARF		X
1375	PALM 8	9	COCOS NUCIFERA	MALAYAN DWARF		X
1376	PALM 15	13	COCOS NUCIFERA	MALAYAN DWARF		X
1377	PALM 10	10	COCOS NUCIFERA	MALAYAN DWARF		X
1378	PALM 11	12	RAVENALA MADAGASCARIENSIS	TRAVELLERS PALM		X
1379	PALM 7	8	RAVENALA MADAGASCARIENSIS	TRAVELLERS PALM		X
1380	PALM 8	10	RAVENALA MADAGASCARIENSIS	TRAVELLERS PALM		X
1381	PALM 7	4	COCOS NUCIFERA	MALAYAN DWARF		X
1382	PALM 9	8	COCOS NUCIFERA	MALAYAN DWARF		X
1383	PALM 10	9	COCOS NUCIFERA	MALAYAN DWARF		X
1384	PALM 10	10	COCOS NUCIFERA	MALAYAN DWARF		X
1385	PALM 9	11	COCOS NUCIFERA	MALAYAN DWARF		X
1386	PALM 9	9	COCOS NUCIFERA	MALAYAN DWARF		X
1387	PALM 8	11	COCOS NUCIFERA	MALAYAN DWARF		X
1388	PALM 8	10	COCOS NUCIFERA	MALAYAN DWARF		X
1389	MISC 16	18	COCCOLOBA UVIFERA	SEA GRAPE	NATIVE	X
1390	PALM 10	7	COCOS NUCIFERA	MALAYAN DWARF		X
1393	PALM 9	6	COCOS NUCIFERA	MALAYAN DWARF		X
1394	PALM 11	5	SABAL PALMETTO	SABAL PALM	NATIVE	X
1395	PALM 9	6	SABAL PALMETTO	SABAL PALM	NATIVE	X
1396	PALM 12	6	COCOS NUCIFERA	MALAYAN DWARF		X
1397	PALM 9	8	COCOS NUCIFERA	MALAYAN DWARF		X
1398	PALM 12	7	COCOS NUCIFERA	MALAYAN DWARF		X
1399	PALM 12	8	COCOS NUCIFERA	MALAYAN DWARF		X
1400	PALM 11	6	SABAL PALMETTO	SABAL PALM	NATIVE	X
1401	PALM 13	6	SABAL PALMETTO	SABAL PALM	NATIVE	X
1402	PALM 10	9	COCOS NUCIFERA	MALAYAN DWARF		X
1403	PALM 13	9	COCOS NUCIFERA	MALAYAN DWARF		X
1404	PALM 11	8	COCOS NUCIFERA	MALAYAN DWARF		X
1405	PALM 9	13	COCOS NUCIFERA	MALAYAN DWARF		X
1406	PALM 9	11	COCOS NUCIFERA	MALAYAN DWARF		X
1407	PALM 9	9	COCOS NUCIFERA	MALAYAN DWARF		X
1408	PALM 9	10	COCOS NUCIFERA	MALAYAN DWARF		X
1409	PALM 12	11	COCOS NUCIFERA	MALAYAN DWARF		X
1410	PALM 9	12	COCOS NUCIFERA	MALAYAN DWARF		X
1411	PALM 11	7	COCOS NUCIFERA	MALAYAN DWARF		X
1412	PALM 10	9	COCOS NUCIFERA	MALAYAN DWARF		X
1413	PALM 13	6	COCOS NUCIFERA	MALAYAN DWARF		X
1414	PALM 11	5	COCOS NUCIFERA	MALAYAN DWARF		X
1430	MISC 6	6	ROYSTONIA REGIA	ROYAL PALM	NATIVE	X
1431	PALM 21	11	ROYSTONIA REGIA	ROYAL PALM	NATIVE	X
1432	PALM 10	6	COCOS NUCIFERA	MALAYAN DWARF		X
1433	PALM 14	7	COCOS NUCIFERA	MALAYAN DWARF		X
1434	PALM 11	9	COCOS NUCIFERA	MALAYAN DWARF		X
1435	PALM 12	7	SABAL PALMETTO	SABAL PALM	NATIVE	X
1436	PALM 10	10	COCOS NUCIFERA	MALAYAN DWARF		X
1437	PALM 13	7	SABAL PALMETTO	SABAL PALM	NATIVE	
1438	PALM 12	7	SABAL PALMETTO	SABAL PALM	NATIVE	
1446	PALM 9	7	SABAL PALMETTO	SABAL PALM	NATIVE	X
1447	PALM 12	6	SABAL PALMETTO	SABAL PALM	NATIVE	X
1448	PALM 19	7	SABAL PALMETTO	SABAL PALM	NATIVE	X
1449	PALM 6	9	COCOS NUCIFERA	MALAYAN DWARF		X
1450	PALM 12	7	SABAL PALMETTO	SABAL PALM	NATIVE	X
1473	PALM 8	12	COCOS NUCIFERA	MALAYAN DWARF		X
1474	PALM 9	6	SABAL PALMETTO	SABAL PALM	NATIVE	X
1475	PALM 14	11	PHOENIX SYLVESTRIS	SILVER DATE PALM		
1510	PALM 5	4	RAVENALA MADAGASCARIENSIS	TRAVELLERS PALM		X
1511	PALM 7	3	COCOS NUCIFERA	MALAYAN DWARF		X
1543	PALM 11	7	SABAL PALMETTO	SABAL PALM	NATIVE	X
1544	PALM 10	6	RAVENALA MADAGASCARIENSIS	TRAVELLERS PALM		X
1545	PALM 10	6	RAVENALA MADAGASCARIENSIS	TRAVELLERS PALM		X
1546	PALM 10	5	RAVENALA MADAGASCARIENSIS	TRAVELLERS PALM		X
1547	PALM 10	10	RAVENALA MADAGASCARIENSIS	TRAVELLERS PALM		X

NUMBER OF TREES MAINTAINED	22
NUMBER OF TREES REMOVED	83
TOTAL NUMBER OF TREES	105

FINAL SUBMITTAL

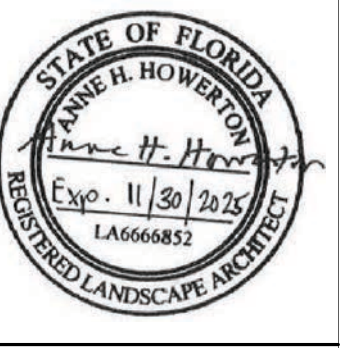

HART HOWERTON
 NEW YORK, SAN FRANCISCO
 10 East 40th Street, New York, NY 10016
 Tel: 212 683 5631 Fax: 212 461 3788
 Email: NY@hartowerton.com

THE BREAKERS
PALM BEACH
 1 S COUNTY RD
 PALM BEACH, FLORIDA 33480

©2023 Hart Howerton.
 The design and concepts shown are the sole property of Hart Howerton and may not be used without the prior written consent of Hart Howerton.

SCALE:
 NOTE: DO NOT SCALE DRAWINGS. USE PROVIDED DIMENSIONS ONLY, OR SEEK CLARIFICATION FROM ARCHITECT FOR DIMENSIONS THAT ARE NOT INDICATED.

MILESTONES	
DATE	ISSUE
12/12/2024	1ST SUBMIT
01/27/2025	FINAL SUBMIT

REVISIONS		
NO.	DATE	ISSUE

DRAWING TITLE:
F.E.C.
TREE DISPOSITION
SCHEDULE

PROJECT #:
 22-525
 DRAWN BY:
 MU
 CHECKED BY:
 JN

DRAWING NO:
FEC L0-01

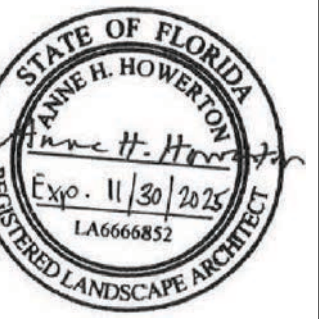

HART HOWERTON
 NEW YORK: SAN FRANCISCO
 10 East 40th Street, New York, NY 10016
 Tel.: 212 683 5631 Fax: 212 461 3788
 Email: NY@hartowerton.com

GENERAL LEGEND

--- LIMIT OF WORK (LOW)

TREE DISPOSITION LEGEND

- EXISTING PALM TO BE MAINTAINED
- EXISTING PALM TO BE REMOVED
- EXISTING CANOPY TREE TO BE MAINTAINED
- EXISTING CANOPY TREE TO BE REMOVED



FINAL SUBMITTAL

**THE BREAKERS
 PALM BEACH
 1 S COUNTY RD
 PALM BEACH, FLORIDA 33480**

©2023 Hart Howerton
 The design and concepts shown are the sole property of Hart Howerton and may not be used without the prior written consent of Hart Howerton.

SCALE: 1" = 30'-0"
 NOTE: DO NOT SCALE DRAWINGS. USE DIMENSIONS DIMENSIONED ONLY. FOR CLARIFICATION FROM ARCHITECT FOR MEASUREMENTS THAT ARE NOT INDICATED.

MILESTONES	
DATE	ISSUE
12/12/2024	1ST SUBMIT
01/27/2025	FINAL SUBMIT

REVISIONS		
NO.	DATE	ISSUE

DRAWING TITLE:
**F.E.C.
 TREE DISPOSITION
 PLAN**

PROJECT #:
 22-525
 DRAWN BY:
 MU
 CHECKED BY:
 JN

DRAWING NO:
FEC L0-02

1/24/2025 4:39:56 PM

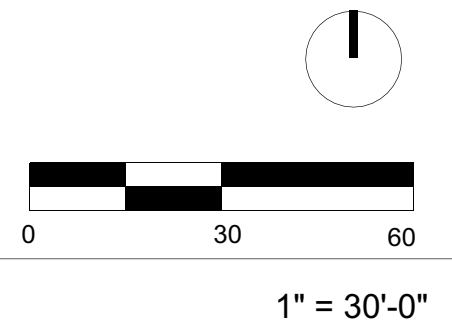

1" = 30'-0"

CATEGORY	KEYNOTE	ITEM	MATERIAL	FINISH	NOTES
PAVING	P1	VEHICULAR PAVEMENT 1	BRICK	TO MATCH EXISTING	MAIN ACCESS ROADS
	P2	VEHICULAR PAVEMENT 2	ASPHALT	TO MATCH EXISTING	SERVICE AREAS
	P3	CART PATH	CONCRETE	TO MATCH EXISTING	RE-CONFIGURE GOLF CART TURN-AROUND
	P4	PEDESTRIAN PAVEMENT	CORAL STONE ('CALYPSO CORAL')	HONED & FILLED	3"X6" @ 1 3/4" THICK; 6"X12" @ 1 3/4" THICK AND 12"X24" @ 1 3/4" THICK OF 'CALYPSO CORAL' WITH 3"X3"; 6"X6" AND 12"X6" ACCENT TILE, MORTAR SET ON SLAB
	P5	PEBBLE BORDER INLAY	BEACH PEBBLE	NATURAL FINISH	12" WIDE BEACH PEBBLE ON EDGE BORDER; MORTAR SET ON CONCRETE BAND
	P6	ENTRY FOUNTAIN - PAVEMENT	CRUSHED LIMESTONE	COMPACTED LIMESTONE WITH STABILIZER	1-1/2 TO 3 INCH LAYER OF A BLENDED MIXTURE OF CRUSHED LIMESTONE WITH STABILIZER
	P7	BOCCE + SHUFFLEBOARD - PAVEMENT	CORAL STONE ('CALYPSO CORAL')	BRUSHED & FILLED	18"X18" @ 2" THICK OF 'CALYPSO CORAL'; SAND SET ON AGGREGATE
	P8	SHUFFLEBOARD - COURT SURFACE	IPE DECK	IPE OIL FINISH	CONCEALED FASTENER SYSTEM; PIER SUPPORT SYSTEM 8" ABOVE FINISH GRADE. 'SHUFFLEBOARD - COURT LINES PAINTED WITH EPOXY PAINT
	P9	BOCCE - COURT SURFACE	CRUSHED SHELL AND DECOMPOSED GRANITE MIX	TAN	1-1/2 TO 3 INCH LAYER OF A BLENDED MIXTURE OF CRUSHED OYSTER SHELL AND DECOMPOSED GRANITE, ADD TOP COAT OF OYSTER FLOUR 1/4 TO 1/2 LB/SF
	P10	MINI GOLF - TURF	SYNTHETIC PUTTING LAWN	GREEN	PUTTING SURFACE: 3/8" HEIGHT PILE FRINGE LAWN, 1-3/8" HEIGHT PILE
	P11	PLAYGROUND - SURFACE	POUR IN PLACE RUBBER PLAY SURFACE	BLUE & TAN TONES	80% FLAT PLAY SURFACE AND 20% MOUNDED PLAY SURFACE
	P12	BASKETBALL - SURFACE	POUR IN PLACE RUBBER PLAY SURFACE	DARK BLUE	COURT WITH PAINTED LINES
	P13	SIDEWALK	CONCRETE	EXPOSED TABBY	MATCH EXISTING

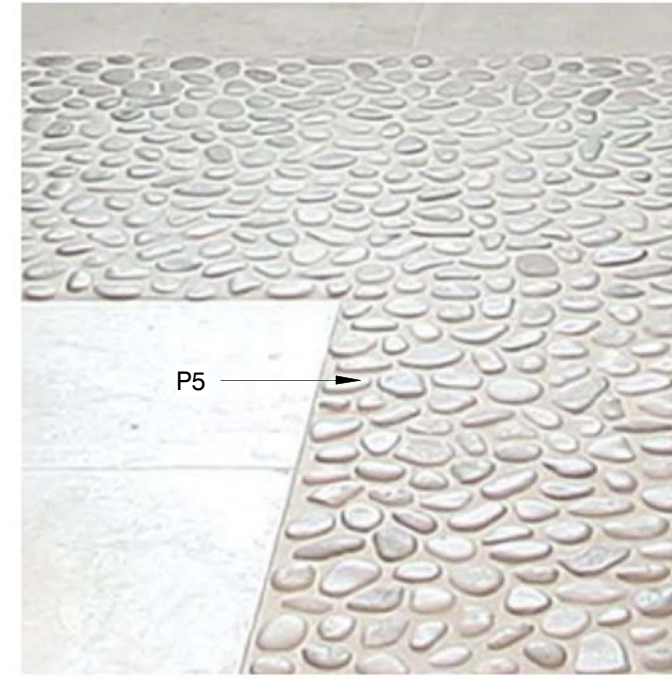
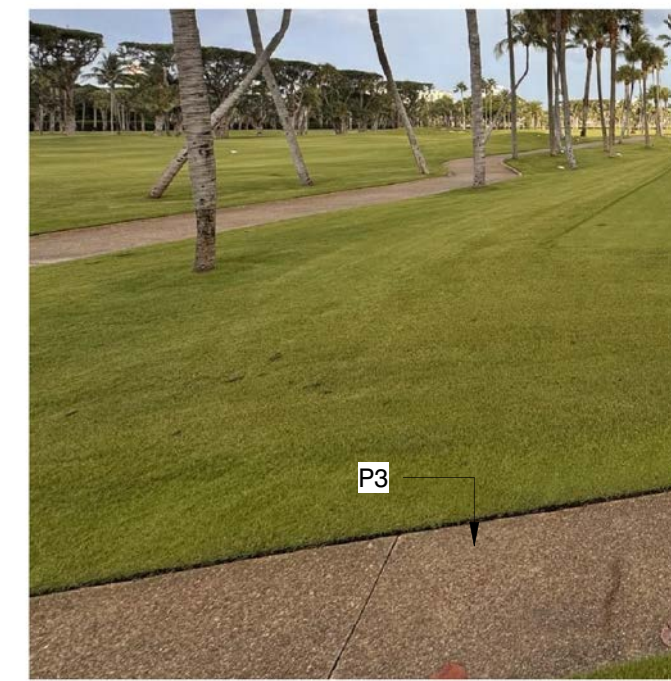
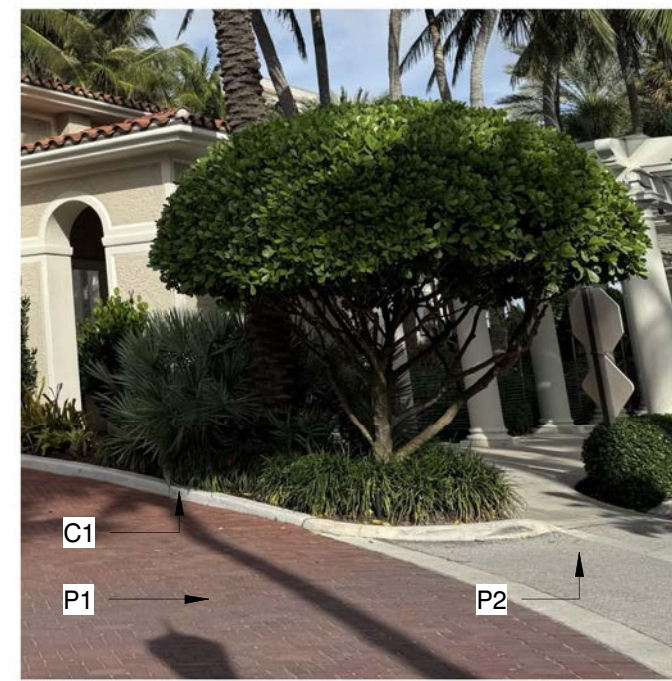

WALLS AND CURBS	C1	CONCRETE CURB	POUR IN PLACE CONCRETE	TO MATCH EXISTING	ALONG BOH/ PARKING/ RECONFIGURED ACCESS ROAD
	C2	MOUNTABLE CURB	POUR IN PLACE CONCRETE	TO MATCH EXISTING	PARKING/ RECONFIGURED ACCESS ROAD
	C3	BOCCE - COURT BORDER	CONCRETE CURB WITH IPE VENEER	IPE VENEER	RAISED BOCCE CURB EDGE WITH RECESSED LIGHTING AND ADA ACCESS
	C4	SHUFFLEBOARD - RAISED EDGE	CONCRETE CURB WITH CORAL STONE VENEER	BRUSHED	RAISED EDGE
	C5	BOCCE + SHUFFLEBOARD - FLUSH EDGE	CONCRETE CURB WITH CORAL STONE VENEER	BRUSHED	FLUSH EDGE
	C6	UMBRELLA MOUNT			PAVERS ON TOP OF FOUNDATION MOUNT WITH SLEEVE
	W1	PLAYGROUND - SEAT WALL	POUR IN PLACE CONCRETE SEAT WALL WITH MOSAIC TILE	CERAMIC AND PORCELAIN MOSAIC MATTE FINISH	"UNDER THE SEA" THEME MOSAIC TILE SEATING BENCH ON ALL SIDES

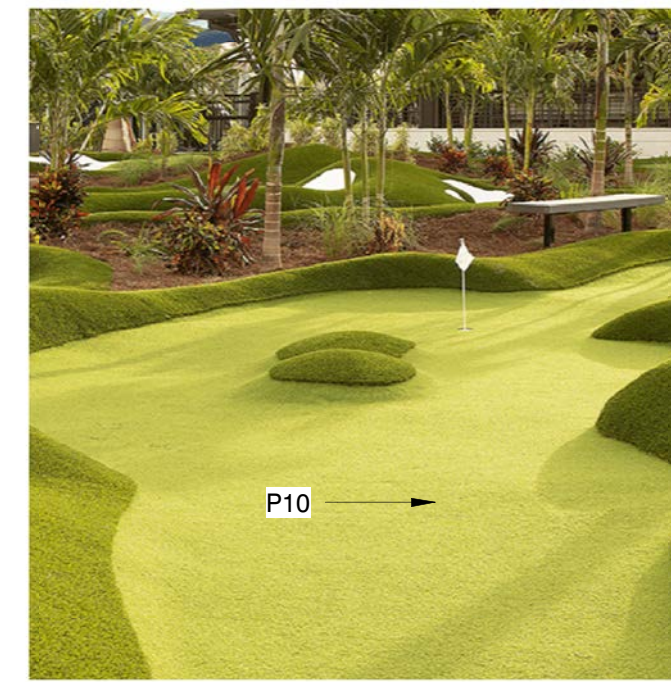

GATES & FENCES	G1	SITE SECURITY GATE	6' ALUMINUM FENCE GATE	POWDER COATED	VERTICAL PICKET SYSTEM; SUPPLIED BY AMERISTAR OR FORTRESSFENCE
	G2	PLAYGROUND GATE	4' DECORATIVE GATE	POWDER COATED	VERTICAL PICKET SYSTEM; SUPPLIED BY AMERISTAR OR FORTRESSFENCE
	F1	GOLF SAFETY NET	35' SAFETY NETTING WITH METAL SUPPORT POSTS	TO MATCH EXISTING	
	F2	SITE SECURITY FENCE	6' ALUMINUM FENCE	POWDER COATED	VERTICAL PICKETS AND ALLOW PLANTS TO GROW THROUGH AND SCREEN THE FENCE; SUPPLIED BY AMERISTAR OR FORTRESSFENCE
	F3	PLAYGROUND FENCE	4' ALUMINUM FENCE	POWDER COATED	VERTICAL PICKETS AND ALLOW PLANTS TO GROW THROUGH AND SCREEN THE FENCE; SUPPLIED BY AMERISTAR OR FORTRESSFENCE



MISC. SITE ELEMENTS	A1	TRENCH DRAIN	ALUMINUM	BRONZE AGED	
	A2	AREA DRAIN	ALUMINUM	BRONZE AGED	
	A3	ENTRY FOUNTAIN	CORAL STONE 'CALYPSO CORAL', TILE FINISH INSIDE BASIN	NATURAL FINISH	
	A4	TERRACE FOUNTAIN	CAST STONE, TILE FINISH INSIDE BASIN	NATURAL FINISH	
	A5	MINI-GOLF FOUNTAIN			
	A6	SHUFFLEBOARD FOUNTAIN	CAST STONE	AGED LIMESTONE	ANDALUSIA FOUNTAIN BY CAMPANIA
	A7	BENCH	CAST STONE	AGED LIMESTONE	PROVENCAL BENCH BY CAMPANIA
	A8	PLANTERS	PLANTER TYPES: (5) CAST STONE LINEAR PLANTERS 24" HEIGHT, 18" DEPTH @ 6' L (2) VERSAILLES PLANTERS : 26 1/2" SQ., 31 1/2" HT (4) ST. JAMES URN, SMALL 14.25" DIAM. X 15.5" HT (18) ST. JAMES URN, LARGE 24" DIAM. X 15.5" HT	CAST STONE	LINEAR PLANTERS INCLUDE 6' X 8' HT TRELLIS AND IRRIGATION; LOCATED EAST SIDE FACE OF FEC ALONG PARKING
	A9	BASKETBALL - BASKETBALL HOOP	STEEL POST, STANDARD BACKBOARD/ HOOP	POWDER COATED	2 BASKETBALL HOOPS
	A10	MINI GOLF - BREAKERS REPLICA BUILDING	COMPOSITE	PAINTED TO MATCH	MODEL REPLICA OF BREAKERS HOTEL
	A11	TOPIARIES	(1 QTY.) OCTOPUS - 12" HEIGHT WITH 15' TO 20' TENTACLES (6 QTY.) JELLY FISH @ 3' ROUND WITH 8' TO 10' LONG TENTACLES (9 QTY.) TROPICAL FISH @ 5' LONG, 2' WIDE AND 3' TALL (2 QTY.) SEAHORSE @ 12' HEIGHT 30" WIDE WITH (2) 4' DIA. CAST STONE CLAMSHELLS	REINFORCED WIRE MESH FRAME	ALT A: PRE-GROWN PLANTS ON WIRE MESH FRAME TOPIARY ALT B: SYNTHETIC TOPIARY ON WIRE MESH FRAME
	A12	SIGNAGE	COMPOSITE	TBD	
	A13	PLAYGROUND EQUIPMENT	COMPOSITE	TBD	SAILBOAT IS A CLIMBABLE/ INTERACTIVE PLAY STRUCTURE WITH CLIMBABLE PLAY STRUCTURES "UNDER THE SEA"...
	A14	BIKE RACK	METAL BIKE RACK	POWDER COATED	SMALL RACK TO SHOWCASE "BRANDED" BIKES



HART HOWERTON
NEW YORK: SAN FRANCISCO
10 East 40th Street, New York, NY 10016
Tel: 212 683 5631 Fax: 212 461 3788
Email: NY@hartowerton.com

FINAL SUBMITTAL

THE BREAKERS
PALM BEACH
1 S COUNTY RD
PALM BEACH, FLORIDA 33480

©2023 Hart Howerton.
The design and concepts shown are the sole property of Hart Howerton and may not be used without the prior written consent of Hart Howerton.

SCALE:
NOTE: DO NOT SCALE DRAWINGS. USE DIMENSIONS DIMENSIONS ONLY, OR SEEK CLARIFICATION FROM ARCHITECT FOR DIMENSIONS THAT ARE NOT INDICATED.

MILESTONES	
DATE	ISSUE
12/12/2024	1ST SUBMIT
01/27/2025	FINAL SUBMIT

REVISIONS		
NO.	DATE	ISSUE

REVISIONS		
NO.	DATE	ISSUE

DRAWING TITLE:
F.E.C.
MATERIAL SCHEDULE

PROJECT #: 22-525
DRAWN BY: MU
CHECKED BY: JN

DRAWING NO:
FEC L1-00



HART HOWERTON
 NEW YORK, SAN FRANCISCO
 10 East 40th Street, New York, NY 10016
 Tel.: 212 683 5631 Fax: 212 461 3788
 Email: NY@harthowerton.com

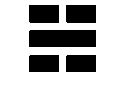

**THE BREAKERS
 PALM BEACH
 1 S COUNTY RD
 PALM BEACH, FLORIDA 33480**

©2025 Hart Howerton.
 The design and concepts shown are the sole property of Hart Howerton and may not be used without the prior written consent of Hart Howerton.

SCALE: 1" = 30'-0"
 NOTE: DO NOT SCALE DRAWINGS. USE DIMENSIONS DIMENSIONS ONLY. FOR ALL CLARIFICATIONS FROM ARCHITECT FOR MEASUREMENTS THAT ARE NOT INDICATED.

MILESTONES	
DATE	ISSUE
12/12/2024	1ST SUBMIT
01/27/2025	FINAL SUBMIT

REVISIONS

NO.	DATE	ISSUE

DRAWING TITLE:
**F.E.C.
 MATERIAL PLAN**

PROJECT #:
 22-525
 DRAWN BY:
 MU
 CHECKED BY:
 JN

DRAWING NO:
FEC L1-01

GENERAL LEGEND

--- LIMIT OF WORK (LOW)

MATERIAL LEGEND

- P1 - VEHICULAR PAVEMENT 1
- P2 - VEHICULAR PAVEMENT 2
- P3 - CART PATH
- P4 - PEDESTRIAN PAVEMENT
- P5 - PEBBLE BORDER INLAY
- P6 - ENTRY FOUNTAIN - PAVEMENT
- P7 - BOCCÉ + SHUFFLEBOARD - PAVEMENT
- P8 - SHUFFLEBOARD - COURT SURFACE
- P9 - BOCCÉ - COURT SURFACE
- P10 - MINI GOLF - TURF
- P11 - PLAYGROUND - SURFACE
- P12 - BASKETBALL - SURFACE
- P13 - SIDEWALK
- C1 - CONCRETE CURB
- C2 - MOUNTABLE CURB
- C3 - BOCCÉ - COURT BORDER
- C4 - SHUFFLEBOARD - RAISED EDGE
- C5 - BOCCÉ + SHUFFLEBOARD - FLUSH EDGE
- W1 - PLAYGROUND - SEAT WALL
- G1 - SITE SECURITY GATE
- G2 - PLAYGROUND GATE
- F1 - GOLF SAFETY NET
- F2 - SITE SECURITY FENCE
- F3 - PLAYGROUND FENCE
- A3 - ENTRY FOUNTAIN
- A4 - TERRACE FOUNTAIN
- A5 - MINI-GOLF FOUNTAIN
- A6 - SHUFFLEBOARD FOUNTAIN
- A7 - BENCH
- A8 - PLANTERS
- A9 - BASKETBALL HOOP
- A10 - MINI GOLF - BREAKERS REPLICA BUILDING
- A11 - TOPIARIES
- A12 - SIGNAGE
- A13 - PLAYGROUND EQUIPMENT
- A14 - BIKE RACK

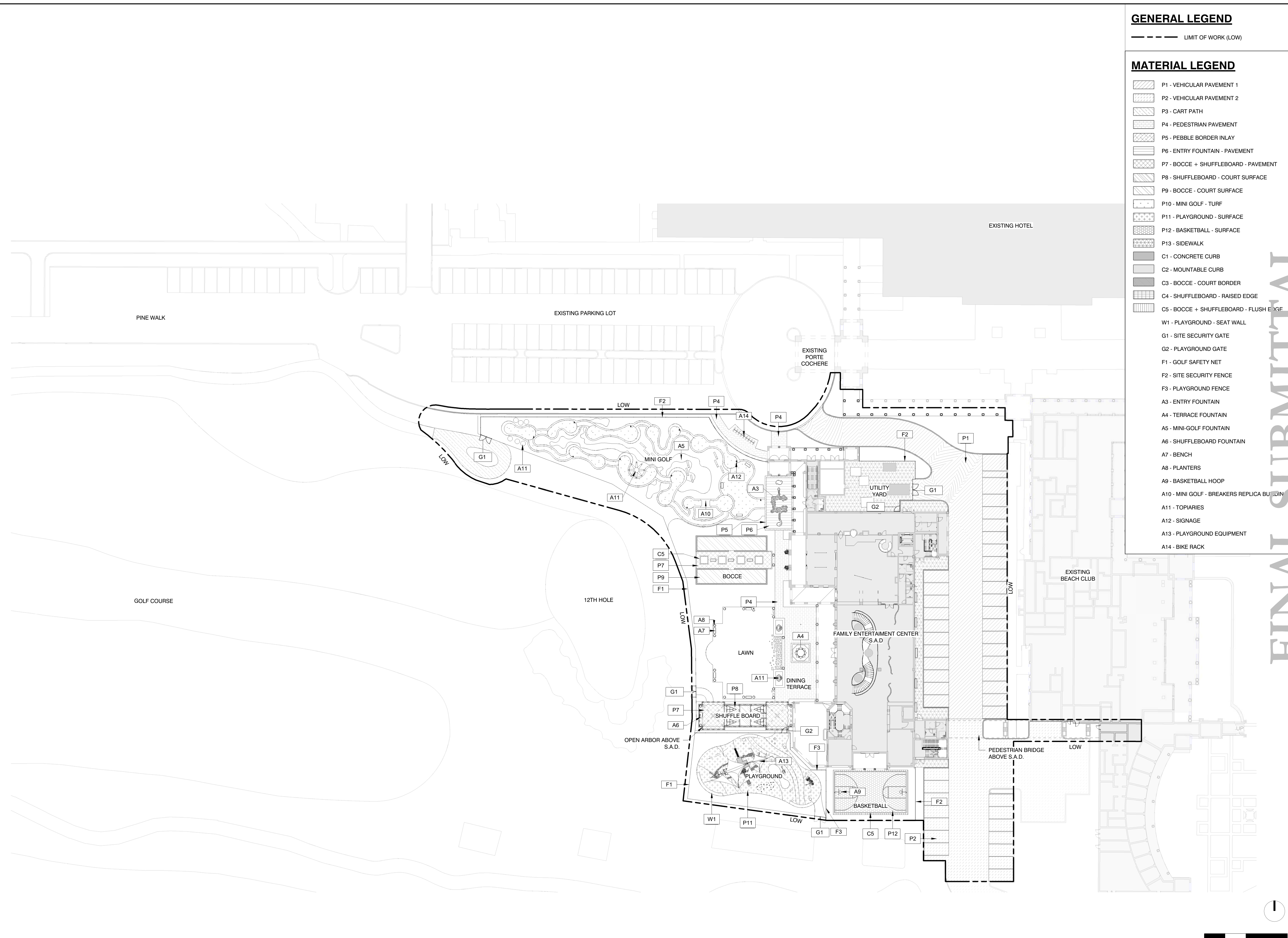

FINAL SUBMITTAL

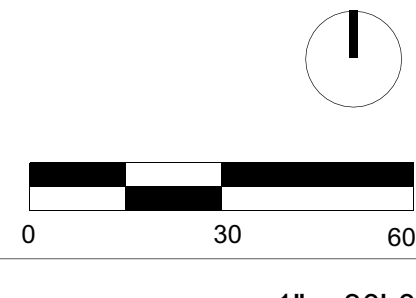

1/24/2025 4:40:00 PM



Town of Palm Beach

Planning Zoning and Building

360 S County Rd
Palm Beach, FL 33480
www.townofpalmbeach.com



HART HOWERTON
NEW YORK, SAN FRANCISCO

10 East 40th Street, New York, NY 10016
Tel.: 212 683 5631 Fax: 212 461 3768
Email: NY@hartowerton.com

Table with columns: CATEGORY, CODE, QUANTITY, BOTANICAL NAME, COMMON NAME, SIZE, NATIVE. Lists various tree species like Clusia guttata, Magnolia grandiflora, etc.

Table with columns: PALMS, CODE, QUANTITY, BOTANICAL NAME, COMMON NAME, SIZE, NATIVE. Lists palm species like Acoelorrhaphes wrightii, Roystonea regia, etc.

Table with columns: HEDGE A, HEDGE B, HEDGE C, CODE, QUANTITY, BOTANICAL NAME, COMMON NAME, SIZE, NATIVE. Lists hedge species like Podocarpus macrophyllus, Clusia guttata, etc.

Table with columns: GRASS, QUANTITY, BOTANICAL NAME, COMMON NAME, SIZE, NATIVE. Lists Paspalum grass.

Table with columns: VINE, QUANTITY, BOTANICAL NAME, COMMON NAME, SIZE, NATIVE. Lists Trachelospermum jasminoides, Passiflora suberosa, etc.

Table with columns: TOPIARIES, QUANTITY, BOTANICAL NAME, COMMON NAME, SIZE, NATIVE. Lists Mixed Plant Material.

Table with columns: GROUND COVER A, GROUND COVER B, QUANTITY, BOTANICAL NAME, COMMON NAME, SIZE, NATIVE. Lists Phytolacca dioica, Evolvulus glomeratus.

Table with columns: SHRUB A, QUANTITY, BOTANICAL NAME, COMMON NAME, SIZE, NATIVE. Lists Agapanthus africanus, Zamia floridana.

Table with columns: SHRUB B, QUANTITY, BOTANICAL NAME, COMMON NAME, SIZE, NATIVE. Lists Nephrolepis biserrata 'Macho', Zamia floridana.

Table with columns: SHRUB C, QUANTITY, BOTANICAL NAME, COMMON NAME, SIZE, NATIVE. Lists Strelitzia nicolai, Heliconia Varieties, Philodendron Varieties, Alocasia Varieties.

Table with columns: SHRUB D, QUANTITY, BOTANICAL NAME, COMMON NAME, SIZE, NATIVE. Lists Cordyline Varieties, Agave Varieties, Dracaena Varieties, Alocasia Varieties, Aechmea Varieties, Dicot edule, Euphorbia tirucalli.

Table with columns: SHRUB E, QUANTITY, BOTANICAL NAME, COMMON NAME, SIZE, NATIVE. Lists Strelitzia nicolai, Heliconia Varieties, Philodendron Varieties, Alocasia Varieties.

Table with columns: SHRUB F, QUANTITY, BOTANICAL NAME, COMMON NAME, SIZE, NATIVE. Lists Chrysobalanus icaco.

Table with columns: SHRUB G, QUANTITY, BOTANICAL NAME, COMMON NAME, SIZE, NATIVE. Lists Nephrolepis biserrata 'Macho', Zamia floridana, Psychotria nervosa, Chrysobalanus icaco 'Horizontal', Hamelia patens.

Landscape Legend table with columns: Line #, Property Address, Lot Area (sq. ft.), REQUIRED, EXISTING, PROPOSED. Includes landscape open space, LOS to be altered, perimeter LOS, front yard LOS, native trees/shrubs, and groundcover percentages.

To determine qualifying native vegetation use either:
the Institute for Regional Conservation Natives for Your Neighborhood FL Statewide Plant List
OR
the Florida Native Plant Society Native Plants for Your Area List

Note: Modification of >50% of existing landscape/greenscape are subject to minimum native plant requirements and must submit a landscape and irrigation plan for review.

This table shall be included on the landscape species index sheet as prepared by a licensed landscape architect and landscape openspace data shall be incorporated on to corresponding zoning legend.

See Ord. 003-2023

REV BF 20230727

*NOTES:

-- 'EXISTING LANDSCAPE AREA' AND ' PROPOSED LANDSCAPE AREA' WITHIN THE PROJECT LIMIT OF WORK ARE LISTED IN LINE 4 ABOVE.
-- PREVIOUSLY THE ENTIRE 'PROJECT LIMIT OF WORK AREA' HAS BEEN CONSIDERED AS PART OF THE 'BREAKERS PUD' IN CALCULATIONS OF 'OPEN SPACE' FOR THE OVERALL PUD PROPERTY. ON THIS BASIS, NO CHANGE IN 'OPEN SPACE' IS PROPOSED IN THIS APPLICATION FOR THE OVERALL PUD PROPERTY.

FINAL SUBMITTAL

THE BREAKERS
PALM BEACH
1 S COUNTY RD
PALM BEACH, FLORIDA 33480

©2023 Hart Howerton.
The design and concepts shown are the sole property of Hart Howerton and may not be used without the prior written consent of Hart Howerton.

SCALE: 1/2" = 1'-0"
NOTE: DO NOT SCALE DRAWINGS. USE FINISHED DIMENSIONS ONLY, OR MAKE CLARIFICATIONS FROM ARCHITECT FOR DIMENSIONS THAT ARE NOT INDICATED.

MILESTONES table with columns: DATE, ISSUE. Shows 12/12/2024 1ST SUBMIT and 01/27/2025 FINAL SUBMIT.

REVISIONS

Table with columns: NO., DATE, ISSUE. Empty table for revisions.

DRAWING TITLE:
P.L.C.
PLANTING
SCHEDULE &
LANDSCAPE
LEGEND

PROJECT #: 22-525
DRAWN BY: MU
CHECKED BY: JN

DRAWING NO:
FEC L6-00

GENERAL LEGEND

--- LIMIT OF WORK (LOW)



HART HOWERTON
 NEW YORK, SAN FRANCISCO
 10 East 40th Street, New York, NY 10016
 Tel.: 212 683 5631 Fax.: 212 461 3788
 Email: NY@harthowerton.com

FINAL SUBMITTAL

**THE BREAKERS
 PALM BEACH
 1 S COUNTY RD
 PALM BEACH, FLORIDA 33480**

©2023 Hart Howerton
 The design and concepts shown are the sole property of Hart Howerton and may not be used without the prior written consent of Hart Howerton.

SCALE: 1" = 30'-0"
 NOTE: DO NOT SCALE DRAWINGS. USE DIMENSIONS DIMENSIONED ONLY OR SEE CLARIFICATIONS FROM ARCHITECT FOR MEASUREMENTS THAT ARE NOT INDICATED.

MILESTONES	
DATE	ISSUE
12/12/2024	1ST SUBMIT
01/27/2025	FINAL SUBMIT

REVISIONS		
NO.	DATE	ISSUE

DRAWING TITLE:
**SHRUB AND
 GROUND COVER
 PLAN**

PROJECT #:
 22-525
 DRAWN BY:
 MU
 CHECKED BY:
 JN

DRAWING NO:
FEC L6-02

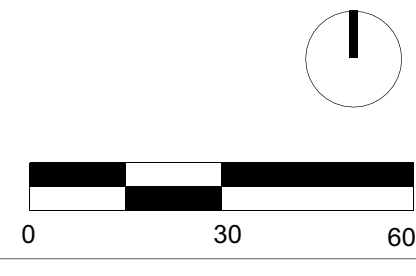
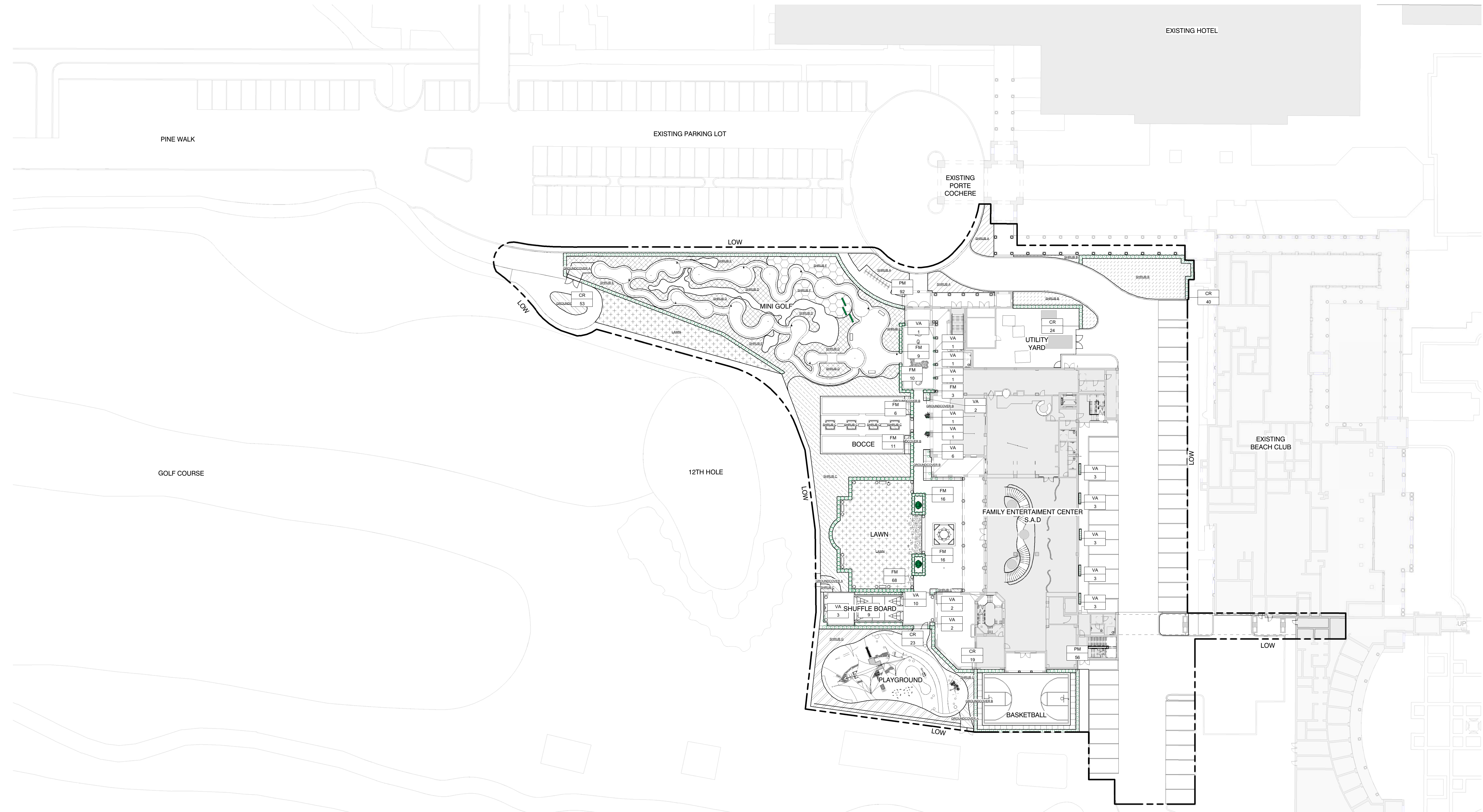

1/24/2025 4:40:09 PM

1" = 30'-0"



HART HOWERTON
 NEW YORK, SAN FRANCISCO
 10 East 40th Street, New York, NY 10016
 Tel.: 212 683 5631 Fax: 212 461 3788
 Email: NY@harthowerton.com

GENERAL LEGEND

- - - - - TRACT LINE
- --- LIMIT OF WORK (LOW)
- --- COSTAL CONSTRUCTION CONTROL LINE (CCCL)

TREE & PALM LEGEND

- STRUCTURES (19,898 SF)
- HARDSCAPE (39,800 SF)
- GREENSPACE (23,641 SF)
- WATER FEATURES (1,086 SF)



FINAL SUBMITTAL

**THE BREAKERS
 PALM BEACH
 1 S COUNTY RD
 PALM BEACH, FLORIDA 33480**

©2023 Hart Howerton.
 The design and concepts shown are the sole property of Hart Howerton and may not be used without the prior written consent of Hart Howerton.

SCALE: 1" = 30'-0"
 NOTE: DO NOT SCALE DRAWINGS. USE DIMENSIONS DIMENSIONED ONLY. FOR CLARIFICATION FROM ARCHITECT FOR MEASUREMENTS THAT ARE NOT INDICATED.

MILESTONES	
DATE	ISSUE
12/12/2024	1ST SUBMIT
01/27/2025	FINAL SUBMIT

REVISIONS		
NO.	DATE	ISSUE

DRAWING TITLE:
**F.E.C.
 OPEN SPACE
 DIAGRAM**

PROJECT #:
 22-525
 DRAWN BY:
 MU
 CHECKED BY:
 JN

DRAWING NO:
FEC L8-01



LAWN AND WEST ELEVATION

1/24/2025 4:40:14 PM



HART HOWERTON
 NEW YORK, SAN FRANCISCO
 10 East 40th Street, New York, NY 10016
 Tel.: 212 683 5831 Fax.: 212 461 3788
 Email: NY@harthowerton.com

FINAL SUBMITTAL

THE BREAKERS
PALM BEACH
 1 S COUNTY RD
 PALM BEACH, FLORIDA 33480

©2023 Hart Howerton.
 The design and concepts shown are the sole property of Hart Howerton and may not be used without the prior written consent of Hart Howerton.

SCALE:
 NOTE: DO NOT SCALE DRAWINGS. USE FIELD DIMENSIONS ONLY. FOR S&K CLARIFICATIONS FROM ARCHITECT FOR MEASUREMENTS THAT ARE NOT INDICATED.

MILESTONES	
DATE	ISSUE
12/12/2024	1ST SUBMIT
01/27/2025	FINAL SUBMIT

REVISIONS		
NO.	DATE	ISSUE

DRAWING TITLE:
F.E.C.
PERSPECTIVE
VIGNETTE

PROJECT #:
 22-525
 DRAWN BY:
 MU
 CHECKED BY:
 JN

DRAWING NO:
FEC L8-02