

Scope of Work

- * Landscape renovations to an existing Golf Course



The Everglades Club 500 S. County Rd Palm Beach

F L O R I D A

ARC-24-0137 (ZON-24-0086)
02/26/25 (ARCOM), 02/12/25 (TC)

Sheet Index

Cover Sheet

- L1.0 - Truck Logistics Plan
- L2.0 - Construction Entrance & Staging Plan
- L3.0 - Demolition and Vegetation Action Plan
- L4.0 Open Space Graphic
- L5.0 - Landscape Action Plan



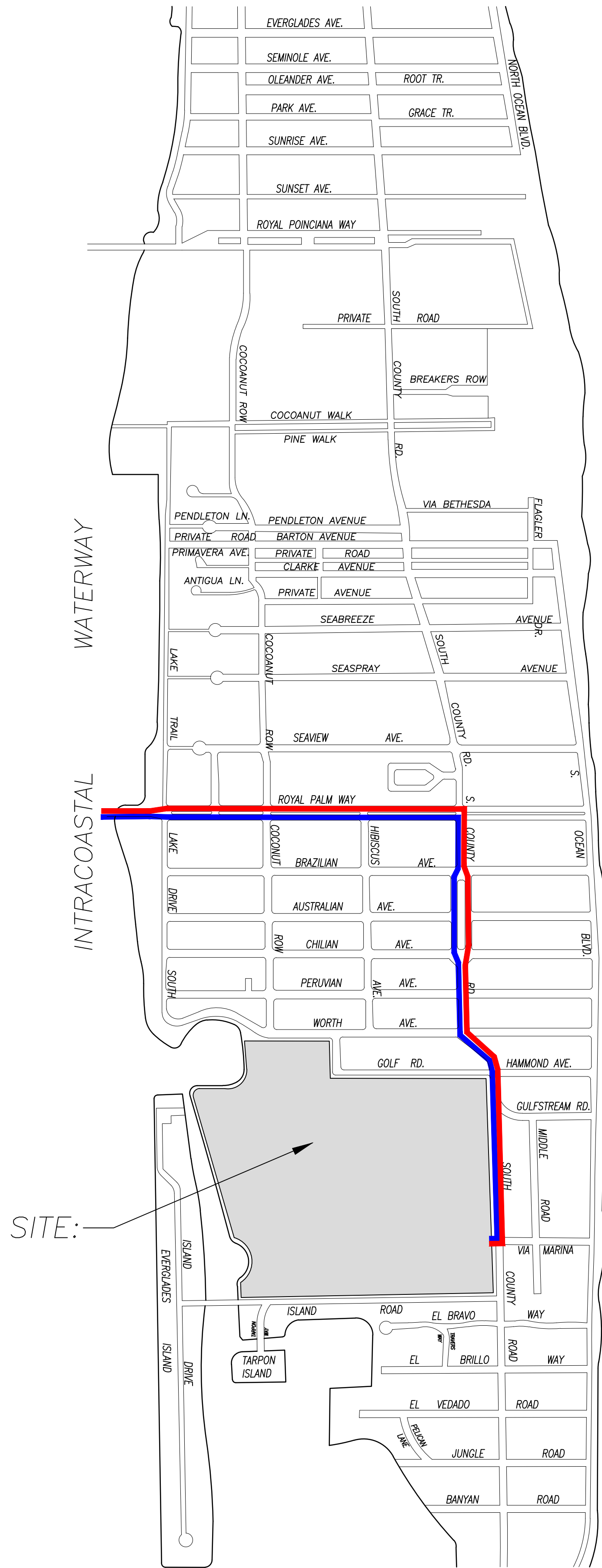

SCALE: N.T.S.

1 PROPOSED CONSTRUCTION SCHEDULE

SCHEDULE:

- To be determined

2 PROPOSED TRUCK INGRESS / EGRESS ROUTES MAP

SCHEDULE:

- To be determined

NOTE: SEE SEPARATE "CONSTRUCTION STAGING PLAN" SHEET FOR INFORMATION ON LOCATIONS FOR PARKING, MATERIAL STORAGE, DELIVERIES, DUMPSTER, PORTABLE TOILETS, ETC.

- PROPOSED INGRESS TRUCK ROUTE
- PROPOSED EGRESS TRUCK ROUTE

The Everglades Club 500 S County Rd Palm Beach

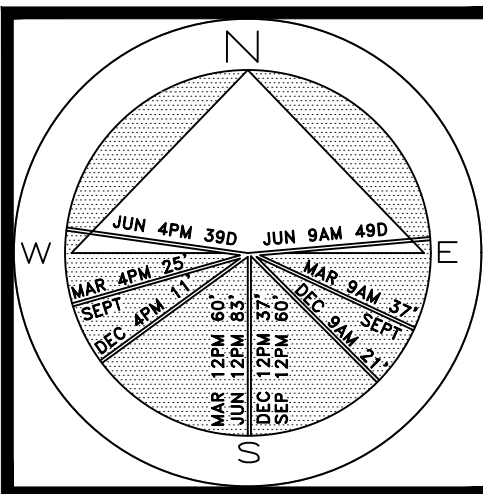

JOB NUMBER: # 24202.00 LA
DRAWN BY: Matt Tollison
DATE: 12.16.2024

SHEET L1.0

48 HOURS BEFORE DIGGING
CALL TOLL FREE
1-800-432-4770
SUNSHINE STATE ONE CALL
OF FLORIDA, INC.

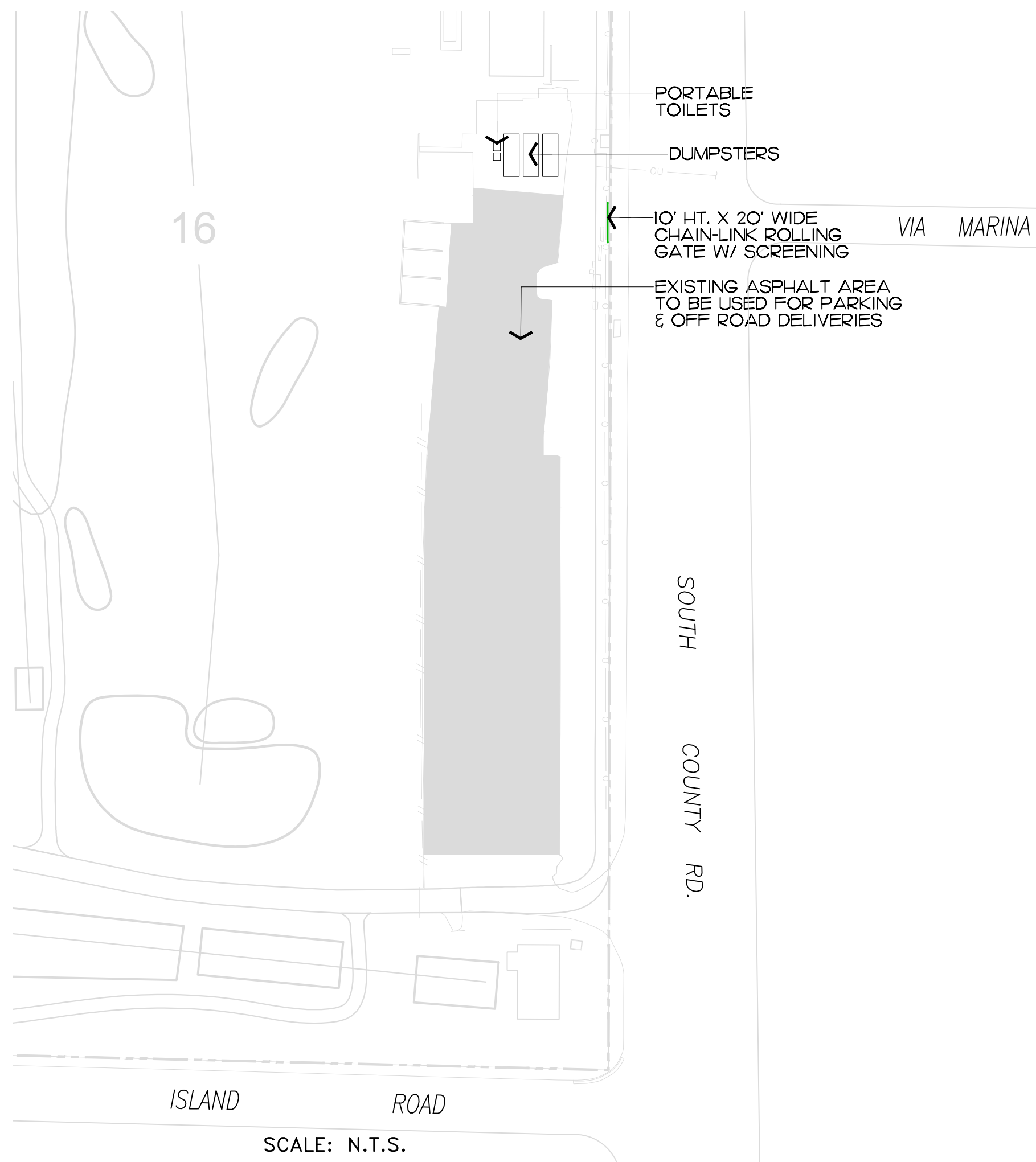
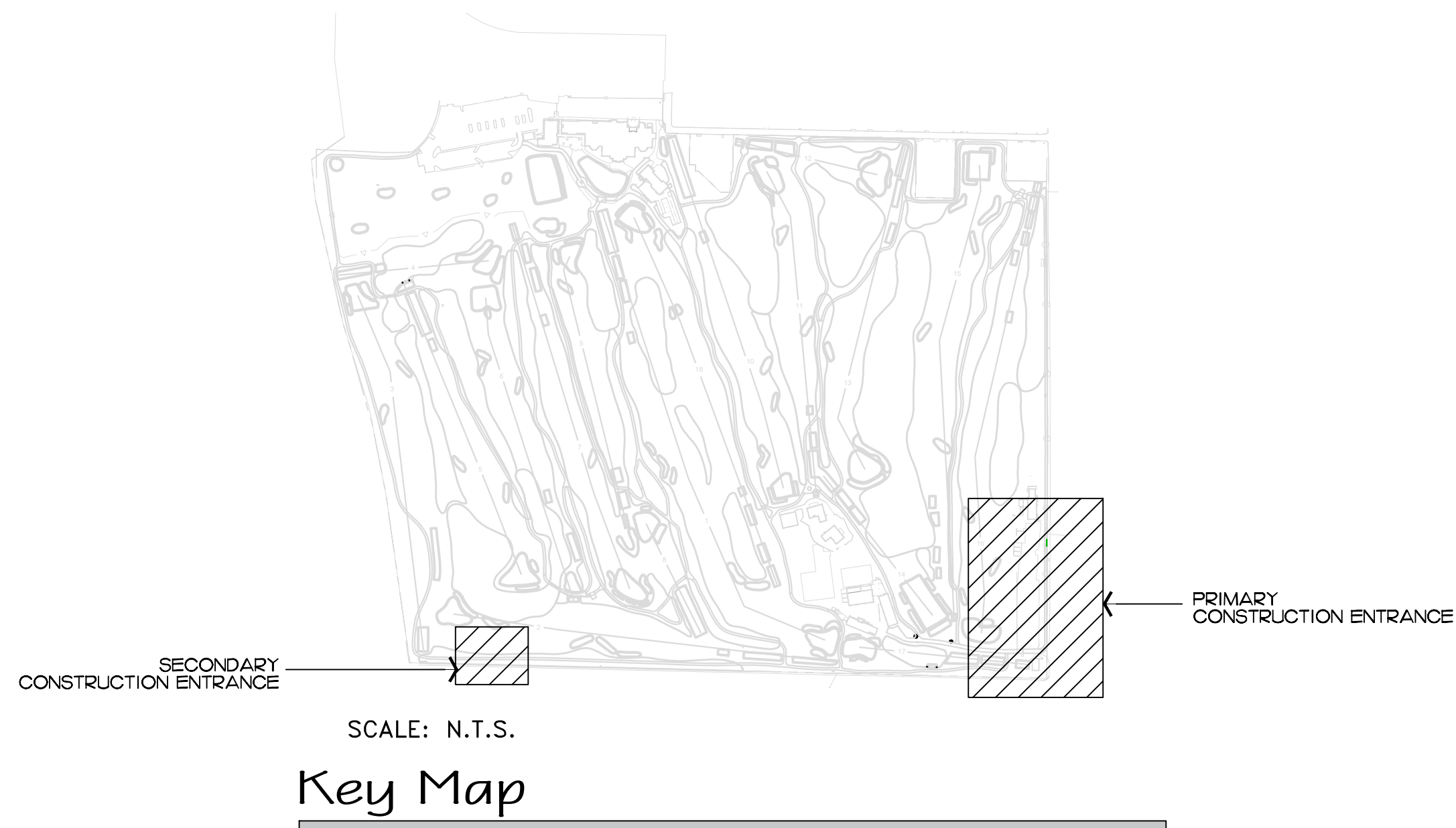

Existing North Buffer / South County Road



Existing South Buffer / South County Road

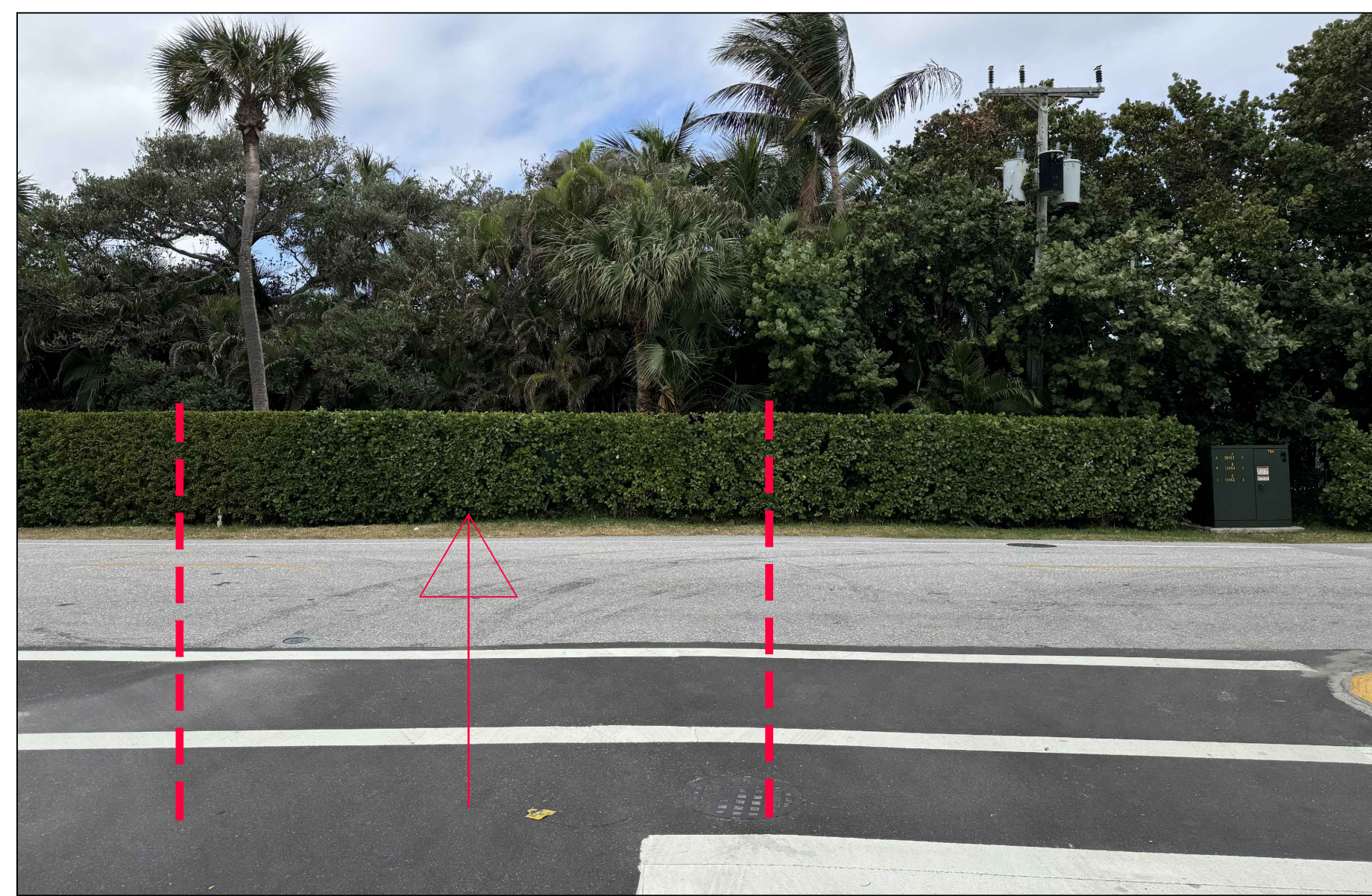

Proposed Primary Construction Entrance

*Locate at the West end of Via Marina on North County Rd.

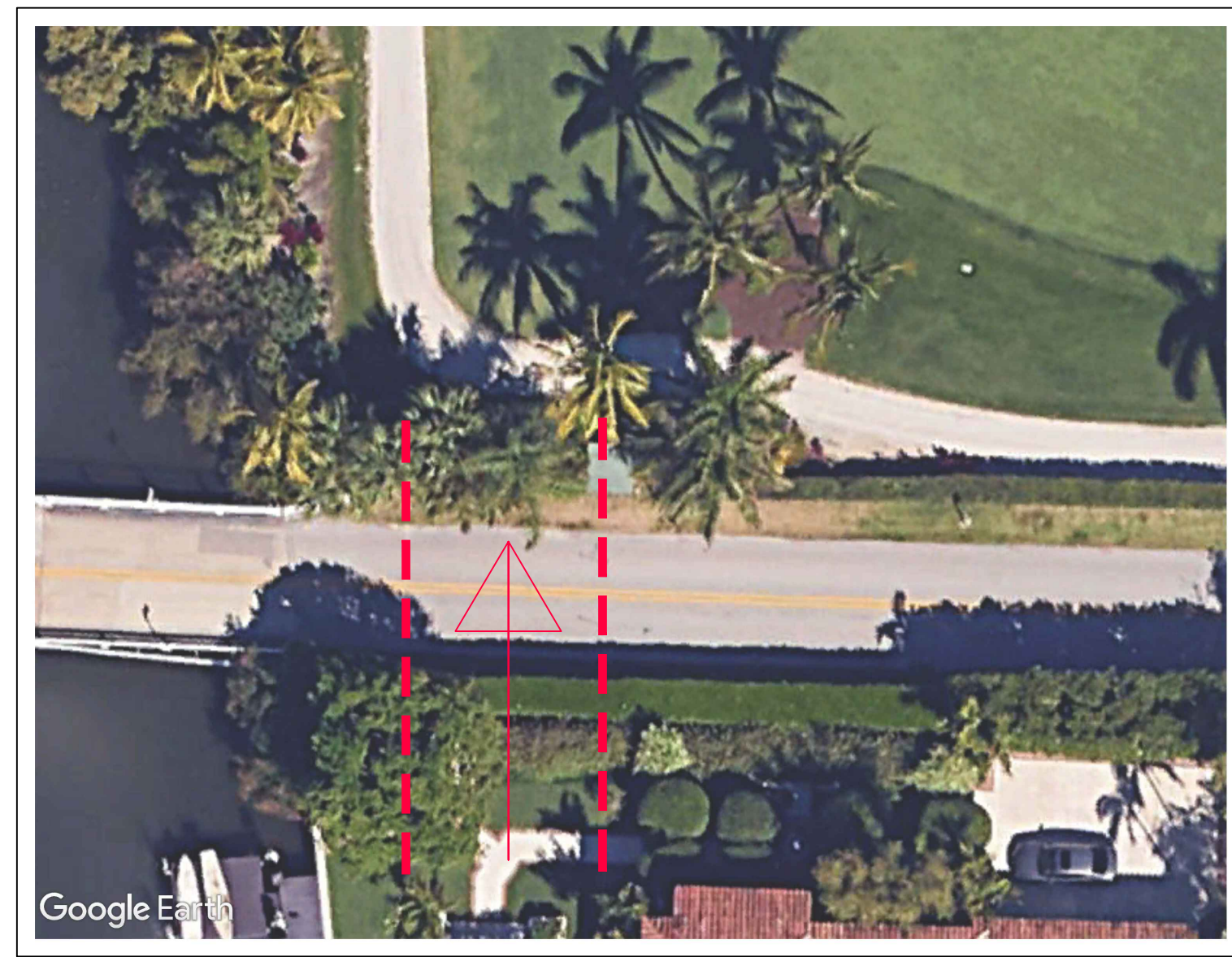

Proposed Secondary Construction Entrance

*Locate on Island Rd. Southwest Corner of Property

Construction Entrance & Staging Plan

SCALE: N.T.S.

The Everglades Club
500 S County Rd
Palm Beach

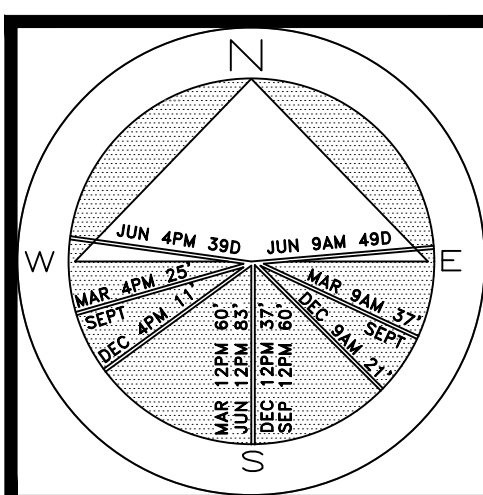

JOB NUMBER: # 24202.00 LA
DRAWN BY: Matt Tollison
DATE: 12.17.2024

SHEET L2.0

PLANT NAME	QTY.
BURSERA SIMARUBA GUMBO LIMBO TREE	1
CALLISTEMON CITRINUS BOTTLEBRUSH TREE	3
CANANGA ODORATA YLANG YLANG TREE	1
FICUS SPP. FICUS TREE	3
ILEX CASSINE DAHOON HOLLY TREE	1
MYRCIANTHES FRAGRANS SIMPSON STOPPER TREE	5
QUERCUS VIRGIANA LIVE OAK TREE	1
SWIETENIA MAHAGONI MAHOGANY TREE	3
TABEBUIA HETEROPHYLLA TABEBUIA TREE	8
MELALEUCA QUINQUEVERVIA MELALEUCA TREE (INVASIVE)	3
SYZYGium CUMINI JAVA PLUM TREE (INVASIVE)	1
THESPESIA POPULNEA SEASIDE MAHOE TREE (INVASIVE)	T.B.D.

PLANT NAME	QTY.
BURSERA SIMARUBA GUMBO LIMBO TREE	1
CALLISTEMON CITRINUS BOTTLEBRUSH TREE	3
CANANGA ODORATA YLANG YLANG TREE	1
FICUS SPP. FICUS TREE	3
ILEX CASSINE DAHOOH HOLLY TREE	1
MYRCIANTHES FRAGRANS SIMPSON STOPPER TREE	5
QUERCUS VIRGIANA LIVE OAK TREE	1
SWIETENIA MAHAGONI MAHOGANY TREE	3
TABEBUIA HETEROPHYLLA TABEBUIA TREE	8
MELALEUCA QUINQUEVERVIA MELALEUCA TREE (INVASIVE)	3
SYZYGium CUMINI JAVA PLUM TREE (INVASIVE)	1
THESPESIA POPULNEA SEASIDE MAHOE TREE (INVASIVE)	T.B.D.

PLANT NAME	QTY.
BURSERA SIMARUBA GUMBO LIMBO TREE	5
CORDIA SEBESTENA ORANGE GEIGER TREE	1
MYRCIANTHES FRAGRANS SIMPSON STOPPER TREE	6

PLANT NAME	QTY.
BURSERA SIMARUBA GUMBO LIMBO TREE	5
CORDIA SEBESTENA ORANGE GEIGER TREE	1
MYRCIANTHES FRAGRANS SIMPSON STOPPER TREE	6

PLANT NAME	QTY.
CARYOTA MITIS FISHTAIL PALM	2
COCOS NUCIFERA COCONUT PALM	83
DYPSPIS LUTESCENS ARECA PALM	68
ELAEIS GUINEENSIS AFRICAN OIL PALM	5
PHOENIX SPP. DATE PALM	1
ROYSTONEA REGIA ROYAL PALM	19
SABAL PALMETTO SABAL PALM	81

PLANT NAME	QTY.
CARYOTA MITIS FISHTAIL PALM	2
COCOS NUCIFERA COCONUT PALM	83
DYPSPIS LUTESCENS ARECA PALM	68
ELAEIS GUINEENSIS AFRICAN OIL PALM	5
PHOENIX SPP. DATE PALM	1
ROYSTONEA REGIA ROYAL PALM	19
SABAL PALMETTO SABAL PALM	81

PLANT NAME	QTY.
ADONIDIA MERRILLII CHRISTMAS PALM	4
BISMARCKIA NOBILIS BISMARCK PALM	2
COCOS NUCIFERA COCONUT PALM	7
DICTYOSPERMA ALBUM HURRICANE PALM	2
HYOPHORBE LAGENICAULIS BOTTLE PALM	1
PHOENIX SPP. DATE PALM	1
PHOENIX ROEBELENI PYGMY DATE PALM	5
PTYCHOSPERMA ELEGANS SOLITAIRE PALM	3
ROYSTONEA REGIA ROYAL PALM	8
SABAL PALMETTO SABAL PALM	31
THRINAX RADIATA THATCH PALM	15
VEITCHIA MONTGOMERYANA MONTGOMERY PALM	7
WODYETIA BIFURCATA FOXTAIL PALM	1

PLANT NAME	QTY.
ADONIDIA MERRILLII CHRISTMAS PALM	4
BISMARCKIA NOBILIS BISMARCK PALM	2
COCOS NUCIFERA COCONUT PALM	7
DICTYOSPERMA ALBUM HURRICANE PALM	2
HYOPHORBE LAGENICAULIS BOTTLE PALM	1
PHOENIX SPP. DATE PALM	1
PHOENIX ROEBELENI PYGMY DATE PALM	5
PTYCHOSPERMA ELEGANS SOLITAIRE PALM	3
ROYSTONEA REGIA ROYAL PALM	8
SABAL PALMETTO SABAL PALM	31
THRINAX RADIATA THATCH PALM	15
VEITCHIA MONTGOMERYANA MONTGOMERY PALM	7
WODYETIA BIFURCATA FOXTAIL PALM	1

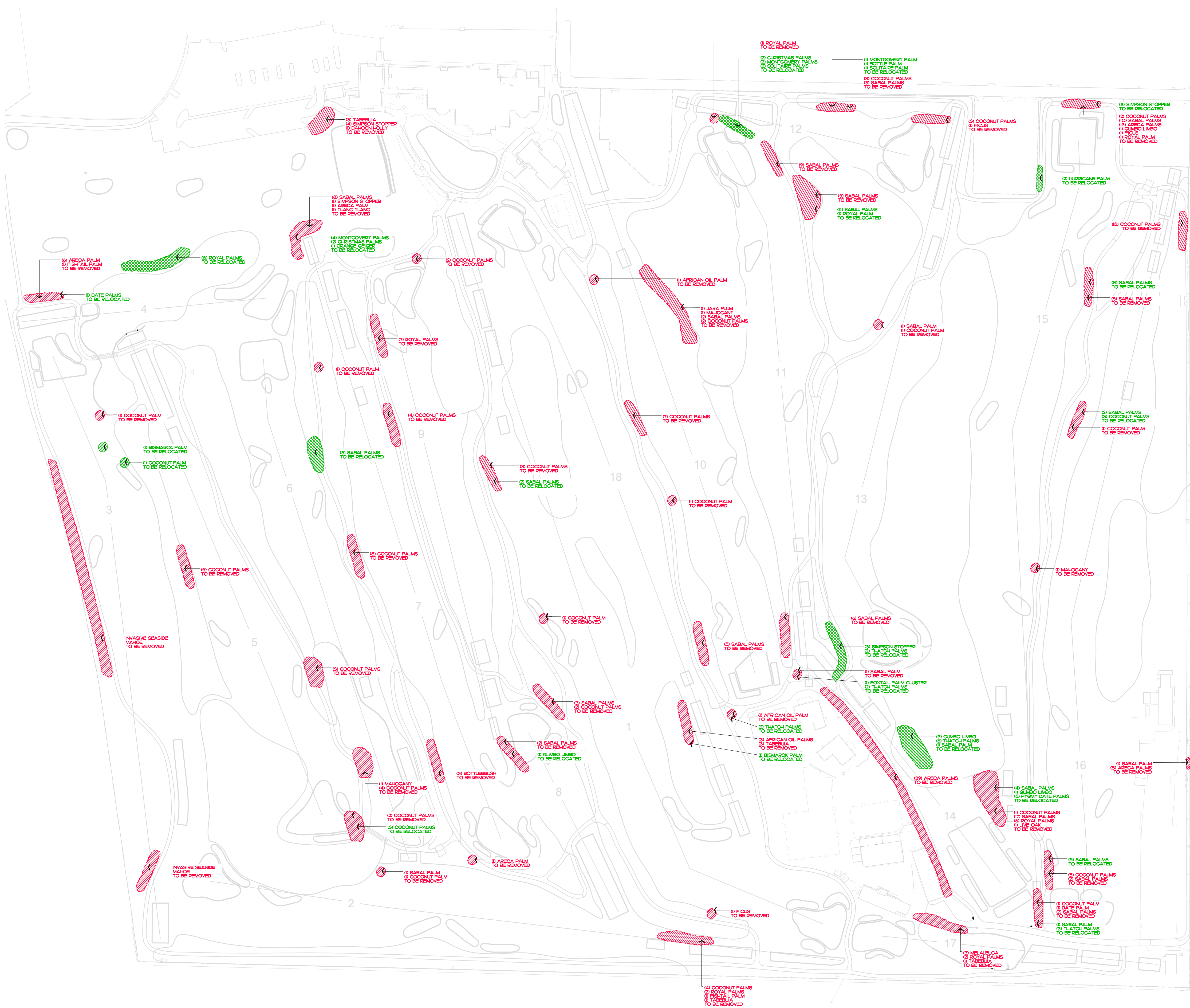

 ENVIRONMENT
DESIGN
GROUP

139 North County Road S#20-B Palm Beach, FL 33480
Phone 561.832.4600 Mobile 561.313.4424

Landscape Architecture
Land Planning
Landscape Management

Dustin M. Mizell, MIA RIA #6666784
Dustin@environmentdesigngroup.com

The Everglades Club
500 S County Rd
Palm Beach

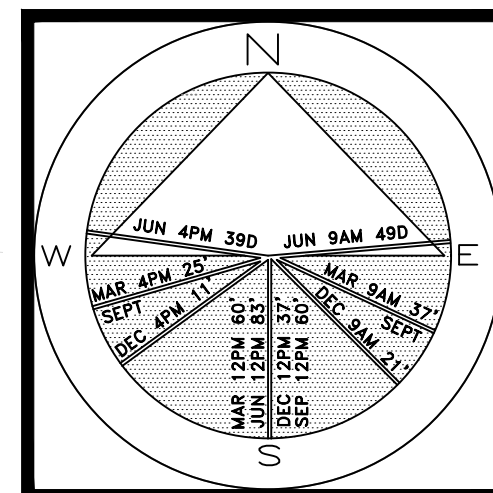

JOB NUMBER: # 24202.00 LA
DRAWN BY: Matt Tollison
DATE: 12.16.2024

SHEET L3.C

COPYRIGHT: 2024

The following drawings are instruments of service to the Landscape Architect. They are not to be reproduced in any form without the designs, arrangements and plans indicated herein. All rights are reserved and shall be owned by and the property of the designer, and were created, evolved and developed in and in connection with this project. None of such ideas, designs, concepts, or drawings are to be copied or disclosed to any person, firm or corporation without the written permission of the Landscape Architect.

DISCLAIMER: 2024

Understood, as the term is generally understood, that the ENVIRONMENT DESIGN GROUP does not provide any design services during construction, including on-site construction administration. In the event a service clarification is called, the client agrees to indemnify and hold harmless ENVIRONMENT DESIGN GROUP from any liability and from, costs or omissions in the performance of said services. The client hereby consents to the use of his/her names, employees, or subcontractors.

48 HOURS BEFORE DIGGING
CALL TOLL FREE
1-800-432-4770
SUNSHINE STATE ONE CALL
OF FLORIDA, INC.

Demolition and Vegetation Action Plan

SCALE IN FEET 0' 100' 200' 300'

Legeria

IMPERVIOUS AREA (HOUSE/STRUCTURE)

IMPERVIOUS AREA (HARDSCAPE)

IMPERVIOUS AREA (WATER)

PERVIOUS AREA / OPEN SPACE

ENVIRONMENTAL
DESIGN
GROUP

139 North County Road 5020-8 Palm Beach, FL 33480
Phone: 561.832.4600 Mobile: 561.313.4424

Landscape Architecture
Land Planning
Landscape Management

Dustin M. Mizell, M.L.A. R.L.A. #6666784
Dustin@environmentaldesigngroup.com

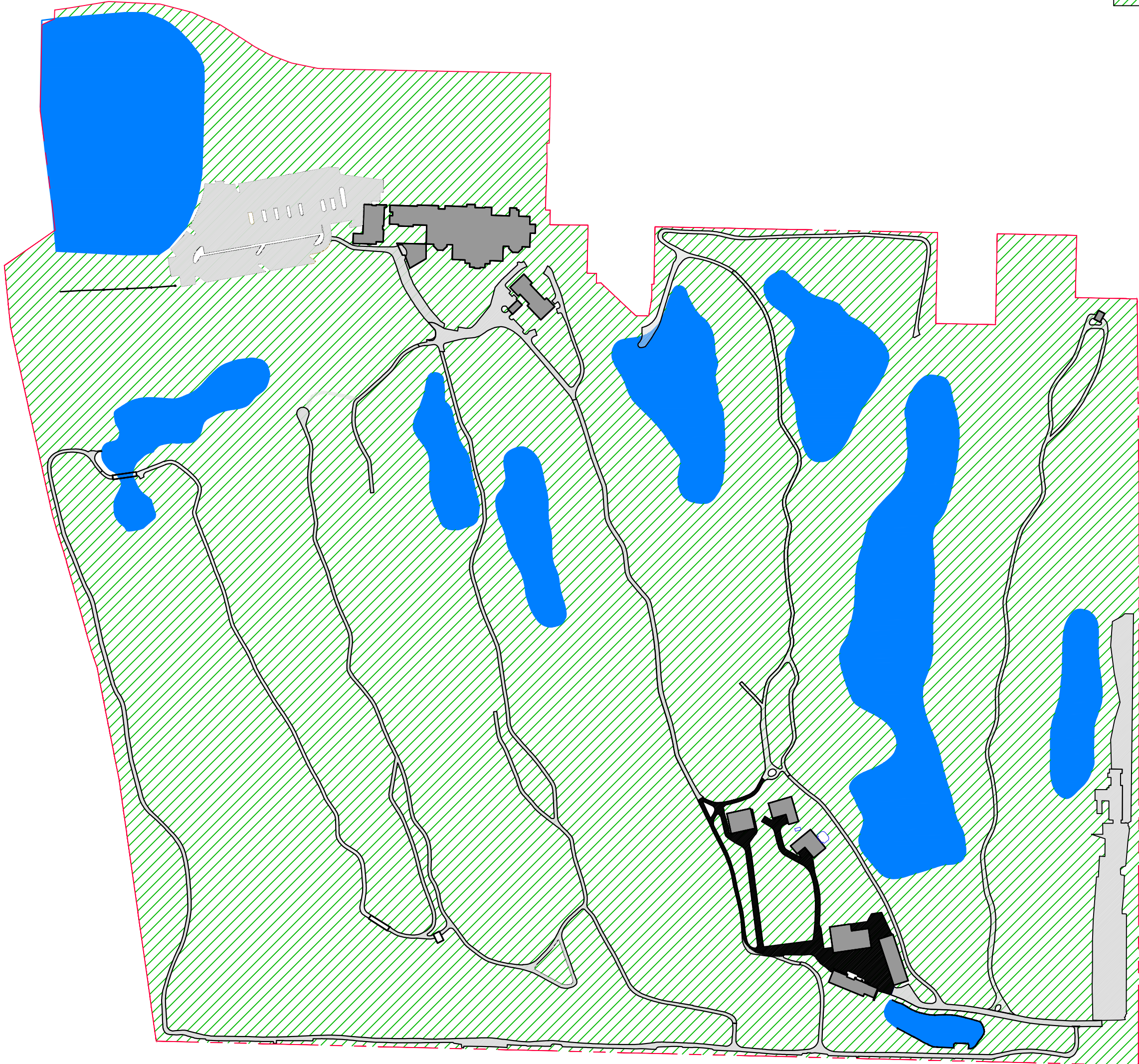

Existing Lot Coverage Graphic

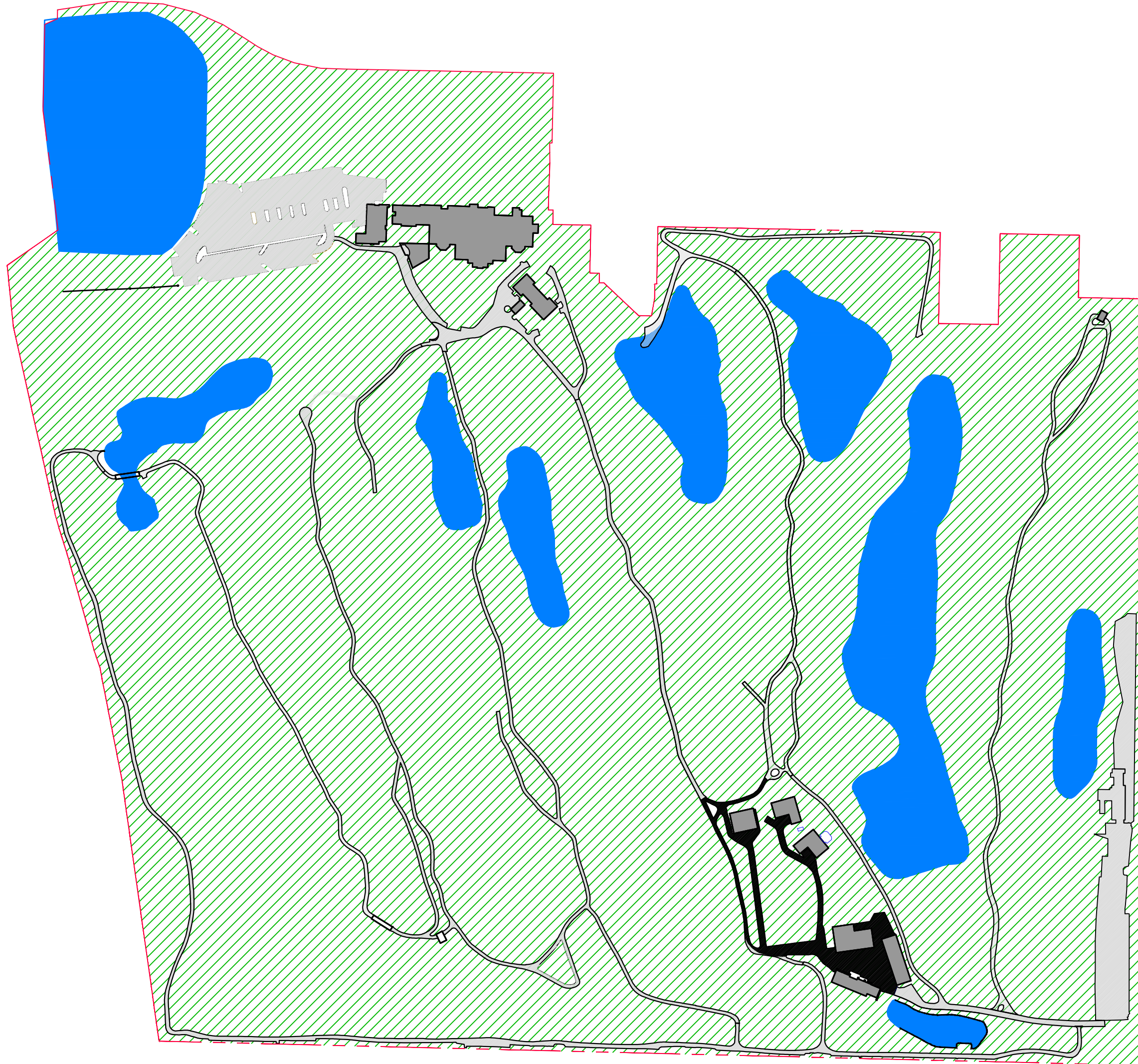

Proposed Lot Coverage Graphic

Existing Site Data

DESCRIPTION	REQUIRED	EXISTING
LOT ZONE		RA (ESTATE RESIDENTIAL)
LOT AREA	10,000 S.F. MINIMUM	91.44 ACRES 3,939,126 SF
OPEN / PERMEABLE SPACE	MINIMUM 45%	3,088,879 SF (78.4%)
FRONT YARD LANDSCAPE	MINIMUM 40% OF FRONT YARD 16,003 SF	35,192 SF (88.0%)
PERIMETER LANDSCAPE WITHIN 10' OF PROPERTY LINE	N/A	N/A

Proposed Site Data

DESCRIPTION	REQUIRED	PROPOSED
LOT ZONE		RA (ESTATE RESIDENTIAL)
LOT AREA	10,000 S.F. MINIMUM	91.44 ACRES 3,939,126 SF
OPEN / PERMEABLE SPACE	MINIMUM 45%	3,056,071 SF (77.6%)
FRONT YARD LANDSCAPE	MINIMUM 40% OF FRONT YARD 16,003 SF	25,910 SF (64.8%)
PERIMETER LANDSCAPE WITHIN 10' OF PROPERTY LINE	N/A	N/A

The Everglades Club
500 S County Rd
Palm Beach

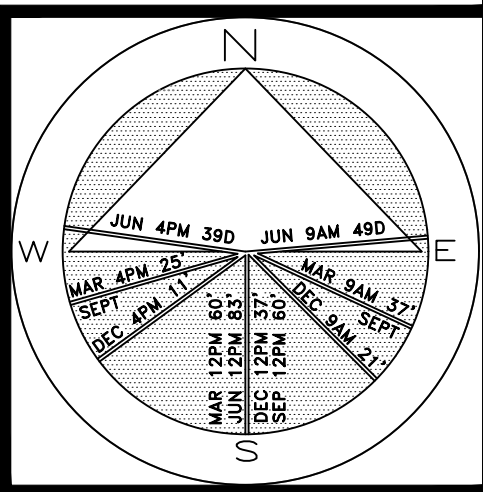

JOB NUMBER: # 24202.00 LA
DRAWN BY: Erika Gottsegen
DATE: 12.17.2024

COPYRIGHT: 2024

The following drawings are instruments of service to the Landscape Architect. They are not products of design. All ideas, designs, arrangements and plans indicated or represented by this/these drawings are owned by and the property of the designer, and were created, evolved and developed for use on and in connection with this project. None of such ideas, designs, arrangements or plans shall be used by or disclosed to any person, firm or corporation without the written permission of the Landscape Architect.

DISCLAIMER: 2024

Construction, as the term is generally understood, and that ENVIRONMENTAL DESIGN GROUP does not provide landscape architectural services during construction, including on-site monitoring, site visits, shop drawing review, design clarification, etc., the client agrees to indemnify and hold harmless ENVIRONMENTAL DESIGN GROUP from any liability arising from acts or omissions in the performance of said services during construction by the client, and his/her agents, employees, or subcontractors.

48 HOURS BEFORE DIGGING
CALL TOLL FREE
1-800-432-4770
SUNSHINE STATE ONE CALL
OF FLORIDA, INC.

Open Space Graphics

SHEET L4.0

50% Native Shrub Mix

PLANT NAME	NATIVE
CHRYSOBALANUS ICACO COCOPLUM	YES
CODAEIUM VARIEGATUM CROTON	NO
NERIUM OLEANDER OLEANDER	NO
TRIPSACUM DACTYLOIDES FAKAHATCHEE GRASS	YES

Additional Shrubs

PLANT NAME	NATIVE
CLUSIA GUTTIFERA CLUSIA	NO
CODAEIUM VARIEGATUM CROTON	NO
CONOCARPUS ERECTUS GREEN BUTTONWOOD	YES
ERNODEA LITTORALIS BEACH CREEPER	YES
IRIS VIRGINIANA IRIS	YES
NERIUM OLEANDER OLEANDER	NO
PODOCARPUS MACROPHYLLUS PODOCARPUS	NO
PORTULACA GRANDIFLORA MOSS ROSE	NO
STRELITZIA NICOLAI WHITE BIRD OF PARADISE	NO

NOTE:
ALL PROPOSED VEGETATION WILL MEET THE
TOWN REQUIREMENT OF 30% NATIVE PLANTINGS.

COPYRIGHT: 2024
The following drawings are instruments of service to the Landscape Architect. They are not products of design. All ideas, designs, arrangements and plans indicated or represented by this/these drawings are owned by and the property of the designer, and were created, evolved and developed for use on and in connection with this project. None of such ideas, designs, arrangements or plans shall be used by or disclosed to any person, firm or corporation without the written permission of the Landscape Architect.

DISCLAIMER: 2024
Construction, as the term is generally understood, and that ENVIRONMENT DESIGN GROUP does not provide landscape architectural services during construction, including on-site monitoring, site visits, shop drawing review, design clarification, etc., the client agrees to indemnify and hold harmless ENVIRONMENT DESIGN GROUP from any liability arising from acts or omissions in the performance of said services during construction by the client, and his/her agents, employees, or subcontractors.

48 HOURS BEFORE DIGGING
CALL TOLL FREE
1-800-432-4770
SUNSHINE STATE ONE CALL
OF FLORIDA, INC.



The Everglades Club
500 S County Rd
Palm Beach

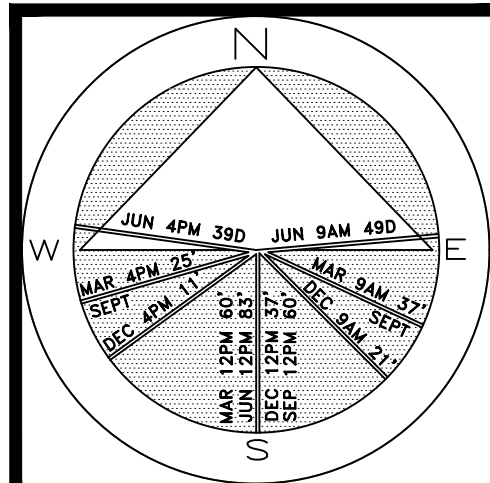

JOB NUMBER: # 24202.00 LA
DRAWN BY: Matt Tollison
DATE: 12.16.2024

SHEET L5.0

Landscape Action Plan

SCALE IN FEET 0' 100' 200' 300'