

# DESIGN PROVIDED BY: DKK CONSULTING, INC.

951 SANSBURY'S WAY, SUITE 206 ♠ ROYAL PALM BEACH, FL 33411

C.O.A. # 26848

PREPARED FOR: EVERGLADES GOLF CLUB/ COMFORT STATION #16

PROJECT NAME: EVERGLADES GOLF CLUB  
356 WORTH AVENUE  
PALM BEACH, FL 33480

PROJECT SCOPE: ENGINEERING DESIGN SERVICES -  
INFRASTRUCTURE MODIFICATIONS,  
CONFORT STATION #16 OSTDS CONVERSION



LOCATION MAP  
NOT TO SCALE

INDEX OF DRAWINGS				
SHEET NO.	SHT NO. IN SET	SHEET TITLE	REV. #	REV. DATE
CVR-1	1 OF 3	COVER SHEET, INDEX OF DWGS	-	-
C-1	2 OF 3	OVERALL MASTER SITE PLAN	-	-
C-2	3 OF 3	OSTDS TO SANITARY SEWER CONVERSION	-	-

ENGINEER OF RECORD:  
DEREK SCHENAVAR  
PROFESSIONAL ENGINEER # : 63858

ARC-24-0137 (ZON-24-0086)  
02/26/25 (ARCOM), 02/12/25 (TC)



NOTE

ALL UTILITIES, INFRASTRUCTURE, SERVICES, ETC, DEPICTED ON THIS PLAN ARE APPROXIMATE IN NATURE AND LOCATION. ALL WORK BEING PERFORMED ON THESE PREMISES IS TO FIELD VERIFY ANY AND ALL ABOVE OR BELOW GROUND ELEMENTS DEPICTED HEREON.

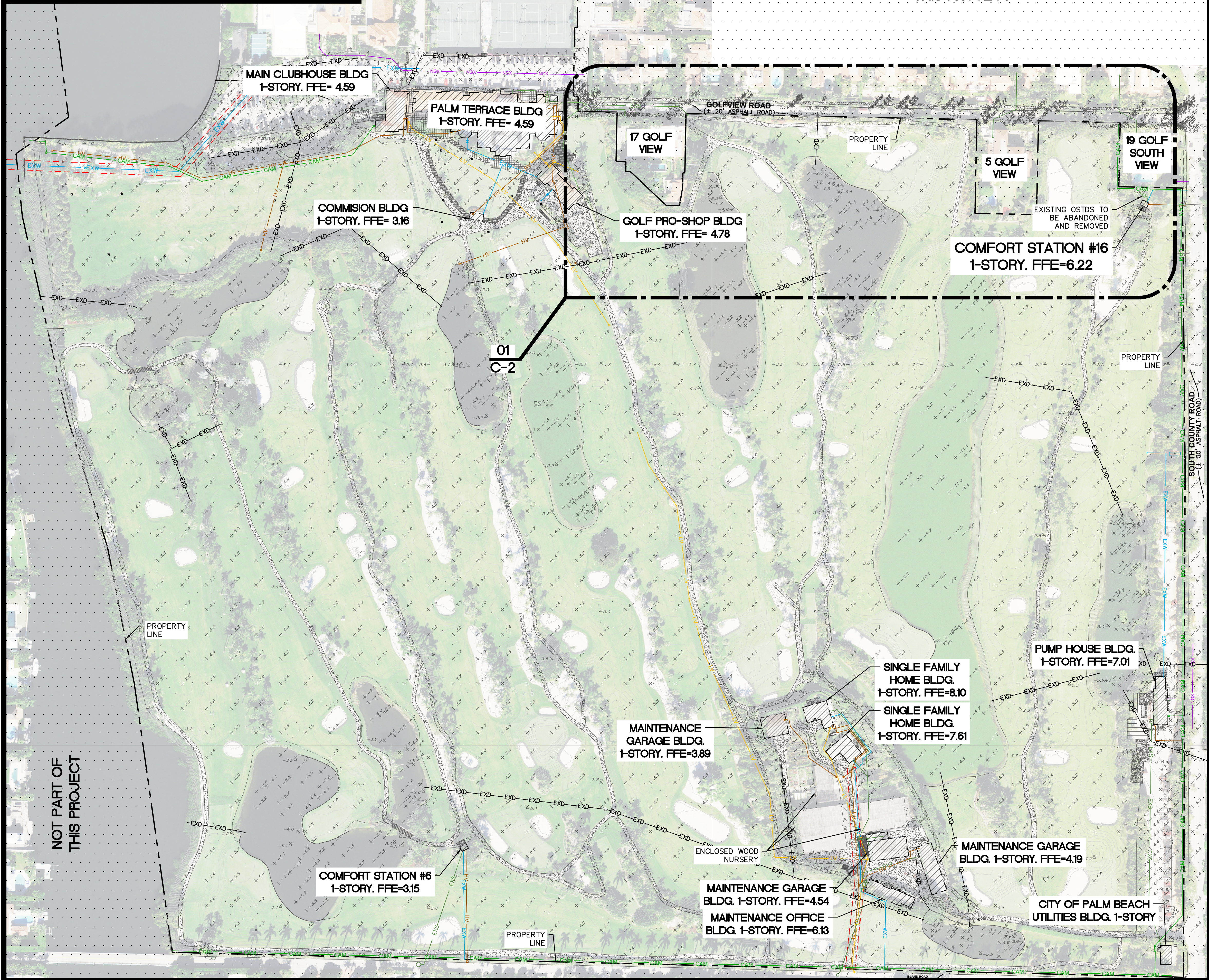

01 OVERALL MASTER SITE PLAN

SCALE: 1"=100'

NOT PART OF  
THIS PROJECT



LOCATION MAP

SCALE: NOT TO SCALE

LEGEND

EXISTING GRADE	(+14.9)
PROPOSED GRADE	(16.0)
TYPICAL	TYP.
EXISTING	EX.
CONCRETE	CONC.
WOOD POWER POLE	WPP.
SANITARY MANHOLE	SM
PLANTER	PL
GROUND	GND
EX. CATCH BASIN	CB
MAILBOX	MB
EX. WATER METER	WM
EX. WATER VALVE	WV
EX. FENCE	---
CORRUGATED ALUMINUM PIPE	CAP
DUCTILE IRON PIPE	DIP
TOP OF PIPE	T.O.P.
ELEVATION	EL.
EX. SANITARY SEWER LINE	EXS
EX. POTABLE WATER LINE	EXW
EX. DRAINAGE/ STORMWATER LINE	EXD
EX. HIGH VOLTAGE LINE	HV
EX. LOW VOLTAGE LINE	LV
EX. CAMERA LINE	CAM
EX. NG LINE	NG
PR. SANITARY SEWER LINE	S
CONCRETE AREA	CONC
PAVER BRICK AREA	PBR
GRAVEL AREA	GRAV
DIVING RANGE PANEL	DR
INTERNET	IT
DRAINAGE STRUCTURE ID	CB
RIM ELEVATION	1.46
INVERT ELEVATIONS	-1.30 N
BOTTOM ELEVATION	B-1.39

GENERAL NOTES

- REGULATIONS - ALL CONSTRUCTION SHALL BE DONE IN A WORKMAN LIKE MANNER AND SHALL CONFORM TO ALL COUNTY, STATE AND FEDERAL REGULATIONS AND OR CODES INCLUDING BUT NOT LIMITED TO THE CURRENT PALM BEACH COUNTY. THE CONTRACTOR SHALL BE RESPONSIBLE FOR OBTAINING ALL PERMITS AND LICENSES TO BEGIN WORK AND PAY ALL REQUIRED FEES ASSOCIATED WITH SAME.
- CHANGES - ALL CHANGES SHALL BE APPROVED IN WRITING BY THE ENGINEER AND THE OWNER PRIOR TO CONSTRUCTION.
- GUARANTEE - THE CONTRACTOR SHALL GUARANTEE ALL WORK AND MATERIAL FOR A PERIOD OF ONE YEAR FROM THE DATE OF PROJECT ACCEPTANCE, DURING WHICH ALL FAULTY CONSTRUCTION AND/OR MATERIAL SHALL BE REPLACED AT THE CONTRACTOR'S EXPENSE.
- SHOP DRAWINGS - THE CONTRACTOR SHALL SUBMIT SHOP DRAWINGS FOR PIPES, STRUCTURES, FRAMES AND GRATES, ETC. TO THE ENGINEER FOR APPROVAL.
- THE CONTRACTOR SHALL SUBMIT ALL RECORD DATA TO THE ENGINEER FOR HIS REVIEW AND APPROVAL.
- IT IS THE CONTRACTOR'S RESPONSIBILITY TO REVIEW ALL DRAWINGS AND SPECIFICATIONS FOR COMPLETENESS AND ACCURACY. FURTHERMORE, THE CONTRACTOR IS TO COORDINATE ALL TRADES AND DISCIPLINES AS REQUIRED. ANY DISCREPANCIES IN PLANS OR SPECIFICATIONS ARE TO BE BROUGHT TO THE ATTENTION OF THE ENGINEER IN WRITING.
- IT IS THE RESPONSIBILITY OF THE CONTRACTOR TO BE FAMILIAR WITH EXISTING SITE CONDITIONS, PERFORM SUBSURFACE INVESTIGATIONS AND VERIFY EXISTING GRADES.
- CONTRACTOR TO VERIFY ALL EXISTING DIMENSIONS, ELEVATIONS AND CONDITIONS PRIOR TO BEGINNING CONSTRUCTION.
- PRIOR TO CONSTRUCTION, THE CONTRACTOR IS TO FIELD LOCATE AND SAFEGUARD ALL EXISTING UTILITIES, STRUCTURES, AND SURVEY MARKERS.
- IF CONDITIONS REQUIRE WORK NOT SHOWN OR NOT VISIBLE ON PLANS, CONTRACTOR IS TO CONTACT ENGINEER PRIOR TO CONTINUING.
- ANY CHANGES TO THE PROPOSED DESIGN CONTAINED HEREIN THESE DRAWINGS SHALL HAVE BEEN REVIEWED AND APPROVED IN WRITING BY THE ENGINEER PRIOR TO COMMENCING WORK ON ITEMS AFFECTED.
- MAINTENANCE OF TRAFFIC - THE CONTRACTOR SHALL MAINTAIN TWO LANE TRAFFIC AT ALL TIMES DURING CONSTRUCTION AND SHALL PROVIDE ALL NECESSARY BARRICADES, LIGHTING, SIGNAGE AND FLAGMAN FOR THE SAFETY OF THE PUBLIC. M.O.T. IN ACCORDANCE WITH F.D.O.T. INDEX SERIES 600.

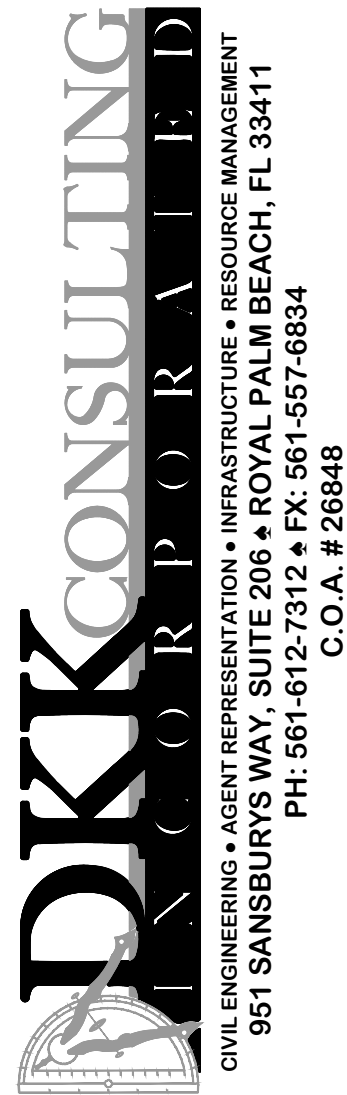

ENGINEER OF RECORD:  
DEREK SCHENAVAR  
PE # 63858

#	DATE	DESCRIPTION

EVERGLADES GOLF CLUB/ COMFORT STATION #16

356 WORTH AVENUE  
PALM BEACH, FL 33480

OVERALL MASTER SITE PLAN

DATE:	12/03/24
SCALE:	AS NOTED
DRAWN BY:	ALG
CHECKED BY:	DHS
PROJECT #:	24-02050.05.01

C-1



ALL UTILITIES, INFRASTRUCTURE, SERVICES, ETC,  
DEPICTED ON THIS PLAN ARE APPROXIMATE IN NATURE  
AND LOCATION. ALL WORK BEING PERFORMED ON THESE  
PREMISES IS TO FIELD VERIFY ANY AND ALL ABOVE OR  
BELOW GROUND ELEMENTS DEPICTED HEREON.

EXISTING GRADE	(+14.9)	EX. SANITARY SEWER LINE	EXS
PROPOSED GRADE	16.0	EX. POTABLE WATER LINE	EXW
TYPICAL	TYP.	EX. DRAINAGE/ STORMWATER LINE	EXD
EXISTING	EX.	EX. HIGH VOLTAGE LINE	HV
CONCRETE	CONC.	EX. LOW VOLTAGE LINE	LV
WOOD POWER POLE	WPP.	EX. CAMERA LINE	CAM
SANITARY MANHOLE	S	EX. NG LINE	NGX
PLANTER	PL	PR. SANITARY SEWER LINE	S
GROUND	GND	CONCRETE AREA	
EX. CATCH BASIN	CB	PAVER BRICK AREA	
MAILBOX	MB	GRAVEL AREA	
EX. WATER METER	WM	DIVING RANGE PANEL	DR.
EX. WATER VALVE	WV	INTERNET	IT.
EX. FENCE	— / — / — / —	DRAINAGE STRUCTURE ID	CB
CORRUGATED ALUMINUM PIPE	CAP	RIM ELEVATION	1.46
DUCTILE IRON PIPE	DIP	INVERT ELEVATIONS	-1.30 N
TOP OF PIPE	T.O.P.	BOTTOM ELEVATION	B-1.39
ELEVATION	EL.		

THE PROPOSED INFRASTRUCTURE MODIFICATIONS FOR COMFORT STATION #16, AS DETAILED IN THESE DRAWINGS, INVOLVE THE CONVERSION OF THE EXISTING GRAVITY-FLOW ON-SITE TREATMENT AND DISPOSAL SYSTEM (OSTDS WHICH WILL BE ABANDONED AND REMOVED) INTO A LIFT STATION THAT WILL DISCHARGE AND CONNECT TO THE ADJACENT EXISTING SANITARY SEWER COLLECTION SYSTEM ON GOLFVIEW ROAD, SPECIFICALLY AT THE EXISTING PLUG.

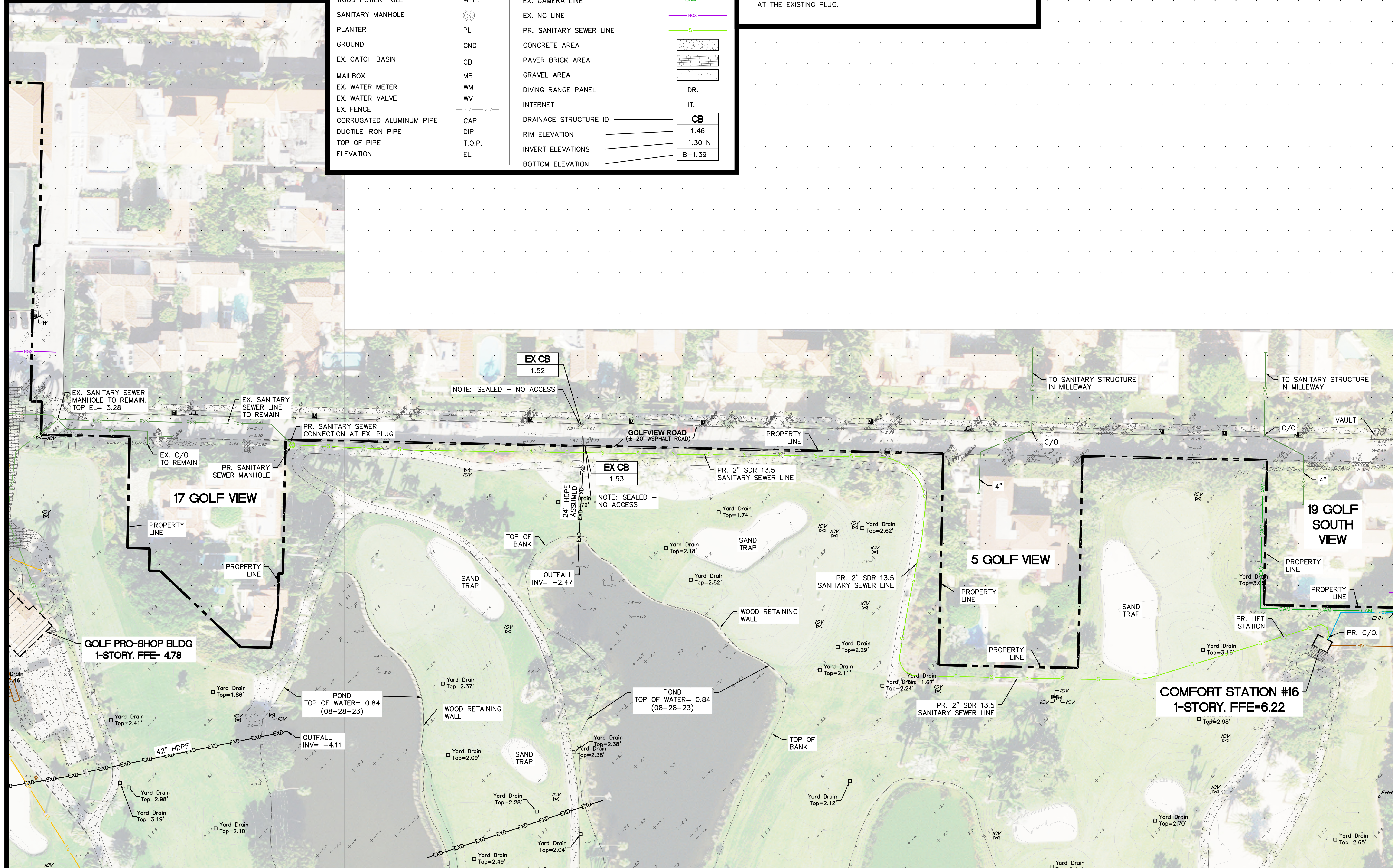

## 01 PROPOSED SANITARY SEWER CONNECTION PLAN

SCALE: 1"=40'

ENGINEER OF RECORD:  
DEREK SCHENAVAR  
PE #: 63858

[illegible]

EVERGLADES GOLF CLUB/ COMFORT STATION #16

356 WORTH AVENUE  
PALM BEACH, FL 33480

## COSTS TO SANITARY SEWER CONVERSION

DATE:	12/03/24
SCALE:	AS NOTED
DRAWN BY:	ALG
CHECKED BY:	DHS
PROJECT #:24-02050.05.01	

C-2