

## MATERIAL LEGEND

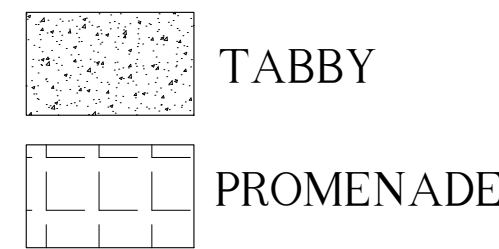

### FOUNTAIN / POND NOTES:

- ALL TILE AND STONE TILE ARE DECORATIVE ONLY. SHELL MUST BE IMPERMEABLE PRIOR TO INSTALLATION OF FINISH MATERIAL. ALL MASONRY MATERIAL SHALL BE COMPATIBLE WITH FOUNTAIN / POND CONDITIONS.
- ALL DRAWINGS TO BE ENGINEERED. ENGINEER DRAWINGS PREVAIL FOR CONSTRUCTION.
- CONFIRM OVERFLOW VALVE TYPE (MANUAL OR AUTOMATIC) WITH SMI PRIOR TO INSTALLATION.
- ALL GROUT COLORS TO BE SELECTED BY SMI & APPROVED BY OWNER.
- ENGINEER DWGS. MUST BE PRESENTED TO SMI FOR REVIEW OF OVERALL AESTHETIC DESIGN INTENT.
- CONTRACTOR TO VERIFY ALL DIMENSIONS, LOCATION, & SET BACKS PRIOR TO CONSTRUCTION.
- CONSTRUCTION TO COMPLY WITH ALL APPLICABLE STATE & LOCAL CODES WHETHER INDICATED HERE OR NOT. WHERE COMPLIANCE REQUIRES SUBSTANTIAL DEVIATION FROM THE DESIGN INTENT, AS SHOWN ON THE CONTRACT DRAWINGS, MODIFICATIONS MUST BE REVIEWED BY THE SMI.
- OBTAIN NECESSARY SUB-SURFACE INFORMATION. EXCAVATE & REMOVE ALL MUCK & OTHER UNACCEPTABLE MATERIAL & REPLACE W/ GOOD CLEAN STRUCTURALLY SOUND FILL MATERIAL. PROVIDE DE-WATERING AS NECESSARY.
- OBTAIN ALL NECESSARY PERMITS AS PER STATE & LOCAL CODES.
- INFORMATION SHOWN IS SCHEMATIC IN NATURE. ALL EQUIPMENT TO BE INSTALLED AS PER MANUFACTURERS SPECIFICATIONS. FOUNTAIN / POND STRUCTURE & ALL EQUIPMENT SHALL BE WARRANTED UNDER CONTRACTORS WARRANTY FOR ONE FULL YEAR FOR PARTS & LABOR.
- TO BE INSTALLED BY LOCAL & STATE LICENSED POOL CONTRACTOR.
- PROVIDE OPERATION AND MAINTENANCE MANUALS TO OWNER UPON COMPLETION OF WORK & ACCEPTANCE BY OWNER.
- ALL EQUIPMENT AND EXPOSED PIPING SHALL BE CLEARLY LABELED W/ PERTINENT DATA SUCH AS, BUT NOT LIMITED TO: PUMP & FILTER SPECIFICATIONS, PIPE SIZE, USE & FLOW DIRECTION, ETC.
- ALL EXPOSED PIPING SHALL BE COPPER (NO EXPOSED PVC PIPES).
- LOCATE PUMP AND ALL MECHANICAL EQUIPMENT PER OWNERS DIRECTION.
- LOCATE CONTROLS FOR LIGHTS, AND FOUNTAINS INSIDE HOUSE PER OWNERS DIRECTION.
- PITCH FLOOR OF BASIN TO DRAIN.
- OVERFLOW DRAIN BY CONTRACTOR TO BE APPROVED BY SMI.
- CONTRACTOR TO INSTALL WATER LEVELER.
- INSTALL ADJUSTMENT VALVE IN VISIBLE LOCATION.

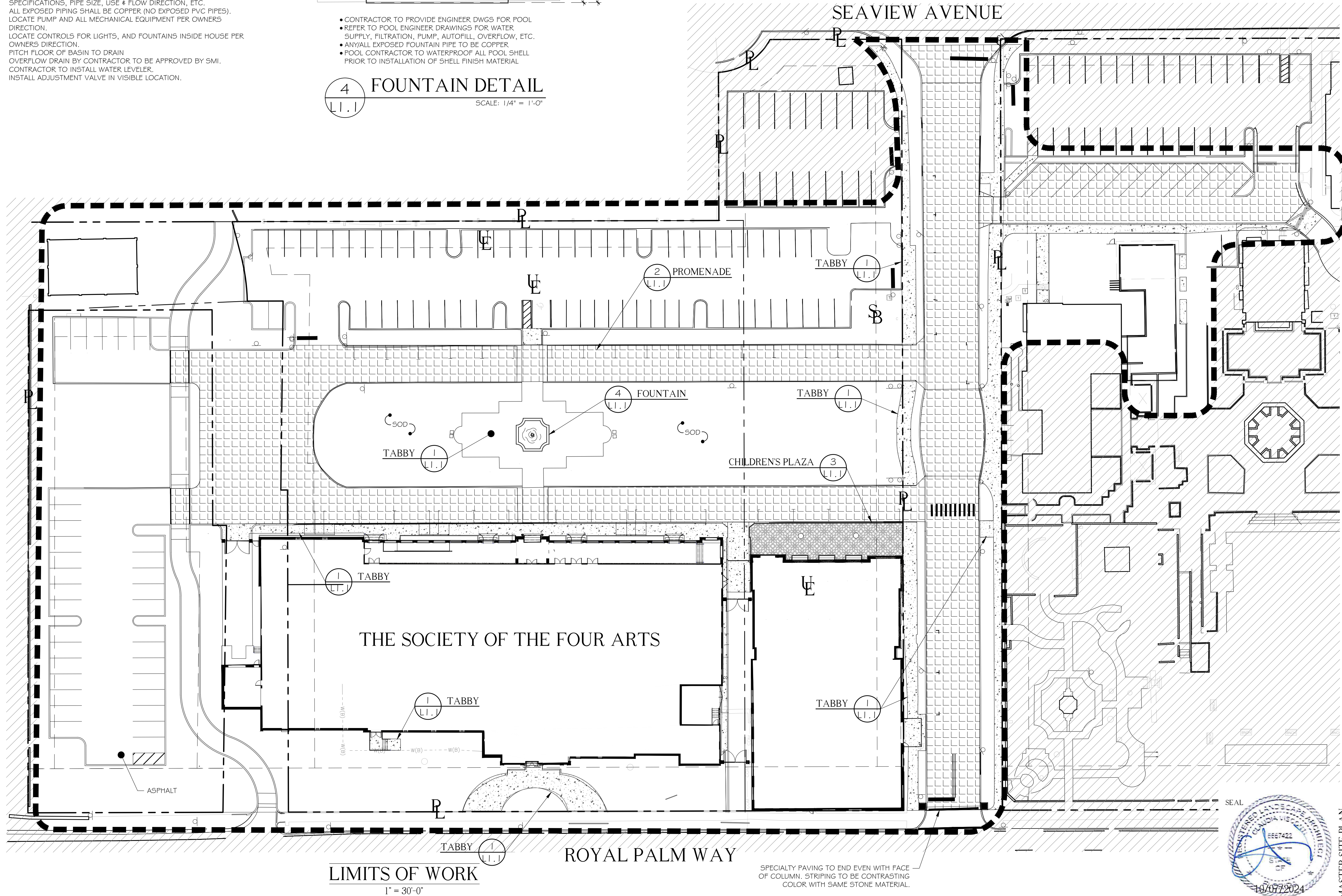
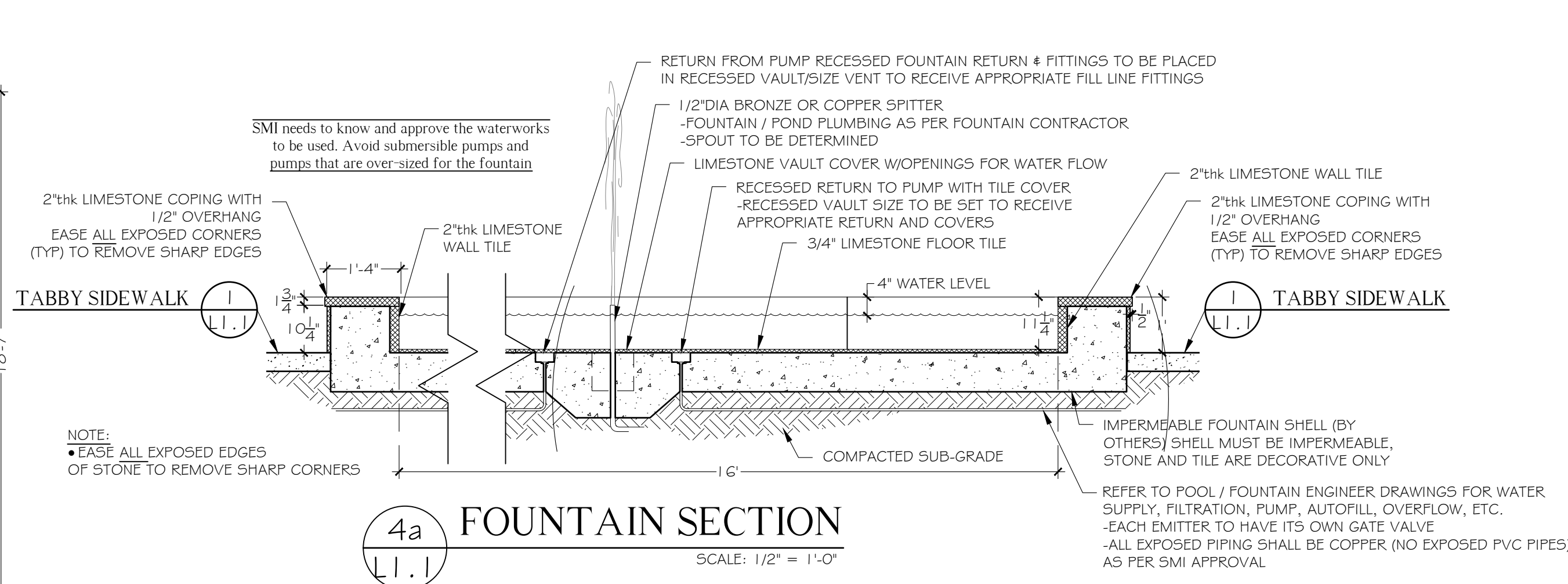
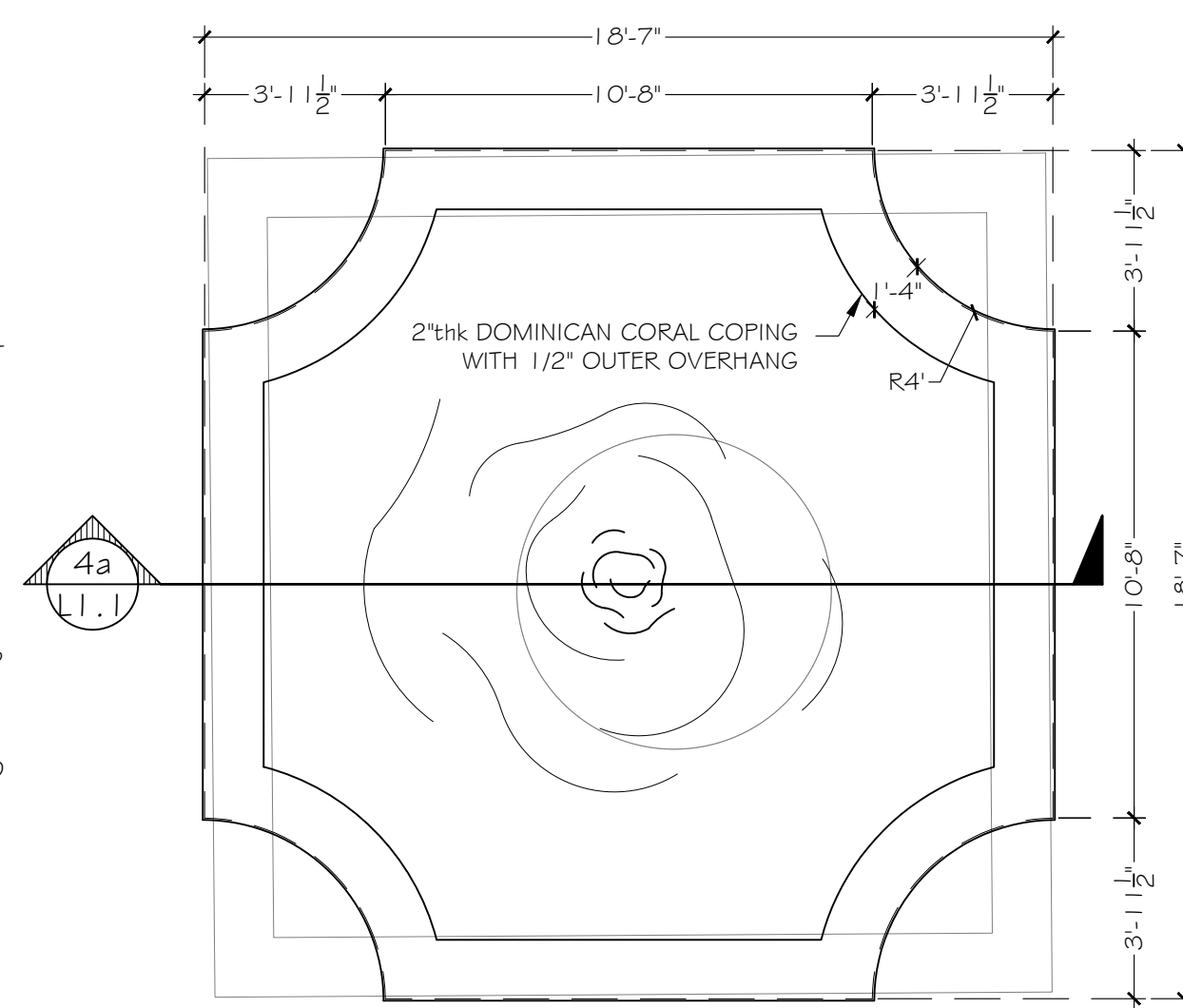

**The Society of the Four Arts**

100 Four Arts Plaza, Palm Beach, FL 33480

THESE DRAWINGS ARE FOR THE EXCLUSIVE USE OF SPINA OROURKE + PARTNERS, INC. AND MAY NOT BE DUPLICATED, REPRODUCED OR USED IN ANY MANNER WITHOUT THE EXPRESS WRITTEN CONSENT OF SPINA OROURKE + PARTNERS, INC. ALL RIGHTS RESERVED.

Revisions

Project no: 2953  
Date: 2024.10.07  
Drawn by: VD  
Project Manager: CFV

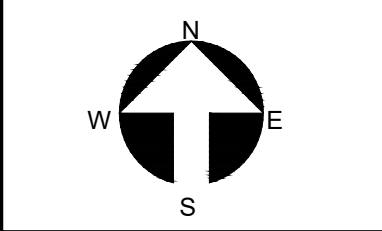

**L1.1**

Final Submittal

**SPINA OROURKE**

**BEYER BLINDER BELLE**

285 Banyan Blvd  
West Palm Beach, Florida 33401  
561.684.6844 • Fax: 561.684.6504  
spinaorourke.com  
FL Lic # A23002399

**SMI**

LANDSCAPE ARCHITECTURE  
140 Royal Palm Way, Suite 200, Palm Beach, Florida 33480  
561.684.6844 • Fax: 561.684.6504  
smiarchitect.com  
FL registration # LA 13000223

Architecture • Interior Design  
Keith M. Spina # AR15419



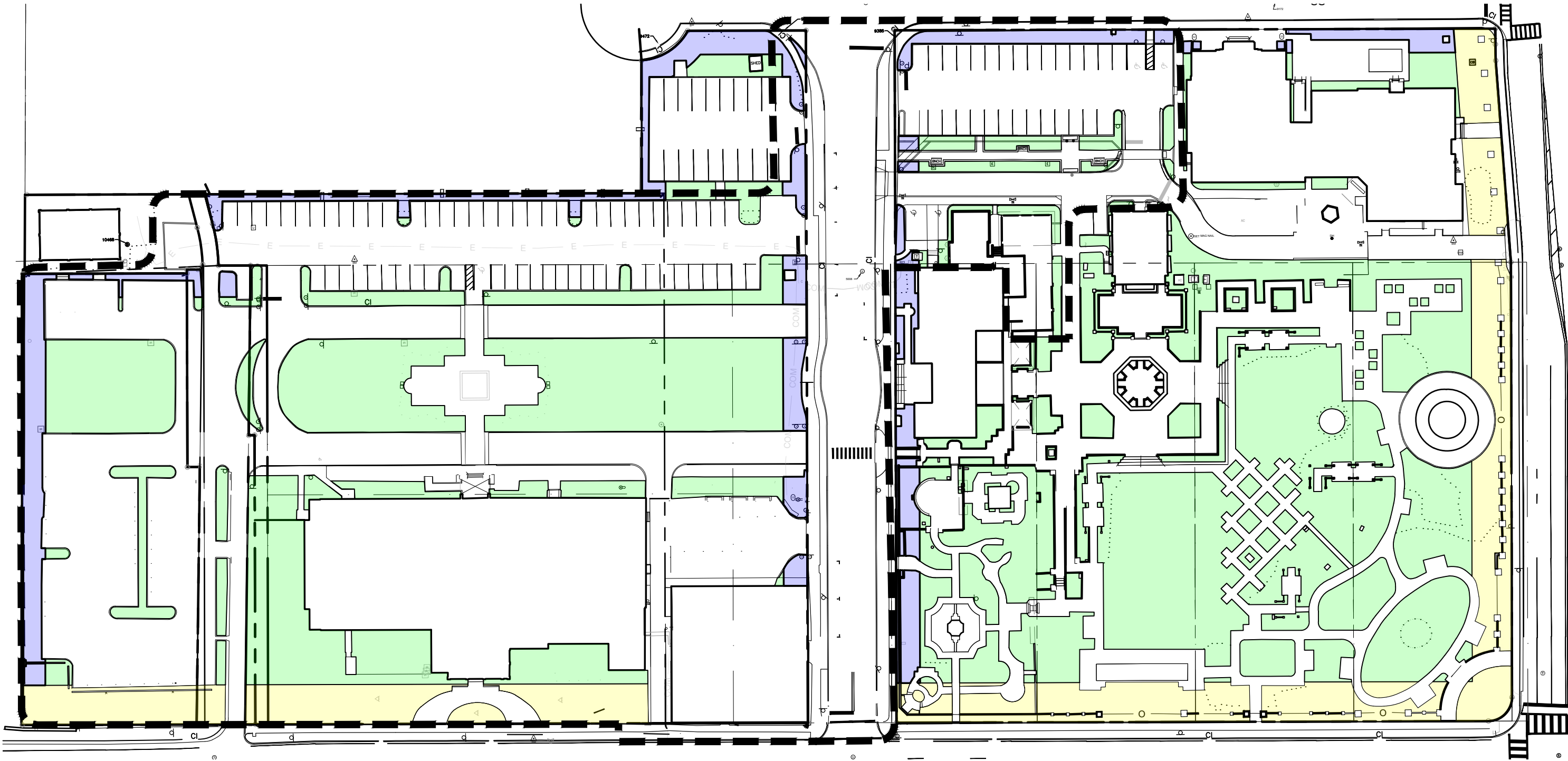

EXISTING SITE PLAN

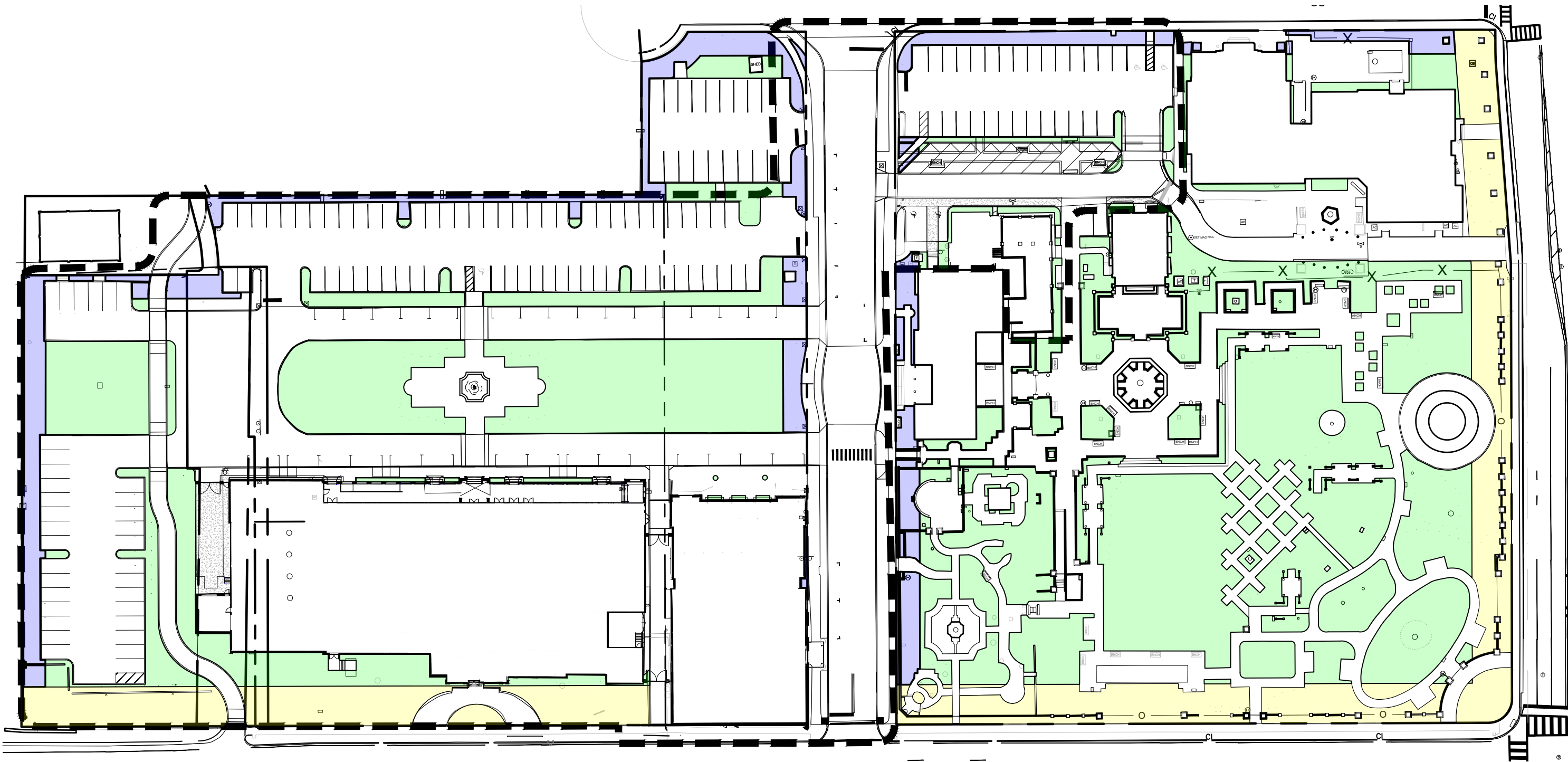

PROPOSED SITE PLAN

Pervious

Front Yard Pervious

Perimeter Pervious

Area Calculations (RB): Campus

All units in square feet, unless noted otherwise

	Existing	Proposed
Overall Site:	339,840 (100%)	339,840 (100%)
Building:	46,678 (14%)	61,699 (18%)
Impervious/paving/Structures	159,574 (47%)	153,962 (45%)
Landscape open space	133,588 (39%)	124,179 (37%)
Required landscape open space is 50% (339,840 x .50 = 169,920 sf required Overall Site)		
Front Yard	N/A	
No front yard exists within limits of work		

- ABBREVIATIONS KEY
- DIA = Diameter

DR = Dominican Republic

HS = HardScape

HT = Height

LA = Landscape Architect

LS = LandScape

MAX = MAXimum

MIN = MINimum

SMI = SMI Landscape Architecture

TBD = To Be Determined

TC = Terra Cotta

THK = THick

TYP = TYPical
- GRADING

BOS = Bottom Of Steps

ELEV = ELEVation

FFE = Finished Floor Elevation

TOS = Top Of Steps

TOW = Top Of Wall



SITE COMPARISON PLAN

L-1.1a

NTS  
Final Submittal

Project no: 2953  
Date: 2024.10.07  
Drawn by: VD  
Project Manager: CFV

Revisions

THESE DRAWINGS ARE FOR THE EXCLUSIVE USE OF SPINA OROURKE + PARTNERS, INC. AND MAY NOT BE DUPLICATED, REPRODUCED OR USED IN ANY MANNER WITHOUT THE EXPRESS WRITTEN CONSENT OF SPINA OROURKE + PARTNERS, INC. ALL RIGHTS RESERVED.

The Society of the Four Arts

100 Four Arts Plaza, Palm Beach, FL 33480



SPINA OROURKE + PARTNERS, INC.

285 Banyan Blvd  
West Palm Beach, Florida 33401  
561.684.6844 • Fax 561.684.5504  
spinaorourke.com  
FL Lic #A23002399

BEYER BLINDER BELLE

120 Broadway  
20th Floor  
New York, NY 10271  
212.777.7800  
beyerblinderbelle.com

SMI LANDSCAPE ARCHITECTURE

140 Royal Palm Way, Suite 200A  
Palm Beach, Florida 33480  
561.684.6844  
smi-landscape.com  
FL Registration #LA 1300223

Architecture • Interior Design

Keith W. Spina #AR13419



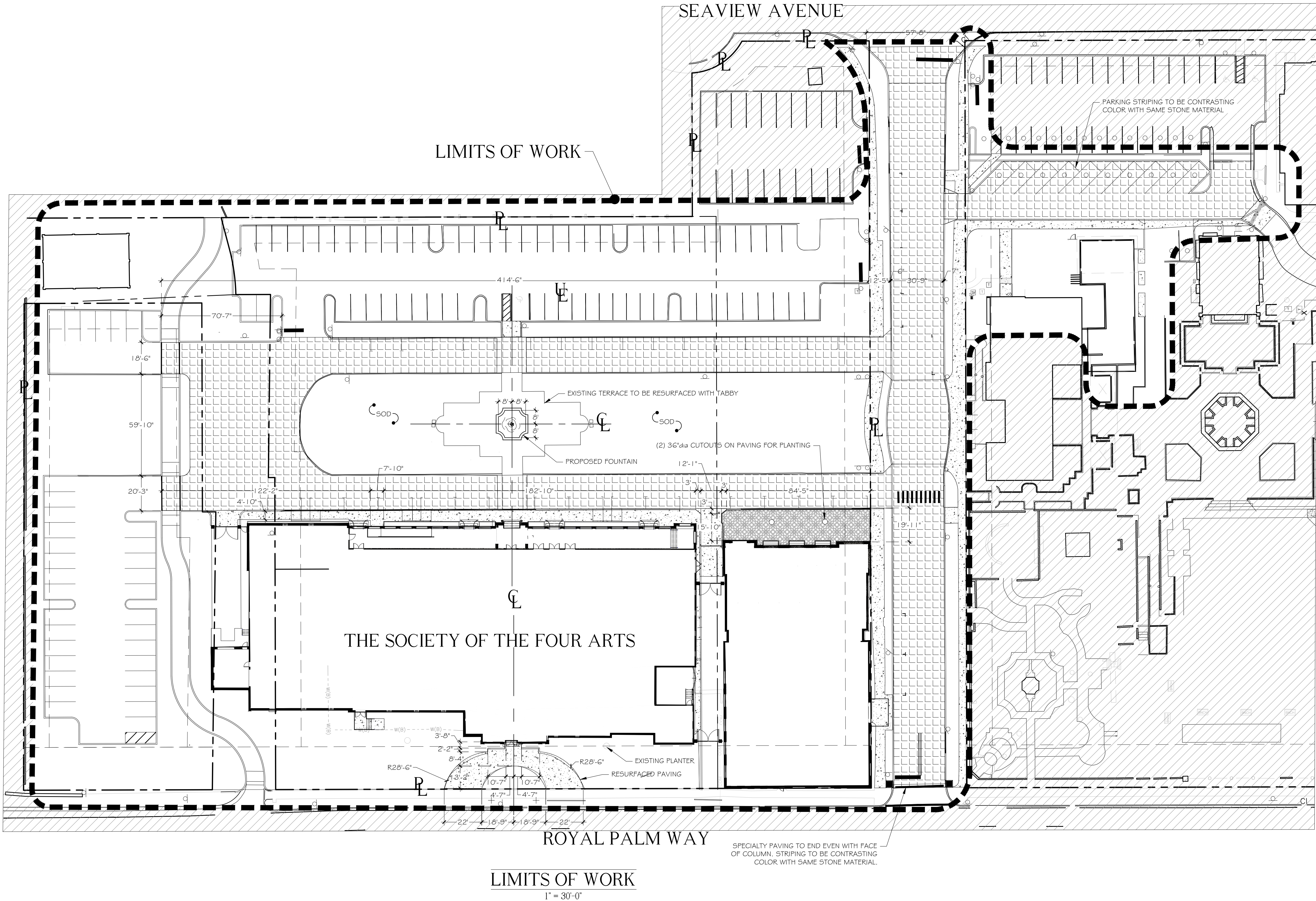

ABBREVIATIONS KEY  
DIA = DIAMETER  
DR = DOMINICAN REPUBLIC  
HS = HARDSCAPE  
HT = HEIGHT  
LA = LANDSCAPE ARCHITECT  
LS = LANDSCAPE  
MAX = MAXIMUM  
MIN = MINIMUM  
SMI = SMI LANDSCAPE ARCHITECTURE  
TBD = TO BE DETERMINED  
TC = TERRA COTTA  
THK = THICK  
TYP = TYPICAL

GRADING  
DOS = BOTTOM OF STEPS  
ELEV = ELEVATION  
FFE = FINISHED FLOOR ELEVATION  
TOS = TOP OF STEPS  
TOW = TOP OF WALL

SMI TO APPROVE LAYOUT OF  
ALL HARDSCAPE MATERIAL  
PRIOR TO INSTALLATION

Survey By: Keith Surveying Job # 13223.00

BEYER BLINDER BELLE SMI  
LANDSCAPE ARCHITECTURE  
140 Royal Palm Way, Suite 200 Palm Beach, Florida 33480  
Phone: (561) 684-5504  
Fax: (561) 684-5504  
beyerblinderbelle.com  
FL Lic # A23802299

285 Banyan Blvd  
West Palm Beach, Florida 33401  
561.684.6844 • Fax 561.684.5504  
spinaorourke.com  
FL Lic # A23802299

SPINAOROURKE + PARTNERS  
Architecture • Interior Design  
Keith M. Spina # AR15419

The Society of the Four Arts  
100 Four Arts Plaza, Palm Beach, FL 33480

THESE DRAWINGS ARE FOR THE  
EXCLUSIVE USE OF SPINA OROURKE +  
PARTNERS, INC. AND MAY NOT BE  
DUPLICATED, REPRODUCED OR USED  
IN ANY MANNER WITHOUT THE  
EXPRESS WRITTEN CONSENT OF SPINA  
OROURKE + PARTNERS, INC. ALL  
RIGHTS RESERVED.

Revisions

Project no: 2953  
Date: 2024.10.07  
Drawn by: VD  
Project Manager: CFV

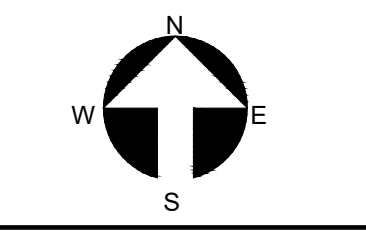

L1.2  
Final Submittal



SITE PLAN LAYOUT



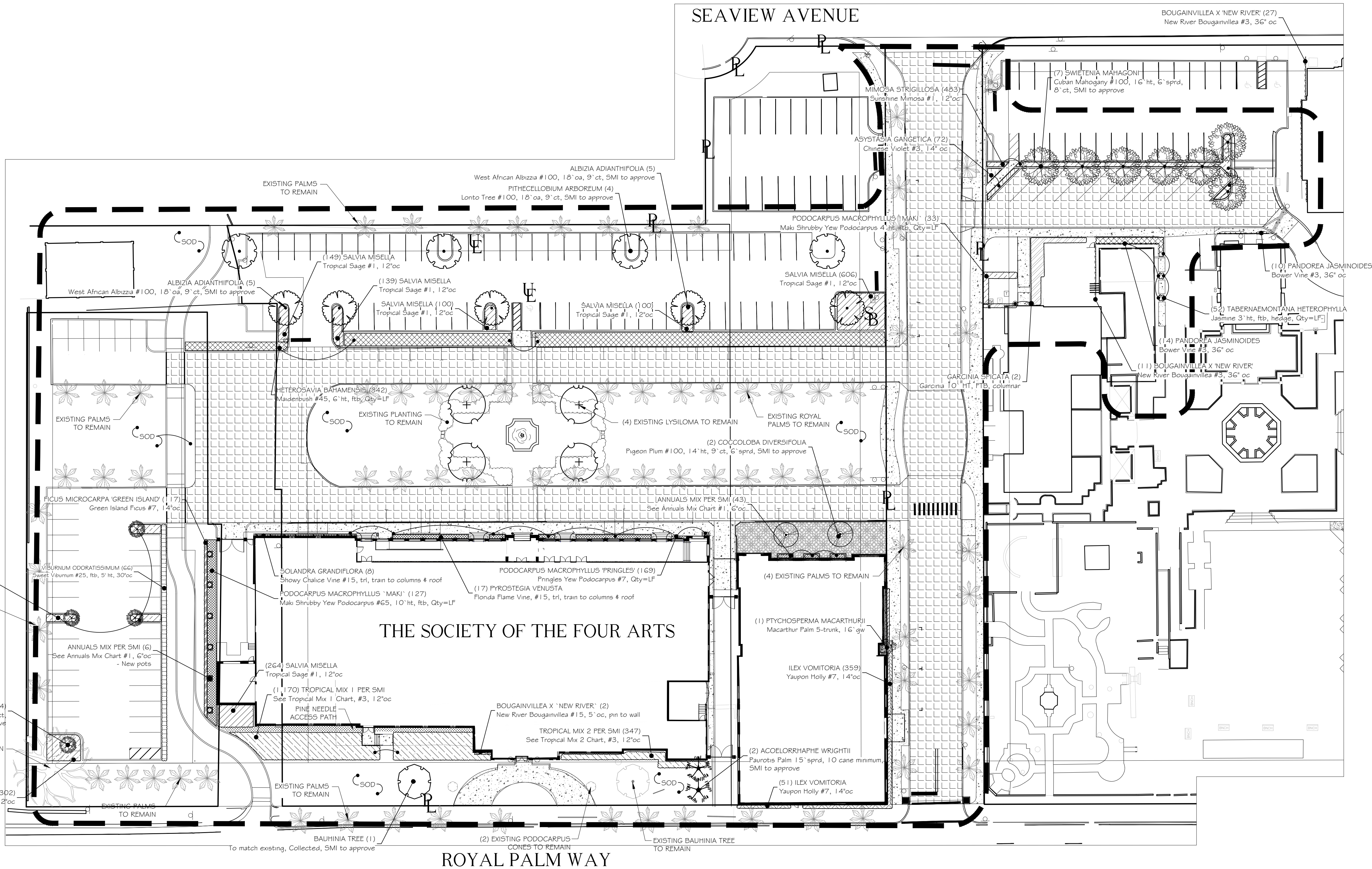

SEE SHEET D-3 FOR EXISTING (NUMBERED) TREES LIST AND DISPOSITION

SMI TO APPROVE STAKED LAYOUT OF ALL TREES AND PLANTING LAYOUT PRIOR TO INSTALLATION

ALL IRRIGATION, IRRIGATION EQUIPMENT AND IRRIGATION BOXES TO BE CONCEALED

ALL PLANTING BEDS ABUTTING LAWN TO HAVE METAL EDGE BORDER

SEAL

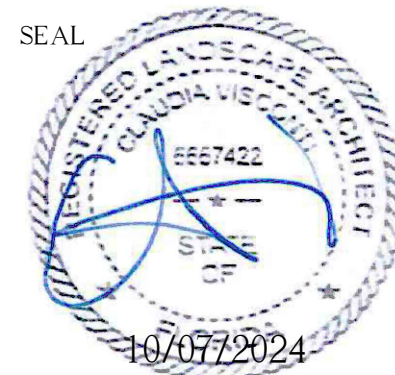

PLANTING PLAN

The Society of the Four Arts

100 Four Arts Plaza, Palm Beach, FL 33480

THESE DRAWINGS ARE FOR THE EXCLUSIVE USE OF SPINA OROURKE + PARTNERS, INC. AND MAY NOT BE REPRODUCED OR COPIED IN ANY MANNER WITHOUT THE EXPRESS WRITTEN CONSENT OF SPINA OROURKE + PARTNERS, INC. ALL RIGHTS RESERVED.

Revisions

Project no: 2953  
Date: 2024.10.07  
Drawn by: VD  
Project Manager: CFV

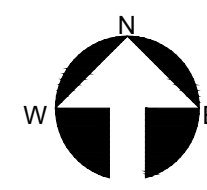

L2.1

1" = 30'-0"  
Final Submittal



SPINA OROURKE  
ARCHITECTS

285 Banyan Blvd  
West Palm Beach, Florida 33401

BEYER BLINDER BELLE  
SMI

120 Broadway  
20th Floor  
New York, NY 10271  
212 777 7800  
beyerblinderbelle.com

Architecture • Interior Design

Keith M. Spina #AR15419

LANDSCAPE ARCHITECTURE  
140 Royal Palm Way, Suite 200 Palm Beach, Florida 33480  
P.O. Box 100000  
West Palm Beach, FL 33408  
FL Registration #LA 13000223



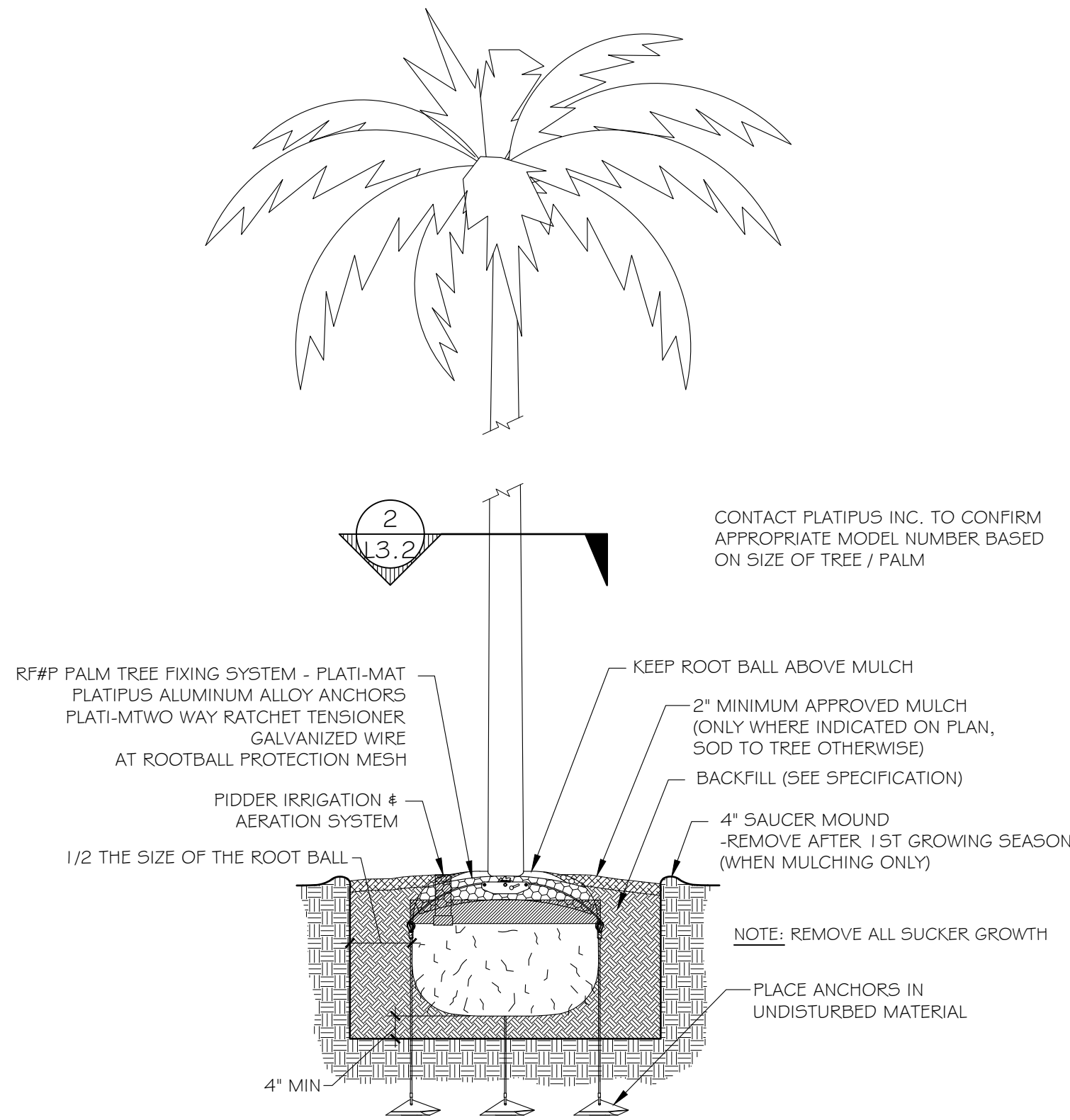

1  
L3.2  
PLATIPUS TREE ANCHORING  
DETAIL  
SCALE: NOT TO SCALE

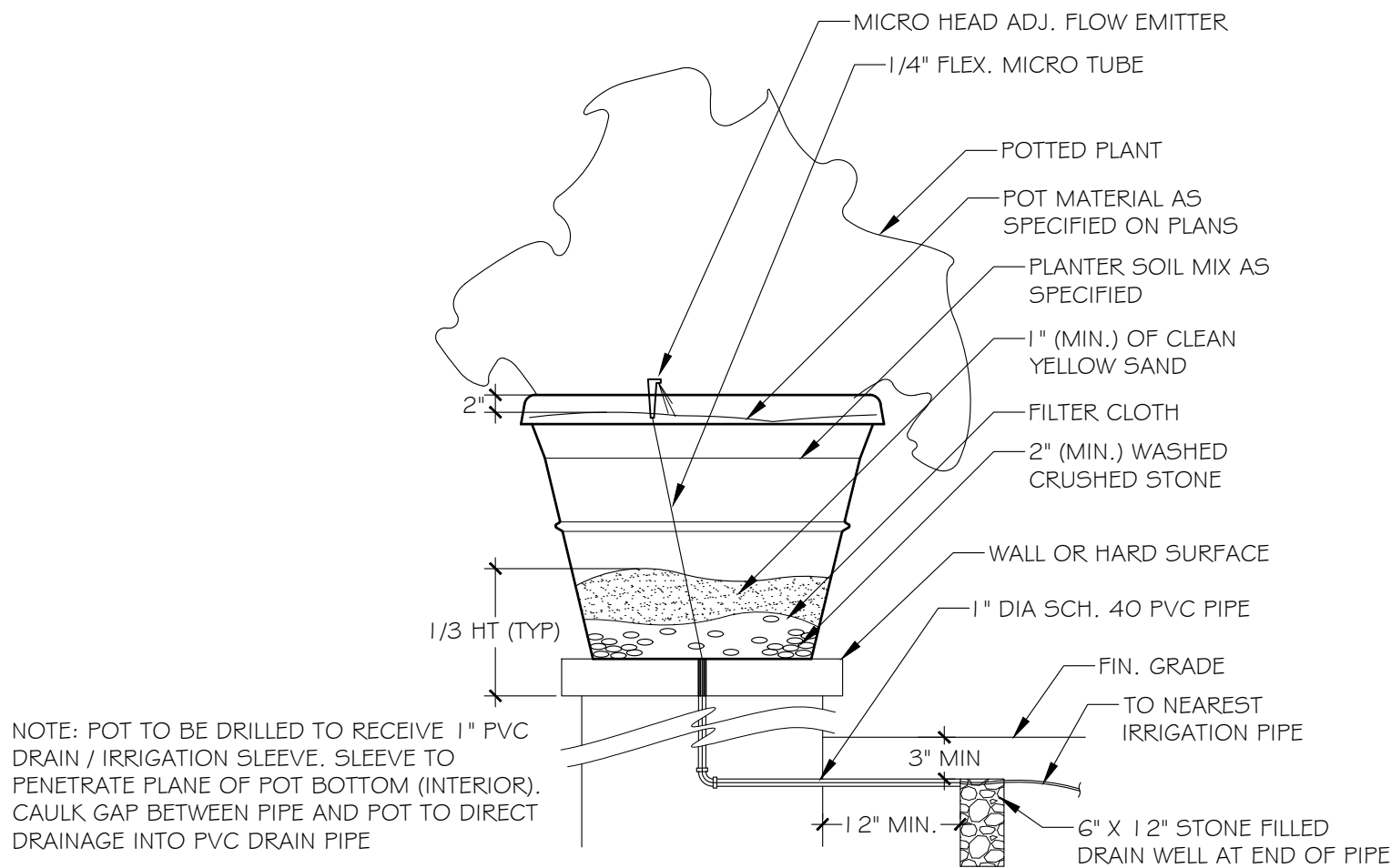

4  
L3.2  
POTTED PLANT DETAIL  
SCALE: NOT TO SCALE

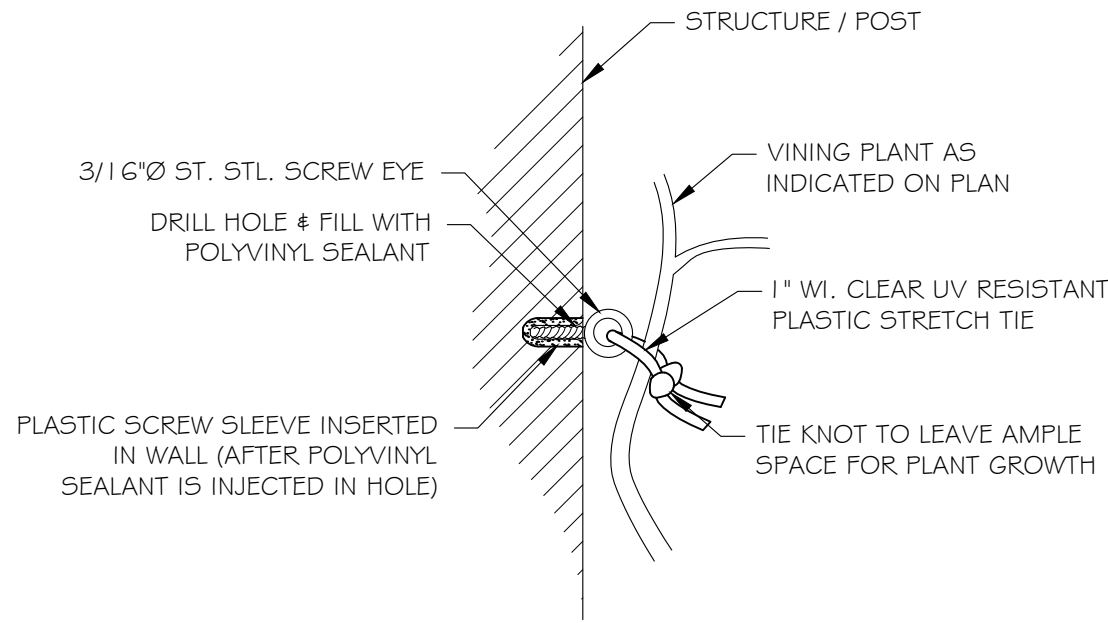

## PIN TO WALL

7  
L3.2  
VINE SUPPORT DETAIL  
SCALE: NOT TO SCALE

SMI TO APPROVE STAKED LAYOUT OF ALL TREES  
AND PLANTING LAYOUT PRIOR TO INSTALLATION

ALL IRRIGATION, IRRIGATION EQUIPMENT AND  
IRRIGATION BOXES TO BE CONCEALED

ALL PLANTING BEDS ABUTTING LAWN  
TO HAVE METAL EDGE BORDER

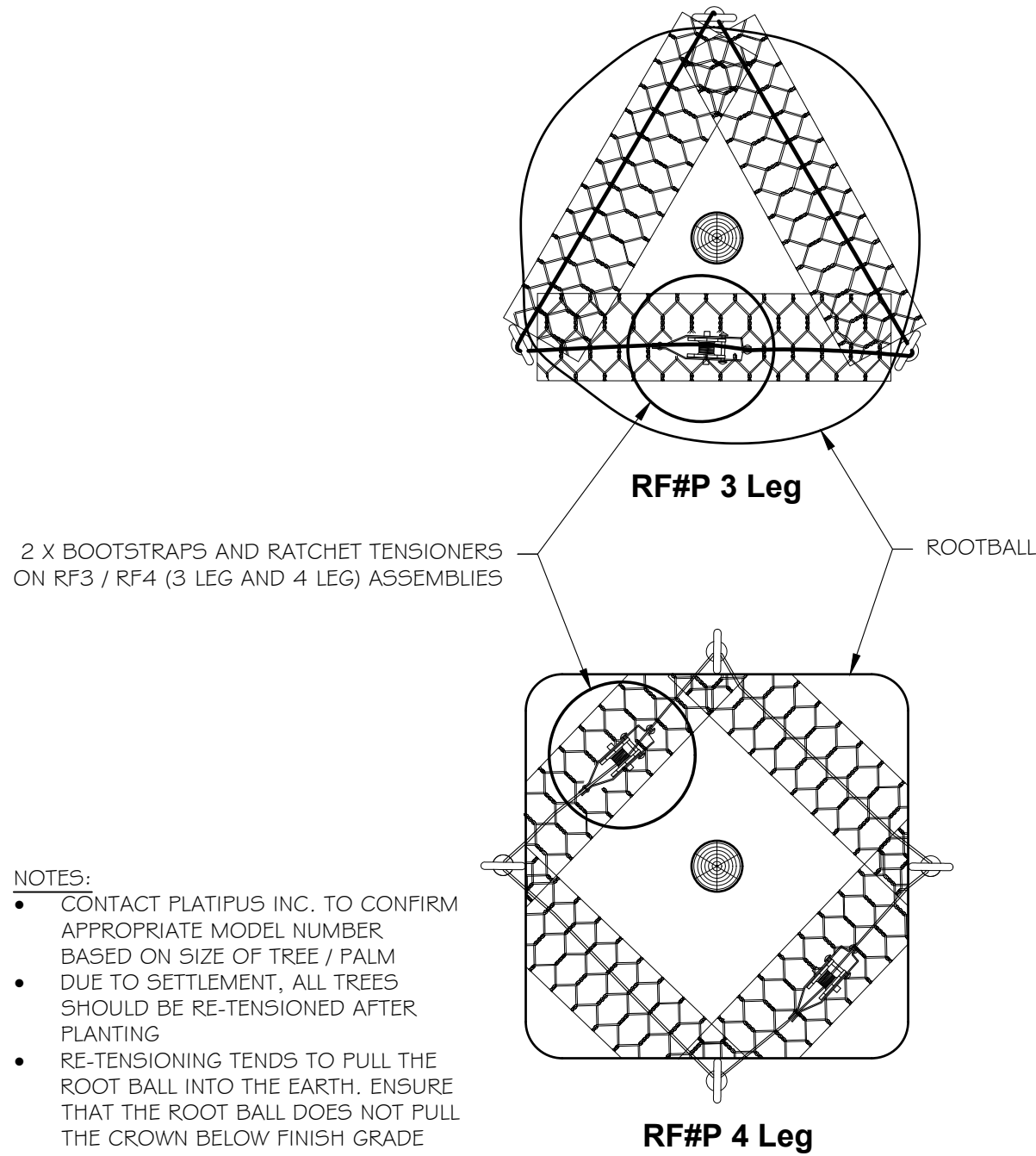

- NOTES:
- CONTACT PLATIPUS INC. TO CONFIRM APPROPRIATE MODEL NUMBER BASED ON SIZE OF TREE / PALM
  - DUE TO SETTLEMENT, ALL TREES SHOULD BE RE-TENSIONED AFTER PLANTING
  - RE-TENSIONING TENDS TO PULL THE ROOT BALL INTO THE EARTH, ENSURE THAT THE ROOT BALL DOES NOT PULL THE CROWN BELOW FINISH GRADE

2  
L3.2  
PLATIPUS ROOTBALL BOOTSTRAP  
DETAIL  
SCALE: NOT TO SCALE

ALL SOD PLANTED BETWEEN STONE TO BE  
CASHMERE ZOYSIA REGARDLESS OF  
OVERALL SITE SOD TYPE

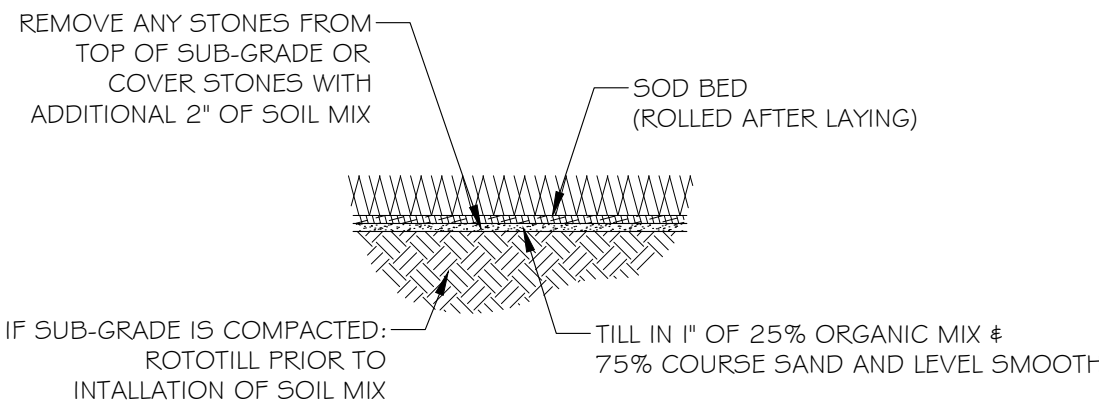

5  
L3.2  
SOD PLANTING DETAIL  
SCALE: 1/2\"/>

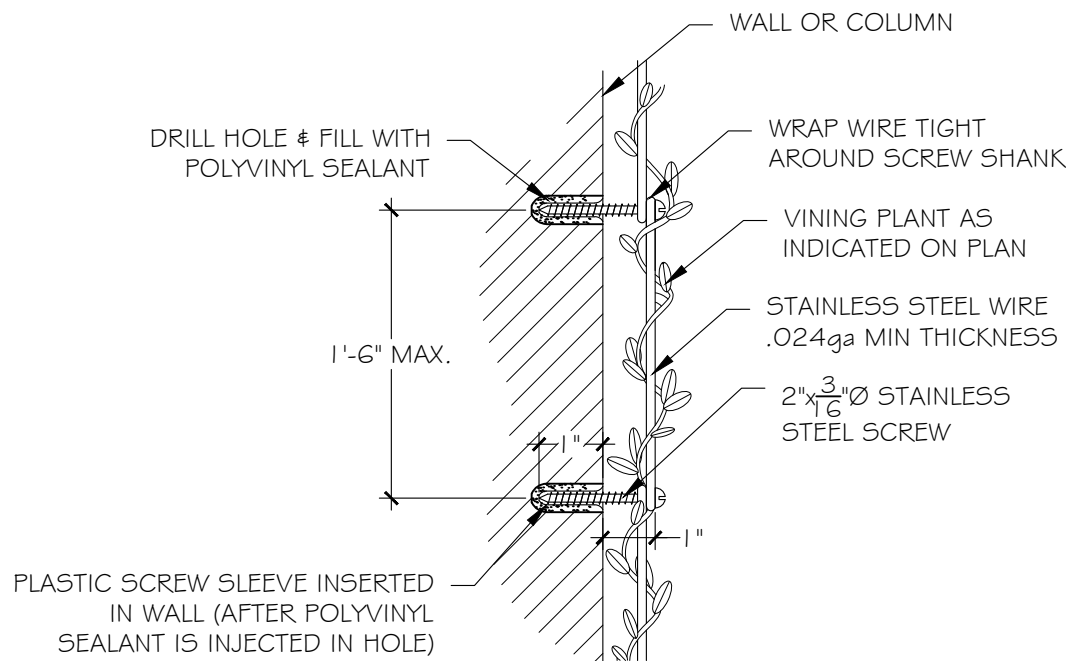

## WIRE TO WALL

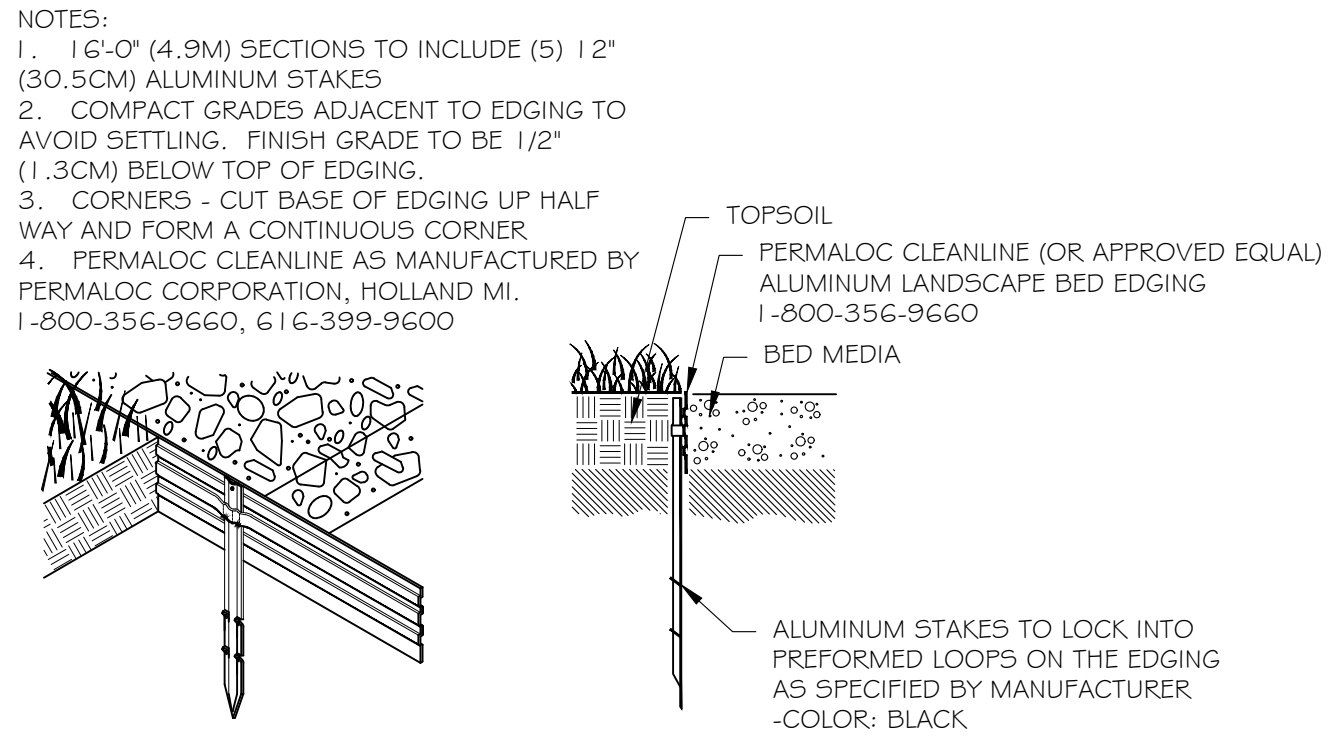

- NOTES:
- 1 1/2\"/>

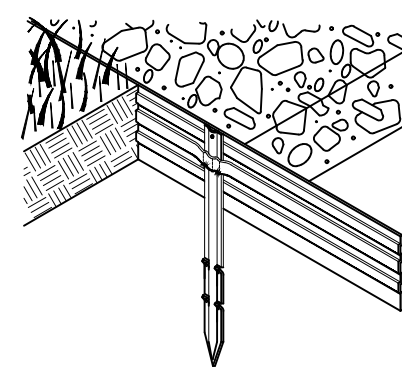

8  
L3.2  
PLANT BED EDGING DETAIL  
SCALE: NTS

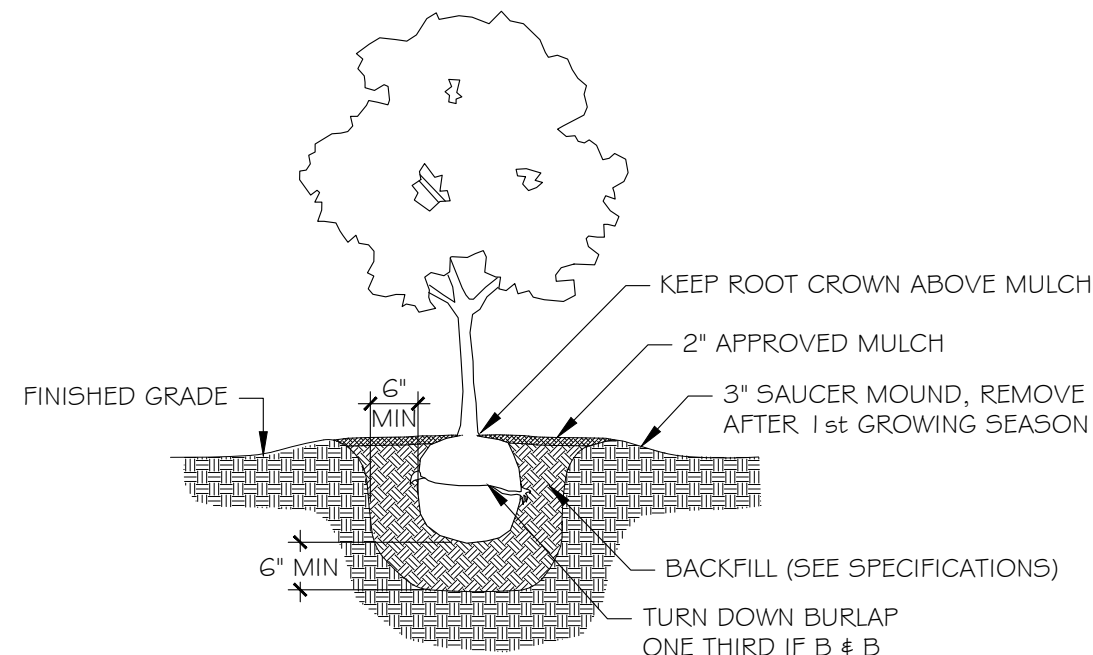

3  
L3.2  
SHRUB PLANTING DETAIL  
SCALE: NOT TO SCALE

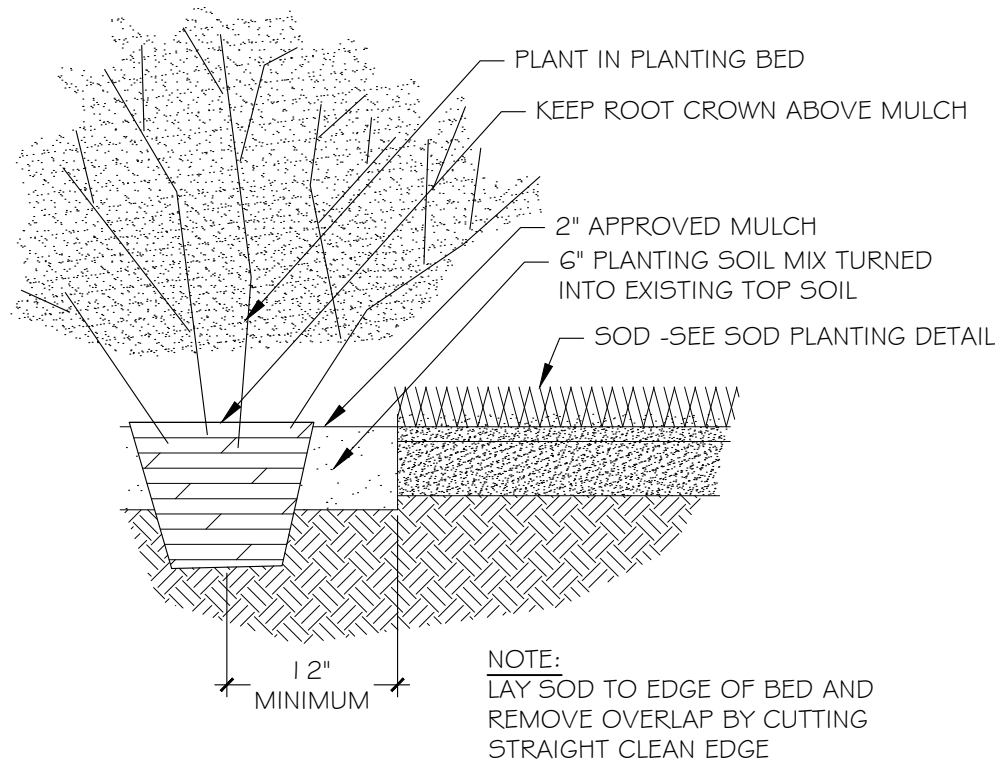

6  
L3.2  
PLANTING BED DETAIL  
SCALE: NOT TO SCALE

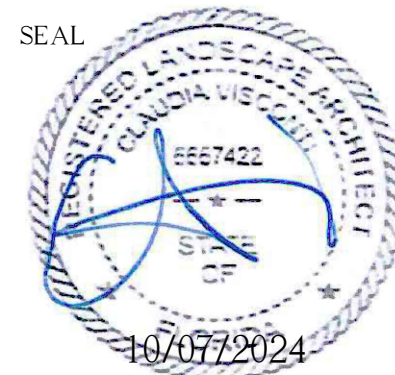

PLANTING DETAILS

L2.2

N.T.S.  
Final Submittal



## PLANTING SPECIFICATIONS

PLEASE FURNISH FLORIDA CERTIFIED LANDSCAPE CONTACTORS (FCLC) REGISTRATION NUMBER WITH PROPOSAL.

### GENERAL CONDITIONS

#### SCOPE:

1. THE WORK INCLUDED IN THESE SPECIFICATIONS SHALL CONSIST OF THE FURNISHING OF ALL LABOR, TOOLS, MATERIALS, PERMITS, ETC., NECESSARY FOR THE EXECUTION OF THE WORK AS HEREIN SPECIFIED AND SHOWN ON THE DRAWINGS.

2. THE LANDSCAPE CONTRACTOR SHALL INSTALL ALL MATERIAL IN ACCORDANCE WITH SOUND NURSERY PRACTICE AND SHALL PERFORM MAINTENANCE AND WATERING UNTIL FINAL COMPLETION AND ACCEPTANCE BY THE LANDSCAPE ARCHITECT.

#### EXAMINATION OF DRAWINGS AND SITE:

1. THE LANDSCAPE CONTRACTOR SHALL EXAMINE THE SITE AND FULLY ACQUAINT HIMSELF WITH ALL OF THE EXISTING CONDITIONS IN ORDER THAT NO MISUNDERSTANDING MAY AFTERWARDS ARISE AS TO THE CHARACTER OR AS TO THE EXTENT OF THE WORK TO BE DONE, AND LIKEWISE, IN ORDER TO ADVISE AND ACQUAINT HIMSELF WITH ALL PRECAUTIONS TO BE TAKEN IN ORDER TO AVOID INJURY TO PERSONS OR PROPERTY OF ANOTHER. NO ADDITIONAL COMPENSATION WILL BE GRANTED BECAUSE OF ANY UNUSUAL DIFFICULTIES THAT MAY BE ENCOUNTERED IN THE EXECUTION OR MAINTENANCE OF ANY PORTION OF THE WORK. ANY DISCREPANCIES, OR OMISSIONS OR DOUBTS AS TO MEANING SHALL BE COMMUNICATED TO THE LANDSCAPE ARCHITECT, WHO WILL MAKE ANY INTERPRETATIONS HE/SHE DEEMS NECESSARY.

#### PLANT LIST:

1. ANY DISCREPANCY BETWEEN THE PLANT LIST AND THE DRAWINGS SHALL BE CONSIDERED AS CORRECT ON THE DRAWINGS.

#### PROTECTION OF PUBLIC AND PROPERTY:

1. THE LANDSCAPE CONTRACTOR SHALL PROTECT ALL MATERIALS AND WORK AGAINST INJURY FROM ANY CAUSE AND SHALL PROVIDE AND MAINTAIN ALL NECESSARY GUARDS FOR THE PROTECTION OF THE PUBLIC. HE SHALL BE HELD RESPONSIBLE FOR ANY DAMAGE OR INJURY TO A PERSON OR PROPERTY WHICH MAY OCCUR AS A RESULT OF HIS FAULT OR NEGLIGENCE IN THE EXECUTION OF THE WORK.

2. THE LANDSCAPE CONTRACTOR SHALL MAINTAIN WORKMAN'S COMPENSATION, COMPREHENSIVE GENERAL LIABILITY INSURANCE (\$1,000,000) AND PROPERTY DAMAGE INSURANCE (\$1,000,000.00). A COPY OF THE CERTIFICATE OF INSURANCE MUST BE FURNISHED TO OWNER.

#### GUARANTEE:

1. THE GUARANTEE PERIOD FOR ALL MATERIAL SHALL BEGIN AFTER FINAL APPROVAL BY LANDSCAPE ARCHITECT.

2. ALL MATERIAL EXCEPT SOD SHALL BE GUARANTEED FOR ONE YEAR PROVIDED IT RECEIVES PROPER MAINTENANCE (AS PRESCRIBED BY THE LANDSCAPE CONTRACTOR) BY THE OWNER AND IS NOT DAMAGED OR DESTROYED BY HURRICANES OR OTHER CAUSES BEYOND THE CONTRACTOR'S CONTROL.

3. IT IS THE RESPONSIBILITY OF THE LANDSCAPE CONTRACTOR TO BRING TO THE ATTENTION OF THE LANDSCAPE ARCHITECT THE OWNER'S NEGLIGENCE TO PROVIDE PROPER CARE OF THE MATERIAL.

4. ALL REPLACEMENT COST OF GUARANTEED MATERIAL, INCLUDING EQUIPMENT, AND LABOR, SHALL BE THE RESPONSIBILITY OF THE CONTRACTOR

#### AWARD OF CONTRACT:

1. ONLY UNIT PRICE-INSTALLED BIDS FOR THE WORK WILL BE ACCEPTABLE. HOWEVER, THE OWNER RETAINS THE RIGHT TO DELETE PORTIONS OF THE WORK FROM THE CONTRACT AND/OR AWARD SEPARATE CONTRACTS FOR PHASES OF THE PROJECT. THE LANDSCAPE ARCHITECT RESERVES THE RIGHT TO REJECT ANY AND ALL BIDS WHEN SUCH REJECTIONS ARE IN THE INTEREST OF THE OWNER.

#### EXECUTION OF THE WORK:

1. THE LANDSCAPE CONTRACTOR SHALL HAVE HIS LABOR CREWS CONTROLLED AND DIRECTED BY A LANDSCAPE FOREMAN WELL Versed IN PLANT MATERIALS, PLANTING, READING OF BLUEPRINTS AND COORDINATION BETWEEN JOB AND NURSERY IN ORDER TO EXECUTE INSTALLATION RAPIDLY AND CORRECTLY.

#### WATER:

1. WATER SOURCE SHALL BE FURNISHED BY THE OWNER.

2. IT IS THE RESPONSIBILITY OF THE LANDSCAPE CONTRACTOR TO COORDINATE HIS WORK WITH IRRIGATION CONTRACTOR.

3. ALL PLANT MATERIAL INSTALLED PRIOR TO THE INSTALLATION OF THE IRRIGATION SYSTEM SHALL BE WATERED WITH A TEMPORARY SYSTEM BY THE LANDSCAPE CONTRACTOR.

#### IRRIGATION:

-DRIP IRRIGATION MAY ONLY BE USED IF SPECIFIED BY SMI OR IF REQUIRED BY MUNICIPALITY

#### GRADING:

1. THE GENERAL CONTRACTOR SHALL BE RESPONSIBLE FOR ALL SUBGRADE OF LANDSCAPE AREAS UNLESS OTHERWISE SPECIFIED. THE TERR SUBGRADE SHALL BE DEFINED AS 4"-6" BELOW FINISH GRADE UNLESS OTHERWISE NOTED ON PLANS.

2. THE LANDSCAPE CONTRACTOR SHALL BE RESPONSIBLE FOR ALL FINISHED AND FINE GRADING WITHIN PLANTER BEDS AND THE FILLING OF PLANTER BOXES. THE LANDSCAPE CONTRACTOR SHALL REMOVE ALL EXCESS SOIL AND DEBRIS ACCUMULATED DURING HIS WORK.

3. THE SOD CONTRACTOR SHALL BE RESPONSIBLE FOR FINISH GRADE IN ALL SODDED AREAS. SEE SPECIFICATIONS RELATING TO SPECIES GROWERS.

TO PROTECT AGAINST GANODERMA PALM FUNGUS ALWAYS REMOVE ALL PALM STUMPS FROM PROPERTY - STUMPS ACT AS HOSTS TO THIS DESTRUCTIVE LONG LIVED FUNGUS.

#### DIGGING

1. THE LANDSCAPE CONTRACTOR SHALL EXERCISE CARE IN DIGGING AND OTHER WORK SO AS NOT TO DAMAGE EXISTING WORK, INCLUDING UNDERGROUND AND OVERHEAD PIPES AND CABLES. SHOULD SUCH UNDERGROUND AND OVERHEAD OBSTRUCTIONS BE ENCOUNTERED WHICH INTERFERE WITH PLANTING, THE LANDSCAPE ARCHITECT OR THE OWNER'S AUTHORIZED REPRESENTATIVE SHALL BE CONSULTED AND WILL ADJUST THE LOCATION OF PLANTS TO CLEAR SUCH OBSTRUCTION OR MOVE THE OBSTRUCTION.

2. THE LANDSCAPE CONTRACTOR SHALL BE RESPONSIBLE FOR THE IMMEDIATE REPAIR OF ANY DAMAGE CAUSED BY HIS WORK. PLANTING PITS

1. EXCAVATE CIRCULAR PITS WITH VERTICAL SIDES FOR ALL PLANTS, EXCEPT FOR HEDGES AND PLANTS SPECIFICALLY DESIGNATED TO BE PLANTED IN BEDS. DIAMETER OF PITS OF TREES AND SHRUBS SHALL BE AT LEAST 1/3 LARGER THAN THE DIAMETER OF THE BALL.

2. EXCAVATE PLANTING PITS AND PLANTING BEDS, PREPARE FINE SUBGRADE THROUGHOUT ALL PITS AND BEDS, AND PLACE THE PLANTS TO BE PLANTED FOR APPROVAL BY LANDSCAPE ARCHITECT BEFORE INSTALLATION.

#### PRUNING

1. REMOVE DEAD AND BROKEN BRANCHES FROM ALL PLANT MATERIAL IMMEDIATELY. PRUNE TO RETAIN TYPICAL GROWTH HABIT OF INDIVIDUAL PLANTS WITH AS MUCH HEIGHT AND SPREAD AS IS PRACTICAL.

2. HEDGE MATERIALS TO BE PULLED IN, TIED AND TRIMMED TO VERTICAL AFTER INSTALLATION, WITH A FINISHED APPEARANCE UNLESS OTHERWISE NOTED.

#### TREE BRACING AND GUYING

1. REMEMBER TO CONSIDER SOIL CONDITIONS WHEN PLANTING TREES IN MADE UP GROUND AND THE NEED TO PLACE THE ANCHORS IN A UNDISTURBED MATERIAL.. IF SO, YOU CAN ORDER 'ED' KITS (EXTRA DEPTH). TO ALLOW FOR THIS YOU MAY ALSO NEED A LONGER DRIVE ROD.

2. THE ANCHOR SHOULD BE DRIVEN TO THE FULL WORKING DEPTH USING A SUITABLE DRIVE ROD.

3. YOU MUST LOADLOCK THE ANCHORS PROPERLY INTO THEIR WORKING POSITION, BY APPLYING AN UPWARDS FORCE / LOAD ON THE WIRE TENDON.

4. IF THE ANCHORS ARE NOT LOADLOCKED PROPERLY, THE TREE WILL BECOME LOOSE WHEN THE FIRST WINDS ARRIVE.

5. PALM TREE ROOTBALLS MUST BE A MINIMUM OF 5' DIAMETER, PROPERLY ROOT WRAPPED AND OF SUFFICIENT STRENGTH AND PROPORTION TO SUPPORT A ROOTBALL FIXING METHOD. THE CORRECT PALM TREE KIT REQUIRED MUST BE SPECIFIED BY THE LANDSCAPE ARCHITECT ONCE THE ROOTBALL DIMENSIONS, TREE HEIGHT AND SAIL AREA OF THE TREE HAVE BEEN ESTABLISHED.

6. THE D-MAN CELLS / DEADMEN SHOULD BE INSTALLED AT LEAST 12" BELOW THE BASE OF THE ROOTBALL WITH THE SOIL COMPACTED ABOVE THE CELLS TO 60%, RIGHT UP TO THE NURSERY LINE.

7. IT IS NOT ADVISABLE TO USE STRAP SYSTEMS FOR CONTAINER GROWN STOCK (SEE PLATI-MAT SYSTEMS).

8. DUE TO SETTLEMENT OF THE TREE & AFTER WATERING RE-TENSIONING IS HIGHLY RECOMMENDED.

9. REFER TO MANUFACTURERS SPECIFICATIONS FOR COMPLETE INSTALLATION INSTRUCTIONS AT WWW.PLATIFUS.US.

10. SMALL TREES SHALL BE GUYED IN THREE DIRECTIONS WITH THREE STRANDS OF NO. 12 GALVANIZED WIRE ATTACHED TO ANCHORS DRIVEN BELOW GRADE. WIRES WHICH COME IN CONTACT WITH THE TREE ARE TO BE ENCASED IN RUBBER HOSE.

#### PLANT MATERIALS

1. NOMENCLATURE: PLANT NAMES SHALL CONFORM TO THE NAMES GIVEN IN HORTUS III AND IN STANDARDIZED PLANT NAMES, 2001, LATEST EDITION. PREPARED BY THE AMERICAN JOINT COMMITTEE ON HORTICULTURAL NOMENCLATURE. NAMES OF VARIETIES NOT INCLUDED THEREIN, CONFORM GENERALLY WITH NAMES ACCEPTED IN THE NURSERY TRADE.

2. QUALITY: PLANTS SHALL HAVE A HABIT OF GROWTH THAT IS NORMAL FOR THE SPECIES AND SHALL BE SOUND, HEALTHY, VIGOROUS AND FREE FROM INSECT PESTS, PLANT DISEASES AND INJURIES. TREES SHALL BE HEAVILY BRANCHED, OR IN PALMS, HEAVILY LEAFED. REQUIREMENTS FOR THE MEASUREMENT, BRANCHING GRADING, QUALITY, BALLING AND BURLAPPING OF PLANTS IN THE PLANT LISTS GENERALLY FOLLOW THE CODE OF STANDARDS CURRENTLY RECOMMENDED BY THE AMERICAN ASSOCIATION OF NURSERYMEN, INC., AND THE AMERICAN STANDARD FOR NURSERY STOCK. PLANT MATERIAL SHALL BE GRADED AS SPECIFIED ON THE DRAWINGS.

GRADES SHALL CONFORM TO GRADES AND STANDARDS FOR NURSERY STOCK, STATE PLANT BOARD OF FLORIDA. PALMS WITH MARRIED OR BURNED TRUNKS WILL NOT BE ACCEPTED. PLANTS WITH BROKEN, DAMAGED, OR INSUFFICIENT BALLS WILL BE REJECTED. ALL PLANTS SHALL BE FLORIDA FANCY.

3. SUBSTITUTIONS WILL BE PERMITTED ONLY UPON WRITTEN APPROVAL BY THE LANDSCAPE ARCHITECT.

#### PLANTING SOIL

##### SOIL BY 'ATLAS SOIL' OR APPROVED ALTERNATE

ALL PLANTING AREAS SHALL BE CLEANEED OF ALL PLANT AND MATERIAL TWO WEEKS PRIOR TO INSTALLATION OF SOIL FOR REMOVAL OF ANY NEEDS.

GROUND COVER BEDS -REMOVE 6" OF EXISTING SOIL AND FILL WITH 4" OF 8270 MIX & TILL MIX INTO EXISTING SOIL.

SHRUB BEDS -REMOVE 6" OF EXISTING SOIL AND FILL WITH A MIX OF 50% APPROVED SOIL & 50% EXISTING SOIL.

TREE PITS -REMOVE SOIL IN THE AMOUNT OF 1/2 LARGER THAN THE BALL OF THE TREE AND REPLACE WITH A MIX OF 50% APPROVED SOIL & 50% EXISTING SOIL.

PALMS -REMOVE SOIL IN THE AMOUNT OF 1/2 LARGER THAN THE BALL OF THE PALM AND REPLACE WITH APPROPRIATE SOIL AND CLEAN YELLOW SAND FREE OF NEEDS.

SOIL SPECS FOR PLANTING BEDS:	SOIL SPECS FOR TREES AND LARGE SHRUBS:
ATLAS PEAT & SOIL 8270 MIX	SMILA SOIL MIX (APPROVED SOIL)
50% Pinebark	
40% Florida Peat	
20% can peat	
25% fia peat	
40% pine bark	
15% arlite	
	50% Pinebark
	40% Florida Peat
	10% Coarse Sand
	10lbs Dolomite per/Yard
	10.5lbs TurfPro per/Yard
	25 pounds Nutricote 10/6/0-360 P/yard optional

1. SOLE SOURCE - FROM ATLAS PEAT & SOIL INC., P.O. BOX 3867, BOYNTON BEACH, FLORIDA, 33424-3867, (561) 734-7300

PLANTING SOIL NOT MEETING THESE REQUIREMENTS WILL NOT BE ACCEPTED.

1. SOIL FOR PLANTING TREES, SHRUBS AND GROUND COVER SHALL BE SMILA SOIL UNLESS OTHERWISE SPECIFIED ON THE DRAWINGS.

2. IT SHALL BE THE RESPONSIBILITY OF THE LANDSCAPE CONTRACTOR TO REMOVE ANY EXCESS SOIL AND DEBRIS FROM THE SITE. REFER TO THE GRADING PLAN AND GRADING SPECIFICATIONS.

3. LANDSCAPE ARCHITECT MAY REQUEST SOIL ANALYSIS FOR THE TESTING OF PLANTING SOIL UTILIZED BY THE SELECTED LANDSCAPE CONTRACTOR.

#### FERTILIZER

1. TREES USE ONE 21 GRAM AGRIFORM PLANTING TABLET PER 1/2" TRUNK DIAMETER. SPACE EQUALLY AROUND AT 2/3 DEPTH OF BALL.

2. SHRUBS: AGRIFORM PLANTING TABLETS SHALL BE APPLIED PER THE MANUFACTURERS SUGGESTED APPLICATION RATES.

3. SOD USE FERTILIZER AS PER BELOW WITH TRACE ELEMENTS APPLIED AT THE RATE OF 15 LBS. PER 1000 SQ. FT. PRIOR TO LAYING SOD.

4. POWDERED MYCCHORHIZAE MIX; DIE HARD, 'PLANT HEALTH' CARE OR EQUAL) AND LIQUID B-THRIVE (OR EQUAL) SHOULD BE ADDED TO ALL TREES, SHRUBS AND GROUND COVER PLANTING BEDS AS PER MANUFACTERES DIRECTIONS.

5. ALL TREES, SHRUBS, GROUND COVER AND SOD TO USE LESCO 13-3-13 FERTILIZER AS PER MANUFACTURERS SPECIFICATIONS

#### MULCH

ALL MULCH FOR THE PROJECT SHALL BE ATLAS GROWN. MULCH SHALL BE APPLIED 2" IN TREES AND PALMS AS SPECIFIED, AND ALL PLANTING BEDS, HEDGE AND SHRUBS, CROWN CROWN OF ROOT BALL ABOVE MULCH

SOLE SOURCE - FROM ATLAS PEAT & SOIL INC., P.O. BOX 3867, BOYNTON BEACH, FLORIDA, 33424-3867, (561) 734-7300

SUBMIT BAG TO LANDSCAPE ARCHITECT FOR APPROVALS.

#### SABAL PALMS

1. SABAL PALMS SHALL HAVE A MINIMUM TRUNK DIAMETER OF 12" MEASURED 2' ABOVE GROUND.

#### HEDGES

1. THE LANDSCAPE CONTRACTOR SHALL PROVIDE FULL MATERIAL TO PRODUCE A SOLID SCREEN FROM THE TOP OF HEDGE TO THE BASE OF HEDGE.

2. THE LANDSCAPE CONTRACTOR SHALL BE RESPONSIBLE TO ADD FILLERS TO THE HEDGE AS NEEDED TO PRODUCE A SOLID FULL TO BASE (F.T.B.), SCREEN TO BE INCLUDED IN THE CONTRACTED PRICE.

3. PLANT MATERIAL WITH WEAK OR THIN FOLIAGE WILL NOT BE ACCEPTED.

#### VINES

1. MATERIALS & INSTALLATION OF VINE SUPPORTS SHALL BE INCLUDED IN UNIT COST OF VINE SPECIFIED

#### SODDING

1. THE LANDSCAPE CONTRACTOR SHALL SOD ALL AREAS INDICATED AND NOTED ON THE DRAWINGS.

2. NO SODDING SHALL OCCUR UNTIL ALL AREAS TO BE SODDED ARE CLEARED OF ANY ROUGH GRASS, WEEDS, AND DEBRIS, THE GROUND BROUGHT TO AN EVEN GRADE AND SPECIFIED AMENDMENTS HAVE BEEN ADDED. SEE DETAILS FOR SPECIFIC AMENDMENTS AS PER SOD TYPE. ALL SODDED AREAS WILL BE TREATED WITH 'ROUNDUP' HERBICIDE PER MANUFACTURER'S SPECIFICATIONS AT LEAST TEN DAYS PRIOR TO SOD INSTALLATION.

3. THE SOD SHALL BE FIRM, TOUGH TEXTURE, HAVING A COMPACTED GROWTH OF GRASS WITH GOOD ROOT DEVELOPMENT. IT SHALL CONTAIN NO NOXIOUS WEEDS, OR ANY OTHER OBJECTIONABLE VEGETATION, FUNGUS, INSECTS OR DISEASE. PREPARATION OF AREAS SHALL BE PERFORMED WELL ENOUGH IN ADVANCE TO ALLOW SUFFICIENT TIME TO WORK PROPERLY. THE SOIL EMBEDDED IN THE SOD SHALL BE GOOD, CLEAN EARTH, FREE FROM STONES AND DEBRIS. THE SOD SHALL BE FREE FROM FUNGUS, VERMIN, AND OTHER DISEASES.

4. BEFORE BEING CUT AND LIFTED, THE SOD SHALL HAVE BEEN MOVED AT LEAST THREE TIMES WITH A LAWN MOWER, WITH THE FINAL MOWING NOT MORE THAN SEVEN DAYS BEFORE THE SOD IS CUT. THE SOD SHALL BE CAREFULLY CUT INTO UNIFORM DIMENSIONS.

5. SOLID SOD SHALL BE LAID WITH CLOSELY ABUTTING JOINTS WITH A TAMPED OR ROLLED EVEN SURFACE.

6. WATERING SHALL BE ACCOMPLISHED UNTIL ACCEPTANCE OF THE WORK BY THE LANDSCAPE ARCHITECT.

7. MAINTENANCE OF MATERIAL SHALL BE THE RESPONSIBILITY OF THE LANDSCAPE CONTRACTOR UNTIL FINAL APPROVAL OF LANDSCAPE ARCHITECT.

8. IT SHALL BE THE RESPONSIBILITY OF THE LANDSCAPE CONTRACTOR TO BRING THE SOD EDGE IN A NEAT, CLEAN MANNER TO THE EDGE OF ALL PAVING AND SHRUB AREAS.

9. SEE PLANS FOR DETAILS. RE: SOD VARIETIES

10. FOR SOD, APPLY DEPTH OF SOIL AS PER PLANTING DETAILS PAGE. REMOVE ANY STONES FROM TOP OF SUB-GRADE OR COVER STONES WITH ADDITIONAL 2" OF SOIL MIX.

11. ALL SOD AREA SHALL BE TREATED WITH 'ROUND UP' TWO WEEKS PRIOR TO INSTALLATION FOR REMOVAL OF ANY EXISTING OBJECTIONABLE PLANTS. DOSAGE AND APPLICATION PER MANUFACTURERS SPECIFICATIONS.

## PLANT LIST

All plants to be Florida Fancy

QTY	BOTANICAL NAME	COMMON NAME	SIZE	NOTES
TREES				
1	Bauhinia tree	To match existing.	Collected, SMI to approve	
2	Coccoloba diversifolia	Pigeon Plum	#100, 14' ht, 9' ct, 6' sprd, SMI to approve	
4	Pithecellobium arboreum	Lorito Tree	#100, 18' oa, 9' ct, SMI to approve	
5	Samanea saman	Rain tree	#100, 18' oa, 9' ct, SMI to approve	
11	Swietenia mahagoni	Cuban Mahogany	#100, 16' ht, 6' sprd, 8' ct, SMI to approve	Native
PALM TREES				
2	Acoelorrhaphe wrightii	Paurotis Palm	15' sprd, 10 cane minimum, SMI to approve	
1	Ptychosperma macarthurii	Macarthur Palm	5-trunk, 16' gw	Not Native
SHRUBS				
85	Ficus microcarpa 'Green Island'	Green Island Ficus	#7, 14'oc	
2	Garcinia spicata	Garcinia	10' HT, FTB, columnar	Not Native
342 LF	Heterosavia bahamensis	Maidenbush	#45, 6' ht, ftb, Qty=LF	
3	Ilex vomitoria 'Schillings'	Schillings Yaupon Holly	1' dia. sphere, ftb	
4	Ilex vomitoria 'Schillings'	Schillings Yaupon Holly	2' dia. sphere, ftb	
4	Ilex vomitoria 'Schillings'	Schillings Yaupon Holly	3' dia. sphere, ftb	
1	Ilex vomitoria 'Schillings'	Schillings Yaupon Holly	4' dia. sphere, ftb	
105 LF	Podocarpus macrophyllus 'Maki'	Maki Shrubby Yew Podocarpus	#65, 10' ht, ftb, Qty=LF	
33 LF	Podocarpus macrophyllus 'Maki'	Maki Shrubby Yew Podocarpus	4' ht, ftb, Qty=LF	Not Native
169 LF	Podocarpus macrophyllus 'Pringles'	Pringles Yew Podocarpus	#7, Qty=LF	
52 LF	Tabernaemontana heterophylla	Jasmine	3' ht, ftb, hedge, Qty=LF	
VINE/ESPALIER				
2	Bougainvillea x 'New River'	New River Bougainvillea	#15, 5' oc, pin to wall	Not Native
38	Bougainvillea x 'New River'	New River Bougainvillea	#3, 36' oc	
24	Pandorea jasminoides	Bower Vine	#3, 36' oc	
9	Pyrostegia venusta	Florida Flame Vine,	#15, trl, train to columns & roof	
8	Solandra grandiflora	Showy Chalice Vine	#15, trl, train to columns & roof	Not Native
SHRUB AREAS				
73	Annuals Mix per SMI	See Annuals Mix Chart	#1, 6'oc	
72	Asystasia gangetica	Chinese Violet	#3, 14" oc	
410	Ilex vomitoria	Yaupon Holly	#7, 14'oc	
1,032	Mimosa strigillosa	Sunshine Mimosa	#1, 12'oc	Native
1,341	Salvia misella	Tropical Sage	#1, 12'oc	Native
1,991	Tropical Mix 1 per SMI	See Tropical Mix 1 Chart,	#3, 12'oc	
347	Tropical Mix 2 per SMI	See Tropical Mix 2 Chart,	#3, 12'oc	
66	Viburnum odoratissimum	Sweet Viburnum	#25, ftb, 5' ht, 30'oc	
44 sf	Zephyranthes grandiflora	Pink Rain Lily	#1, 6'oc, can to can	
GROUND COVERS				
828	Trachelospermum asiaticum 'Minima'	Minima Asian Jasmine	#1, 12'oc	Not Native

#### CLEAN UP

1. THE LANDSCAPE CONTRACTOR SHALL AT ALL TIMES KEEP THE PREMISES FREE FROM ACCUMULATIONS OF WASTE MATERIALS OR RUBBISH CAUSED BY HIS EMPLOYEES OR WORK. HE SHALL LEAVE ALL PAVED AREAS 'BROOM CLEAN' WHEN COMPLETED WITH THE WORK.

2. MARKS AND DAMAGE TO EXISTING PAVING MATERIALS SHALL BE THE RESPONSIBILITY OF THE LANDSCAPE CONTRACTOR.

ALL PALMS, TREES, AND LARGE SPECIMEN PLANTS SHALL BE STAKED BY THE LANDSCAPE CONTRACTOR FOR LA APPROVAL OF LAYOUT AND LOCATIONS PRIOR TO INSTALLING SAME.

TREE STAKE PAINT FORMULA:  
BEHR PREMIUM PLUS EXT FLAT -ACCENT BASE (4670)  
COLORANT                    02   45   96  
D   THALO GREEN                    01   04  
C   YELLOW OXIDE                    02   04   0  
B   LAMP BLACK                    01   00   0

SUBMIT SAMPLE

SMI TO APPROVE STAKED LAYOUT OF ALL TREES AND PLANTING LAYOUT PRIOR TO INSTALLATION

ALL IRRIGATION, IRRIGATION EQUIPMENT AND IRRIGATION BOXES TO BE CONCEALED

ALL PLANTING BEDS ABUTTING LAWN TO HAVE METAL EDGE BORDER

SEAL



120 Broadway  
20th Floor  
New York, NY 10271  
212 777 7800  
beyerblinderbelle.com

**BEYER  
BLINDER  
BELLE**

**SMI**

LANDSCAPE ARCHITECTURE  
140 Broad Palm Way, Suite 205A Palm Beach, Florida 33480  
Phone: 561.684.6844  
Fax: 561.684.6844  
Email: info@spinaorourke.com  
FL Registration #LA 1306023

285 Banyan Blvd  
West Palm Beach Florida 33401  
561.684.6844 • Fax 561.684.6844  
spinaorourke.com  
FL Lic #A2800299

**SPINAOROURKE**  
+ ASSOCIATES



The Society of the Four Arts

100 Four Arts Plaza, Palm Beach, FL 33480

THESE DRAWINGS ARE FOR THE EXCLUSIVE USE OF SPINA OROURKE + PARTNERS, INC. AND MAY NOT BE DUPLICATED, REPRODUCED OR USED IN ANY MANNER WITHOUT THE EXPRESS WRITTEN CONSENT OF SPINA OROURKE + PARTNERS, INC. ALL RIGHTS RESERVED.

#### Revisions



Project no: 2953  
Date: 2024.10.07  
Drawn by: VD  
Project Manager: CFV

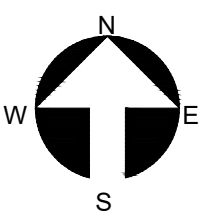

**L2.3**

N.T.S.  
Final Submittal

PLANTING SPECIFICATIONS



Autodesk Docs/Society of the Four Arts/SFA-Roversky-R22.mxd

ABBREVIATIONS KEY  
DIA = DIAMETER  
DR = DOMINICAN REPUBLIC  
HS = HANDSCAPE  
HT = HEIGHT  
LA = LANDSCAPE ARCHITECT  
LS = LANDSCAPE  
MAX = MAXIMUM  
MIN = MINIMUM  
SMI = SMI LANDSCAPE ARCHITECTURE  
TBD = TO BE DETERMINED  
TC = TERRA COTTA  
THK = THICK  
TYP = TYPICAL

GRADING  
BOS = BOTTOM OF STEPS  
ELEV = ELEVATION  
FFE = FINISHED FLOOR ELEVATION  
TOS = TOP OF STEPS  
TOW = TOP OF WALL



**Town of Palm Beach**  
Planning Zoning and Building  
360 S County Rd  
Palm Beach, FL 33480  
www.townofpalmbeach.com

Line #	Landscape Legend Campus		
	Property Address:	100 Four Arts Plaza, Palm Beach, FL 33480	
2	Lot Area (sq. ft.):	334,443 sq ft	
3		REQUIRED	PROPOSED
4	Landscape Open Space (LOS) (Sq Ft and %)	N/A	N/A
5	LOS to be altered (Sq Ft and %)	N/A	46,337 sq ft (14%)
6	Perimeter LOS (Sq Ft and %)	N/A	N/A
7	Front Yard LOS (Sq Ft and %)	N/A	8,434 (57%)
8	Native Trees %	30% (number of trees)	56.5%
9	Native Shrubs & Vines %	30% (number of shrubs & vines)	30%
10	Native Groundcover %	30% (groundcover area)	100%

NOTE:  
Native calculations are based off of proposed planting  
only per Sect. 66-285

Newly planted non-native plant material

Newly planted native plant material

Areas not shown in color are either existing to remain,  
building, hardscape, or sod

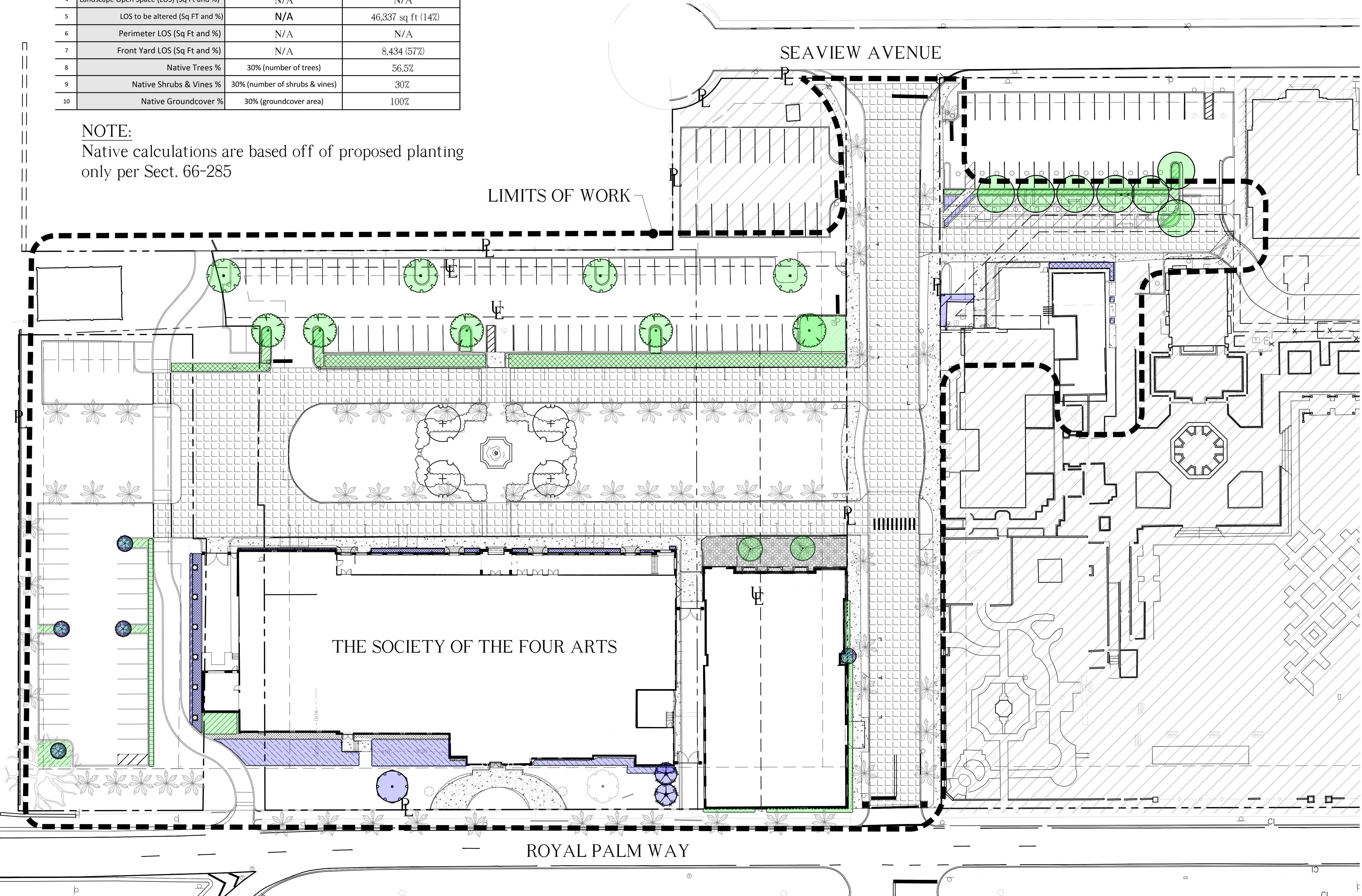

120 Broadway  
20th Floor  
New York, NY 10271  
212 777 7800  
beyerblinderbelle.com

285 Banyan Blvd  
West Palm Beach, Florida 33401  
561.684.6844 • Fax 561.684.5504  
spinaorourke.com  
FL Lic # A23002399

SPINAOROURKE  
+ PARTNERS  
ARCHITECTS

LANDSCAPE ARCHITECTURE  
140 Royal Palm Way, Suite 200 Palm Beach, Florida 33480  
Palm Beach, FL 33480  
FL Registration # LA 13000233

BEYER  
BLINDER  
BELLE  
SMI

Architecture • Interior Design  
Keith M. Spina #AR15419

The Society of the Four Arts

100 Four Arts Plaza, Palm Beach, FL 33480

THESE DRAWINGS ARE FOR THE  
EXCLUSIVE USE OF SPINA OROURKE +  
PARTNERS, INC. AND MAY NOT BE  
DUPLICATED, REPRODUCED OR USED  
IN ANY MANNER WITHOUT THE  
EXPRESS WRITTEN CONSENT OF SPINA  
OROURKE + PARTNERS, INC. ALL  
RIGHTS RESERVED.

Revisions
-----------

Project no: 2953  
Date: 2024.10.07  
Drawn by: VD  
Project Manager: CFV

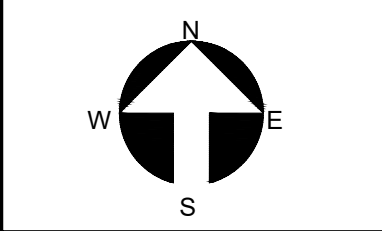

N-1

1" = 20'-0"  
Final Submittal







Autodesk Docs/Society of the Four Arts/SFA-Roversky-R22.rvt

ABBREVIATIONS KEY  
DIA = DIAMETER  
DR = DOMINICAN REPUBLIC  
HS = HARDSCAPE  
HT = HEIGHT  
LA = LANDSCAPE ARCHITECT  
LS = LANDSCAPE  
MAX = MAXIMUM  
MIN = MINIMUM  
SMI = SMI LANDSCAPE ARCHITECTURE  
TBD = TO BE DETERMINED  
TC = TERRA COTTA  
THK = THICK  
TYP = TYPICAL

GRADING  
BOS = BOTTOM OF STEPS  
ELEV = ELEVATION  
FFE = FINISHED FLOOR ELEVATION  
TOS = TOP OF STEPS  
TOW = TOP OF WALL

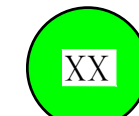
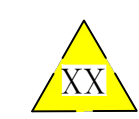
SEE SHEET D-3 FOR EXISTING (NUMBERED) TREES LIST AND DISPOSITION

Relocation Key  
 Remove  
 Remain  
 Relocate  
 HARDSCAPE TO BE REMOVED  
 VEGETATION TO BE REMOVED

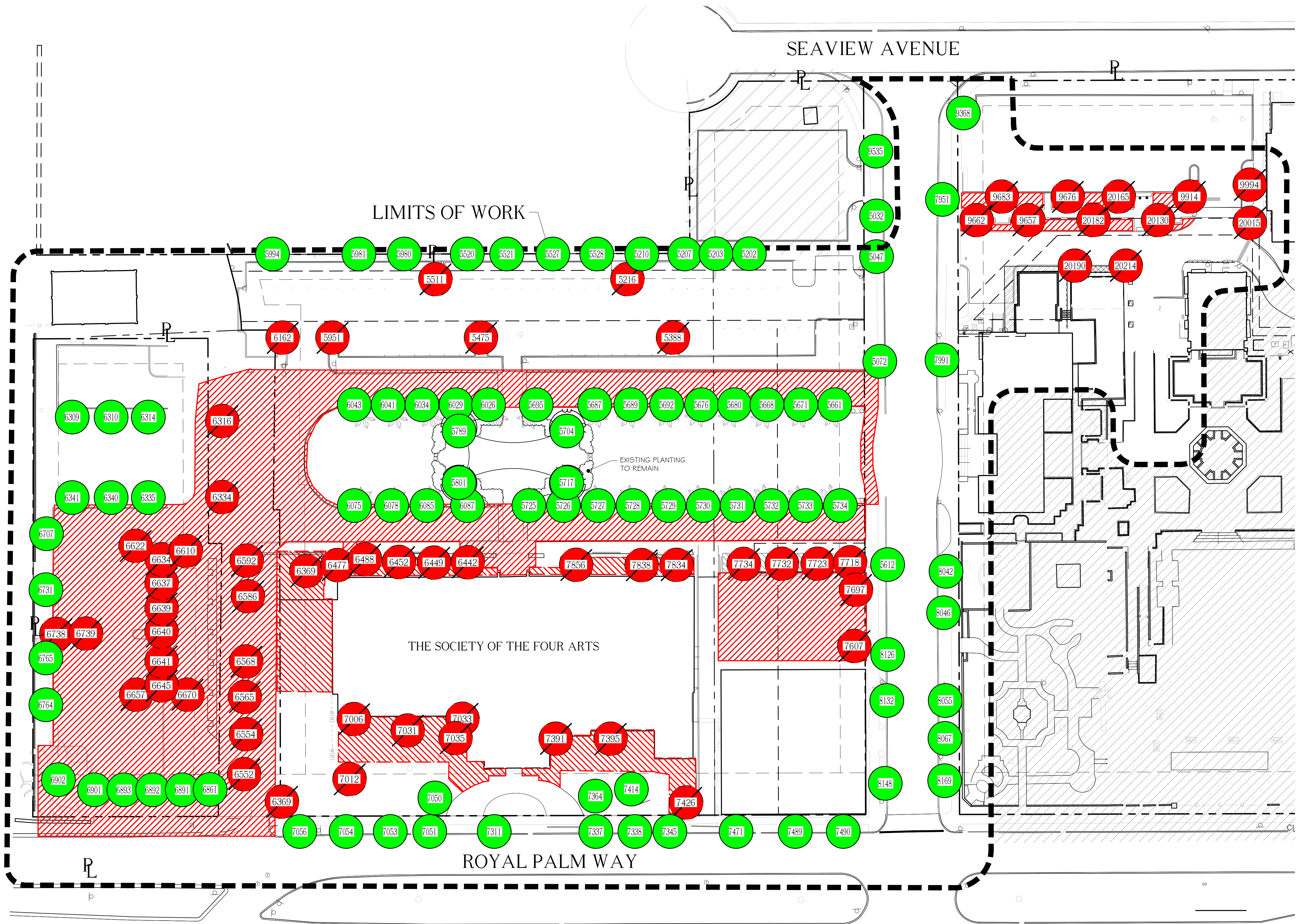

NOTE:  
-EXISTING SOD TO REMAIN  
-CONTRACTOR TO REPAIR SOD AS NEEDED UNTIL CONSTRUCTION BEGINS  
-SOD: STENOTAPHRUM SECUNDATUM 'FLORATAM'  
-LOT SHALL BE SODDED AND IRRIGATED PER TOWN REQUIREMENTS

Survey By: Keith Surveying Job # 13223.00



PRE DEMOLITION PLAN

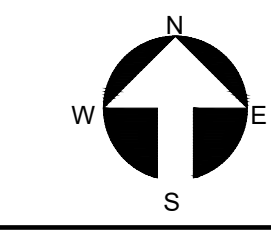

Project no: 2953  
Date: 2024.10.07  
Drawn by: VD  
Project Manager: CFV

Revisions

THESE DRAWINGS ARE FOR THE EXCLUSIVE USE OF SPINA OROURKE + PARTNERS, INC. AND MAY NOT BE DUPLICATED, REPRODUCED OR USED IN ANY MANNER WITHOUT THE EXPRESS WRITTEN CONSENT OF SPINA OROURKE + PARTNERS, INC. ALL RIGHTS RESERVED.

The Society of the Four Arts

100 Four Arts Plaza, Palm Beach, FL 33480



SPINA OROURKE + PARTNERS, INC.

285 Banyan Blvd  
West Palm Beach, Florida 33401

561.684.6844 • Fax: 561.684.5504  
spinaorourke.com

FL Lic # A23802299

FL Registration # AR15419

Architecture • Interior Design

Keith M. Spina

SMI

LANDSCAPE ARCHITECTURE  
140 Royal Palm Way, Suite 200 Palm Beach, Florida 33480  
P.O. Box 100000  
Palm Beach, Florida 33408  
FL Registration # LA 1300223

BEYER BLINDER BELLE

120 Broadway  
20th Floor  
New York, NY 10271  
212.777.7800  
beyerblinderbelle.com



Autodesk Docs://Society of the Four Arts-XA-SFA-Roversky-R22.rvt

ABBREVIATIONS KEY  
DIA =DiAmeter  
DR =Dominican Republic  
HS =HardScape  
HT =Height  
LA =Landscape Architect  
LS =LandScape  
MAX =MAximum  
MIN =MiNimum  
SMI =SMI Landscape Architecture  
TBD =To Be Determined  
TC =Terra Cotta  
THK =Thick  
TYP =Typical

GRADING  
BOS =Bottom Of Steps  
ELEV =ELEVation  
FFE =Finished Floor Elevation  
TOS =Top Of Steps  
TOW =Top Of Wall

SEE SHEET D-3 FOR EXISTING (NUMBERED) TREES LIST

ALL TREES & PALMS TO REMAIN UNLESS NOTED OTHERWISE

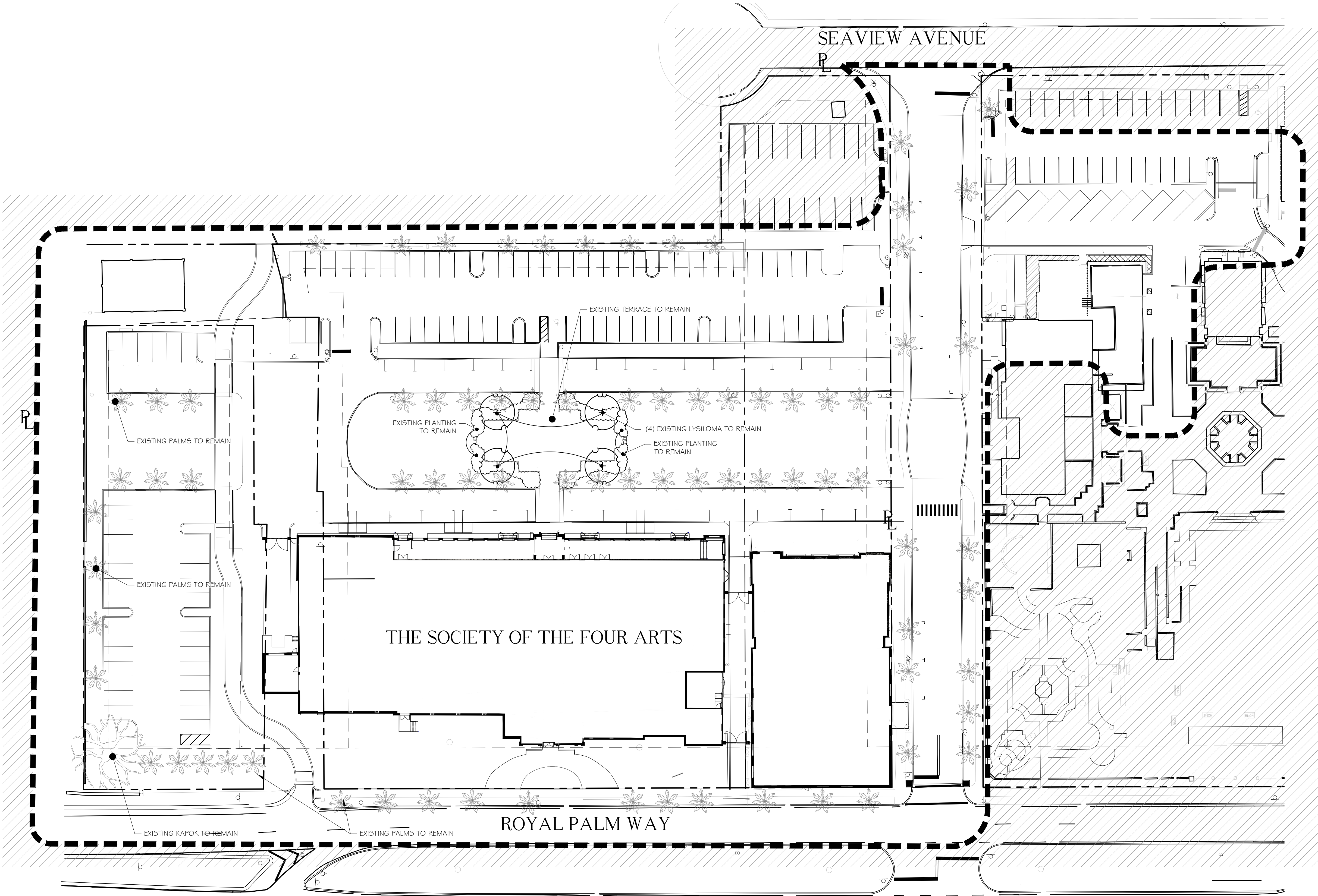

NOTE:  
-EXISTING SOD TO REMAIN  
-CONTRACTOR TO REPAIR SOD AS NEEDED UNTIL CONSTRUCTION BEGINS  
-SOD: STENOTAPHRUM SECUNDATUM FLORATAM  
-LOT SHALL BE SODDED AND IRRIGATED PER TOWN REQUIREMENTS

Survey By: Keith Surveying Job # 13223.00

120 Broadway  
20th Floor  
New York, NY 10271  
212 777 7800  
beyerblinderbelle.com

285 Banyan Blvd  
West Palm Beach Florida 33401  
561.684.6844 • Fax 561.684.5504  
spinaorourke.com  
FL Lic # A23802299

LANDSCAPE ARCHITECTURE  
140 Royal Palm Way, Suite 205A Palm Beach, Florida 33480  
Phone: 561.684.5506  
Fax: 561.684.5504  
About Our Firm: www.spinaorourke.com  
FL Registration # LA 13060223

SPINAOROURKE PARTNERS  
Architecture • Interior Design  
Keith M. Spina #AR15419

The Society of the Four Arts  
100 Four Arts Plaza, Palm Beach, FL 33480

THESE DRAWINGS ARE FOR THE EXCLUSIVE USE OF SPINA OROURKE PARTNERS, INC. AND MAY NOT BE DUPLICATED, REPRODUCED OR USED IN ANY MANNER WITHOUT THE EXPRESS WRITTEN CONSENT OF SPINA OROURKE PARTNERS, INC. ALL RIGHTS RESERVED.

Revisions

Project no: 2953  
Date: 2024.10.07  
Drawn by: VD  
Project Manager: CFV

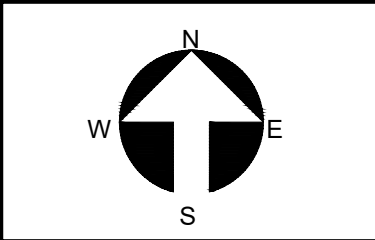

POST DEMOLITION PLAN

D-2

1" = 20'-0"  
Final Submittal



EXISTING TREES LIST

Trees not noted as to Remain or to Remove are not included within the scope of work

TREE TABLE			
Number	Name	DBH (in)	Disposition
5032	SYLVESTER PALM	18	REMAIN
5047	SYLVESTER PALM	16	REMAIN
5072	SYLVESTER PALM	18	REMAIN
5086	SABAL PALM	12	-
5088	LIGUSTRUM	3	-
5089	LIGUSTRUM	2	-
5090	LIGUSTRUM	3	-
5148	LIGUSTRUM	3	-
5160	LIGUSTRUM	3	-
5195	LIGUSTRUM	3	-
5202	LIGUSTRUM	3	REMAIN
5203	LIGUSTRUM	3	REMAIN
5207	PALM	6	REMAIN
5210	PALM	5	REMAIN
5216	UNKNOWN	5	REMOVE
5294	UNKNOWN	5	-
5298	UNKNOWN	5	-
5300	UNKNOWN	6	-
5305	LIGUSTRUM	3	-
5310	FICUS	24	-
5313	LIGUSTRUM	3	-
5320	LIGUSTRUM	3	-
5358	CUBAN ROYAL PALM	21	-
5360	CUBAN ROYAL PALM	20	-
5363	CUBAN ROYAL PALM	19	-
5364	CUBAN ROYAL PALM	24	-
5388	UNKNOWN	4	REMOVE
5392	CUBAN ROYAL PALM	18	-
5393	CUBAN ROYAL PALM	22	-
5403	CUBAN ROYAL PALM	18	-
5404	CUBAN ROYAL PALM	20	-
5408	CUBAN ROYAL PALM	21	-
5455	CUBAN ROYAL PALM	18	-
5458	CUBAN ROYAL PALM	20	-
5475	UNKNOWN	6	REMOVE
5483	CUBAN ROYAL PALM	20	-
5484	UNKNOWN	8	REMOVE
5511	UNKNOWN	8	REMOVE
5520	PALM	6	REMAIN
5521	PALM	5	REMAIN
5527	PALM	6	REMAIN
5528	PALM	7	REMAIN
5580	CUBAN ROYAL PALM	18	-
5612	SYLVESTER PALM	15	REMAIN
5661	CUBAN ROYAL PALM	22	REMAIN
5668	CUBAN ROYAL PALM	19	REMAIN
5671	CUBAN ROYAL PALM	20	REMAIN
5675	CUBAN ROYAL PALM	20	-
5676	CUBAN ROYAL PALM	23	REMAIN
5680	CUBAN ROYAL PALM	22	REMAIN
5687	CUBAN ROYAL PALM	20	REMAIN
5689	CUBAN ROYAL PALM	23	REMAIN
5692	CUBAN ROYAL PALM	23	REMAIN
5695	CUBAN ROYAL PALM	20	REMAIN

TREE TABLE			
Number	Name	DBH (in)	Disposition
5701	UNKNOWN	12	
5704	UNKNOWN	10	REMAIN
5717	UNKNOWN	10	REMAIN
5725	CUBAN ROYAL PALM	20	REMAIN
5726	CUBAN ROYAL PALM	20	REMAIN
5727	CUBAN ROYAL PALM	24	REMAIN
5728	CUBAN ROYAL PALM	23	REMAIN
5729	CUBAN ROYAL PALM	21	REMAIN
5730	CUBAN ROYAL PALM	22	REMAIN
5731	CUBAN ROYAL PALM	21	REMAIN
5732	CUBAN ROYAL PALM	23	REMAIN
5733	CUBAN ROYAL PALM	19	REMAIN
5734	CUBAN ROYAL PALM	20	REMAIN
5786	UNKNOWN	12	
5789	UNKNOWN	10	REMAIN
5801	UNKNOWN	12	REMAIN
5927	CUBAN ROYAL PALM	18	
5951	LIGUSTRUM	3	REMOVE
5980	PALM	6	REMAIN
5981	PALM	8	REMAIN
5994	PALM	6	REMAIN
5999	MAHOGANY	19	
6026	CUBAN ROYAL PALM	19	REMAIN
6029	CUBAN ROYAL PALM	20	REMAIN
6034	CUBAN ROYAL PALM	20	REMAIN
6041	CUBAN ROYAL PALM	18	REMAIN
6043	CUBAN ROYAL PALM	20	REMAIN
6075	CUBAN ROYAL PALM	20	REMAIN
6078	CUBAN ROYAL PALM	21	REMAIN
6085	CUBAN ROYAL PALM	19	REMAIN
6087	CUBAN ROYAL PALM	23	REMAIN
6096	SABAL PALM	12	
6162	LIGUSTRUM	3	REMOVE
6183	MAHOGANY	20	
6226	BUTTONWOOD	6	
6227	GEIGER	7	
6261	BUTTONWOOD	10	
6294	BUTTONWOOD	12	
6309	CUBAN ROYAL PALM	19	
6310	CUBAN ROYAL PALM	18	REMAIN
6314	CUBAN ROYAL PALM	18	REMAIN
6316	CUBAN ROYAL PALM	20	REMOVE
6334	CUBAN ROYAL PALM	18	REMOVE
6335	CUBAN ROYAL PALM	20	REMAIN
6340	CUBAN ROYAL PALM	20	REMAIN
6341	CUBAN ROYAL PALM	19	REMAIN
6369	SABAL	10	REMOVE
6442	FICUS	15	REMOVE
6449	FICUS	15	REMOVE
6452	FICUS	14	REMOVE
6477	FICUS	3	REMOVE
6488	FICUS	3	REMOVE
6549	SCREW PINE	10	-

TREE TABLE			
Number	Name	DBH (in)	Disposition
6552	MAHOGANY	24	REMOVE
6554	MAHOGANY	22	REMOVE
6565	MAHOGANY	20	REMOVE
6568	MAHOGANY	19	REMOVE
6586	MAHOGANY	20	REMOVE
6592	MAHOGANY	24	REMOVE
6610	MAHOGANY	19	REMOVE
6622	MAHOGANY	19	REMOVE
6634	SYLVESTER PALM	12	REMOVE
6637	SYLVESTER PALM	14	REMOVE
6639	SYLVESTER PALM	12	REMOVE
6640	SYLVESTER PALM	10	REMOVE
6641	SYLVESTER PALM	8	REMOVE
6645	SYLVESTER PALM	10	REMOVE
6657	MAHOGANY	20	REMOVE
6670	MAHOGANY	24	REMOVE
6707	CUBAN ROYAL PALM	19	REMAIN
6731	CUBAN ROYAL PALM	18	REMAIN
6738	ALEXANDER PALM	10	REMOVE
6739	ALEXANDER PALM	8	REMOVE
6764	CUBAN ROYAL PALM	21	REMAIN
6765	CUBAN ROYAL PALM	19	REMAIN
6861	CUBAN ROYAL PALM	19	REMAIN
6891	CUBAN ROYAL PALM	19	REMAIN
6892	CUBAN ROYAL PALM	19	REMAIN
6893	CUBAN ROYAL PALM	20	REMAIN
6901	CUBAN ROYAL PALM	18	REMAIN
6902	UNKNOWN	60	REMAIN
7006	SCREW PINE	8	REMOVE
7012	ORCHID	8	REMOVE
7031	EUREKA CLUSTER	3	REMOVE
7033	SCHEFFIERA	6	REMOVE
7035	SCHEFFIERA CLUSTER	3	REMOVE
7050	PORTER CORPUS	4	REMAIN
7051	CUBAN ROYAL PALM	18	REMAIN
7053	CUBAN ROYAL PALM	19	REMAIN
7054	CUBAN ROYAL PALM	19	REMAIN
7056	CUBAN ROYAL PALM	20	REMAIN
7101	CUBAN ROYAL PALM	18	-
7103	CUBAN ROYAL PALM	19	-
7113	CUBAN ROYAL PALM	20	-
7156	CUBAN ROYAL PALM	18	-
7160	CUBAN ROYAL PALM	19	-
7163	CUBAN ROYAL PALM	18	-
7179	CUBAN ROYAL PALM	14	-
7182	CUBAN ROYAL PALM	19	-
7198	CUBAN ROYAL PALM	19	-
7205	CUBAN ROYAL PALM	19	-
7213	CUBAN ROYAL PALM	20	-
7218	CUBAN ROYAL PALM	21	-
7221	CUBAN ROYAL PALM	19	-
7244	CUBAN ROYAL PALM	20	-

TREE TABLE			
Number	Name	DBH (in)	Disposition
7248	CUBAN ROYAL PALM	19	-
7258	CUBAN ROYAL PALM	20	-
7261	CUBAN ROYAL PALM	16	-
7266	CUBAN ROYAL PALM	19	-
7268	CUBAN ROYAL PALM	12	-
7281	CUBAN ROYAL PALM	16	-
7311	CUBAN ROYAL PALM	18	REMAIN
7337	CUBAN ROYAL PALM	19	REMAIN
7338	CUBAN ROYAL PALM	19	REMAIN
7345	CUBAN ROYAL PALM	20	REMAIN
7364	PORTER CORPUS	4	REMAIN
7391	SCHEFFIERA	10	REMOVE
7395	EUREKA CLUSTER	3	REMOVE
7414	ORCHID	30	REMAIN
7426	MAHOGANY	18	REMOVE
7471	CUBAN ROYAL PALM	20	REMAIN
7489	CUBAN ROYAL PALM	20	REMAIN
7490	CUBAN ROYAL PALM	20	REMAIN
7607	MAHOGANY	15	REMOVE
7697	MAHOGANY	15	REMOVE
7718	FICUS	16	REMOVE
7723	FICUS	15	REMOVE
7732	FICUS	18	REMOVE
7734	FICUS	20	REMOVE
7834	FICUS	14	REMOVE
7838	FICUS	15	REMOVE
7856	FICUS	15	REMOVE
7951	SYLVESTER PALM	14	REMAIN
7991	SYLVESTER PALM	18	REMAIN
8042	SYLVESTER PALM	14	REMAIN
8046	SYLVESTER PALM	15	REMAIN
8055	SYLVESTER PALM	16	REMAIN
8067	SYLVESTER PALM	14	REMAIN
8126	SYLVESTER PALM	16	REMAIN
8132	SYLVESTER PALM	17	REMAIN
8148	SYLVESTER PALM	16	REMAIN
8169	SYLVESTER PALM	14	REMAIN
8207	CUBAN ROYAL PALM	18	-
8223	CUBAN ROYAL PALM	17	-
8238	CUBAN ROYAL PALM	18	-
8248	CUBAN ROYAL PALM	18	-
8253	CUBAN ROYAL PALM	18	-
8257	CUBAN ROYAL PALM	20	-
8261	CUBAN ROYAL PALM	19	-
8264	CUBAN ROYAL PALM	20	-
8265	CUBAN ROYAL PALM	18	-
8278	CUBAN ROYAL PALM	18	-
8293	CUBAN ROYAL PALM	19	-
8295	CUBAN ROYAL PALM	20	-
8300	CUBAN ROYAL PALM	20	-
8316	CUBAN ROYAL PALM	18	-

TREE TABLE			
Number	Name	DBH (in)	Disposition
8327	CUBAN ROYAL PALM	12	-
8342	CUBAN ROYAL PALM	20	-
8346	CUBAN ROYAL PALM	21	-
8449	CUBAN ROYAL PALM	18	-
8458	CUBAN ROYAL PALM	17	-
8501	CUBAN ROYAL PALM	19	-
8506	CUBAN ROYAL PALM	14	-
8507	CUBAN ROYAL PALM	20	-
8510	CUBAN ROYAL PALM	18	-
8513	CUBAN ROYAL PALM	15	-
8556	CUBAN ROYAL PALM	18	-
8585	CUBAN ROYAL PALM	17	-
8677	FICUS	60	-
8959	COCO PALM	12	-
8960	COCO PALM	12	-
8961	COCO PALM	12	-
8962	COCO PALM	12	-
8963	COCO PALM	12	-
9130	SYLVESTER PALM	14	-
9131	SYLVESTER PALM	16	-
9205	CHRISTMAS PALM	5x3	-
9218	CHRISTMAS PALM	6x3	-
9275	SYLVESTER PALM	15	-
9297	SYLVESTER PALM	16	-
9388	SYLVESTER PALM	17	REMAIN
9535	SYLVESTER PALM	18	REMAIN
9657	LIGUSTRUM	6	REMOVE
9662	LIGUSTRUM	6	REMOVE
9676	LIGUSTRUM	6	REMOVE
9683	LIGUSTRUM	6	REMOVE
9800	MAHOGANY	20	-
9914	LIGUSTRUM	6	REMOVE
9994	LIGUSTRUM	7	REMOVE
10784	ALEXANDER PALM	6X2	-
10785	ALEXANDER PALM	6X2	-
10786	ALEXANDER PALM	4X3	-
10787	ALEXANDER PALM	4X3	-
10788	ALEXANDER PALM	4X3	-
10789	ALEXANDER PALM	4X3	-
10790	ALEXANDER PALM	4X3	-
10796	ALEXANDER PALM	5X3	-
10797	ALEXANDER PALM	3X3	-
10798	ALEXANDER PALM	4X3	-
10805	ALEXANDER PALM	5X3	-
10806	ALEXANDER PALM	5X3	-
10808	TABULIA ROSEA	4.00	-
10876	ALEXANDER PALM	5X3	-
10877	ALEXANDER PALM	5X3	-
10878	ROBELLINI PALM 4X3	4X3	-
10879	ROBELLINI PALM 4X3	4X3	-
10880	ROBELLINI PALM 4X3	4X3	-
10916	DATES	18	-
10917	DATES	18	-
10918	DATES	18	-
10919	DATES	15	-
10948	ALEXANDER PALM	8	-
10949	ALEXANDER PALM	8	-
10950	ALEXANDER PALM	8	-

TREE TABLE			
Number	Name	DBH (in)	Disposition
10951	ALEXANDER PALM	8	-
10952	ALEXANDER PALM	8	-
10953	ALEXANDER PALM	5X3	-
10954	ALEXANDER PALM	5X3	-
10955	ALEXANDER PALM	5X3	-
10956	ALEXANDER PALM	5X3	-
10957	ALEXANDER PALM	5X3	-
10958	ALEXANDER PALM	5X3	-
10959	ALEXANDER PALM	7X3	-
10960	ALEXANDER PALM	4X3	-
10961	ALEXANDER PALM	4X3	-
10962	ALEXANDER PALM	4X3	-
10963	ALEXANDER PALM	4X3	-
10964	ALEXANDER PALM	4X3	-
10965	ALEXANDER PALM	4X3	-
10966	ALEXANDER PALM	8	-
10967	ALEXANDER PALM	6	-
10968	ALEXANDER PALM	8	-
10969	ALEXANDER PALM	6	-
10970	ALEXANDER PALM	6	-
10971	ALEXANDER PALM	6	-
10972	COCO PALM	8	-
10973	COCO PALM	6	-
10974	COCO PALM	6	-
10975	BISMARK PALM	8	-
11051	DATES	20	-
11065	DATES	20	-
11087	DATES	24	-
11102	DATES	18	-
11110	UNKNOWN	4	-
11111	UNKNOWN	5	-
11137	UNKNOWN	4	-
11271	OAK	12	-
11272	OAK	14	-
11273	OAK	12	-
11274	OAK	16	-
11275	OAK	15	-
11276	OAK	8	-
20015	LIGUSTRUM	5	REMOVE
20130	LIGUSTRUM	7	REMOVE
20165	LIGUSTRUM	4	REMOVE
20182	LIGUSTRUM	6	REMOVE
20190	COCO PALM	10	REMOVE
20214	COCO PALM	10	REMOVE
20615	UNKNOWN	17	-
20625	PODOCARPUS	12	-
20629	PODOCARPUS	20	-
20633	PODOCARPUS	19	-
20635	UNKNOWN	15	-
20652	BUTTONWOOD	14	-
20653	BUTTONWOOD	16	-
20654	BUTTONWOOD	16	-
20655	BUTTONWOOD	20	-
20656	BUTTONWOOD	20	-
20660	ALEXANDER PALM	5X3	-
20661	ALEXANDER PALM	5X3	-
20662	ALEXANDER PALM	5X3	-



ABBREVIATIONS KEY  
DIA = DIAMETER  
DR = DOMINICAN REPUBLIC  
HS = HARDSCAPE  
HT = HEIGHT  
LA = LANDSCAPE ARCHITECT  
LS = LANDSCAPE  
MAX = MAXIMUM  
MIN = MINIMUM  
SMI = SMI LANDSCAPE ARCHITECTURE  
TBD = TO BE DETERMINED  
TC = TERRA COTTA  
THK = THICK  
TYP = TYPICAL

GRADING  
BOS = BOTTOM OF STEPS  
ELEV = ELEVATION  
FFE = FINISHED FLOOR ELEVATION  
TOS = TOP OF STEPS  
TOW = TOP OF WALL

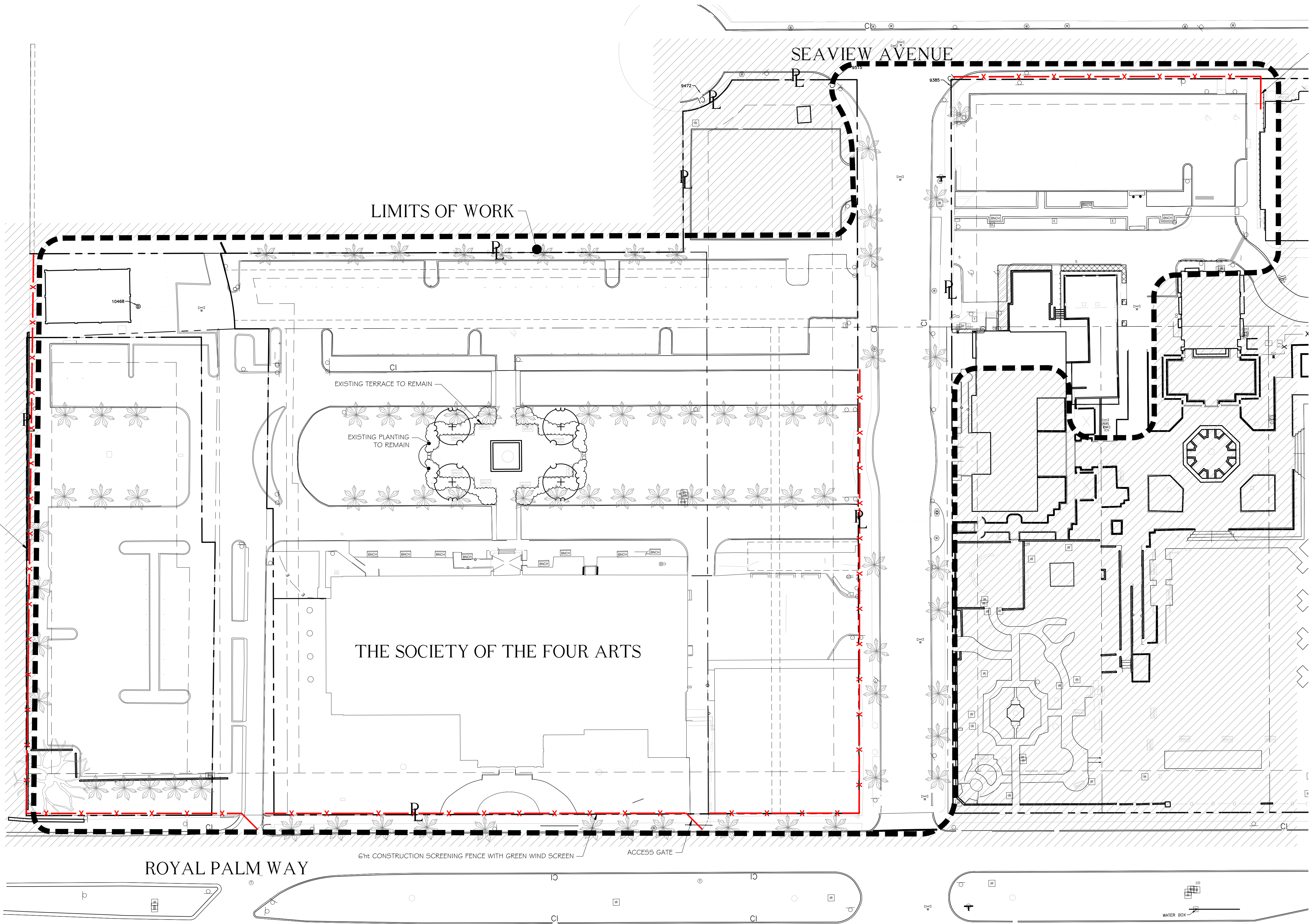

NOTE:  
-EXISTING SOD TO REMAIN  
-CONTRACTOR TO REPAIR SOD AS NEEDED UNTIL CONSTRUCTION BEGINS  
-SOD: STENOTAPHRUM SECUNDATUM 'FLORATAM'  
-LOT SHALL BE SODDED AND IRRIGATED PER TOWN REQUIREMENTS

Survey By: Keith Surveying Job # 13223.00



CONSTRUCTION SCREENING

**CS-1**  
1" = 30'-0"  
Final Submittal



Project no: 2953  
Date: 2024.10.07  
Drawn by: VD  
Project Manager: CFV

Revisions

THESE DRAWINGS ARE FOR THE EXCLUSIVE USE OF SPINA OROURKE + PARTNERS, INC. AND MAY NOT BE REPRODUCED, REPRODUCED OR USED IN ANY MANNER WITHOUT THE EXPRESS WRITTEN CONSENT OF SPINA OROURKE + PARTNERS, INC. ALL RIGHTS RESERVED.

**The Society of the Four Arts**

100 Four Arts Plaza, Palm Beach, FL 33480



**SPINA OROURKE + PARTNERS**

285 Banyan Blvd  
West Palm Beach, Florida 33401

561.684.6844 • Fax: 561.684.5504  
spinaorourke.com

FL Lic # A23802299

Architecture • Interior Design  
Keith M. Spina #AR13419

**BEYER BLINDER BELLE**  
SMI  
120 Broadway  
20th Floor  
New York, NY 10271  
212.777.7800  
beyerblinderbelle.com

LANDSCAPE ARCHITECTURE  
140 Royal Palm Way, Suite 200 Palm Beach, Florida 33480  
Fax: 561.684.5504  
About Our Firm  
FL Registration # LA 13060223





The Society of the Four Arts

100 Four Arts Plaza, Palm Beach, FL 33480

- |  |  |
|--|--|
| <p>THESE DRAWINGS ARE FOR THE EXCLUSIVE USE OF SPINA ORourke • PARTNERS, INC. AND MAY NOT BE DUPLICATED, REPRODUCED OR USED IN ANY MANNER WITHOUT THE EXPRESS WRITTEN CONSENT OF SPINA ORourke • PARTNERS, INC. ALL RIGHTS RESERVED.</p> |  |
| <p><b>Revisions</b></p>  |  |
| <div style="text-align: center; margin-bottom: 20px;"> </div> <div> <p>Project no: 2953<br/>             Date: 2024.10.07<br/>             Drawn by: VD<br/>             Project Manager: CFV</p> </div>                                 |  |
| <h1 style="margin: 0;">TI-1</h1> <p style="font-size: 24px; margin: 10px 0;">NOT TO SCALE</p> <p style="font-size: 18px; margin: 0;">Final Submittal</p>   |  |

**SPINAOROURKE**  
+ PARTNERS  
285 Banyan Blvd  
West Palm Beach Florida 33401  
561 684-6844 • Fax 561 684-5594  
[spinaorourke.com](http://spinaorourke.com)

**BEYER BLINDER BELLE**  
S M I  
LANDSCAPE ARCHITECTURE  
206 Park Boulevard  
New York, NY 10271  
Tel: 212 777 7800  
Fax: 212 777 7890  
[beyerblinderbelle.com](mailto:beyerblinderbelle.com)

**Architecture • Interior Design**  
Keith M. Spina • AR 3419  
Tel: 415 399 0223  
[www.kmsai.net](http://www.kmsai.net)

Architecture • Interior Design  
Keith M. Spina #AR13419



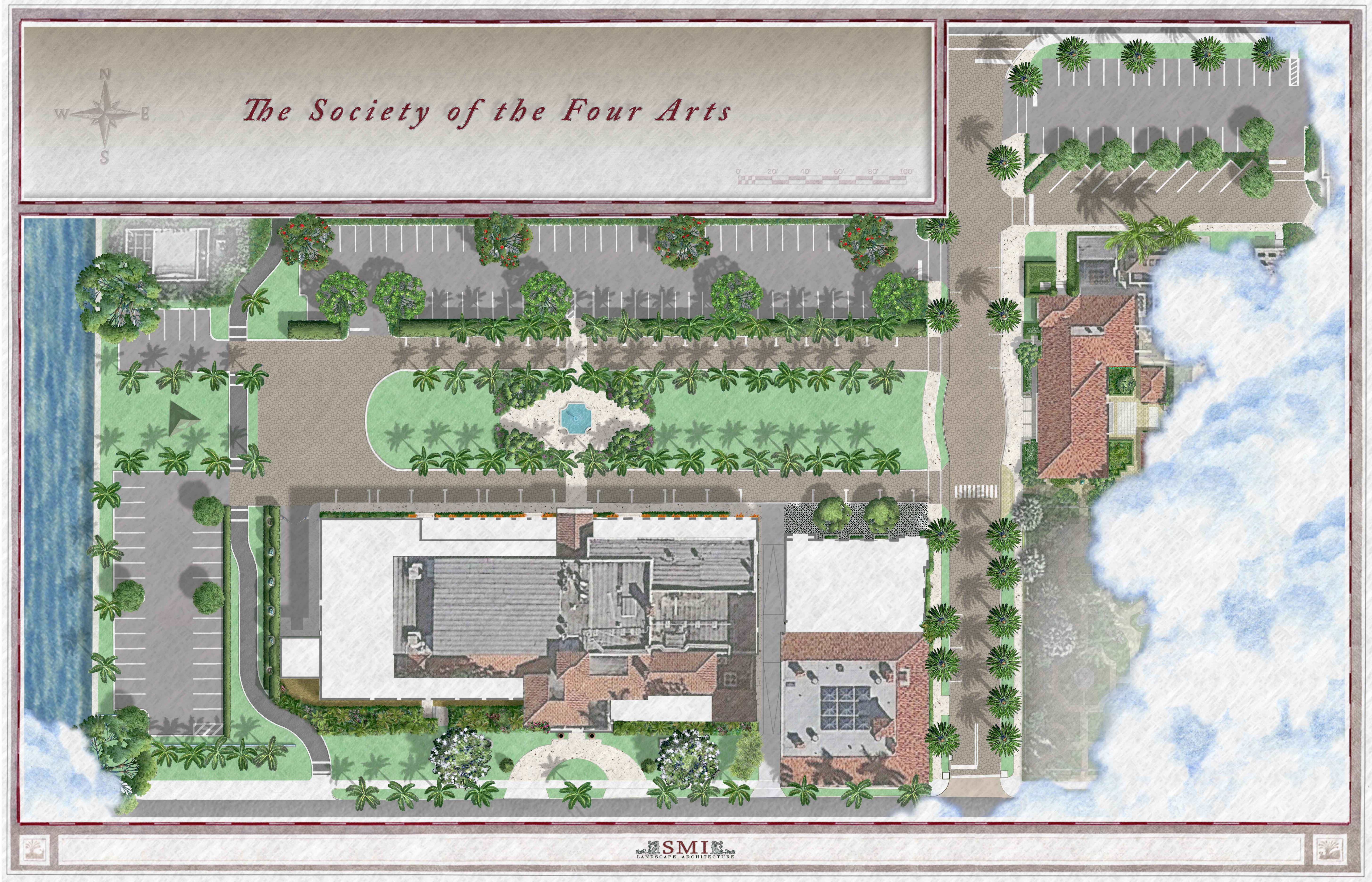

SITE PLAN RENDERING

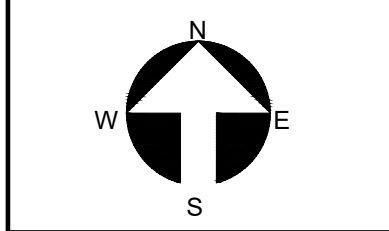

Project no: 2953  
Date: 2024.10.07  
Drawn by: VD  
Project Manager: CFV

Revisions

THESE DRAWINGS ARE FOR THE EXCLUSIVE USE OF SPINA OROURKE + PARTNERS, INC. AND MAY NOT BE DUPLICATED, REPRODUCED OR USED IN ANY MANNER WITHOUT THE EXPRESS WRITTEN CONSENT OF SPINA OROURKE + PARTNERS, INC. ALL RIGHTS RESERVED.



# The Society of the Four Arts

100 Four Arts Plaza, Palm Beach, FL 33480



## SPINA OROURKE + PARTNERS, INC.

Architecture • Interior Design

Kath M. Spina #AR15419

### BEYER BLINDER BELLE SMI

LANDSCAPE ARCHITECTURE

140 Royal Palm Way, Suite 200A Palm Beach, Florida 33480  
Phone: 561.684.6844  
Fax: 561.684.6844  
Email: info@beyerbldbelle.com  
FL Registration #LA 13000223

285 Banyan Blvd  
West Palm Beach Florida 33401  
561.684.6844 • Fax 561.684.6844  
spinaorourke.com  
FL Lic #A23002399

120 Broadway  
20th Floor  
New York, NY 10271  
212.777.7800  
beyerbldbelle.com