

MATERIAL LEGEND

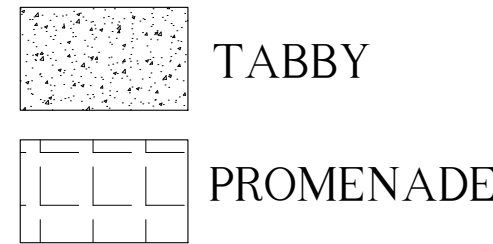

ABBREVIATIONS KEY
DIA = DIAMETER
DR = DOMINICAN REPUBLIC
HS = HARDSCAPE
HT = HEIGHT
LA = LANDSCAPE ARCHITECT
LS = LANDSCAPE
MAX = MAXIMUM
MIN = MINIMUM
SMI = SMI LANDSCAPE ARCHITECTURE
TBD = TO BE DETERMINED
TC = TERRA COTTA
THK = THICK
TYP = TYPICAL

GRADING
BOS = BOTTOM OF STEPS
ELEV = ELEVATION
FFE = FINISHED FLOOR ELEVATION
TOS = TOP OF STEPS
TOW = TOP OF WALL

SMI TO APPROVE LAYOUT OF ALL HARDSCAPE MATERIAL PRIOR TO INSTALLATION

FOUNTAIN / POND NOTES:

- ALL TILE AND STONE TILE ARE DECORATIVE ONLY. SHELL MUST BE IMPERMEABLE PRIOR TO INSTALLATION OF FINISH MATERIAL. ALL MASONRY MATERIAL SHALL BE COMPATIBLE WITH FOUNTAIN / POND CONDITIONS.
- ALL DRAWINGS TO BE ENGINEERED. ENGINEER DRAWINGS PREVAIL FOR CONSTRUCTION.
- CONFIRM OVERFLOW VALVE TYPE (MANUAL OR AUTOMATIC) WITH SMI PRIOR TO INSTALLATION.
- ALL GROUT COLORS TO BE SELECTED BY SMI & APPROVED BY OWNER.
- ENGINEER DWGS. MUST BE PRESENTED TO SMI FOR REVIEW OF OVERALL AESTHETIC DESIGN INTENT.
- CONTRACTOR TO VERIFY ALL DIMENSIONS, LOCATION, & SET BACKS PRIOR TO CONSTRUCTION.
- CONSTRUCTION TO COMPLY WITH ALL APPLICABLE STATE & LOCAL CODES WHETHER INDICATED HERE OR NOT. WHERE COMPLIANCE REQUIRES SUBSTANTIAL DEVIATION FROM THE DESIGN INTENT, AS SHOWN ON THE CONTRACT DRAWINGS, MODIFICATIONS MUST BE REVIEWED BY THE SMI.
- OBTAIN NECESSARY SUB-SURFACE INFORMATION. EXCAVATE & REMOVE ALL MUCK & OTHER UNACCEPTABLE MATERIAL & REPLACE W/ GOOD CLEAN STRUCTURALLY SOUND FILL MATERIAL. PROVIDE DE-WATERING AS NECESSARY.
- OBTAIN ALL NECESSARY PERMITS AS PER STATE & LOCAL CODES.
- INFORMATION SHOWN IS SCHEMATIC IN NATURE. ALL EQUIPMENT TO BE INSTALLED AS PER MANUFACTURER'S SPECIFICATIONS. FOUNTAIN / POND STRUCTURE & ALL EQUIPMENT SHALL BE WARRANTED UNDER CONTRACTORS WARRANTY FOR ONE FULL YEAR FOR PARTS & LABOR.
- TO BE INSTALLED BY LOCAL & STATE LICENSED POOL CONTRACTOR.
- PROVIDE OPERATION AND MAINTENANCE MANUALS TO OWNER UPON COMPLETION OF WORK & ACCEPTANCE BY OWNER.
- ALL EQUIPMENT AND EXPOSED PIPING SHALL BE CLEARLY LABELED W/ PERTINENT DATA SUCH AS, BUT NOT LIMITED TO: PUMP & FILTER SPECIFICATIONS, PIPE SIZE, USE & FLOW DIRECTION, ETC.
- ALL EXPOSED PIPING SHALL BE COPPER (NO EXPOSED PVC PIPES).
- LOCATE PUMP AND ALL MECHANICAL EQUIPMENT PER OWNERS DIRECTION.
- LOCATE CONTROLS FOR LIGHTS, AND FOUNTAINS INSIDE HOUSE PER OWNERS DIRECTION.
- PITCH FLOOR OF BASIN TO DRAIN.
- OVERFLOW DRAIN BY CONTRACTOR TO BE APPROVED BY SMI.
- CONTRACTOR TO INSTALL WATER LEVELER.
- INSTALL ADJUSTMENT VALVE IN VISIBLE LOCATION.

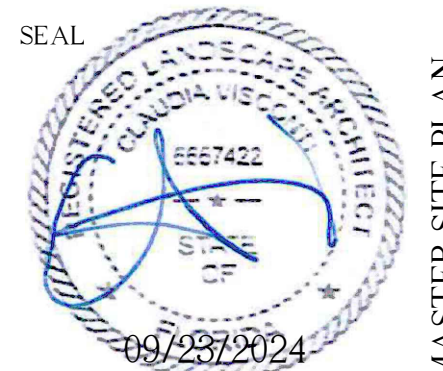
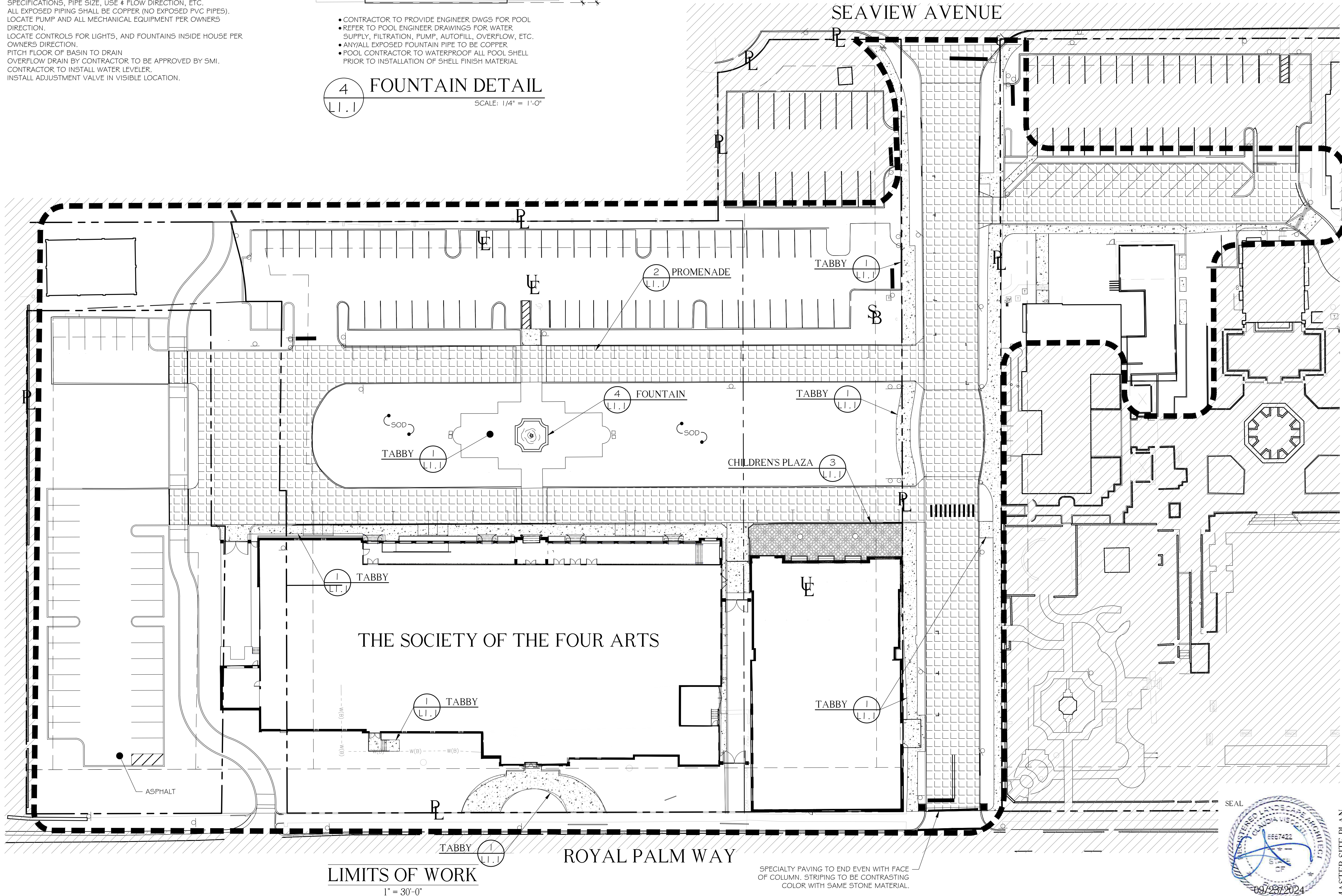
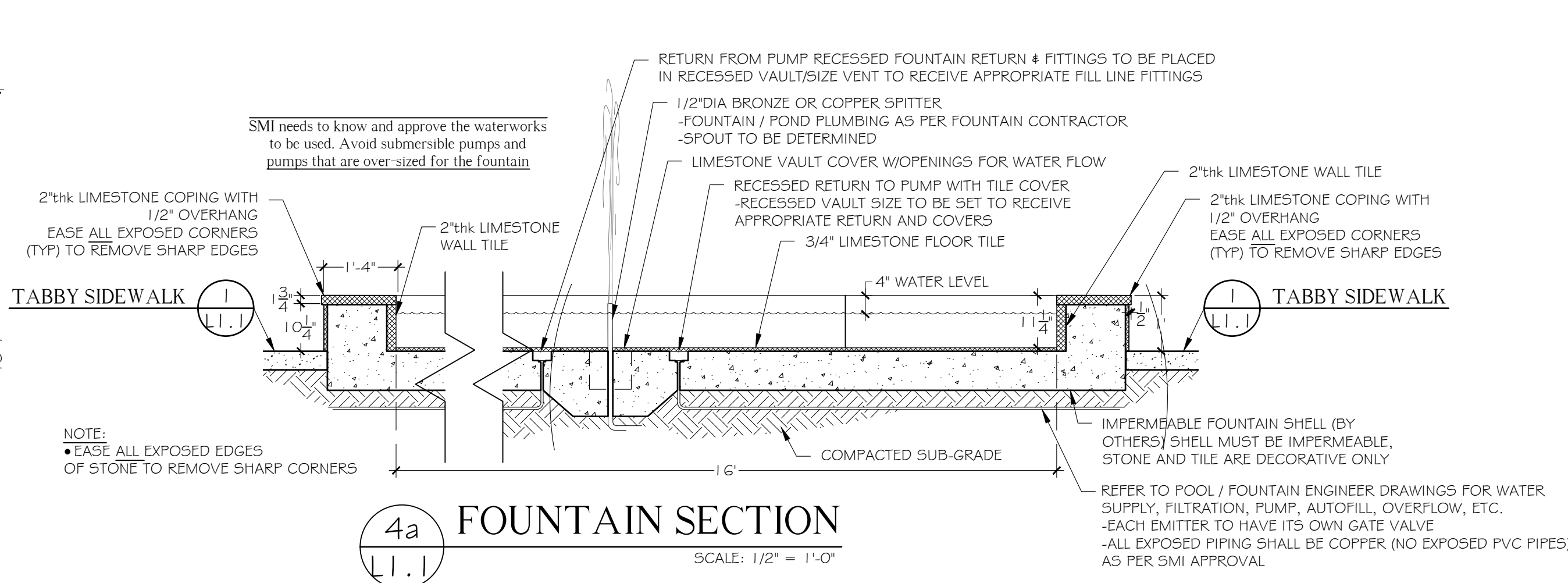
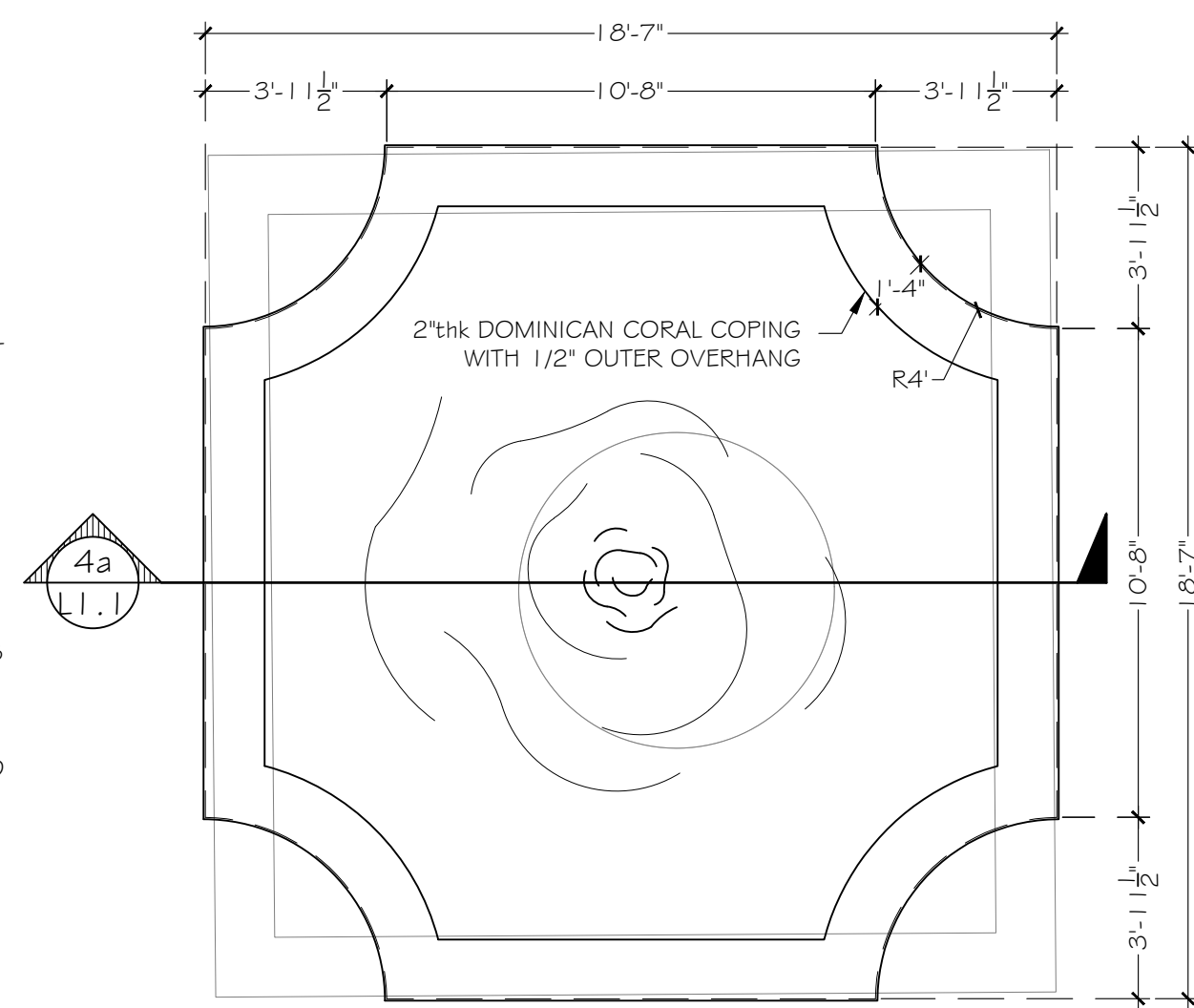

120 Broadway
20th Floor
New York, NY 10271
212 777 7800
beyerblinderbelle.com

285 Banyan Blvd
West Palm Beach, Florida 33401
561.684.6844 • Fax 561.684.6504
spinaorourke.com
FL Lic # A23002399

LANDSCAPE ARCHITECTURE
140 Broad Path Way, Suite 200 Palm Beach, Florida 33480
Tel: 561.684.6844
Fax: 561.684.6504
About Our Firm
FL Registration #LA 13000223

SPINAOROURKE
ARCHITECTS

The Society of the Four Arts
100 Four Arts Plaza, Palm Beach, FL 33480

Architecture • Interior Design
Keith M. Spina #AR13419

THESE DRAWINGS ARE FOR THE EXCLUSIVE USE OF SPINA OROURKE + PARTNERS, INC. AND MAY NOT BE DUPLICATED, REPRODUCED OR USED IN ANY MANNER WITHOUT THE EXPRESS WRITTEN CONSENT OF SPINA OROURKE + PARTNERS, INC. ALL RIGHTS RESERVED.

Revisions

Project no: 2953
Date: 2024.09.23
Drawn by: VD
Project Manager: CFV

N
W E
S

L1.1
Second Submittal

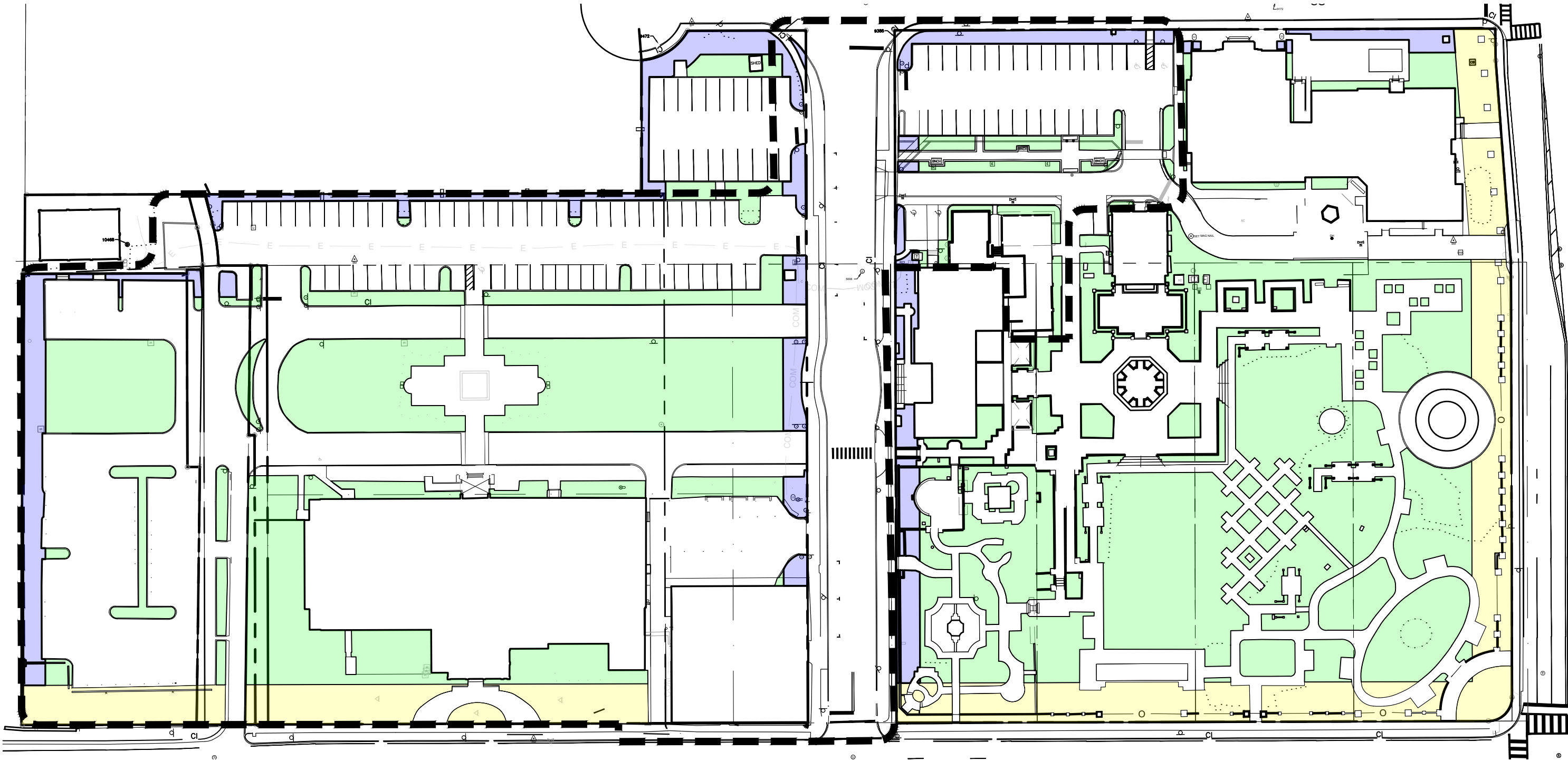

EXISTING SITE PLAN

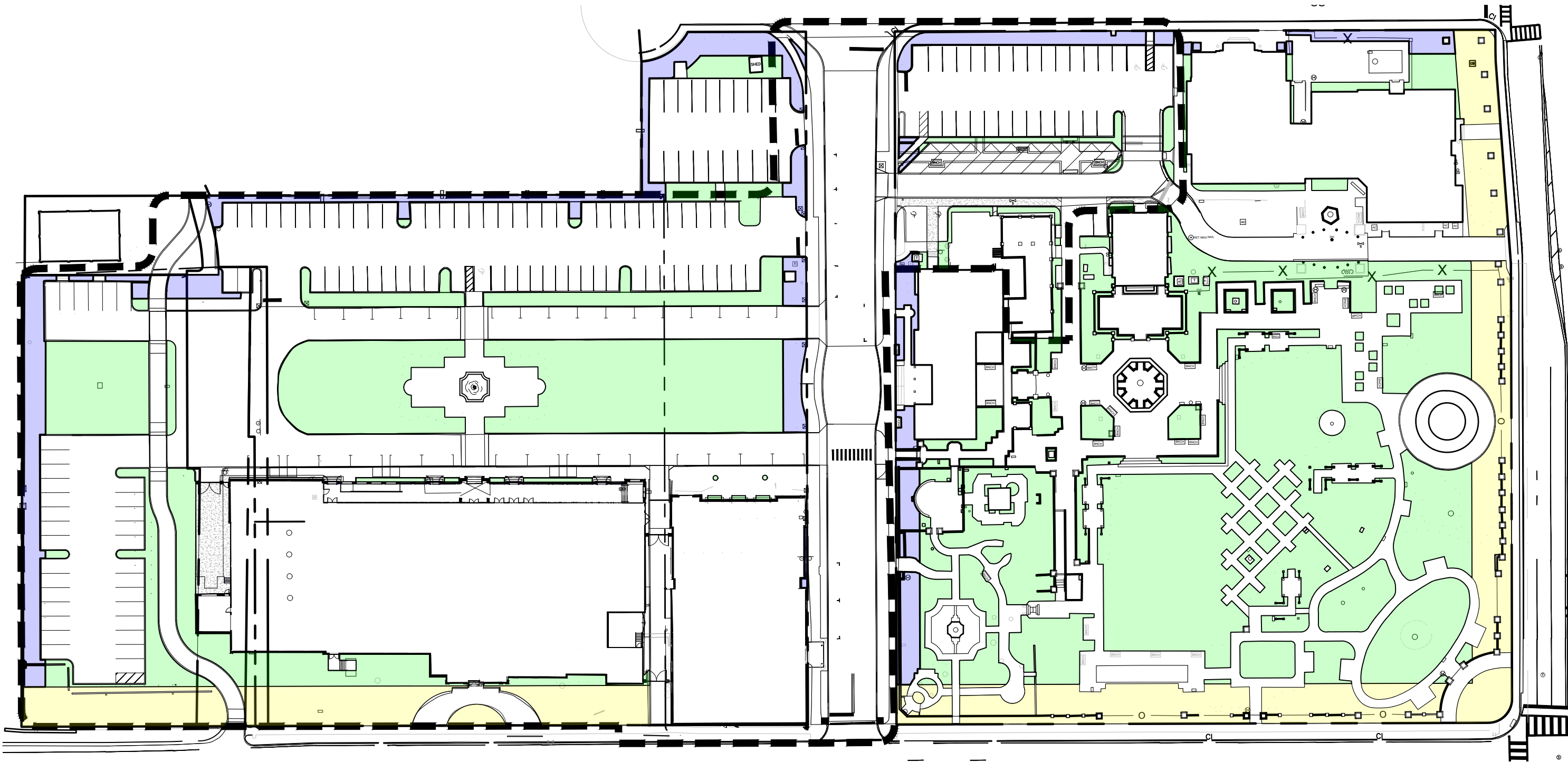

PROPOSED SITE PLAN

Area Calculations (RB): Campus		
All units in square feet, unless noted otherwise		
	Existing	Proposed
Overall Site:	339,840 (100%)	339,840 (100%)
Building:	46,678 (14%)	61,699 (18%)
Impervious/paving/Structures	159,574 (47%)	153,962 (45%)
Landscape open space	133,588 (39%)	124,179 (37%)
Required landscape open space is 50% (339,840 x .50 = 169,920 sf required Overall Site)		
Front Yard	N/A	
No front yard exists within limits of work		

Pervious

Front Yard Pervious

Perimeter Pervious

Color Key

SMI TO APPROVE LAYOUT OF ALL HARDSCAPE MATERIAL PRIOR TO INSTALLATION

- ABBREVIATIONS KEY
- DIA = Diameter
 - DR = Dominican Republic
 - HS = HardScape
 - HT = Height
 - LA = Landscape Architect
 - LS = LandScape
 - MAX = MAXimum
 - MIN = MINimum
 - SMI = SMI Landscape Architecture
 - TBD = To Be Determined
 - TC = Terra Cotta
 - THK = Thick
 - TYP = TYPical
- GRADING
- BOS = Bottom Of Steps
 - ELEV = ELEVation
 - FFE = Finished Floor Elevation
 - TOS = Top Of Steps
 - TOW = Top Of Wall



SITE COMPARISON PLAN

L-1.1a

NTS
Second Submittal

Project no: 2953
Date: 2024.09.23
Drawn by: VD
Project Manager: CFV

Revisions

THESE DRAWINGS ARE FOR THE EXCLUSIVE USE OF SPINA OROURKE + PARTNERS, INC. AND MAY NOT BE DUPLICATED, REPRODUCED OR USED IN ANY MANNER WITHOUT THE EXPRESS WRITTEN CONSENT OF SPINA OROURKE + PARTNERS, INC. ALL RIGHTS RESERVED.

The Society of the Four Arts

100 Four Arts Plaza, Palm Beach, FL 33480

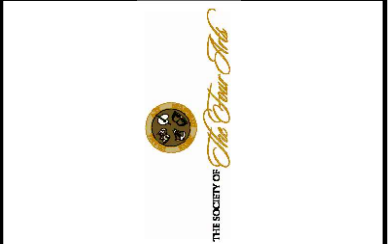

SPINA OROURKE + PARTNERS, INC.
Architecture • Interior Design
Keith M. Spina #AR15419

285 Banyan Blvd
West Palm Beach, Florida 33401
561.684.6844 • Fax 561.684.5504
spinaorourke.com
FL Lic # A23802299

BEYER BLINDER BELLE
SMI
LANDSCAPE ARCHITECTURE
140 Royal Palm Way, Suite 200 Palm Beach, Florida 33480
P.O. Box 508008
West Palm Beach, FL 33408
FL registration # LA 1300223
beyerblinderbelle.com

120 Broadway
20th Floor
New York, NY 10271
212.777.7800

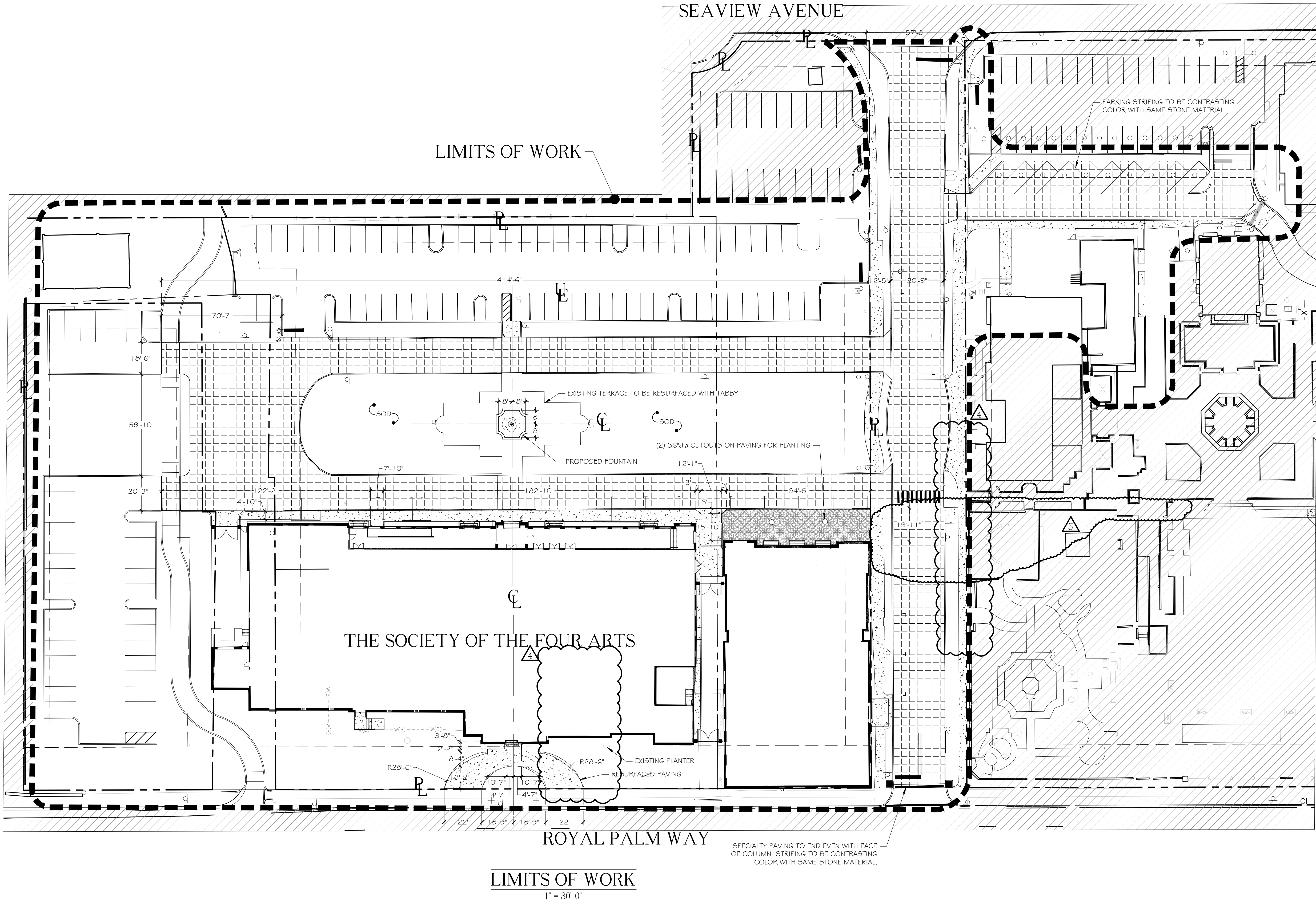

ABBREVIATIONS KEY
DIA = DIAMETER
DR = DOMINICAN REPUBLIC
HS = HARDSCAPE
HT = HEIGHT
LA = LANDSCAPE ARCHITECT
LS = LANDSCAPE
MAX = MAXIMUM
MIN = MINIMUM
SMI = SMI LANDSCAPE ARCHITECTURE
TBD = TO BE DETERMINED
TC = TERRA COTTA
THK = THICK
TYP = TYPICAL

GRADING
DOS = BOTTOM OF STEPS
ELEV = ELEVATION
FFE = FINISHED FLOOR ELEVATION
TOS = TOP OF STEPS
TOW = TOP OF WALL

SMI TO APPROVE LAYOUT OF
ALL HARDSCAPE MATERIAL
PRIOR TO INSTALLATION

Survey By: Keith Surveying Job # 13223.00

BEYER BLINDER BELLE SMI
285 Banyan Blvd
West Palm Beach, Florida 33401
561.684.6844 • Fax 561.684.5504
spinaorourke.com
FL Lic # A23002399
LANDSCAPE ARCHITECTURE
140 Royal Palm Way, Suite 200 Palm Beach, Florida 33480
Fax 561.684.5506
about@spinaorourke.com
FL registration # LA 1306023

SPINAOROURKE + PARTNERS
The Society of the Four Arts
100 Four Arts Plaza, Palm Beach, FL 33480

THESE DRAWINGS ARE FOR THE
EXCLUSIVE USE OF SPINA OROURKE +
PARTNERS, INC. AND MAY NOT BE
DUPLICATED, REPRODUCED OR USED
IN ANY MANNER WITHOUT THE
EXPRESS WRITTEN CONSENT OF SPINA
OROURKE + PARTNERS, INC. ALL
RIGHTS RESERVED.

Revisions
△

Project no: 2953
Date: 2024.09.23
Drawn by: VD
Project Manager: CFV

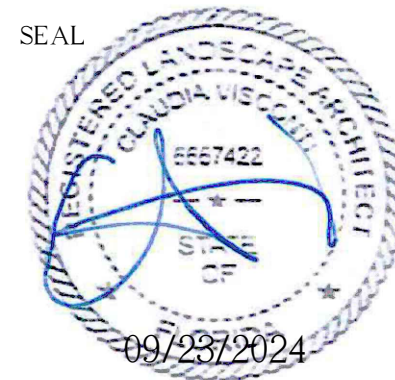
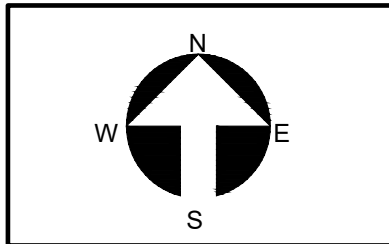

SITE PLAN LAYOUT
L1.2
Second Submittal

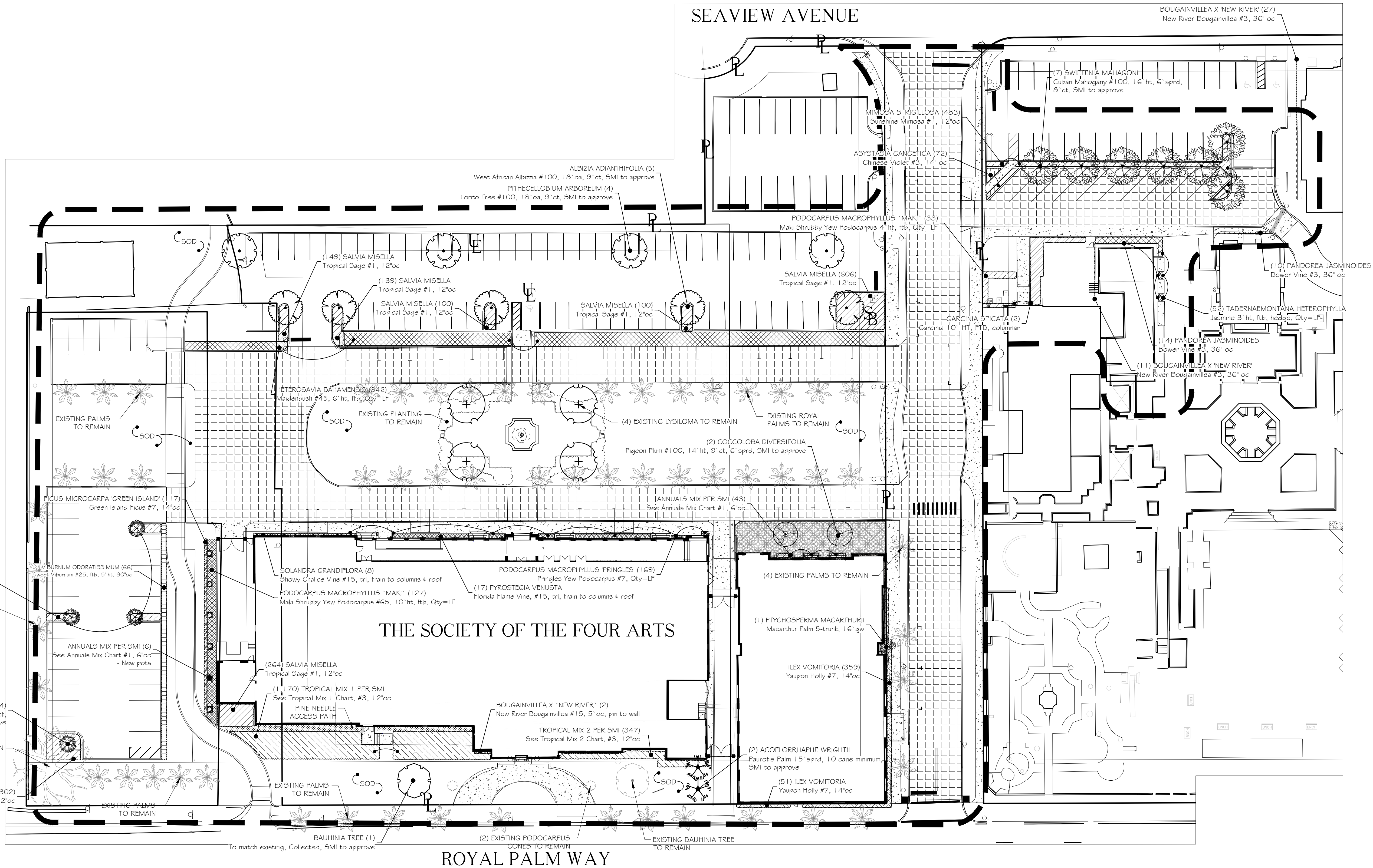

SMI TO APPROVE STAKED LAYOUT OF ALL TREES
AND PLANTING LAYOUT PRIOR TO INSTALLATION

ALL IRRIGATION, IRRIGATION EQUIPMENT AND
IRRIGATION BOXES TO BE CONCEALED

ALL PLANTING BEDS ABUTTING LAWN
TO HAVE METAL EDGE BORDER

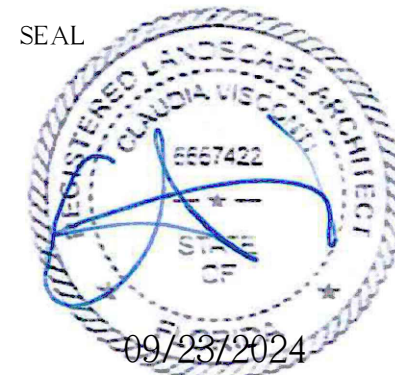

PLANTING PLAN

L2.1

1" = 30'-0"
Second Submittal

The Society of the Four Arts

100 Four Arts Plaza, Palm Beach, FL 33480

THESE DRAWINGS ARE FOR THE
EXCLUSIVE USE OF SPINA OROURKE +
PARTNERS, INC. AND MAY NOT BE
DUPLICATED, REPRODUCED OR USED
IN ANY MANNER WITHOUT THE
EXPRESS WRITTEN CONSENT OF SPINA
OROURKE + PARTNERS, INC. ALL
RIGHTS RESERVED.

Revisions

Project no: 2953
Date: 2024.09.23
Drawn by: VD
Project Manager: CFV

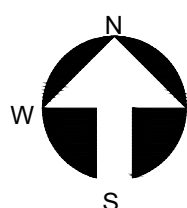

SPINA OROURKE + PARTNERS, INC.
285 Banyan Blvd
West Palm Beach, Florida 33401
561.684.6844 • Fax 561.684.6504
spinaorourke.com
FL Lic #A28002999

BEYER BLINDER BELLE
SMI
LANDSCAPE ARCHITECTURE
140 Royal Palm Way, Suite 200 Palm Beach, Florida 33480
P.O. Box 100000
West Palm Beach, FL 33402
FL registration #LA 1300023

Architecture • Interior Design
Keith M. Spina #AR15419

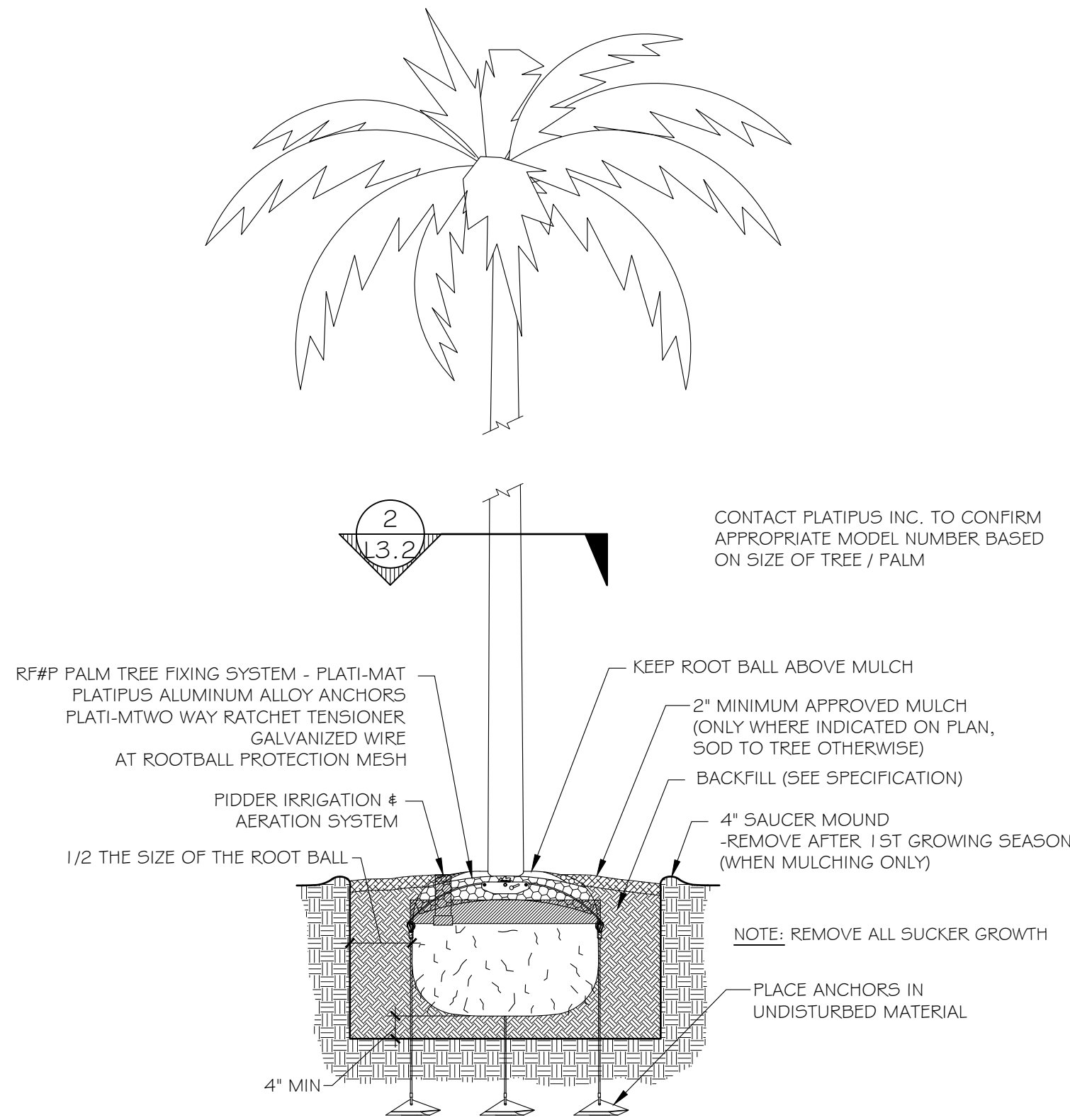

1
L3.2
PLATIPUS TREE ANCHORING
DETAIL
SCALE: NOT TO SCALE

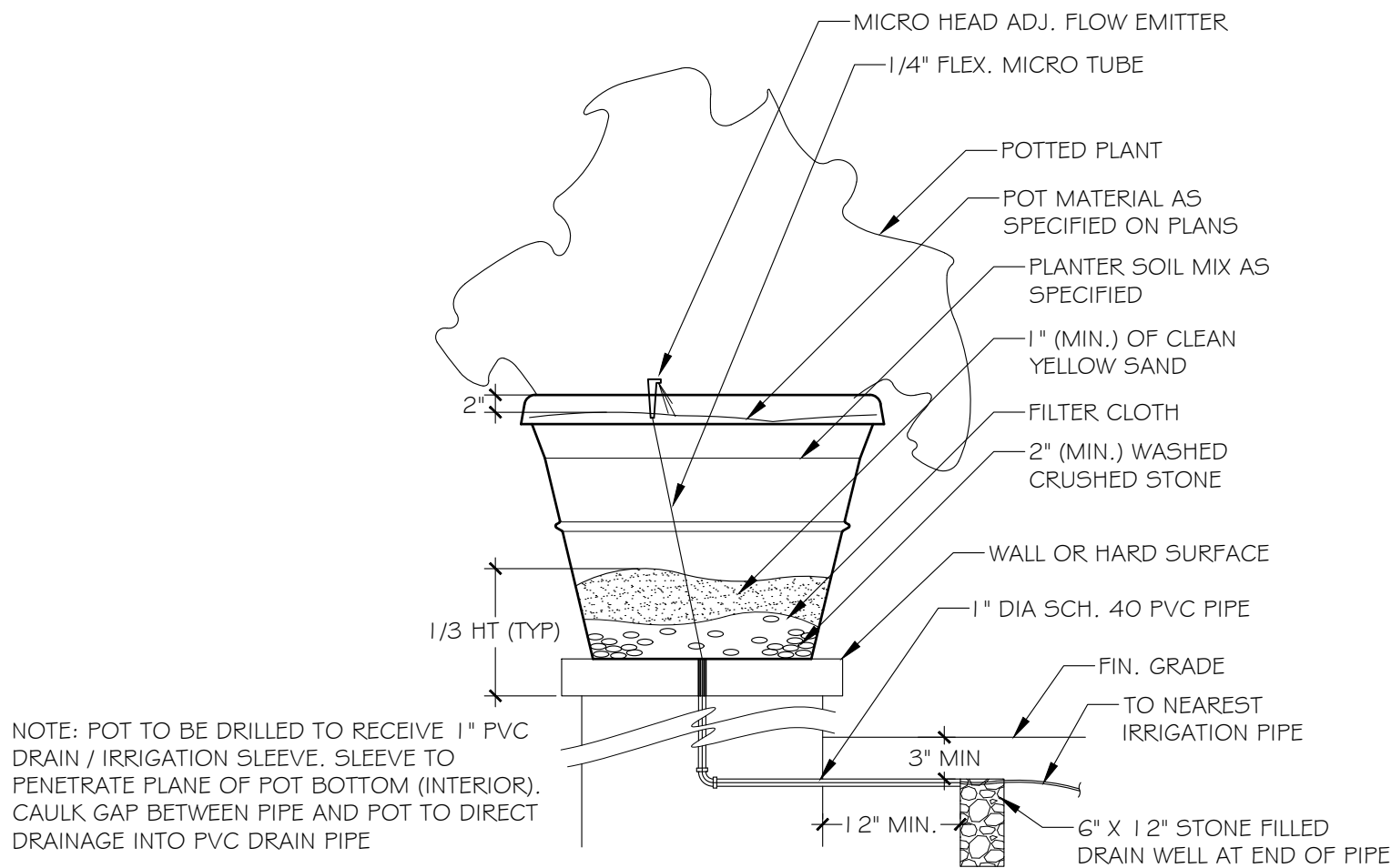

4
L3.2
POTTED PLANT DETAIL
SCALE: NOT TO SCALE

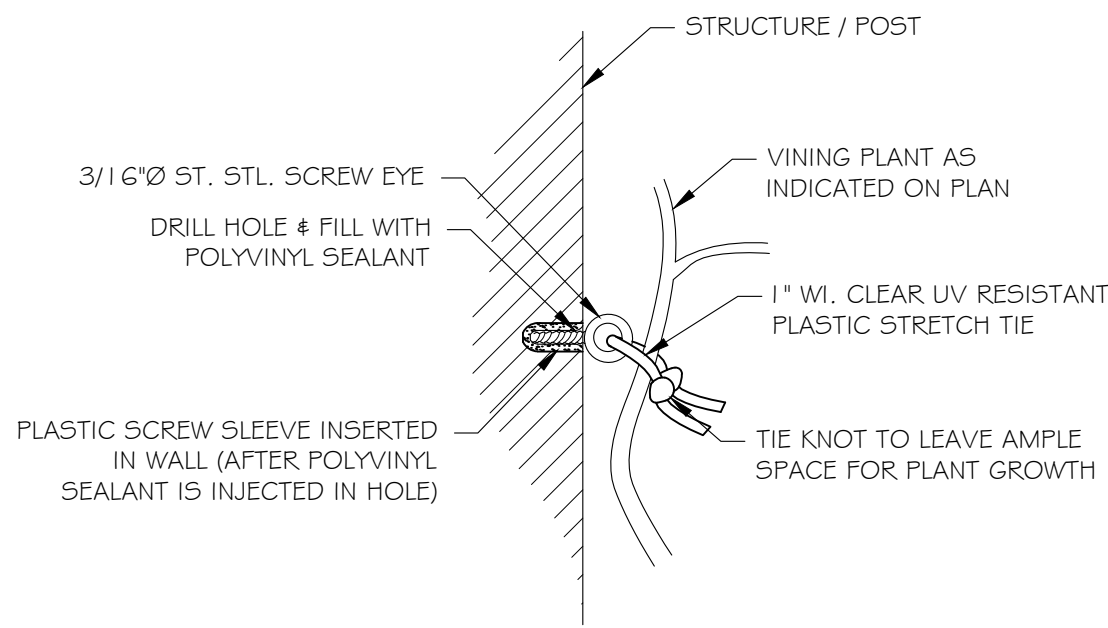

PIN TO WALL

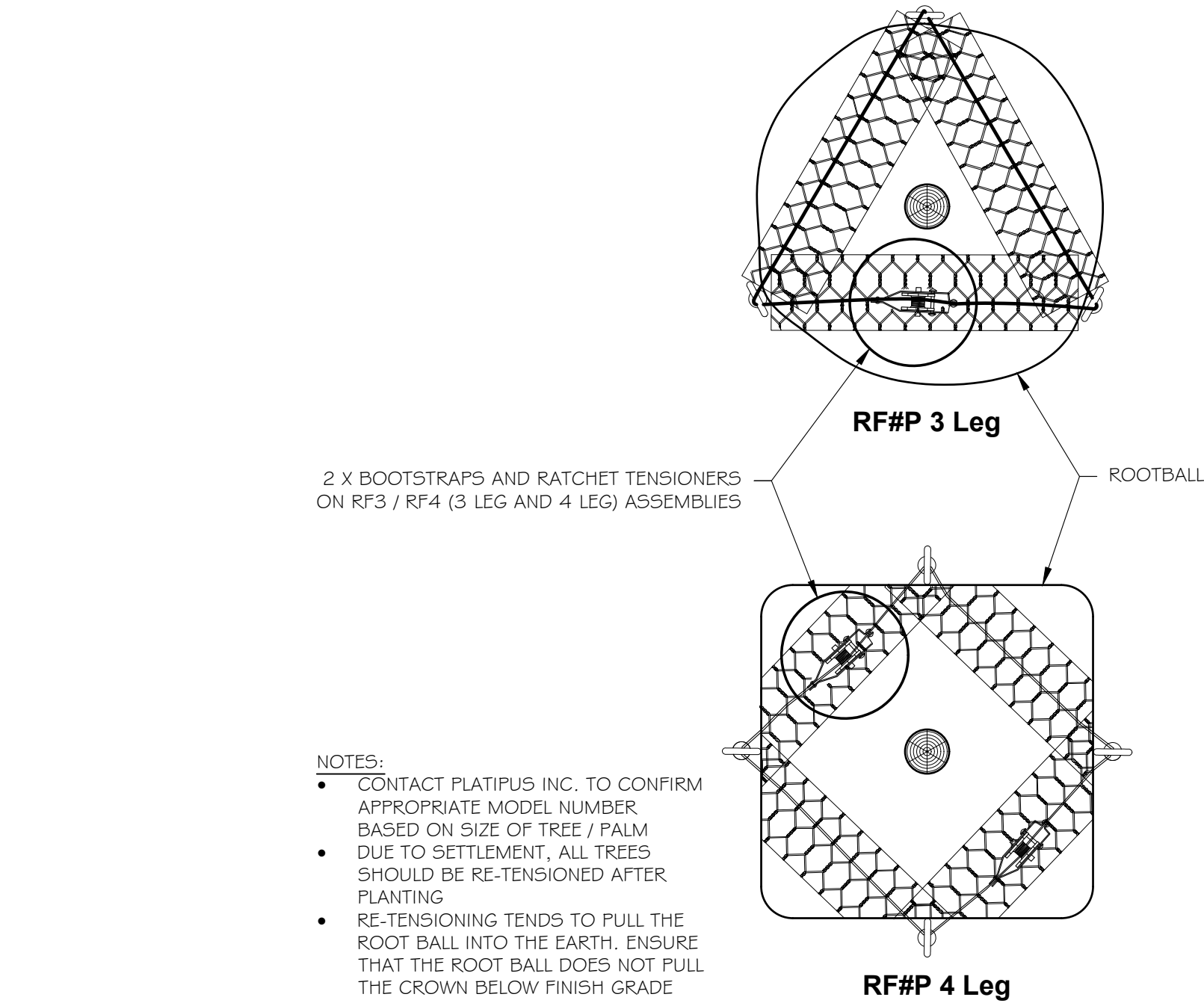

2
L3.2
PLATIPUS ROOTBALL BOOTSTRAP
DETAIL
SCALE: NOT TO SCALE

ALL SOD PLANTED BETWEEN STONE TO BE CASHMERE ZOYSIA REGARDLESS OF OVERALL SITE SOD TYPE

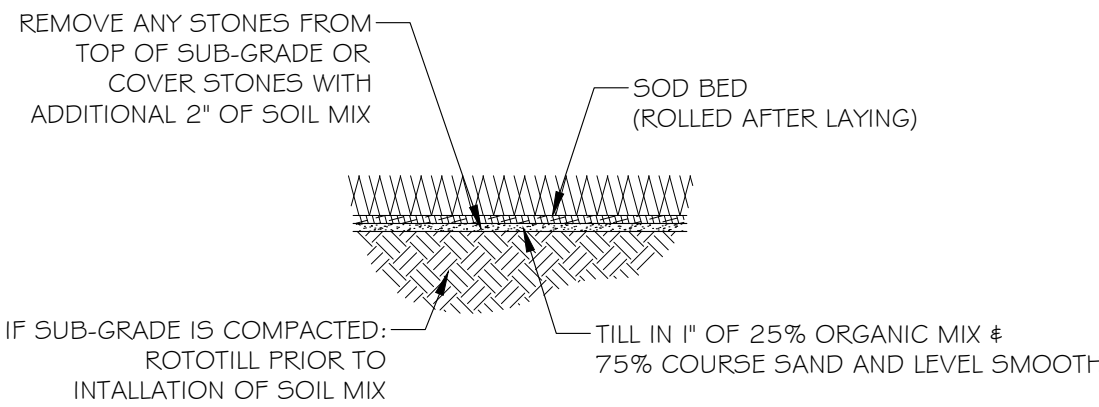

5
L3.2
SOD PLANTING DETAIL
SCALE: 1/2\"/>

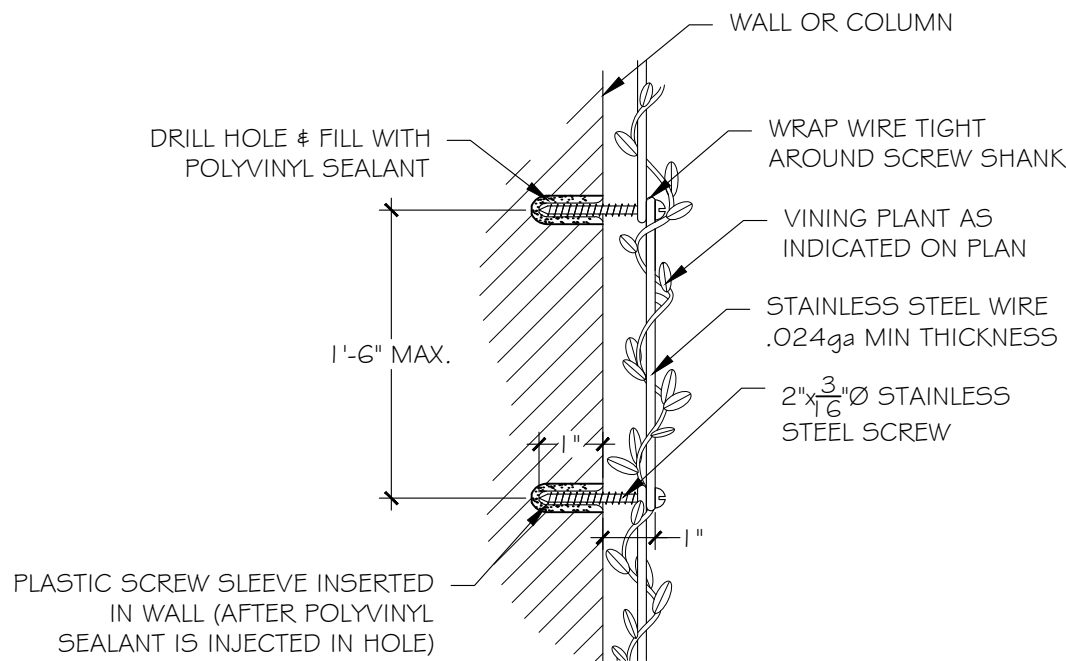

WIRE TO WALL

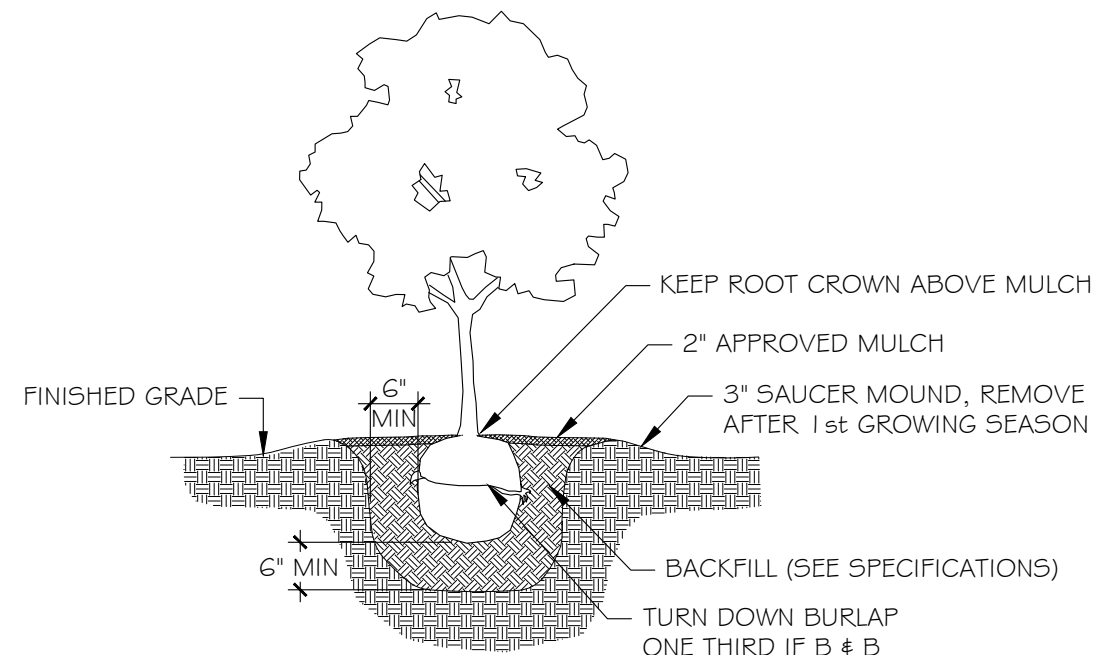

3
L3.2
SHRUB PLANTING DETAIL
SCALE: NOT TO SCALE

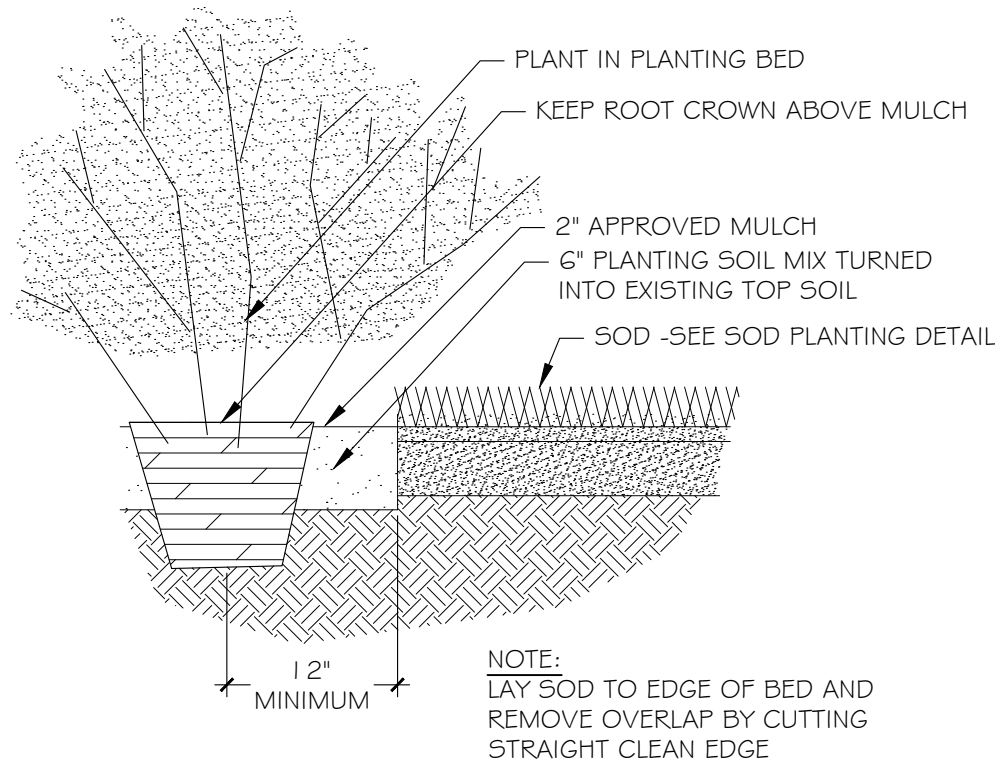

6
L3.2
PLANTING BED DETAIL
SCALE: NOT TO SCALE

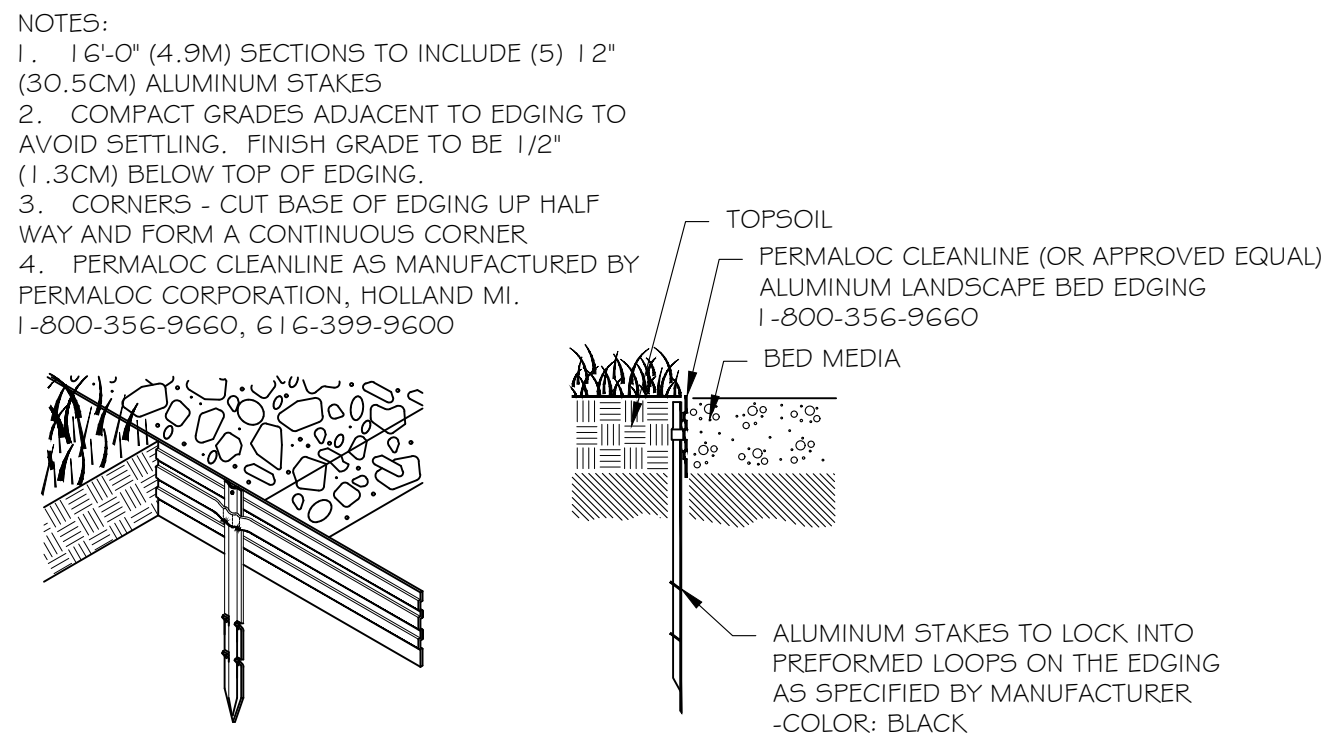

8
L3.2
PLANT BED EDGING DETAIL
SCALE: NTS

SMI TO APPROVE STAKED LAYOUT OF ALL TREES AND PLANTING LAYOUT PRIOR TO INSTALLATION

ALL IRRIGATION, IRRIGATION EQUIPMENT AND IRRIGATION BOXES TO BE CONCEALED

ALL PLANTING BEDS ABUTTING LAWN TO HAVE METAL EDGE BORDER

7
L3.2
VINE SUPPORT DETAIL
SCALE: NOT TO SCALE

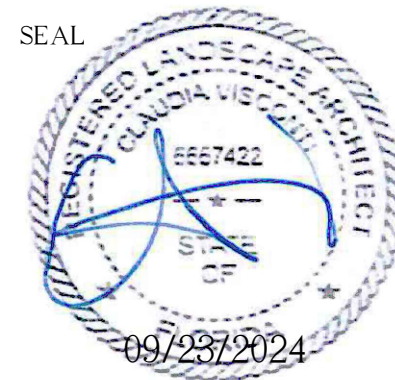

PLANTING DETAILS

L2.2

N.T.S.
Second Submittal

PLANTING SPECIFICATIONS

PLEASE FURNISH FLORIDA CERTIFIED LANDSCAPE CONTACTORS (FCLC) REGISTRATION NUMBER WITH PROPOSAL.

GENERAL CONDITIONS

SCOPE:

1. THE WORK INCLUDED IN THESE SPECIFICATIONS SHALL CONSIST OF THE FURNISHING OF ALL LABOR, TOOLS, MATERIALS, PERMITS, ETC., NECESSARY FOR THE EXECUTION OF THE WORK AS HEREIN SPECIFIED AND SHOWN ON THE DRAWINGS.

2. THE LANDSCAPE CONTRACTOR SHALL INSTALL ALL MATERIAL IN ACCORDANCE WITH SOUND NURSERY PRACTICE AND SHALL PERFORM MAINTENANCE AND WATERING UNTIL FINAL COMPLETION AND ACCEPTANCE BY THE LANDSCAPE ARCHITECT.

EXAMINATION OF DRAWINGS AND SITE:

1. THE LANDSCAPE CONTRACTOR SHALL EXAMINE THE SITE AND FULLY ACQUAINT HIMSELF WITH ALL OF THE EXISTING CONDITIONS IN ORDER THAT NO MISUNDERSTANDING MAY AFTERWARDS ARISE AS TO THE CHARACTER OR AS TO THE EXTENT OF THE WORK TO BE DONE, AND LIKEWISE, IN ORDER TO ADVISE AND ACQUAINT HIMSELF WITH ALL PRECAUTIONS TO BE TAKEN IN ORDER TO AVOID INJURY TO PERSONS OR PROPERTY OF ANOTHER. NO ADDITIONAL COMPENSATION WILL BE GRANTED BECAUSE OF ANY UNUSUAL DIFFICULTIES THAT MAY BE ENCOUNTERED IN THE EXECUTION OR MAINTENANCE OF ANY PORTION OF THE WORK. ANY DISCREPANCIES, OR OMISSIONS OR DOUBTS AS TO MEANING SHALL BE COMMUNICATED TO THE LANDSCAPE ARCHITECT, WHO WILL MAKE ANY INTERPRETATIONS HE/SHE DEEMS NECESSARY.

PLANT LIST:

1. ANY DISCREPANCY BETWEEN THE PLANT LIST AND THE DRAWINGS SHALL BE CONSIDERED AS CORRECT ON THE DRAWINGS.

PROTECTION OF PUBLIC AND PROPERTY:

1. THE LANDSCAPE CONTRACTOR SHALL PROTECT ALL MATERIALS AND WORK AGAINST INJURY FROM ANY CAUSE AND SHALL PROVIDE AND MAINTAIN ALL NECESSARY GUARDS FOR THE PROTECTION OF THE PUBLIC. HE SHALL BE HELD RESPONSIBLE FOR ANY DAMAGE OR INJURY TO A PERSON OR PROPERTY WHICH MAY OCCUR AS A RESULT OF HIS FAULT OR NEGLIGENCE IN THE EXECUTION OF THE WORK.

2. THE LANDSCAPE CONTRACTOR SHALL MAINTAIN WORKMAN'S COMPENSATION, COMPREHENSIVE GENERAL LIABILITY INSURANCE (\$1,000,000) AND PROPERTY DAMAGE INSURANCE (\$1,000,000.00). A COPY OF THE CERTIFICATE OF INSURANCE MUST BE FURNISHED TO OWNER.

GUARANTEE:

1. THE GUARANTEE PERIOD FOR ALL MATERIAL SHALL BEGIN AFTER FINAL APPROVAL BY LANDSCAPE ARCHITECT.

2. ALL MATERIAL EXCEPT SOD SHALL BE GUARANTEED FOR ONE YEAR PROVIDED IT RECEIVES PROPER MAINTENANCE (AS PRESCRIBED BY THE LANDSCAPE CONTRACTOR) BY THE OWNER AND IS NOT DAMAGED OR DESTROYED BY HURRICANES OR OTHER CAUSES BEYOND THE CONTRACTOR'S CONTROL.

3. IT IS THE RESPONSIBILITY OF THE LANDSCAPE CONTRACTOR TO BRING TO THE ATTENTION OF THE LANDSCAPE ARCHITECT THE OWNER'S NEGLIGENCE TO PROVIDE PROPER CARE OF THE MATERIAL.

4. ALL REPLACEMENT COST OF GUARANTEED MATERIAL, INCLUDING EQUIPMENT, AND LABOR, SHALL BE THE RESPONSIBILITY OF THE CONTRACTOR

AWARD OF CONTRACT:

1. ONLY UNIT PRICE-INSTALLED BIDS FOR THE WORK WILL BE ACCEPTABLE. HOWEVER, THE OWNER RETAINS THE RIGHT TO DELETE PORTIONS OF THE WORK FROM THE CONTRACT AND/OR AWARD SEPARATE CONTRACTS FOR PHASES OF THE PROJECT. THE LANDSCAPE ARCHITECT RESERVES THE RIGHT TO REJECT ANY AND ALL BIDS WHEN SUCH REJECTIONS ARE IN THE INTEREST OF THE OWNER.

EXECUTION OF THE WORK:

1. THE LANDSCAPE CONTRACTOR SHALL HAVE HIS LABOR CREWS CONTROLLED AND DIRECTED BY A LANDSCAPE FOREMAN WELL Versed IN PLANT MATERIALS, PLANTING, READING OF BLUEPRINTS AND COORDINATION BETWEEN JOB AND NURSERY IN ORDER TO EXECUTE INSTALLATION RAPIDLY AND CORRECTLY.

WATER:

1. WATER SOURCE SHALL BE FURNISHED BY THE OWNER.

2. IT IS THE RESPONSIBILITY OF THE LANDSCAPE CONTRACTOR TO COORDINATE HIS WORK WITH IRRIGATION CONTRACTOR.

3. ALL PLANT MATERIAL INSTALLED PRIOR TO THE INSTALLATION OF THE IRRIGATION SYSTEM SHALL BE WATERED WITH A TEMPORARY SYSTEM BY THE LANDSCAPE CONTRACTOR.

IRRIGATION:

-DRIP IRRIGATION MAY ONLY BE USED IF SPECIFIED BY SMI OR IF REQUIRED BY MUNICIPALITY

GRADING:

1. THE GENERAL CONTRACTOR SHALL BE RESPONSIBLE FOR ALL SUBGRADE OF LANDSCAPE AREAS UNLESS OTHERWISE SPECIFIED. THE TERRAIN SUBGRADE SHALL BE DEFINED AS 4"-6" BELOW FINISH GRADE UNLESS OTHERWISE NOTED ON PLANS.

2. THE LANDSCAPE CONTRACTOR SHALL BE RESPONSIBLE FOR ALL FINISHED AND FINE GRADING WITHIN PLANTER BEDS AND THE FILLING OF PLANTER BOXES. THE LANDSCAPE CONTRACTOR SHALL REMOVE ALL EXCESS SOIL AND DEBRIS ACCUMULATED DURING HIS WORK.

3. THE SOD CONTRACTOR SHALL BE RESPONSIBLE FOR FINISH GRADE IN ALL SODDED AREAS. SEE SPECIFICATIONS RELATING TO SPECIES GROWERS.

TO PROTECT AGAINST GANODERMA PALM FUNGUS ALWAYS REMOVE ALL PALM STUMPS FROM PROPERTY - STUMPS ACT AS HOSTS TO THIS DESTRUCTIVE LONG LIVED FUNGUS.

DIGGING

1. THE LANDSCAPE CONTRACTOR SHALL EXERCISE CARE IN DIGGING AND OTHER WORK SO AS NOT TO DAMAGE EXISTING WORK, INCLUDING UNDERGROUND AND OVERHEAD PIPES AND CABLES. SHOULD SUCH UNDERGROUND AND OVERHEAD OBSTRUCTIONS BE ENCOUNTERED WHICH INTERFERE WITH PLANTING, THE LANDSCAPE ARCHITECT OR THE OWNER'S AUTHORIZED REPRESENTATIVE SHALL BE CONSULTED AND WILL ADJUST THE LOCATION OF PLANTS TO CLEAR SUCH OBSTRUCTION OR MOVE THE OBSTRUCTION.

2. THE LANDSCAPE CONTRACTOR SHALL BE RESPONSIBLE FOR THE IMMEDIATE REPAIR OF ANY DAMAGE CAUSED BY HIS WORK. PLANTING PITS

1. EXCAVATE CIRCULAR PITS WITH VERTICAL SIDES FOR ALL PLANTS, EXCEPT FOR HEDGES AND PLANTS SPECIFICALLY DESIGNATED TO BE PLANTED IN BEDS. DIAMETER OF PITS OF TREES AND SHRUBS SHALL BE AT LEAST 1/3 LARGER THAN THE DIAMETER OF THE BALL.

2. EXCAVATE PLANTING PITS AND PLANTING BEDS, PREPARE FINE SUBGRADE THROUGHOUT ALL PITS AND BEDS, AND PLACE THE PLANTS TO BE PLANTED FOR APPROVAL BY LANDSCAPE ARCHITECT BEFORE INSTALLATION.

PRUNING

1. REMOVE DEAD AND BROKEN BRANCHES FROM ALL PLANT MATERIAL IMMEDIATELY. PRUNE TO RETAIN TYPICAL GROWTH HABIT OF INDIVIDUAL PLANTS WITH AS MUCH HEIGHT AND SPREAD AS IS PRACTICAL.

2. HEDGE MATERIALS TO BE PULLED IN, TIED AND TRIMMED TO VERTICAL AFTER INSTALLATION, WITH A FINISHED APPEARANCE UNLESS OTHERWISE NOTED.

TREE BRACING AND GUYING

1. REMEMBER TO CONSIDER SOIL CONDITIONS WHEN PLANTING TREES IN MADE UP GROUND AND THE NEED TO PLACE THE ANCHORS IN A UNDISTURBED MATERIAL.. IF SO,YOU CAN ORDER 'ED' KITS (EXTRA DEPTH). TO ALLOW FOR THIS YOU MAY ALSO NEED A LONGER DRIVE ROD.

2. THE ANCHOR SHOULD BE DRIVEN TO THE FULL WORKING DEPTH USING A SUITABLE DRIVE ROD.

3. YOU MUST LOADLOCK THE ANCHORS PROPERLY INTO THEIR WORKING POSITION, BY APPLYING AN UPWARDS FORCE / LOAD ON THE WIRE TENDON.

4. IF THE ANCHORS ARE NOT LOADLOCKED PROPERLY, THE TREE WILL BECOME LOOSE WHEN THE FIRST WINDS ARRIVE.

5. PALM TREE ROOTBALLS MUST BE A MINIMUM OF 5'DIAMETER, PROPERLY ROOT WRAPPED AND OF SUFFICIENT STRENGTH AND PROPORTION TO SUPPORT A ROOTBALL FIXING METHOD. THE CORRECT PALM TREE KIT REQUIRED MUST BE SPECIFIED BY THE LANDSCAPE ARCHITECT ONCE THE ROOTBALL DIMENSIONS, TREE HEIGHT AND SAIL AREA OF THE TREE HAVE BEEN ESTABLISHED.

6.THE D-MAN CELLS / DEADMEN SHOULD BE INSTALLED AT LEAST 12" BELOW THE BASE OF THE ROOTBALL WITH THE SOIL COMPACTED ABOVE THE CELLS TO 60%, RIGHT UP TO THE NURSERY LINE.

7.IT IS NOT ADVISABLE TO USE STRAP SYSTEMS FOR CONTAINER GROWN STOCK (SEE PLATI-MAT SYSTEMS).

8. DUE TO SETTLEMENT OF THE TREE & AFTER WATERING RE-TENSIONING IS HIGHLY RECOMMENDED.

9. REFER TO MANUFACTURERS SPECIFICATIONS FOR COMPLETE INSTALLATION INSTRUCTIONS AT WWW.PLATIFUS.US.

10. SMALL TREES SHALL BE GUYED IN THREE DIRECTIONS WITH THREE STRANDS OF NO. 12 GALVANIZED WIRE ATTACHED TO ANCHORS DRIVEN BELOW GRADE. WIRES WHICH COME IN CONTACT WITH THE TREE ARE TO BE ENCASED IN RUBBER HOSE.

PLANT MATERIALS

1. NOMENCLATURE: PLANT NAMES SHALL CONFORM TO THE NAMES GIVEN IN HORTUS III AND IN STANDARDIZED PLANT NAMES, 2001, LATEST EDITION. PREPARED BY THE AMERICAN JOINT COMMITTEE ON HORTICULTURAL NOMENCLATURE. NAMES OF VARIETIES NOT INCLUDED THEREIN, CONFORM GENERALLY WITH NAMES ACCEPTED IN THE NURSERY TRADE.

2. QUALITY: PLANTS SHALL HAVE A HABIT OF GROWTH THAT IS NORMAL FOR THE SPECIES AND SHALL BE SOUND, HEALTHY, VIGOROUS AND FREE FROM INSECT PESTS, PLANT DISEASES AND INJURIES. TREES SHALL BE HEAVILY BRANCHED, OR IN PALMS, HEAVILY LEAFED. REQUIREMENTS FOR THE MEASUREMENT, BRANCHING GRADING, QUALITY, BALLING AND BURLAPPING OF PLANTS IN THE PLANT LISTS GENERALLY FOLLOW THE CODE OF STANDARDS CURRENTLY RECOMMENDED BY THE AMERICAN ASSOCIATION OF NURSERYMEN, INC., AND THE AMERICAN STANDARD FOR NURSERY STOCK. PLANT MATERIAL SHALL BE GRADED AS SPECIFIED ON THE DRAWINGS.

GRADES SHALL CONFORM TO GRADES AND STANDARDS FOR NURSERY STOCK, STATE PLANT BOARD OF FLORIDA. PALMS WITH MARRIED OR BURNED TRUNKS WILL NOT BE ACCEPTED. PLANTS WITH BROKEN, DAMAGED, OR INSUFFICIENT BALLS WILL BE REJECTED. ALL PLANTS SHALL BE FLORIDA FANCY.

3. SUBSTITUTIONS WILL BE PERMITTED ONLY UPON WRITTEN APPROVAL BY THE LANDSCAPE ARCHITECT.

PLANTING SOIL

SOIL BY 'ATLAS SOIL' OR APPROVED ALTERNATE

ALL PLANTING AREAS SHALL BE CLEANEED OF ALL PLANT AND MATERIAL TWO WEEKS PRIOR TO INSTALLATION OF SOIL FOR REMOVAL OF ANY NEEDS.

GROUND COVER BEDS -REMOVE 6" OF EXISTING SOIL AND FILL WITH 4" OF 82TO MIX & TILL/MIX INTO EXISTING SOIL.

SHRUB BEDS -REMOVE 6" OF EXISTING SOIL AND FILL WITH A MIX OF 50% APPROVED SOIL & 50% EXISTING SOIL.

TREE PITS -REMOVE SOIL IN THE AMOUNT OF 1/2 LARGER THAN THE BALL OF THE TREE AND REPLACE WITH A MIX OF 50% APPROVED SOIL & 50% EXISTING SOIL.

PALMS -REMOVE SOIL IN THE AMOUNT OF 1/2 LARGER THAN THE BALL OF THE PALM AND REPLACE WITH APPROPRIATE SOIL AND CLEAN YELLOW SAND FREE OF NEEDS.

SOIL SPECS FOR PLANTING BEDS:	SOIL SPECS FOR TREES AND LARGE SHRUBS:
ATLAS PEAT & SOIL 82TO MIX	SMILA SOIL MIX (APPROVED SOIL)
50% Pinebark	
40% Florida Peat	
20% can peat	
25% fia peat	
40% pine bark	
15% arlite	
	50% Pinebark
	40% Florida Peat
	10% Coarse Sand
	10lbs Dolomite per/Yard
	10.5lbs TurfPro per/Yard
	25 pounds Nutricote 10/6/0-360 P/yard optional

1. SOLE SOURCE - FROM ATLAS PEAT & SOIL INC., P.O. BOX 386T, BOYNTON BEACH, FLORIDA, 33424-386T, (561) 734-7300

PLANTING SOIL NOT MEETING THESE REQUIREMENTS WILL NOT BE ACCEPTED.

1. SOIL FOR PLANTING TREES, SHRUBS AND GROUND COVER SHALL BE SMILA SOIL UNLESS OTHERWISE SPECIFIED ON THE DRAWINGS.

2. IT SHALL BE THE RESPONSIBILITY OF THE LANDSCAPE CONTRACTOR TO REMOVE ANY EXCESS SOIL AND DEBRIS FROM THE SITE. REFER TO THE GRADING PLAN AND GRADING SPECIFICATIONS.

3. LANDSCAPE ARCHITECT MAY REQUEST SOIL ANALYSIS FOR THE TESTING OF PLANTING SOIL UTILIZED BY THE SELECTED LANDSCAPE CONTRACTOR.

FERTILIZER

1. TREES USE ONE 21 GRAM AGRIFORM PLANTING TABLET PER 1/2" TRUNK DIAMETER. SPACE EQUALLY AROUND AT 2/3 DEPTH OF BALL.

2. SHRUBS: AGRIFORM PLANTING TABLETS SHALL BE APPLIED PER THE MANUFACTURERS SUGGESTED APPLICATION RATES.

3. SOD USE FERTILIZER AS PER BELOW WITH TRACE ELEMENTS APPLIED AT THE RATE OF 15 LBS. PER 1000 SQ. FT. PRIOR TO LAYING SOD.

4. POWDERED MYCCHORHIZAE MIX; DIE HARD, 'PLANT HEALTH' CARE OR EQUAL) AND LIQUID B-THRIVE (OR EQUAL) SHOULD BE ADDED TO ALL TREES, SHRUBS AND GROUND COVER PLANTING BEDS AS PER MANUFACTERES DIRECTIONS.

5. ALL TREES, SHRUBS, GROUND COVER AND SOD TO USE LESCO 13-3-13 FERTILIZER AS PER MANUFACTURERS SPECIFICATIONS

MULCH

ALL MULCH FOR THE PROJECT SHALL BE ATLAS GROWN. MULCH SHALL BE APPLIED 2" IN TREES AND PALMS AS SPECIFIED, AND ALL PLANTING BEDS, HEDGE AND SHRUBS, CROWN CROWN OF ROOT BALL ABOVE MULCH

SOLE SOURCE - FROM ATLAS PEAT & SOIL INC., P.O. BOX 386T, BOYNTON BEACH, FLORIDA, 33424-386T, (561) 734-7300

SUBMIT BAG TO LANDSCAPE ARCHITECT FOR APPROVALS.

SABAL PALMS

1. SABAL PALMS SHALL HAVE A MINIMUM TRUNK DIAMETER OF 12" MEASURED 2' ABOVE GROUND.

HEDGES

1. THE LANDSCAPE CONTRACTOR SHALL PROVIDE FULL MATERIAL TO PRODUCE A SOLID SCREEN FROM THE TOP OF HEDGE TO THE BASE OF HEDGE.

2. THE LANDSCAPE CONTRACTOR SHALL BE RESPONSIBLE TO ADD FILLERS TO THE HEDGE AS NEEDED TO PRODUCE A SOLID FULL TO BASE (F.T.B.), SCREEN TO BE INCLUDED IN THE CONTRACTED PRICE.

3. PLANT MATERIAL WITH WEAK OR THIN FOLIAGE WILL NOT BE ACCEPTED.

VINES

1. MATERIALS & INSTALLATION OF VINE SUPPORTS SHALL BE INCLUDED IN UNIT COST OF VINE SPECIFIED

SODDING

1. THE LANDSCAPE CONTRACTOR SHALL SOD ALL AREAS INDICATED AND NOTED ON THE DRAWINGS.

2. NO SODDING SHALL OCCUR UNTIL ALL AREAS TO BE SODDED ARE CLEARED OF ANY ROUGH GRASS, WEEDS, AND DEBRIS, THE GROUND BROUGHT TO AN EVEN GRADE AND SPECIFIED AMENDMENTS HAVE BEEN ADDED. SEE DETAILS FOR SPECIFIC AMENDMENTS AS PER SOD TYPE. ALL SODDED AREAS WILL BE TREATED WITH 'ROUNDUP' HERBICIDE PER MANUFACTURER'S SPECIFICATIONS AT LEAST TEN DAYS PRIOR TO SOD INSTALLATION.

3. THE SOD SHALL BE FIRM, TOUGH TEXTURE, HAVING A COMPACTED GROWTH OF GRASS WITH GOOD ROOT DEVELOPMENT. IT SHALL CONTAIN NO NOXIOUS WEEDS, OR ANY OTHER OBJECTIONABLE VEGETATION, FUNGUS, INSECTS OR DISEASE. PREPARATION OF AREAS SHALL BE PERFORMED WELL ENOUGH IN ADVANCE TO ALLOW SUFFICIENT TIME TO WORK PROPERLY. THE SOIL EMBEDDED IN THE SOD SHALL BE GOOD, CLEAN EARTH, FREE FROM STONES AND DEBRIS. THE SOD SHALL BE FREE FROM FUNGUS, VERMIN, AND OTHER DISEASES.

4. BEFORE BEING CUT AND LIFTED, THE SOD SHALL HAVE BEEN MOVED AT LEAST THREE TIMES WITH A LAWN MOWER, WITH THE FINAL MOWING NOT MORE THAN SEVEN DAYS BEFORE THE SOD IS CUT. THE SOD SHALL BE CAREFULLY CUT INTO UNIFORM DIMENSIONS.

5. SOLID SOD SHALL BE LAID WITH CLOSELY ABUTTING JOINTS WITH A TAMPED OR ROLLED EVEN SURFACE.

6. WATERING SHALL BE ACCOMPLISHED UNTIL ACCEPTANCE OF THE WORK BY THE LANDSCAPE ARCHITECT.

7. MAINTENANCE OF MATERIAL SHALL BE THE RESPONSIBILITY OF THE LANDSCAPE CONTRACTOR UNTIL FINAL APPROVAL OF LANDSCAPE ARCHITECT.

8. IT SHALL BE THE RESPONSIBILITY OF THE LANDSCAPE CONTRACTOR TO BRING THE SOD EDGE IN A NEAT, CLEAN MANNER TO THE EDGE OF ALL PAVING AND SHRUB AREAS.

9. SEE PLANS FOR DETAILS. RE: SOD VARIETIES

10. FOR SOD, APPLY DEPTH OF SOIL AS PER PLANTING DETAILS PAGE. REMOVE ANY STONES FROM TOP OF SUB-GRADE OR COVER STONES WITH ADDITIONAL 2" OF SOIL MIX.

11. ALL SOD AREA SHALL BE TREATED WITH 'ROUND UP' TWO WEEKS PRIOR TO INSTALLATION FOR REMOVAL OF ANY EXISTING OBJECTIONABLE PLANTS. DOSAGE AND APPLICATION PER MANUFACTURERS SPECIFICATIONS.

PLANT LIST

All plants to be Florida Fancy

QTY	BOTANICAL NAME	COMMON NAME	SIZE	NOTES
TREES				
1	Bauhinia tree	To match existing.	Collected, SMI to approve	
2	Coccoloba diversifolia	Pigeon Plum	#100, 14' ht, 9' ct, 6' sprd, SMI to approve	
4	Pithecellobium arboreum	Lorito Tree	#100, 18' oa, 9' ct, SMI to approve	
5	Samanea saman	Rain tree	#100, 18' oa, 9' ct, SMI to approve	
11	Swietenia mahagoni	Cuban Mahogany	#100, 16' ht, 6' sprd, 8' ct, SMI to approve	Native
PALM TREES				
2	Acoelorrhaphe wrightii	Paurotis Palm	15' sprd, 10 cane minimum, SMI to approve	
1	Ptychosperma macarthurii	Macarthur Palm	5-trunk, 16' gw	Not Native
SHRUBS				
85	Ficus microcarpa 'Green Island'	Green Island Ficus	#7, 14'oc	
2	Garcinia spicata	Garcinia	10' HT, FTB, columnar	Not Native
342 LF	Heterosavia bahamensis	Maidenbush	#45, 6' ht, ftb, Qty=LF	
3	Ilex vomitoria 'Schillings'	Schillings Yaupon Holly	1' dia. sphere, ftb	
4	Ilex vomitoria 'Schillings'	Schillings Yaupon Holly	2' dia. sphere, ftb	
4	Ilex vomitoria 'Schillings'	Schillings Yaupon Holly	3' dia. sphere, ftb	
1	Ilex vomitoria 'Schillings'	Schillings Yaupon Holly	4' dia. sphere, ftb	
105 LF	Podocarpus macrophyllus 'Maki'	Maki Shrubby Yew Podocarpus	#65, 10' ht, ftb, Qty=LF	
33 LF	Podocarpus macrophyllus 'Maki'	Maki Shrubby Yew Podocarpus	4' ht, ftb, Qty=LF	Not Native
169 LF	Podocarpus macrophyllus 'Pringles'	Pringles Yew Podocarpus	#7, Qty=LF	
52 LF	Tabernaemontana heterophylla	Jasmine	3' ht, ftb, hedge, Qty=LF	
VINE/ESPALIER				
2	Bougainvillea x 'New River'	New River Bougainvillea	#15, 5' oc, pin to wall	Not Native
38	Bougainvillea x 'New River'	New River Bougainvillea	#3, 36' oc	
24	Pandorea jasminoides	Bower Vine	#3, 36' oc	
9	Pyrostegia venusta	Florida Flame Vine,	#15, trl, train to columns & roof	
8	Solandra grandiflora	Showy Chalice Vine	#15, trl, train to columns & roof	Not Native
SHRUB AREAS				
73	Annuals Mix per SMI	See Annuals Mix Chart	#1, 6'oc	
72	Asystasia gangetica	Chinese Violet	#3, 14" oc	
410	Ilex vomitoria	Yaupon Holly	#7, 14'oc	
1,032	Mimosa strigillosa	Sunshine Mimosa	#1, 12'oc	Native
1,341	Salvia misella	Tropical Sage	#1, 12'oc	Native
1,991	Tropical Mix 1 per SMI	See Tropical Mix 1 Chart,	#3, 12'oc	
347	Tropical Mix 2 per SMI	See Tropical Mix 2 Chart,	#3, 12'oc	
66	Viburnum odoratissimum	Sweet Viburnum	#25, ftb, 5' ht, 30'oc	
44 sf	Zephyranthes grandiflora	Pink Rain Lily	#1, 6'oc, can to can	
GROUND COVERS				
828	Trachelospermum asiaticum 'Minima'	Minima Asian Jasmine	#1, 12'oc	Not Native

CLEAN UP

1. THE LANDSCAPE CONTRACTOR SHALL AT ALL TIMES KEEP THE PREMISES FREE FROM ACCUMULATIONS OF WASTE MATERIALS OR RUBBISH CAUSED BY HIS EMPLOYEES OR WORK. HE SHALL LEAVE ALL PAVED AREAS 'BROOM CLEAN' WHEN COMPLETED WITH THE WORK.

2. MARKS AND DAMAGE TO EXISTING PAVING MATERIALS SHALL BE THE RESPONSIBILITY OF THE LANDSCAPE CONTRACTOR.

ALL PALMS, TREES, AND LARGE SPECIMEN PLANTS SHALL BE STAKED BY THE LANDSCAPE CONTRACTOR FOR LA APPROVAL OF LAYOUT AND LOCATIONS PRIOR TO INSTALLING SAME.

TREE STAKE PAINT FORMULA:
BEHR PREMIUM PLUS EXT FLAT -ACCENT BASE (4670)
COLORANT 02 45 56
D THALO GREEN 01 04
C YELLOW OXIDE 02 04 0
B LAMP BLACK 01 00 0

SUBMIT SAMPLE

SMI TO APPROVE STAKED LAYOUT OF ALL TREES AND PLANTING LAYOUT PRIOR TO INSTALLATION

ALL IRRIGATION, IRRIGATION EQUIPMENT AND IRRIGATION BOXES TO BE CONCEALED

ALL PLANTING BEDS ABUTTING LAWN TO HAVE METAL EDGE BORDER

SEAL



120 Broadway
20th Floor
New York, NY 10271
212 777 7800
beyerblinderbelle.com

285 Banyan Blvd
West Palm Beach Florida 33401
561 684 6844 • Fax 561 684 6564
spina@spourke.com
FL Lic #A2800299

LANDSCAPE ARCHITECTURE
140 Broad Palm Way, Suite 205C Palm Beach, Florida 33480
Fax: 561 684 6566
About Our Firm
FL Registration #LA 1306023

SPINA O'ROURKE + PARTNERS



The Society of the Four Arts

100 Four Arts Plaza, Palm Beach, FL 33480

THESE DRAWINGS ARE FOR THE EXCLUSIVE USE OF SPINA O'ROURKE + PARTNERS, INC. AND MAY NOT BE DUPLICATED, REPRODUCED OR USED IN ANY MANNER WITHOUT THE EXPRESS WRITTEN CONSENT OF SPINA O'ROURKE + PARTNERS, INC. ALL RIGHTS RESERVED.

Revisions



Project no: 2953
Date: 2024.09.23
Drawn by: VD
Project Manager: CFV

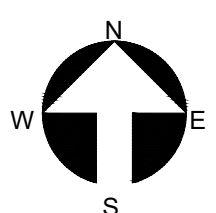

L2.3

N.T.S.
Second Submittal

PLANTING SPECIFICATIONS

Autodesk Docs/Society of the Four Arts/SFA-Roversky-R22.mxd

10/26/2023

- ABBREVIATIONS KEY
- DIA = DIAMETER
 - DR = DOMINICAN REPUBLIC
 - HS = HANDSCAPE
 - HT = HEIGHT
 - LA = LANDSCAPE ARCHITECT
 - LS = LANDSCAPE
 - MAX = MAXIMUM
 - MIN = MINIMUM
 - SMI = SMI LANDSCAPE ARCHITECTURE
 - TBD = TO BE DETERMINED
 - TC = TERRA COTTA
 - THK = THICK
 - TYP = TYPICAL
- GRADING
- BOS = BOTTOM OF STEPS
 - ELEV = ELEVATION
 - FTE = FINISHED FLOOR ELEVATION
 - TOS = TOP OF STEPS
 - TOW = TOP OF WALL



Town of Palm Beach
Planning Zoning and Building
360 S County Rd
Palm Beach, FL 33480
www.townofpalmbeach.com

Line #	Landscape Legend Campus		
	Property Address:	100 Four Arts Plaza, Palm Beach, FL 33480	
2	Lot Area (sq. ft.):	334,443 sq ft	
3		REQUIRED	PROPOSED
4	Landscape Open Space (LOS) (Sq Ft and %)	N/A	N/A
5	LOS to be altered (Sq Ft and %)	N/A	46,337 sq ft (14%)
6	Perimeter LOS (Sq Ft and %)	N/A	N/A
7	Front Yard LOS (Sq Ft and %)	N/A	8,434 (57%)
8	Native Trees %	30% (number of trees)	56.5%
9	Native Shrubs & Vines %	30% (number of shrubs & vines)	30%
10	Native Groundcover %	30% (groundcover area)	100%

- Newly planted non-native plant material
 - Newly planted native plant material
- Areas not shown in color are either existing to remain, building, hardscape, or sod

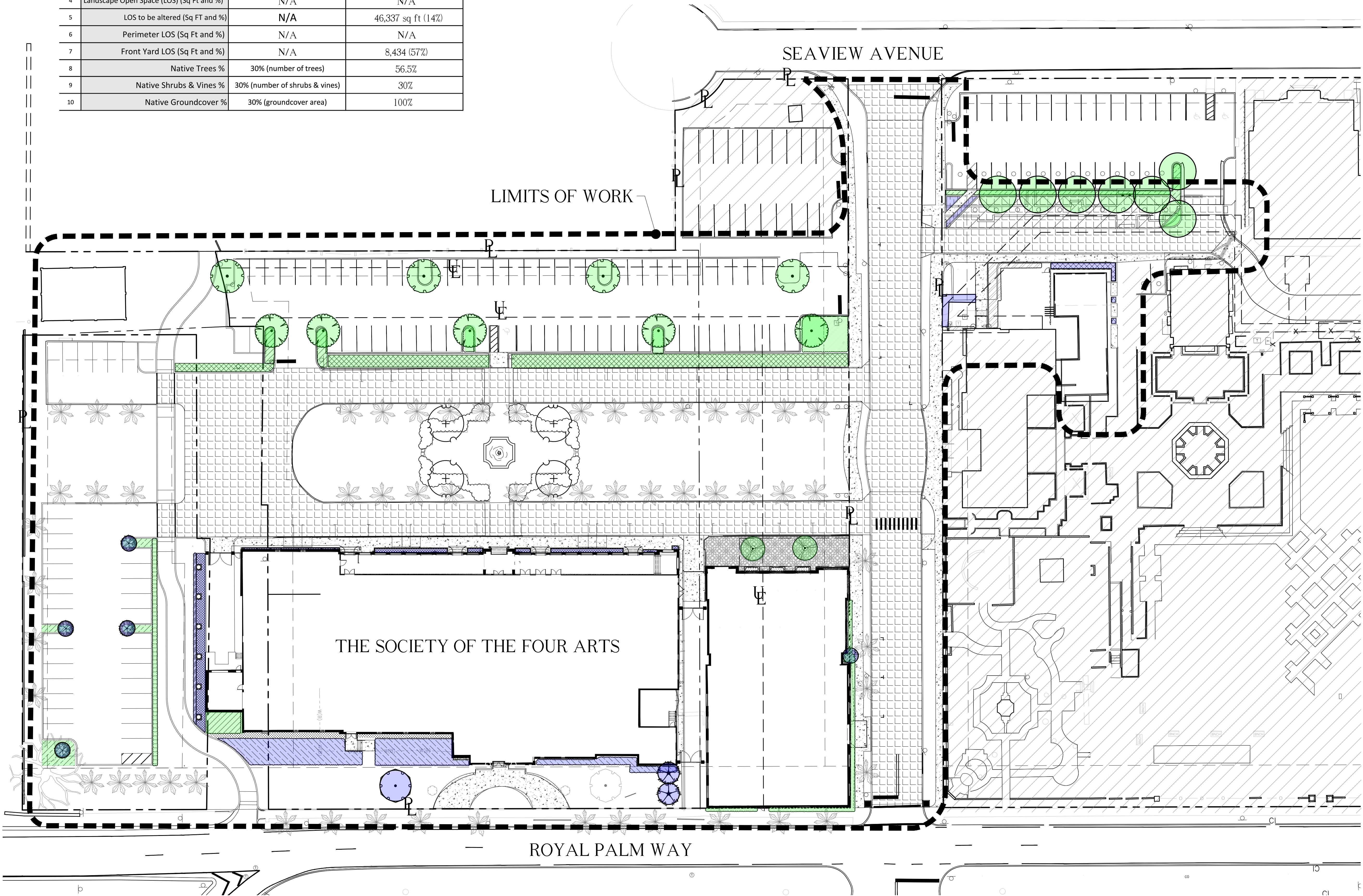

120 Broadway
20th Floor
New York, NY 10271
212 777 7800
beyerblinderbelle.com

**BEYER
BLINDER
BELLE**

SMI

LANDSCAPE ARCHITECTURE
140 Broad Path Way, Suite 200 Palm Beach, Florida 33480
Phone: 561.684.6844 Fax: 561.684.6846
www.beyerblinderbelle.com
FL Registration #LA 13060223

285 Banyan Blvd
West Palm Beach, Florida 33401
561.684.6844 • Fax 561.684.6846
spinaorourke.com
FL Lic #A23002399

**SPINAOROURKE
+ PARTNERS**

Architecture • Interior Design
Keith M. Spina #AR13419

The Society of the Four Arts

100 Four Arts Plaza, Palm Beach, FL 33480

THESE DRAWINGS ARE FOR THE EXCLUSIVE USE OF SPINA OROURKE + PARTNERS, INC. AND MAY NOT BE DUPLICATED, REPRODUCED OR USED IN ANY MANNER WITHOUT THE EXPRESS WRITTEN CONSENT OF SPINA OROURKE + PARTNERS, INC. ALL RIGHTS RESERVED.

Revisions

Project no: 2953
Date: 2024.09.23
Drawn by: VD
Project Manager: CFV

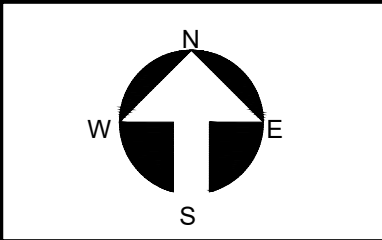

N-1

1" = 20'-0"
Second Submittal



Autodesk Docs/Society of the Four Arts/SFA-Roversky-R22.rvt

ABBREVIATIONS KEY
DIA = DIAMETER
DR = DOMINICAN REPUBLIC
HS = HARDSCAPE
HT = HEIGHT
LA = LANDSCAPE ARCHITECT
LS = LANDSCAPE
MAX = MAXIMUM
MIN = MINIMUM
SMI = SMI LANDSCAPE ARCHITECTURE
TBD = TO BE DETERMINED
TC = TERRA COTTA
THK = THICK
TYP = TYPICAL

GRADING
BOS = BOTTOM OF STEPS
ELEV = ELEVATION
FFE = FINISHED FLOOR ELEVATION
TOS = TOP OF STEPS
TOW = TOP OF WALL

SEE SHEET D-3 FOR EXISTING (NUMBERED) TREES LIST

Relocation Key

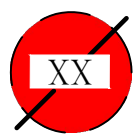

Remove



Relocate

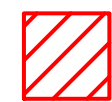

HARDSCAPE TO BE REMOVED



VEGETATION TO BE REMOVED

ALL TREES & PALMS TO REMAIN UNLESS NOTED OTHERWISE

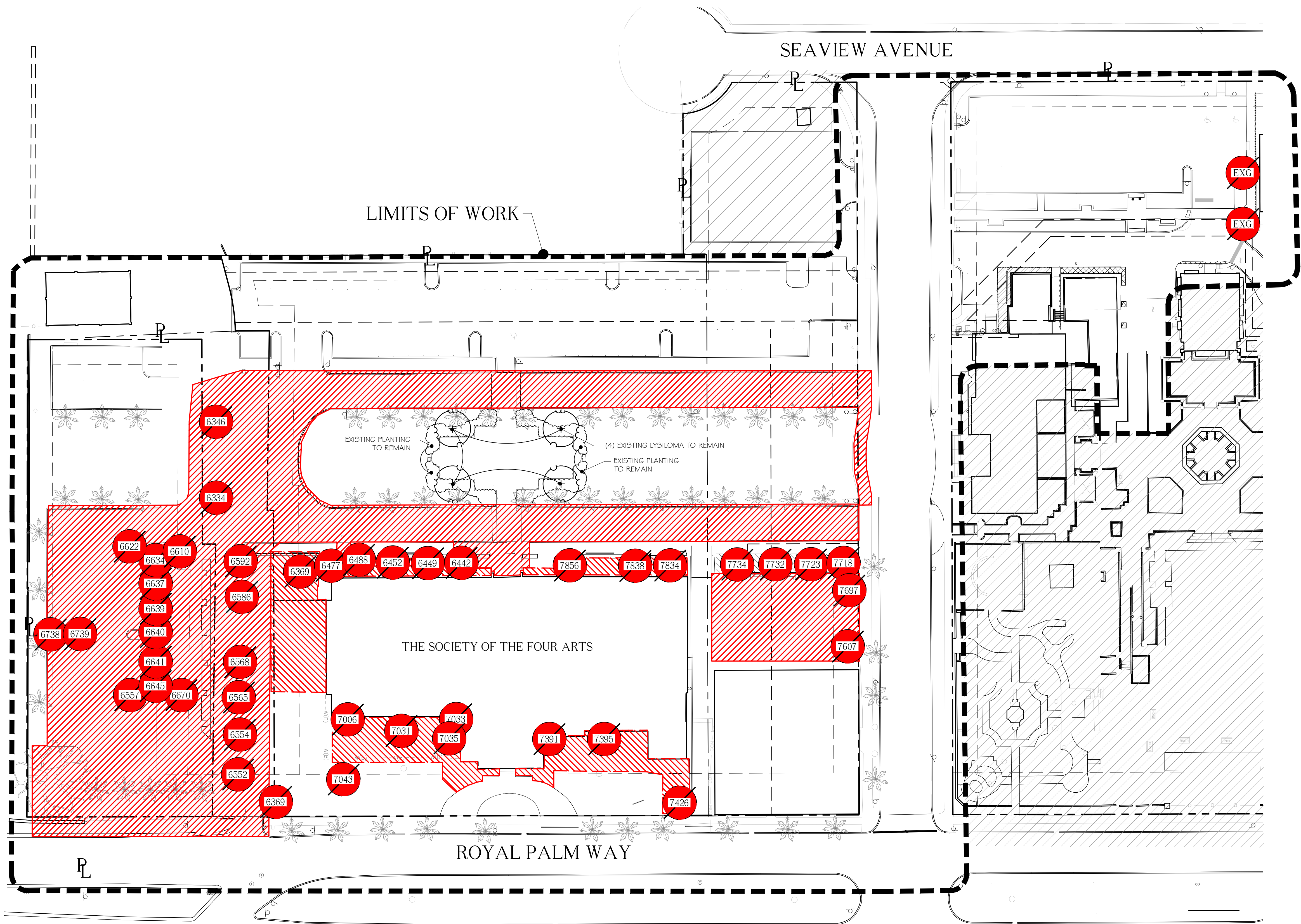

NOTE:
-EXISTING SOD TO REMAIN
-CONTRACTOR TO REPAIR SOD AS NEEDED UNTIL CONSTRUCTION BEGINS
-SOD: STENOTAPHRUM SECUNDATUM 'FLORATAM'
-LOT SHALL BE SODDED AND IRRIGATED PER TOWN REQUIREMENTS

Survey By: Keith Surveying Job # 13223.00

120 Broadway
20th Floor
New York, NY 10271
212 777 7800
beyerblinderbelle.com

285 Banyan Blvd
West Palm Beach, Florida 33401
561.684.6844 • Fax 561.684.5504
spinaorourke.com
FL Lic # A23802299

SPINAOROURKE
ARCHITECTS
Architecture • Interior Design
Keith M. Spina # AR15419



The Society of the Four Arts

100 Four Arts Plaza, Palm Beach, FL 33480

THESE DRAWINGS ARE FOR THE
EXCLUSIVE USE OF SPINA OROURKE +
PARTNERS, INC. AND MAY NOT BE
DUPLICATED, REPRODUCED OR USED
IN ANY MANNER WITHOUT THE
EXPRESS WRITTEN CONSENT OF SPINA
OROURKE + PARTNERS, INC. ALL
RIGHTS RESERVED.

Revisions



Project no: 2953
Date: 2024.09.23
Drawn by: VD
Project Manager: CFV

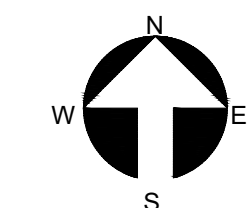

D-1

1" = 20'-0"
Second Submittal



PRE DEMOLITION PLAN

Autodesk Docs://Society of the Four Arts/SFA-Roversky-R22.rvt

ABBREVIATIONS KEY
DIA =DIAmeter
DR =Dominican Republic
HS =HardScape
HT =Height
LA =Landscape Architect
LS =LandScape
MAX =MAXimum
MIN =MINimum
SMI =SMI Landscape Architecture
TBD =To Be Determined
TC =Terra Cotta
THK =THick
TYP =TYPical

GRADING
BOS =Bottom Of Steps
ELEV =ELEVation
FFE =Finished Floor Elevation
TOS =Top Of Steps
TOW =Top Of Wall

SEE SHEET D-3 FOR EXISTING (NUMBERED) TREES LIST

ALL TREES & PALMS TO REMAIN UNLESS NOTED OTHERWISE

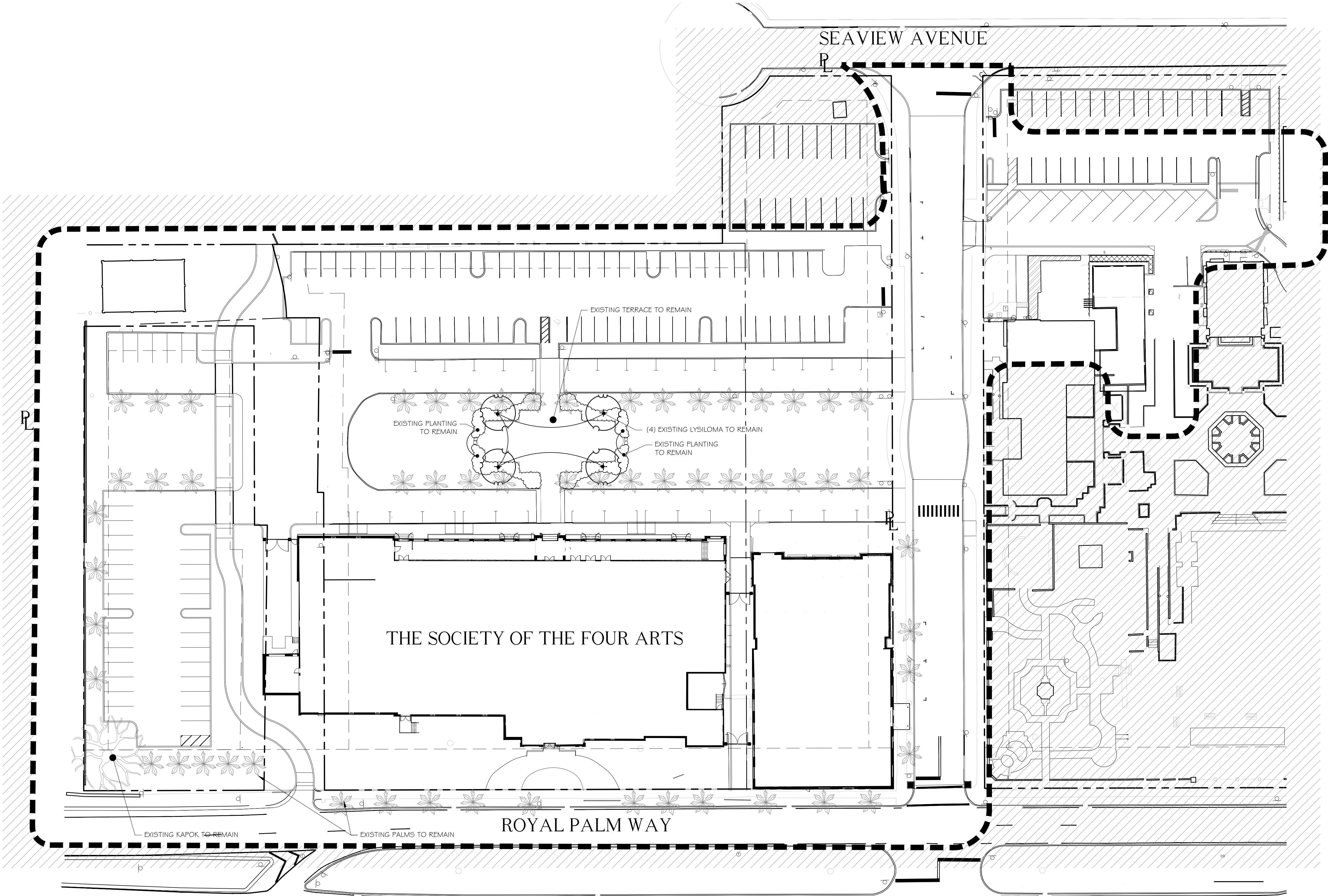

NOTE:
-EXISTING SOD TO REMAIN
-CONTRACTOR TO REPAIR SOD AS NEEDED UNTIL CONSTRUCTION BEGINS
-SOD: STENOTAPHRUM SECUNDATUM FLORATAM
-LOT SHALL BE SODDED AND IRRIGATED PER TOWN REQUIREMENTS

Survey By: Keith Surveying Job # 13223.00

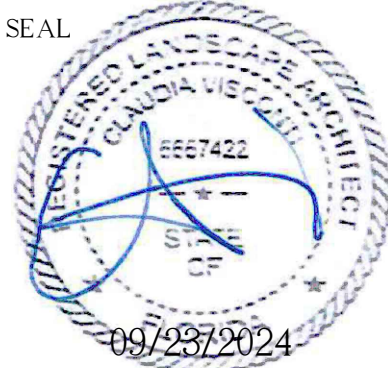

POST DEMOLITION PLAN

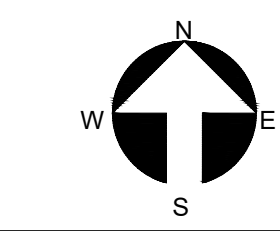

Project no: 2953
Date: 2024.09.23
Drawn by: VD
Project Manager: CFV

Revisions

THESE DRAWINGS ARE FOR THE EXCLUSIVE USE OF SPINA OROURKE + PARTNERS, INC. AND MAY NOT BE REPRODUCED OR USED IN ANY MANNER WITHOUT THE EXPRESS WRITTEN CONSENT OF SPINA OROURKE + PARTNERS, INC. ALL RIGHTS RESERVED.

The Society of the Four Arts

100 Four Arts Plaza, Palm Beach, FL 33480



SPINA OROURKE + PARTNERS, INC.

285 Banyan Blvd
West Palm Beach, Florida 33401
561.684.6844 • Fax 561.684.5504
spinaorourke.com
FL Lic #A23802399

120 Broadway
20th Floor
New York, NY 10271
212.777.7800
beyerblinderbelle.com

BEYER BLINDER BELLE

SMI

LANDSCAPE ARCHITECTURE
140 Royal Palm Way, Suite 2050 Palm Beach, Florida 33480
Phone: 561.684.5506
Fax: 561.684.5504
beyerblinderbelle.com
FL Registration #LA 13060223

Architecture • Interior Design
Keith M. Spina #AR15419

EXISTING TREES LIST

TREE TABLE		
Number	Name	DBH (in)
5032	SYLVESTER PALM	18
5047	SYLVESTER PALM	16
5072	SYLVESTER PALM	18
5086	SABAL PALM	12
5088	LIGUSTRUM	3
5089	LIGUSTRUM	2
5090	LIGUSTRUM	3
5148	LIGUSTRUM	3
5160	LIGUSTRUM	3
5195	LIGUSTRUM	3
5202	LIGUSTRUM	3
5203	LIGUSTRUM	3
5207	UNKNOWN	6
5210	UNKNOWN	5
5216	UNKNOWN	5
5294	UNKNOWN	5
5298	UNKNOWN	5
5300	UNKNOWN	6
5305	LIGUSTRUM	3
5310	FICUS	24
5313	LIGUSTRUM	3
5320	LIGUSTRUM	3
5358	CUBAN ROYAL PALM	21
5360	CUBAN ROYAL PALM	20
5363	CUBAN ROYAL PALM	19
5364	CUBAN ROYAL PALM	24
5388	UNKNOWN	4
5392	CUBAN ROYAL PALM	18
5393	CUBAN ROYAL PALM	22
5403	CUBAN ROYAL PALM	18
5404	CUBAN ROYAL PALM	20
5408	CUBAN ROYAL PALM	21
5455	CUBAN ROYAL PALM	18
5458	CUBAN ROYAL PALM	20
5475	UNKNOWN	6
5483	CUBAN ROYAL PALM	20
5484	UNKNOWN	8
5511	UNKNOWN	8
5520	UNKNOWN	6
5521	UNKNOWN	5
5527	UNKNOWN	6
5528	UNKNOWN	7
5580	CUBAN ROYAL PALM	18
5612	SYLVESTER PALM	15
5661	CUBAN ROYAL PALM	22
5668	CUBAN ROYAL PALM	19
5671	CUBAN ROYAL PALM	20
5675	CUBAN ROYAL PALM	20
5676	CUBAN ROYAL PALM	23
5680	CUBAN ROYAL PALM	22
5687	CUBAN ROYAL PALM	20
5689	CUBAN ROYAL PALM	23
5692	CUBAN ROYAL PALM	23
5695	CUBAN ROYAL PALM	20

TREE TABLE		
Number	Name	DBH (in)
5701	UNKNOWN	12
5704	UNKNOWN	10
5717	UNKNOWN	10
5725	CUBAN ROYAL PALM	20
5726	CUBAN ROYAL PALM	20
5727	CUBAN ROYAL PALM	24
5728	CUBAN ROYAL PALM	23
5729	CUBAN ROYAL PALM	21
5730	CUBAN ROYAL PALM	22
5731	CUBAN ROYAL PALM	21
5732	CUBAN ROYAL PALM	23
5733	CUBAN ROYAL PALM	19
5734	CUBAN ROYAL PALM	20
5786	UNKNOWN	12
5789	UNKNOWN	10
5801	UNKNOWN	12
5927	CUBAN ROYAL PALM	18
5951	LIGUSTRUM	3
5980	UNKNOWN	6
5981	UNKNOWN	8
5994	UNKNOWN	6
5999	MAHOGANY	19
6026	CUBAN ROYAL PALM	19
6029	CUBAN ROYAL PALM	20
6034	CUBAN ROYAL PALM	20
6041	CUBAN ROYAL PALM	18
6043	CUBAN ROYAL PALM	20
6075	CUBAN ROYAL PALM	20
6078	CUBAN ROYAL PALM	21
6085	CUBAN ROYAL PALM	19
6087	CUBAN ROYAL PALM	23
6096	SABAL PALM	12
6162	LIGUSTRUM	3
6183	MAHOGANY	20
6226	BUTTONWOOD	6
6227	GEIGER	7
6261	BUTTONWOOD	10
6294	BUTTONWOOD	12
6309	CUBAN ROYAL PALM	19
6310	CUBAN ROYAL PALM	18
6314	CUBAN ROYAL PALM	18
6316	CUBAN ROYAL PALM	20
6334	CUBAN ROYAL PALM	18
6335	CUBAN ROYAL PALM	20
6340	CUBAN ROYAL PALM	20
6341	CUBAN ROYAL PALM	19
6369	SABAL	10
6442	FICUS	15
6449	FICUS	15
6452	FICUS	14
6477	FICUS	3
6488	FICUS	3
6549	SCREW PINE	10

TREE TABLE		
Number	Name	DBH (in)
6552	MAHOGANY	24
6554	MAHOGANY	22
6565	MAHOGANY	20
6568	MAHOGANY	19
6586	MAHOGANY	20
6592	MAHOGANY	24
6610	MAHOGANY	19
6622	MAHOGANY	19
6634	SYLVESTER PALM	12
6637	SYLVESTER PALM	14
6639	SYLVESTER PALM	12
6640	SYLVESTER PALM	10
6641	SYLVESTER PALM	8
6645	SYLVESTER PALM	10
6657	MAHOGANY	20
6670	MAHOGANY	24
6707	CUBAN ROYAL PALM	19
6731	CUBAN ROYAL PALM	18
6738	ALEXANDER PALM	10
6739	ALEXANDER PALM	8
6764	CUBAN ROYAL PALM	21
6765	CUBAN ROYAL PALM	19
6861	CUBAN ROYAL PALM	19
6891	CUBAN ROYAL PALM	19
6892	CUBAN ROYAL PALM	19
6893	CUBAN ROYAL PALM	20
6901	CUBAN ROYAL PALM	18
6902	UNKNOWN	60
7006	SCREW PINE	8
7012	ORCHID	8
7031	EUREKA CLUSTER	3
7033	SCHIEFFIERA	6
8046	SCHIEFFIERA CLUSTER	15
7035	SYLVESTER PALM	3
7050	PORTER CORPUS	4
7051	CUBAN ROYAL PALM	18
7053	CUBAN ROYAL PALM	19
7054	CUBAN ROYAL PALM	19
7056	CUBAN ROYAL PALM	20
7101	CUBAN ROYAL PALM	18
7103	CUBAN ROYAL PALM	19
7113	CUBAN ROYAL PALM	20
7156	CUBAN ROYAL PALM	18
7160	CUBAN ROYAL PALM	19
7163	CUBAN ROYAL PALM	18
7179	CUBAN ROYAL PALM	14
7182	CUBAN ROYAL PALM	19
7198	CUBAN ROYAL PALM	19
7205	CUBAN ROYAL PALM	19
7213	CUBAN ROYAL PALM	20
7218	CUBAN ROYAL PALM	21
7221	CUBAN ROYAL PALM	19
7244	CUBAN ROYAL PALM	20

TREE TABLE		
Number	Name	DBH (in)
7248	CUBAN ROYAL PALM	19
7258	CUBAN ROYAL PALM	20
7261	CUBAN ROYAL PALM	16
7266	CUBAN ROYAL PALM	19
7268	CUBAN ROYAL PALM	12
7281	CUBAN ROYAL PALM	16
7311	CUBAN ROYAL PALM	18
7337	CUBAN ROYAL PALM	19
7338	CUBAN ROYAL PALM	19
7345	CUBAN ROYAL PALM	20
7364	PORTER CORPUS	4
7391	SCHIEFFIERA	10
7395	EUREKA CLUSTER	3
7414	ORCHID	30
7426	MAHOGANY	18
7471	CUBAN ROYAL PALM	20
7489	CUBAN ROYAL PALM	20
7490	CUBAN ROYAL PALM	20
7607	MAHOGANY	15
7697	MAHOGANY	15
7718	FICUS	16
7723	FICUS	15
7732	FICUS	18
7734	FICUS	20
7834	FICUS	14
7838	FICUS	15
7856	FICUS	15
7951	SYLVESTER PALM	14
7991	SYLVESTER PALM	18
8042	SYLVESTER PALM	14
8046	SYLVESTER PALM	15
8055	SYLVESTER PALM	16
8067	SYLVESTER PALM	14
8126	SYLVESTER PALM	16
8132	SYLVESTER PALM	17
8148	SYLVESTER PALM	16
8169	SYLVESTER PALM	14
8207	CUBAN ROYAL PALM	18
8223	CUBAN ROYAL PALM	17
8238	CUBAN ROYAL PALM	18
8248	CUBAN ROYAL PALM	18
8253	CUBAN ROYAL PALM	18
8257	CUBAN ROYAL PALM	20
8261	CUBAN ROYAL PALM	19
8264	CUBAN ROYAL PALM	20
8265	CUBAN ROYAL PALM	18
8278	CUBAN ROYAL PALM	18
8293	CUBAN ROYAL PALM	19
8295	CUBAN ROYAL PALM	20
8300	CUBAN ROYAL PALM	20
8316	CUBAN ROYAL PALM	18

TREE TABLE		
Number	Name	DBH (in)
8327	CUBAN ROYAL PALM	12
8342	CUBAN ROYAL PALM	20
8346	CUBAN ROYAL PALM	21
8449	CUBAN ROYAL PALM	18
8458	CUBAN ROYAL PALM	17
8501	CUBAN ROYAL PALM	19
8506	CUBAN ROYAL PALM	14
8507	CUBAN ROYAL PALM	20
8510	CUBAN ROYAL PALM	18
8513	CUBAN ROYAL PALM	15
8556	CUBAN ROYAL PALM	18
8677	FICUS	60
8959	COCO PALM	12
8960	COCO PALM	12
8961	COCO PALM	12
8962	COCO PALM	12
8963	COCO PALM	12
9130	SYLVESTER PALM	14
9131	SYLVESTER PALM	16
9205	CHRISTMAS PALM	5x3
9218	CHRISTMAS PALM	6x3
9275	SYLVESTER PALM	15
9297	SYLVESTER PALM	16
9368	SYLVESTER PALM	17
9535	SYLVESTER PALM	18
9657	LIGUSTRUM	6
9662	LIGUSTRUM	6
9676	LIGUSTRUM	6
9683	LIGUSTRUM	6
9800	MAHOGANY	20
9914	LIGUSTRUM	6
9994	LIGUSTRUM	7
10784	ALEXANDER PALM	6X2
10785	ALEXANDER PALM	6X2
10786	ALEXANDER PALM	4X3
10787	ALEXANDER PALM	4X3
10788	ALEXANDER PALM	4X3
10789	ALEXANDER PALM	4X3
10790	ALEXANDER PALM	4X3
10796	ALEXANDER PALM	5X3
10797	ALEXANDER PALM	3X3
10798	ALEXANDER PALM	4X3
10805	ALEXANDER PALM	5X3
10806	ALEXANDER PALM	5X3
10808	TABULIA ROSEA	4.00
10876	ALEXANDER PALM	5X3
10877	ALEXANDER PALM	5X3
10878	ROBELLINI PALM 4X3	4X3
10879	ROBELLINI PALM 4X3	4X3
10880	ROBELLINI PALM 4X3	4X3
10916	DATES	18
10917	DATES	18
10918	DATES	18
10919	DATES	15
10948	ALEXANDER PALM	8
10949	ALEXANDER PALM	8
10950	ALEXANDER PALM	8

TREE TABLE		
Number	Name	DBH (in)
10951	ALEXANDER PALM	8
10952	ALEXANDER PALM	8
10953	ALEXANDER PALM	5X3
10954	ALEXANDER PALM	5X3
10955	ALEXANDER PALM	5X3
10956	ALEXANDER PALM	5X3
10957	ALEXANDER PALM	5X3
10958	ALEXANDER PALM	5X3
10959	ALEXANDER PALM	7X3
10960	ALEXANDER PALM	4X3
10961	ALEXANDER PALM	4X3
10962	ALEXANDER PALM	4X3
10963	ALEXANDER PALM	4X3
10964	ALEXANDER PALM	4X3
10965	ALEXANDER PALM	4X3
10966	ALEXANDER PALM	8
10967	ALEXANDER PALM	6
10968	ALEXANDER PALM	8
10969	ALEXANDER PALM	6
10970	ALEXANDER PALM	6
10971	ALEXANDER PALM	6
10972	COCO PALM	8
10973	COCO PALM	6
10974	COCO PALM	6
10975	BISMARK PALM	8
11051	DATES	20
11065	DATES	20
11087	DATE PALM	24
11102	DATES	18
11110	UNKNOWN	4
11111	UNKNOWN	5
11137	UNKNOWN	4
11271	OAK	12
11272	OAK	14
11273	OAK	12
11274	OAK	16
11275	OAK	15
11276	OAK	8
20015	LIGUSTRUM	5
20130	LIGUSTRUM	7
20165	LIGUSTRUM	4
20182	LIGUSTRUM	6
20190	COCO PALM	10
20214	COCO PALM	10
20615	UNKNOWN	17
20625	PODOCARPUS	12
20629	PODOCARPUS	20
20633	PODOCARPUS	19
20635	UNKNOWN	15
20652	BUTTONWOOD	14
20653	BUTTONWOOD	16
20654	BUTTONWOOD	16
20655	BUTTONWOOD	20
20656	BUTTONWOOD	20
20680	ALEXANDER PALM	5X3
20681	ALEXANDER PALM	5X3
20682	ALEXANDER PALM	5X3

TREE TABLE		
Number	Name	DBH (in)
20665	ALEXANDER PALM	5X3
20666	ALEXANDER PALM	5X3
20676	ALEXANDER PALM	5X3
20683	ALEXANDER PALM	5X3
20685	ALEXANDER PALM	5X3
20687	ALEXANDER PALM	5X3
20703	CUBAN ROYAL PALM	14
20705	CUBAN ROYAL PALM	14
20707	CUBAN ROYAL PALM	15
20708	CUBAN ROYAL PALM	14
20709	CUBAN ROYAL PALM	15
20731	OAK	17
20734	SABAL PALM	14
20735	MAGNOLIA	8
20736	SABAL PALM	14
20737	SABAL PALM	16
20738	MAGNOLIA	12
20743	MAGNOLIA	11
20744	OAK	19
20788	PODOCARPUS	24
20803	OAK	16
20822	CUBAN ROYAL PALM	12
20824	CUBAN ROYAL PALM	12
20825	CUBAN ROYAL PALM	14
20826	ALMOND	30
20829	CUBAN ROYAL PALM	14
20831	CUBAN ROYAL PALM	12
20832	CUBAN ROYAL PALM	14
20833	OAK	15
20845	UNKNOWN	18
20854	UNKNOWN	18
20870	SYLVESTER PALM	15
20871	SYLVESTER PALM	15
20872	DATE PALM	24
20873	DATE PALM	22
20874	DATE PALM	24
20875	DATE PALM	24
20876	DATE PALM	24
20887	UNKNOWN	18
20928	ALMOND	48
20968	SCREW PINE	8
20979	COCO PALM	14
20983	COCO PALM	16
20985	COCO PALM	12
21048	SCREW PINE	10
21063	COCO PALM	15
21076	FICUS	15
21090	ALEXANDER	8
21091	ALEXANDER	8
21092	ALEXANDER	9
21093	ALEXANDER	8
21096	DATE	22
21170	CUBAN ROYAL PALM	14
21171	CUBAN ROYAL PALM	14
21172	LEMON	2
21211	JACARANDA	24
21299	OAK	12
21301	JACARANDA	10
21416	MAGNOLIA	3
21492	CALUSIA	2

TREE TABLE		
Number	Name	DBH (in)

ABBREVIATIONS KEY
DIA = DIAMETER
DR = DOMINICAN REPUBLIC
HS = HARDSCAPE
HT = HEIGHT
LA = LANDSCAPE ARCHITECT
LS = LANDSCAPE
MAX = MAXIMUM
MIN = MINIMUM
SMI = SMI LANDSCAPE ARCHITECTURE
TBD = TO BE DETERMINED
TC = TERRA COTTA
THK = THICK
TYP = TYPICAL

GRADING
BOS = BOTTOM OF STEPS
ELEV = ELEVATION
FFE = FINISHED FLOOR ELEVATION
TOS = TOP OF STEPS
TOW = TOP OF WALL

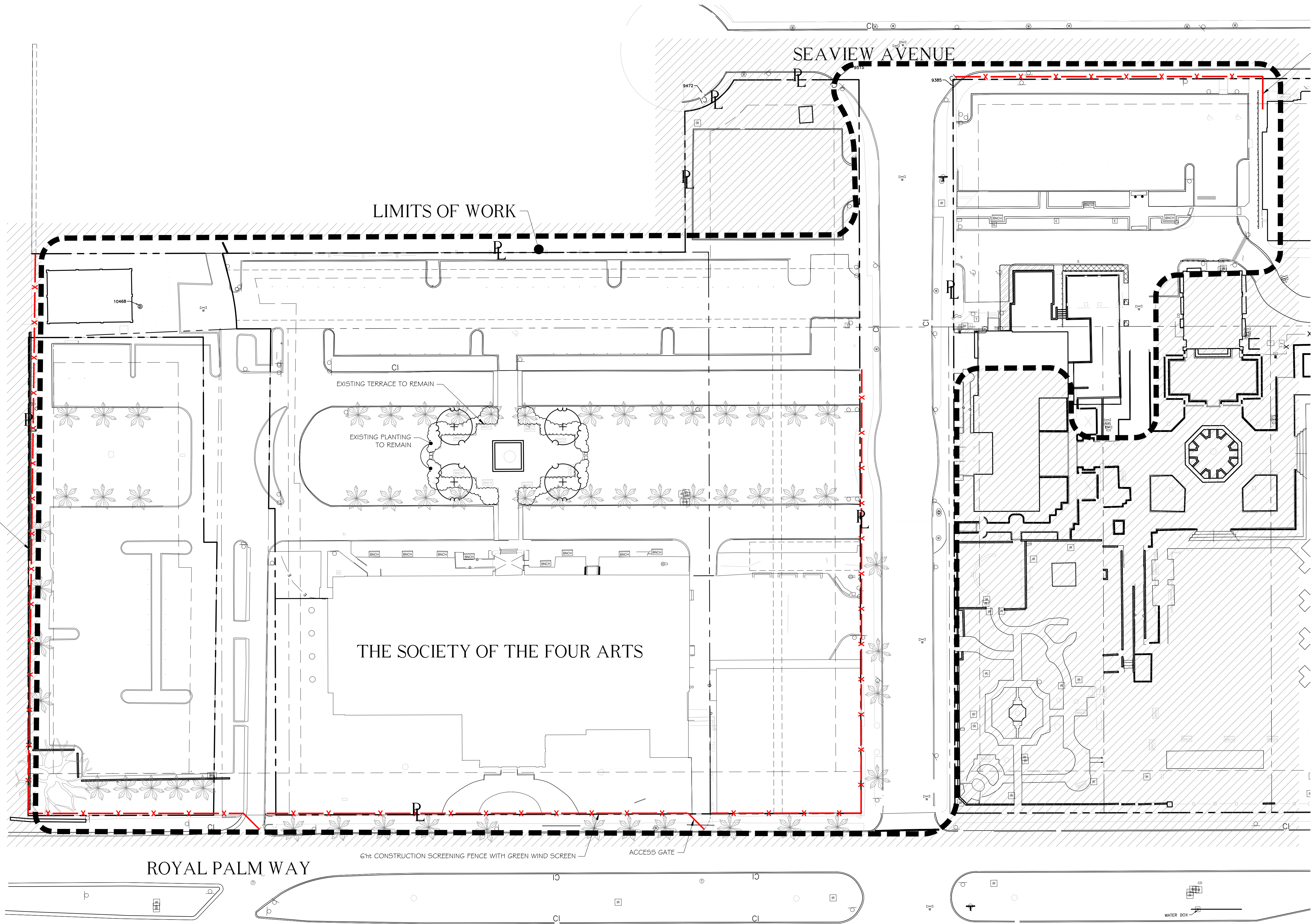

NOTE:
-EXISTING SOD TO REMAIN
-CONTRACTOR TO REPAIR SOD AS NEEDED UNTIL CONSTRUCTION BEGINS
-SOD: STENOTAPHRUM SECUNDATUM 'FLORATAM'
-LOT SHALL BE SODDED AND IRRIGATED PER TOWN REQUIREMENTS

Survey By: Keith Surveying Job # 13223.00

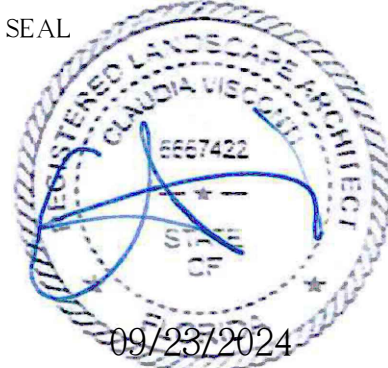

CONSTRUCTION SCREENING

CS-1

1" = 30'-0"
Second Submittal

Project no: 2953
Date: 2024.09.23
Drawn by: VD
Project Manager: CFV

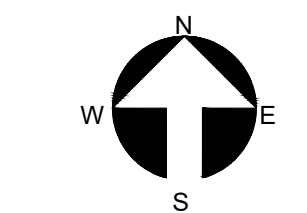

Revisions

THESE DRAWINGS ARE FOR THE
EXCLUSIVE USE OF SPINA OROURKE +
PARTNERS, INC. AND MAY NOT BE
DUPLICATED, REPRODUCED OR USED
IN ANY MANNER WITHOUT THE
EXPRESS WRITTEN CONSENT OF SPINA
OROURKE + PARTNERS, INC. ALL
RIGHTS RESERVED.

The Society of the Four Arts

100 Four Arts Plaza, Palm Beach, FL 33480



SPINA+OROURKE
+ PARTNERS

285 Banyan Blvd
West Palm Beach Florida 33401

561.684.6844 • Fax 561.684.5504
spinaorourke.com

FL Lic # A23802299

Architecture • Interior Design
Keith M. Spina #AR13419

120 Broadway
20th Floor
New York, NY 10271

212.777.7800
beyerblinderbelle.com

SMI

LANDSCAPE ARCHITECTURE
140 Royal Palm Way, Suite 200 Palm Beach, Florida 33480
Fax 561.684.5504
About Our Firm
FL Registration LA 13300223



- A. Deliveries and workers will be using the Royal Park bridge to royal palm way, Continue onto Royal Palm Way. Turn left onto Four Arts Plaza. Turn left.
- B. Maximum truck length = 60 Feet
- C. Total number of estimated deliveries generated by project = 120

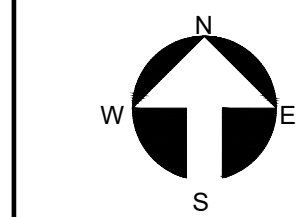

TL-1

NOT TO SCALE
Second Submittal

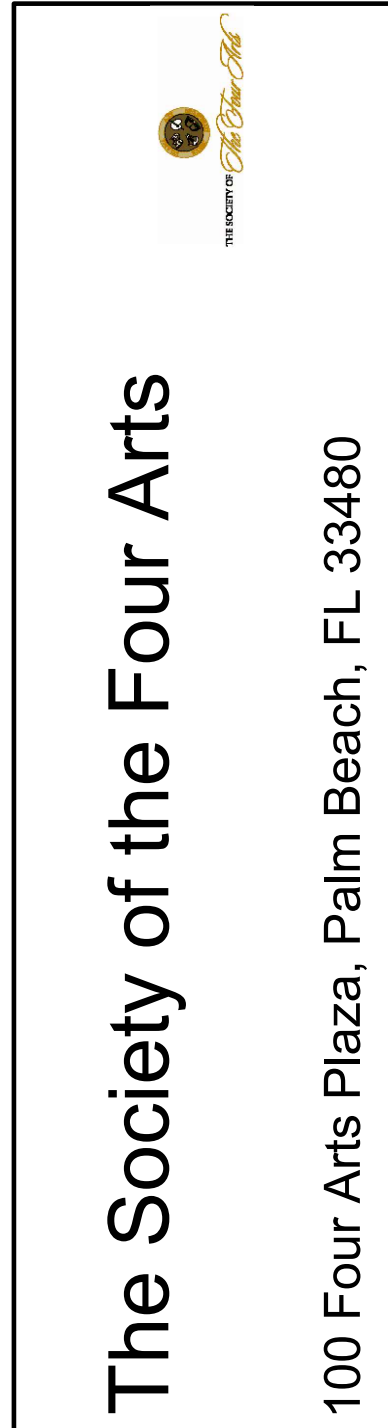

THESE DRAWINGS ARE FOR THE
EXCLUSIVE USE OF SPINA OROURKE +
PARTNERS, INC. AND MAY NOT BE
DUPLICATED, REPRODUCED OR USED
IN ANY MANNER WITHOUT THE
EXPRESS WRITTEN CONSENT OF SPINA
OROURKE + PARTNERS, INC. ALL
RIGHTS RESERVED.

Revisions

△

Project no: 2953
Date: 2024.09.23
Drawn by: VD
Project Manager: CFV

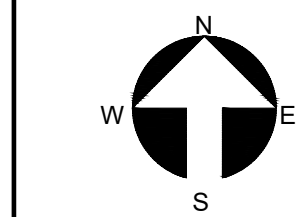

TL-1

NOT TO SCALE
Second Submittal

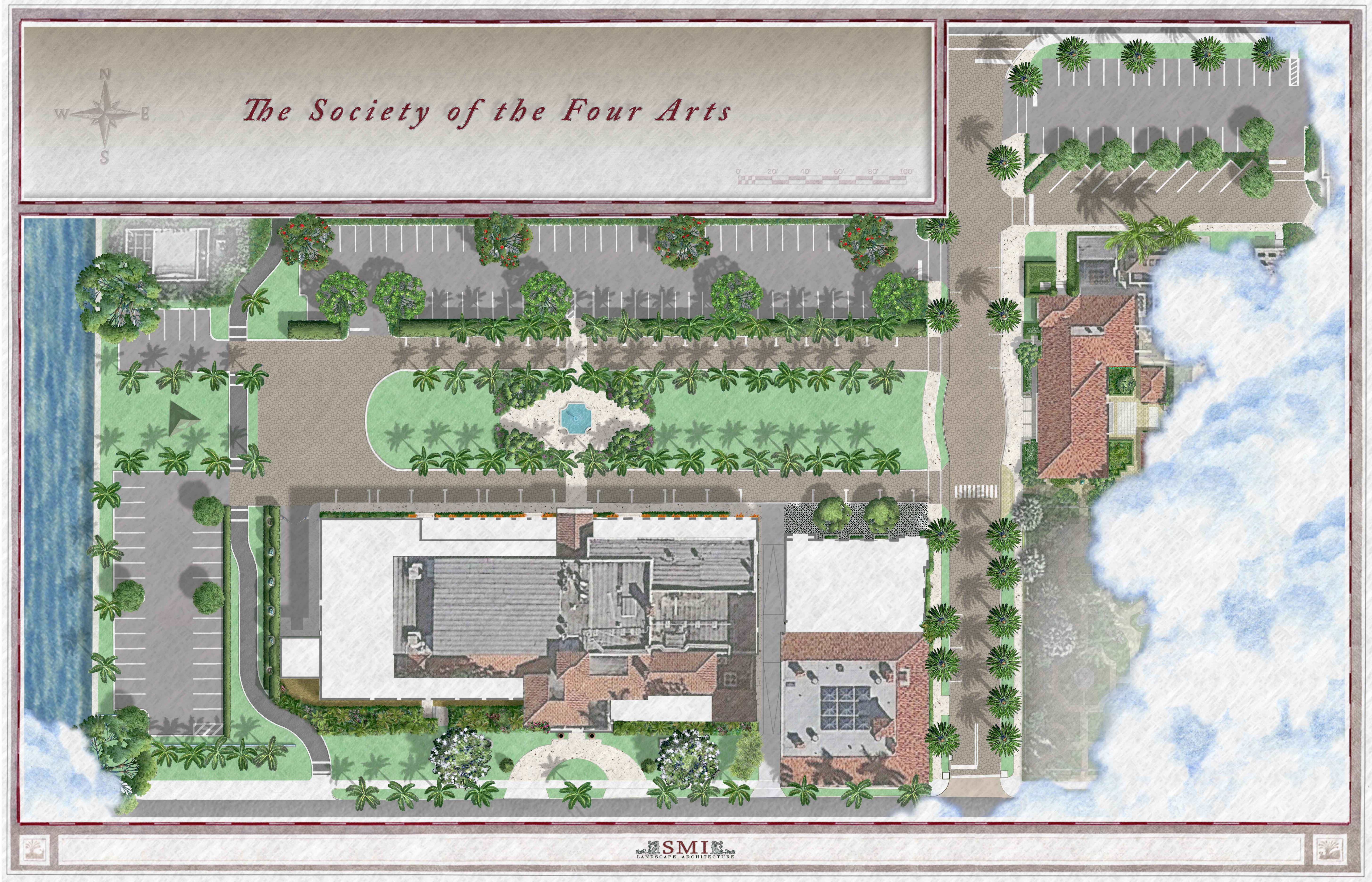

SITE PLAN RENDERING

R-1
(GRAPHIC SCALE)
Second Submittal

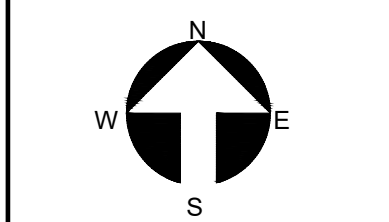

Project no: 2953
Date: 2024.09.23
Drawn by: VD
Project Manager: CFV

Revisions

THESE DRAWINGS ARE FOR THE EXCLUSIVE USE OF SPINA OROURKE + PARTNERS, INC. AND MAY NOT BE DUPLICATED, REPRODUCED OR USED IN ANY MANNER WITHOUT THE EXPRESS WRITTEN CONSENT OF SPINA OROURKE + PARTNERS, INC. ALL RIGHTS RESERVED.

The Society of the Four Arts
100 Four Arts Plaza, Palm Beach, FL 33480



SPINA OROURKE + PARTNERS, INC.

285 Banyan Blvd
West Palm Beach, Florida 33401
561.684.6844 • Fax 561.684.6504
spinaorourke.com
FL Lic # A23802299

BEYER BLINDER BELLE SMI
LANDSCAPE ARCHITECTURE
140 Royal Palm Way, Suite 200, Palm Beach, Florida 33480
Phone: 561.684.6844
Fax: 561.684.6504
beyerblinderbelle.com
FL Registration # LA 13000223

120 Broadway
20th Floor
New York, NY 10271
212.777.7800
beyerblinderbelle.com