

MOORING PILES

RECEIVED

By yfigueroa at 10:49 am, Feb 26, 2024

LAKE WORTH
320 DUNBAR ROAD
TOWN OF PALM BEACH
PALM BEACH COUNTY, FL
FOR:
PETER MAY

FEBRUARY 26, 2024

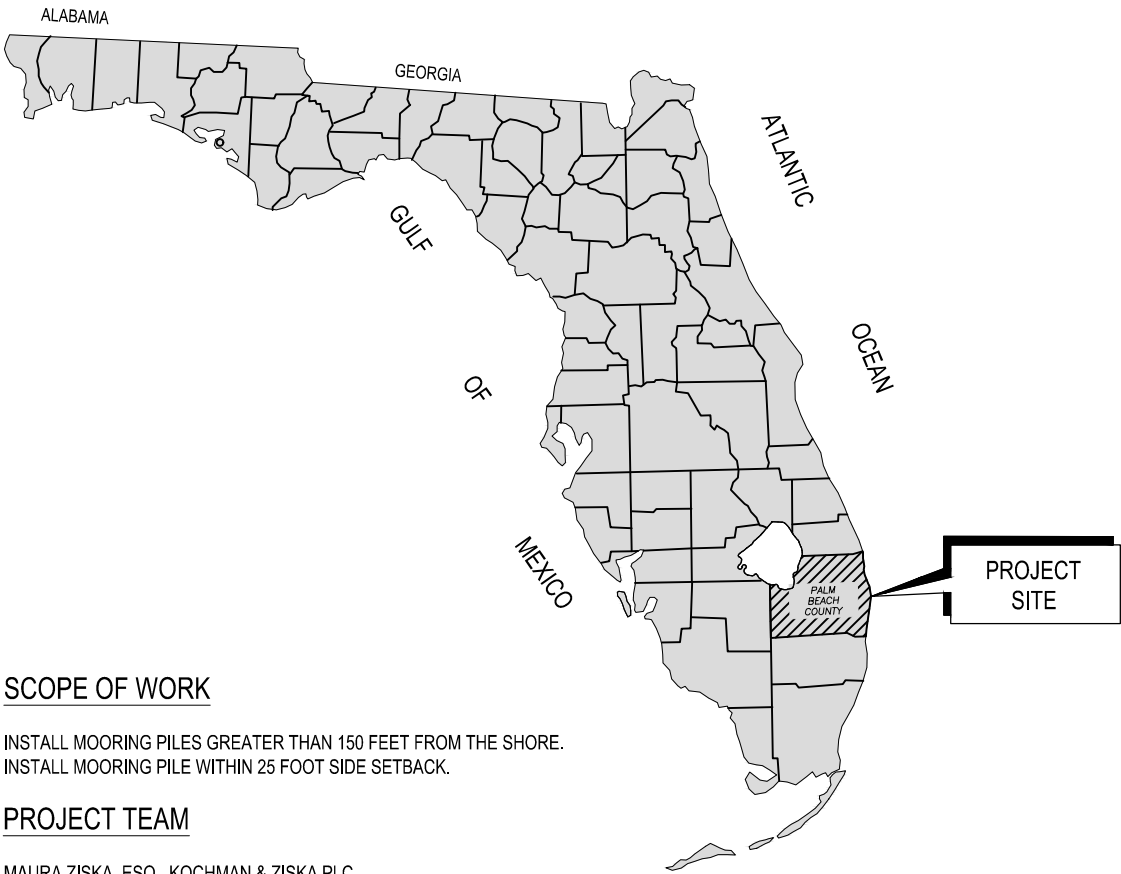

SCOPE OF WORK

INSTALL MOORING PILES GREATER THAN 150 FEET FROM THE SHORE.
INSTALL MOORING PILE WITHIN 25 FOOT SIDE SETBACK.

PROJECT TEAM

MAURA ZISKA, ESQ., KOCHMAN & ZISKA PLC
C. CURRY ISIMINGER, P.E., ISIMINGER & STUBBS ENGINEERING, INC.
CRAIG WALLACE, WALLACE SURVEYING CORP.

SKETCH SUBMITTED FOR TOWN OF PALM BEACH VARIANCE REVIEW.
NOT INTENDED FOR CONSTRUCTION OR BUILDING PERMIT REVIEW.

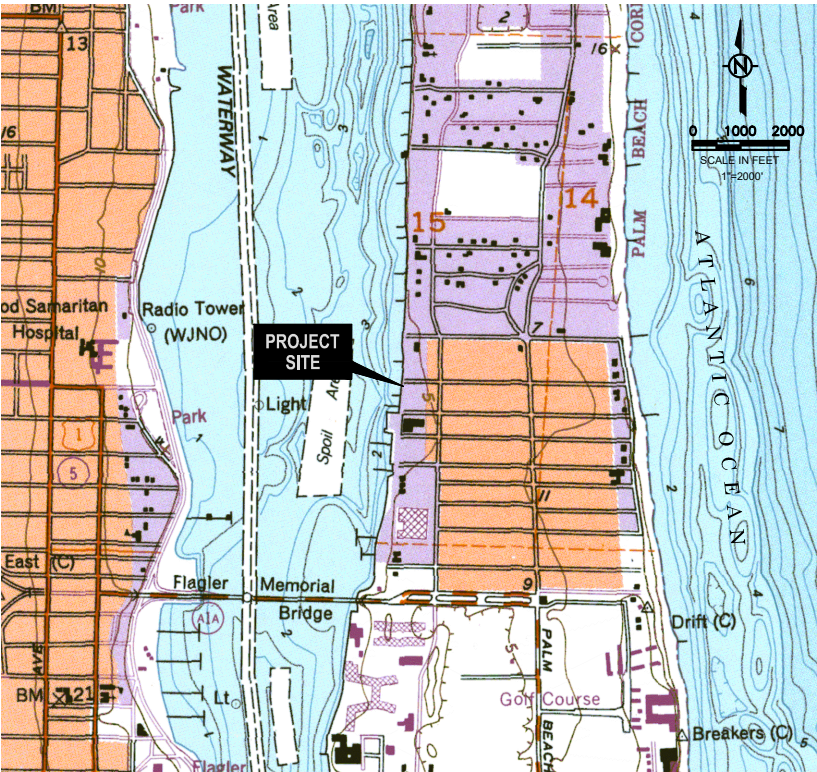

TAKEN FROM U.S.G.S PALM BEACH, FLORIDA QUADRANGLE

INDEX TO DRAWINGS

SHEET	TITLE
1	VICINITY MAP AND TITLE SHEET
2	LOCATION MAP
3	PLAN VIEW
4	AERIAL PLAN VIEW

SECOND SUBMITTAL

ZON-24-051

HEARING DATE: APRIL 10, 2024

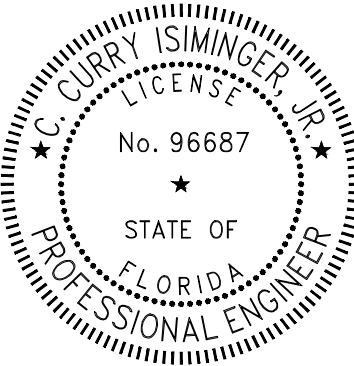

2/26/2024

This item has been digitally signed and sealed by Charles Curry Isiminger, Jr., P.E. on the date adjacent to the seal. Printed copies of this document are not considered signed and sealed and the signature must be verified on any electronic copies.

VICINITY MAP AND TITLE SHEET

ISIMINGER & STUBBS ENGINEERING, INC. COASTAL • ENVIRONMENTAL • MARINE REGISTRY NUMBER: 8114 P.O. BOX 14702 - NORTH PALM BEACH, FL 33408 (561) 881-0003							
MOORING PILES LAKE WORTH 320 DUNBAR ROAD TOWN OF PALM BEACH, PALM BEACH COUNTY, FL APPLICANT: PETER MAY							
DATE	1/24	DRAWN	CCIJR	CHKD	MDB	APPRVD	CCIJR
DWG NO.	22055E1						SHEET
COMPUTER FILE NO.	22055E1r2						OF 4
							1

REV 2 2/24 REV. FOR SECOND SUBMITTAL

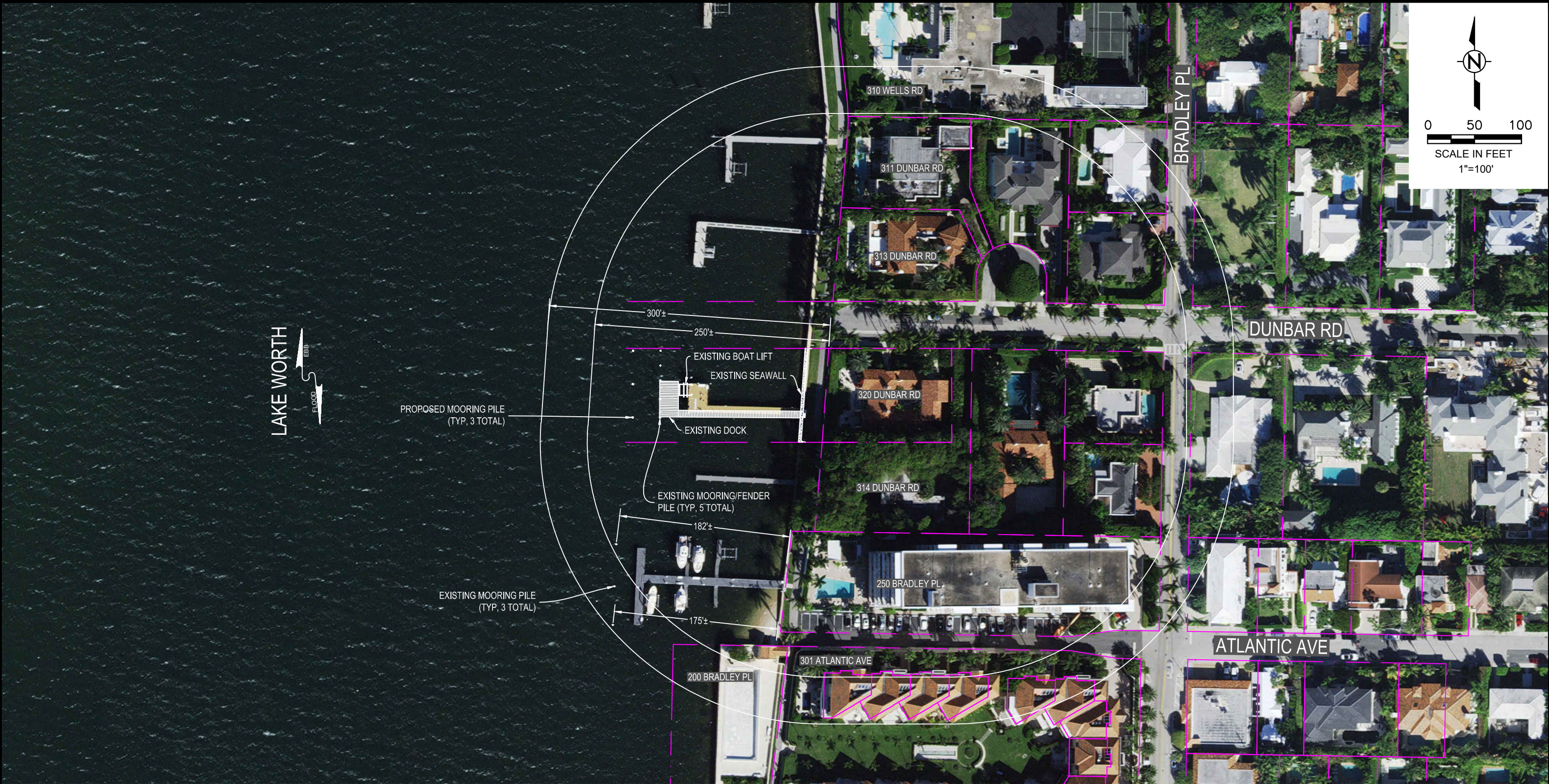

- NOTES:
- 1. PROPERTY LINES ARE APPROXIMATE.
 - 2. 2022 AERIAL PHOTOGRAPH FROM PALM BEACH COUNTY.

SKETCH SUBMITTED FOR TOWN OF PALM BEACH VARIANCE REVIEW.
NOT INTENDED FOR CONSTRUCTION OR BUILDING PERMIT REVIEW.

2/26/2024

This item has been digitally signed and sealed by Charles Curry Isiminger, Jr., P.E. on the date adjacent to the seal. Printed copies of this document are not considered signed and sealed and the signature must be verified on any electronic copies.

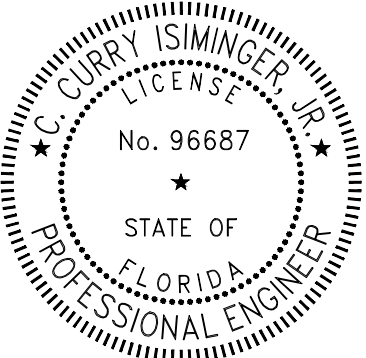

REV 1 2/24 REV. FOR FIRST SUBMITTAL

LOCATION MAP

**ISIMINGER & STUBBS
ENGINEERING, INC.**
COASTAL • ENVIRONMENTAL • MARINE
REGISTRY NUMBER: 8114
P.O. BOX 14702 - NORTH PALM BEACH, FL 33408 (561) 881-0003

**MOORING PILES
LAKE WORTH
320 DUNBAR ROAD
TOWN OF PALM BEACH, PALM BEACH COUNTY, FL
APPLICANT: PETER MAY**

DATE	1/24	DRAWN	CCIJR	CHKD	MDB	APPRVD	CCIJR
DWG NO.	22055E2						SHEET
COMPUTER FILE NO.	22055E1						OF 4

The diagram illustrates a tidal cycle. It features a vertical line with a horizontal bar at the top. The line is labeled 'EBB' on the left side and 'FLOOD' on the right side. The line starts at the top, goes down, then up, then down, then up, and finally down to the bottom. The horizontal bar at the top is labeled 'EBB'.

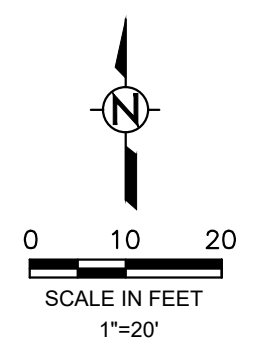

DATE	1/24	DRAWN	CCIJR	CHKD	MDB	APPRVD	CCIJR
DWG NO.	22055E3					SHEET	
COMPUTER FILE NO.	22055Er2					OF 4	
						3	

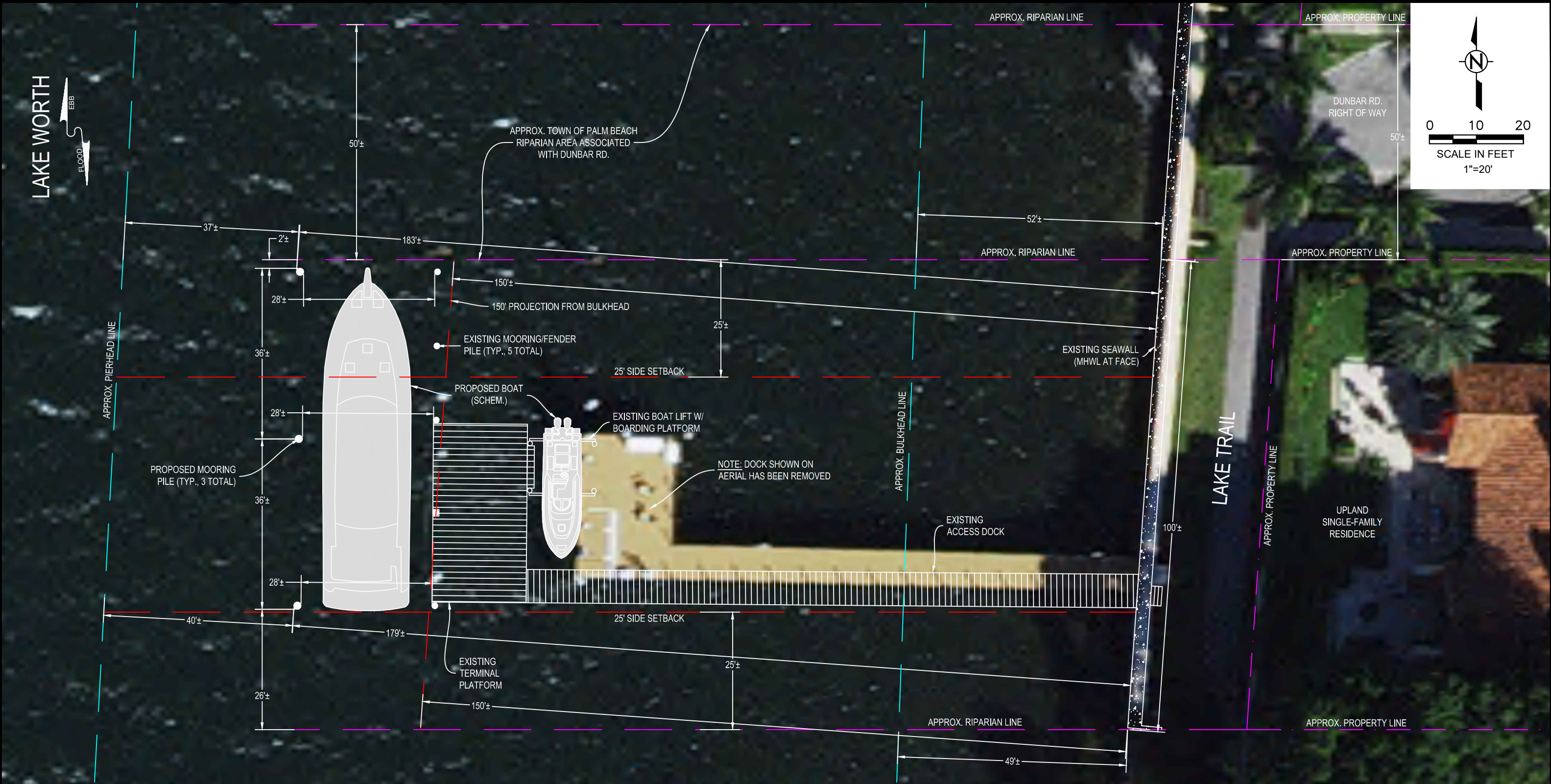

NOTES:

- EXISTING LOCATIONS ARE APPROXIMATE BASED ON SURVEY BY WALLACE SURVEYING CORP., REV. 06/01/17, AND ON-SITE OBSERVATIONS.
- 2022 AERIAL PHOTOGRAPH FROM PALM BEACH COUNTY.

**SKETCH SUBMITTED FOR TOWN OF PALM BEACH VARIANCE REVIEW.
NOT INTENDED FOR CONSTRUCTION OR BUILDING PERMIT REVIEW.**

This item has been digitally signed and sealed by Charles Curry Isiminger, Jr., P.E. on the date adjacent to the seal. Printed copies of this document are not considered signed and sealed and the signature must be verified on any electronic copies.

2/26/2024

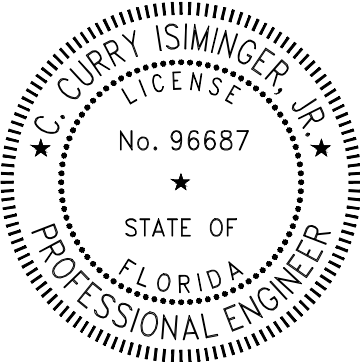

AERIAL PLAN VIEW

**ISIMINGER & STUBBS
ENGINEERING, INC.**
COASTAL • ENVIRONMENTAL • MARINE
REGISTRY NUMBER: 8114
P.O. BOX 14702 - NORTH PALM BEACH, FL 33408 (561) 881-0003

MOORING PILES
LAKE WORTH
320 DUNBAR ROAD
TOWN OF PALM BEACH, PALM BEACH COUNTY, FL
APPLICANT: PETER MAY

DATE	1/24	DRAWN	CCIJR	CHKD	MDB	APPRVD	CCIJR
DWG NO.	22055E4						SHEET OF 4
COMPUTER FILE NO.	22055Er2						

4