

SECTION No.: 93060000
S.R. No.: SR-A1A
FM No.: 447663-1-52-01
COUNTY: PALM BEACH

**AMENDMENT NUMBER ONE (1)
STATE OF FLORIDA DEPARTMENT OF TRANSPORTATION, DISTRICT FOUR (4)
MAINTENANCE MEMORANDUM OF AGREEMENT (MMOA)**

THIS AMENDMENT Number One (1) to the Original Maintenance Memorandum of Agreement (MMOA), FM# 446175-1-52-01 dated 08/14/2023, made and entered into this _____ by and between the **STATE OF FLORIDA DEPARTMENT OF TRANSPORTATION** hereinafter called the **DEPARTMENT** and the **Town of Palm Beach**, a municipal corporation existing under the Laws of Florida, hereinafter called the **AGENCY**.

WITNESSETH

WHEREAS, the parties entered into the Maintenance Memorandum of Agreement dated, 08/14/2023, for the purpose of requiring the **AGENCY** to maintain all existing and new decorative or non-standard lights; and

WHEREAS, the **AGENCY** intends to install additional new decorative or non-standard lights along a portion of SR A1A/ South Ocean Blvd under FM # 447663-1-52-01 within the **DEPARTMENT'S** right-of-way; and

WHEREAS, it is the intent of the **AGENCY** and the **DEPARTMENT** that the **AGENCY** shall maintain: all decorative and non-standard lights, hereinafter referred as "**IMPROVEMENTS**" within the project limits along SR A1A/ South Ocean Blvd from Mile Post (M.P.) 20.307 to M.P. 20.348 and from M.P. 20.594 to M.P. 22.381 and,

WHEREAS the installation of the **IMPROVEMENTS** pursuant to this Amendment extends the **AGENCY's** maintenance limits, as described in **Exhibit A**, of the Original Agreement dated 08/14/2023; and

WHEREAS, the **AGENCY** by Resolution No. _____ dated _____, attached hereto and by this reference made a part hereof, desires to enter into this MMOA Amendment and authorized its officers to do so.

NOW THEREFORE, for and in consideration of mutual benefits that flow each to the other, the parties covenant and agree as follows:

1. **Exhibit "A"** of the Maintenance Memorandum of Agreement dated 08/14/2023, shall be amended to include the additional areas: SR A1A/ South Ocean Blvd from 20.307 to M.P. 20.348 and from M.P. 20.594 to M.P. 22.381, as set forth in Exhibit A attached and incorporated into this Amendment.
2. The **DEPARTMENT** shall construct the **IMPROVEMENTS** along A1A/ South Ocean Blvd from M.P. 20.307 to M.P. 20.348 and from M.P. 20.594 to M.P. 22.381 as set forth in **Exhibit A** in accordance with the plans attached as **Exhibit B**.
3. The **AGENCY** shall agree to maintain the additional **IMPROVEMENTS** in the

SECTION No.: 93060000
S.R. No.: SR-A1A
FM No.: 447663-1-52-01
COUNTY: PALM BEACH

AGREEMENT described above.

4. Except as modified by this Amendment, all terms and conditions of this original **AGREEMENT** and all Amendments thereto shall remain in full force and effect.
5. **LIST OF EXHIBITS**

Exhibit A – Project location, description and aerial image

Exhibit B – Project plans

SECTION No.: 93060000
S.R. No.: SR-A1A
FM No.: 447663-1-52-01
COUNTY: PALM BEACH

IN WITNESS OF THE FOREGOING, the parties have set their hands and seals the day and year first above written.

TOWN OF PALM BEACH

By: _____
Chairperson/Mayor/Manager

Date: _____

Attest: _____ (SEAL)
City Clerk

Legal Approval

Attorney

Date

SECTION No.: 93060000
S.R. No.: SR-A1A
FM No.: 447663-1-52-01
COUNTY: PALM BEACH

IN WITNESS OF THE FOREGOING, the parties have set their hands and seals the day and year first above written.

DEPARTMENT:

STATE OF FLORIDA
DEPARTMENT OF TRANSPORTATION

Sign: _____
Director of Operations

Print Name: Paul A. Lampley

Date: _____

Approval as to Form:

Sign: _____
District General Counsel

Print Name: _____

Date: _____

SECTION No.: 93060000
S.R. No.: SR-A1A
FM No.: 447663-1-52-01
COUNTY: PALM BEACH

EXHIBIT A

PROJECT LOCATION, DESCRIPTION AND AERIAL IMAGE

I. Location of additional IMPROVEMENTS:

The additional **IMPROVEMENTS** associated with this Agreement are within the **DEPARTMENT's** right-of-way, within limits of the Town of Palm Beach, Florida, along State Road A1A / South Ocean Blvd from Mile Post (M.P.) M.P. 20.307 to M.P. 20.348 and from M.P. 20.594 to M.P. 22.381.

II. Description of Work:

The proposed project consists of new installation of decorative and non-standard lights.

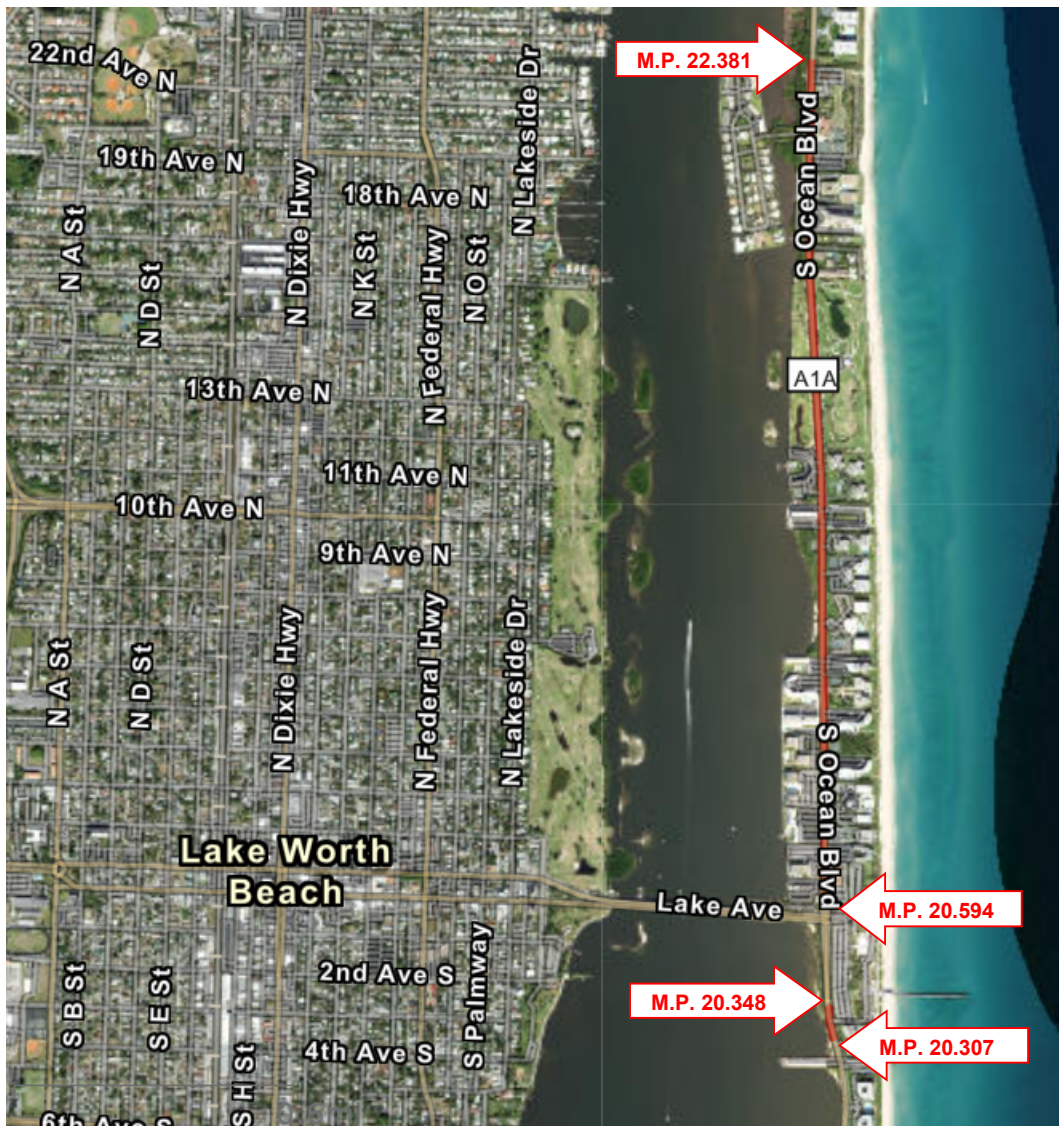

SECTION No.: 93060000
S.R. No.: SR-A1A
FM No.: 447663-1-52-01
COUNTY: PALM BEACH

III. Entire limits of IMPROVEMENTS

The entire limits of the **IMPROVEMENTS** that shall be maintain by the **AGENCY** are within the **DEPARTMENT's** right-of-way, within limits of the Town of Palm Beach, Florida, along State Road A1A from 20.307 to M.P. 20.348, from M.P. 20.594 to M.P. 22.381 and from M.P. 24.835 to M.P. 27.044.

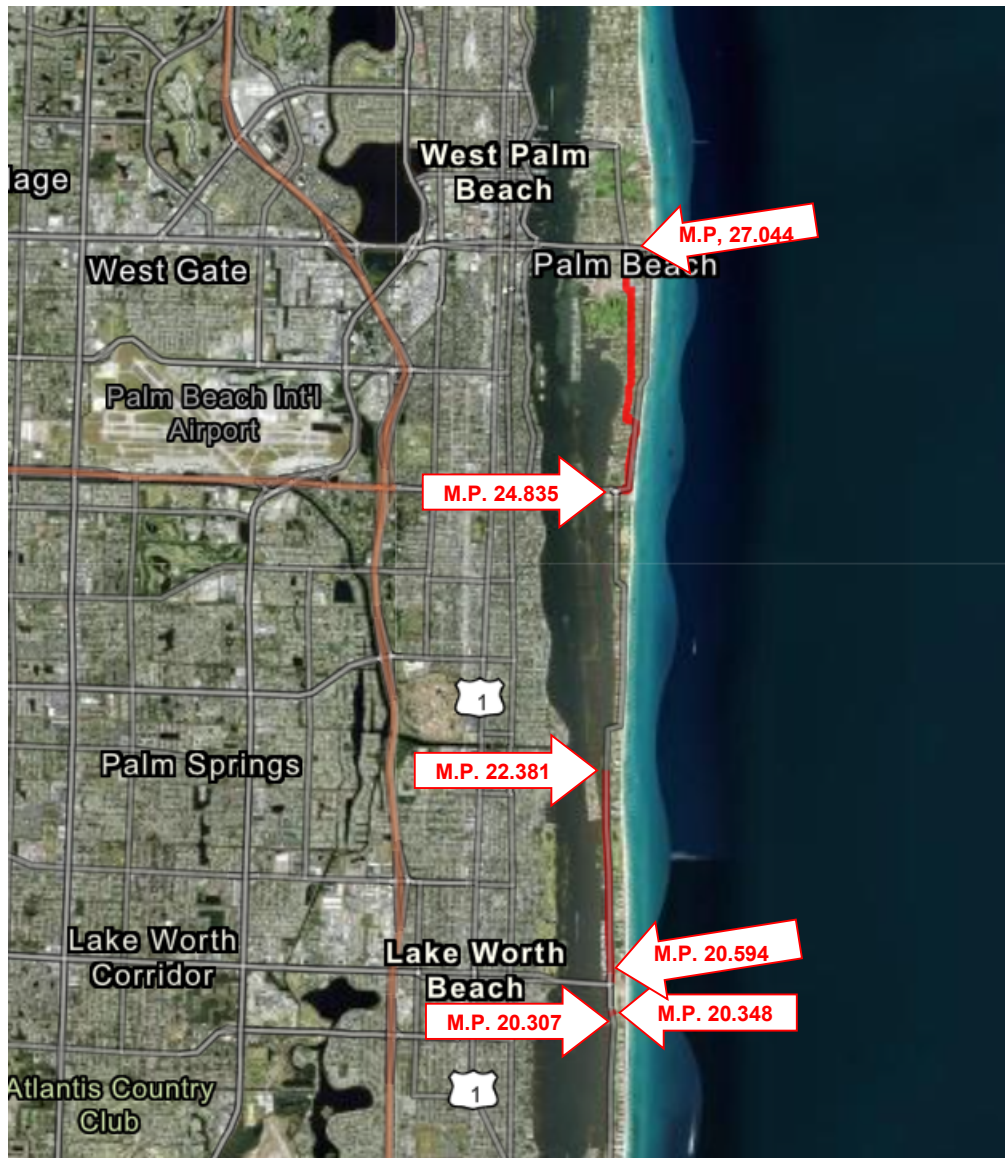

SECTION No.: 93060000
S.R. No.: SR-A1A
FM No.: 447663-1-52-01
COUNTY: PALM BEACH

EXHIBIT B

Lighting Plans prepared by Fernando Amado-Mateus P.E., Trace Consultants, INC., dated December 22, 2022, as approved by the **DEPARTMENT**.

Construction Plans (attached)

Sheets included:

PDF Page Number (#)	Plan Sheet (#)	Sheet Description
8	L-1	KEY SHEET
9	L-2	GENERAL NOTES
10	L-3	LIGHTING DATA TABLE
11-13	L-4 THRU L-6	LIGHTING PLAN
14-16	L-7 THRU L-9	LIGHTING POLE DETAILS
17	L-10	LOAD CENTER DETAILS

[The remainder of this page intentionally left blank]

STATE OF FLORIDA
DEPARTMENT OF TRANSPORTATION
LIGHTING PLANS

FINANCIAL PROJECT ID 447663-1-52-01
PALM BEACH COUNTY (93060)

STATE ROAD NO. SR A1A
FROM SOUTH OF LAKE AVE TO N OF IBIS WAY

PROJECT LOCATION URL: <https://tinyurl.com/mat4v9cb>
PROJECT LIMITS: BEGIN MP 20.307 - END MP 22.381
EXCEPTIONS: NONE
BRIDGE LIMITS: NONE
RAILROAD CROSSING: NONE

INDEX OF LIGHTING PLANS

SHEET NO.	SHEET DESCRIPTION
L-1	KEY SHEET
L-2	GENERAL NOTES
L-3	LIGHTING DATA TABLE
L-4 - L-6	LIGHTING PLAN
L-7 - L-9	LIGHT POLE DETAILS
L-10	LOAD CENTER DETAILS

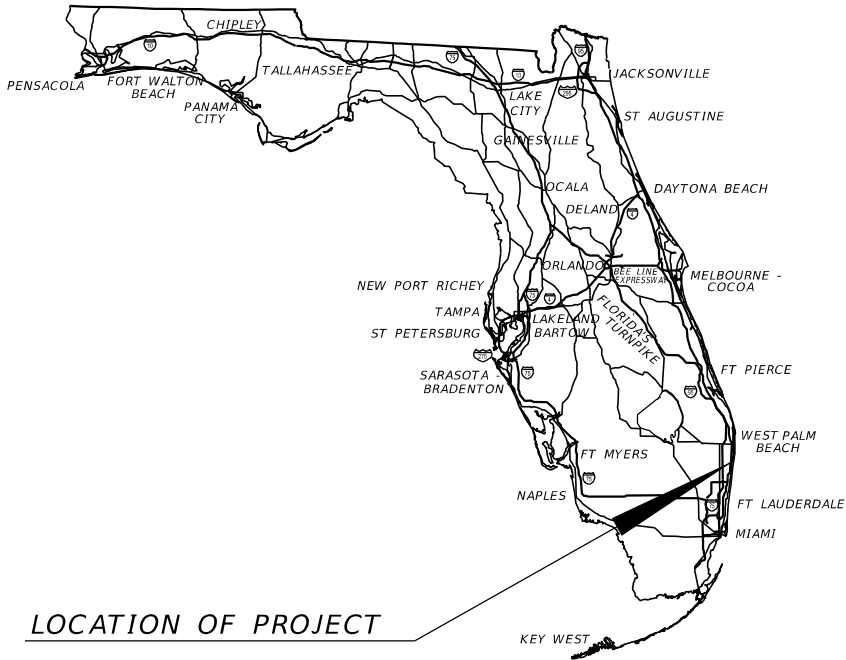

LOCATION OF PROJECT

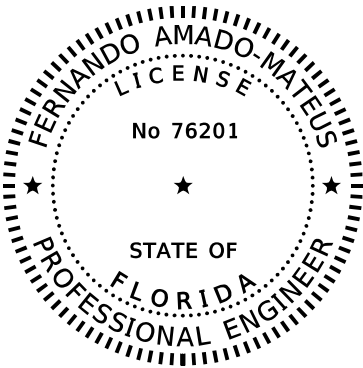

THIS ITEM HAS BEEN DIGITALLY
SIGNED AND SEALED BY

ON THE DATE ADJACENT TO THE SEAL

PRINTED COPIES OF THIS DOCUMENT ARE
NOT CONSIDERED SIGNED AND SEALED
AND THE SIGNATURE MUST BE VERIFIED
ON ANY ELECTRONIC COPIES.

THE ABOVE NAMED PROFESSIONAL IS
RESPONSIBLE FOR THE FOLLOWING SHEETS
IN ACCORDANCE WITH RULE 61G15-23.004, F.A.C.

LIGHTING PLANS
ENGINEER OF RECORD:

FERNANDO AMADO MATEUS, P.E.
P.E. LICENSE NUMBER 76201
TRACE CONSULTANTS, INC.
8900 SW 117 AVENUE, SUITE 105B
MIAMI, FLORIDA 33186
PHONE: 786-808-0119
CONTRACT NO.: CAH06
VENDOR NO.: F455418595

FDOT PROJECT MANAGER:

VANDANA NAGOLE, P.E.

CONSTRUCTION CONTRACT NO.	FISCAL YEAR	SHEET NO.
E0000	25	L-1

GENERAL NOTES

1.

CONTACT THE MAINTAINING AGENCY FOR ALL STREET LIGHTING INSPECTIONS. PROVIDE A TWO (2) WEEK NOTICE IN ADVANCE TO SCHEDULE INSPECTIONS. CONTACT INFORMATION BELOW:

1.1 CITY OF LAKE WORTH BEACH PUBLIC WORKS

1749 3RD AVENUE SOUTH
LAKE WORTH BEACH, FL 33460

CONTACT:
MELISSA STURDIVANT
PUBLIC WORKS OFFICE MANAGER
(561) 586-1720

1.2 TOWN OF PALM BEACH PUBLIC WORKS

951 OKEECHOBEE RD. SUITE A
WEST PALM BEACH, FL 33401

CONTACT:
H. PAUL BRAZIL, P.E.
DIRECTOR OF PUBLIC WORKS
(561) 838-5440

1.3 PALM BEACH COUNTY ENGINEERING AND PUBLIC WORKS-TRAFFIC

2300 NORTH JOG ROAD, 3RD FLOOR
WEST PALM BEACH, FL 33411

CONTACT:
MOTASEM AL-TURK, P.E., Ph.D.
DIRECTOR OF ENGINEERING AND PUBLIC WORKS-TRAFFIC
(561) 684-4030
2.















DELIVER ALL SALVAGEABLE LIGHTING EQUIPMENT TO EACH MAINTAINING AGENCY WHERE LIGHTING WORK TAKES PLACE. LIGHTING EQUIPMENT CONSIDERED SALVAGEABLE ARE SALVAGEABLE ALUMINUM POLES, LUMINAIRES, AND CABLE DISTRIBUTION SYSTEMS.

PAY ITEM NOTES:

715-5-32

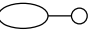
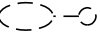
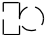
COST INCLUDES FURNISHING AND INSTALLING THE FOLLOWING LUMINAIRES:
AUTOBAHN ATB SERIES, MODEL ATB2 (264 W, 4000 CCT, R4 DISTRIBUTION,WIRED FOR 120 V, 3-PIN NEMA PHOTOCONTROL RECEPTACLE, SHORTING CAP & PHOTOCELL)

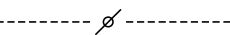
LEGEND

SYMBOLS	DESCRIPTION
<div><div>(WORK BY FDOT CONTRACTOR)</div><div></div></div>	<div>ORNAMENTAL LIGHT POLE AND LED LUMINAIRE DESIGNED FOR 10,173 LUMENS, TYPE III DISTRIBUTION, 7 PIN PHOTOCONTROL RECEPTACLE WITH SHORTING CAP, WIRED FOR 240 VOLT OPERATION. NO PHOTOCELL REQUIRED. SINGLE ARM POLE.</div> <div>PHOTOMETRIC DISTRIBUTION CURVE USED FOR DESIGN: MSR_108W_48LED_G2_LE3WS.ies</div> <div>LUMINAIRE RETROFIT FOR EXISTING ORNAMENTAL POLE DESIGNED FOR 10,173 LUMENS, TYPE III DISTRIBUTION, 7 PIN PHOTOCONTROL RECEPTACLE WITH SHORTING CAP, AND WIRED FOR 120 VOLT OPERATION. NO PHOTOCELL REQUIRED. SINGLE ARM POLE.</div> <div>PHOTOMETRIC DISTRIBUTION CURVE USED FOR DESIGN: MSR_108W_48LED_G2_LE3WS.ies</div> <div>LUMINAIRE RETROFIT FOR TRAFFIC SIGNAL POLE DESIGNED FOR 33,907 LUMENS, TYPE IV DISTRIBUTION, 3 PIN NEMA PHOTOCONTROL RECEPTACLE WITH SHORTING CAP, AND WIRED FOR 120 VOLT OPERATION. PHOTOCELL REQUIRED. SINGLE ARM POLE.</div> <div>PHOTOMETRIC DISTRIBUTION CURVE USED FOR DESIGN: ATB2_P604_R4_4K.ies</div> <div>LUMINAIRE RETROFIT FOR UTILITY CONCRETE POLE DESIGNED FOR 22,612 LUMENS, TYPE III DISTRIBUTION, 7 PIN PHOTOCONTROL RECEPTACLE WITH SHORTING CAP, AND WIRED FOR 480 VOLT OPERATION. NO PHOTOCELL REQUIRED. SINGLE ARM POLE.</div> <div>PHOTOMETRIC DISTRIBUTION CURVE USED FOR DESIGN: ATB2_P602_R4_4K_RFD325843.ies (WORK BY TOWN OF LAKE WORTH BEACH)</div>
<div><div>(WORK BY FPL)</div><div></div></div>	<div>ORNAMENTAL LIGHT POLE AND LED LUMINAIRE DESIGNED FOR 22,612 LUMENS, TYPE III DISTRIBUTION. CONCRETE POLE IS OCTOGONAL-SHAPED, SINGLE ARM POLE WITH PENDANT ARM, WITH BLACK FINISH FOR POLE AND LUMINAIRE HOUSING.</div> <div>PHOTOMETRIC DISTRIBUTION CURVE USED FOR DESIGN: ESL3_P45S_40K_XXXXXX_TG3.ies</div> <div>LUMINAIRE RETROFIT FOR EXISTING ORNAMENTAL POLE DESIGNED FOR 22,612 LUMENS, TYPE III DISTRIBUTION. SINGLE ARM POLE WITH PENDANT ARM, WITH BLACK FINISH FOR LUMINAIRE HOUSING.</div> <div>PHOTOMETRIC DISTRIBUTION CURVE USED FOR DESIGN: ESL3_P45S_40K_XXXXXX_TG3.ies</div>
	EXISTING LIGHT POLE TO REMAIN (ANY TYPE)
	EXIST. LOAD CENTER TO REMAIN
	EXISTING PULL BOX
	PROPOSED PULL BOX AND APRON
	EXISTING CONDUIT
	2" HIGH DENSITY POLYETHYLENE (HDPE) CONDUIT (DIRECTIONAL BORE) WITH THREE RHW-2/XLP CONDUCTORS INSIDE THE CONDUIT: ONE WITH RED INSULATION, ONE WITH WHITE INSULATION, AND ONE GROUND WITH GREEN INSULATION.
	2" HIGH DENSITY POLYETHYLENE (HDPE) CONDUIT (OPEN TRENCH) WITH THREE RHW-2/XLP CONDUCTORS INSIDE THE CONDUIT: ONE WITH BLACK INSULATION, ONE WITH WHITE INSULATION, AND ONE GROUND WITH GREEN INSULATION.

WORK BY FPL

REVISIONS				ENGINEER OF RECORD		STATE OF FLORIDA DEPARTMENT OF TRANSPORTATION			GENERAL NOTES	SHEET NO.
DATE	DESCRIPTION		DATE	DESCRIPTION		ROAD NO.	COUNTY	FINANCIAL PROJECT ID		
						SR A1A	PALM BEACH	447663-1-52-01		L-2

FERNANDO AMADO-MATEUS, P.E.
LICENSE NUMBER: 76201
TRACE CONSULTANTS, INC.
8900 SW 117 AVENUE, SUITE 105B
MIAMI, FLORIDA 33186

8/11/2023 10:18:24 PM Fernando Z:\FDOT\Connect\10\10\Workspaces\FDOT\44766315201\Lighting\PLDTLT01.dgn

LIGHTING DATA TABLE												
SR A1A & SR 802/LAKE AVENUE	POLE NO.	CIRCUIT*	STATION	POLE OFFSET	MOUNTING HEIGHT	POLE TYPE	ARM CONFIGURATION	ARM LENGTH	WATTAGE	LOCATION	FOUNDATION	PAY ITEM
	LPLWB-01	B-1	121+45* / BL SURVEY SR A1A	49' LT*	20*	EXIST. ORNAMENTAL CONC.POLE / RETROFIT	PENDANT	3'(*)	97	BACK OF SWK	CYLINDRICAL	715-11-216
	LPLWB-02	A-1	121+47* / BL SURVEY SR A1A	49' RT*	20*	EXIST. ORNAMENTAL CONC.POLE / RETROFIT	PENDANT	3'(*)	97	BACK OF SWK	CYLINDRICAL	715-11-216
	LPLWB-03	A-1	121+86* / BL SURVEY SR A1A	49' RT	20	LIGHT POLE COMPLETE, ORNAMENTAL CONC.	PENDANT	3'	97	BEHIND SWK	SPREAD FOOTER	715-511-320
	LPTS-01	TS	122+51* / BL SURVEY SR A1A	52' LT*	40*	EXIST. TRAFFIC SIGNAL POLE / RETROFIT	BRACKET MOUNT	10'(*)	264	EXIST. SIGNAL ARM	CYLINDRICAL	715-11-211
	LPLWB-04	B-2	122+69* / BL SURVEY SR A1A	128' LT	20	LIGHT POLE COMPLETE, ORNAMENTAL CONC.	PENDANT	3'	97	BEHIND SWK	CYLINDRICAL	715-511-320
	LPLWB-05	B-2	122+73* / BL SURVEY SR A1A	177' LT*	20*	EXIST. ORNAMENTAL CONC. POLE / RETROFIT	PENDANT	3'(*)	97	BEHIND SWK	CYLINDRICAL	715-11-216
	LPTS-02	TS	123+57* / BL SURVEY SR A1A	63' RT*	40*	EXIST. TRAFFIC SIGNAL POLE / RETROFIT	BRACKET MOUNT	10'(*)	264	EXIST. SIGNAL ARM	CYLINDRICAL	715-11-211
	LPLWB-06	A-2	123+70* / BL SURVEY SR A1A	154' LT*	20*	EXIST. ORNAMENTAL CONC. POLE / RETROFIT	PENDANT	3'(*)	97	BEHIND OF SWK	CYLINDRICAL	715-11-216
	LPTS-03	TS	123+78* / BL SURVEY SR A1A	74' LT*	40*	EXIST. TRAFFIC SIGNAL POLE / RETROFIT	BRACKET MOUNT	10'(*)	264	EXIST. SIGNAL ARM	CYLINDRICAL	715-11-211
LPTPB-01	EXIST	124+86* / BL SURVEY SR A1A	49' LT*	40*	EXIST. UTILITY POLE CONC. POLE/ RETROFIT	BRACKET MOUNT	12'(*)	186	BACK OF SWK	DIRECT BURIAL	N/A	
SR A1A & PG3	LPPG3-01	EXIST	185+32* / BL SURVEY A1A	37' LT*	37*	EXIST. ORNAMENTAL CONC. POLE / RETROFIT (FPL)	PENDANT	6'(*)	153	BEHIND SWK	DIRECT BURIAL	N/A
	LPPG3-02	EXIST	186+13* / BL SURVEY A1A	35' LT*	37'	PROP. ORNAMENTAL CONC. POLE (FPL)	PENDANT	6'	153	BEHIND SWK	DIRECT BURIAL	N/A
	LPPG3-03	EXIST	187+02* / BL SURVEY A1A	35' LT*	37*	EXIST. ORNAMENTAL CONC. POLE / RETROFIT (FPL)	PENDANT	6'(*)	153	BEHIND SWK	DIRECT BURIAL	N/A
	LPPG3-04	EXIST	187+79* / BL SURVEY A1A	35' LT*	37*	PROP. ORNAMENTAL CONC. POLE (FPL)	PENDANT	6'	153	BEHIND SWK	DIRECT BURIAL	N/A
SR A1A & PP	LPPHI-01	EXIST	215+92 / BL SURVEY A1A	38' LT	37'	EXIST. ORNAMENTAL CONC. POLE / RETROFIT (FPL)	PENDANT	6'	153	BEHIND SWK	DIRECT BURIAL	N/A
	LPPHI-02	EXIST	216+88 / BL SURVEY A1A	32' LT	37'	PROP. ORNAMENTAL CONC. POLE (FPL)	PENDANT	6'	153	BEHIND SWK	DIRECT BURIAL	N/A
* EXISTING STATIONS, OFFSETS AND MOUNTING HEIGHTS TO REMAIN - PROVIDED FOR REFERENCE ONLY.												
TS: EXISTING CIRCUIT CONNECTED TO TRAFFIC SIGNAL SYSTEM, TO REMAIN												
<div>LIGHTING WORK BY UTILITY COMPANY</div> <div><div></div> WORK BY FP&L</div> <div><div></div> WORK BY LAKE WORTH BEACH UTILITY COMPANY</div>												
<div>WORK BY FPL</div> <div>3 NEW POLES 3 RETROFITS</div> <div>CONVENTIONAL LIGHTING DESIGN CRITERIA</div> <div>EXISTING SIGNALIZED INTERSECTION</div> <div>Average Initial Intensity (H.F.C.) 1.5 Std/1.0 Min. Vertical Illuminance Ratio (V.F.C) 1.5 Std/1.0 Min. Uniformity Ratio Avg./Min. 4:1 or less Uniformity Ratio Max./Min. 10:1 or less Wind Speed 160 MPH</div> <div>MIDBLOCK CROSSING</div> <div>Average Initial Intensity (H.F.C.) N/A Vertical Illuminance Ratio (V.F.C) 1.5 Std Uniformity Ratio Avg./Min. N/A Uniformity Ratio Max./Min. N/A Wind Speed 160 MPH</div>												
REVISIONS						ENGINEER OF RECORD		STATE OF FLORIDA DEPARTMENT OF TRANSPORTATION			LIGHTING DATA TABLE	
DATE	DESCRIPTION			DATE	DESCRIPTION		ROAD NO.		COUNTY	FINANCIAL PROJECT ID		
							SR A1A		PALM BEACH	447663-1-52-01	SHEET NO.	
						FERNANDO AMADO-MATEUS, P.E. LICENSE NUMBER: 76201 TRACE CONSULTANTS, INC. 8900 SW 117 AVENUE, SUITE 105B MIAMI, FLORIDA 33186						L-3

THE OFFICIAL RECORD OF THIS SHEET IS THE ELECTRONIC FILE DIGITALLY SIGNED AND SEALED UNDER RULE 61G15-23.004, F.A.C.

8/11/2023 10:18:56 PM Fanado
Z:\FDOT\Connect\10.10\Workspaces\FDOT\Worksets\FDOT\44766315201\Lighting\PLAN\L101.dgn

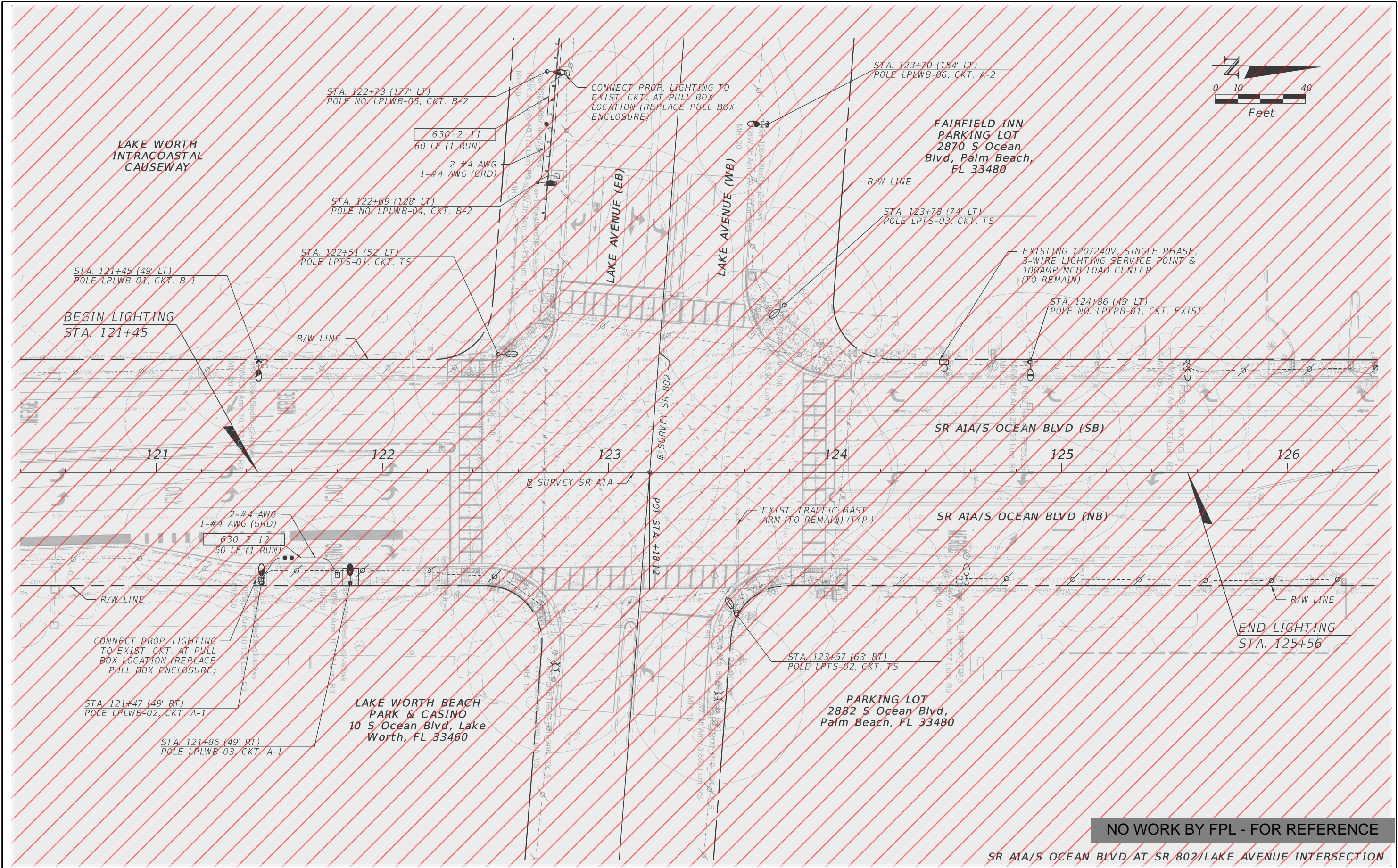

REVISIONS				ENGINEER OF RECORD		STATE OF FLORIDA DEPARTMENT OF TRANSPORTATION			SHEET NO.
DATE	DESCRIPTION	DATE	DESCRIPTION	FERNANDO AMADO-MATEUS, P.E. LICENSE NUMBER: 76201 TRACE CONSULTANTS, INC. 8900 SW 117 AVENUE, SUITE 105B MIAMI, FLORIDA 33186		ROAD NO.	COUNTY	FINANCIAL PROJECT ID	
						SR A1A	PALM BEACH	447663-1-52-01	

NO WORK BY FPL - FOR REFERENCE

SR A1A/S OCEAN BLVD AT SR 802/LAKE AVENUE INTERSECTION

LIGHTING PLAN

L-4

THE OFFICIAL RECORD OF THIS SHEET IS THE ELECTRONIC FILE DIGITALLY SIGNED AND SEALED UNDER RULE 61G15-23.004, F.A.C.

8/11/2023 10:18:57 PM fanado
Z:\FDOT\Connect 10.10\Workspaces\FDOT\Worksets\FDOT\4476631520\Lighting\PLAN\LT01.dgn

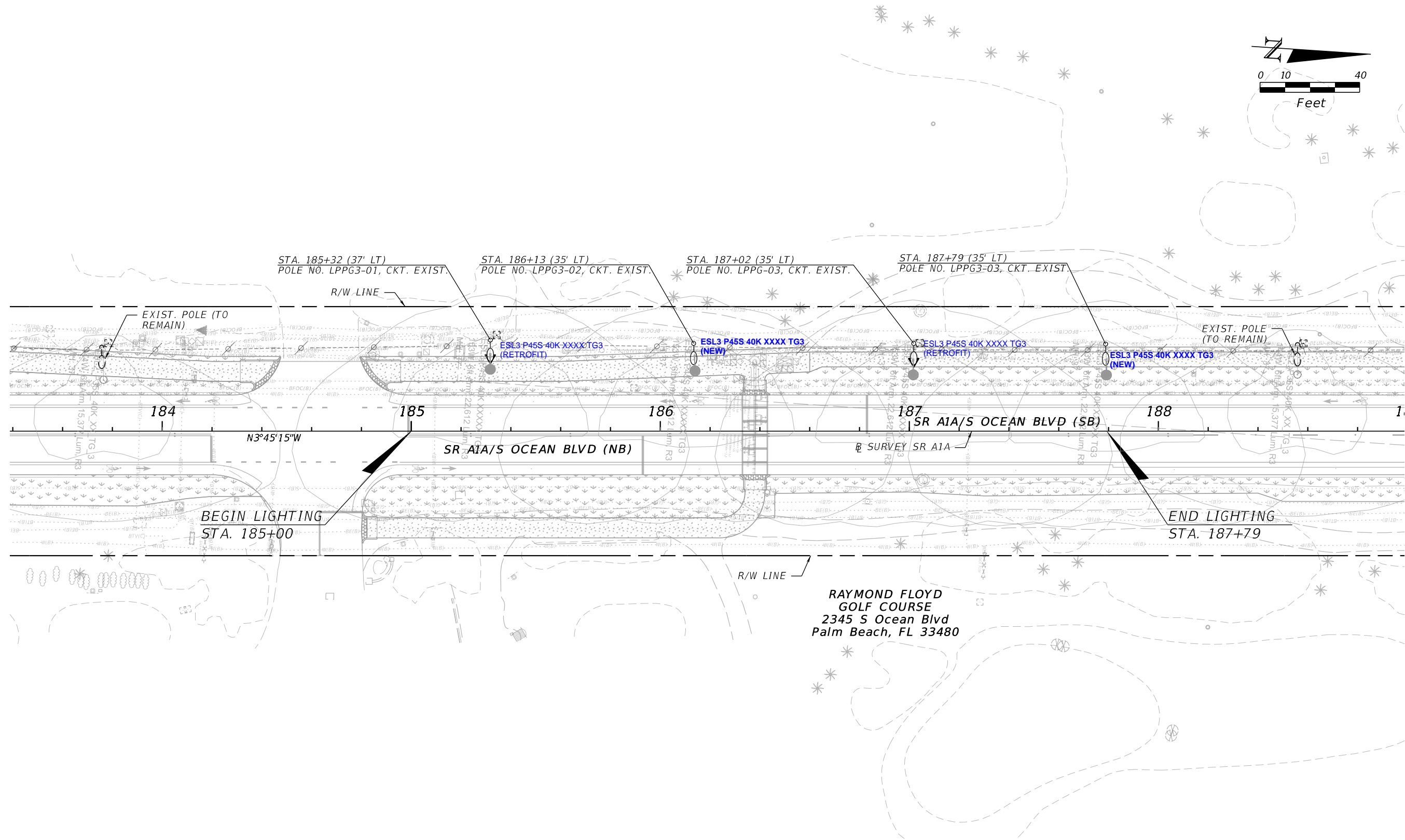

WORK BY FPL

SR A1A/S OCEAN BLVD AT RAYMOND FLOYD GOLF COURSE (PG-3)
MID-BLOCK CROSSING

REVISIONS				ENGINEER OF RECORD	STATE OF FLORIDA DEPARTMENT OF TRANSPORTATION			SHEET NO.
DATE	DESCRIPTION	DATE	DESCRIPTION	FERNANDO AMADO-MATEUS, P.E. LICENSE NUMBER: 76201 TRACE CONSULTANTS, INC. 8900 SW 117 AVENUE, SUITE 105B MIAMI, FLORIDA 33186				
				ROAD NO.	COUNTY	FINANCIAL PROJECT ID	LIGHTING PLAN	
				SR A1A	PALM BEACH	447663-1-52-01		
							L-5	

THE OFFICIAL RECORD OF THIS SHEET IS THE ELECTRONIC FILE DIGITALLY SIGNED AND SEALED UNDER RULE 61G15-23.004, F.A.C.

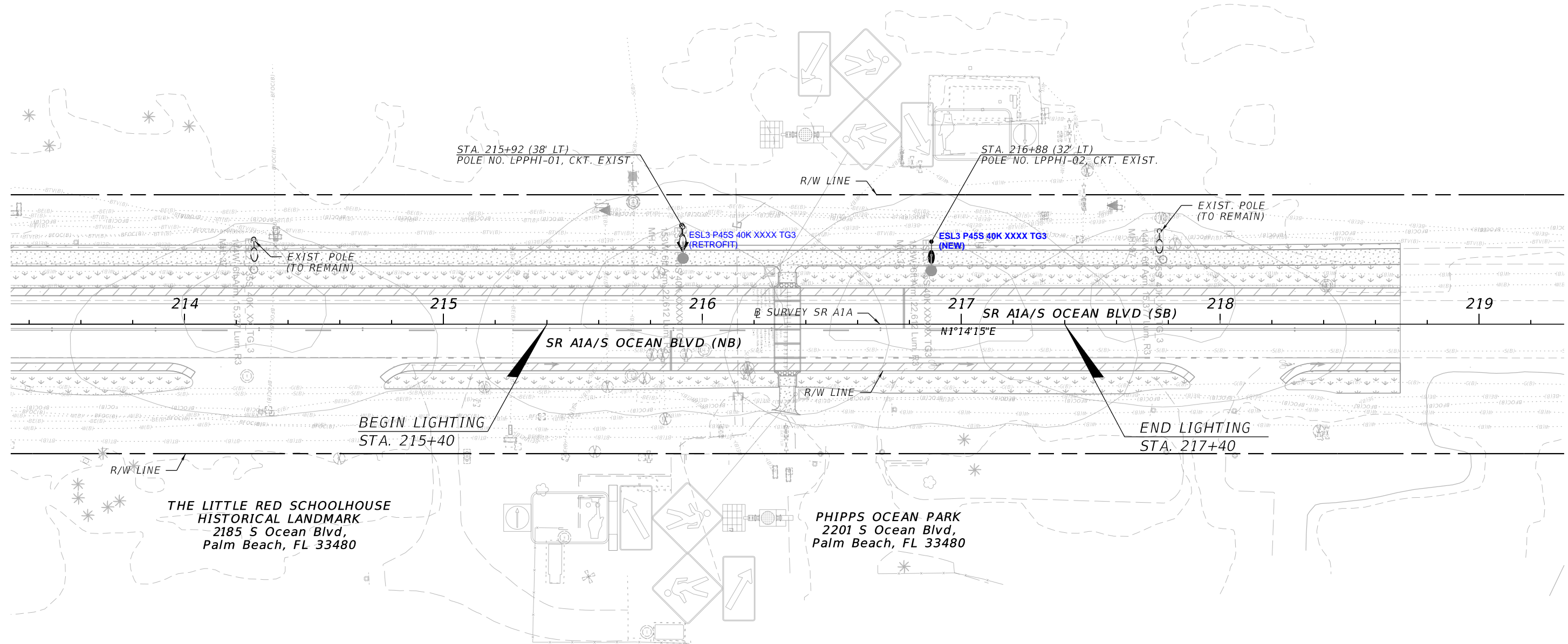
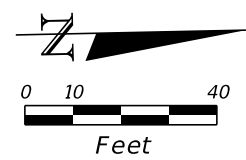

WORK BY FPL

SR A1A/S OCEAN BLVD AT PHIPPS PARK
MID-BLOCK CROSSING

LIGHTING PLAN

REVISIONS				ENGINEER OF RECORD		STATE OF FLORIDA DEPARTMENT OF TRANSPORTATION			SHEET NO.
DATE	DESCRIPTION	DATE	DESCRIPTION	FERNANDO AMADO-MATEUS, P.E. LICENSE NUMBER: 76201 TRACE CONSULTANTS, INC. 8900 SW 117 AVENUE, SUITE 105B MIAMI, FLORIDA 33186		ROAD NO.	COUNTY	FINANCIAL PROJECT ID	
						SR A1A	PALM BEACH	447663-1-52-01	

8/11/2023 10:18:59 PM Fernando
Z:\FDOT\Connect\10.10\Workspaces\FDOT\Worksets\FDOT\44766315201\Lighting\PLAN\L101.dgn

THE OFFICIAL RECORD OF THIS SHEET IS THE ELECTRONIC FILE DIGITALLY SIGNED AND SEALED UNDER RULE 61G15-23.004, F.A.C.

8/11/2023 10:19:00 PM Fernando Amado Mateus
Z:\FDOT\Connect\10.10\Workspaces\FDOT\447663\15201\Lighting\CNPLLT01.dgn

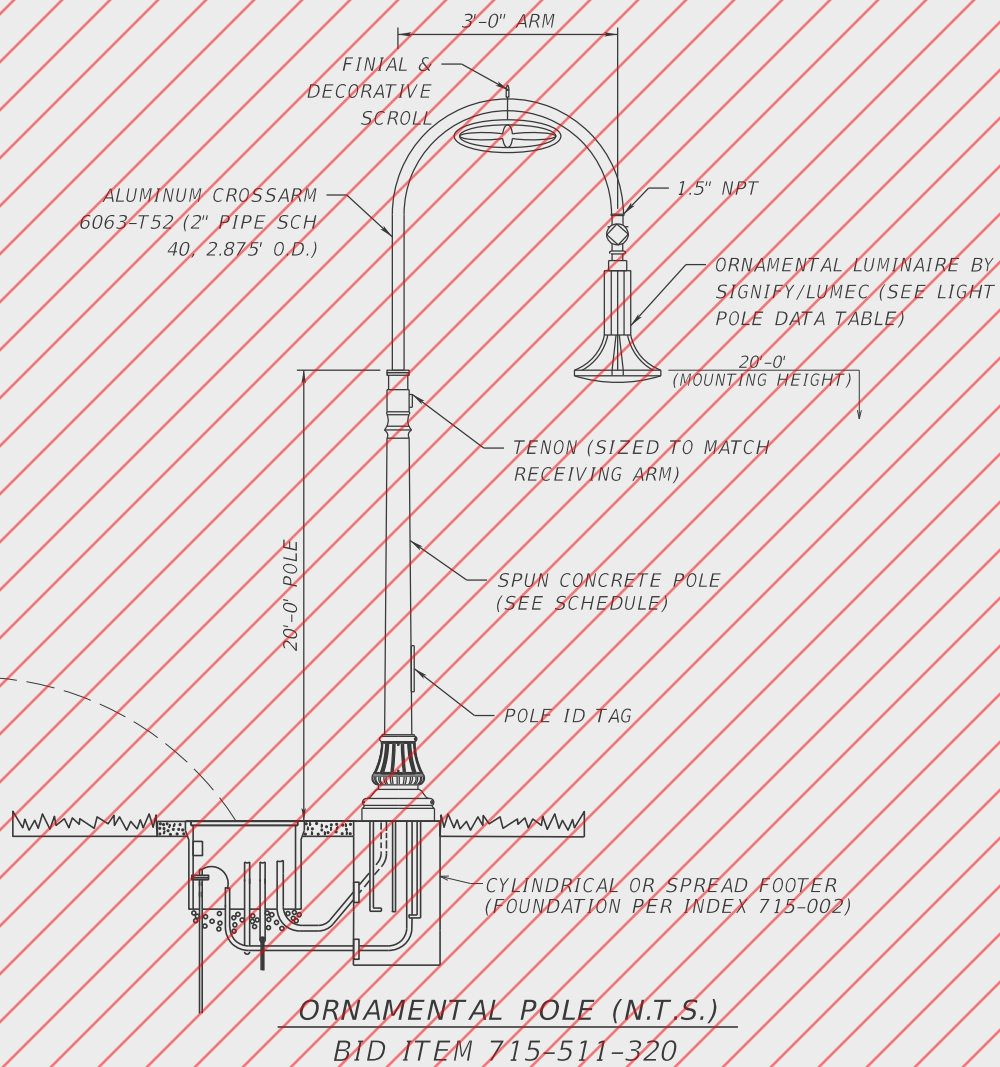
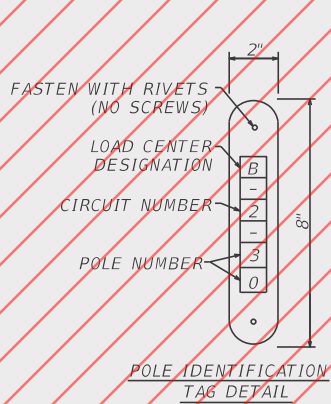
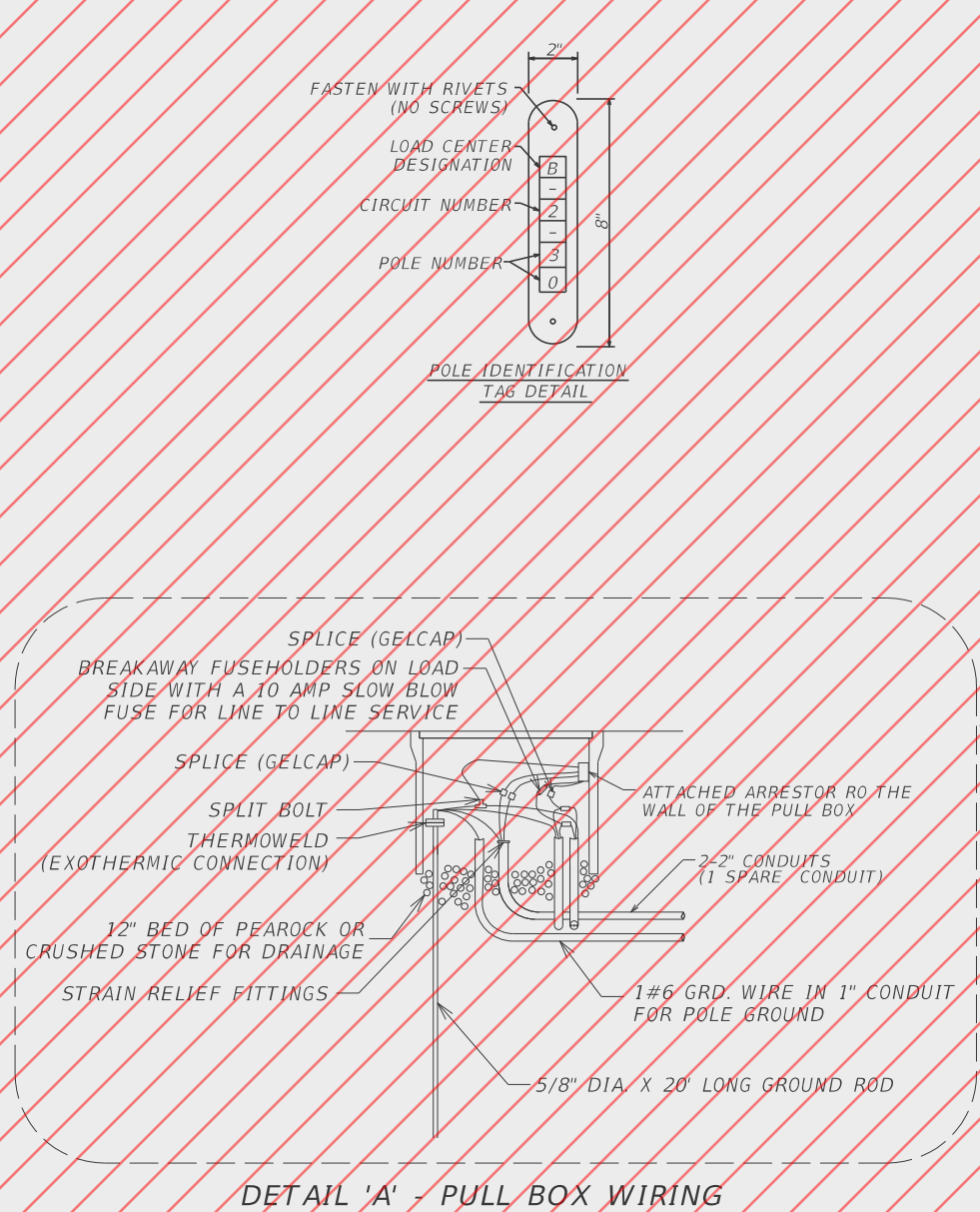

ORNAMENTAL POLE SCHEDULE

ELEMENT	MANUFACTURER	REFERENCE NO.	DIMENSIONS	COLOR
ALUMINUM CROSS-ARM - ROADWAY LIGHTING	ARTEC MANUFACTURING	LAKE WORTH ARM (VX-WPB-ASSE-GN4TX)	3'x3' ARM	GN4TX GREEN
SPUN CONCRETE POLE (FLUTED)	AMERON	VEF06.1 SPL W/TENON ASSEMBLY	20'-0' HT	PINE GREEN

SHOP DRAWINGS

PROVIDE SIGNED AND SEALED STRUCTURAL PLANS AND CALCULATIONS FOR THE ENTIRE DECORATIVE LIGHTING SYSTEM, INCLUDING CONNECTIONS DESIGN (LUMINAIRE-TO-ARM, ARM-TO-UPRIGHT, AND UPRIGHT-TO-FOUNDATION CONNECTIONS). PROVIDE PLANS AND CALCULATIONS SIGNED AND SEALED BY A FLORIDA-LICENSED PROFESSIONAL ENGINEER WHICH DEMONSTRATE THAT THE DECORATIVE LIGHT FIXTURES HAVE BEEN DESIGNED IN ACCORDANCE WITH THE LATEST VERSION OF AASHTO LRFDLTS AS MODIFIED BY THE PROVISIONS OF THE FDOT STRUCTURES MANUAL VOLUME 3.

NO WORK BY FPL - FOR REFERENCE

ORNAMENTAL POLE DETAILS (1 OF 2)

REVISIONS				ENGINEER OF RECORD			STATE OF FLORIDA DEPARTMENT OF TRANSPORTATION			SHEET NO.
DATE	DESCRIPTION	DATE	DESCRIPTION	FERNANDO AMADO-MATEUS, P.E. LICENSE NUMBER: 76201 TRACE CONSULTANTS, INC. 8900 SW 117 AVENUE, SUITE 105B MIAMI, FLORIDA 33186			ROAD NO.	COUNTY	FINANCIAL PROJECT ID	
							SR A1A	PALM BEACH	447663-1-52-01	

LIGHT POLE DETAILS

L-7

8/11/2023 10:19:01 PM Fernando Z:\FDOT\Connect\10\10\Workspaces\FDOT\Worksets\FDOT\4476631520\Lighting\CNPLLT01.dgn

KEY LEGEND

- 1 ORNAMENTAL TEARDROP FIXTURE
- 2 ALUMINUM FINNIALS
- 3 SCH 80 ALUMINUM PIPE CROSS-ARM
- 4 NOT USED
- 5 TENON TO FIT CROSS-ARM
- 6 SPUN CONCRETE POLE BLACK FINISH
- 7 POLE ID TAG AT 48" ABOVE SIDEWALK LEVEL, FACING TRAFFIC

NOTE: POLE, ACCESSORIES, HARDWARE (EXCEPT S.S.) AND LUMINAIRE SHALL HAVE BLACK POWDER COAT FINISH

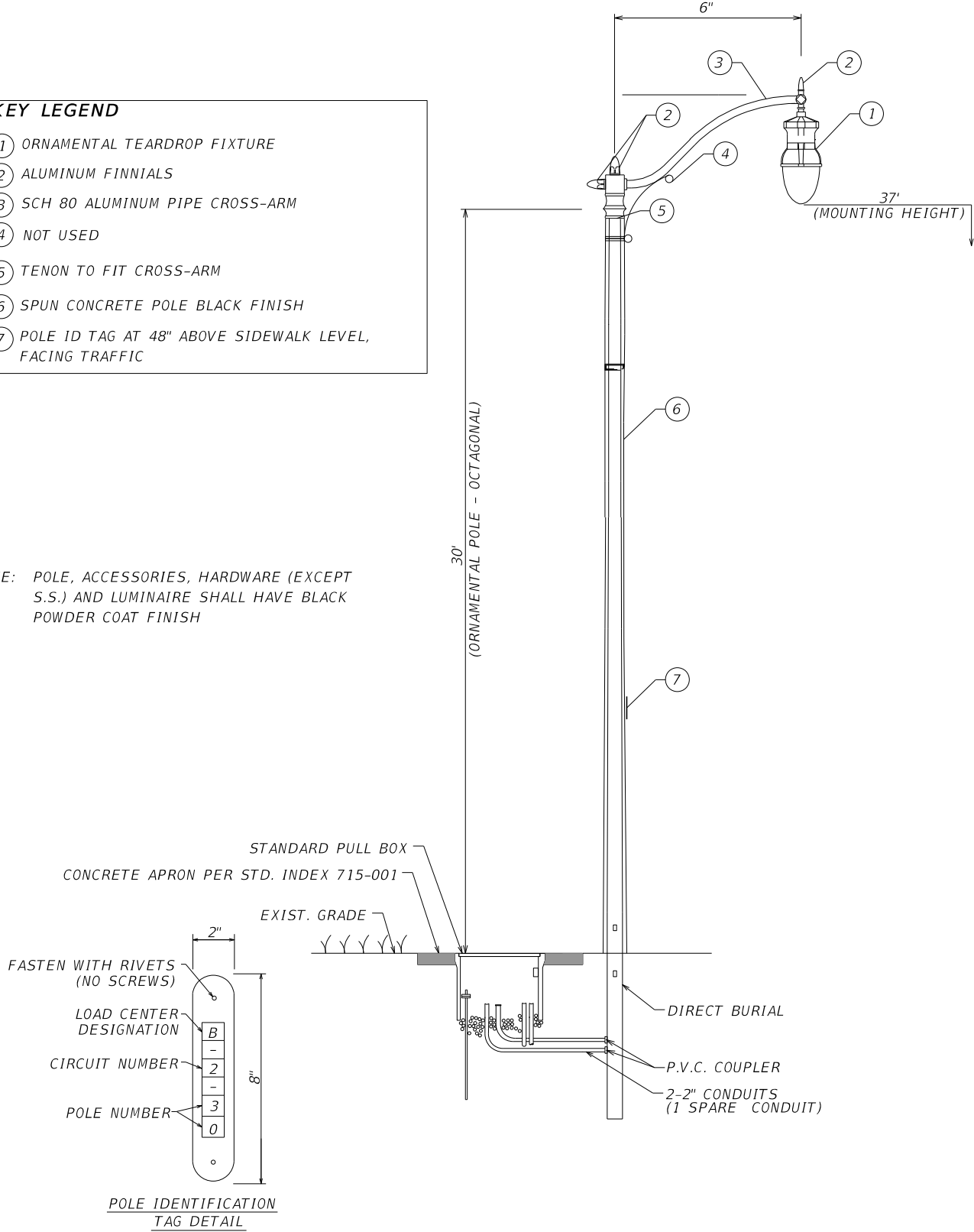

ORNAMENTAL POLE INSTALLATION DETAIL

* POLES BY FPL

WORK BY FPL

ORNAMENTAL POLE DETAILS (2 OF 2)

REVISIONS				ENGINEER OF RECORD	STATE OF FLORIDA DEPARTMENT OF TRANSPORTATION			LIGHT POLE DETAILS
DATE	DESCRIPTION	DATE	DESCRIPTION	FERNANDO AMADO-MATEUS, P.E. LICENSE NUMBER: 76201 TRACE CONSULTANTS, INC. 8900 SW 117 AVENUE, SUITE 105B MIAMI, FLORIDA 33186	ROAD NO.	COUNTY	FINANCIAL PROJECT ID	
					SR A1A	PALM BEACH	447663-1-52-01	

THE OFFICIAL RECORD OF THIS SHEET IS THE ELECTRONIC FILE DIGITALLY SIGNED AND SEALED UNDER RULE 61G15-23.004, F.A.C.

8/11/2023 10:19:03 PM Fernando
Z:\FDOT\Connect\10.10\Workspaces\FDOT\Worksets\FDOT\44766315201\Lighting\SPD\LT101.dgn

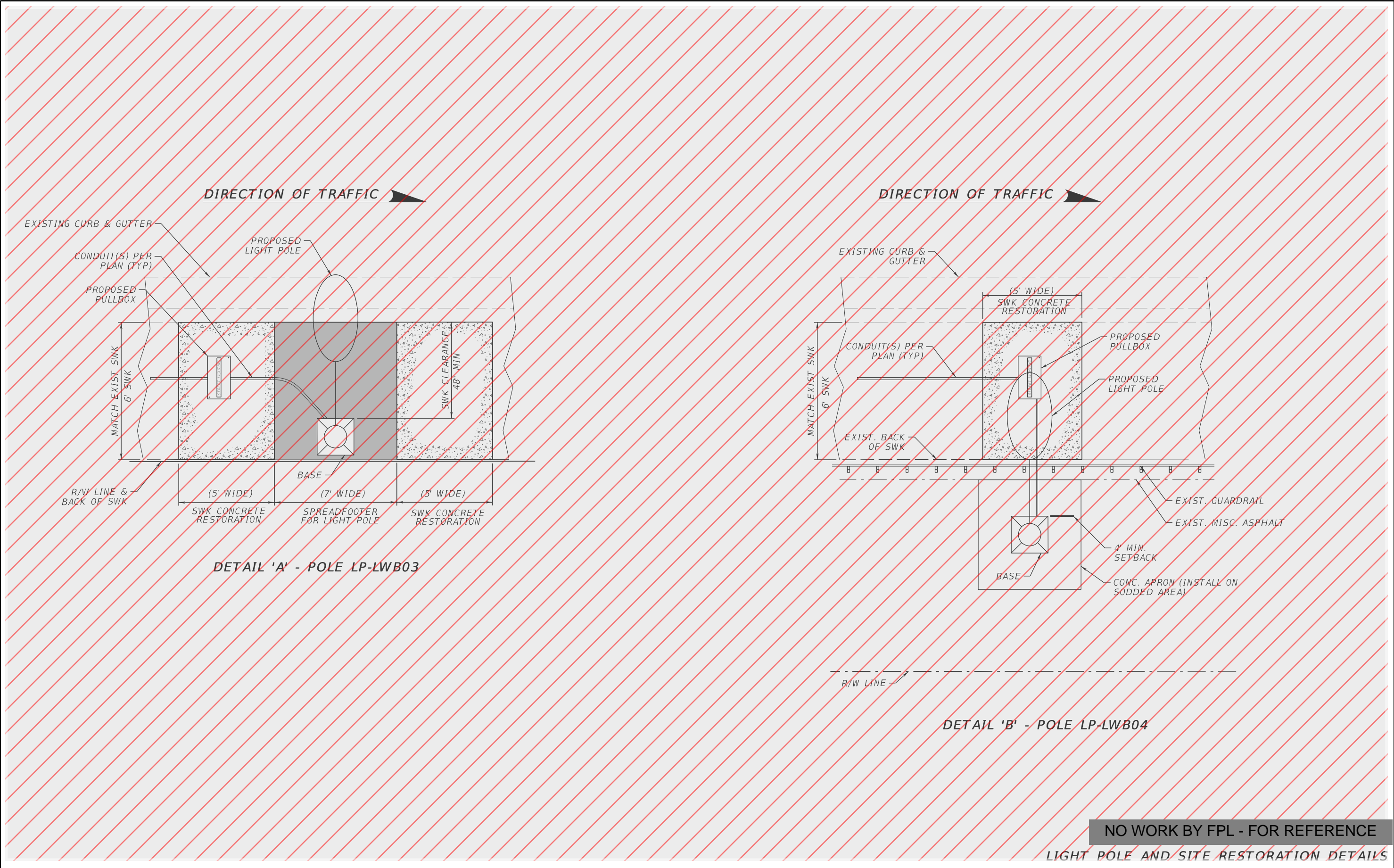

REVISIONS				ENGINEER OF RECORD	STATE OF FLORIDA DEPARTMENT OF TRANSPORTATION			SHEET NO.
DATE	DESCRIPTION	DATE	DESCRIPTION		ROAD NO.	COUNTY	FINANCIAL PROJECT ID	
				FERNANDO AMADO-MATEUS, P.E. LICENSE NUMBER: 76201 TRACE CONSULTANTS, INC. 8900 SW 117 AVENUE, SUITE 105B MIAMI, FLORIDA 33186	SR A1A	PALM BEACH	447663-1-52-01	L-9

LIGHT POLE DETAILS

THE OFFICIAL RECORD OF THIS SHEET IS THE ELECTRONIC FILE DIGITALLY SIGNED AND SEALED UNDER RULE 61G15-23.004, F.A.C.

8/11/2023 10:19:03 PM fanado Z:\FDOT\Connect\10\10\Workspaces\FDOT\Worksets\FDOT\4476631520\Lighting\SRP1LT01.dgn

SERVICE POINT DATA TABLE

SERVICE	ENCLOSURE SIZE & SERVICE COND.	ARTERIAL	ROADWAY	FROM	TO	LOCATION	CIRCUIT	CONDUCTORS	BREAKER SIZE	EXISTING CONNECTED LOAD (C)	PROPOSED CONNECTED LOAD (C)	MAINTAINING AGENCY
EXIST. CITY OF LAKE WORTH SERVICE POINT (TO REMAIN)	100 A MCB, 120/240V, SINGLE PHASE, 3 WIRE SERVICE FEEDER, 2-60 AMP CONTACTORS SIZE.	SR-A1A	86050	Southbound of SR 802	Northbound of SR 802	SR A1A / N OCEAN BLVD NORTHWEST CORNER AT 50 FT LT OF STA. 124+85.00 C/ L SR A1A.	A-I	3-#4	2-30 AMPS	14.8	8.5	CITY OF LAKE WORTH BEACH
							A-II	3-#4	2-30 AMPS	12.5	7.3	
							B-I	3-#4	2-30 AMPS	11.4	6.7	
							B-II	3-#4	2-30 AMPS	12.5	7.7	

NOTE: NO NET INCREASE IN DEMAND LOAD FOR ANY EXISTING CIRCUIT. EXISTING CIRCUITS, CONDUCTORS, BREAKERS AND SERVICE FEEDERS

EXISTING "CITY OF LAKE WORTH SERVICE POINT" 100A MCB IN NEMA 3R ENCLOSURE, 120/240 VOLTS, 1Φ, 3W SERVICE (PER STATE PRJ. FM #228858-1-52-01/FY 2004 AS-BUILTS)						
NO.	CIRCUIT NO.	SERVING	VA	AMPS	CIRCUIT BREAKER	WIRE/CONDUIT
1	A-I	STREET LIGHTING	4,080	8.5	30A	#4
2	A-II	STREET LIGHTING	3,504	7.3	30A	#4
3	B-I	STREET LIGHTING	3,216	6.7	30A	#4
4	B-II	STREET LIGHTING	3,696	7.7	30A	#4

(EXISTING SERVICE CONDUCTORS TO REMAIN)

CONTINUOUS LOAD = 14,496 VA
25% CONT. LOAD = 3,624 VA
TOTAL = 18,120 VA
DEMAND LOAD = 38 A

NO WORK BY FPL - FOR REFERENCE

REVISIONS				ENGINEER OF RECORD	STATE OF FLORIDA DEPARTMENT OF TRANSPORTATION			LOAD CENTER DETAILS
DATE	DESCRIPTION	DATE	DESCRIPTION	FERNANDO AMADO-MATEUS, P.E. LICENSE NUMBER: 76201 TRACE CONSULTANTS, INC. 8900 SW 117 AVENUE, SUITE 105B MIAMI, FLORIDA 33186	ROAD NO.	COUNTY	FINANCIAL PROJECT ID	
					SR A1A	PALM BEACH	447663-1-52-01	

L-10

THE OFFICIAL RECORD OF THIS SHEET IS THE ELECTRONIC FILE DIGITALLY SIGNED AND SEALED UNDER RULE 61G15-23.004, F.A.C.