

# BURNS RESIDENCE

1150 N. OCEAN WAY  
PALM BEACH, FLORIDA 33480

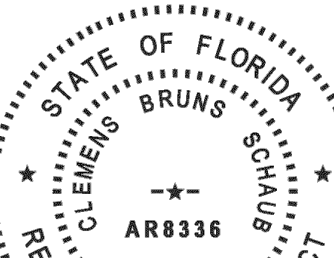

*Robert E. Studd*

**CLEMENS BRUNS SCHAUB**  
**ARCHITECT & ASSOCIATES, PA**

DESIGN CONFORMS TO THE  
2020 FLORIDA BUILDING CODE RESIDENTIAL

**THE ASSOCIATES STUDIO, LLC**

[illegible]

## REVISION NARRATIVE:

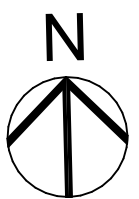

PROJECT NO: 23-01

DRAWN BY: TAS

CHECKED BY: CBS

**COPYRIGHT:**  
©2024 CLEMENS BRUNS SCHAUB, ARCHITECT & THE ASSOCIATES STUDIO, LLC. THIS CONTRACT DOCUMENT IS THE PROPERTY OF CLEMENS BRUNS SCHAUB, ARCHITECT & THE ASSOCIATES STUDIO, LLC. UNAUTHORIZED REPRODUCTION OR USE WILL BE PROSECUTED PURSUANT TO COPYRIGHT LAWS INCLUDING 1990 ARCHITECTURAL WORKS COPYRIGHT PROTECTION ACT.

SHEET TITLE:

## PERSPECTIVES (TREES)

ARCOM REVIEW ARC-23-166  
(FINAL RESUBMITTAL)

## A1.12





**BURNS**  
RESIDENCE

1150 N. OCEAN WAY  
PALM BEACH, FLORIDA 33480

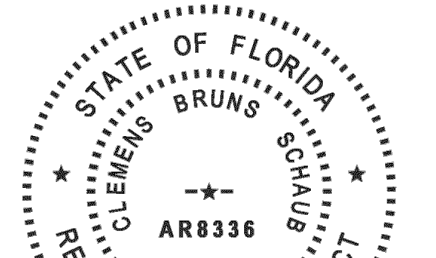

*Michael S. Shul*

**CLEMENS BRUNS SCHAUB  
ARCHITECT & ASSOCIATES, PA**

AR8336  
P.O.BOX 664160 VERO BEACH FLORIDA 32964  
EMAIL: CBS@CBSARCHS.COM  
WWW.CBSARCHS.COM  
PH: 772.231.1484

DESIGN CONFORMS TO THE  
2020 FLORIDA BUILDING CODE RESIDENTIAL

**THE ASSOCIATES STUDIO, LLC**



664 AZALEA LANE  
VERO BEACH, FLORIDA 32963  
EMAIL: TAS@TAS-Studio.com  
www.TheAssociatesStudio.com  
Ph: 772.231.1484

[illegible]

REVISION NARRATIVE:

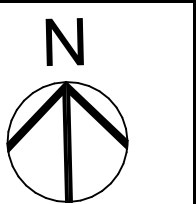

PROJECT NORTH

PROJECT NO:	23-01
-------------	-------

DRAWN BY:	TAS
-----------	-----

CHECKED BY: CBS

**COPYRIGHT:**  
©2024 CLEMENS BRUNS SCHAUB, ARCHITECT & THE ASSOCIATES STUDIO, LLC. THIS CONTRACT DOCUMENT IS THE PROPERTY OF CLEMENS BRUNS SCHAUB, ARCHITECT & THE ASSOCIATES STUDIO, LLC. UNAUTHORIZED REPRODUCTION OR USE WILL BE PROSECUTED PURSUANT TO COPYRIGHT LAWS INCLUDING 1990 ARCHITECTURAL WORKS COPYRIGHT PROTECTION ACT.

SHEET TITLE:

## PERSPECTIVES (TREES)

ARCOM REVIEW ARC-23-166  
(FINAL RESUBMITTAL)

## A1.13



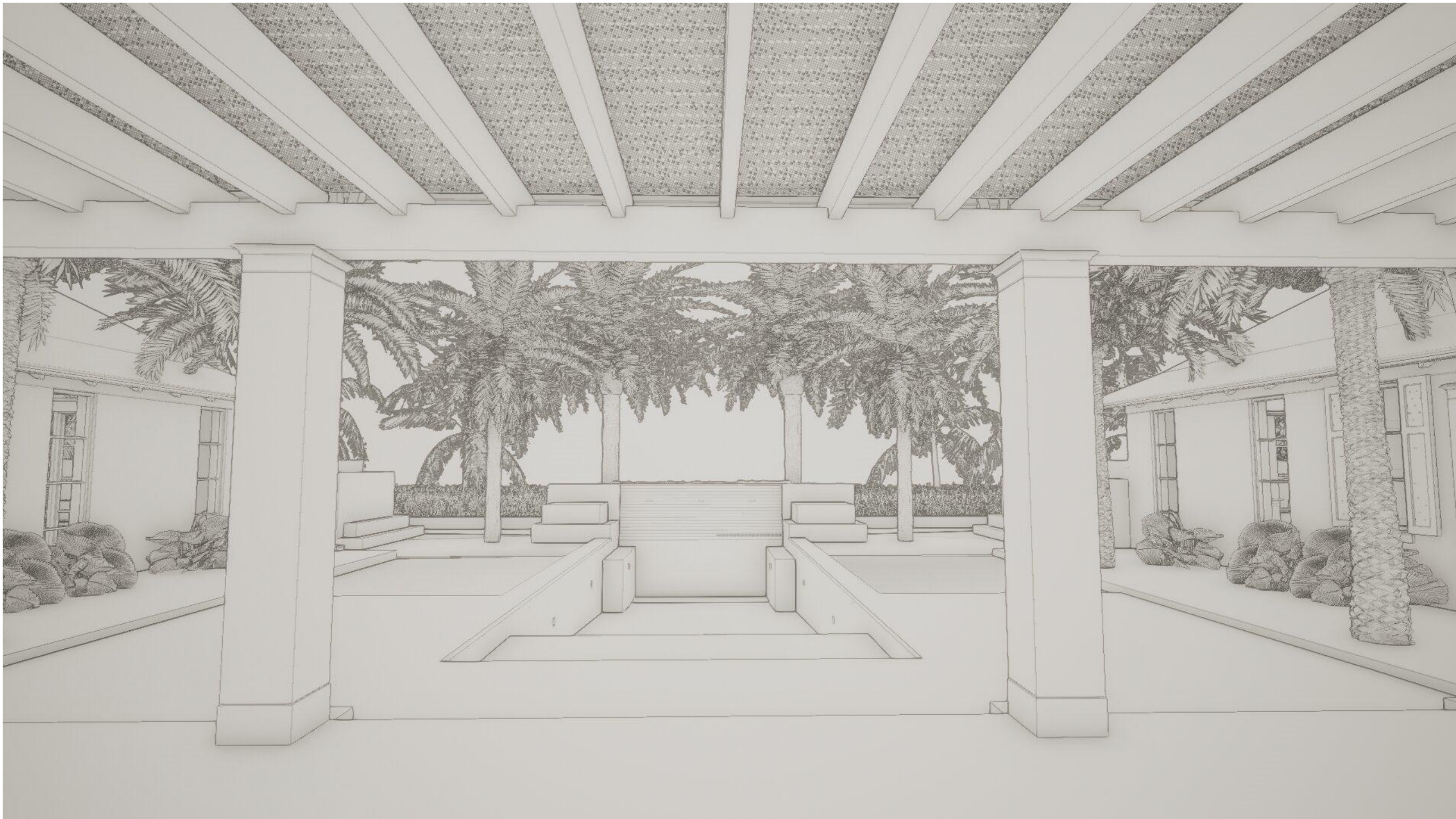
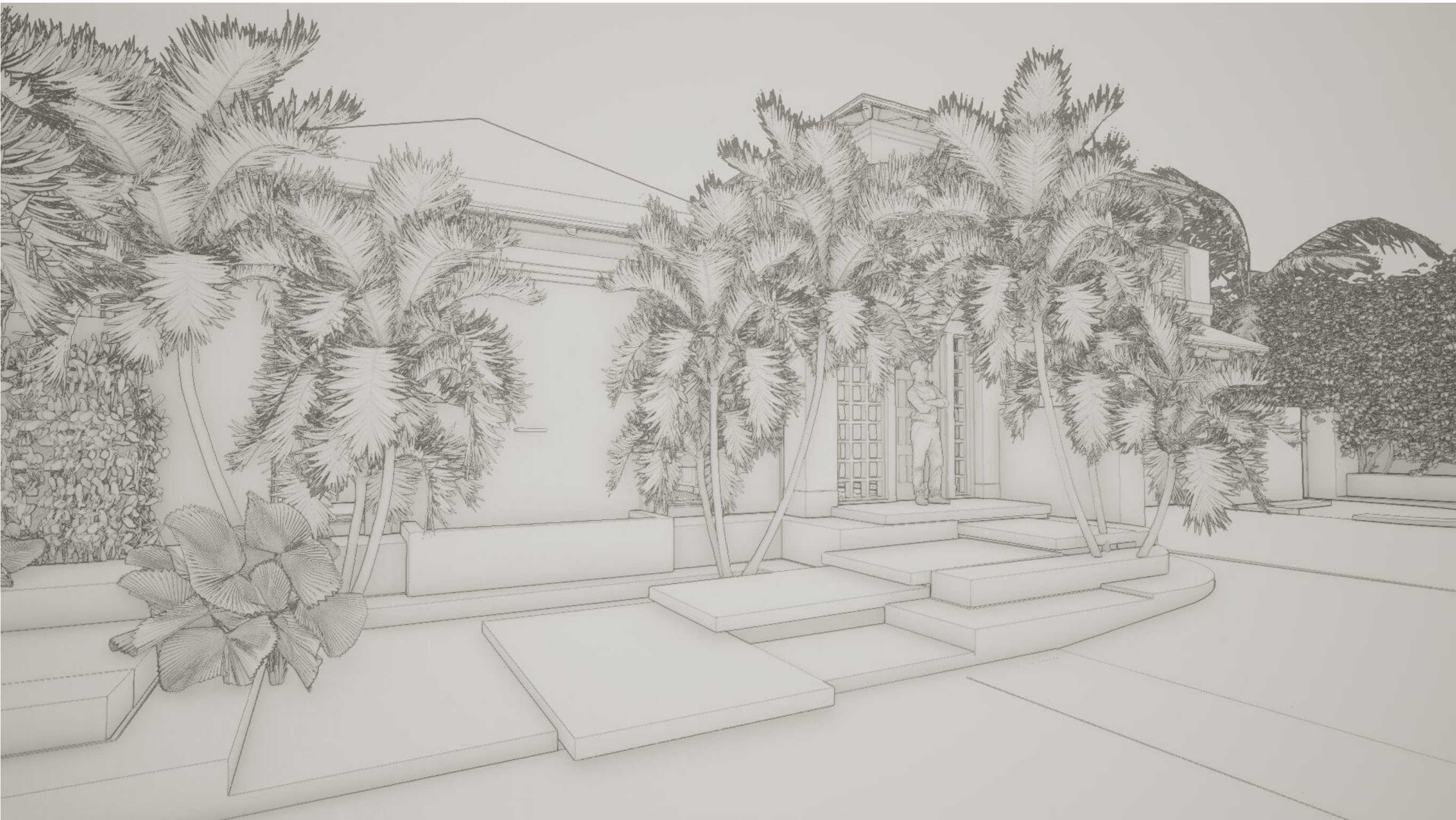

**BURNS  
RESIDENCE**  
1150 N. OCEAN WAY  
PALM BEACH, FLORIDA 33480

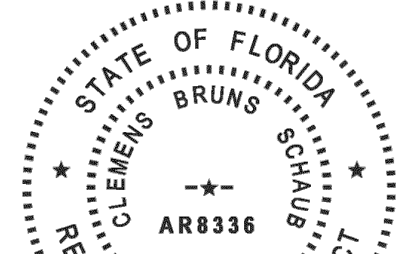

*Clemens Bruns Schaub*  
Clemens Bruns Schaub

**CLEMENS BRUNS SCHAUB  
ARCHITECT & ASSOCIATES, PA**  
AR8336  
P.O. BOX 664160 VERO BEACH FLORIDA 32964  
EMAIL: CBS@CBSARCHS.COM  
WWW.CBSARCHS.COM  
PH: 772.231.1484  
DESIGN CONFORMS TO THE  
2020 FLORIDA BUILDING CODE RESIDENTIAL

**THE ASSOCIATES STUDIO, LLC**



664 AZALEA LANE  
VERO BEACH, FLORIDA 32963  
EMAIL: TAS@TAS-Studio.com  
www.TheAssociatesStudio.com  
Ph: 772.231.1484

REV ID	ISSUE	DATE
00	ARCOM PRE-APP	09/18/2023
01	ARCOM FIRST SUBMITTAL	10/05/2023
02	ARCOM FIRST SUBMITTAL V2	11/02/2023
03	ARCOM SECOND SUBMITTAL	11/20/2023
04	ARCOM FINAL	01/24/2024
05	ARCOM FINAL RESUBMITTAL	02/05/2024

REVISION NARRATIVE:

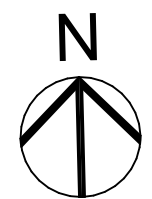

PROJECT NORTH

PROJECT NO: 23-01

DRAWN BY: TAS

CHECKED BY: CBS

COPYRIGHT:  
©2024 CLEMENS BRUNS SCHAUB, ARCHITECT & THE ASSOCIATES STUDIO, LLC. THIS CONTRACT DOCUMENT IS THE PROPERTY OF CLEMENS BRUNS SCHAUB, ARCHITECT & THE ASSOCIATES STUDIO, LLC. UNAUTHORIZED REPRODUCTION OR USE WILL BE PROSECUTED PURSUANT TO COPYRIGHT LAWS INCLUDING 1990 ARCHITECTURAL WORKS COPYRIGHT PROTECTION ACT.

SHEET TITLE:

**PERSPECTIVES (TREES)**

ARCOM REVIEW ARC-23-166  
(FINAL RESUBMITTAL)

**A1.14**





**BURNS  
RESIDENCE**  
1150 N. OCEAN WAY  
PALM BEACH, FLORIDA 33480



**CLEMENS BRUNS SCHAUB  
ARCHITECT & ASSOCIATES, PA**  
AR8336  
P.O. BOX 664160 VERO BEACH FLORIDA 32964  
EMAIL: CBS@CBSARCHS.COM  
WWW.CBSARCHS.COM  
PH: 772.231.1484  
DESIGN CONFORMS TO THE  
2020 FLORIDA BUILDING CODE RESIDENTIAL

**THE ASSOCIATES STUDIO, LLC**



REV ID	ISSUE	DATE
00	ARCOM PRE-APP	09/18/2023
01	ARCOM FIRST SUBMITTAL	10/05/2023
02	ARCOM FIRST SUBMITTAL V2	11/02/2023
03	ARCOM SECOND SUBMITTAL	11/20/2023
04	ARCOM FINAL	01/24/2024
05	ARCOM FINAL RESUBMITTAL	02/05/2024

REVISION NARRATIVE:



PROJECT NO: 23-01  
DRAWN BY: TAS  
CHECKED BY: CBS  
COPYRIGHT:  
©2024 CLEMENS BRUNS SCHAUB, ARCHITECT & THE ASSOCIATES STUDIO, LLC. THIS CONTRACT DOCUMENT IS THE PROPERTY OF CLEMENS BRUNS SCHAUB, ARCHITECT & THE ASSOCIATES STUDIO, LLC. UNAUTHORIZED REPRODUCTION OR USE WILL BE PROSECUTED PURSUANT TO COPYRIGHT LAWS INCLUDING 1990 ARCHITECTURAL WORKS COPYRIGHT PROTECTION ACT.

SHEET TITLE:  
**PERSPECTIVES (TREES)**

ARCOM REVIEW ARC-23-166  
(FINAL RESUBMITTAL)

**A1.15**